

MISCELLANEOUS  
ATTACHMENT DETAILS

Part No.	Description	No. off	Material Specification	Class of Eqpt M.R. or L.M.	Plate	
1	2	3	4	5	6	
	AILERON AND JACKS, Port and Starboard Attachment Details Assy (EB8.00.87/8)	-	-	-	-	R
	Consisting of:					
EB8.20.6035	BOLT, jack attachment (Mod 4848)	4	S98	C	HA1/1	R
A25/15G	BOLT, aileron wing attachment	4	-	C	HA1/2	R
A27/JS	NUT, jack attachment	1	-	C	HA1/3	R
SP90/E6	PIN, split, 3/32 in. dia.	4	-	C	HA1/4	R
EB8.20.4447	SHIM aileron hinge	2	Lam. Alum	C	HA1/5	R
SP14/J	WASHER, jack to aileron	AR	-	C	HA1/6	R
EB8.24.307	WASHER, slip jack attachment	4	DTD166B	C	HA1/7	R
	CENTRE FUSELAGE TO REAR FUSELAGE Attachment Details (EB8.00.25)	-	-	-	-	R
	Consisting of:					
A25/6E	BOLT, 1/4 in. hex. hd. BSF	54	-	C	HA2/1	R
A25/7E	BOLT, 1/4 in. hex. hd. BSF	10	-	C	HA2/2	R
A25/9E	BOLT, 1/4 in. hex. hd. BSF	12	-	C	HA2/3	R
A25/10E	BOLT, 1/4 in. hex. hd. BSF	16	-	C	HA2/4	R
A25/13E	BOLT, 1/4 in. hex. hd. BSF	8	-	C	HA2/5	R
A25/6G	BOLT, 5/16 in. hex. hd. BSF	16	-	C	HA2/6	R
A25/7G	BOLT, 5/16 in. hex. hd. BSF	8	-	C	HA2/7	R
A25/13G	BOLT, 5/16 in. hex. hd. BSF	30	-	C	HA2/8	R
A25/15G	BOLT, 5/16 in. hex. hd. BSF	12	-	C	HA2/9	R
A25/16N	BOLT, 1/2 in. hex. hd. BSF	2	-	C	HA2/10	R
A25/18N	BOLT, 1/2 in. hex. hd. BSF	2	-	C	HA2/11	R
AGS2001/E1	NUT, stiff, 1/4 in. BSF	100	-	C	HA2/12	R
AGS2001/G1	NUT, stiff, 5/16 in. BSF	66	-	C	HA2/13	R
AGS2001/NI	NUT, stiff, 1/2 in. BSF	4	-	C	HA2/14	R
SP15/E	WASHER	70	-	C	HA2/15	R
SP15/G	WASHER	16	-	C	HA2/16	R
EAL10.2713	WASHER	4	-	C	HA2/17	R
	CONTROLS TO RUDDER AND ELEVATOR Attachment Details Assy. (EB8.00.63)	-	-	-	-	R
	Consisting of:					
EB8.45.769	BOLT, control rod to rudder attachment	1	S97	C	HA3/1	R
EEAS13/1	BOLT, control rod to elevator attachment	1	S11	C	HA3/2	R
EEAS14	BUSH	1	S11	C	HA3/3	R
EB8.45.763	COLLAR, distance	1	S95	C	HA3/4	R
A27/NS	NUT, slotted, 1/2 in. BSF	1	-	C	HA3/5	R
EEAS63/E	NUT, slotted, 1/4 in. BSF	1	S96	C	HA3/6	R
EB8.45.761	PAD, pressure	2	DTD197A	C	HA3/7	R
EEAS127	PIECE, distance	1	S96	C	HA3/8	R
SP90/C8	PIN, split, 1/16 in. dia.	1	-	C	HA3/9	R
SP90/E10	PIN, split, 3/32 in. dia.	1	-	C	HA3/10	R
SP13/N	WASHER, 1/2 in.	1	-	C	HA3/11	R

MISCELLANEOUS  
ATTACHMENT DETAILS

Part No.	Description	No. off	Material Specification	Class of Eqpt M.R. or L.M.	Plate	
	1 2 3 4 5 6					
	DROP TANK AND FAIRING TO WING, Port and Starboard Attachment Details Assembly (EB8.00.81/2)	-	-	-	-	R
	Consisting of:					
EB8.62.121	BOLT, explosive, forward	1	-	C	HA4/1	R
EB8.62.123	BOLT, explosive, inboard aft	1	-	C	HA4/2	R
EB8.62.125	BOLT, explosive, outboard aft	1	-	C	HA4/3	R
AGS2002/Q1	NUT, stiff, 5/8 in. BSF	3	-	C	HA4/4	R
EB8.62.139	SHIM	2	Lam. Alum	C	HA4/5	R
EB8.62.177	SHIM	1	Lam. Alum	C	HA4/6	R
EA1.20.10505	WASHER	3	DTD124	C	HA4/7	R
EB8.62.147	WASHER	3	DTD5054	C	HA4/8	R
	FLAP, INBOARD, Port and Starboard Attachment details (EB8.25.1)	-	-	-	-	R
	Consisting of:					
EA1.25.265	BOLT, hinge attachment to wing	2	S15	C	HA1/7A	R
A27/JS	NUT, slotted, 3/8 in. BSF	2	-	C	HA1/8	R
SP90/C8	PIN, split, 1/16 in. dia.	2	-	C	HA1/9	R
EA1.25.43	WASHER, spherical	4	S11	C	HA1/10	R
SP10/J	WASHER	2	-	C	HA1/11	R
	FLAP, OUTBOARD, Port and Starboard Attachment Details (EA9.25.1/2)	-	-	-	-	R
	Consisting of:					
EA1.25.265	BOLT, hinge attachment to wing	2	S15	C	HA1/12	R
A27/JS	NUT, slotted, 3/8 in. BSF	2	-	C	HA1/13	R
SP90/C8	PIN, split, 1/16 in.	2	-	C	HA1/14	R
EA1.25.43	WASHER, spherical	4	S11	C	HA1/15	R
AGS160/F	WASHER	2	-	C	HA1/16	R
	FIN TO FUSELAGE Attachment Details Assy. (EB8.00.55)	-	-	-	-	R
	Consisting of:					
EA1.32.75	BOLT, fin attachment, port	1	DTD473	C	HA3/12	R
EA1.32.77	BOLT, fin attachment, starboard	1	DTD473	C	HA3/13	R
A25/1C	BOLT, 2BA	10	-	C	HA3/14	R
A25/9C	BOLT, 2BA	6	-	C	HA3/15	R
AS1242/1C	BOLT, 2BA	18	-	C	HA3/16	R
AS1242/1-1/2C	BOLT, 2BA	36	-	C	HA3/17	R
EEAS1/4C	SCREW, 2BA	58	-	C	HA3/18	R
EEAS1/4-1/2C	BOLT, 2BA	20	-	C	HA3/19	R
	HINGED NOSE TO FORWARD FUSELAGE, Attachment Details (EB8.10.4053)	-	-	-	-	R
AS2504/20J	BOLT, close tolerance, 3/8 in. BSF, upper and lower hinge arm	2	-	C	HA5/1	R
EB8.10.6935	BOLT, 1/4 in. BSF, folding strut attachment	1	S96	C	HA5/2	R
A27/JS	NUT, slotted, 3/8 in. BSF, upper and lower hinge arm	2	-	C	HA5/3	R
A27/ES	NUT, slotted, 1/4 in. BSF, folding strut	1	-	C	HA5/4	R
SP90/C8	PIN, split, 1/16 in. dia.	3	-	C	HA5/5	R
EB8.10.7009	SPACER, upper and lower hinge arm	2	L65	C	HA5/6	R
SP15/E	WASHER, 1/4 in.	1	-	C	HA5/7	R

MISCELLANEOUS  
ATTACHMENT DETAILS

Part No.	Description	No. off	Material Specification	Class of Eqpt M.R. or L.M.	Plate	
1	2	3	4	5	6	
	REAR FAIRING TO FUSELAGE Attachment Details Assembly (EA1.00.59)	-	-	-	-	R
	Consisting of:					
A25/4E	BOLT, 1/4 in. BSF	2	-	C	HA6/1	R
A27/ES	NUT, slotted, 1/4 in. BSF	2	-	C	HA6/2	R
AGS2001/E1	NUT, stiff, 1/4 in. BSF	4	-	C	HA6/3	R
SP90/C8	PIN, split, 1/16 in. dia.	2	-	C	HA6/4	R
EEAS1/3C	SCREW, 2BA.	4	S11	C	HA6/5	R
SP16/E	WASHER	2	-	C	HA6/6	R
	RUDDER TO FIN AND FUSELAGE Attachment Details Assembly. (EB8.00.57)	-	-	-	-	R
	Consisting of:					
EA1.32.203	BOLT, rudder to fin attachment	2	S11	C	HA3/20	R
EA1.32.205	BOLT, rudder to fin attachment	4	S11	C	HA3/21	R
EB8.12.1111	END-CAP Assembly (Pre AS2989)	1	-	C	-	R
EB8.12.679	END-CAP (Pre AS2989)	1	-	C	-	R
EB8.12.1109	SEAL, Ring (Pre AS2989)	1	L65	C	-	R
EB8.12.679	END-CAP (AS2989)	1	-	C	HA3/25	R
EB8.33.213	NUT, slotted, rudder to fuselage attachment	1	S95	C	HA3/26	R
SP90/H16	PIN, split, 5/32 in. dia.	1	-	C	HA3/27	R
EB8.12.1183	WASHER, felt (AS2989)	1	RS4	-	HA3/28	R
	NOTE:- This item must not be fitted before EB8.12.1109 is removed from the aircraft and the redundant holes in EB8.12.679 have been sealed					
	TAIL PLANE AND ELEVATOR Attachment Details	-	-	-	-	R
	Consisting of:					
EA1.12.451	BOLT, tail plane actuator anchor	1	S65	C	HA7/1	R
EA3.30.75	BOLT, pivot, tail plane attachment forward hinge point	2	S97	C	HA7/2	R
EA3.31.45	BOLT, port elevator operating lever	1	S95	C	HA7/3	R
EEAS13/1	BOLT, connecting rod attachment	1	S1	C	HA7/4	R
A25/3C	BOLT, 2BA, detachable fairing attachment	4	-	C	HA7/5	R
A25/14J	BOLT, 3/8 in. BSF connecting link attachment	1	-	C	HA7/6	R
EA3.31.47	BUSH, serrated, for bolt, port elevator operating lever	1	S95	C	HA7/7	R
EB8.30.67	FAIRING, Detachable Root, Port Group (Supplied to Pt. No. EB8.00.531 for spares purposes)	1	-	C	HA7/8	R
	Spares for:					
EA1.30.1107	PANEL, access, tailplane actuator	1	DTD610	C	HA7/9	R
EB8.30.68	FAIRING, Detachable Root, Starboard Group (Supplied to Pt. No. EB8.00.532 for spares purposes)	1	-	C	HA7/10	R
	Spares for:					
EA1.30.1107	PANEL, access, tailplane actuator	1	DTD610	C	HA7/11	R

MISCELLANEOUS  
ATTACHMENT DETAILS

Part No.	Description	No. off	Material Specification	Class of Eqpt M.R. or L.M.	Plate	
	1 2 3 4 5 6					
EA3.31.43	LINK, connecting elevator operating levers	1	DTD683	C	HA7/12	R
A27/JT	LOCKNUT, 3/8 in BSF	3	-	C	HA7/13	R
A27/JTL	LOCKNUT, 3/8 in. BSF LH	1	-	C	HA7/14	R
SP21	NIPPLE, lubricating	2	-	C	HA7/15	R
EA1.12.453	NUT, tailplane, actuator anchor	1	-	C	HA7/16	R
EA1.30.341	NUT, tailplane attachment forward hinge point (Pre SAS 4741)	2	L40	C	-	R
A24/PP	NUT, 9/16 in BSF (SAS 5741)	2	-	C	HA7/18	R
A27/JS	NUT, slotted, 3/8 in. BSF	2	-	C	HA7/19	R
A58/ES	NUT, slotted, 1/4 in. BSF	1	-	C	HA7/21	R
SP90/C8	PIN, split, 1/16 in. dia.	3	-	C	HA7/22	R
SP90/E8	PIN, split, 1/32 in. dia.	1	-	C	HA7/22A	R
SP90/E10	PIN, split, 1/32 in. dia.	4	-	C	HA7/23	R
EA1.12.597	PLATE, sealing, tailplane to fuselage, forward, port	1	-	C	HA7/24	R
EA1.12.598	PLATE, sealing, tailplane to fuselage, forward, starboard	1	-	C	HA7/25	R
EA1.12.599	PLATE, sealing, tailplane to fuselage, aft port	1	-	C	HA7/26	R
EA1.12.600	PLATE, sealing, tailplane to fuselage, aft, starboard	1	-	C	HA7/27	R
EA1.31.49	PLATE, locking, for serrated bush	1	S95	C	HA7/28	R
EA1.31.279	ROD END, bearing, elevator tab connecting rod (Pre Mod 5000 ALT SB/9/012)	1	-	C	-	R
EK5.31.607	ROD END, bearing, elevator tab connecting rod (Mod 5000 ALT SB/9/012)	1	-	C	HA7/29	R
EB8.31.31	SCREW, connecting, between connecting rod and rod end	1	S95	C	HA7/30	R
A33/C16	SCREW, 2BA, sealing plate attachment	15	-	C	HA7/31	R
A33/C20	SCREW, 2BA, sealing plate attachment	20	-	C	HA7/32	R
A33/C24	SCREW, 2BA, sealing plate attachment	36	-	C	HA7/33	R
EA1.12.455	WASHER, tailplane actuator anchor	2	DTD610	C	HA7/34	R
EA1.31.165	WASHER, connecting link attachment	2	L1	C	HA7/35	R
EA1.31.361	WASHER, elevator hinge	2	DTD610	C	HA7/36	R
SP15/E	WASHER, connecting rod attachment	1	-	C	HA7/37	R
	UNDERCARRIAGE TO WING, Port and Starboard Attachment details Assembly (EB8.00.35/6)	-	-	-	-	R
	Consisting of:					
EA3.40.179	ADAPTOR, lubricating nipples for side stay pivot bolt	1	S95	C	HA8/1	R
EA1.20.1107	BOLT, main undercarriage, pivot	1	S95	C	HA8/2	R
EA1.40.243	BOLT, hinge side stay link	1	S65	C	HA8/3	R
EA3.40.177	BOLT, side stay pivot	1	S65	C	HA8/4	R
EB8.50.1359	BOLT, attachment, link to cowl door	1	S65	C	HA8/5	R
AS1242/3C	BOLT, 2BA, stop block attachment	2	-	C	HA8/6	R
EB8.50.1351	LINK, cowl door, group	1	-	C	HA8/7	R
SP21	NIPPLE, lubricating	1	-	C	HA8/8	R
EA1.20.1287	NUT, main undercarriage pivot bolt	1	S11	C	HA8/9	R
EA1.40.287	NUT, side link bolt	2	S11	C	HA8/10	R
AGS2002/C1	NUT, stiff 2BA	1	-	C	HA8/11	R
EA3.20.1813	PIN, split, main undercarriage pivot bolt	1	DTD268	C	-	R
OR						
SP90/L24 #	PIN, split, 1/4 in dia, main undercarriage pivot bolt	1	-	C	HA8/12	R
	#Preferred alternative to Part No. EA3.20.1813					R
AGS784/22	PIN, split, 1/8 in. dia.	1	-	C	HA8/13	R



MISCELLANEOUS  
ATTACHMENT DETAILS

Part No.	Description	No. off	Material Specification	Class of Eqpt M.R. or L.M.	Plate	
	1 2 3 4 5 6					
SP90/G16	PIN, split, 1/16 in. dia.	1	-	C	HA8/14	R
EA3.20.933	PLATE, locking, main undercarriage pivot bolt (Pre Mod 3593)	1	-	C	-	R
EA9.20.1137	PLATE, locking, main undercarriage pivot bolt (Mod 3593)	1	-	C	HA8/15	R
EA3.20.1129	STOP, BLOCK, side stay, pivot bolt, port	1	DTD683	C	HA8/16	R
EA3.20.1130	STOP, BLOCK, side stay pivot bolt, starboard	1	DTD683	C	HA8/17	R
EA1.20.1285	WASHER, main undercarriage pivot bolt (Pre Mod 3593)	1	L45	C	-	R
EA9.20.1143	WASHER, main undercarriage pivot bolt (Mod 3593)	1	-	C	HA8/18	R
	WING, TO FUSELAGE, Port and Starboard Attachment details Assembly (EB8.00.5/6)	-	-	-	-	R
	Consisting of:					
EA3.20.135	BLOCK, sealing, wing to fuselage joint	1	Linatex	C	HA9/1	R
EA1.20.2897	BLOCK, sealing, wing to fuselage joint	1	Linatex	C	HA9/2	R
EA1.20.2899	BLOCK, sealing, wing to fuselage joint	1	Linatex	C	HA9/3	R
EB8.20.5987	BLOCK, guide	39	-	C	HA9/4	R
AS1242/2-1/2C	BOLT, guide block	39	-	C	HA9/5	R
EA1.20.1101	BOLT, main pick-up, wing to fuselage	2	DTD473	C	HA9/6	R
EA1.20.2277	BOLT, wing to fuselage attachment	2	DTD473	C	HA9/7	R
A25/10C	BOLT, 2BA	1	-	C	HA9/8	R
A25/10N	BOLT, 1/2 in. BSF	1	-	C	HA9/9	R
AGS571/906	BOLT, 9/16 in. BSF	7	-	C	HA9/10	R
EA1.11.129	COLLAR, rear spar to fuselage	1	DTD126A	C	HA9/11	R
EA9.20.1371	GUSSET, bottom, main spar closing panel port	1	S3	C	HA9/12	R
EA9.20.1372	GUSSET, bottom, main spar closing panel starboard	1	S3	C	HA9/13	R
EA9.20.1373	GUSSET, top, main spar closing panel, port	1	S3	C	HA9/14	R
EA9.20.1374	GUSSET, top, main spar closing panel, starboard	1	S3	C	HA9/15	R
AGS2007/C1	NUT, guide block bolt	39	-	C	HA9/16	R
A27/CP	NUT, 2BA	1	-	C	HA9/17	R
A27/NS	NUT, slotted, 1/2 in. BSF	1	-	C	HA9/18	R
A27/SS	NUT, slotted, 3/4 in. BSF	2	-	C	HA9/19	R
A27/WS	NUT, slotted, 1 in. BSF	2	-	C	HA9/20	R
AGS572/J	NUT, slotted, 9/16 in. BSF	7	-	C	HA9/21	R
AGS2001/C1	NUT, stiff, 2BA	42	-	C	HA9/22	R
EA1.20.2275	PAD, wing attachment bolt	2	S11	C	HA9/23	R
EA1.1.127	PIN, rear spar to fuselage	1	S11	C	HA9/24	R
SP90/E10	PIN, split, 3/32 in. dia.	8	-	C	HA9/25	R
SP90/H16	PIN, split, 5/32 in. dia.	2	-	C	HA9/26	R
SP90/K20	PIN, split, 3/16 in. dia.	2	-	C	HA9/27	R
EB8.20.5983	PLATE, sealing	1	-	C	HA9/28	R
EB8.20.5984	PLATE, sealing	1	-	C	HA9/29	R
EB8.20.5985	PLATE, sealing	1	-	C	HA9/30	R
EB8.20.5986	PLATE, sealing	1	-	C	HA9/31	R
EEAS1/1-1/2C	SCREW, 2BA	409	S11	C	HA9/32	R
EEAS1/2C	SCREW, csk, 2BA	38	S11	C	HA9/33	R
EEAS1/2-1/2C	SCREW, 2BA	47	S11	C	HA9/34	R
EEAS1/4C	SCREW, 2BA	12	S11	C	HA9/35	R
PK4100	SCREW, csk. Pk. No. 4 x 3/8 in. long	10	-	C	HA9/36	R

MISCELLANEOUS  
ATTACHMENT DETAILS

Part No.	Description						No. off	Material Specification	Class of Eqpt M.R. or L.M.	Plate	
	1	2	3	4	5	6					
EA3.20.689	STRIP, closing, top, aft of spar, port (Supplied undrilled and with trim allowance)						1	-	C	HA9/37	R
EA3.20.690	STRIP, closing, top, aft of spar, starboard (Supplied undrilled and with trim allowance)						1	-	C	HA9/38	R
EA3.20.691	STRIP, closing, bottom, aft of spar, port (Supplied undrilled and with trim allowance)						1	-	C	HA9/39	R
EA3.20.692	STRIP, closing, bottom, aft of spar, starboard (Supplied undrilled and with trim allowance)						1	-	C	HA9/40	R
EA1.11.131	WASHER, distance, rear spar to fuselage						1	L40	C	HA9/41	R
EA1.20.1335	WASHER, main pick-up bolt						2	DTD610	C	HA9/42	R
EEAS27/16GU	WASHER, 2BA						42	DTD124	C	HA9/43	R
AGS163/C	WASHER, spring, 2BA						12	-	C	HA9/44	R
AGS2036/C	WASHER, locking, 2BA						12	-	C	HA9/45	R
SP13/C	WASHER, 2BA						1	-	C	HA9/46	R
SP124/P	WASHER, 9/16 in.						7	-	C	HA9/47	R
SP15/S	WASHER, 3/4 in.						1	-	C	HA9/48	R
SP16/N	WASHER, 1/4 in.						1	-	C	HA9/49	R

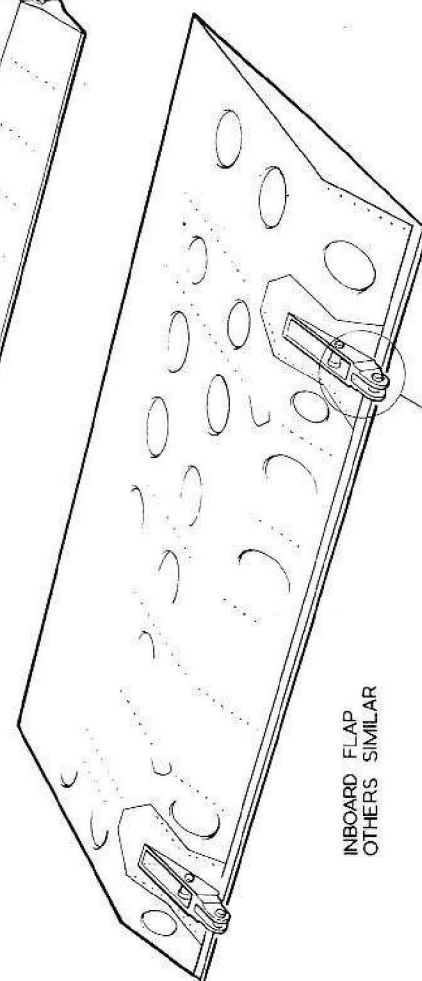
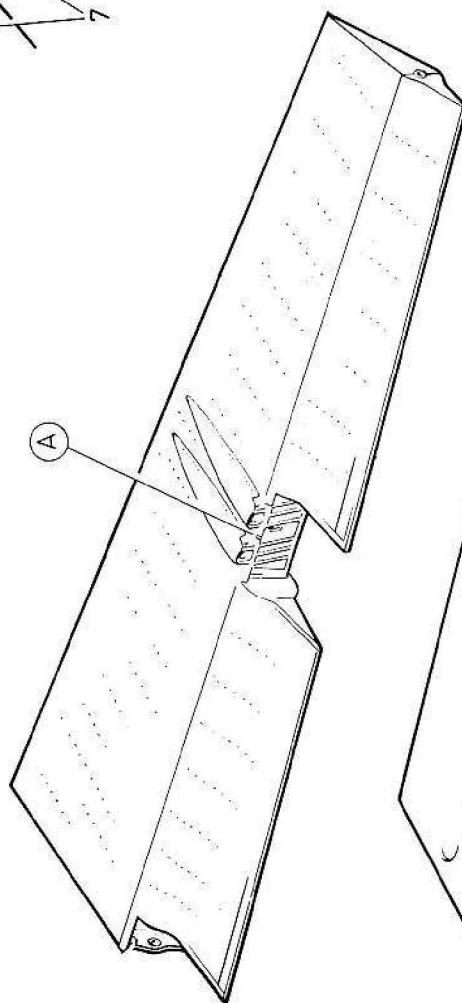
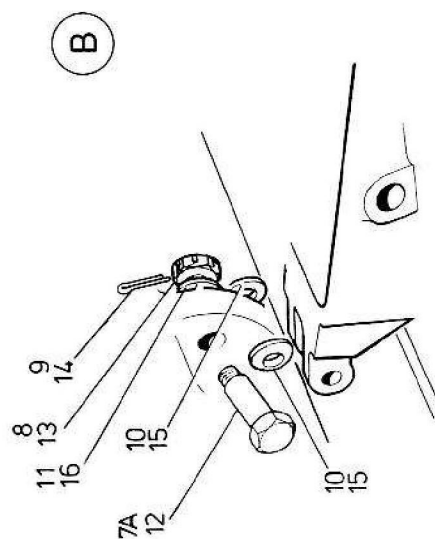
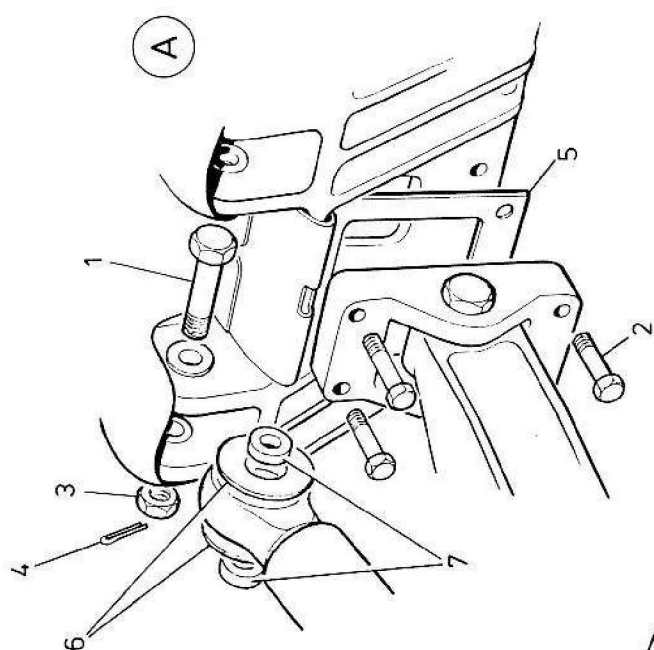

INBOARD FLAP  
OTHERS SIMILAR

