

PART I

MINOR REPAIRS

The repairs described in this Part are limited in scope because they have been devised with a view to avoiding, as far as possible, the use of non-portable special tools, jigs, or other equipment which it is not practicable to provide as standard Unit equipment. Repairs which are beyond the scope of this Part will be described in the Repair Leaflets in Part 2 of this Volume.

In this Part, the prohibition of repairs in certain areas or the absence of a suitable repair instruction for any damage sustained, is not to be taken as meaning that the component is beyond repair. Reference should be made to Part 2 where a repair leaflet covering major damage may be found. In the absence of any instructions and when the appropriate specialist officer considers that repair is possible, the component is to be classified as "repairable" and disposed of through the normal equipment procedure.

LIST OF CHAPTERS

Note.—A list of contents appears at the beginning of each chapter

- 1 General information and standard repairs
- 2 Power plant structure
- 3 Systems
- 4 Fuselage
- 5 Alighting gear
- 6 Main planes
- 7 Tail plane and fins
- 8 Elevators and rudders
- 9 Miscellaneous repairs

RESTRICTED

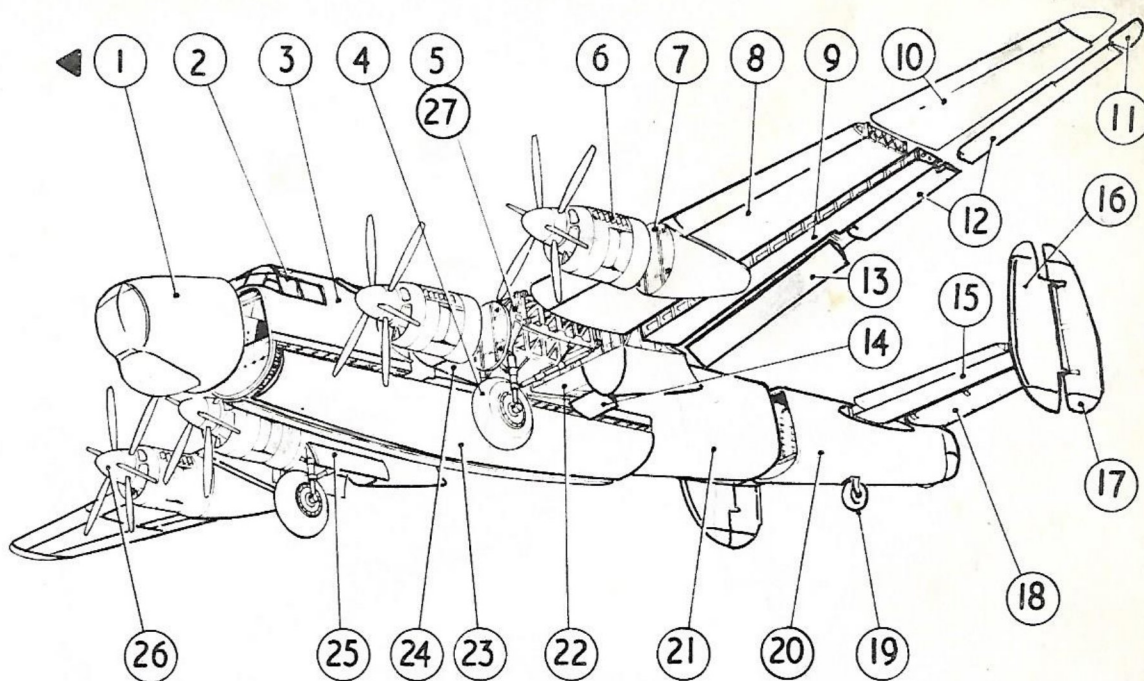

Item No.	Component	Chap. Ref.	Item No.	Component	Chap. Ref.
1	Fuselage - nose section	4	15	Tail plane	7
2	Canopy	4	16	Fin	7
3	Fuselage - front centre section	4	17	Rudder	8
4	Main wheel unit	5	18	Elevator	8
5	Undercarriage beam	5	19	Tail wheel unit	5
6	Power plant	2	20	Fuselage - rear section	4
7	Power plant sub-frame, outboard	2	21	Fuselage - rear centre section	4
8	Main plane - intermediate plane	6	22	Main plane - centre section - trailing edge	6
9	Main plane - intermediate plane - trailing edge	6	23	Bomb doors	4
10	Main plane - outer plane	6	24	Centre section - Fuselage - Main plane	6
11	Main plane - tip	6	25	Undercarriage doors	2
12	Aileron	6	26	Propellers and spinners	2
13	Flap, outboard	6	27	Power plant sub-frame, inboard	2
14	Flap, inboard	6			

INTRODUCTION Mk.1

Detailed diagrams of the components indicated in the above exploded view of the aircraft will be found in the chapters referenced in the key. Where necessary, these diagrams are coloured to indicate structure classification (Chap.1, para.2).

The standard repairs given in Chap.1 apply to all common forms of structure throughout the aircraft; for example, damage to any part of the skin plating may be repaired by the methods given in the relevant illustrations in Chap.1. Repairs for specific parts of the

airframe structure are given in the relevant chapters (List of Chapters).

A.P.101A-0600-6 (Standard Repairs for Airframes) gives details of standard repair procedure applicable to all aircraft and references to associated publications.

In A.P.4267A, Vol.1, Sect.4, Chap.3 and Sect.5, will be found illustrations of the various detachable panels which are provided to facilitate access to the interior of the aircraft.

RESTRICTED

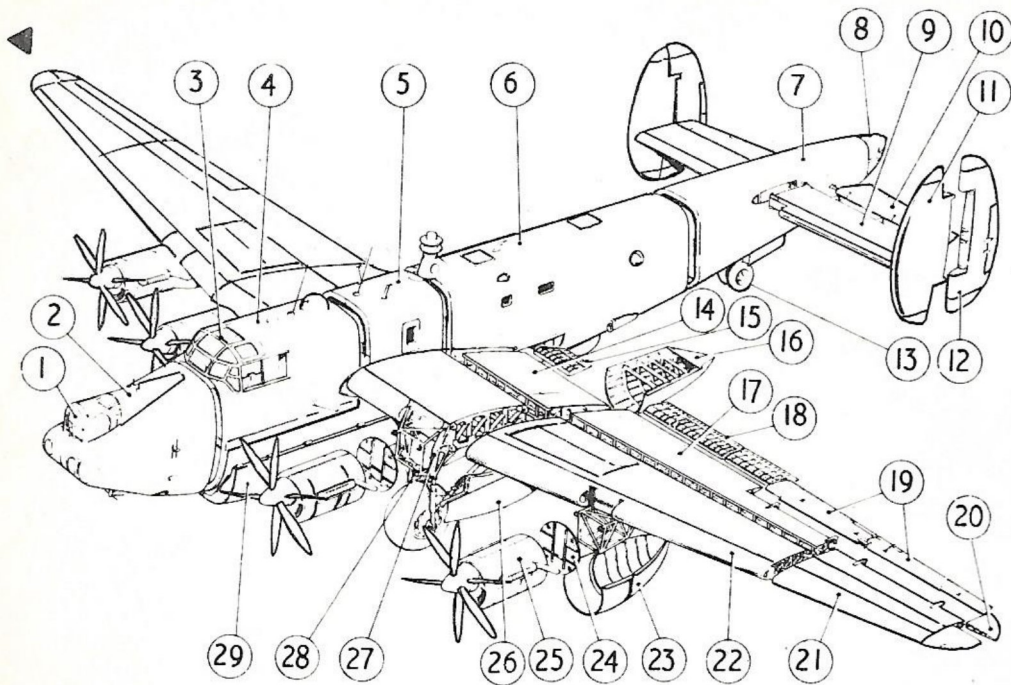

Item No.	Component	Chap. Ref.	Item No.	Component	Chap. Ref.
1	Gunner's canopy	4	16	Nacelles - inboard	2
2	Fuselage - nose section	4	17	Main plane - intermediate plane - trailing edge	6
3	Canopy	4	18	Flap - outboard	6
4	Fuselage - front centre section	4	19	Aileron	6
5	Centre section - Fuselage - Main plane	6	20	Main plane - tip	6
6	Fuselage - rear centre section	4	21	Main plane - outer plane	6
7	Fuselage - rear section	4	22	Main plane - intermediate plane	6
8	Rear fairing	4	23	Nacelles - outboard	2
9	Tail plane	7	24	Power plant sub-frame, outboard and firewall	2
10	Elevator	8	25	Power plant	2
11	Fin	7	26	Undercarriage doors	2
12	Rudder	8	27	Undercarriage beam	5
13	Tail wheel unit	5	28	Main wheel unit	5
14	Main plane - centre section - trailing edge	6	29	Bomb doors	4
15	Flap - inboard	6			

INTRODUCTION Mk.2

Detailed diagrams of the components indicated in the above exploded view of the aircraft will be found in the chapters referenced in the key. Where necessary, these diagrams are coloured to indicate structure classification (Chap.1, para.2).

The standard repairs given in Chap.1 apply to all common forms of structure throughout the aircraft; for example, damage to any part of the skin plating may be repaired by the methods given in the relevant illustrations in Chap.1. Repairs for specific parts of the

airframe structure are given in the relevant chapters (List of Chapters).

A.P.101A-0600-6 (Standard Repairs for Airframes) gives details of standard repair procedure applicable to all aircraft and references to associated publications.

In A.P.101B-1702-1B1, Sect.2, Chap.4 will be found illustrations of the various detachable panels which are provided to facilitate access to the interior of the aircraft.

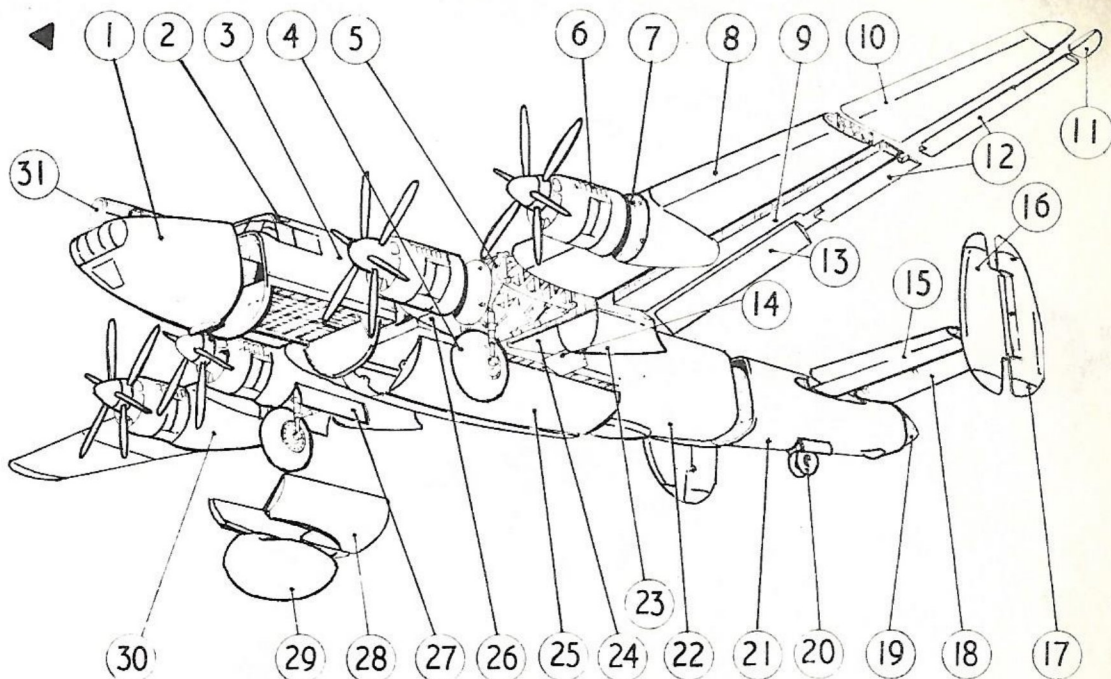

Item No.	Component	Chap. Ref.	Item No.	Component	Chap. Ref.
1	Fuselage - nose section	4	16	Fin	7
2	Canopy	4	17	Rudder	8
3	Fuselage - front centre section	4	18	Elevator	8
4	Main wheel unit	5	19	Rear fairing	4
5	Undercarriage beam	5	20	Tail wheel unit	5
6	Power plant	2	21	Fuselage - rear section	4
7	Power plant sub-frame, outboard and firewall	2	22	Fuselage - rear centre section	4
8	Main plane - intermediate plane	6	23	Nacelles - inboard	2
9	Main plane - intermediate plane - trailing edge	6	24	Main plane - centre section - trailing edge	6
10	Main plane - outer plane	6	25	Bomb doors	4
11	Main plane - tip	6	26	Centre section - Fuselage - Main plane	6
12	Aileron	6	27	Undercarriage doors	2
13	Flap, outboard	6	28	Radar compartment doors	4
14	Flap, inboard	6	29	Radome	1
15	Tail plane	7	30	Nacelles - outboard	2
			31	Gunner's canopy	4

INTRODUCTION AEW Mk.2

Detailed diagrams of the components indicated in the above exploded view of the aircraft will be found in the chapters referenced in the key. Where necessary, these diagrams are coloured to indicate structure classifications (Chap.1, para.2).

The standard repairs given in Chap.1 apply to all common forms of structure throughout the aircraft; for example, damage to any part of the skin plating may be repaired by the methods given in the relevant illustrations in Chap.1. Repairs for specific parts of the

airframe structure are given in the relevant chapters (List of Chapters).

A.P.101A-0600-6 (Standard Repairs for Airframes) gives details of standard repair procedure applicable to all aircraft and reference to associated publications.

In A.P.101B-1702-1B1, Sect.2, Chap.4, will be found illustrations of the various detachable panels which are provided to facilitate access to the interior of the aircraft. ►

This file was downloaded
from the RTFM Library.
Link: www.scottbouch.com/rtfm
Please see site for usage terms,
and more aircraft documents.

