

## TAIL UNIT

## TAIL PARACHUTE

Issued with A.L. No. 13

REF. No.	PART NUMBER	DESCRIPTION	No. OFF	MATL. SPEC.	CL. OF ST.	PLATE No.
					M.R. L.M.	
		1 2 3 4 5				
<b>PARACHUTE ASSY, TAIL, INSTALLATION</b> (1848/1A and 1A/UN) Spares for:—						
—	1848/73	ANGLE .....	1	—	MR	QC.1
—	1848/141	BRACKET, front support .....	1	—	MR	QC.1
Attachment parts for 1848/141:—						
28D/13132	AS.3297-1C	Bolt .....	4	—	C	—
28DU/9480269	A.173-1D	Bolt .....	4	—	C	—
28M/10288	AGS.2001-C1	Nut .....	4	—	C	—
6956	FOS.40/4	Nut .....	4	—	MR/C	—
—	1348/91ND	BUTTSTRAP, port .....	1	—	MR	QC.1
—	1348/92ND	BUTTSTRAP, starboard .....	1	—	MR	QC.1
—	1848/29A/1	CHANNEL assy (Mod. 574) .....	1	—	MR	QC.1
—	1848/53	CHANNEL, trailing edge .....	1	—	MR	QC.1
—	1848/71	DIAPHRAGM .....	1	—	MR	QC.1
2475	1848/31A	DOOR assy, side, port (Pre-mod. 525) .....	1	—	MR/B	QC.1
Spares for:—						
28FP/552	Oddie 217	STUD .....	1	—	C	QC.1
28FP/1004893	Oddie 214	WASHER .....	1	—	C	QC.1
2476	1848/32A	DOOR assy, side, starboard (Pre-mod. 525) .....	1	—	MR/C	QC.1
Spares for:—						
28FP/1185	Oddie 217	STUD .....	1	—	C	—
28FP/1004893	Oddie 214	WASHER .....	1	—	C	—
DOORS and links, sub-assy (1848/183AND and 183AND/UN) Spares for:—						
—	1848/227ND	ANGLE .....	1	—	MR	QC.1
—	Dzus GF4-150	BUSH, spun .....	2	—	C	—
28FP/9993392	Oddie 212	CLIP, fastener (Mod. 574) .....	2	—	C	—
1443635	1848/309	DIAPHRAGM assy (Mod. 574) .....	1	—	MR/C	—
DOORS assy, parachute (1848/271A/1) .....						
Spares for:—						
1497210	1848/239AND/2	DOOR assy, port (Mod. 705) .....	1	—	B	QC.1
1497211	1848/241AND/2	DOOR assy, starboard (Mod. 705) .....	1	—	B	QC.1
—	1848/271BND	PLATE, reinforcing (Mod. 705) .....	1	10 s.w.g. S.510	LM	QC.1
—	1848/271CND	PLATE, reinforcing (Mod. 705) .....	1	10 s.w.g. S.510	LM	QC.1
1497214	1848/271FND	RUBBER, "P", section (Mod. 705) .....	2	—	C	QC.1
1497212	1848/271DND	STRIP, capping (Mod. 705) .....	1	—	C	QC.1
1497213	1848/271END	STRIP, capping (Mod. 705) .....	1	—	C	QC.1
Attachment parts for 1848/271A:—						
2479	1848/79	Bolt, bottom hinge .....	1	—	MR/C	QC.1
28M/9419539	A.103-D5	Nut .....	1	—	C	—
28P/1007741	SP.9-C8	Pin, split .....	2	—	C	—
28P/12466	SP.4Z-D3	Pin, stainless .....	1	—	C	—
28W/9419475	SP.15-C	Washer .....	1	—	C	—
28W/9457834	SP.124-D	Washer .....	1	—	C	—
28W/9419405	SP.15-E	Washer .....	1	—	C	—
28W/17427	SP.124-E	Washer .....	1	—	C	—

TAIL UNIT  
TAIL PARACHUTE

Issued with A.L. No. 13

REF. No.	PART NUMBER	DESCRIPTION	No. OFF	MATL. SPEC.	CL. OF ST.	PLATE No.
					M.R. L.M.	
		1 2 3 4 5				
2485	1848/49A	LINK assy, hinge .....	2	—	C	QC.1
		OR				
7623	1848/273A	LINK assy, hinge .....	2	—	MR/C	QC.1
		Attachment parts for 1848/273A:—				
4216	1848/237	Pin, hinge .....	1	—	MR/C	QC.1
28P/9143877	SP.9-C4	Pin, split .....	1	—	C	—
—	1848/235	Tube (Make from 5/16" diameter bar) .....	1	DTD.423	MR/LM	QC.1
2486	1848/51A	LINK assy, hinge .....	2	—	C	QC.1
		OR				
7624	1848/275A	LINK assy, hinge .....	2	—	MR/C	QC.1
		Attachment parts for 1848/275A:—				
4216	1848/237	Pin, hinge .....	1	—	MR/C	QC.1
28P/1202460	SP.9-C4	Pin, split .....	1	—	C	—
—	1848/235	Tube .....	1	—	MR/LM	QC.1
6023	1848/69	STOP, hinge link .....	1	—	MR/C	QC.1
28W/9419474	SP.15-B	WASHER .....	2	—	C	—
		EJECTOR assy, tail parachute (1348/719A and 719A/UN) (Pre-mod. 574)				
		Spares for:—				
—	1348/727A	ANGLE assy, port .....	1	—	MR	QC.1
—	1348/727A/UN	ANGLE assy, port .....	1	—	MR	—
—	1348/728A	ANGLE assy, starboard .....	1	—	MR	QC.1
—	1348/728A/UN	ANGLE assy, starboard .....	1	—	MR	—
		Spares for:—				
28M/9435067	AGS.2008-C1	NUT, anchor .....	4	—	C	—
6963	FOS.41/4	NUT, anchor .....	4	—	MR/C	—
2480	1348/723AND	DIAPHRAGM assy (Pre-mod. 574) .....	1	—	MR/B	QC.1
		Attachment parts for 1348/723AND:—				
28D/9436920	A.25-1C	Bolt .....	4	—	C	—
28DU/9419565	A.102-1D	Bolt .....	4	—	C	—
28W/9419402	SP.13-C	Washer .....	4	—	C	—
28W/1010519	SP.122-D	Washer .....	4	—	C	—
28M/9435067	AGS.2008-C1	NUT .....	4	—	C	—
6963	FOS.41/4	NUT .....	4	—	MR/C	—
2481	1348/739AND	PAD assy (Pre-mod. 574) .....	1	—	MR/C	QC.1
8372	1348/739AND/UN	PAD assy (Pre-mod. 674) .....	1	—	MR/C	—
		Attachment parts for 1348/739AND and 739AND/UN:—				
28S/9419431	AS.2996-5C	Screw .....	1	—	C	—
28S/1201336	A.204-16D	Screw .....	1	—	C	—
28W/9419404	SP.16-C	Washer .....	1	—	C	—
28W/17551	SP.125-D	Washer .....	1	—	C	—
2482	1348/379	SPRING .....	1	—	MR/C	QC.1
2483	1348/721AND	TUBE assy (Pre-mod. 574) .....	1	—	MR/C	QC.1
8371	1348/721AND/UN	TUBE assy (Pre-mod. 574) .....	1	—	MR/C	—

TAIL UNIT  
TAIL PARACHUTE

Issued with A.L. No. 15

REF. No.	PART NUMBER	DESCRIPTION	No. OFF	MATL. SPEC.	CL. OF ST.	PLATE No.
					M.R. L.M.	
		1	2	3	4	5
2484	1848/67	END, eye, slotted (Pre-mod. 574)	1	—	MR/C	QC.1
1443642	1848/303	END, eye, slotted (Mod. 574)	1	—	MR/C	—
—	1848/55	FITTINGS, hinge	1	—	MR	QC.1
‡ 6011	1848/75A	HINGE, top	1	—	MR/C	QC.1
1443643	1848/305	NUT, special (Mod. 574)	1	—	C	—
—	1812/249	PACKING	2	—	MR	QC.1
—	1848/165	PACKING, trailing edge	1	—	MR	QC.1
1443638	1848/293A	PAD assy (Mod. 574)	1	—	C	—
		PARACHUTE assy, brake (1348/787A)	1	—	—	QC.1
		Spares for:—				
15D/714	C.Q. Parachute MRI-GQ-345	PACK, brake parachute	1	—	A	—
		Attachment parts for 15D/714:—				
2861	1348/779	Pin, shear	1	—	MR/C	QC.1
28P/1007739	SP.9-E5	Pin, split	2	—	C	—
2862	1348/785A	ROD assy, link	1	—	MR/C	QC.1
2488	1848/65	PIN, release (Pre-mod. 574)	1	—	MR/C	QC.1
1443641	1848/307	PIN, release (Mod. 574)	1	—	MR/C	—
—	1848/27ND	SKIN, fairing, port	1	—	MR	QC.1
—	1848/28ND	SKIN, fairing, starboard	1	—	MR	QC.1
2490	1848/61A	SLEEVE, assy, inner	1	—	MR/C	QC.1
2491	1848/59	SLEEVE, outer	1	—	MR/C	QC.1
1443639	1848/289A	SLEEVE assy (Mod. 574)	1	—	B	—
		Spares for:—				
1443640	1848/291	CLEAT	4	—	C	—
2492	1848/57	SPRING, return	1	—	MR/C	QC.1
2493	1848/63	SPRING, return	1	—	MR/C	QC.1
—	1848/233	STRIP, closing	1	—	MR	QC.1
1443636	1848/315A	TUBE assy (Mod. 574)	1	—	MR/C	—
1443637	1848/315A/UN	TUBE assy (Mod. 574)	1	—	MR/C	—
1443634	1848/23A/1	UNIT, release (Mod. 574)	1	—	MR/B	QC.1
		Spares for:—				
—	1848/249A	HOOK assy, release	1	—	MR	QC.1
—	1848/331A	LEVER assy, release	1	—	MR	QC.1
28P/1207866	SP.4Y-A6	PIN, clevis	1	—	C	—
28P/9429619	SP.9-C5	PIN, split	1	—	C	—
—	1848/15A	PLATE, side, port	1	—	MR	QC.1
—	1848/16A	PLATE, side, starboard	1	—	MR	QC.1
2496	1348/127	ROD, spring	1	—	MR/C	QC.1
		Attachment parts for 1348/127:—				
28P/1207868	SP.4-A8	Pin	1	—	C	—
28P/9429619	SP.9-C5	Pin, split	1	—	C	—
28W/17542	SP.124-B	Washer	1	—	C	—
2497	1348/129	SPRING	1	—	MR/C	QC.1
		Attachment parts for 1348/129:—				
2495	1348/345	Base, spring	2	—	MR/C	QC.1
28P/9429619	SP.9-C5	Pin, split	1	—	C	—
—	1348/141	TUBE	1	—	MR	QC.1
—	1248/91	TUBE, distance	3	—	MR	QC.1
—	1348/657	WASHER	1	—	MR	QC.1
28W/17542	SP.124-B	WASHER	1	—	C	—

RESTRICTED

REF. No.	PART NUMBER	DESCRIPTION					No. OFF	MATL. SPEC.	CL. OF ST.	PLATE No.
		1	2	3	4	5			M.R. L.M.	

RESTRICTED

PARACHUTE, INSTALLATION  
(REF DRG 1848/1A)

QCI

TAIL PARACHUTE

QCI

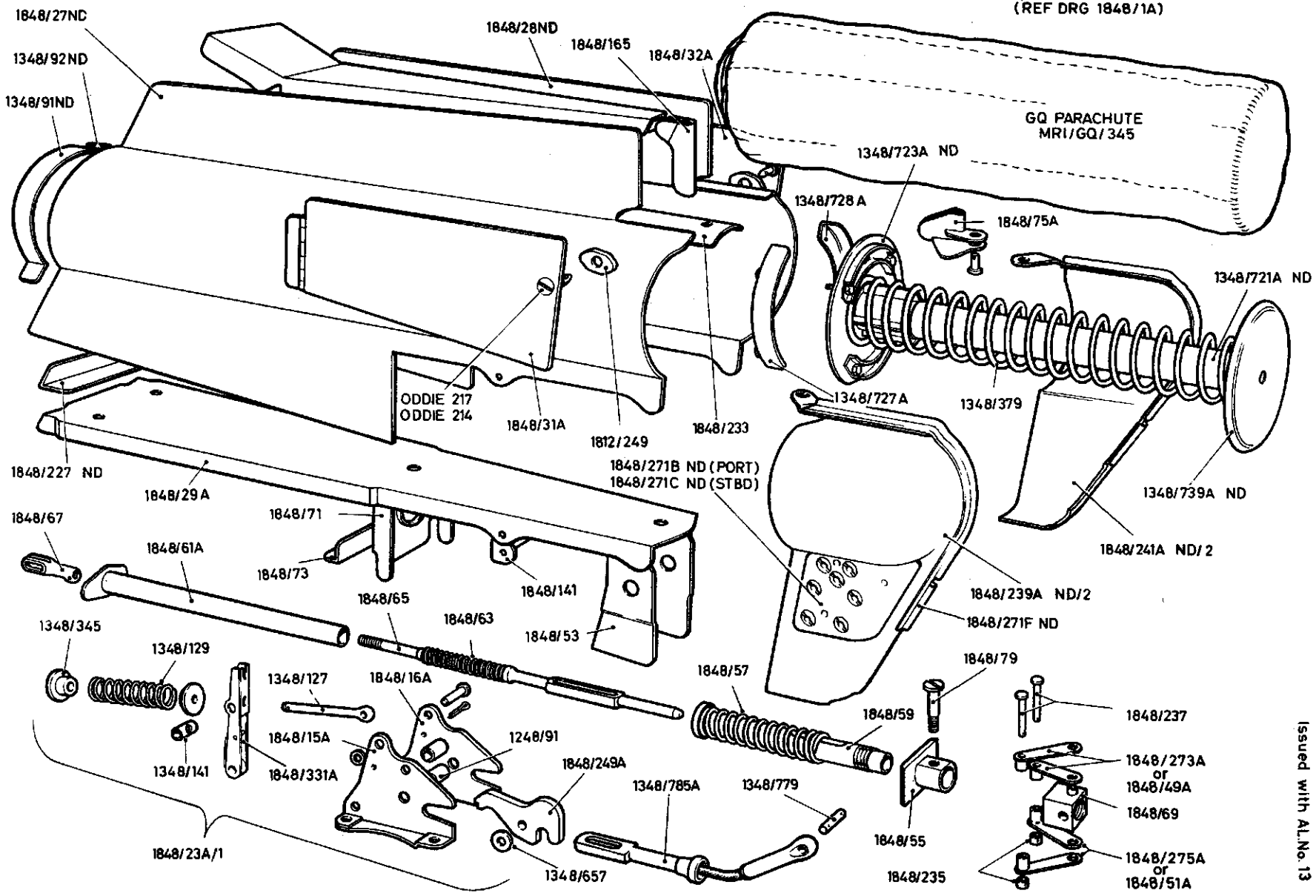

RESTRICTED

Gnat. T. Mk1

RESTRICTED

Plate QCI  
Issued with A.L.No. 13

This file was downloaded  
from the RTFM Library.

Link: [www.scottbouch.com/rtfm](http://www.scottbouch.com/rtfm)

Please see site for usage terms,  
and more aircraft documents.

