

ILLUSTRATED PARTS CATALOGUE (-3)

CONTENTS

Memorandum of instructions

Index of part numbers

Detailed parts list

MEMORANDUM OF INSTRUCTIONSContents

1 Any unsatisfactory feature found in this publication is to be reported on MoD Form 765 in accordance with the appropriate service procedure:

Naval Aircraft Maintenance Manual (RN)

EMER - Aircraft A040 (Army)

AP 100B-01 Order 0504 (RAF)

Demands

2 Requirements for demands are:

2.1 The demand must quote the appropriate Reference Number for each item. Unreferenced parts are not normally provisioned as spares and demands for such items must quote the maker's Part Number and the name and type of equipment. The location of each part within the equipment should be clearly indicated.

2.2 Demands are to be prepared in accordance with the procedure laid down in AP 830 Volume 1 or BR4.

Local manufacture

3 Parts annotated 'LM' are to be manufactured from local resources. If the manufacture of such items is beyond the capacity of the Unit the demand is to be endorsed 'Unable to manufacture locally'.

Major repair

4 'MR' indicates that an item is required for major repair purposes only and will not normally be held in store by Units other than those authorised to undertake major repair of the equipment.

Units per assembly

5 The number quoted is the quantity required per next higher assembly in the position shown except 'attaching parts' which quote the quantity required to attach one item. The letters 'AR' in the units per assembly column indicates that the quantity is 'as required'. Where applicable, the quantity normally fitted is shown as a nominal figure (eg Nom 3). Where an item is listed for reference purposes only, the letters 'RF' are quoted.

Classification of equipment

6 The Class of Store is indicated by a single letter as laid down in AP830 Volume 1 or BR4.

► Fitting code (FC)

7 The fitting code is indicated by one of the following letters and is only quoted against parts which are not directly interchangeable.

V	Open up holes on assembly	Y	Drill or drill and tap on assembly
W	Partially assembled	Z	Trim on assembly
X	Ream or machine on assembly		

Obsolescent stock

8 An asterisk in the Part Number column indicates that no further purchases of the item will be made but the part is to be used until stocks are exhausted.

Modifications

9 When items are affected by a modification the 'Mod No' is quoted in the Description column. Modifications incorporated in the Catalogue are listed in the Modification Record.

Amendments

10 Amendments to the Catalogue will be published as and when necessary. They will be numbered consecutively and the Amendment Record is to be completed for each Amendment embodied. A summary of Amendments distributed is published in the CS(PS)4 Newsletter.

CATALOGUE ARRANGEMENT

11 This catalogue is arranged in three main sections, the sections being:

- Introduction
- Index of Part Numbers
- Detailed Parts List

Introduction

12 The introduction gives a brief description of the catalogue, the procedures used in the compilation and a guide to the method of use.

Index of Part Numbers

13 The index of part numbers gives all numbers listed in the detailed parts list, their reference number and respective chapter, figure and index number. All parts are listed in strict alpha-numeric sequence for ease of location. ◀

► Detailed Parts List

14 The detailed parts list is arranged by subjects dealing with an individual system or major installation. The subject is further sub-divided into main assemblies contained in the detailed parts list. An illustration of each assembly and sub-assembly, exploded as necessary to show the component parts, is provided to illustrate each part that is supplied as a spare. Each illustration is assigned a figure number within its own subject and all parts illustrated are given an index number which corresponds to the index number listed in the related column of the detailed parts listing.

15 The assembly order of the detailed parts list is maintained by a multi-indentation system where the relationship of main assemblies, sub-assemblies and detail parts is indicated by the degree of indentation of the description of the part. Attaching parts are listed immediately following the parts they attach and are shown outside the indentation columns to distinguish them from detail parts of the assembly or installation. The basic format for this layout is as follows:

```

1 2 3 4 5 6
Main assembly or installation
    Attaching parts for main assembly or installation
. Detail parts of main assembly or installation
. Assembly
    Attaching parts for assembly
. . Detail parts of assembly
. . Sub-assembly
    Attaching parts for sub-assembly
. . . Detail parts of sub-assembly
. . . Sub-sub-assembly
    Attaching parts for sub-sub-assembly
. . . . Detail parts of sub-sub-assembly

```

HOW TO USE THE ILLUSTRATED PARTS CATALOGUE

When the part number is known

16 Locate the part number in the index of part numbers and note the chapter, figure and index number. Refer to the noted position in the detailed parts list for information regarding the part.

When the part number is not known

17 Identify the applicable section using the contents list and note the chapter number. Identify the applicable figure within the noted chapter, locate the part on the illustration and note the figure and index number. Refer to the detailed parts list for information regarding the part. ◀

INDEX OF PART NUMBERS

Part Number	DMC	Reference Number	Chap	Fig-Index	C of S or LM	FC
CX122263	37F	5306-99-1367700		1-10	C	
CX133743		2995-99-4381343		1-4	P	
CX134575		5310-99-4381470		1-8	C	
CX136391		5330-99-4381381		1-5	C	
CX136565		5310-99-4381472		1-9	C	
CX137360				1-6+	P	
CX137361				1-2+	P	
CX137362		2995-99-4381282		1-1+	P	
CX138472		5365-99-4381434		1-7	C	
CX167942		2995-99-4381308		1-3	P	

DETAILED PARTS LIST

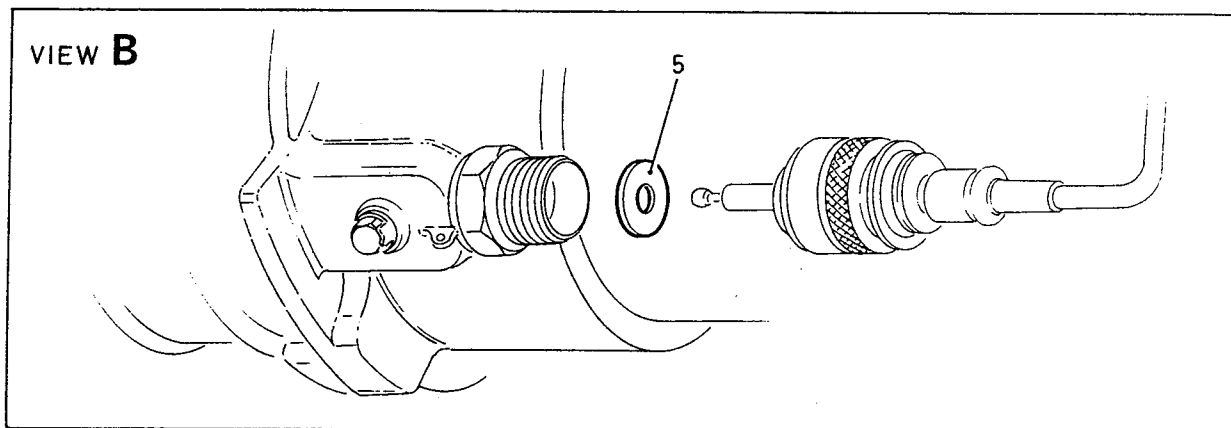
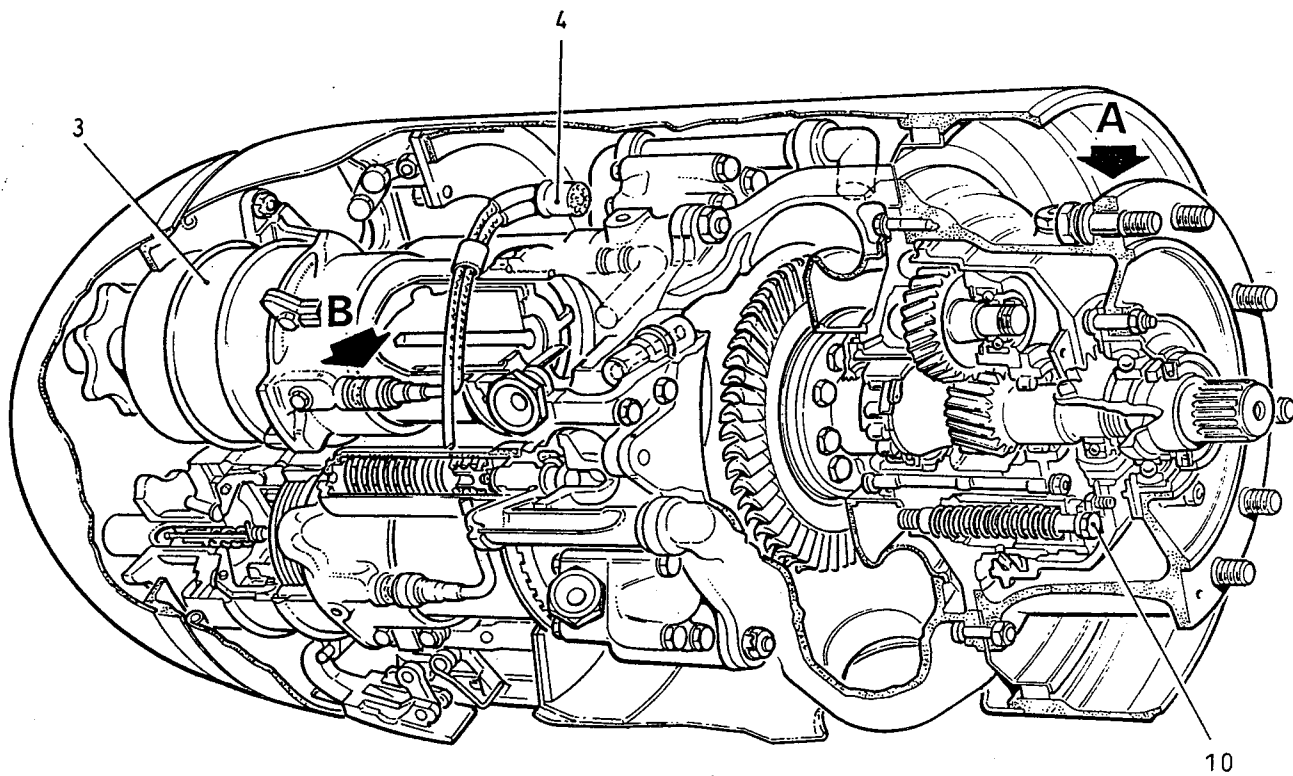
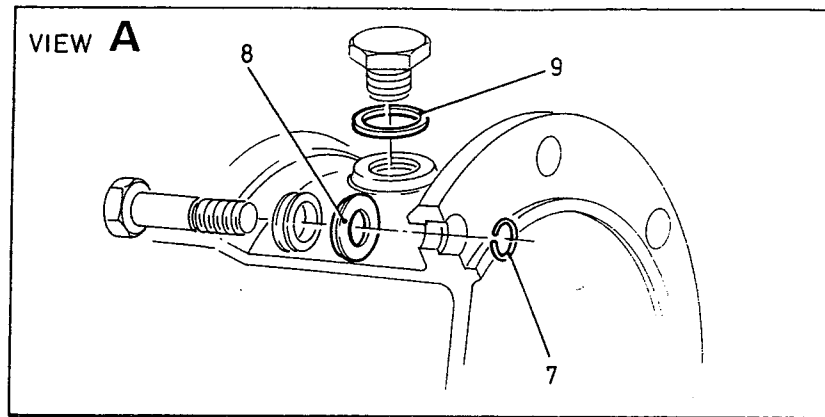

Figure 1 Triple breech turbo starter

DETAILED PARTS LIST

STARTER, TURBO, TRIPLE BREECH

Fig - Index No	Part Number	Description 123456	NSCM	Usage Code	Units per Assy
1-					
1+	CX137362	TURBO-STARTER & BREECH MECHANISM TBS720 Mk 2	K0642		REF
2+	CX137361	.TURBO-STARTER, BREECH END, MAIN ASSEMBLY	K0642		REF
3	CX167942	..CAP, BREECH ASSY	K0642		3
4	CX133743	..LEADS & FITTINGS - FIRING ASSY	K0642		1
5	CX136391	..RING for housing adapter - firing lead connection	K0642		3
6+	CX137360	.TURBO-STARTER, STARTER END, MAIN ASSEMBLY	K0642		REF
7	CX138472	..RING, spring for set screw	K0642		8
8	CX134575	..WASHER, for set screws securing gear casing to bearing housing	K0642		8
9	CX136565	..WASHER, joint for filler plug	K0642		1
10	CX122263	..SCREW, set, for return mechanism	K0642		3

+ Item not illustrated

This file was downloaded
from the RTFM Library.

Link: www.scottbouch.com/rtfm

Please see site for usage terms,
and more aircraft documents.

