

CHAP 1 AIRFRAME SP 28B AL 4 SHEET 1 OF 3	SERVICING PROCEDURE T55	BAC F53 & T55 (SA) 5A3A Section 1 2nd Edition
Canopy Internal and External Jettison Cables - Adjustment	AFSC 42252 43151 42272 43171	TIME EST
Safety and Servicing Notes are to be complied with throughout the work detailed on this card.		
SPECIAL TOOLS AND EQUIPMENT  Nil.  <u>42252/43151</u>  NOTE: Items 1 and 2 are only applicable when the internal jettison cables require adjustment.		ASSOCIATED PROCEDURES  SP 1B(W) 2B(W) 5B(AF) 6B(AF) 132B(AF) 133(AF)
1. PREPARATION  1.1 Canopy. Remove (SP 5B(AF)).  <u>42252</u>		
2. PREPARATION  2.1 Ejection seats. Remove (SP 1B(W)).		
3. ADJUSTMENT OF EXTERNAL CABLE  NOTE: To obviate the possibility of jettison cables becoming kinked during adjustment or resetting they must be kept taut, and the affected handle restrained throughout the resetting operations.		
3.1 External cable at jettison cross-shaft (See Fig.1). Disconnect.		
3.2 Access panel 161P. Remove.		
3.3 Turnbuckle adjuster. Remove locking wire and adjust to provide some slack in cable.		
3.4 External cable at jettison cross-shaft. (i) Adjust until connecting pin is at lower end of slot. (ii) Tighten locknut. (iii) Fit washer and new split pin to connecting pin.		
WARNING: THE THREADED PORTION OF THE ADJUSTER MUST PROTRUDE ABOVE THE ADJUSTER BLOCK NUT MORE THAN 0.20in AND NOT LESS THAN TWO THREADS (SEE FIG.1).		
3.5 Access panel 161P. (i) Adjust turnbuckle to take up slack in cable.		
		Continued Overleaf
SERVICING PROCEDURE INSPECTION STAGES DO NOT EXCLUDE ADDITIONAL INSPECTION STAGES INCORPORATED AS NECESSARY IN MAINTENANCE CERTIFICATION DOCUMENTS		

CHAP 1 AIRFRAME	SERVICING PROCEDURE	BAC F53 & T55 (SA)
SP 28B AL 4	T55	5A3A Section 1
SHEET 2 OF 3		2nd Edition

Safety and Servicing Notes are to be complied with throughout the work detailed on this card.

42252

3. ADJUSTMENT OF EXTERNAL CABLE (contd)

- 3.5 Access panel 161P )contd). (ii) Check turnbuckle for safety.  
(iii) Tighten locknuts and wirelock adjuster.

4. ADJUSTMENT OF INTERNAL CABLE

- 4.1 Internal cable at jettison cross-shaft (See Fig.1). (i) Disconnect.  
(ii) Adjust until connecting pin is at lower end of slot.  
(iii) Tighten locknut.  
(iv) Fit washer and new split pin to connecting pin.

NOTE 1: When carrying out the latter operations it may be necessary to take up some adjustment on the conduit adjuster at the handle end.

It is essential that the adapter is in safety and the conduit ends correctly located in the associated stop-brackets. Do not twist the handle.

NOTE 2: The connection of the internal and external jettison cables to the jettison cross-shaft must be internal cable to STBD and external cable to PORT.

5. TESTING

- 5.1 Internal and External Jettison cables. Test (SP 132B (AF)).

42272 (INSPECTOR)

6. INSPECTION STAGE

- 6.1 Cable assembly. Independent check (SP 133 (AF)).

42252

7. COMPLETION

- 7.1 Ejection seat. Refit (SP 2B(W)).  
7.2 Canopy. Refit (SP 6B(AF)).

NOTE: All wirelocking must be 22 SWG stainless steel wire.

Continued

SERVICING PROCEDURE INSPECTION STAGES DO NOT EXCLUDE ADDITIONAL INSPECTION STAGES INCORPORATED AS NECESSARY IN MAINTENANCE CERTIFICATION DOCUMENTS

Safety and Servicing Notes are to be complied with throughout the work detailed on this card.

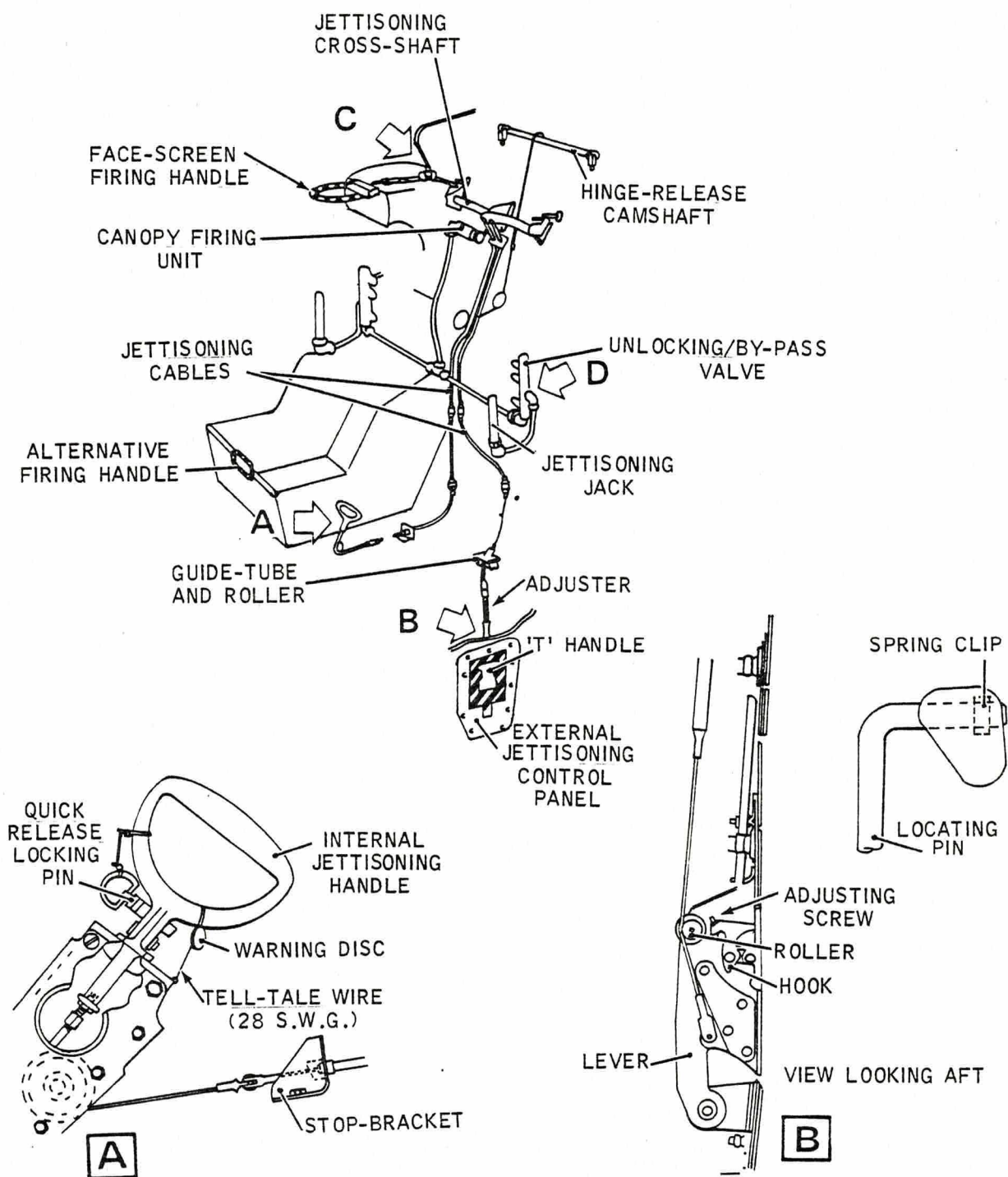

JETTISONING MECHANISM  
FIGURE 1

SERVICING PROCEDURE INSPECTION STAGES DO NOT EXCLUDE ADDITIONAL INSPECTION STAGES INCORPORATED AS NECESSARY IN MAINTENANCE CERTIFICATION DOCUMENTS







This file was downloaded  
from the RTFM Library.

Link: [www.scottbouch.com/rtfm](http://www.scottbouch.com/rtfm)

Please see site for usage terms,  
and more aircraft documents.