

CHAP 1 AIRFRAME SP 36 AL 8 SHEET 1 OF 5		SERVICING PROCEDURE F53 T55		BAC F53 & T55 (SA) 5A3A Section 1 2nd Edition		
Main Undercarriage Top And Bottom Toggles - Replacement				AFSC 42152 43151 42172 43171		TIME EST
Safety and Servicing Notes are to be complied with throughout the work detailed on this card.						
SPECIAL TOOLS AND EQUIPMENT						ASSOCIATED PROCEDURES
Extractor tool (27Q/34895), (Part No. MT 1311).						SP 35 (AF) 106 (AF)
<div>43151</div>						
1. PREPARATION						
1.1 Aircraft.		(i)	Raise on jacks until all wheels are clear of ground.			
		(ii)	Trestle at Frame 59.			
<div>43151 / 42152</div>						
2. PREPARATION						
2.1 Centre toggle pin.		Remove.				
2.2 Top toggle (See Fig.1).		(i)	Remove split pin.			
		(ii)	Remove shackle pin complete with washer under head.			
		(iii)	Remove attachment pin (using extractor tool MT 1311).			
		(iv)	Remove top toggle.			
		(v)	Retain shims for possible use with serviced toggle.			
2.3 Bottom toggle (See Fig.1).		(i)	Remove split pin.			
		(ii)	Remove shackle pin.			
		(iii)	Remove attachment pin (using extractor tool MT 1311).			
		(iv)	Remove bottom toggle.			
		(v)	Retain spacer and shims for possible use with serviced toggle.			
3. REPLACEMENT						
3.1 Top toggle.		Fit sleeve bush (quantity 2) (27Q/35676 - Part No. 406737).				
3.2 Bottom toggle.		Fit sleeve bush (quantity 2) (27Q/35676 - Part No. 406737).				
						Continued Overleaf
SERVICING PROCEDURE INSPECTION STAGES DO NOT EXCLUDE ADDITIONAL INSPECTION STAGES INCORPORATED AS NECESSARY IN MAINTENANCE CERTIFICATION DOCUMENTS						

Safety and Servicing Notes are to be complied with throughout the work detailed on this card.

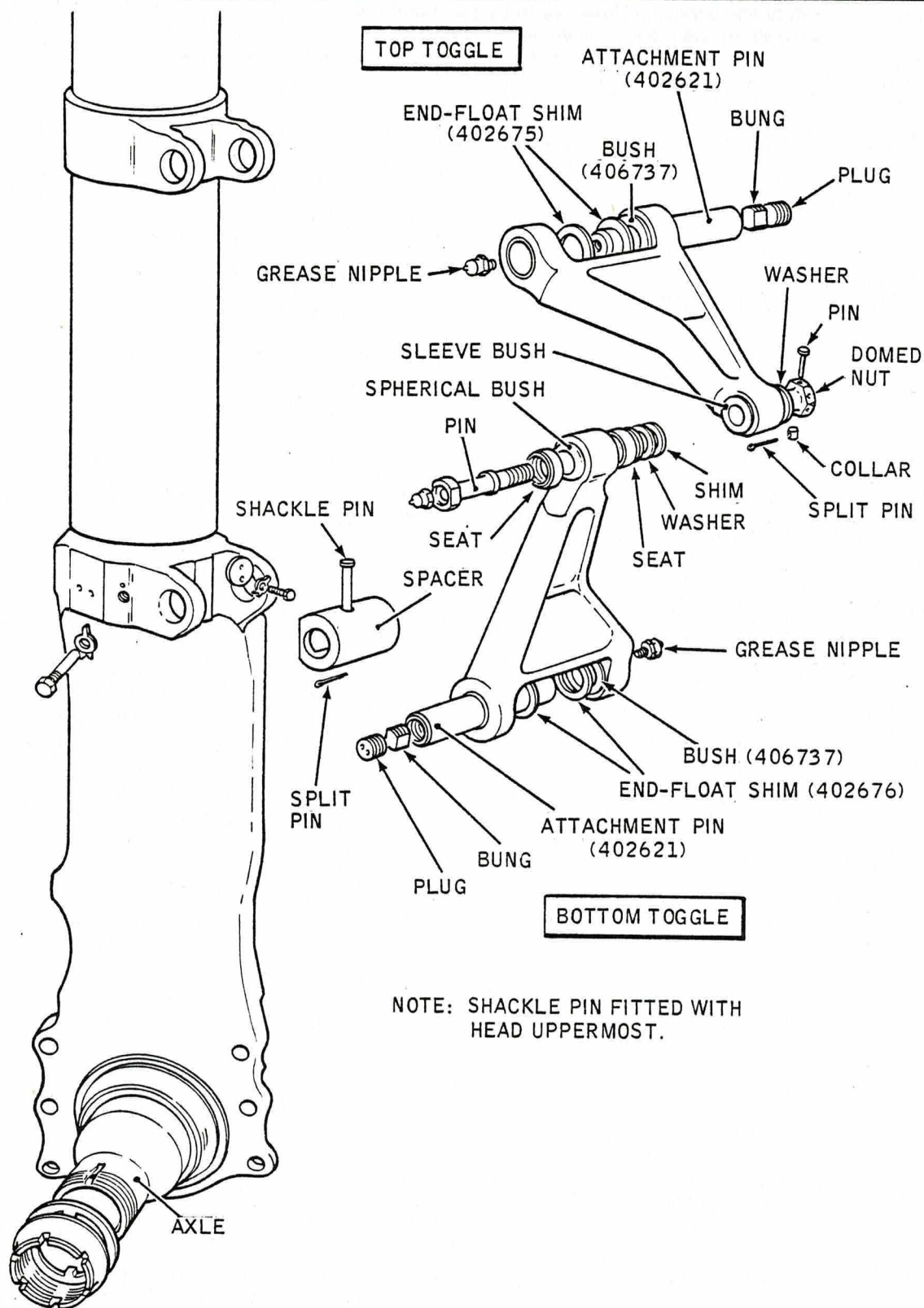

NOTE: SHACKLE PIN FITTED WITH HEAD UPPERMOST.

MAIN UNDERCARRIAGE - HALF-FORK AND TOGGLES
FIGURE 1

Continued

CHAP 1 AIRFRAME	SERVICING PROCEDURE	BAC F53 & T55 (SA)
SP 36 AL 4	F53 T55	5A3A Section 1
SHEET 3 OF 5		2nd Edition

Safety and Servicing Notes are to be complied with throughout the work detailed on this card.

43151 / 42152

4. FITTING

4.1 Top toggle (See Fig.1).

- (i) Position toggle, holding it to one side.
- (ii) Measure total end-float, halve the figure obtained, subtract 0.001 in.
- (iii) Manufacture two shims, each to the dimension obtained in (ii), to a tolerance of PLUS OR MINUS 0.0005 in.

NOTE: This will give an end-float on assembled toggle of between 0.001 in. and 0.003 in.

- (iv) Assemble to undercarriage fitting with shims manufactured in (iii).
- (v) Refit attachment pin, (grease nipple outboard), using special tool MT 1311.
- (vi) Refit shackle pin, with sufficient washers under head to prevent toggle fouling during its movement.
- (vii) Lock with split pin.
- (viii) Lubricate attachment pin (XG-287) (See Fig.2).

4.2 Bottom toggle (See Fig.1).

- (i) Calculate end-float and shimming as in Sub-Items 4.1 (i), (ii) & (iii) above.
- (ii) Assemble to undercarriage fitting with spacer and manufactured shims.
- (iii) Refit attachment pin (grease nipple inboard), using special tool MT 1311.
- (iv) Refit shackle pin.
- (v) Lock with split pin.
- (vi) Lubricate attachment pin (XG-287) (See Fig.2).

4.3 Centre toggle.

Assemble (SP 35(AF)).

4.4 Mainwheel.

Check wheel tracking. Servicing Manual Book 1, Sect.2, Chap.4, Fig.5 (Airframe Symmetry).

Continued Overleaf

SERVICING PROCEDURE INSPECTION STAGES DO NOT EXCLUDE ADDITIONAL INSPECTION STAGES INCORPORATED AS NECESSARY IN MAINTENANCE CERTIFICATION DOCUMENTS

CHAP. 1 AIRFRAME
S.P. 36 A.L. 4
SHEET 4 OF 5

SERVICING PROCEDURE
F53 T55

BAC F53 & T55 (SA)
5A3A Section 1
2nd Edition

Safety and Servicing Notes are to be complied with
throughout the work detailed on this card.

KEY TO LUBRICANTS

SYMBOL NOMENCLATURE



XG - 287

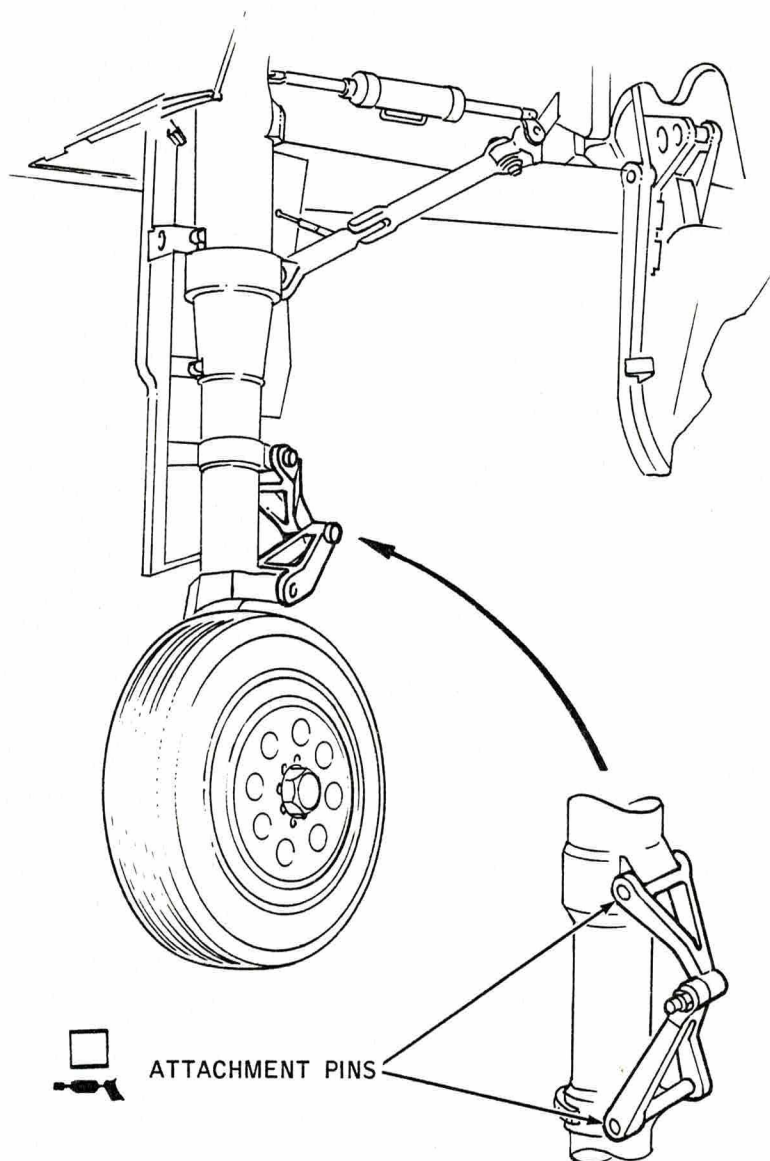

MAIN UNDERCARRIAGE LUBRICATION POINTS

FIGURE 2

Continued

SERVICING PROCEDURE INSPECTION STAGES DO NOT EXCLUDE ADDITIONAL INSPECTION STAGES
INCORPORATED AS NECESSARY IN MAINTENANCE CERTIFICATION DOCUMENTS

CHAP. 1	AIRFRAME	SERVICING PROCEDURE	BAC F53 & T55 (SA)
S.P. 36	A.L. 4	F53 T55	5A3A Section 1
SHEET 5	OF 5		2nd Edition

Safety and Servicing Notes are to be complied with throughout the work detailed on this card.

43151/42152

5. TESTING

5.1 Undercarriage. Test (SP 106 (AF)).

43171/42172 (INSPECTOR)

6. INSPECTION STAGE

6.1 Inspect installation. Independent check of:
 (i) Assembly and Locking.
 (ii) Function.

43151

7. COMPLETION

7.1 Aircraft. Lower off jacks and trestles.



This file was downloaded
from the RTFM Library.

Link: www.scottbouch.com/rtfm

Please see site for usage terms,
and more aircraft documents.

ENGINE
INHIBITED
DO NOT
TURN
PROP