

CHAP. 1 AIRFRAME	SERVICING PROCEDURE	BAC F53 & T55 (SA)	
S.P. 6A A.L. 8	F53	5A3A Section 1	
SHEET 1 OF 9		2nd Edition	
Canopy - Fitting		AFSC	TIME EST
Safety and Servicing Notes are to be complied with throughout the work detailed on this card.		43151	32851
		42252	43171
		53450	42272
		32850	42251
SPECIAL TOOLS AND EQUIPMENT			ASSOCIATED PROCEDURE
<p>Canopy sling (26DK/95263).</p> <p>Spring balance (1A/4707675).</p> <p>Multi purpose servicing hoist (4GC/4232366).</p> <p>Jib No.3. (4GC/4232396).</p> <p style="text-align: center;"><u>53450</u></p> <p>NOTE 1: If previous canopy was jettisoned by use of cartridge-operated firing unit ensure system has been refurbished in accordance with Repair Manual, Part 2, Repair Leaflet B1/4.</p> <p>NOTE 2: When fitting a new canopy correct clearance below the rim of windscreen arch and forward edge of canopy should be obtained by removal or fitment of shims beneath abutment pads.</p> <p style="text-align: center;"><u>43151/42252</u></p>			
1. PREPARATION			
1.1 Main battery. Ensure connected.			
1.2 Battery master switch. Ensure set to OFF.			
1.3 Canopy hinge release mechanism assembly (See Fig.1). Examine, components for fretting and corrosion. Replace as necessary.			
2. PULL-OFF CHECK			
2.1 Hinge arm bush mechanism (left and right) (See Fig.2).			
(i) Place hinge bush in profile of hinge arm.			
(ii) Rotate free pivoted hook to engage outer diameter of bush.			
(iii) Hold hook in this position.			
2.2 Eccentrically mounted catch (See Fig.1).			
(i) Rotate to engage flat on bush retaining hook.			
(ii) Attach spring balance (1A/4707675).			
Continued Overleaf			
SERVICING PROCEDURE INSPECTION STAGES DO NOT EXCLUDE ADDITIONAL INSPECTION STAGES. INCORPORATED AS NECESSARY IN MAINTENANCE CERTIFICATION DOCUMENTS			

CHAP.	1	AIRFRAME	SERVICING PROCEDURE	BAC F53 & T55 (SA)
S.P.	6A	A.L.	F53	5A3A Section 1
SHEET	2	OF 9		2nd Edition

Safety and Servicing Notes are to be complied with throughout the work detailed on this card.

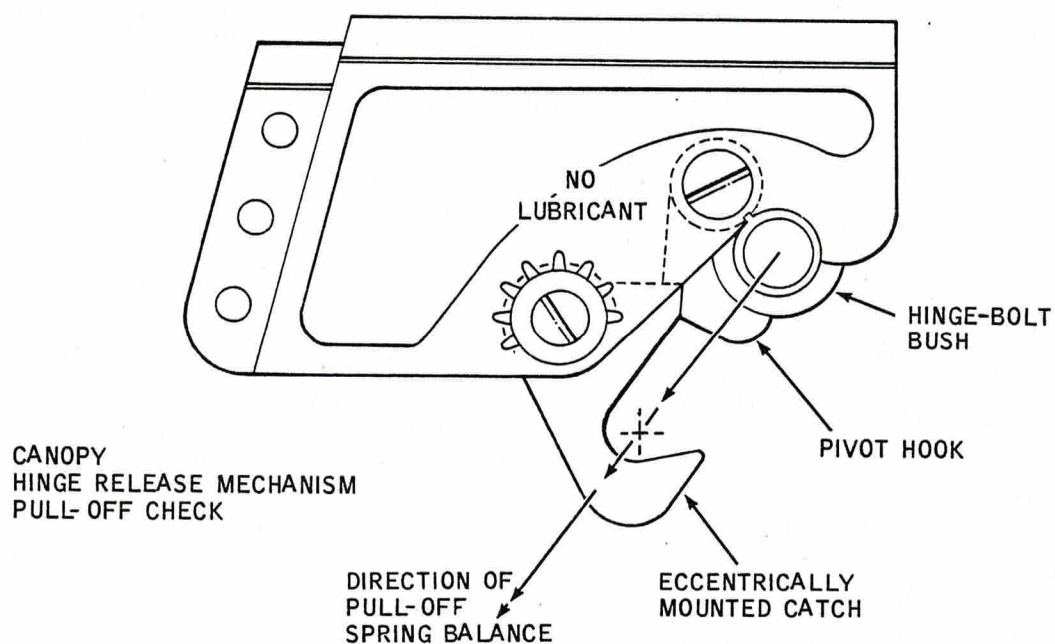

CANOPY HINGE RELEASE MECHANISM
PULL-OFF CHECK

FIGURE 1

Continued

CHAP 1 AIRFRAME	SERVICING PROCEDURE	B A C F 53 & T 55 (SA)
SP 6A AL 4	F53	5A3A Section 1
SHEET 3 OF 9		2nd Edition

Safety and Servicing Notes are to be complied with throughout the work detailed on this card.

43151/42252

2. PULL-OFF CHECK (contd)

- 2.2 Eccentrically mounted catch (See Fig.1) (contd)
- (iii) With a straight pull dislodge catch and permit free movement of bush retaining hook.
 - (iv) Ensure spring balance reading is between 50 and 90 lbs.

NOTE: Sub-items 2.3 to 2.5 are applicable only if reading obtained at Sub-item 2.2 is incorrect.

- 2.3 Eccentrically mounted catch bush. Withdraw countersunk bolt until locking tab is clear of locking recess.

- 2.4 Eccentric bush.
- (i) Rotate to move catch pivot point forward.
 - (ii) Rotate to increase or decrease pressure on catch and hook until loading is correct.
 - (iii) Tighten countersunk bolt until locking tab on eccentric bush is fully engaged with one of radial recesses in hinge arm.

- 2.5 Countersunk bolt. Relock by centre popping.

43171/42272 (INSPECTORS)

3. INSPECTION STAGE - ASSEMBLY CHECK

- 3.1 Inspect eccentrically mounted catch. Ensure correctly assembled and locked.

43151/42252

4. PREPARATION

- 4.1 Canopy lifting eye-bolts. Screw in fully by hand.
- 4.2 Canopy sling. Fit (26DK/95263).
- 4.3 Canopy lifting eye-bolts. Align with sling.
- 4.4 Multi purpose servicing hoist with No.3 Jib. Connect to sling.
- 4.5 Air drier blanks. Remove.

Continued Overleaf

SERVICING PROCEDURE INSPECTION STAGES DO NOT EXCLUDE ADDITIONAL INSPECTION STAGES INCORPORATED AS NECESSARY IN MAINTENANCE CERTIFICATION DOCUMENTS

CHAP. 1 AIRFRAME

S.P. 6A A.L.

SHEET 4 OF 9

SERVICING PROCEDURE

F53

BAC F53 & T55 (SA)

5A3A Section 1

2nd Edition

Safety and Servicing Notes are to be complied with throughout the work detailed on this card.

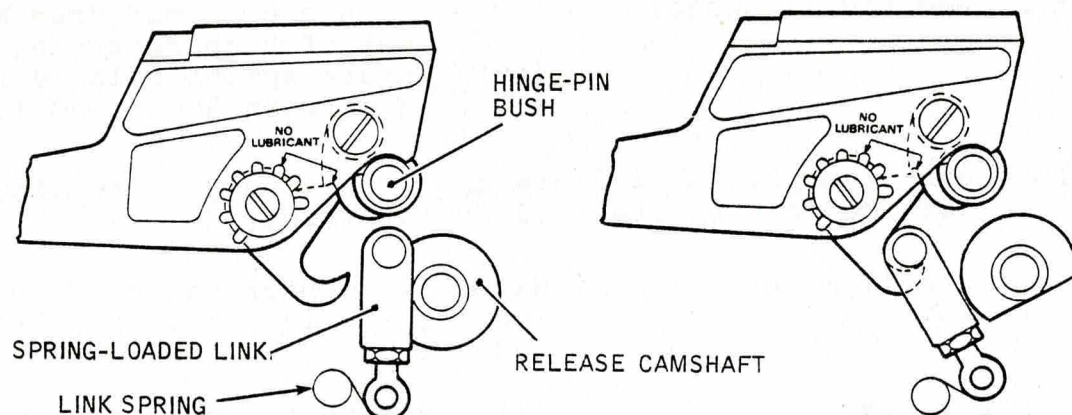

MECHANISM NORMAL

MECHANISM COCKED

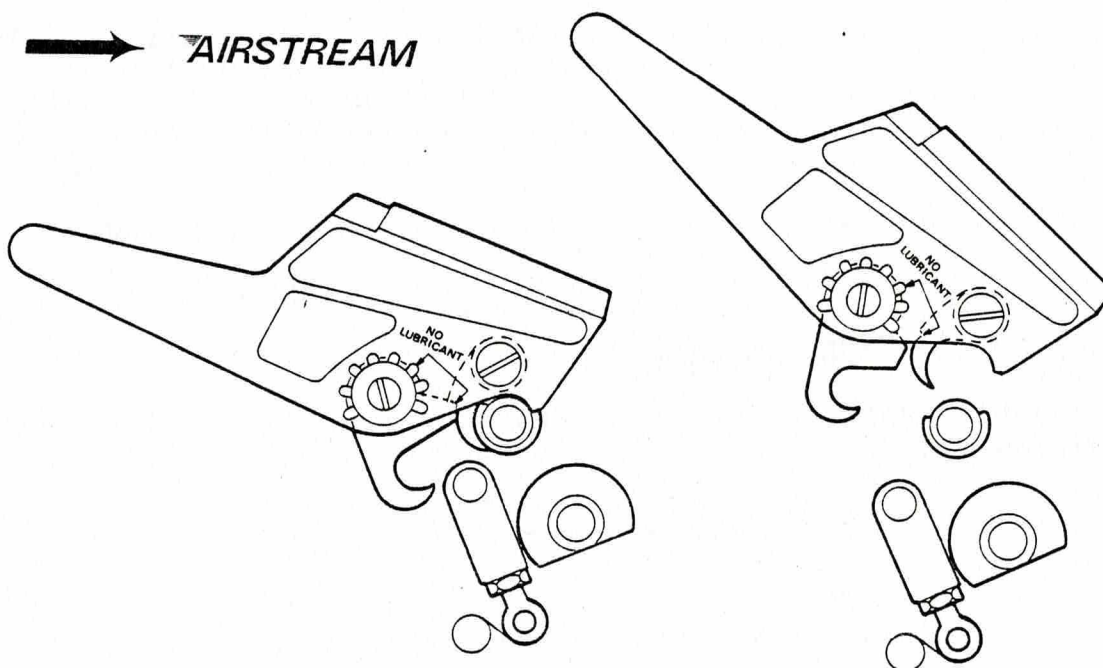

CANOPY LIFTED BY JETTISONING JACKS

CANOPY SEPARATED FROM AIRCRAFT

ACTION OF HINGE RELEASE MECHANISM

FIGURE 2

Continued

SERVICING PROCEDURE INSPECTION STAGES DO NOT EXCLUDE ADDITIONAL INSPECTION STAGES INCORPORATED AS NECESSARY IN MAINTENANCE CERTIFICATION DOCUMENTS

CHAP 1 AIRFRAME	SERVICING PROCEDURE	B A C F 53 & T 55 (SA)
SP 6A AL 7	F53	5A3A Section 1
SHEET 5 OF 9		2nd Edition

Safety and Servicing Notes are to be complied with throughout the work detailed on this card.

4 3 1 7 1 / 4 2 2 7 2 (INSPECTORS)

5. INSPECTION STAGE - ASSEMBLY CHECK

- 5.1 Inspect bush hook and catch (left and right). Ensure correctly fitted and locked.

4 3 1 5 1 / 4 2 2 5 2

6. FITTING

- 6.1 Canopy. (i) Raise using hoise and jib.
(ii) Position on aircraft in half open position.
- 6.2 Hinge bolts. (i) Refit.
(ii) Wirelock.

4 3 1 7 1 / 4 2 2 7 2 (INSPECTORS)

7. INSPECTION STAGE - ASSEMBLY CHECK

- 7.1 Inspect hinge release counter shaft (See Fig.2). Ensure left and right release camshaft flat is bearing on spring-loaded links in spring hinge box.

4 3 1 5 1 / 4 2 2 5 2

8. FITTING

- 8.1 Canopy selector. Set to OPEN.
- 8.2 Canopy jack ram. Extend, using aircraft hand-pump.
- 8.3 Jack attachment bolt. (i) Refit.
(ii) Check clearance between faces of eye-end fitting and lugs of canopy attachment bracket.

NOTE 1: Ensure jack attachment nut has chamfered edge outboard.

NOTE 2: If gap at any side exceeds 0.028 in. fit shim (26DK/36047) to either one or both sides if necessary.

(iii) Lock nut and bolt with wire.

Continued Overleaf

SERVICING PROCEDURE INSPECTION STAGES DO NOT EXCLUDE ADDITIONAL INSPECTION STAGES INCORPORATED AS NECESSARY IN MAINTENANCE CERTIFICATION DOCUMENTS

CHAP	1	AIRFRAME	SERVICING PROCEDURE	BAC F53 & T55 (SA)
SP	6A	AL	F53	5A3A Section 1
SHEET	6	OF		2nd Edition

Safety and Servicing Notes are to be complied with throughout the work detailed on this card.

43151/42252

8. FITTING (contd)

- 8.4 Air drier hoses.
- (i) Reconnect.
 - (ii) Ensure clip Part No. AGS605/0 is fitted to right hand hose and positioned so that the tightening screw is outboard of pipe with centre line vertical and screw head downwards.
 - (iii) Ensure left hand hose has engagement on bulkhead connector and canopy connector of 1 in.
- 8.5 Vent hose. Reconnect.
- 8.6 IFF aerial. Reconnect.
- 8.7 IFF aerial cable from aerial to rear bulkhead. Ensure does not foul during canopy operation.

32851

9. TESTING

- 9.1 IFF installation. Test (SP 102 (RAD)).

43151/42252

10. FITTING

- 10.1 Handling equipment. Remove.
- 10.2 Canopy eye-bolts socket blanking screws. Refit.

43171/42272 (INSPECTORS)

11. INSPECTION STAGE - ASSEMBLY CHECK

- 11.1 Inspect bush lock and catch. Using torch and mirror ensure correctly fitted and locked.
- 11.2 Jack attachment bolt. Ensure correctly assembled and locked.

Continued

SERVICING PROCEDURE INSPECTION STAGES DO NOT EXCLUDE ADDITIONAL INSPECTION STAGES INCORPORATED AS NECESSARY IN MAINTENANCE CERTIFICATION DOCUMENTS

CHAP 1 AIRFRAME	SERVICING PROCEDURE	B A C F 53 & T 55 (SA)
SP 6A AL 7	F53	5A3A Section 1
SHEET 7 OF 9		2nd Edition

Safety and Servicing Notes are to be complied with throughout the work detailed on this card.

43151/42252

12. TESTING

12.1 Canopy system. Test (SP 103(AF)).

42251/43151

NOTE: Item 13 is applicable only if a new canopy has been fitted.

13. TESTING

13.1 Cabin pressurization. Test (SP 116A (AF)).

43171/42272 (INSPECTORS)

14. INSPECTION STAGE - ASSEMBLY CHECK

14.1 Spring retaining clips and locknuts on shootbolt controls rods (left and right). Check clears panelling by 0.06 in. minimum throughout operation of shoot-bolt rods.

14.2 Canopy. Close with hydraulic pressure ensuring lock closes with shoot bolts.

14.3 Shoot bolts (See Fig.3). (i) Ensure penetrate windscreen arch by 0.70 in.
(ii) Release.
(iii) Ensure no excessive force is required to engage and disengage.

14.4 Canopy. Open, using aircraft hand-pump.

15. INSPECTION STAGE

15.1 Canopy fitting. Independent check (SP 129 (AF)).

32850

16. FITTING AND TESTING

16.1 UHF homing RF unit. (i) Refit.
16.2 UHF homing AF unit. (ii) Test (SP 105 (AC)).

16.3 Standby UHF TR. (i) Refit.
(ii) Test (SP 107 (AC)).

Continued Overleaf

SERVICING PROCEDURE INSPECTION STAGES DO NOT EXCLUDE ADDITIONAL INSPECTION STAGES INCORPORATED AS NECESSARY IN MAINTENANCE CERTIFICATION DOCUMENTS

CHAP 1 AIRFRAME	SERVICING PROCEDURE	BAC F53 & T55 (SA)
SP 6A AL 4	F53	5A3A Section 1
SHEET 8 OF 9		2nd Edition

Safety and Servicing Notes are to be complied with throughout the work detailed on this card.

32850

16. FITTING AND TESTING (contd)

- 16.4 Access panels 22P and 22S Refit.
(left and right).

43151 / 42252

17. COMPLETION

- 17.1 Access Panel 23 and fibre-glass breakaway panels. Refit.

- 17.2 Ejection seat safety catch withdrawal cable. Connect to canopy.

42272 (INSPECTOR)

18. INSPECTION STAGE

- 18.1 Ejection seat. Independent check (SP 102 (W)).

NOTE: All wirelocking to be of 22 SWG stainless steel wire unless otherwise notified.

Continued

SERVICING PROCEDURE INSPECTION STAGES DO NOT EXCLUDE ADDITIONAL INSPECTION STAGES INCORPORATED AS NECESSARY IN MAINTENANCE CERTIFICATION DOCUMENTS

CHAP. 1 AIRFRAME

S.P. 6A A.L.

SHEET 9 OF 9

SERVICING PROCEDURE

F53

BAC F53 & T55 (SA)

5A3A Section 1

2nd Edition

Safety and Servicing Notes are to be complied with throughout the work detailed on this card.

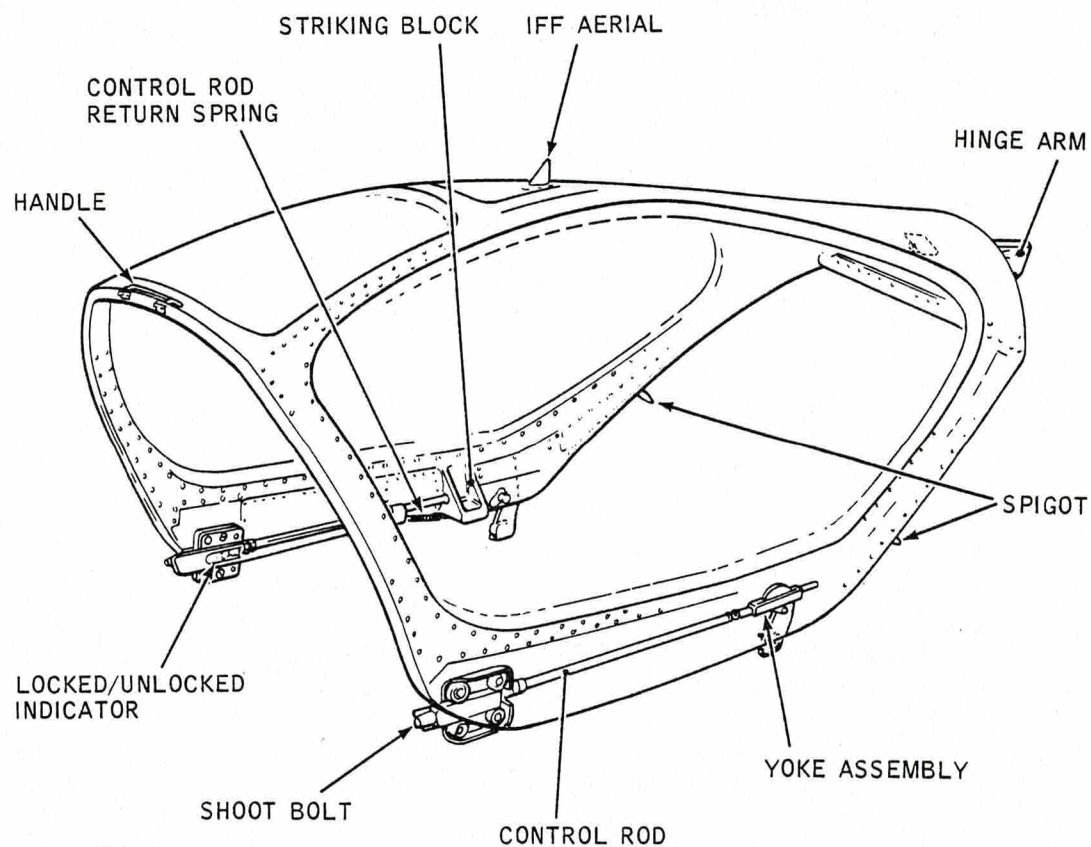

CANOPY SHOOT BOLTS

FIGURE 3

SERVICING PROCEDURE INSPECTION STAGES DO NOT EXCLUDE ADDITIONAL INSPECTION STAGES INCORPORATED AS NECESSARY IN MAINTENANCE CERTIFICATION DOCUMENTS

Project Title: [Illegible]

This file was downloaded
from the RTFM Library.

Link: www.scottbouch.com/rtfm

Please see site for usage terms,
and more aircraft documents.

