

CHAP. 3 AIRFRAME S.P. 305B A.L. 1 SHEET 1 OF 2		SERVICING PROCEDURE T55	BAC F53 & T55 (SA) 5A3A Section 1 2nd Edition													
Rudder Controls			AFSC	TIME EST												
Safety and Servicing Notes are to be complied with throughout the work detailed on this card.			43151 42152													
<div><div><p>A ALL THE BALL BEARINGS IN THIS ASSEMBLY ARE PRE-PACKED WITH GREASE XG-287</p></div><div><p>B ALL BALL BEARINGS IN THE RUDDER HINGE ASSEMBLY ARE PRE-PACKED WITH GREASE XG-287</p></div><div><p>D</p></div><div><p>C</p></div><div><p>KEY TO LUBRICANTS</p><table><tr><th>SYMBOL</th><th>NOMENCLATURE</th></tr><tr><td>●</td><td>XG-276</td></tr><tr><td>□</td><td>XG-287</td></tr><tr><td>▢</td><td>XG-277</td></tr></table><p>P PRE-PACKED</p></div><div><p>C</p><p>TYPICAL ROD-TO-ROD CONNECTION PRE-PACKED BEARINGS WITH SIDE PLATES</p></div><p>LUBRICATION OF CONTROLS</p></div> <div><p>FIGURE 1</p><p>Continued Overleaf</p></div> <tr><td colspan="5">SERVICING PROCEDURE INSPECTION STAGES DO NOT EXCLUDE ADDITIONAL INSPECTION STAGES INCORPORATED AS NECESSARY IN MAINTENANCE CERTIFICATION DOCUMENTS</td></tr>				SYMBOL	NOMENCLATURE	●	XG-276	□	XG-287	▢	XG-277	SERVICING PROCEDURE INSPECTION STAGES DO NOT EXCLUDE ADDITIONAL INSPECTION STAGES INCORPORATED AS NECESSARY IN MAINTENANCE CERTIFICATION DOCUMENTS				
SYMBOL	NOMENCLATURE															
●	XG-276															
□	XG-287															
▢	XG-277															
SERVICING PROCEDURE INSPECTION STAGES DO NOT EXCLUDE ADDITIONAL INSPECTION STAGES INCORPORATED AS NECESSARY IN MAINTENANCE CERTIFICATION DOCUMENTS																

Safety and Servicing Notes are to be complied with throughout the work detailed on this card.

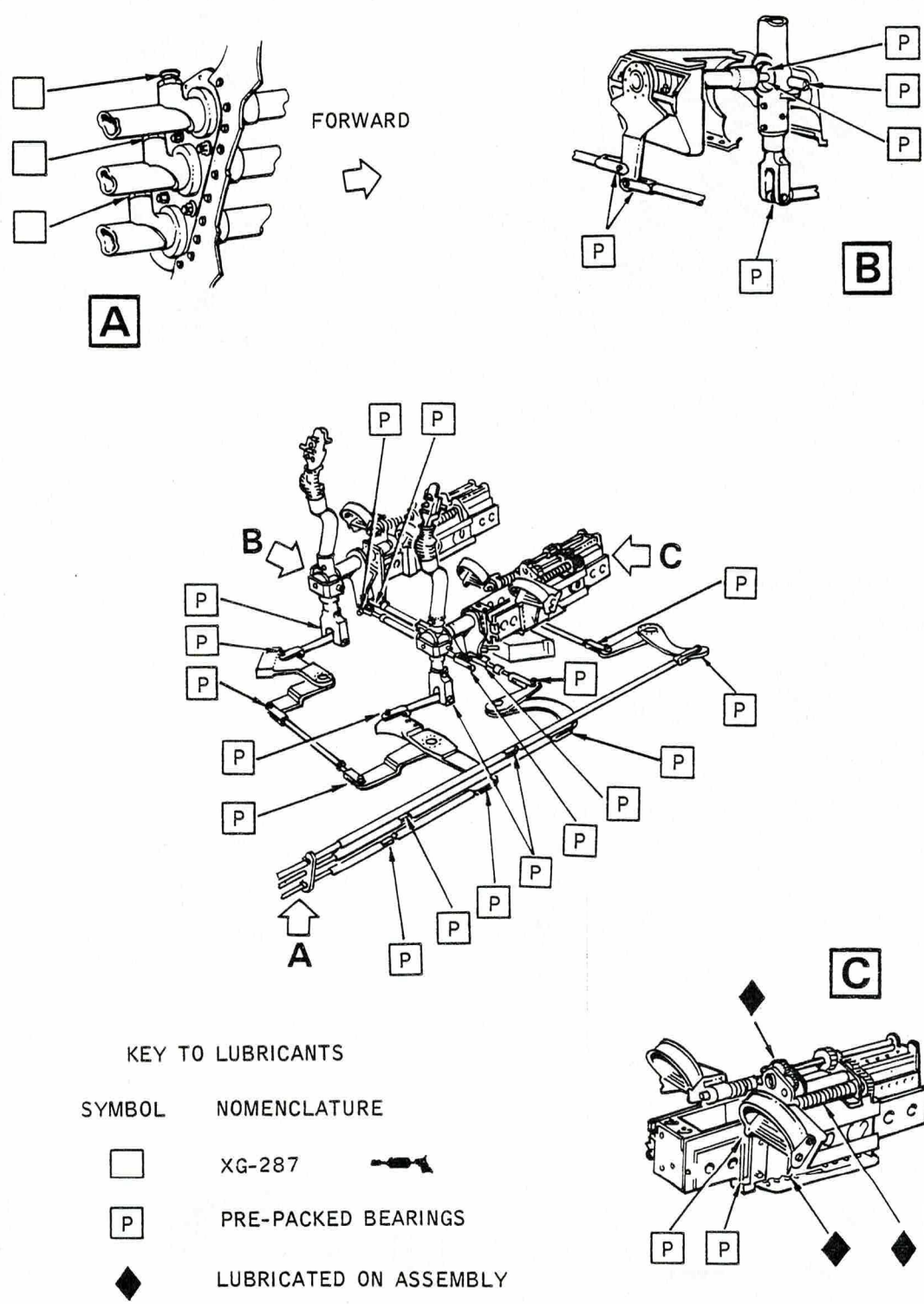

LUBRICATION OF CONTROLS

FIGURE 2

This file was downloaded
from the RTFM Library.

Link: www.scottbouch.com/rtfm

Please see site for usage terms,
and more aircraft documents.

