

| | | |
|------------------|---------------------|--------------------|
| CHAP. 4 AIRFRAME | SERVICING PROCEDURE | BAC F53 & T55 (SA) |
| S.P. 413 A.L. | F53 T55 | 5A3A Section 1 |
| SHEET 1 OF 4 | | 2nd Edition |

| | | |
|---|---------------------------------|----------|
| Auxiliary Spar - Loose Bolts | AFSC 43151 53450 53470 | TIME EST |
| Safety and Servicing Notes are to be complied with throughout the work detailed on this card. | | |

SPECIAL TOOLS AND EQUIPMENT

Nil.

43151

1. OPERATION (See Fig.1 and 2)

1.1 Auxiliary spar bolts (inboard wall of wheel wells (left and right)).

1.2 Nuts in area between undercarriage and sidestay bracket at Spar 4.

} Ensure tight and peened.

NOTE: Item 2 is applicable only if bolts or nuts are found to be free to turn in Item 1.

2. EXAMINATION

2.1 Auxiliary spar bolts.

2.2 Nuts in area between undercarriage and sidestay bracket at Spar 4.

(i) Gain access to nuts on inner side of spar through lightening holes.

(ii) Using a spanner on bolt head and nut ensure locking has not failed. Excessive force is not to be used or peen locking will be broken.

53450

NOTE: Item 3 is applicable only if bolts or nuts are found unlocked in Item 2.

3. RECTIFICATION

3.1 Nuts in area between undercarriage and sidestay bracket at Spar 4.

Tighten and repeen.

Continued Overleaf

SERVICING PROCEDURE INSPECTION STAGES DO NOT EXCLUDE ADDITIONAL INSPECTION STAGES INCORPORATED AS NECESSARY IN MAINTENANCE CERTIFICATION DOCUMENTS

Safety and Servicing Notes are to be complied with throughout the work detailed on this card.

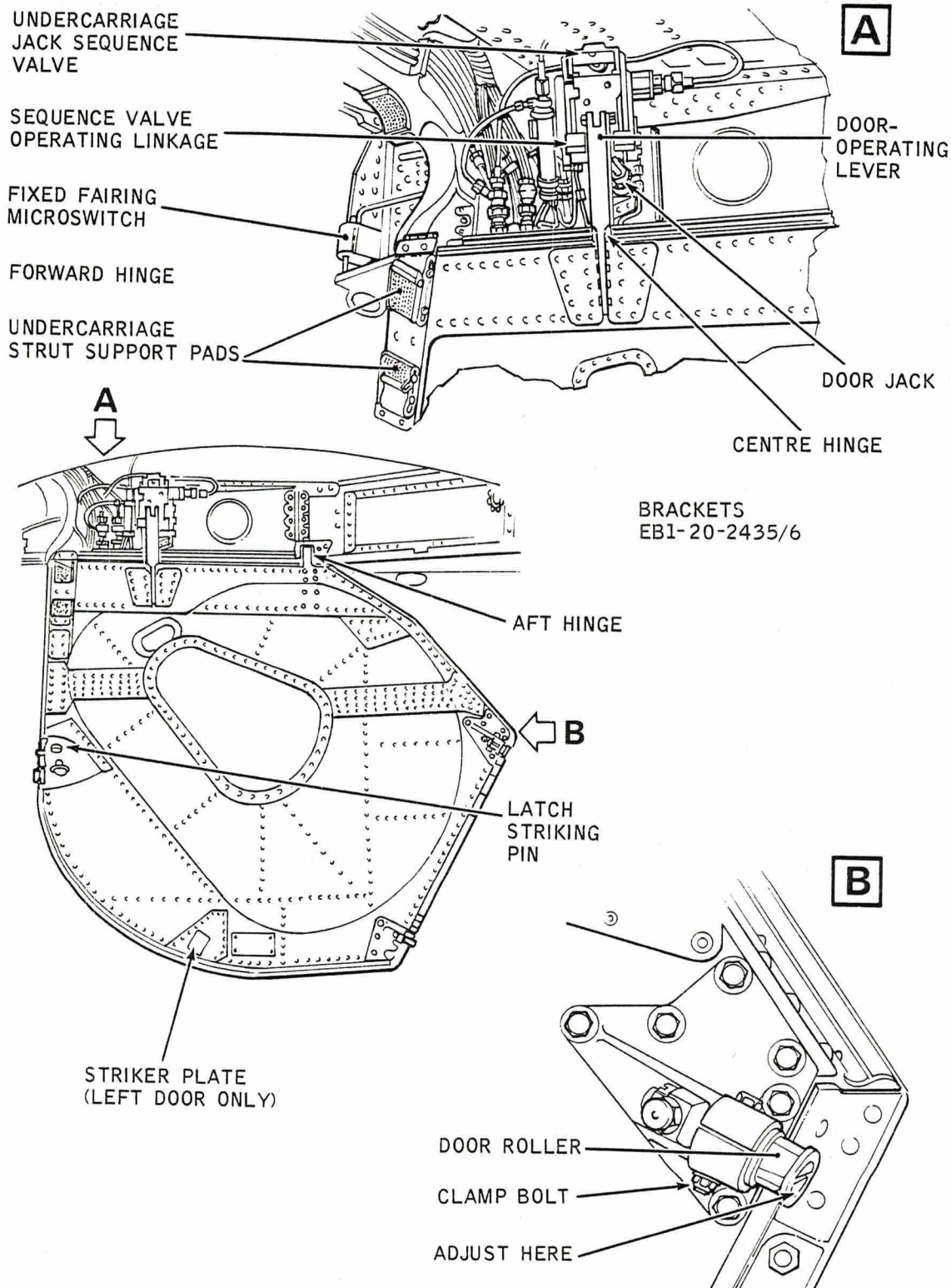

D-DOOR OPERATING ARM BRACKETS

FIGURE 1

Continued

| | | | |
|----------|----------|---------------------|--------------------|
| CHAP. 4 | AIRFRAME | SERVICING PROCEDURE | BAC F53 & T55 (SA) |
| S.P. 413 | A.L. 1 | F53 T55 | 5A3A Section 1 |
| SHEET 3 | OF 4 | | 2nd Edition |

Safety and Servicing Notes are to be complied with throughout the work detailed on this card.

53450

3. RECTIFICATION (contd)

3.2 Special bolts at forward end of spar.

- (i) Manufacture tapped plate as detailed in Repair Scheme SRO/20/50.
- (ii) Refit as detailed in Repair Scheme SRO/20/50.

NOTE: The applicable drawings are available from British Aerospace, Saudi Technical Support Dept., Warton, Lancashire, England.

53470 (QUALITY CONTROL)

4. INSPECTION STAGE

4.1 Inspect.

Item 3, if applicable.

Continued Overleaf

SERVICING PROCEDURE INSPECTION STAGES DO NOT EXCLUDE ADDITIONAL INSPECTION STAGES INCORPORATED AS NECESSARY IN MAINTENANCE CERTIFICATION DOCUMENTS

| | | | |
|----------|----------|---------------------|--------------------|
| CHAP. 4 | AIRFRAME | SERVICING PROCEDURE | BAC F53 & T55 (SA) |
| S.P. 413 | A.L. | F53 T55 | 5A3A Section 1 |
| SHEET 4 | OF 4 | | 2nd Edition |

Safety and Servicing Notes are to be complied with throughout the work detailed on this card.

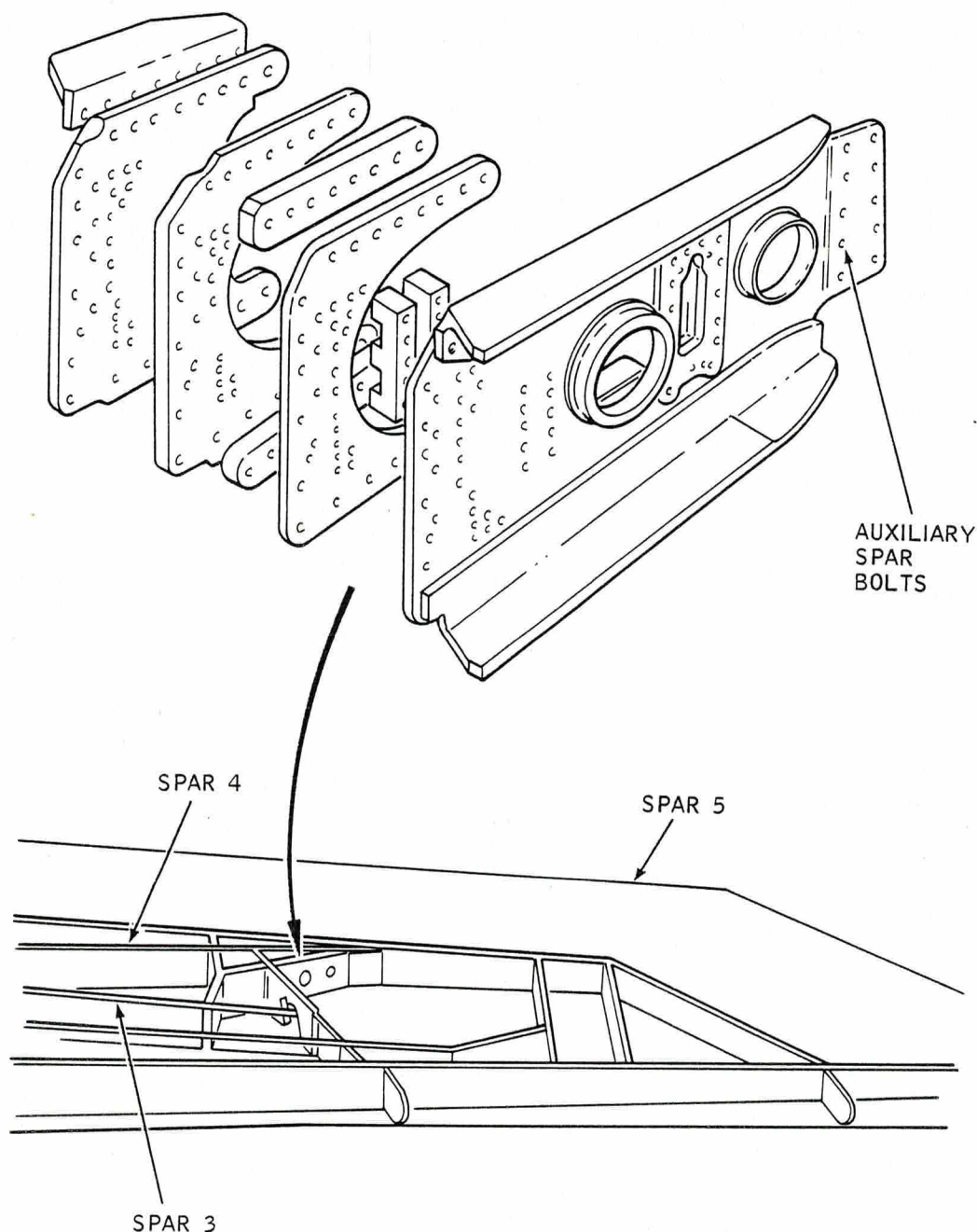

HALF WING - LEFT AND RIGHT
FIGURE 2

This file was downloaded
from the RTFM Library.
Link: www.scottbouch.com/rtfm

Please see site for usage terms,
and more aircraft documents.

