

**TAIL UNIT
RUDDER C/W TAB**

Ref. No.	Part No.	Description	No. Off	Matl Spec.	Cl. of Equip.	Plate No.
					M.R. L.M.	
5173	E.A3.33.1	RUDDER, C/W TAB, ASSEMBLY	1	—	A	TU.1
1439171	E.A3.00.1069	RUDDER, C/W TAB, ASSEMBLY (MOD. 4478) (PRE-MOD. 4853)	1	—	A	
	E.A3.00.5373	RUDDER, C/W TAB, ASSEMBLY (MOD. 4853)	1	—	—	
		Spares for:—				
9992	E.A1.33.489	BOLT , special, balance weight	4	—	C	
329	E.A1.33.247	BOLT , special trim, tab actuator connecting	1	S.11	C	
5876	E.A1.33.283	BRACKET, HINGE TOP MOUNTING, ASSEMBLY	1	—	B	TU.1
		Consisting of:—				
	E.A1.33.71	BRACKET, HINGE RUDDER, ASSEMBLY	1	—	—	TU.1
		Spares for:—				
2A/9500467	HOFFMANN CA.3	BALLRACE , self aligning	1	—	C	TU.1
1041	EEAS.3J	HOUSING , ballrace	1	—	C	TU.1
20452	EEAS.4/18J	WASHER , packing	2	—	C	
2100	E.A1.33.293	BRACKET , hinge top mounting	1	DTD.683	C	TU.1
3668	E.A3.33.215	CUP , sealing	2	RUBBER	C	TU.1
28M/5808571	A27/GS	NUT , 5/8" BSF	1	—	C	TU.1
28P/1207	AGS.166/3	PIN , split	1	—	C	
3669	E.A3.33.213	PLATE , locking	1	DTD.124A	C	TU.1
28S/7187	No.8 x 5/16" 4100	SCREW , self tapping, type Z	1	—	C	
28W/9419477	SP.15/J	WASHER	1	—	C	
		Attaching parts for E.A1.33.283:—				
28D/1011240	A25/5E	Bolt 1/2" BSF	2	—	C	
2101	E.A1.33.297	COWL , rudder, tab control rod	1	L.59	C	TU.1
9994	E.A1.33.189	HINGE TAB, BOTTOM, AT RIB 1, ASSEMBLY	1	—	B	
		Consisting of:—				
2A/9500463	SKEFKO CBA.2	BALLRACE , self aligning	1	—	C	
28N/2001688	AGS.2030/22	CIRCLIP , internal, 5/8" dia.	1	—	C	
	E.A1.33.189A	HOUSING , ballrace	1	L.40	—	
		Attaching parts for E.A1.33.189A:—				
28D/9133012	A25/3C	Bolt , 2 BA	3	—	C	
28W/9419475	SP.15/C	Washer	3	—	C	
	E.A3.33.7	NOSE, RUDDER AND PIVOT POINT, ASSEMBLY	1	—	—	
		Spares for:—				
	E.A3.33.247	ARM , mass balance	1	—	—	
2A/9500423	RANSOME & MARLES CA.118	BALLRACE , main lower tab operating gear	1	—	C	
9949	E.A1.33.125	BRACKET, BOTTOM RUDDER HINGE, ASSEMBLY	1	—	B	
		Spares for:—				
18220	E.A3.33.217	SHROUD , sealing	1	—	C	
2733	E.A1.33.815	SPIGOT , rudder bottom bearing	1	S.11	C	TU.1
		Attaching parts for E.A1.33.125:—				
28D/9133011	A25/2C	Bolt , 2 BA	10	H.T.S.	C	
28D/9133012	A25/3C	Bolt , 2 BA	2	H.T.S.	C	
28M/9433473	AGS.2002/C/1	Nut , 2 BA	12	—	C	
28W/9419404	SP.16/C	Washer	12	L.A.	C	

**TAIL UNIT
RUDDER C/W TAB**

Ref. No.	Part No.	Description	No. Off	Matl Spec.	Cl. of Equip.	Plate No.
					M.R. L.M.	
		1 2 3 4 5 6				
13097	E.A3.00.259	GEAR, TAB OPERATING, ASSEMBLY (E.A1.33.215) Spares for:—	1	—	A	
19742	E.A1.33.231	BRACKET , stop 1	1	—	C	
28D/9133012	A25/3C	Attaching parts for E.A1.33.231:—				
28M/9433473	AGS.2002/C/1	Bolt, 2 BA 2	2	H.T.S.	C	
		Nut, 2 BA 1	1	—	C	
19739	E.A1.33.161	LEVER , assembly 1	1	—	B	
		Attaching parts for E.A1.33.161:—				
19745	E.A1.33.241	Bolt, special 3	3	—	C	
28M/7002430	AGS.2002/E/1	Nut, ½" BSF 3	3	—	C	
19731	E.A1.33.211	STOP , limit 1	1	—	C	
		Attaching parts for E.A1.33.211:—				
28D/1011242	A25/7E	Bolt, ½" BSF 1	1	H.T.S.	C	
28M/1201610	AGS.2001/E/1	Nut, ½" BSF 1	1	—	C	
28W/9418921	SP.13/E	Washer 1	1	—	C	
19753	E.A1.33.803	TUBE, TORQUE, OUTER, ASSEMBLY 1	1	—	MR	
		Spares for:—				
19751	E.A1.33.721	LEVER , assembly 1	1	—	B	
		Attaching parts for E.A1.33.721:—				
19745	E.A1.33.241	Bolt, special 3	3	—	C	
28M/7002430	AGS.2002/E/1	Nut, ½" BSF 3	3	—	C	
28W/9419405	SP.15/E	Washer 3	3	—	C	
2103	E.A1.33.177	HOUSING, BEARING, FOR RUDDER OPERATING GEAR AT RIB 6, ASSEMBLY Spares for:—	1	—	B	TU.1
2A/9500420	RANSOME & MARLES CA.1 1/8"	BALLRACE 1	1	—	C	TU.1
28N/1007712	AGS.2031/24	CIRCLIP , external, 1 1/8" dia. 1	1	—	C	TU.1
28N/2001693	AGS.2030/48	CIRCLIP , internal, 1 1/8" dia. 1	1	—	C	TU.1
	E.A1.33.123	HOUSING , bearing 1	1	L.40	—	
19741	E.A1.33.179	LEVER , tab control 1	1	—	C/MR	
5495	E.A1.33.205	PLATE , stop 1	1	L.40	C	TU.1
		Attaching parts for E.A1.33.205:—				
28D/9140203	AS.1246/3C	Bolt, 2 BA 1	1	H.T.S.	C	
19743	E.A1.33.201	RING , ballrace, retaining 1	1	L.64	C	TU.1
19730	E.A1.33.203	TUBE , distance 1	1	T.4	C	TU.1
		Attaching parts for E.A1.33.177:—				
28D/1011238	A25/3E	Bolt, ½" BSF 4	4	H.T.S.	C	
6360	E.A1.33.383	HOUSING , bearing, tab operating gear at rib 2	1	L.40	C	TU.1
		Attaching parts for E.A1.33.383:—				
28D/1011238	A25/3E	Bolt, ½" BSF 6	6	H.T.S.	C	
9715	E.A1.33.445	PANEL , access, L.H., lower hinge bracket 1	1	—	C	
9716	E.A1.33.447	PANEL , access, R.H., lower hinge bracket 1	1	—	C	
		Attaching parts for E.A1.33.445 and E.A1.33.447:—				
1025	EEAS.1/1C	Screw, 2 BA 8	8	S.11	C	

**TAIL UNIT
RUDDER C/W TAB**

Ref. No.	Part No.	Description	No. Off	Matl Spec.	Cl. of Equip.	Plate No.
					M.R. L.M.	
5402	E.A1.33.791	PANEL , access, upper hinge bracket	1	—	C	
1025	EEAS.1/1C	Attaching parts for E.A1.33.791:— Screw, 2 BA	10	S.11	C	
9717	E.A1.33.425	PLUG , sealing, rudder lifting point, assembly ...	2	—	C	
6833	E.A1.33.57	RIB , No. 1, leading edge, port (Pre-Mod. 4427) ...	1	—	C	
1438852	E.A9.33.75	RIB , No. 1, leading edge, port (Mod. 4427) ... (Supplied to Part No. E.A3.00.5265 for spares purposes)	1	—	C	
6834	E.A1.33.58	RIB , No. 1, leading edge, starboard (Pre-Mod. 4427)	1	—	C	
1438853	E.A9.33.76	RIB , No. 1, leading edge, starboard (Mod. 4427) (Supplied to Part No. E.A3.00.5266 for spares purposes)	1	—	C	
9935	E.A1.33.15	SPAR, RUDDER, ASSEMBLY Spares for:—	1	—	MR	
26556	E.A1.33.463	DIAPHRAGM , rudder spar	1	—	C	
1523	E.A1.33.779	NUT , special, balance weight clamping	1	M.S.	C	
9962	E.A3.33.133	PAD , balance weight, assembly	1	—	C	
	E.A3.33.283	REINFORCEMENT OF TRAILING EDGE, RIB NO. 1 (MOD. 4707) Spares for:—	—	—	—	
21652	E.A3.33.289	ANGLE , reinforcing, L.H.	1	L.72	MR	
21658	E.A3.33.290	ANGLE , reinforcing, R.H.	1	L.72	MR	
21655	E.A3.33.293	PACKING , below curved reinforcing strip ...	2	L.72	MR	
21654	E.A3.33.295	PACKING , butt strap	2	L.72	MR	
21650	E.A3.33.285	SKIN , insertion, L.H.	1	L.72	MR	
21656	E.A3.33.286	SKIN , insertion, R.H.	1	L.72	MR	
21651	E.A3.33.287	STRAP , butt, L.H.	1	L.72	MR	
21657	E.A3.33.288	STRAP , butt, R.H.	1	L.72	MR	
21653	E.A3.33.291	STRIP , packing, angle	2	L.72	MR	
9957	E.A1.33.75	RIB , trailing, No. 2, assembly	1	—	C	
9958	E.A1.33.77	RIB , trailing, No. 3, assembly	1	—	C	
9960	E.A1.33.93	RIB, TRAILING, NO. 6, ASSEMBLY Spares for:—	1	—	MR	
18216	E.A1.33.187	HINGE , tab, centre Attaching parts for E.A1.33.187:—	1	—	C	
28D/9133011	A25/2C	Bolt, 2 BA	1	—	C	
28D/9133012	A25/3C	Bolt, 2 BA	2	—	C	
28M/9403520	A27/CP	Nut, 2 BA	3	—	C	
28W/9419475	SP.15/C	Washer	2	—	C	
10007	E.A3.33.271	ROD, TAB CONTROL, ASSEMBLY (MOD. 1171) ... Spares for:—	1	—	B	TU.1
12026	E.A3.33.269	BOLT , special, adjusting	1	S.95	C	TU.1
3225	EEAS.131/1	END-FORK , for control tube	1	DTD.683	C	TU.1
28R/13507	CF.2	END-ROD	1	—	C	TU.1
1573	EEAS.37/13A	NIPPLE , 3/8" dia.	10	—	C	TU.1
	E.A1.33.275	SOCKET , screwed	1	L.40	—	
	EEAS.38/1A	SPOKE , 6 BA (Make from Ref. 28R/6123) Attaching parts for E.A3.33.271:—	1	H.T.S.	LM	
1051	EEAS.13	Bolt, special, 1/4" BSF	1	S.11	C	
328	E.A1.31.65	Bolt, special	1	—	C	
68	EEAS.14	Bush, bearing	2	S.11	C	
28M/1011467	A27/ES	Nut, 1/4" BSF	1	—	C	
28M/5808573	A27/CS	Nut, 2 BA	1	—	C	
2104	EEAS.28/8GR	Washer	2	L.72	C	
28W/9419404	SP.16/C	Washer	1	—	C	

**TAIL UNIT
RUDDER C/W TAB**

Ref. No.	Part No.	Description						No. Off	Matl Spec.	Cl. of Equip. M.R. L.M.	Plate No.
		1	2	3	4	5	6				
9983	E.A1.33.811	SKIN	panel	upper	port	1	—	C	
9984	E.A1.33.812	SKIN	panel	upper	starboard	1	—	C	
9995	E.A3.33.93	SKIN	panel	lower	port	1	—	C	
9996	E.A3.33.94	SKIN	panel	lower	starboard	1	—	C	
9912	E.A3.33.97	SKIN	panel	intermediate	port	1	—	C	
9919	E.A3.33.98	SKIN	panel	intermediate	starboard	1	—	C	
10005*	E.A3.33.231	SPOILER	rudder	trailing edge	port	1	—	C	
32176											
10006*	E.A3.33.232	SPOILER	rudder	trailing edge	starboard	1	—	C	
32177											
3368	E.A3.33.21	TAB, RUDDER, TRIM, ASSEMBLY	1	—	A	TU.1
1439178	E.A3.00.1079	TAB, RUDDER, TRIM, ASSEMBLY (MOD. 4478)	1	—	A	
		(PRE-MOD. 4853)									
	E.A3.00.5383	TAB, RUDDER, TRIM, ASSEMBLY (MOD. 4853)	1	—	—	
		Spares for:—									
4679	E.A3.31.53	ARM, balance, support	6	L40	C	TU.1
		Attaching parts for E.A3.31.53:—									
28M/13376	A29/EP	Nut, 1" BSF	6	—	C	
28W/9419487	SP.16/E	Washer	2	—	C	
28W/9419405	SP.15/E	Washer	4	—	C	
4160	E.A1.45.49	BOLT, special, balance weight retaining	6	S.1	C	
19754	E.A3.33.23	BRACKET, rudder tab actuator	1	—	MR	
334	E.A1.31.61	PIN, hinge bearing	2	S.11	C	
		Attaching parts for E.A1.31.61:—									
28M/1007403	A27/ET	Nut, 1" BSF	2	—	C	
335	E.A1.33.249	WASHER, special, thrust, at trim tab actuator connecting bolt	2	L.40	C	
9993	E.A1.33.491	WASHER, fillet, balance weight	4	—	C	
7088	E.A1.33.481	WASHER, balance, balance weight	19	—	C	
9991	E.A1.33.483	WEIGHT, balance	7	—	B	
9953	E.A1.33.249	WEIGHT, balance	1	—	MR	
9963	E.A3.33.139	WEIGHT, balance	3	—	B	

**TAIL UNT
RUDDER C/W TAB**

Ref. No.	Part No.	Description						No. off	Matl. Spec.	Cl. of Equip.	Plate No.
		1	2	3	4	5	6			M.R. L.M.	
SUMMARY OF STOCK ITEMS USED ON RUDDER, C/W TAB, ASSEMBLY											
28D/9133011	A25/2C	Bolt, 2	BA	hex. head,	"65 long		C	
28D/9133012	A25/3C	Bolt, 2	BA	hex. head,	"75 long		C	
28D/1200119	A25/4C	Bolt, 2	BA	hex. head,	"85 long		C	
28D/1011030	A25/2E	Bolt, 1	" BSF	hex. head,	"7 long		C	
28D/1011238	A25/3E	Bolt, 1	" BSF	hex. head,	"8 long		C	
28D/1011240	A25/5E	Bolt, 1	" BSF	hex. head,	1" long		C	
28D/7002413	A25/14E	Bolt, 1	" BSF	hex. head,	1"9 long		C	
28D/12635	A25/24E	Bolt, 1	" BSF	hex. head,	2"9 long		C	
28D/9140203	AS.1246/3C	Bolt, 2	BA	round head,	0"7 long		C	
28D/1214388	AS.1246/46E	Bolt, 1	" BSF	round head,	5"05 long		C	
28D/1214389	AS.1246/56E	Bolt, 1	" BSF	round head,	1"01 long		C	
28D/1013284	AS.1248/2C	Bolt, 2	BA	hex. head,	0"6 long		C	
28M/9403520	A27/CP	Nut, 2	BA	plain		C	
28M/5808573	A27/CS	Nut, 2	BA	slotted		C	
28M/1011467	A27/ES	Nut, 1	" BSF	slotted		C	
28M/1077403	A27/ET	Nut, 1	" BSF	thin		C	
28M/1006939	A27/GP	Nut, 1	" BSF	plain		C	
28M/13376	A29/EP	Nut, 1	" BSF	plain		C	
28M/13717	A29/GP	Nut, 1	" BSF	plain		C	
28M/13718	A29/GPL	Nut, 1	" BSF	plain, L.H. thread		C	
28M/1278190	AGS.2001/C/1	Nut, stiff, 2	BA		C	
28M/10281	AGS.2001/C/3	Nut, stiff, 2	BA		C	
28M/9433473	AGS.2002/C/1	Nut, stiff, 2	BA		C	
28M/11957	AGS.2007/C/1	Nut, stiff, 2	BA		C	
28M/9434251	AGS.2008/B/1	Nut, stiff, 4	BA		C	
28P/9527619	SP.90/C7	Pin, split, 1/8"	x 1"		C	
28W/9419475	SP.15/C	Washer, 2	BA	plain		C	
28W/9419405	SP.15/E	Washer, 1	" BSF	plain		C	
28W/9419476	SP.15/G	Washer, 1/8"	BSF	thin		C	
28W/9419404	SP.16/C	Washer, 2	BA	plain		C	
28W/9419487	SP.16/E	Washer, 1	" BSF	plain		C	

Ref. No.	Part No.	1 2 3 4 5 6	Description	No. off	Matl. Spec.	Cl. of Equip. M.R. L.M.	Plate No.

**TAIL UNIT
TAILPLANE AND ELEVATORS**

Ref. No.	Part No.	Description	No. Off	Matl Spec.	Cl. of Equip.	Plate No.
					M.R. L.M.	
	E.B6.00.19	TAILPLANE AND ELEVATORS, ASSEMBLY (PRE-MOD. 2182)	—	—	—	
	E.A9.00.19	TAILPLANE AND ELEVATORS, ASSEMBLY (MOD. 2182)	—	—	—	
		Spares for:—				
3385	E.A3.31.45	BOLT , special, in port elevator operating lever ...	1	S.95	C	
67	EEAS.13/1	BOLT , special, ¼" BSF ...	1	S.11	C	
1590	E.A1.30.335	BUFFER , rubber, stop elevator control ...	2	Shore 45	C	
3386	E.A3.31.47	BUSH , control, for special bolt, port elevator operating lever	1	S.95	C	
2991	E.A1.31.1	ELEVATOR, C/W TAB, PORT, ASSEMBLY (PRE-MOD. 2182)	1	—	A	TU.2
1439168	E.A3.00.1065	ELEVATOR, C/W TAB, PORT, ASSEMBLY (MOD. 4478) (PRE-MOD. 4853) (For aircraft not embodying Mod. 2182)	1	—	A	
	E.A3.00.5369	ELEVATOR, C/W TAB, PORT, ASSEMBLY (MOD. 4853) (For aircraft not embodying Mod. 2182)	1	—	—	
13241	E.A9.31.1	ELEVATOR, C/W TAB, PORT, ASSEMBLY (MOD. 2182)	1	—	A	TU.2
		Spares for:—				
	E.A1.31.709	BALANCE, MASS, ELEVATOR, PORT, ASSEMBLY	1	—	—	
		Consisting of:—				
	E.A1.31.713	ARM , balance weight ...	1	S.95	—	
	E.A1.31.133	BOLT , special, make-up balance weight ...	2	M.S	—	
	E.A1.31.705	PIN , special, locking, balance weight to arm ...	1	S.95	—	
19724	E.A1.31.707	PLUG , screwed end fitting ...	1	S.95	C/MR	
43227	E.A1.31.129	WEIGHT , balance make-up ...	1	G.E.C.	B/MR	
	E.A1.31.711	WEIGHT , arm, balance ...	1	Heavy Metal G.E.C.	—	
30A/9140209	†	WIRE , locking, 20 SWG ...	QR	Soft Iron	C	
2A/9500463	SKEFKO CBA.2	BEARING , ballrace elevator ...	1	—	C	
2A/9500419	SKEFKO T.T.S.8½	BEARING , ballrace, tab control lever at tab torque, mounting	1	—	C	
333	E.A1.31.63	BOLT , special, bearing tab hinge ...	1	S.11	C	
328	E.A1.31.65	BOLT , special, bearing, connecting rod at joint	1	S.65	C	
10076	E.A1.31.157	BRACKET , link, mounting ...	1	L.40	C	TU.2
28N/12455	AGS.2031/22	CIRCLIP , external, 1⅞" dia. ...	1	—	C	
28N/2001688	AGS.2030/22	CIRCLIP , internal, 22 m/m ...	1	—	C	
	E.A1.31.11	ELEVATOR, PORT, ASSEMBLY	1	—	—	
		Spares for:—				
336	E.A1.31.79	BRACKET , hinge ...	3	—	C	TU.2
337	E.A1.31.485	COVER , hand hole between elevator rib and hinge rib	2	L.72	C	TU.2
10069	E.A1.31.487	DIAPHRAGM , tab shroud ...	3	—	C	
	E.A1.31.7	HORN, ELEVATOR, PORT, ASSEMBLY	1	—	MR	
		Spares for:—				
	E.A1.31.51	BRACKET , horn ...	1	DTD.300	—	
10022	E.A1.31.551	PANEL , skin, top ...	1	—	C	
10023	E.A1.31.552	PANEL , skin, bottom ...	1	—	C	
1468	EEAS.1/2C	SCREW , 2 BA ...	3	S.96	C	
1029	EEAS.1/4C	SCREW , 2 BA ...	8	S.96	C	
10035	EEAS.1/4½E	SCREW , ¼" BSF ...	16	S.96	C	
338	E.A1.31.91	SPIGOT , hinge ...	1	S.96	C	

**TAIL UNIT
TAILPLANE AND ELEVATORS**

Ref. No.	Part No.	Description						No. Off	Matl Spec.	Cl. of Equip. M.R. L.M.	Plate No.
		1	2	3	4	5	6				
	E.A3.31.25	WEIGHT, ELEVATOR HORN, BALANCE, ASSEMBLY						1	—	MR	
		Consisting of:—									
19726	E.A3.31.29	BOLT , special						1	M.5.	C/MR	TU.2
19725	E.A3.31.27	DISC , balance weight						QR	DTD.126A	C/MR	
19715	E.A1.31.333	DISC , balance weight						QR	L.64	C/MR	TU.2
	E.A1.31.339	HOUSING , balance weight						1	—	—	
28W/9416198	SP.42/J	WASHER , tab						1	—	C	
28W/9419477	SP.15/J	WASHER						QR	—	C	
19727	E.A3.31.39	WEIGHT , mass balance						1	S.92	C/MR	
19728	E.A3.31.41	WEIGHT , mass balance						QR	S.92	C/MR	TU.2
10050	E.A1.31.83	HOUSING , bearing, tab spar						1	L.40	C	TU.2
1531	E.A1.31.679	MEMBER , trailing edge						1	L.72	C/MR	
10061	E.A1.31.325	PACKING , trailing edge						8	Balsa Wood	C	
10074	E.A1.31.499	PANEL , skin top						1	—	C/MR	
10075	E.A1.31.501	PANEL , skin bottom						1	—	C/MR	
10042	E.A1.31.25	RIB , No. 2, 3 and 4						3	—	C/MR	
10044	E.A1.31.29	RIB , No. 5, tab hinge						1	—	C/MR	
10045	E.A1.31.31	RIB , No. 9, tab hinge						1	—	C/MR	
1468	EEAS.1/2C	SCREW , 2 BA						2	S.11	C	
1033	EEAS.1/2½E	SCREW , ½" BSF						8	S.11	C	
	E.A1.31.15	SPAR, ELEVATOR MAIN, PORT, ASSEMBLY						1	—	MR	
		Spares for:—									
19707	E.A1.31.53	BRACKET , hinge, elevator, centre						1	DTD.300	C	
5206	E.A1.31.169	BRACKET, BEARING, C/W BALLRACE, ASSEMBLY						1	—	B	TU.2
		Spares for:—									
1042	EEAS.3/K	HOUSING						1	—	C	
19717	E.A1.31.421	BUSH , balance weight arm						1	S.95	C/MR	
19711	E.A1.31.149	HINGE , elevator, inboard						1	L.45	C/MR	
6940	E.A1.31.317	MOUNTING, TAB, TORQUE TUBE, ASSEMBLY						1	—	C	
		Spares for:—									
13245	E.A1.31.215	LEVER , stop pin						1	S.11	C	
1091	EEAS.37/8A	NIPPLE , 4 BA						8	S.11	C	
5032	E.A1.31.303	SHIM						1	ALUM.	C	
	E.A9.31.89	SHIM , laminated, 0"003, ⅛" thick						2	S.11	LM	
	E.A9.31.81	SHIM , laminated, 0"003, ⅛" thick						2	S.11	LM	
		(Make from 30B/2443)									
338	E.A1.31.91	SPIGOT , hinge						2	S.11	C	
	EEAS.38/2A	SPOKE , 4 BA (Make from Ref. 28R/6124)						4	S.11	LM	
	HOFFMANN										
28R/13507	CF.2	END-ROD						1	—	C	
5982	E.A1.31.159	LEVER, COUPLING AND CONTROL OPERATING ROD, C/W BALLRACE (PRE-MOD. 2705)						1	—	B	TU.2
37749	E.A9.31.45	LEVER, COUPLING AND CONTROL OPERATING ROD, C/W BALLRACE (MOD. 2705)						1	—	B	
		Spares for:—									
2A/9500467	SKEFKO CBA.3	BEARING , ballrace						1	—	C	
		Attaching parts for E.A1.31.159 and E.A9.31.45:—									
28D/1011242	A25/7E	Bolt , ½" BSF						4	—	C	
28D/1010031	A25/8E	Bolt , ⅜" BSF						5	—	C	
28M/1011475	A27/EP	Nut , ½" BSF						9	—	C	

**TAIL UNIT
TAILPLANE AND ELEVATORS**

Ref. No.	Part No.	Description	No. Off	Matl Spec.	Cl. of Equip.	Plate No.
					M.R. L.M.	
		1 2 3 4 5 6				
2115	E.A1.31.691	LEVER, elevator, tab, operating	1	L.40 or DTD.684	C	TU.2
10077	E.A1.31.155	LINK, restricting, operating lever travel	2	L.72	C	TU.2
2106	E.A1.31.211	NUT, special, clamp, torque tube	1	S.1	C	
340	E.A1.31.363	PLUG, elevator, mechanism inspection	2	—	C	TU.2
25608	E.A3.30.273	ROD, CONNECTING, BETWEEN ELEVATOR TAB AND OPERATING LEVER, ASSEMBLY (MOD. 2125)	1	—	B	TU.2
		Spares for:—				
342	E.A1.31.101	END, piece, ball bearing rod connecting (Made from Ref. 28R/13507)	1	—	C	
395	E.A1.31.99	END, piece	1	DTD.683	C	
343	E.A1.31.277	SHIM, tab hinge bracket	1	ALUM.	C	
	or					
22976	EEAS.27/8/4	SHIM, hinge bracket	1	ALUM.	C	
3369	E.A1.31.5	TAB, ELEVATOR, PORT, ASSEMBLY (PRE-MOD. 2182 AND 4077)	1	—	A	
26518	E.A9.31.5	TAB, ELEVATOR, PORT, ASSEMBLY (MOD. 2182)	1	—	A	
34718	E.A3.31.125	TAB, ELEVATOR, PORT, ASSEMBLY (MOD. 4077)	1	—	A	
1439173	E.A3.00.1073	TAB, ELEVATOR, PORT, ASSEMBLY (MOD. 4478) (PRE-MOD. 4853)	1	—	A	
	E.A3.00.5377	TAB, ELEVATOR, PORT, ASSEMBLY (MOD. 4853) (For Aircraft embodying Mod. 4077 not embodying Mod. 2182)	1	—	—	
		Spares for:—				
4679	E.A3.31.53	ARM, support, balance weight	8	L.40	C/MR	TU.2
4160	E.A1.45.49	BOLT, special, balance weight fixing	8	S.1	C/MR	
4162	E.A1.31.49	FITTING, tab hinge inter (inboard) (Pre-Mod. 2182)	1	L.40	C/MR	
	E.A9.31.9	FITTING, tab hinge inter (inboard) (Mod. 2182)	1	L.40	C/MR	
4155	E.A1.31.55	FITTING, tab hinge inter (outboard (Pre-Mod. 2182)	1	L.40	C/MR	TU.2
	E.A9.31.11	FITTING, tab hinge inter (outboard) (Mod. 2182)	1	L.40	C/MR	
4163	E.A1.31.57	FITTING, tab hinge inboard, end	1	—	C/MR	
4164	E.A3.31.23	FITTING, tab hinge outboard, end	1	L.40	C/MR	TU.2
334	E.A1.31.61	PIN, special, tab bearing	3	S.11	C	
343	E.A1.31.277	SHIM, balance weight, packing	4	ALUM.	C	
	or					
22976	EEAS.27/8/4	SHIM, balance weight, packing	4	ALUM.	C	
	E.A1.31.355	WEIGHT, balance	2	—	—	
	E.A1.31.445	WEIGHT, balance	2	—	—	
	E.A1.31.717	WEIGHT, balance, auxiliary	1	—	—	
12945	E.A3.31.117	TORQUE TUBE AND BLOW BACK ROD, ASSEMBLY (PRE-MOD. 2182)	1	—	A	
13242	E.A9.31.27	TORQUE TUBE AND BLOW BACK ROD, ASSEMBLY (MOD. 2182)	1	—	A	
		Consisting of:—				
5983	E.A1.31.167	BRACKET, bearing	1	—	B/MR	
5984	E.A1.31.443	LEVER, operating	1	—	B/MR	
28M/5808573	A27/CS	NUT, 2 BA	4	—	C	
28M/13451	A29/JS	NUT, 3/8" BSF	1	—	C	
28P/9527619	SP.90/C7	PIN, split	5	—	C	
2107	E.A1.31.193	ROD, blow back (Pre-Mod. 2182)	1	—	B/MR	
26519	E.A9.31.19	ROD, blow back (Mod. 2182)	1	—	B/MR	
1030	EEAS.1/5C	SCREW, 2 BA	4	S.11	C	
2108	E.A1.31.199	TUBE, torsion	1	—	B/MR	
28W/9419404	SP.16/C	WASHER	4	—	C	

**TAIL UNIT
TAILPLANE AND ELEVATORS**

Ref. No.	Part No.	Description	No. Off	Matl Spec.	Cl. of Equip.	Plate No.
					M.R. L.M.	
		1 2 3 4 5 6				
30A/9140209	†	WIRE, locking, 20 SWG	QR	Soft Iron	C	
2992	E.A1.31.3	ELEVATOR, C/W TAB, STARBOARD, ASSEMBLY	1	—	A	TU.2
1439169	E.A3.00.1067	ELEVATOR, C/W TAB, STARBOARD, ASSEMBLY (MOD. 4478) (PRE-MOD. 4853)	1	—	A	
	E.A3.00.5371	ELEVATOR, C/W TAB, STARBOARD, ASSEMBLY (MOD. 4853)	1	—	—	
	E.A1.31.710	Spares for:— BALANCE MASS ELEVATOR, STARBOARD, ASSEMBLY	1	—	—	
	E.A1.31.713	Consisting of:— ARM, balance weight	1	S.95	—	
	E.A1.31.133	BOLT, special, make-up balance weight ...	2	M.S.	—	
	E.A1.31.705	PIN, special, locking, balance weight to arm ...	1	S.95	—	
19724	E.A1.31.707	PLUG, screwed end fitting	1	S.95	C/MR	
43227	E.A1.31.129	WEIGHT, balance make-up	1	G.E.C.	B	
	E.A1.31.712	WEIGHT, arm, balance	1	Heavy Metal G.E.C.	—	
30A/9140209	†	WIRE, locking, 20 SWG	QR	Soft Iron	C	
2A/9500463	SKEFKO CBA.2	BEARING, ballrace, elevator tab	1	—	C	
333	E.A1.31.63	BOLT, special, bearing tab hinge	1	S.11	C	
328	E.A1.31.65	BOLT, special, bearing con rod at joint ...	1	—	C	
346	E.A1.31.275	BOLT, special, stop	1	L.40	C	
28N/2001688	AGS.2030/22	CIRCLIP, internal, 25 m/m	1	—	C	
	E.A1.31.13	ELEVATOR, STARBOARD, ASSEMBLY	1	—	MR	
	E.A1.31.79	Spares for:— BRACKET, hinge	3	—	C	TU.2
	E.A1.31.485	COVER, hand hole, between elevator rib and hinge rib	1	L.72	C	TU.2
10069	E.A1.31.487	DIAPHRAGM, tab shroud	3	—	C/MR	
	E.A1.31.8	HORN, ELEVATOR, ASSEMBLY	1	—	MR	
	E.A1.31.52	Spares for:— BRACKET, horn	1	DTD.300	—	
10022	E.A1.31.551	PANEL, skin, top	1	—	C/MR	
10023	E.A1.31.552	PANEL, skin, bottom	1	—	C/MR	
1468	EEAS.1/2C	SCREW, 2 BA	3	S.96	C	
1029	EEAS.1/4C	SCREW, 2 BA	8	S.96	C	
10035	EEAS.1/4E	SCREW, 3/4" BSF	16	S.96	C	
338	E.A1.31.91	SPIGOT, hinge	1	S.11	C	
	E.A3.31.25	WEIGHT, ELEVATOR HORN BALANCE, ASSEMBLY	1	—	MR	
	E.A3.31.29	Consisting of:— BOLT, special	1	M.S.	C/MR	TU.2
19725	E.A3.31.27	DISC, balance weight	1	DTD.126A	C/MR	
19715	E.A1.31.333	DISC, balance weight	QR	L.64	C/MR	TU.2
	E.A1.31.339	HOUSING, balance weight	1	—	—	
28W/9419477	SP.15/J	WASHER, 3/8" BSF, plain	QR	—	C	
28W/9416198	SP.42/J	WASHER, tab	1	—	C	
19727	E.A3.31.39	WEIGHT, mass balance	1	S.92	C/MR	
19728	E.A3.31.41	WEIGHT, mass balance	QR	S.92	C/MR	TU.2
10050	E.A1.31.83	HOUSING, bearing, tab spar	1	L.40	C/MR	TU.2
1531	E.A1.31.679	MEMBER, trailing edge	1	L.72	C/MR	
10061	E.A1.31.325	PACKING, trailing edge	8	Balsa Wood	C	
10074	E.A1.31.499	PANEL, skin, top	1	—	C/MR	
10075	E.A1.31.501	PANEL, skin, bottom	1	—	C/MR	
10045	E.A1.31.31	RIB, No. 5 and 9, tab hinge	2	—	C/MR	

**TAIL UNIT
TAILPLANE AND ELEVATORS**

Ref. No.	Part No.	Description	No. Off	Mati Spec.	Cl. of Equip.	Plate No.
					M.R. L.M.	
1468	EEAS.1/2C	SCREW, 2 BA	4	S.11	C	
1033	EEAS.1/2½E E.A1.31.17	SCREW, ¼" BSF SPAR, ELEVATOR MAIN, STARBOARD, ASSEMBLY	6 1	S.11 —	C MR	
		Spares for:—				
19707	E.A1.31.53	BRACKET, hinge elevator, centre	1	DTD.300	C	
19717	E.A1.41.421	BUSH, balance weight arm	1	S.95	C/MR	
5207	E.A1.31.151	HINGE, elevator, inboard	1	L.45	C	
1091	EEAS.37/8A	NIPPLE, 4 BA	8	S.11	C	
338	E.A1.31.91	SPIGOT, hinge	1	S.11	C	
	EEAS.38/2A	SPIGOT, 4 BA (Make from Ref. 28R/6124) ...	4	S.11	LM	
21546	E.A1.31.351	LEVER, stop coupling arm attachment	1	DTD.683	C/MR	
10091	E.A1.31.271	LEVER, COUPLING CONTROL, ASSEMBLY (PRE-MOD. 2705) Consisting of:—	1	—	B	
346	E.A1.31.275	BOLT, special, stop	1	L.40	C	
5982	E.A1.31.159	LEVER	1	—	C	
28M/1007404	A27/JT	NUT, ¾" BSF	1	—	C	
37750	E.A9.31.47	LEVER, COUPLING CONTROL, ASSEMBLY (MOD. 2705) Consisting of:—	1	—	B	
346	E.A1.31.275	BOLT, special, stop	1	L.40	C	
37749	E.A9.31.45	LEVER	1	—	C	
28M/1007404	A27/JT	NUT, ¾" BSF	1	—	C	
		Attaching parts for E.A9.31.47:—				
28D/1011242	A25/7E	Bolt, ½" BSF	4	—	C	
28D/1010031	A25/8E	Bolt, ½" BSF	5	—	C	
28M/1011475	A27/EP	Nut, ½" BSF	9	—	C	
340	E.A1.31.363	PLUG, elevator mechanism inspection	2	—	C	TU.2
2922	E.A1.31.105	ROD, connecting, elevator tab gear	1	—	C	
343	E.A1.31.277	SHIM, connecting rod attachment tab	1	ALUM.	C	
	or					
22976	EEAS.27/8/4	SHIM, connecting rod attachment tab	1	—	C	
3370	E.A1.31.6	TAB, ELEVATOR, STARBOARD, ASSEMBLY (PRE-MOD. 4078)	1	—	A	TU.2
34719	E.A3.31.127	TAB, ELEVATOR, STARBOARD, ASSEMBLY (MOD. 4078)	1	—	A	
1439174	E.A3.00.1075	TAB, ELEVATOR, STARBOARD, ASSEMBLY (MOD. 4478) (PRE-MOD. 4853)	1	—	A	
	E.A3.00.5379	TAB, ELEVATOR, STARBOARD, ASSEMBLY (MOD. 4853) (For Aircraft embodying Mod. 4078) Spares for:—	1	—	—	
4679	E.A3.31.53	ARM, support, balance weight	12	L.40	—	TU.2
4160	E.A1.45.49	BOLT, special, balance weight fixing	12	—	C/MR	
4161	E.A1.31.50	FITTING, tab, hinge inter, inboard	1	L.40	C/MR	
4155	E.A1.31.55	FITTING, tab, hinge inter, outboard	1	L.40	C/MR	TU.2
4164	E.A3.31.23	FITTING, tab, hinge, outboard end	1	—	C/MR	TU.2
4165	E.A1.31.449	FITTING, tab, hinge, inboard end	1	—	C/MR	TU.2
334	E.A1.31.61	PIN, special, tab bearing	3	S.11	C	
343	E.A1.31.277	SHIM, balance weight packing	6	ALUM.	C	
	or					
22976	EEAS.27/8/4	SHIM, balance weight packing	6	—	C	

**TAIL UNIT
TAILPLANE AND ELEVATORS**

Ref. No.	Part No.	Description	No. Off	Matl Spec.	Cl. of Equip.	Plate No.
					M.R. L.M.	
		1 2 3 4 5 6				
	E.A1.31.353	WEIGHT, balance	4	—	—	
	E.A1.31.355	WEIGHT, balance	2	—	—	
	E.A1.31.718	WEIGHT, balance, auxiliary	1	—	—	
1077	EEAS.28/34JR	WASHER, special	1	—	C	
3075	E.A1.30.1147	FAIRING, DETACHABLE ROOT, PORT, ASSEMBLY (PRE-MOD. 1277)	1	—	C	TU.2
3076	E.A1.30.1148	FAIRING, DETACHABLE ROOT, STARBOARD, ASSEMBLY (PRE-MOD. 1277)	1	—	C	TU.2
13125	E.A9.00.377	FAIRING, DETACHABLE ROOT, PORT, ASSEMBLY (MOD. 1277)	1	—	B	
13126	E.A9.00.378	FAIRING, DETACHABLE ROOT, STARBOARD, ASSEMBLY (MOD. 1277)	1	—	B	
3085	E.A1.30.1107	PANEL, access, tailplane actuator	1	L.72	C	TU.2
3383	E.A3.31.43	LINK, connecting, elevator operating levers	1	DTD.683	C	TU.2
3384	E.A3.31.40	PLATE, locking, for serrated bush	1	S.95	C	
10990	E.A1.31.279	ROD, end, c/w ballrace tab operating	1	—	C	
31468	E.B8.31.31	SCREW, special, connecting, between con-rod and end piece (Mod. 3330)	1	—	C	
6942	E.B6.30.1	TAILPLANE, assembly (PRE-MOD. 1277)	1	—	A	
		Spares for:—				
4175	E.A1.30.297	BOLT, special, mounting, between main spar and tailplane structure bottom, port and starboard	4	S.65	C/MR	
4176	E.A1.30.299	BOLT, special, mounting, between main spar and tailplane structure top, port and starboard	4	S.65	C/MR	
4177	E.A1.30.321	BOLT, special, jointing at rib 3 to main spar bracket (Pre-Mod. 4783)	8	DTD.473	C/MR	
	E.A3.30.409	BOLT, special, jointing at rib 3 to main spar, bracket (Mod. 4783)	8	S.98	—	
4386	E.A1.30.323	BOLT, special, jointing at rib 1 to main spar ...	4	S.11	C	
10919	E.A1.30.413	BRACKET, TAILPLANE, ACTUATOR, CHANNEL ASSEMBLY	1	—	B	
		Spares for:—				
21343	E.A1.30.379	BOLT, special	4	S.65	C	
352	E.A1.30.279	BUSH, bearing	2	S.1	C	
353	E.A1.30.277	PIN, attachment	2	S.11	C	
13170*	E.A1.30.5	EDGE, LEADING, TAILPLANE, PORT, ASSEMBLY	1	—	B	
33683		(Supplied to Drg. E.A9.00.23 for spares purposes)				
		Spares for:—				
35893	E.B8.30.99	RIB, NO. 2, INSTALLATION, PORT (MOD. 2334)	1	—	MR	
		Spares for:—				
35895	E.B8.30.339	ANGLE, attachment	1	—	C/MR	
35912	E.B8.30.375	BOOM, tee	1	—	C/MR	
35914	E.B8.30.377	PACKING	1	—	C/MR	
	E.A9.30.81	RIB, No. 2	1	—	MR	
33521	E.B8.30.89	STIFFENER	1	—	C/MR	
10920	E.A1.30.69	RIB, NO. 3, ASSEMBLY	1	—	C/MR	
		Spares for:—				
12095	E.A1.30.171	LUG, attachment (Pre-Mod. 4783)	1	—	C	
12096	E.A1.30.172	LUG, attachment (Pre-Mod. 4783)	1	—	C	

**TAIL UNIT
TAILPLANE AND ELEVATORS**

Ref. No.	Part No.	Description						No. Off	Matl Spec.	Cl. of Equip. M.R. L.M.	Plate No.
		1	2	3	4	5	6				
	E.A1.30.44	SPAR, MAIN, ASSEMBLY						1	—	—	
	E.A1.30.388	Spares for:— BRACKET, SLINGING, ASSEMBLY						1	—	—	
5355	E.A1.30.355	Spares for:— DISC, sealing, assembly						1	—	C	
	E.A1.30.7	EDGE, TRAILING, TAILPLANE, PORT, ASSEMBLY						1	—	MR	
10962	E.A1.30.121	Spares for:— BOLT, special, mounting, centre hinge bracket						2	S.11	C/MR	
354	E.A1.30.49	BRACKET, HINGE, ELEVATOR, OUTBOARD, ASSEMBLY						1	—	B	
2A/9500441	SKEFKO B.A.L.½	Spares for:— BALLRACE						1	BSS.292	C	
355	E.A1.30.401	HOUSING, ballrace						1	DTD.683	C	
1774	EEAS.4/20G	WASHER, packing, 20 SWG						1	L.72	C	
356	E.A1.30.117	BRACKET, HINGE, ELEVATOR, CENTRE, PORT, ASSEMBLY						1	—	B	TU.2
2A/9500441	SKEFKO B.A.L.½	Spares for:— BALLRACE						1	BSS.292	C	
357	E.A1.30.399	HOUSING						1	DTD.683	C	
21689	E.A1.30.403	CHANNEL, reinforcing						1	—	C	
27136	E.A1.30.405	CHANNEL, reinforcing						1	—	C	
12920	E.A1.30.383	CUP, sealing, elevator lock recess						2	L.40	C	
	E.A1.30.93	RIB, NO. 3, ASSEMBLY						1	—	—	
12097	E.A1.30.173	Spares for:— LUG, attachment (Pre-Mod. 4783)						1	—	C	
12098	E.A1.30.174	LUG, attachment (Pre-Mod. 4783)						1	—	C	
	E.A3.30.407	LUG, attachment (Mod. 4783)						1	S.97	—	
	E.A3.30.408	LUG, attachment (Mod. 4783)						1	S.97	—	
28D/1008151	A25/4E	Attaching parts for E.A3.30.407 or E.A3.30.408:— Bolt, ¼" BSF						10	—	C	
28M/7002430	AGS.2002/E/1	Nut, ¼" BSF						10	—	C	
28W/9471273	SP.124/E	Washer						10	—	C	
5019	E.A1.30.261	SHIM, plate						1	—	C	
38762	E.A1.30.51	SPAR, FALSE, OUTBOARD, ASSEMBLY						1	—	MR	
21587	E.A1.30.353	Spares for:— BRACKET, SLINGING, ASSEMBLY						1	—	MR	
5355	E.A1.30.355	Spares for:— DISC, sealing, assembly						1	—	C	
	E.A1.30.8	EDGE, TRAILING, TAILPLANE, STARBOARD, ASSEMBLY						1	—	—	
10962	E.A1.30.121	Spares for:— BOLT, special, mounting, centre lever bracket						2	S.11	C/MR	
21573	E.A1.30.313	BOLT, special, mounting						2	S.11	C	
354	E.A1.30.49	BRACKET, HINGE ELEVATOR, OUTBOARD, ASSEMBLY						1	—	B	
2A/9500441	SKEFKO BAL.½	Spares for:— BALLRACE						1	—	C	
355	E.A1.30.401	HOUSING, ballrace						1	—	C	
1774	EEAS.4/20G	WASHER, packing, 20 SWG						1	L.72	C	
356	E.A1.30.117	BRACKET, HINGE ELEVATOR, CENTRE STARBOARD, ASSEMBLY						1	—	B	TU.2
2A/9500441	SKEFKO BAL.½	Spares for:— BALLRACE						1	—	C	
357	E.A1.30.399	HOUSING, ballrace						1	DTD.683	C	

Restricted

Ref. No.	Part No.	1	2	3	4	5	6	Description	No. Off	Matl Spec.	Cl. of Equip.	Plate No.
											M.R.	

Restricted

**TAIL UNIT
TAILPLANE AND ELEVATORS**

Ref. No.	Part No.	Description	No. off	Matl. Spec.	Cl. of Equip.	Plate No.
					M.R. L.M	
	E.A1.30.33	SPAR, MAIN TAILPLANE, CENTRE SECTION, ASSEMBLY	1	—	—	
		Spares for:—				
5869	E.A3.30.145	BUSH , hinge	4	S.99	C	
40071	E.A1.30.263	FORK , bottom	2	S.65	MR	
27460	E.A1.30.265	FORK , top	2	S.65	MR	
5020	E.A1.30.267	SHIM	4	ALUM.	C	
7207	E.A1.30.415	VANE , sealing, port	1	—	MR	
7239	E.A1.30.416	VANE , sealing, starboard	1	—	MR	
1073	EEAS.28/15JR	WASHER , 10 SWVG	8	L.72	C	
1077	EEAS.28/34JR	WASHER	4	—	C	
1079	EEAS.28/38JR	WASHER	4	—	C	
22288	E.A1.30.289	WASHER , fillet, actuator bracket	4	—	MR	
13127	E.A9.00.125	TAILPLANE, ASSEMBLY (MOD. 1277) (PRE-MOD. 2148)	1	—	A	
		Spares for this assembly are identical with those for assembly Part No. E.B6.30.1 on page 1292, except for the following additions				
		Add:—				
	E.A9.30.27	SEALING, TAILPLANE TO RUDDER STUB, PORT, GROUP (MOD. 1277)	—	—	—	
		Spares for:—				
24750	E.A3.30.265	PLATE , insert	1	—	C	
24752	E.A3.30.267	PLATE , insert	1	—	C	
24713	E.A9.30.35	SPRING-SEAL , assembly	1	—	C	
24715	E.A9.30.39	SPRING-SEAL , assembly	1	—	C	
	E.A9.30.28	SEALING TAILPLANE TO RUDDER STUB, STARBOARD, GROUP (MOD. 1277)	—	—	—	
		Spares for:—				
24751	E.A3.30.266	PLATE , insert	1	—	C	
24753	E.A3.30.268	PLATE , insert	1	—	C	
24714	E.A9.30.36	SPRING-SEAL , assembly	1	—	C	
24716	E.A9.30.40	SPRING-SEAL , assembly	1	—	C	
	E.A9.30.7	SEALING, TAILPLANE TO TAILPLANE STUB, PORT, GROUP (MOD. 1277)	—	—	—	
		Spares for:—				
24697	E.A9.30.9	BLOCK	1	—	C	
24699	E.A9.30.11	BLOCK	1	—	C	
24705	E.A9.30.17	BLOCK	1	—	C	
24707	E.A9.30.19	BLOCK	1	—	C	
24701	E.A9.30.13	PACKING	1	—	C	
24703	E.A9.30.15	PACKING	1	—	C	
24709	E.A9.30.21	PACKING	1	—	C	
24711	E.A9.30.23	PACKING	1	—	C	
	E.A9.30.8	SEALING TAILPLANE TO TAILPLANE STUB, STARBOARD, GROUP (MOD. 1277)	—	—	—	
		Spares for:—				
24698	E.A9.30.10	BLOCK	1	—	C	
24700	E.A9.30.12	BLOCK	1	—	C	
24706	E.A9.30.18	BLOCK	1	—	C	
24708	E.A9.30.20	BLOCK	1	—	C	

**TAIL UNIT
TAILPLANE AND ELEVATORS**

Ref. No.	Part No.							Description	No. off	Matl. Spec.	Cl. of Equip.		Plate No.
		1	2	3	4	5	6				M.R.	L.M.	
24702	E.A9.30.14							PACKING	1	—		C	
24704	E.A9.30.16							PACKING	1	—		C	
24710	E.A9.30.22							PACKING	1	—		C	
24712	E.A9.30.24							PACKING	1	—		C	
31025	E.A9.00.131							TAILPLANE, ASSEMBLY (MOD. 2148)	1	—		A	
Spares for this assembly are identical with those for assembly Part No. E.A9.00.125 on page 1295, except for the following deletions and additions Delete:—													
18609	E.A3.30.131							PLATE , closing, port (Pre-Mod. 2148)	1	—		MR	
18610	E.A3.30.132							PLATE , closing, starboard (Pre-Mod. 2148)	1	—		MR	
Add:—													
28723	E.A9.30.75							PLATE , closing, port (Mod. 2148)	1	—		MR	
28724	E.A9.30.76							PLATE , closing, starboard (Mod. 2148)	1	—		MR	

1257

Pages ~~1297~~ to 1306 not issued

AL 20 ~~1295~~

**TAIL UNIT
TAILPLANE AND ELEVATORS**

Ref. No.	Part No.	Description	No. off	Matl. Spec.	Cl. of Equip.	Plate No.
					M.R. L.M.	
		1 2 3 4 5 6				
SUMMARY OF STOCK ITEMS USED ON TAILPLANE AND ELEVATORS, ASSEMBLY						
28D/9133011	A25/2C	Bolt, 2 BA, hex. head, 0"65 long		C
28D/9133012	A25/3C	Bolt, 2 BA, hex. head, 0"75 long		C
28D/1200119	A25/4C	Bolt, 2 BA, hex. head, 0"85 long		C
28D/1011019	A25/8C	Bolt, 2 BA, hex. head, 1"25 long		C
28D/1008151	A25/4E	Bolt, 1/2" BSF, hex. head, 0"9 long		C
28D/1011240	A25/5E	Bolt, 1/2" BSF, hex. head, 1" long		C
28D/1011242	A25/7E	Bolt, 1/2" BSF, hex. head, 1"2 long		C
28D/1010031	A25/8E	Bolt, 1/2" BSF, hex. head, 1"3 long		C
28D/1202771	A25/4G	Bolt, 3/8" BSF, hex. head, 0"95 long		C
28D/1011256	A25/5G	Bolt, 3/8" BSF, hex. head, 1"05 long		C
28D/1011257	A25/7G	Bolt, 3/8" BSF, hex. head, 1"25 long		C
28D/1202326	A25/14J	Bolt, 3/8" BSF, hex. head, 2"15 long		C
28D/1011311	A25/10L	Bolt, 3/8" BSF, hex. head, 1"7 long		C
28D/1214091	AS.1242/2C	Bolt, 2 BA, c'sk. head, 0"57 long		C
28D/9709461	AS.1242/3C	Bolt, 2 BA, c'sk. head, 0"67 long		C
28D/1007976	AS.1242/4C	Bolt, 2 BA, c'sk. head, 0"77 long		C
28D/9140203	AS.1246/3C	Bolt, 2 BA, round head, 0"7 long		C
28N/9153394	AGS.899/6	Collar		C
28M/6039	A18/JS	Nut, 3/8" BSF, slotted		C
28M/9403520	A27/CP	Nut, 2BA, plain		C
28M/5808573	A27/CS	Nut, 2BA, slotted		C
28M/1006473	A27/CT	Nut, 2BA, thin		C
28M/1011475	A27/EP	Nut, 1/2" BSF, plain		C
28M/1011467	A27/ES	Nut, 1/2" BSF, slotted		C
28M/1007403	A27/ET	Nut, 1/2" BSF, thin		C
28M/1006939	A27/GP	Nut, 3/8" BSF, plain		C
28M/5808571	A27/GS	Nut, 3/8" BSF, slotted		C
28M/1011470	A27/GT	Nut, 3/8" BSF, thin		C
28M/1011476	A27/JS	Nut, 3/8" BSF, slotted		C
28M/1007404	A27/JT	Nut, 3/8" BSF, thin		C
28M/13811	A27/JTL	Nut, 3/8" BSF, thin		C
28M/7683	AGS.572/A	Nut, 1/2" BSF, thin, slotted		C
28M/9433473	AGS.2002/C/1	Nut, stiff, 2BA		C
28M/7002430	AGS.2002/E/1	Nut, stiff, 1/2" BSF		C
28M/9434253	AGS.2007/B/1	Nut, stiff, 4BA		C
28M/11957	AGS.2007/C/1	Nut, stiff, 2BA		C
28P/9527619	SP.90/C7	Pin, split, 3/8" dia. x 1" long		C
28P/19233	SP.90/E6	Pin, split, 3/8" x 1" long		C
28P/19235	SP.90/E10	Pin, split, 3/8" dia. x 1 1/2" long		C
28P/9520015	SP.90/G8	Pin, split, 1/2" dia. x 1 1/4" long		C
28P/19157	SP.90/G10	Pin, split, 1/2" dia. x 1 1/2" long		C
28P/901	SP.4Y/F11	Pin, shackle		C
28P/903	SP.4Y/F13	Pin, shackle		C
28S/9435716	A33/B12	Screw, 4 BA, c'sk. head, 3/8" long		C
28S/9140929	A33/C12	Screw, 2 BA, c'sk. head, 3/8" long		C
28S/1202768	A33/C16	Screw, 2 BA, c'sk. head, 1/2" long		C
28W/9419475	SP.15/C	Washer, 2 BA, plain		C
28W/9419405	SP.15/E	Washer, 1/2" BSF, plain		C
28W/9419476	SP.15/G	Washer, 3/8" BSF, plain		C

**TAIL UNIT
TAILPLANE AND ELEVATORS**

Ref. No.	Part No.	Description						No. off	Matl. Spec.	Cl. of Equip.		Plate No.
		1	2	3	4	5	6			M.R.	L.M.	
28W/9419477	SP.15/J	Washer		C		
28W/9419404	SP.16/C	Washer, 2 BA,	plain		C		
28W/9419487	SP.16/E	Washer, 1/2"	BSF, plain		C		
28W/9419489	SP.16/J	Washer, 1/2"	BSF, plain		C		
28W/9419491	SP.16/N	Washer, 1/2"	BSF, plain		C		
28W/9419492	SP.16/P	Washer, 1/2"	BSF, plain		C		
28W/9419493	SP.16/Q	Washer, 1/2"	BSF, plain		C		
28W/9416198	SP.42/J	Washer, tab		C		

Plate T.U.1

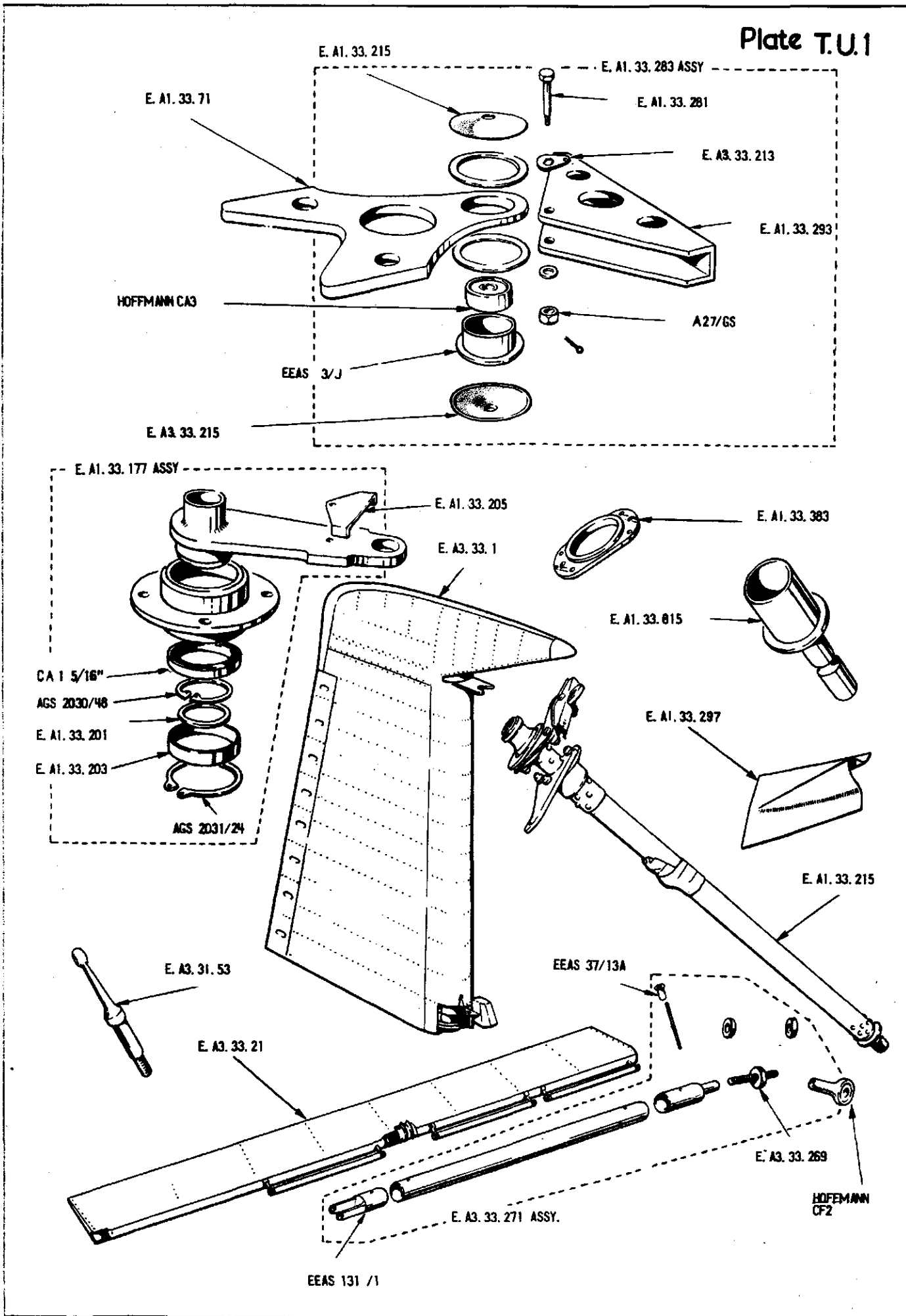

RUDDER AND TAB OPERATING GEAR

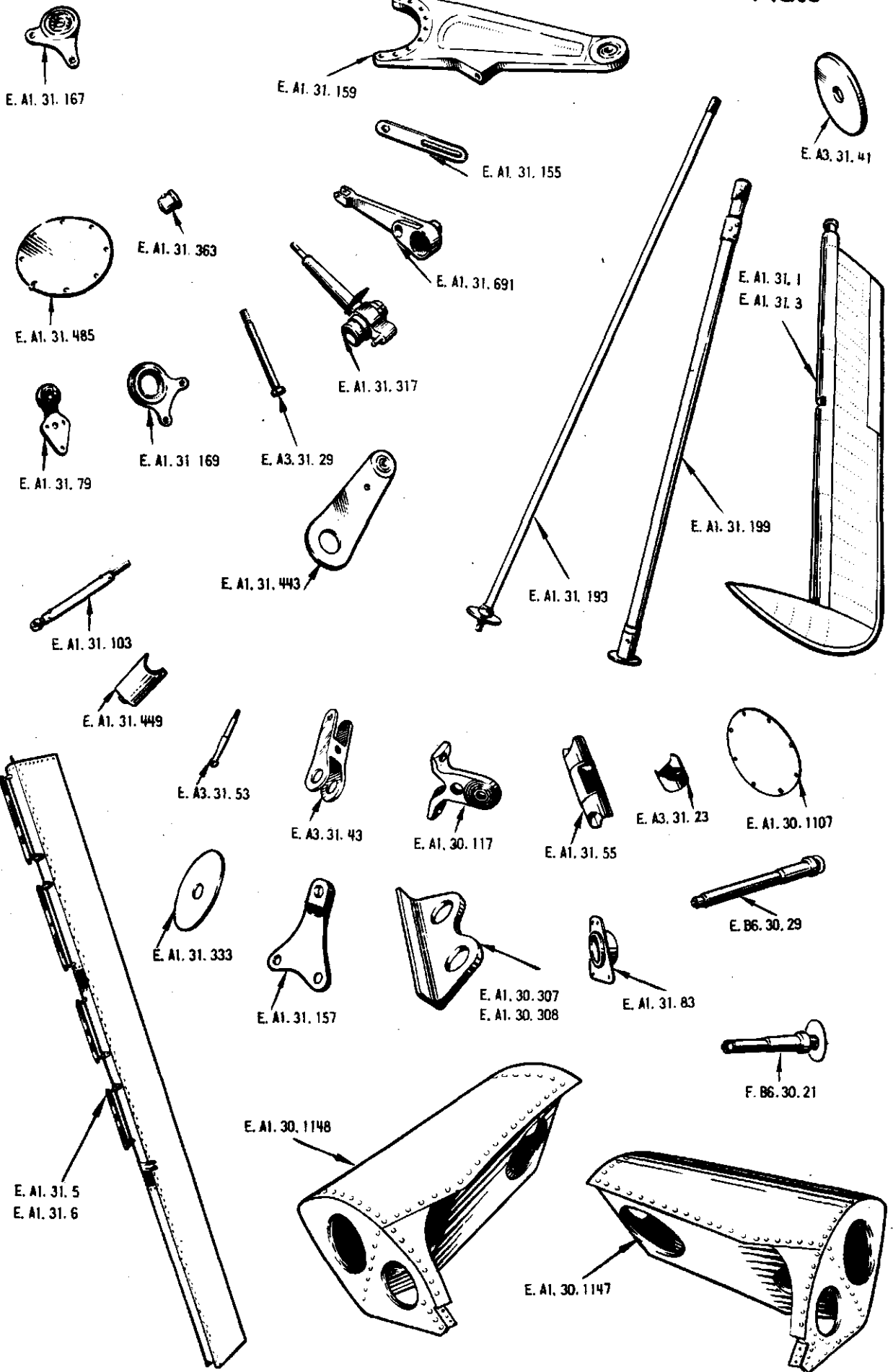

TAILPLANE AND ELEVATORS

This file was downloaded
from the RTFM Library.

Link: www.scottbouch.com/rtfm

Please see site for usage terms,
and more aircraft documents.

