

FLYING CONTROLS IN WING, PORT

Part Number	Description	No. Off	Mati. Spec.	Plate No.
EA1.45.13	CONTROLS, AILERON, IN WING, PORT, ASSEMBLY	-	-	
	Consisting of:-			
EA1.20.619	. ARM, CENTRE LEVER, AILERON CONTROL, ASSEMBLY	1	-	DD1/1
	Spares for:-			
EA1.20.621	. . ARM, CENTRE, LEVER, ASSEMBLY	2	-	DD1/2
	Consisting of:-			
SKEFKO CBA2	. . . BEARING, ballrace	1	-	DD1/4
EEAS3D	. . . HOUSING, ballrace	1	L40	DD1/5
EA1.20.469	. . . LEVER	1	L40	DD1/3
EEAS4/20C	. . . WASHER, packing	2	DTD390	DD1/6
	Attaching parts for EA1.20.621:-			
EA3.45.449	. . Bolt, special	3	S95	DD1/7
A27CS	. . Nut, slotted, 2BA	3	-	DD1/7A
SP90C7	. . Pin, split, 1/16" dia	3	-	DD1/7B
SP13C	. . Washer	3	-	DD1/7C
EA1.20.345	. . MOUNTING, C/W BOSS, ASSEMBLY	1	-	DD1/7D
	Spares for:-			
SKEFKO CBS3	. . . BEARING, ballrace	2	-	DD1/8
EA1.20.579	. . . BOSS, lever	1	L40	DD1/9
	Attaching parts for EA1.20.579:-			
EA1.20.467	. . . Bolt, special	1	L40	DD1/11
A29JS	. . . Nut, slotted, 3/8" BSF	1	-	DD1/11A
SP90C7	. . . Pin, split, 1/16" dia	1	-	DD1/11B
SP15J	. . . Washer	1	-	DD1/11C
EA1.20.465	. . . BRACKET, wall	2	-	DD1/11D
EA1.20.463	. . . TUBE, distance	1	L40	DD1/10
EA1.20.281	. BOSS AND LEVERS, AILERON CONTROL HINGE ON RIB 4, CENTRE WING, ASSEMBLY	1	-	DD1/11E
	Spares for:-			
EA1.20.641	. . BOSS AND LEVER, ASSEMBLY	1	-	DD1/11F
	Spares for:-			
SKEFKO CBS3	. . . BEARING, ballrace	2	-	DD1/11G
EA1.20.607	. . . BOSS	1	L40	DD1/11H
EA1.20.615	. . . BUSH, distance	1	-	DD1/11J
EA1.20.639	. . . LEVER, assembly	1	-	DD1/11K
	Attaching parts for EA1.20.639:-			
A25/5C	. . . Bolt, 2BA	3	-	DD1/11L
A27CP	. . . Nut, 2BA	3	-	DD1/11M
SP16C	. . . Washer	3	-	DD1/11N
	Attaching parts for EA1.20.641:-			
EA1.20.609	. . Bolt, special	1	-	DD1/11P
A29JS	. . Nut, slotted, 3/8" BSF	1	-	DD1/11R
SP90C7	. . Pin, split, 1/16" dia	1	-	DD1/11S
SP15J	. . Washer	1	-	DD1/11T

CONTROLS
FLYING CONTROLS IN WING, PORT

Part Number	Description	No. Off	Mtl. Spec.	Plate No.
EA1.20.633	. BOSS AND LEVERS, AILERON CONTROL HINGE ON RIB 4, OUTER WING, ASSEMBLY (PRE-MOD 5028)	1	-	
EA3.20.2579	. BOSS AND LEVERS, AILERON CONTROL HINGE ON RIB 4, OUTER WING, ASSEMBLY (MOD 5028) (For aircraft not embodying Mod 5100) Spares for:-	1	-	
SKEFKO CBS3 EA3.20.3209	. . BEARING, ballrace . BOSS AND LEVERS, AILERON CONTROL HINGE ON RIB 4, OUTER WING, ASSEMBLY (MOD 4956) (For aircraft embodying Mod 5100) Spares for:-	2 1	- -	DD1/12
EA3.20.3211	. . ARM, curved Attaching parts for EA3.20.3211:-	1	-	DD1/12D
AS1242/4E	. . Bolt, 1/4" BSF	6	-	DD1/30
A27ES	. . Nut, slotted, 1/4" BSF	6	-	DD1/31
SP90C8	. . Pin, split	6	-	DD1/32
EA3.20.3215	. . ARM, straight Attaching parts for EA3.20.3215:-	1	-	DD1/12E
AS1242/4E	. . Bolt, 1/4" BSF	6	-	DD1/33
A27ES	. . Nut, slotted, 1/4" BSF	6	-	DD1/34
SP90C8	. . Pin, split	6	-	DD1/35
SKEFKO CBS3 EA3.20.3233	. . BEARING, ballrace	2	-	DD1/12A
EA1.20.599	. . BOSS	1	-	DD1/12B
EA3.20.3219	. . BUSH, distance	1	-	DD1/12C
AS1242/2C	. . GUARD, assembly Attaching parts for EA3.20.3219:-	1	-	DD1/36
EA3.20.3227	. . Bolt, 2BA	2	-	DD1/37
EA1.20.601	. . RING, radius Attaching parts for EA1.20.633, EA3.20.2579 and EA3.20.3209	2	-	DD1/38
A29JS	. . Bolt, special	1	-	DD1/12F
SP90C7	. . Nut, slotted, 3/8" BSF	1	-	DD1/12G
SP15J	. . Pin, split, 1/16" dia	1	-	DD1/12H
	. . Washer	1	-	DD1/12J
R EA1.20.603	. LEVER, AILERON CONTROL ASSEMBLY Spares for:-	1	-	DD1/13
R EA1.20.641	. . BOSS AND LEVER ASSEMBLY Spares for:-	1	-	DD1/14
R CBS3	. . BEARING, ballrace	2	-	DD1/15D
R EA1.20.607	. . BOSS	1	L40	DD1/16
R EA1.20.615	. . BUSH, distance	1	-	DD1/16A
R EA1.20.639	. . LEVER, assembly Attaching parts for EA1.20.639:-	1	-	DD1/15
R A25/5C	. . Bolt, 2BA	3	-	DD1/15A
R A27CP	. . Nut, 2BA	3	-	DD1/15B
R SP16C	. . Washer	3	-	DD1/15C
R EA1.20.609	. . Attaching parts for EA1.20.641:-	1	L40	DD1/17
R A29JS	. . Bolt, special	1	-	DD1/17A
R SP90C7	. . Nut, slotted, 3/8" BSF	1	-	DD1/17C
R SP15J	. . Pin, split	1	-	DD1/17B
	. . Washer	1	-	DD1/17B

AP101B-0415-3A

CONTROLS

FLYING CONTROLS IN WING, PORT

Part Number	Description	No. Off	Mati. Spec.	Plate No.
EA3.45.321	. TUBE, CONTROL, FROM HINGE MOUNTING ON RIB 4, OUTER WING TO AILERON OPERATING LEVER, ASSEMBLY (PRE-MOD 4930)	1	-	DD1/18
EA3.45.655	. TUBE, CONTROL, FROM HINGE MOUNTING ON RIB 4, OUTER WING TO AILERON OPERATING LEVER, ASSEMBLY (MOD 4930) (PRE-MOD 5473)	1	-	
R R EA3.45.731	. TUBE, CONTROL, FROM HINGE MOUNTING ON RIB 4, OUTER WING TO AILERON OPERATING LEVER, ASSEMBLY (MOD 5473) Spares for:-	1	-	
R R EA3.45.327	. . COUPLING (PRE-MOD 5473)	1	-	DD1/18A
R R EA3.45.817	. . COUPLING (MOD 5473) Attaching parts for EA3.45.327 or EA3.45.817:-	1	-	
EEAS37/13A	. . Nipple	8	-	DD1/18B
EEAS38/1A	. . Spoke	4	-	DD1/18C
R R EA3.45.325	. . FORK-END (PRE-MOD 5473)	1	-	DD1/18D
R R EA3.45.815	. . FORK-END (MOD 5473) Attaching parts for EA3.45.325 or EA3.45.815:-	1	-	
EEAS37/13A	. . Nipple	8	-	DD1/18E
EEAS38/1A	. . Spoke	4	-	DD1/18F
EA1.45.201	. . FORK-END	1	-	DD1/19
A27NT	. . NUT, thin, 1/2" BSF	1	-	DD1/20
R R EA3.45.323	. . TUBE (PRE-MOD 5473)	1	-	DD1/18G
EA3.45.777	. . TUBE (MOD 5473)	1	-	
EA3.45.397	. TUBE, CONTROL, BETWEEN FUSELAGE AND OPERATING LEVER AT RIB 4, CENTRE WING, ASSEMBLY (PRE-MOD 4930)	1	-	DD1/21
EA3.45.687	. TUBE, CONTROL, BETWEEN FUSELAGE AND OPERATING LEVER AT RIB 4, CENTRE WING, ASSEMBLY (MOD 4930) (PRE-MOD 5473)	1	-	
R R EA3.45.757	. TUBE, CONTROL, BETWEEN FUSELAGE AND OPERATING LEVER AT RIB 4, CENTRE WING, ASSEMBLY (MOD 5473)	1	-	
R R EEAS128	. . END-FITTING (PRE-MOD 5473)	1	-	DD1/21A
R R EA3.45.769	. . END-FITTING (MOD 5473) Attaching parts for EEAS128 or EA3.45.769:-	1	-	
EEAS37/13A	. . Nipple	4	-	DD1/21B
EEAS38/1A	. . Spoke	2	-	DD1/21C
EEAS47/2	. . FORK-END, adjusting	1	-	DD1/21D
R R EEAS131/2	. . FORK-END, (PRE-MOD 5473)	1	-	DD1/21E
R R EA3.45.765	. . FORK-END (MOD 5473) Attaching parts for EEAS131/2 or EA3.45.765:-	1	-	
EEAS37/13A	. . Nipple	6	-	DD1/21F
EEAS38/1A	. . Spoke	3	S96	DD1/21G
A29NP	. . NUT, 1/2" BSF	1	-	DD1/21H
R R EA3.45.399	. . TUBE (PRE-MOD 5473)	1	-	DD1/21J
R R EA3.45.797	. . TUBE (MOD 5473)	1	-	

CONTROLS
FLYING CONTROLS IN WING, PORT

Part Number	Description	No. Off	Mati. Spec.	Plate No.
EA3.45.401	. TUBE, CONTROL, BETWEEN OPERATING LEVER ON RIB 4, AND CENTRE LEVER, CENTRE, WING, ASSEMBLY (PRE-MOD 4930)	1	—	DD1/22
EA3.45.689	. TUBE, CONTROL, BETWEEN OPERATING LEVER ON RIB 4, AND CENTRE LEVER, CENTRE, WING, ASSEMBLY (MOD 4930) (PRE-MOD 5473)	1	—	
R R EA3.45.759	. TUBE, CONTROL, BETWEEN OPERATING LEVER ON RIB 4 AND CENTRE LEVER, CENTRE WING, ASSEMBLY (MOD 5473) Spares for:—	1	—	
R R EEAS131/2	. . . FORK-END (PRE-MOD 5473)	2	—	DD1/22A
R R EA3.45.765	. . . FORK-END (MOD 5473) Attaching parts for EEAS131/2 or EA3.45.765:—	2	—	
EEAS37/13A	. . . Nipple	6	—	DD1/22B
EEAS38/1A	. . . Spoke	3	—	DD1/22C
R R EA3.45.403	. . . TUBE (PRE-MOD 5473)	1	—	DD1/22D
R EA3.45.799	. . . TUBE (MOD 5473)	1	—	
EA3.45.405	. TUBE, CONTROL, FROM CENTRE LEVER TO LEVER, BETWEEN RIBS 2 & 2B, OUTER WING, ASSEMBLY (PRE-MOD 4930)	1	—	DD1/23
EA3.45.691	. TUBE, CONTROL, FROM CENTRE LEVER TO LEVER BETWEEN RIBS 2 & 2B, OUTER WING, ASSEMBLY (MOD 4930) (PRE-MOD 5473)	1	—	
R R EA3.45.761	. TUBE, CONTROL, FROM CENTRE LEVER TO LEVER BETWEEN RIBS 2 & 2B, OUTER WING, ASSEMBLY (MOD 5473) Spares for:—	1	—	
R R EEAS131/2	. . . FORK-END (PRE-MOD 5473)	2	—	DD1/23A
R EA3.45.765	. . . FORK-END (MOD 5473) Attaching parts for EEAS131/2 or EA3.45.765:—	2	—	
EEAS37/13A	. . . Nipple	6	—	DD1/23B
EEAS38/1A	. . . Spoke	3	—	DD1/23C
R R EA3.45.407	. . . TUBE (PRE-MOD 5473)	1	—	DD1/23D
R EA3.45.801	. . . TUBE (MOD 5473)	1	—	
EA3.45.409	. TUBE, CONTROL, FROM LEVER BETWEEN RIBS 2 & 2B TO RIB 4, OUTER WING ASSEMBLY (PRE-MOD 4930)	1	—	DD1/24
EA3.45.693	. TUBE, CONTROL, FROM LEVER BETWEEN RIBS 2 & 2B TO RIB 4, OUTER WING ASSEMBLY (MOD 4930) (PRE-MOD 5473)	1	—	
R R EA3.45.763	. TUBE, CONTROL, FROM LEVER BETWEEN RIBS 2 & 2B TO RIB 4, OUTER WING ASSEMBLY (MOD 5473) Spares for:—	1	—	
R R EEAS131/2	. . . FORK-END (PRE-MOD 5473)	2	—	DD1/24A
R EA3.45.765	. . . FORK-END (MOD 5473) Attaching parts for EEAS131/2 or EA3.45.5473:—	2	—	
EEAS37/13A	. . . Nipple	6	—	DD1/24B
EEAS38/1A	. . . Spoke	3	—	DD1/24C
R R EA3.45.411	. . . TUBE (PRE-MOD 5473)	1	—	DD1/24D
R EA3.45.803	. . . TUBE (MOD 5473) Attaching parts for control tubes:—	1	—	
EEAS13/1	. Bolt, special	2	—	DD1/25
EEAS14	. Bush, bearing	2	—	DD1/26
EEAS63E	. Nut, bearing	2	—	DD1/27
EEAS127	. Piece, distance	2	—	DD1/28
SP90C7	. Pin, split, 1/16" dia	2	—	DD1/29

FLYING CONTROLS IN WING, STARBOARD

Part Number	Description	No. Off	Mati. Spec.	Plate No.
EA1.45.14	CONTROLS, AILERON IN WING, STARBOARD, ASSEMBLY	—	—	
EA1.20.620	Consisting of:— ARMS, CENTRE LEVER, AILERON CONTROL, ASSEMBLY	1	—	DE1/1
EA1.20.621	Spares for:— ARM, CENTRE, LEVER, ASSEMBLY	2	—	DE1/2
SKEFKO CBA2	Consisting of:— BEARING, ballrace	1	—	DE1/4
EEAS3D	HOUSING, ballrace	1	L40	DE1/5
EA1.20.469	LEVER	1	L40	DE1/3
EEAS4/20C	WASHER, packing	2	L72	DE1/6
EA3.45.449	Attaching parts for EA1.20.621:— Bolt, special	3	S95	DE1/7
A27CS	Nut, slotted, 2BA	3	—	DE1/7A
SP90C7	Pin, split, 1/16" dia	3	—	DE1/7B
SP13C	Washer	3	—	DE1/7C
EA1.20.346	MOUNTING, C/W BOSS, ASSEMBLY	1	—	DE1/7D
SKEFKO CBS3	Spares for:— BEARING, ballrace	2	—	DE1/8
EA1.20.579	BOSS, lever	1	L40	DE1/9
EA1.20.467	Attaching parts for EA1.20.579:— Bolt, special	1	L40	DE1/11
A29JS	Nut, slotted, 3/8" BSF	1	—	DE1/11A
SP90C7	Pin, split, 1/16" dia	1	—	DE1/11B
SP15J	Washer	1	—	DE1/11C
EA1.20.465	BRACKET	2	—	DE1/11D
EA1.20.463	TUBE, distance	1	L40	DE1/10
EA1.20.282	BOSS AND LEVER, AILERON CONTROL HINGE ON RIB 4, CENTRE WING ASSEMBLY	1	—	DE1/11E
EA1.20.641	Spares for:— BOSS AND LEVER, ASSEMBLY	1	—	DE1/11F
SKEFKO CBS3	Spares for:— BEARING, ballrace	2	—	DE1/11G
EA1.20.607	BOSS	1	L40	DE1/11H
EA1.20.615	BUSH, distance	1	—	DE1/11J
EA1.20.639	LEVER, assembly	1	—	DE1/11K
A25/5C	Attaching parts for EA1.20.639:— Bolt, 2BA	3	—	DE1/11L
A27CP	Nut, 2BA	3	—	DE1/11M
SP16C	Washer	3	—	DE1/11N
EA1.20.609	Attaching parts for EA1.20.641:— Bolt, special	1	—	DE1/11P
A29JS	Nut, slotted, 3/8" BSF	1	—	DE1/11R
SP90C7	Pin, split, 1/16" dia	1	—	DE1/11S
SP15J	Washer	1	—	DE1/11T

FLYING CONTROLS IN WING, STARBOARD

Part Number	Description	No. Off	Mati. Spec.	Plate No.
EA1.20.634	. BOSS AND LEVERS, AILERON CONTROL HINGE ON RIB 4, OUTER WING ASSEMBLY (PRE-MOD 5028)	1	-	
EA3.20.2580	. BOSS AND LEVERS, AILERON CONTROL HINGE ON RIB 4, OUTER WING ASSEMBLY (MOD 5028) (For aircraft not embodying Mod 5100) Spares for:-	1	-	
SKEFKO CBS3	. . BEARING, ballrace	2	-	
EA3.20.3210	. BOSS AND LEVERS, AILERON CONTROL HINGE ON RIB 4, OUTER WING ASSEMBLY (MOD 4956) (For aircraft embodying Mod 5100) Spares for:-	1	-	DE1/12
EA3.20.3212	. . ARM, curved Attaching parts for EA3.20.3212:-	1	-	DE1/12D
AS1242/4E	. . Bolt, 1/4" BSF	6	-	DE1/30
A27ES	. . Nut, slotted, 1/4" BSF	6	-	DE1/31
SP90C8	. . Pin, split	6	-	DE1/32
EA3.20.3215	. . ARM, straight Attaching parts for EA3.20.3215:-	1	-	DE1/12E
AS1242/4E	. . Bolt, 1/4" BSF	6	-	DE1/33
A27ES	. . Nut, slotted, 1/4" BSF	6	-	DE1/34
SP90C8	. . Pin, split	6	-	DE1/35
SKEFKO CBS3	. . BEARING, ballrace	2	-	DE1/12A
EA1.20.3233	. . BOSS	1	-	DE1/12B
EA1.20.599	. . BUSH, distance	1	-	DE1/12C
EA3.20.3220	. . GUARD, assembly Attaching parts for EA3.20.3220:-	1	-	DE1/36
AS1242/2C	. . Bolt, 2BA	2	-	DE1/37
EA3.20.3227	. . RING, radius Attaching parts for EA1.20.634, EA3.20.2580 and EA3.20.3210:-	2	-	DE1/38
EA1.20.601	. Bolt, special	1	-	DE1/12F
A29JS	. Nut, slotted, 3/8" BSF	1	-	DE1/12G
SP90C7	. Pin, split, 1/16" dia	1	-	DE1/12H
SP15J	. Washer	1	-	DE1/12J
R EA1.20.604	. LEVER, AILERON CONTROL ASSEMBLY Spares for:-	1	-	DE1/13
R EA1.20.641	. . BOSS AND LEVER ASSEMBLY Spares for:-	1	-	DE1/14
R CBS3	. . . BEARING, ballrace	2	-	DE1/15D
R EA1.20.607	. . . BOSS	1	L40	DE1/16
R EA1.20.615	. . . BUSH, distance	1	-	DE1/16A
R EA1.20.639	. . . LEVER, assembly Attaching parts for EA1.20.639:-	1	-	DE1/15
R A25/5C	. . . Bolt, 2BA	3	-	DE1/15A
R A27CP	. . . Nut, 2BA	3	-	DE1/15B
R SP16C	. . . Washer	3	-	DE1/15C
R EA1.20.609	. . . Bolt, special Attaching parts for EA1.20.641:-	1	L40	DE1/17
R A29JS	. . . Nut, slotted, 3/8" BSF	1	-	DE1/17A
R SP90C7	. . . Pin, split	1	-	DE1/17C
R SP15J	. . . Washer	1	-	DE1/17B

CONTROLS

FLYING CONTROLS IN WING, STARBOARD

Part Number	Description	No. Off	Mati. Spec.	Plate No.
EA3.45.321	. TUBE, CONTROL, FROM HINGE MOUNTING ON RIB 4, OUTER WING TO AILERON OPERATING LEVER, ASSEMBLY (PRE-MOD 4930)	1	-	DE1/18
EA3.45.655	. TUBE, CONTROL, FROM HINGE MOUNTING ON RIB 4, OUTER WING TO AILERON OPERATING LEVER, ASSEMBLY (MOD 4930) (PRE-MOD 5473)	1	-	
R R EA3.45.731	. TUBE, CONTROL, FROM HINGE MOUNTING ON RIB 4, OUTER WING TO AILERON OPERATING LEVER, ASSEMBLY (MOD 5473) Spares for:-	1	-	
R R EA3.45.327	. . COUPLING (PRE-MOD 5473)	1	-	DE1/18A
R EA3.45.817	. . COUPLING (MOD 5473) Attaching parts for EA3.45.327 or EA3.45.817:-	1	-	
EEAS37/13A	. . Nipple	8	-	DE1/18B
EEAS38/1A	. . Spoke	4	-	DE1/18C
R R EA3.45.325	. . FORK-END (PRE-MOD 5473)	1	-	DE1/18D
R EA3.45.815	. . FORK-END (MOD 5473) Attaching parts for EA3.45.325 or EA3.45.815:-	1	-	
EEAS37/13A	. . Nipple	8	-	DE1/18E
EEAS38/1A	. . Spoke	4	-	DE1/18F
EA1.45.201	. . FORK-END	1	-	DE1/19
A27NT	. . NUT, thin, 1/2" BSF	1	-	DE1/20
R EA3.45.323	. . TUBE (PRE-MOD 5473)	1	-	DE1/18G
R EA3.45.777	. . TUBE (MOD 5473)	1	-	
EA3.45.397	. TUBE, CONTROL, BETWEEN FUSELAGE AND OPERATING LEVER AT RIB 4, CENTRE WING, ASSEMBLY (PRE-MOD 4930)	1	-	DE1/21
EA3.45.687	. TUBE, CONTROL, BETWEEN FUSELAGE AND OPERATING LEVER AT RIB 4, CENTRE WING, ASSEMBLY (MOD 4930) (PRE-MOD 5473)	1	-	
R R EA3.45.757	. TUBE, CONTROL, BETWEEN FUSELAGE AND OPERATING LEVER AT RIB 4, CENTRE WING, ASSEMBLY (MOD 5473) Spares for:-	1	-	
R R EEAS128	. . END-FITTING (PRE-MOD 5473)	1	-	DE1/21A
R EA3.45.769	. . END-FITTING (MOD 5473) Attaching parts for EEAS128 or EA2.45.769:-	1	-	
EEAS37/13A	. . Nipple	4	-	DE1/21B
EEAS38/1A	. . Spoke	2	-	DE1/21C
EEAS47/2	. . FORK-END, adjusting	1	-	DE1/21D
R R EEAS131/2	. . FORK-END (PRE-MOD 5473)	1	-	DE1/21E
R EA3.45.765	. . FORK-END (MOD 5473) Attaching parts for EEAS131/2 or EA3.45.765 :-	1	-	
EEAS37/13A	. . Nipple	6	-	DE1/21F
EEAS38/1A	. . Spoke	3	S96	DE1/21G
R R A29NP	. . NUT, 1/2" BSF	1	-	DE1/21H
EA3.45.399	. . TUBE (PRE-MOD 5473)	1	-	DE1/21J
R EA3.45.797	. . TUBE (MOD 5473)	1	-	

CONTROLS

FLYING CONTROLS IN WING, STARBOARD

Part Number	Description	No. Off	Matl. Spec.	Plate No.
EA3.45.401	. TUBE, CONTROL, BETWEEN OPERATING LEVER ON RIB 4 AND CENTRE LEVER, CENTRE WING, ASSEMBLY (PRE-MOD 4930)	1	-	DE1/22
EA3.45.689	. TUBE, CONTROL, BETWEEN OPERATING LEVER ON RIB 4 AND CENTRE LEVER, CENTRE WING, ASSEMBLY (MOD 4930) (PRE-MOD 5473)	1	-	
EA3.45.759	. TUBE, CONTROL, BETWEEN OPERATING LEVER ON RIB 4 AND CENTRE LEVER, CENTRE WING ASSEMBLY (MOD 5473)	1	-	
EEAS131/2	. . FORK-END (PRE-MOD 5473)	2	-	DE1/22A
EA3.45.765	. . FORK-END (MOD 5473)	1	-	
	Attaching parts for EEAS131/2 or EA3.45.765:-			
EEAS37/13A	. . Nipple	6	-	DE1/22B
EEAS38/1A	. . Spoke	3	S96	DE1/22C
EA3.45.403	. . TUBE (PRE-MOD 5473)	1	-	DE1/22D
EA3.45.799	. . TUBE (MOD 5473)	1	-	
EA3.45.405	. TUBE, CONTROL, FROM CENTRE LEVER TO LEVER BETWEEN RIBS 2 & 2B, OUTER WING, ASSEMBLY (PRE-MOD 4930)	1	-	DE1/23
EA3.45.691	. TUBE, CONTROL, FROM CENTRE LEVER TO LEVER BETWEEN RIBS 2 & 2B, OUTER WING, ASSEMBLY (MOD 4930) (PRE-MOD 5473)	1	-	
EA3.45.761	. TUBE, CONTROL, FROM CENTRE LEVER TO LEVER BETWEEN RIBS 2 AND 2B OUTER WING ASSEMBLY (MOD 5473)	1	-	
	Spares for:-			
EEAS131/2	. . FORK-END (PRE-MOD 5473)	2	-	DE1/23A
EA3.45.765	. . FORK-END (MOD 5473)	2	-	
	Attaching parts for EEAS131/2 or EA3.45.765:-			
EEAS37/13A	. . Nipple	6	-	DE1/23B
EEAS38/1A	. . Spoke	3	S96	DE1/23C
EA3.45.407	. . TUBE (PRE-MOD 5473)	1	-	DE1/23D
EA3.45.801	. . TUBE (MOD 5473)	1	-	

CONTROLS

FLYING CONTROLS IN WING, STARBOARD

Part Number	Description	No. Off	Matl. Spec.	Plate No.
R EA3.45.410	. TUBE, CONTROL, FROM LEVER BETWEEN RIBS 2 AND 2B TO RIB 4, OUTER WING ASSEMBLY (PRE-MOD 4930)	1	-	DE1/24
R EA3.45.694	. TUBE, CONTROL, FROM LEVER BETWEEN RIBS 2 AND 2B AND 2B TO RIB 4, OUTER WING ASSEMBLY (MOD 4930) (PRE-MOD 5473)	1	-	
R EA3.45.764	. TUBE, CONTROL, FROM LEVER BETWEEN RIBS 2 AND 2B TO RIB 4 OUTER WING ASSEMBLY (MOD 5473) Spares for:-	1	-	
R EEAS131/2	. . FORK-END (PRE-MOD 5473)	2	-	DE1/24A
R EA3.45.765	. . FORK-END (MOD 5473) Attaching parts for fork-end:-	2	-	
R EEAS37/13A	. . Nipple	6	-	DE1/24B
R EEAS38/1A	. . Spoke	3	S96	DE1/24C
R EA3.45.412	. . TUBE (PRE-MOD 5473)	1	-	DE1/24D
R EA3.45.804	. . TUBE (MOD 5473) Attaching parts for control tubes:-	1	-	
R EEAS13/1	. Bolt, special	2	-	DE1/25
R EEAS14	. Bush, bearing	2	-	DE1/26
R EEAS63E	. Nut, special	2	-	DE1/27
R EEAS127	. Piece, distance	2	-	DE1/28
R SP90C7	. Pin, split	2	-	DE1/29

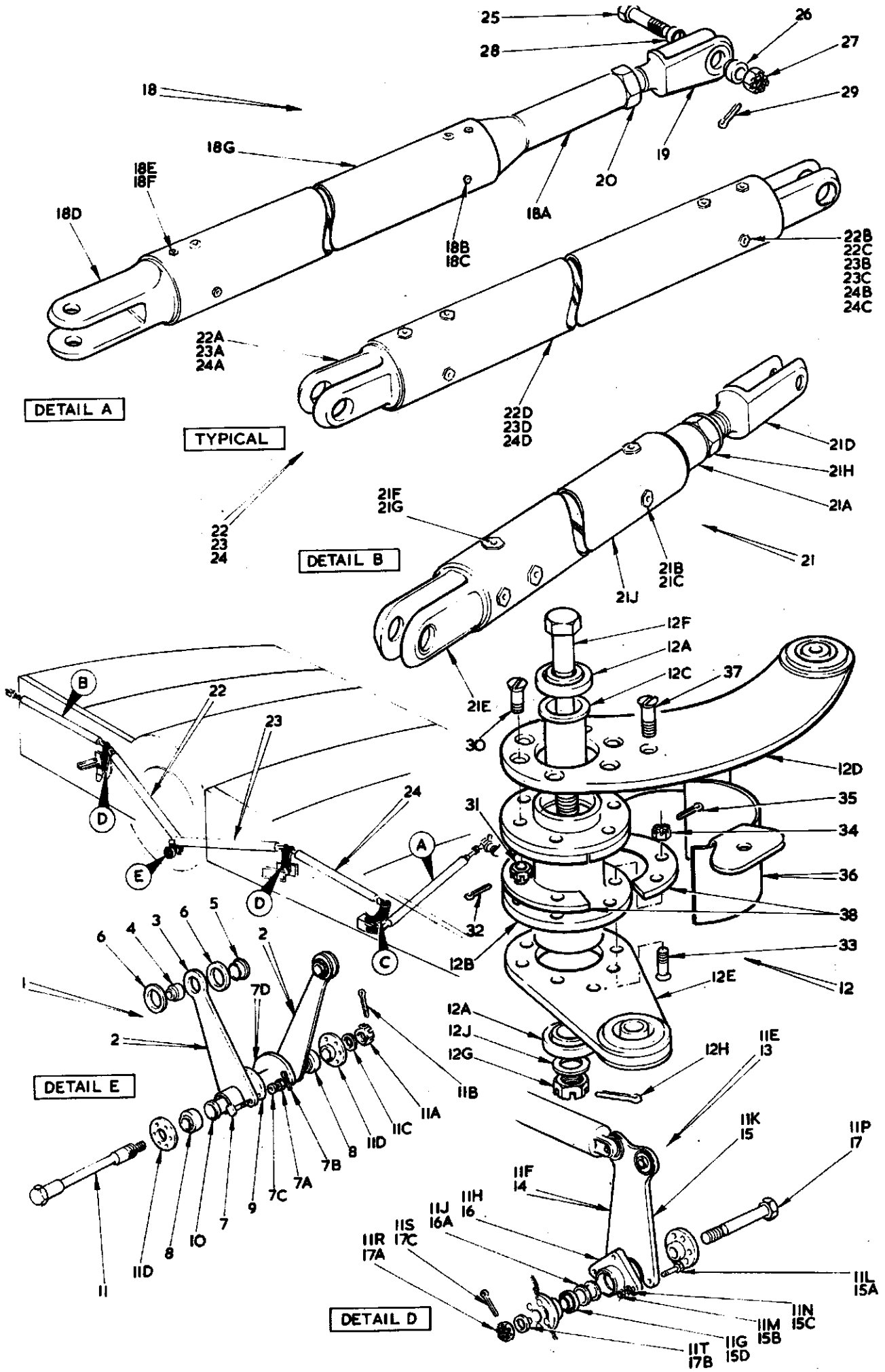

FIG. I AILERON CONTROLS IN WING

This file was downloaded
from the RTFM Library.

Link: www.scottbouch.com/rtfm

Please see site for usage terms,
and more aircraft documents.

