

**POWER INSTALLATION
COWLING, ENGINE, PORT**

Ref. No.	Part No.	Description	No. off	Matl Spec.	Cl. of Equip.	Plate No.
					M.R. L.M.	
		1 2 3 4 5 6				
	E.A6.50.493	COWLING, ENGINE, PORT, ASSEMBLY	—	—	—	
		Spares for:—				
626	E.A1.50.103	CLIP , toggle hook spring, top at station A	2	L.72	C	P.2
627	E.A1.50.105	CLIP , toggle hook spring, top at station B	2	L.72	C	P.2
		Attaching parts for E.A1.50.103 or E.A1.50.105:—				
28D/1007979	AS.1246/1B	Bolt, 4 BA	1	—	C	P.2
28M/1278189	AGS.2001/B/1	Nut, 4 BA	1	—	C	
28W/9419465	SP.13/B	Washer	1	—	C	
5689	E.A6.50.497	COWL, FRONT, ASSEMBLY (Supplied to Drg. No. E.B6.00.129 with trim allowance and pilot holes drilled for spares purposes)	1	—	A	
		Spares for:—				
38671	E.A3.00.957	AIR INTAKE, ASSEMBLY (E.A6.50.557)	1	—	B	
		Spares for:—				
	E.A6.50.519	FRAME, NO. 1, ASSEMBLY	1	—	—	
		Spares for:—				
	E.A6.50.551	RING , sealing (Make from EEAS.140, Ref. 20518)	1	—	LM	
25835	E.A6.50.967	ANGLE , duct extractor, L.H. (Mod. 2114)	1	—	C	
25839	E.A6.50.977	ANGLE , duct extractor, R.H. (Mod. 2114)	1	—	C	
5691	E.A6.50.815	BRACKET , pipe, anti-icing	1	L.72	C	
16444	E.A6.50.821	CLIP , bottom, anti-icing pipe	2	L.72	C	
16443	E.A6.50.819	CLIP , top, anti-icing pipe	2	L.72	C	
		Attaching parts for E.A6.50.821 or E.A6.50.819:—				
28D/9133012	A25/3C	Bolt, 2 BA	2	—	C	
28M/1278190	AGS.2001/C/1	Nut, 2 BA	2	—	C	
25569	E.A6.50.957	COVER , access, P.V. ram	1	L.72	C	
		Attaching parts for E.A6.50.957:—				
28D/1007975	AS.1242/1C	Bolt, 2 BA	12	—	C	
22444	E.A6.50.595	DUCT , stub, bottom bleed valve	2	—	C	
16434	E.A6.50.789	DUCT , extractor, inboard (Pre-Mod. 2114)	1	—	C	
16433	E.A6.50.787	DUCT , extractor, outboard (Pre-Mod. 2114)	1	—	C	
25837	E.A6.50.971	DUCT , extractor (Mod. 2114)	2	S.510	C	
		Attaching parts for E.A6.50.971:—				
28D/1010030	A25/7C	Bolt, 2 BA	3	—	C	
25838	E.A6.50.975	Spring	3	DTD.215	C	
16377	E.A6.50.511	LAND , nut ring, starter exhaust duct	3	—	C	
5690	E.A6.50.735	PANEL , access, bleed valve	1	—	C	
		Attaching parts for E.A6.50.735:—				
28D/1218444	AS.1242/1E	Bolt, 1/4" BSF	12	—	C	
20809	E.A6.50.949	PIPE , anti-icing, assembly	1	—	B	
		Attaching parts for E.A6.50.949:—				
5693	E.A6.50.921	Gasket, air duct end, Bestobell	1	M.4	C	
1025	EEAS.1/1C	Screw, 2 BA	1	—	C	
25836	E.A6.50.969	PLATE , doubling, external	2	—	C	
		Attaching parts for E.A6.50.969:—				
1129	E.A1.50.1051	Screw, special	41	S.96	C	P.2

**POWER INSTALLATION
COWLING, ENGINE, PORT**

Ref. No.	Part No.	Description						No. off	Matl Spec.	Cl. of Equip. M.R. L.M.	Plate No.
		1	2	3	4	5	6				
30858	E.A9.50.27	COWL, BOTTOM, REAR (LESS UNDERCARRIAGE COWL DOOR), ASSEMBLY (Supplied to Drg. No. E.A9.00.497 with trim allowance for spares purposes) Spares for:—						1	—	A	
4178	E.A1.50.65	BRACKET, forward hinge, u/c cowl door ...						1	DTD.683	C	
4171	E.A1.50.67	BRACKET, aft hinge, u/c cowl door ...						1	DTD.683	C	
		Attaching parts for E.A1.50.65 and E.A1.50.67:—									
28D/1011023	A25/20C	Bolt, 2 BA (As required) ...						4	—	C	
28D/1011024	A25/21C	Bolt, 2 BA (As required) ...						2	—	C	
28M/1006473	A27/CT	Nut, 2 BA ...						4	—	C	
28W/9419475	SP.15/C	Washer (As required) ...						4	—	C	
28W/9419404	SP.16/C	Washer (As required) ...						2	—	C	
	E.A9.50.29	COWL, BOTTOM REAR, ASSEMBLY ...						—	—	—	
		Spares for:—									
17710	E.B6.50.57	CLIP, pipe ...						1	—	C	
3815	E.A1.50.872	DUCT ...						1	—	C	
15075	E.A1.50.1591	DUCT ...						1	—	C	
15066	E.A1.50.975	FUNNEL, assembly, air duct ...						2	—	C	
3821	E.A1.50.1523	OUTLET, drain ...						1	—	C	
17708	E.B6.50.55	PIPE ...						1	—	C	
5182	E.A1.50.1601	PLATE, retaining, oil sump drain outlet ...						1	—	C	
	E.A6.50.923	SEAL, rubber (Make from EEAS.157, Ref. 17745) ...						QR	—	LM	
6122385	EEAS.120	SEAL, rubber ...						2	—	C	
	E.B6.50.129	SEAL, Neoprene, 1/4" thick (Make from Ref. 32C/9009171) ...						QR	—	LM	
	E.B6.50.143	SEAL, Neoprene, 1/4" thick (Make from Ref. 32C/9009171) ...						2	—	LM	
37413	E.A6.50.991	SPRING, drain outlet (Mod. 2670) ...						1	—	C	
5014	E.A1.50.1603	SPRING, drain outlet (Pre-Mod. 2670) ...						1	—	C	
5015	E.A1.50.981	SPRING, air duct outlet funnel ...						2	—	C	
15026	E.A1.50.315	DOOR, access, igniter plug ...						2	—	C	
3036	E.A1.50.317	DOOR, access, in bottom rear cowl ...						1	—	C	
3038	E.A1.50.319	DOOR, undercarriage cowl (Supplied with trim allowance all round for spares purposes) ...						1	—	C	
		Attaching parts for E.A1.50.319:—									
6149	E.A1.50.1075	Block, rubber, aft half hinge ...						1	—	C	
28N/9153394	AGS.899/6	Collar ...						2	—	C	
28P/5525	SP.4Z/F10	Pin, shackle ...						1	—	C	
28P/12348	SP.4Z/F18	Pin, shackle ...						1	—	C	
28P/9527619	SP.90/C7	Pin, split ...						2	—	C	
639	E.A1.50.365	Washer ...						2	L.46	C	
28FP/4062396	FJ5/60DS	FASTENER, Dzus ...						4	—	C	
28FP/4062398	FJ5/70DS	FASTENER, Dzus ...						4	—	C	
28FP/4062400	FJ5/80DS	FASTENER, Dzus ...						2	—	C	
634	E.A1.50.282	FASTENER, TOGGLE, ASSEMBLY (INBOARD) ...						2	—	C	
		Spares for:—									
16312	E.A1.50.95	HANDLE, TOGGLE FASTENER, ASSEMBLY ...						1	—	C	
		Spares for:—									
28E/9153406	TERRY 169/1"	RING, split ...						1	—	C	
635	E.A1.50.49	SPRING, 19 SWG ...						1	—	C	
		Attaching parts for E.A1.50.95:—									
16313	E.A1.50.155	Pin, stud, special ...						2	S.96	C	
28P/9527619	SP.90/C7	Pin, split ...						2	—	C	

**POWER INSTALLATION
COWLING, ENGINE, PORT**

Ref. No.	Part No.	Description						No. off	Matl Spec.	Cl. of Equip. M.R. L.M.	Plate No.
		1	2	3	4	5	6				
633	E.A1.50.281	FASTENER, TOGGLE, ASSEMBLY (OUTBOARD) Spares for this assembly are identical with those for assembly Part No. E.A1.50.282 on Page PA.2						2	—	C	
637	E.A1.50.284	FASTENER, TOGGLE, ASSEMBLY (INBOARD FRONT) Spares for:—						1	—	C	
7133	E.A1.50.97	HANDLE, TOGGLE FASTENER, ASSEMBLY ... Spares for:—						1	—	C	
28E/9153406	TERRY 169/1"	RING, split						1	—	C	
635	E.A1.50.49	SPRING, 19 SWG						1	—	C	
17661	E.A1.50.157	Attaching parts for E.A1.50.97:—						2	S.96	C	
28P/1220716	SP.90/E4	Pin, stud, special						2	—	C	
		Pin, split						2	—	C	
636	E.A1.50.283	FASTENER, TOGGLE, ASSEMBLY (OUTBOARD, FRONT) Spares for this assembly are identical with those for assembly Part No. E.A1.50.284						1	—	C	
628	E.A1.50.161	PANEL, toggle fastener housing						6	—	C	
6817	E.B6.50.121	ROD, TENSION, FOR UNDERCARRIAGE COWL DOOR, AND CABLE CHECK, ASSEMBLY Consisting of:—						1	—	C	
17719	E.B6.50.115	CABLE, check						1	—	C	
12201	E.B6.50.119	FORK-END						2	S.1	C	
28M/1006473	A27/CT	NUT, 2 BA						2	—	C	
28P/9140979	SP.4Z/B4	PIN, shackle						1	—	C	
28P/1021104	SP.90/C3	PIN, split						1	—	C	
	E.B6.50.117	ROD, connecting						1	S.1	—	
27190	EEAS.27/5EU	WASHER, special						1	—	C	
		Attaching parts for E.B6.50.121:—									
28D/9133012	A25/3C	Bolt, 2 BA						1	—	C	
28D/9140647	A25/14C	Bolt, 2 BA						1	—	C	
28M/9403520	A27/CP	Nut, 2 BA						2	—	C	
28W/9419402	SP.13/C	Washer						2	—	C	
28FP/341	S5/325	SPRING, Dzus						6	—	C	
6503	E.A1.50.1793	WASHER, cup, Dzus fastener, retaining						10	DTD.124A	C	
		Attaching parts for E.A9.50.27:—									
1025	EEAS.1/1C	Screw, 2BA						10	S.96	C	P.2
15557	E.A6.50.467	COWL, TOP, REAR, ASSEMBLY (Supplied to Drg. E.B6.00.127, with trim allowance for spares purposes) Spares for:—						1	—	A	
28FP/4062396	FJ5/60DS	FASTENER, Dzus						4	—	C	
28FP/4062398	FJ5/70DS	FASTENER, Dzus						4	—	C	
28FP/4062400	FJ5/80DS	FASTENER, Dzus						2	—	C	
634	E.A1.50.282	FASTENER, TOGGLE, ASSEMBLY (OUTBOARD CENTRE) Spares for:—						2	—	C	
16312	E.A1.50.95	HANDLE, TOGGLE FASTENER, ASSEMBLY ... Spares for:—						1	—	C	
28E/9153406	TERRY 169/1"	RING, split						1	—	C	
635	E.A1.50.49	SPRING, 19 SWG						1	—	C	
16313	E.A1.50.155	Attaching parts for E.A1.50.95:—						2	S.96	C	
28P/9527619	SP.90/C7	Pin, stud, special						2	—	C	
		Pin, split						2	—	C	

**POWER INSTALLATION
COWLING, ENGINE, PORT**

Ref. No.	Part No.	Description	No. off	Matl Spec.	Cl. of Equip.		Plate No.
					M.R.	L.M.	
		1 2 3 4 5 6					
633	E.A1.50.281	FASTENER, TOGGLE, ASSEMBLY (INBOARD, CENTRE) Spares for this assembly are identical with those for assembly Part No. E.A1.50.282 on Page PA.3	2	—		C	
636	E.A1.50.283	FASTENER, TOGGLE, ASSEMBLY (OUTBOARD, FRONT AND REAR) Spares for:—	2	—		C	
7133	E.A1.50.97	HANDLE, TOGGLE FASTENER, ASSEMBLY ... Spares for:—	1	—		C	
28E/9153406	TERRY 169/1"	RING, split	1	—		C	
635	E.A1.50.49	SPRING, 19 SWG	1	—		C	
17661	E.A1.50.157	Attaching parts for E.A1.50.97:— Pin, stud, special	2	S.96		C	
28P/1220716	SP.90/E4	Pin, split	2	—		C	
637	E.A1.50.284	FASTENER, TOGGLE, ASSEMBLY (INBOARD FRONT AND REAR) Spares for this assembly are identical with those for assembly Part No. E.A1.50.283	2	—		C	
628	E.A1.50.161	PANEL, toggle fastener, housing	8	—		C	
28FP/341	SS/325	SPRING, Dzus	8	—		C	
6503	E.A1.50.1793	WASHER, cup, Dzus fastener, retaining	10	DTD.124A		C	
5696	E.A6.50.593	DUCT, air compressor bleed valve	2	—		C	
28D/1218444	AS.1242/1E	Attaching parts for E.A6.50.593:— Bolt, 1/2" BSF	16	—		C	
5699	E.A6.50.501	DUCT, engine starter, exhaust (Pre-Mod. 2129)	3	—		C	
25924	E.A6.50.979	DUCT, engine starter, exhaust (Mod. 2129)	3	—		C	
28D/1218444	AS.1242/1E	Attaching parts for E.A6.50.501 or E.A6.50.979:— Bolt, 1/2" BSF	8	—		C	
640	E.A1.50.109	FORK-END, fitting, toggle fastener, top cowl, station "D"	2	S.96		C	P.2
642	E.A1.50.135	FORK-END, fitting, toggle fastener at station "A" and rear attachment of service panel	6	DTD.683		C	P.2
643	E.A1.50.137	FORK-END, fitting, toggle fastener at station "B" and "C"	8	DTD.683		C	P.2
5697	E.A6.50.901	FORK-END, fitting, toggle fastener, front, outboard attachment of service panel Attaching parts for E.A1.50.109, E.A1.50.135, E.A1.50.137 and E.A6.50.901:—	1	DTD.683		C	P.2
28P/864	SP.4Y/D6	Pin, shackle (As required)	8	—		C	P.2
28P/9016037	SP.4Y/F10	Pin, shackle (As required)	9	—		C	P.2
645	E.A1.50.29	HOOK, cowl toggle fastener, at station "B" and "C"	8	S.96		C	P.2
646	E.A1.50.45	HOOK, cowl toggle fastener, at station "A", top cowl at station "D", front outboard and rear attachment of service panel	9	S.96		C	P.2
34189	E.A6.50.25	HOOK, COWL TOGGLE FASTENER, ASSEMBLY FOR INBOARD FRONT ATTACHMENT OF SERVICE PANEL Spares for:—	1	—		C	P.2
646	E.A6.50.21	FORK-END, fitting	1	—		—	
6485	E.A1.50.45	HOOK, toggle fastener	1	—		C	
6485	E.A1.50.121	ROD, toggle fastener	1	—		C	
28P/867	SP.4Y/D9	Attaching parts for E.A6.50.25:— Pin, shackle	1	—		C	

**POWER INSTALLATION
COWLING, ENGINE, PORT**

Ref. No.	Part No.	Description						No. off	Matl Spec.	Cl. of Equip.		Plate No.
		1	2	3	4	5	6			M.R.	L.M.	
5698	E.A6.50.5	PANEL, ENGINE, SERVICE, ASSEMBLY (Supplied with trim allowance for spares purposes) Spares for:—						1	—		B	
636	E.A1.50.283	FASTENER, TOGGLE, ASSEMBLY (INBOARD) Spares for:—						2	—		C	
7133	E.A1.50.97	HANDLE, TOGGLE FASTENER, ASSEMBLY Spares for:—						1	—		C	
28E/9153406	TERRY 169/1"	RING , split						1	—		C	
635	E.A1.50.49	SPRING , 19 SWG Attaching parts for E.A1.50.97:—						1	—		C	
17661	E.A1.50.157	Pin, stud, special						2	S.96		C	
28P/1220716	SP.90/E4	Pin, split						2	—		C	
637	E.A1.50.284	FASTENER, TOGGLE, ASSEMBLY (OUTBOARD) Spares for this assembly are identical with those for assembly Part No. E.A1.50.283						2	—		C	
	E.A6.50.49	PANEL, SERVICE, ASSEMBLY Spares for:—						—	—		—	
16368	E.A6.50.283	DUCT , ventilating (Pre-Mod. 2127)						2	L.59		C	
30808	E.A9.50.39	DUCT , ventilating (Mod. 2127)						2	L.59		C	
628	E.A1.50.161	PANEL , toggle, fastener housing						4	—		C	
28FP/341	SS/325	SPRING , Dzus						4	—		C	
6483	E.A1.50.119	ROD , toggle fastener at station "A"						4	—		C	P.2
5406	E.A1.50.123	ROD , toggle fastener, front outboard attachment of service panel						1	—		C	P.2
6484	E.A1.50.125	ROD , toggle fastener, rear attachment of service panel						2	—		C	P.2
7813	E.A1.50.129	ROD , toggle fastener, at station "B"						4	—		C	P.2
10705	E.A1.50.131	ROD , toggle fastener, at station "C", top cowl attachment						2	—		C	P.2
5405	E.A1.50.133	ROD , toggle fastener, at station "C", bottom cowl attachment						2	—		C	P.2
1037	EEAS.1/8E	SCREW , 1/2" BSF, for attachment of hinge bracket on fire wall						2	S.96		C	P.2
651	E.A1.50.101	SPRING , tension, toggle hook assembly						4	—		C	P.2

**POWER INSTALLATION
COWLING, ENGINE, STARBOARD**

Ref. No.	Part No.	Description	No. off	Matl Spec.	Cl. of Equip.		Plate No.
					M.R.	L.M.	
		1 2 3 4 5 6					
	E.A6.50.495	COWLING, ENGINE, STARBOARD, ASSEMBLY ...	—	—	—		
		Spares for:—					
626	E.A1.50.103	CLIP , toggle hook spring, top at station A ...	2	L.72	C		P.2
627	E.A1.50.105	CLIP , toggle hook spring, top at station B ...	2	L.72	C		P.2
		Attaching parts for E.A1.50.103 or E.A1.50.105:—					
28D/1007979	AS.1246/1B	Bolt, 4 BA ...	1	—	C		P.2
28M/1278189	AGS.2001/B/1	Nut, 4 BA ...	1	—	C		
28W/9419474	SP.15/B	Washer ...	1	—	C		
5700	E.A6.50.499	COWL, FRONT, ASSEMBLY (Supplied to Drg. No. E.B6.00.131 with trim allowance and pilot holes drilled for spares purposes)	1	—	A		
		Spares for:—					
38672	E.A3.00.963	AIR INTAKE, ASSEMBLY (E.A6.50.861) ...	1	—	B		
		Spares for:—					
	E.A6.50.855	FRAME, NO. 1, ASSEMBLY ...	1	—	—		
		Spares for:—					
	E.A6.50.905	RING , sealing (Make from EEAS.140, Ref. 20518)	1	—	LM		
25835	E.A6.50.987	ANGLE , duct extractor, L.H. (Mod. 2114) ...	1	—	C		
25839	E.A6.50.977	ANGLE , duct extractor, R.H. (Mod. 2114) ...	1	—	C		
5701	E.A6.50.881	BRACKET , pipe, anti-icing ...	1	L.72	C		
16444	E.A6.50.821	CLIP , bottom, anti-icing pipe ...	2	L.72	C		
16443	E.A6.50.819	CLIP , top, anti-icing pipe ...	2	L.72	C		
		Attaching parts for E.A6.50.821 or E.A6.50.819:—					
28D/9133012	A25/3C	Bolt, 2 BA ...	2	—	C		
28M/1278190	AGS.2001/C/1	Nut, 2 BA ...	2	—	C		
25569	E.A6.50.957	COVER , access, P.V. ram ...	1	L.72	C		
		Attaching parts for E.A6.50.957:—					
28D/1007975	AS.1242/1C	Bolt, 2 BA ...	12	—	C		
22444	E.A6.50.595	DUCT , stub, bottom bleed valve ...	2	—	C		
16434	E.A6.50.789	DUCT , extractor, inboard (Pre-Mod. 2114) ...	1	—	C		
16433	E.A6.50.787	DUCT , extractor, outboard (Pre-Mod. 2114) ...	1	—	C		
25837	E.A6.50.971	DUCT , extractor (Mod. 2114) ...	2	S.510	C		
		Attaching parts for E.A6.50.971:—					
28D/1010030	A25/7C	Bolt, 2 BA ...	3	—	C		
25838	E.A6.50.975	Spring ...	3	S.201	C		
16377	E.A6.50.511	LAND , nut ring, starter exhaust duct ...	3	—	C		
5690	E.A6.50.735	PANEL , access, bleed valve ...	1	—	C		
		Attaching parts for E.A6.50.735:—					
28D/1218444	AS.1242/1E	Bolt, 1/4" BSF ...	12	—	C		
20808	E.A6.50.947	PIPE , anti-icing, assembly ...	1	—	B		
		Attaching parts for E.A6.50.947:—					
5693	E.A6.50.921	Gasket, air duct end, Bestobell ...	1	M.4	C		
1025	EEAS.1/1C	Screw, 2 BA ...	2	S.96	C		
25836	E.A6.50.969	PLATE , doubling, external ...	2	—	C		
		Attaching parts for E.A6.50.969:—					
1129	E.A1.50.1051	Screw, special ...	41	S.96	C		P.2

**POWER INSTALLATION
COWLING, ENGINE, STARBOARD**

Ref. No.	Part No.	Description	No. off	Matl Spec.	Cl. of Equip.	Plate No.
					M.R. L.M.	
		1 2 3 4 5 6				
28525	E.A9.50.28	COWL, BOTTOM, REAR (LESS U/C COWL DOOR, ASSEMBLY Supplied to Drg. No. E.A9.00.498 with trim allowance for spares purposes) Spares for:—	1	—	A	
4143	E.A1.50.66	BRACKET , forward hinge	1	DTD.683	C	
4144	E.A1.50.68	BRACKET , aft hinge	1	DTD.683	C	
		Attaching parts for E.A1.50.66 and E.A1.50.68:—				
28D/1011023	A25/20C	Bolt, 2 BA (As required)	4	—	C	
28D/1011024	A25/21C	Bolt, 2 BA (As required)	2	—	C	
28M/1006473	A27/CT	Nut, 2 BA	4	—	C	
28W/9419475	SP.15/C	Washer (As required)	4	—	C	
28W/9419404	SP.16/C	Washer (As required)	2	—	C	
	E.A9.50.30	COWL, BOTTOM REAR, ASSEMBLY Spares for:—	1	—	—	
17710	E.B6.50.57	CLIP , pipe	1	—	C	
6921	E.A1.50.871	DUCT	1	—	C	
3822	E.A1.50.1592	DUCT	1	—	C	
15066	E.A1.50.975	FUNNEL , assembly, air duct	2	—	C	
3821	E.A1.50.1523	OUTLET , drain	1	—	C	
17709	E.B6.50.56	PIPE	1	—	C	
5182	E.A1.50.1601	PLATE , retaining, oil sump drain outlet	1	—	C	
	E.A6.50.923	SEAL , rubber (Make from EEAS.157, Ref. 17745)	QR	—	LM	
6122385	EEAS.120	SEAL , rubber	2	—	C	
	E.B6.50.129	SEAL , Neoprene, 1/4" thick (Make from Ref. 32C/9009171)	QR	—	LM	
	E.B6.50.143	SEAL , Neoprene, 1/4" thick (Make from Ref. 32C/9009171)	2	—	LM	
37413	E.A6.50.991	SPRING , drain outlet (Mod. 2670)	1	—	C	
5014	E.A1.50.1603	SPRING , drain outlet (Pre-Mod. 2670)	1	—	C	
5015	E.A1.50.981	SPRING , air duct	2	—	C	
15026	E.A1.50.315	DOOR , access, igniter plug	2	—	C	
3037	E.A1.50.318	DOOR , access, in bottom rear cowl	1	—	C	
3039	E.A1.50.320	DOOR , undercarriage cowl (Supplied with trim allowance all round for spares purposes)	1	—	C	
		Attaching parts for E.A1.50.320:—				
6149	E.A1.50.1075	Block, rubber, aft half hinge	1	—	C	
28N/9153394	AGS.899/6	Collar	2	—	C	
28P/5525	SP.4Z/F10	Pin, shackle	1	—	C	
28P/12348	SP.4Z/F18	Pin, shackle	1	—	C	
28P/9527619	SP.90/C7	Pin, split	2	—	C	
639	E.A1.50.365	Washer	2	L.46	C	
28FP/4062396	FJ5/60DS	FASTENER , Dzus	4	—	C	
28FP/4062398	FJ5/70DS	FASTENER , Dzus	4	—	C	
28FP/4062400	FJ5/80DS	FASTENER , Dzus	2	—	C	

**POWER INSTALLATION
COWLING ENGINE STARBOARD**

Ref. No.	Part No.	1	2	3	4	5	6	Description	No. off	Matl. Spec.	Cl. of Equip.	Place No.
											M.R. L.M.	
633	E.A1.50.281							FASTENER, TOGGLE, ASSEMBLY (OUTBOARD)	2	—	C	
								Spares for:—				
16312	E.A1.50.95							HANDLE, TOGGLE FASTENER, ASSEMBLY ...	1	—	C	
								Spares for:—				
29H/4100	TERRY 169/1"							RING, split	1	—	C	
635	E.A1.50.49							SPRING, 19 SWG	1	SPRING STEEL	C	
								Attaching parts for E.A1.50.95:—				
16313	E.A1.50.155							Pin, stud, special	2	S.11	C	
28P/9527619	SP.90/C7							Pin, split	2	—	C	
634	E.A1.50.282							FASTENER, TOGGLE, ASSEMBLY (INBOARD) ...	2	—	C	
								Spares for this assembly are identical with those for assembly Part No. E.A1.50.281				
636	E.A1.50.283							FASTENER, TOGGLE, ASSEMBLY (OUTBOARD FRONT)	1	—	C	
								Spares for:—				
7133	E.A1.50.97							HANDLE, TOGGLE FASTENER, ASSEMBLY ...	1	—	C	
								Spares for:—				
29H/4100	TERRY 169/1"							RING, split	1	—	C	
635	E.A1.50.49							SPRING, 19 SWG	1	SPRING STEEL	C	
								Attaching parts for E.A1.50.97:—				
17661	E.A1.50.157							Pin, stud, special	2	S.11	C	
28P/9486478	SP.90/C5							Pin, split	2	—	C	
637	E.A1.50.284							FASTENER, TOGGLE, ASSEMBLY (INBOARD FRONT)	1	—	C	
								Spares for this assembly are identical with those for assembly Part No. E.A1.50.283				
628	E.A1.50.161							PANEL, toggle fastener housing	6	—	C	
6817	E.B6.50.121							ROD, TENSION, FOR UNDERCARRIAGE COWL DOOR AND CABLE CHECK, ASSEMBLY	1	—	C	
								Consisting of:—				
17719	E.B6.50.115							CABLE check	1	—	C	
12201	E.B6.50.119							FORK-END	2	S.1	C	
28M/1006473	A27/CT							NUT, 2 BA	2	—	C	
28P/9140979	SP.4Z/B4							PIN, shackle	1	—	C	
28P/1021104	SP.90/C3							PIN, split	1	—	C	
	E.B6.50.117							ROD, connecting	1	S.1	C	
27190	EEAS.27/5EU							WASHER	1	—	C	
								Attaching parts for E.B6.50.121:—				
28D/9133012	A25/3C							Bolt, 2 BA	1	—	C	
28D/9140647	A25/14C							Bolt, 2 BA	1	—	C	
28M/9403520	A27/CP							Nut, 2 BA	2	—	C	
28W/9419402	SP.13/C							Washer:	2	—	C	
28FP/341	S5/S25							SPRING, Dzus	6	—	C	
6503	E.A1.50.1793							WASHER, cup, Dzus fastener retaining	10	DTD.124A	C	
								Attaching parts for E.A9.50.28:—				
1025	EEAS.1/1C							Screw, 2 BA	10	S.11	C	

**POWER INSTALLATION
COWLING ENGINE STARBOARD**

Ref. No.	Part No.	Description	No. off	Matl. Spec.	Cl. of Equip.	Plate No.
					M.R. L.M.	
15558	E.A6.50.468	COWL, TOP, REAR, ASSEMBLY (Supplied to Drg. E.B6.00.128 with trim allowance for spares purposes) Spares for:—	1	—	A	
28FP/120	FJ5/60DS	FASTENER, Dzus	4	—	C	
28FP/122	FJ5/70DS	FASTENER, Dzus	4	—	C	
28FP/124	FJ5/80DS	FASTENER, Dzus	2	—	C	
633	E.A1.50.281	FASTENER, TOGGLE, ASSEMBLY (INBOARD CENTRE) Spares for:—	2	—	C	
16312	E.A1.50.95	HANDLE, TOGGLE FASTENER, ASSEMBLY ... Spares for:—	1	—	C	
29H/4100	TERRY 169/1"	RING, split	1	—	C	
635	E.A1.50.49	SPRING, 19 SWG	1	SPRING STEEL	C	
16313	E.A1.50.155	Attaching parts for E.A1.50.95:— Pin, stud, special	2	S.11	C	
28P/9527619	SP.90/C7	Pin, split	2	—	C	
634	E.A1.50.282	FASTENER, TOGGLE, ASSEMBLY (OUTBOARD CENTRE) Spares for this assembly are identical with those for assembly Part No. E.A1.50.281	2	—	C	
637	E.A1.50.284	FASTENER, TOGGLE, ASSEMBLY (INBOARD FRONT AND REAR) Spares for:—	2	—	C	
7133	E.A1.50.97	HANDLE, TOGGLE FASTENER, ASSEMBLY ... Spares for:—	1	—	C	
29H/4100	TERRY 169/1"	RING, split	1	—	C	
635	E.A1.50.49	SPRING	1	SPRING STEEL	C	
17661	E.A1.50.157	Attaching parts for E.A1.50.97:— Pin, stud, special	2	S.11	C	
28P/19128	SP.90/E4	Pin, split	2	—	C	
636	E.A1.50.283	FASTENER, TOGGLE, ASSEMBLY (OUTBOARD FRONT AND REAR) Spares for this assembly are identical with those for assembly Part No. E.A1.50.284	2	—	C	
628	E.A1.50.161	PANEL, toggle fastener housing	8	—	C	
28FP/341	S5/325	SPRING, Dzus	8	—	C	
6503	E.A1.50.1793	WASHER, cup, Dzus fastener retaining	10	DTD.124A	C	
5696	E.A6.50.593	DUCT, air compressor bleed valve	2	—	C	
28D/1218444	AS.1242/1E	Attaching parts for E.A6.50.593:— Bolt, 1/2" BSF	16	—	C	
5699	E.A6.50.501	DUCT, engine starter exhaust (Pre-Mod. 2129) ...	3	—	C	
25924	E.A6.50.979	DUCT, engine starter exhaust (Mod. 2129) ...	3	—	C	
28D/1218444	AS.1242/1E	Attaching parts for E.A6.50.501 and E.A6.50.979:— Bolt, 1/2" BSF	8	—	C	

**POWER INSTALLATION
COWLING, ENGINE, STARBOARD**

Ref. No.	Part No.	Description						No. off	Matl Spec.	Cl. of Equip. M.R. L.M.	Plate No.
		1	2	3	4	5	6				
640	E.A1.50.109	FORK-END, fitting, toggle fastener, top cowl, station "D"						2	S.96	C	P.2
642	E.A1.50.135	FORK-END, fitting, toggle fastener at station "A" and rear attachment of service panel						6	DTD.683	C	P.2
643	E.A1.50.137	FORK-END, fitting, toggle fastener at station "B" and "C"						8	DTD.683	C	P.2
5704	E.A1.50.159	FORK-END, fitting, toggle fastener, front outboard attachment of service panel						1	DTD.683	C	P.2
		Attaching parts for E.A1.50.109, E.A1.50.135, E.A1.50.137 and E.A1.50.159:—									
28P/864	SP.4Y/D6	Pin, shackle (As required)						8	—	C	P.2
28P/1015710	SP.4Y/D8	Pin, shackle (As required)						1	—	C	P.2
28P/9016037	SP.4Y/F10	Pin, shackle (As required)						8	—	C	P.2
645	E.A1.50.29	HOOK, cowl, toggle fastener at station "B" and "C"						8	S.96	C	P.2
646	E.A1.50.45	HOOK, cowl, toggle fastener at station "A", top cowl at station "D" and service panel attachments						10	S.96	C	P.2
5705	E.A6.50.261	PANEL, ENGINE SERVICE, ASSEMBLY (Supplied with trim allowance for spares purposes) Spares for this assembly are identical with those for assembly Part No. E.A6.50.5 on page PA.5 except for the following deletion and addition Delete:—						1	—	B	
	E.A6.50.49	PANEL, SERVICE, ASSEMBLY Add:—						—	—	—	
641	E.A6.50.259 E.A1.50.111	PANEL, SERVICE, ASSEMBLY ROD-END fitting, toggle fastener, front inboard attachment of service panel						1	DTD.683	C	P.2
		Attaching parts for E.A1.50.111:—									
28P/873	SP.4Y/D15	Pin, shackle						1	—	C	P.2
16493	E.A6.50.31	ROD, toggle fastener, front outboard attachment service panel						1	—	C	P.2
6483	E.A1.50.119	ROD, toggle fastener at station "A"						4	—	C	P.2
6485	E.A1.50.121	ROD, toggle fastener, front inboard attachment service panel						1	—	C	P.2
6484	E.A1.50.125	ROD, toggle fastener, rear attachment of service panel						2	—	C	P.2
7813	E.A1.50.129	ROD, toggle fastener, at station "B"						4	—	C	P.2
10705	E.A1.50.131	ROD, toggle fastener, at station "C" top cowl attachment						2	—	C	P.2
5405	E.A1.50.133	ROD, toggle fastener, at station "C" bottom cowl attachment						2	—	C	P.2
1037	EEAS.1/8E	SCREW, 1/2" BSF, for attachment of hinge bracket on fire wall						2	S.96	C	P.2
651	E.A1.50.101	SPRING, tension, toggle hook assembly						4	—	C	P.2

**POWER INSTALLATION
ENGINE MOUNTINGS AND ATTACHMENTS, PORT**

Ref. No.	Part No.	Description	No. off	Matl Spec.	Cl. of Equip.	Plate No.
					M.R. L.M.	
		1 2 3 4 5 6				
	E.A1.51.1	ENGINE MOUNTINGS AND ATTACHMENTS, PORT, ASSEMBLY	—	—	—	
		Spares for:—				
951	E.A1.51.17	BEARING , spherical, seating, rear engine mounting	2	S.96	C	P.1
954	E.A1.51.3	BRACKET, ENGINE, MOUNTING, REAR, OUT-BOARD, ASSEMBLY (PRE-MOD. 5045)	1	—	B/MR	P.1
		Consisting of:—				
	E.A1.51.11	BRACKET , mounting	1	DTD.683	—	P.1
956	E.A1.51.13	CAP , retaining, spherical bearing	1	DTD.683	C	P.1
		Attaching parts for E.A1.51.13:—				
28M/1011473	A27/JP	Nut, $\frac{3}{8}$ " BSF	2	—	C	
28W/4669277	AGS.195/4	Washer, tab	2	—	C	
	E.A1.51.15	STUD , special	2	S.96	C	P.1
		Attaching parts for E.A1.51.15:—				
3626	E.A1.51.207	Screw, grub	1	S.96	C	P.1
	E.A1.51.211	BRACKET, ENGINE, MOUNTING, REAR, OUT-BOARD, ASSEMBLY (MOD. 5045)	1	—	—	
		Consisting of:—				
	E.K5.51.611	BRACKET , mounting	1	—	—	
	E.A1.51.215	CAP , retaining, spherical bearing	1	DTD.5044	—	
		Attaching parts for E.A1.51.215:—				
28M/9129449	A27/LS	Nut, $\frac{1}{8}$ " BSF	1	—	C	
28M/1011476	A27/JS	Nut, $\frac{3}{8}$ " BSF	1	—	C	
28P/1040788	SP.90/C8	Pin, split	1	—	C	
28P/9496825	SP.90/C9	Pin, split	1	—	C	
28W/9155148	SP.122/J	Washer	1	—	C	
28W/9458601	SP.122/L	Washer	1	—	C	
	E.A1.51.15	STUD	1	S.96	C	
	E.A1.51.213	STUD	1	S.95	—	
		Attaching parts for E.A1.51.15 or E.A1.51.213:—				
3626	E.A1.51.207	Screw, grub	1	S.96	C	
	E.A1.51.4	BRACKET, ENGINE MOUNTING, REAR, INBOARD, ASSEMBLY (PRE-MOD. 5045)	1	—	B/MR	P.1
		Consisting of:—				
	E.A1.51.12	BRACKET , mounting	1	DTD.683	—	P.1
956	E.A1.51.13	CAP , retaining, spherical bearing	1	DTD.683	C	P.1
		Attaching parts for E.A1.51.13:—				
28M/1011473	A27/JP	Nut, $\frac{3}{8}$ " BSF	2	—	C	
28W/4669277	AGS.195/4	Washer, tab	2	—	C	
	E.A1.51.15	STUD , special	2	S.96	C	P.1
		Attaching parts for E.A1.51.15:—				
3626	E.A1.51.207	Screw, grub	1	S.96	C	P.1
	E.A1.51.212	BRACKET, ENGINE MOUNTING, REAR, INBOARD, ASSEMBLY (MOD. 5045)	1	—	—	
		Consisting of:—				
	E.K5.51.612	BRACKET , mounting	1	—	—	
	E.A1.51.215	CAP , retaining, spherical bearing	1	DTD.5044	—	
		Attaching parts for E.A1.51.215:—				
28M/9129449	A27/LS	Nut, $\frac{1}{8}$ " BSF	1	—	C	
28M/1011476	A27/JS	Nut, $\frac{3}{8}$ " BSF	1	—	C	
28P/1040788	SP.90/C8	Pin, split	1	—	C	
28P/9496825	SP.90/C9	Pin, split	1	—	C	
28W/9155148	SP.122/J	Washer	1	—	C	
28W/9458601	SP.122/L	Washer	1	—	C	

**POWER INSTALLATION
ENGINE MOUNTINGS AND ATTACHMENTS, PORT**

Ref. No.	Part No.	Description	No. off	Matl Spec.	Cl. of Equip.	Plate No.
					M.R. L.M.	
		1 2 3 4 5 6				
957	E.A1.51.15	STUD	1	S.96	C	
	E.A1.51.213	STUD	1	S.95	—	
		Attaching parts for E.A1.51.15 or E.A1.51.213:—				
3626	E.A1.51.207	Screw, grub	1	S.96	C	
		Attaching parts for E.A1.51.3, E.A1.51.211, E.A1.51.4 or E.A1.51.212:—				
28D/1011258	A25/8G	Bolt, 1/8" BSF	6	—	C	
28M/1006939	A27/GP	Nut, 1/8" BSF	6	—	C	
	E.A1.51.209	Shim (if required)	2	—	—	
28W/9419476	SP.15/G	Washer	6	—	C	
958	E.A1.51.5	MOUNTING, ENGINE, FORWARD, INBOARD ASSEMBLY (PRE-MOD. 5080)	1	—	B/MR	P.1
6119292	E.A1.51.229	MOUNTING, ENGINE, FORWARD, INBOARD ASSEMBLY (MOD. 5080)	1	—	B	
		Spares for:—				
960	E.A1.51.33	BOLT , shouldered, engine mounting	1	S.96	C	P.1
961	E.A1.51.201	BRACKET , engine mounting (Pre-Mod. 5080)	1	Z5Z	C	P.1
6119290	E.A1.51.225	BRACKET , engine mounting (Mod. 5080)	1	—	C	
963	E.A1.51.45	FORK-END , for tie rod	1	S.96	C	P.1
964	E.A1.51.27	NUT , locking, plug retaining	1	L.65	C	P.1
965	E.A1.51.25	PLUG , retaining, tie rod ball end	1	L.65	C	P.1
966	E.A1.51.43	ROD , tie, adjustable, spherical end	1	S.65	C	P.1
		Attaching parts for E.A1.51.5 or E.A1.51.229:—				
952	E.A1.51.37	Bolt, eye, lower, engine bracket and control bracket, mounting	1	S.96	C	P.1
953	E.A1.51.39	Bolt, eye, upper, engine bracket and control bracket, mounting	1	S.96	C	P.1
28D/1212386	A25/11G	Bolt, 1/8" BSF (Pre-Mod. 5080)	2	—	C	
6119298	EEAS 222/11G	Bolt, 1/8" BSF (Mod. 5080)	2	—	C	
28M/1006939	A27/GP	Nut, 1/8" BSF (Pre-Mod. 5080)	2	—	C	
28M/4095807	AGS.2001/G/1	Nut, 1/8" BSF (Pre-Mod. 5080)	2	—	C	
28M/5808571	A27/GS	Nut, 1/8" BSF (Mod. 5080)	2	—	C	
28P/9527619	SP.90/C7	Pin, split (Mod. 5080)	2	—	C	
28W/9419488	SP.16/G	Washer (Pre-Mod. 5080)	4	—	C	
28W/9706992	SP.125/G	Washer (Mod. 5080)	4	—	C	
6820	E.B6.51.23	MOUNTING, ENGINE, FORWARD, OUTBOARD, ASSEMBLY (PRE-MOD. 5080)	1	—	B/MR	P.1
6119342	E.B6.51.25	MOUNTING, ENGINE, FORWARD, OUTBOARD, ASSEMBLY (MOD. 5080)	1	—	B	
		Spares for:—				
960	E.A1.51.33	BOLT , shouldered, engine mounting	1	S.96	C	P.1
6821	E.B6.51.21	BRACKET , engine mounting (Pre-Mod. 5080)	1	Z5Z	C	P.1
6119340	E.B6.51.27	BRACKET , engine mounting (Mod. 5080)	1	—	C	
963	E.A1.51.45	FORK-END , for tie rod	1	S.96	C	P.1
964	E.A1.51.27	NUT , locking, plug retaining	1	L.65	C	P.1
965	E.A1.51.25	PLUG , retaining, tie rod ball end	1	L.65	C	P.1
966	E.A1.51.43	ROD , tie, adjustable, spherical end	1	S.65	C	P.1
		Attaching parts for E.B6.51.23 or E.B6.51.25:—				
6819	E.A6.50.899	Bolt, shouldered, front, lower	1	S.96	C	
28D/1011260	A25/12G	Bolt, 1/8" BSF (Pre-Mod. 5080)	3	—	C	
6119298	EEAS.222/11G	Bolt, 1/8" BSF (Mod. 5080)	3	—	C	
28M/4095807	AGS 2001/G/1	Nut, 1/8" BSF (Pre-Mod. 5080)	4	—	C	
28M/4199604	A58/G5	Nut, 1/8" BSF (Mod. 5080)	1	—	C	
28P/9527619	SP.90/C7	Pin, split (Mod. 5080)	1	—	C	
28W/9419488	SP.16/G	Washer (Pre-Mod. 5080)	4	—	C	
28W/9706992	SP.125/G	Washer (Mod. 5080)	4	—	C	
971	E.A1.51.19	PIN , spherical bearing, rear inboard bracket, retaining	1	S.96	C	P.1

POWER INSTALLATION
ENGINE MOUNTINGS AND ATTACHMENTS, STARBOARD

Ref. No.	Part No.	Description	No. off	Mati Spec.	Cl. of Equip.	Plate No.
					M.R. L.M.	
	E.A1.51.2	ENGINE MOUNTINGS AND ATTACHMENTS, STARBOARD, ASSEMBLY	—	—	—	
		Spares for:—				
951	E.A1.51.17	BEARING , spherical, seating, rear engine mounting	2	S.96	C	P.1
954	E.A1.51.3	BRACKET , ENGINE MOUNTING, REAR, INBOARD, ASSEMBLY (PRE-MOD. 5045)	1	—	B/MR	P.1
		Consisting of:—				
	E.A1.51.11	BRACKET , mounting	1	DTD.683	—	P.1
956	E.A1.51.13	CAP , retaining, spherical bearing	1	DTD.683	C	P.1
		Attaching parts for E.A1.51.13:—				
28M/1011473	A27/JP	Nut, 3/8" BSF	2	—	C	
28W/683	AGS.195/4	Washer, tab	2	—	C	
	E.A1.51.15	STUD , special	2	S.96	C	P.1
		Attaching parts for E.A1.51.15:—				
3626	E.A1.51.207	Screw, grub	1	S.96	C	P.1
	E.A1.51.211	BRACKET, ENGINE MOUNTING, REAR INBOARD, ASSEMBLY (MOD. 5045)	1	—	—	
		Consisting of:—				
	E.K5.51.611	BRACKET , mounting	1	—	—	
	E.A1.51.215	CAP , retaining, spherical bearing	1	DTD.5044	—	
		Attaching parts for E.A1.51.215:—				
28M/9129449	A27/LS	Nut, 7/8" BSF	1	—	C	
28M/1011476	A27/JS	Nut, 3/8" BSF	1	—	C	
28P/1040788	SP90/C8	Pin, split	1	—	C	
28P/9496825	SP.90/C9	Pin, split	1	—	C	
28W/9155148	SP.122/J	Washer	1	—	C	
28W/9458601	SP.122/L	Washer	1	—	C	
	E.A1.51.15	STUD	1	S.96	C	
	E.A1.51.213	STUD	1	S.95	—	
		Attaching parts for E.A1.51.15 or E.A1.51.213:—				
3626	E.A1.51.207	Screw, grub	1	S.96	C	
	E.A1.51.4	BRACKET, ENGINE MOUNTING, REAR, OUTBOARD, ASSEMBLY (PRE-MOD. 5045)	1	—	B/MR	P.1
		Consisting of:—				
	E.A1.51.12	BRACKET , mounting	1	DTD.683	—	P.1
956	E.A1.51.13	CAP , retaining, spherical bearing	1	DTD.683	C	P.1
		Attaching parts for E.A1.51.13:—				
28M/1011473	A27/JP	Nut, 3/8" BSF	2	—	C	
28W/683	AGS.195/4	Washer, tab	2	—	C	
	E.A1.51.15	STUD , special	2	S.96	C	P.1
		Attaching parts for E.A1.51.15:—				
3626	E.A1.51.207	Screw, grub	1	S.96	C	P.1
	E.A1.51.212	BRACKET, ENGINE MOUNTING, REAR, OUTBOARD, ASSEMBLY (MOD. 5045)	1	—	—	
		Consisting of:—				
	E.K5.51.612	BRACKET , mounting	1	—	—	
	E.A1.51.215	CAP , retaining, spherical bearing	1	DTD.5044	—	
		Attaching parts for E.A1.51.215:—				
28M/9129449	A27/LS	Nut, 7/8" BSF	1	—	C	
28M/1011476	A27/JS	Nut, 3/8" BSF	1	—	C	
28P/1040788	SP.90/C8	Pin, split	1	—	C	
28P/9496825	SP.90/C9	Pin, split	1	—	C	
28W/9155148	SP.122/J	Washer	1	—	C	
28W/9458601	SP.122/L	Washer	1	—	C	

**POWER INSTALLATION
ENGINE MOUNTINGS AND ATTACHMENTS, STARBOARD**

Ref. No.	Part No.	1 2 3 4 5 6	Description	No. off	Matl Spec.	Cl. of Equip.	Plate No.
						M.R. L.M.	
957	E.A1.51.15		STUD	1	S.96	C	
	E.A1.51.213		STUD	1	S.95	—	
			Attaching parts for E.A1.51.15 or E.A1.51.213:—				
3626	E.A1.51.207		Screw, grub	1	S.96	C	
			Attaching parts for E.A1.51.3, E.A1.51.211, E.A1.51.4 or E.A1.51.212:—				
28D/1011258	A25/8G		Bolt, 5/8" BSF	6	—	C	
28M/1006939	A27/GP		Nut, 5/8" BSF	6	—	C	
	E.A1.51.209		Shim (if required)	2	—	—	
28W/9419476	SP.15/G		Washer	6	—	C	
6823	E.A6.50.27		BRACKET , toggle attachment on starboard engine, forward, outboard, mounting, assembly	1	S.96	C	P.1
			Attaching parts for E.A6.50.27:—				
28D/1011238	A25/3E		Bolt, 1/2" BSF	1	—	C	
28D/1011256	A25/5G		Bolt, 5/8" BSF	1	—	C	
28W/9419405	SP.15/E		Washer	1	—	C	
28W/9419476	SP.15/G		Washer	1	—	C	
28W/9416644	SP.47/E		Washer	1	—	C	
28W/9416645	SP.47/G		Washer	1	—	C	
959	E.A1.51.6		MOUNTING, ENGINE, FORWARD, INBOARD, ASSEMBLY (PRE-MOD. 5080)	1	—	B/MR	P.1
6119293	E.A1.51.230		MOUNTING, ENGINE, FORWARD, INBOARD ASSEMBLY (MOD. 5080)	1	—	B	
			Spares for:—				
960	E.A1.51.33		BOLT , shouldered, engine mounting	1	S.96	C	P.1
962	E.A1.51.202		BRACKET , engine mounting (Pre-Mod. 5080)	1	Z5Z	C	P.1
6119291	E.A1.51.226		BRACKET , engine mounting (Mod. 5080)	1	—	C	
963	E.A1.51.45		FORK-END , for tie rod	1	S.96	C	P.1
964	E.A1.51.27		NUT , locking, plug retaining	1	L.65	C	P.1
965	E.A1.51.25		PLUG , retaining, tie rod ball end	1	L.65	C	P.1
966	E.A1.51.43		ROD , tie, adjustable, spherical end	1	S.97	C	P.1
			Attaching parts for E.A1.51.6 or E.A1.51.230:—				
952	E.A1.51.37		Bolt, eye, lower, engine bracket and control bracket, mounting	1	S.96	C	P.1
953	E.A1.51.39		Bolt, eye, upper, engine bracket and control bracket, mounting	1	S.96	C	P.1
28D/1212386	A25/11G		Bolt, 5/8" BSF (Pre-Mod. 5080)	2	—	C	
6119298	EEAS.222/11G		Bolt, 5/8" BSF (Mod. 5080)	2	—	C	
28M/1006939	A27/GP		Nut, 5/8" BSF (Pre-Mod. 5080)	2	—	C	
28M/4095807	AGS.2001/G/1		Nut, 5/8" BSF (Pre-Mod. 5080)	2	—	C	
28M/5808571	A27/GS		Nut, 5/8" BSF (Mod. 5080)	2	—	C	
28P/9527619	SP.90/C7		Pin, split (Mod. 5080)	2	—	C	
28W/9419488	SP.16/G		Washer (Pre-Mod. 5080)	4	—	C	
28W/9706992	SP.125/G		Washer (Mod. 5080)	4	—	C	
6824	E.B6.51.24		MOUNTING, ENGINE, FORWARD, OUTBOARD, ASSEMBLY (PRE-MOD. 5080)	1	—	B/MR	P.1
6119343	E.B6.51.26		MOUNTING, ENGINE, FORWARD, OUTBOARD, ASSEMBLY (MOD. 5080)	1	—	B	
			Spares for:—				
960	E.A1.51.33		BOLT , shouldered, engine mounting	1	S.96	C	P.1
6825	E.B6.51.22		BRACKET , engine mounting (Pre-Mod. 5080)	1	Z5Z	C	P.1
6119341	E.B6.51.28		BRACKET , engine mounting (Mod. 5080)	1	—	C	
963	E.A1.51.45		FORK-END , for tie rod	1	S.96	C	P.1
964	E.A1.51.27		NUT , locking, plug retaining	1	L.65	C	P.1
965	E.A1.51.25		PLUG , retaining, tie rod ball end	1	L.65	C	P.1

**POWER INSTALLATION
ENGINE MOUNTINGS AND ATTACHMENTS, STARBOARD**

Ref. No.	Part No.	1	2	3	4	5	6	Description	No. off	Matl Spec.	Cl. of Equip.	Plate No.
											M.R.	
966	E.A1.51.43							ROD , tie, adjustable, spherical end	1	S.65	C	P.1
								Attaching parts for E.B6.51.24 or E.B6.51.26:—				
6822	E.A6.50.29							Bolt-eye, toggle bracket, attachment	1	S.96	C	P.1
28D/1011260	A25/12G							Bolt, $\frac{3}{16}$ " BSF (Pre-Mod. 5080)	3	—	C	
6119298	EEAS.222/11G							Bolt, $\frac{3}{16}$ " BSF (Mod. 5080)	3	—	C	
28M/4095807	AGS.2001/G/1							Nut, $\frac{3}{16}$ " BSF (Pre-Mod. 5080)	4	—	C	
28M/4199604	A58/GS							Nut, $\frac{3}{16}$ " BSF (Mod. 5080)	1	—	C	
28P/9527619	SP.90/C7							Pin, split (Mod. 5080)	1	—	C	
28W/9419488	SP.16/G							Washer (Pre-Mod. 5080)	4	—	C	
28W/9706992	SP.125/G							Washer (Mod. 5080)	4	—	C	
971	E.A1.51.19							PIN , spherical bearing, rear inboard bracket, retaining	1	S.96	C	P.1

Ref. No.	Part No.							No. off	Matl Spec.	Cl. of Equip.	Plate No.
		1	2	3	4	5	6			M.R. L.M.	

**POWER INSTALLATION
RA7 ENGINE, INSTALLATION, PORT**

Ref. No.	Part No.	Description	No. off	Matl Spec.	Cl. of Equip.	Plate No.
					M.R. L.M.	
	E.A6.00.13	RA7 ENGINE INSTALLATION, PORT	—	—	—	
		Spares for:—				
5706	E.B7.75.117	ADAPTER , screwed, cabin pressure system connection at engine	1	S.91	C	
12K/9631036	†	CARTRIDGE , No. 10, Mk. 3	QR	—	C	
5707	K.A.C. Co. Ltd. C4205/1½"-1½"B	CLAMP , pipe toggle, at hot air valve	2	—	C	
18634	E.B7.50.85	CONNECTION , banjo, fuel drain	1	DTD.683	C	
5708	E.B7.50.23	ELBOW , pipe, assembly, hot air valve to engine ...	1	—	C	
	E.A1.60.5	FIRE PROTECTION SYSTEM IN ENGINE BAY ...	—	—	—	
		Spares for:—				
27N/91	HS/RS 300	UNIT , fire detecting, resetting (Pre-Mod. 4303)	7	—	B	
27N/340	150D/01/300(2)	UNIT , fire detecting, resetting (Mod. 4303) ...	7	—	B	
		Attaching parts for HS/RS 300 or 150D/01/300 (2):—				
28D/9435710	A25/11C	Bolt, 2 BA (As required)	2	—	C	
28D/1011024	A25/21C	Bolt, 2 BA (As required)	1	—	C	
28M/1278190	AGS.2001/C/1	Nut, 2 BA	2	—	C	
	E.A1.60.43	Tube, distance (As required)	1	—	C	
28W/9419475	SP.15/C	Washer	2	—	C	
16448	E.B7.50.25	FITTING , end, hot air valve	1	DTD.683	C	
		Attaching parts for E.B7.50.25:—				
28M/9480017	AGS.2001/E/1	Nut, ¼" BSF	4	—	C	
28W/9418921	SP.13/E	Washer	4	—	C	
6521	E.B7.50.73	GASKET , for shut off valve end fitting	1	L.59	C	
6522	E.B7.50.75	GASKET , for shut off valve elbow	1	L.59	C	
5710	E.B7.75.119	GASKET , for anti-icing and cabin pressure pipe, engine connection	2	L.59	C	
5709	E.B7.75.115	GASKET , for wheel case breather pipe, engine connection	1	L.59	C	
5711	E.B6.50.833	HOSE , metallic, from hot air valve to anti-icing pipe	1	—	C	
36VV/1827	BA.33792	PIPE-JET	1	—	A	
1383	E.A1.57.15	PIPE , flexible, engine fuel (Dunlop Pt. No. AHM.541/21.0)	1	WH2/1	C	
1384	E.A1.57.16	PIPE , flexible, engine fuel (Dunlop Pt. No. AHM.542/21.0)	1	WH2/1	C	
1381	E.A1.60.57	PIPE , flexible, fire protection system (Dunlop Pt. No. AHO.24508/10.75)	1	WH2/1	C	
18626	E.A6.50.869	PIPE , assembly, fuel drain (Pre-Mod. 4726)	1	DTD.323	C	
	E.A3.50.37	PIPE, ASSEMBLY, FUEL DRAIN, INSTALLATION (MOD. 4726)	—	—	—	
		Spares for:—				
5K/0011351	SP.93/A12	GROMMET	2	—	C	
	E.A3.50.35	PIPE , assembly, fuel drain	1	DTD.5019	—	
12631	E.B7.50.105	PIPE , assembly, continuation, wheel case breather, 1½" o/d. x 20 SWG	1	L.54	C	
12351	E.B7.50.133	PIPE , flanged, engine wheel case breather, 1½" o/d. x 20 SWG	1	T.26	C	
19847	E.B7.57.189	PIPE , flexible, drop tank air supply (Avica Equipment Ltd.)	1	—	C	
5716	E.B7.61.83	PIPE , flexible, air cooling for 2-speed generator (Pre-Mod. 3460)	1	—	C	
39472	E.B7.61.133	PIPE , flexible, air cooling for 2-speed generator (Mod. 3460)	1	—	C	
5717	E.B7.75.109	PIPE , flexible, cabin pressure system	1	—	C	

**POWER INSTALLATION
RA7 ENGINE, INSTALLATION, PORT**

Ref. No.	Part No.	Description	No. off	Matl Spec.	Cl. of Equip.		Plate No.
					M.R.	L.M.	
		1 2 3 4 5 6					
1446	EEAS.66/5	RING, clamping	4	L.72		C	
36VV/3784	†	RING, sealing, front flange, jet pipe	1	—		C	
	BELLS ASBESTOS						
28F/17675	AS.5402	RING, sealing, anti-icing pipe connection	2	—		C	
	DUNLOP						
12326	DAS.393/24/3	SLEEVE, connecting, for wheel case breather	2	—		C	
	E.A3.81.1105	THERMO-COUPLE, ASSEMBLY	4	—		—	
		Spares for:—					
6A/3811	†	THERMO-COUPLE	1	—		C	
or							
6A/5452	†						
3613	†	TUBE, silicon rubber, 1/8" i/d. x 16" long	1	Shore 75-80		C	
	or						
	HELLERMANN						
	SLP.80	TUBING, 16" long	1	—		—	
5718	E.A6.47.141	TUBE, CONTROL, THROTTLE AND SHUT-OFF COCK (LESS BALL JOINT HOUSING)	2	—		C	
		Spares for:—					
	E.A3.47.55	FORK-END	1	—		—	
19813	E.A1.47.359	TURNBUCKLE	1	—		C/MR	
		Attaching parts for E.A6.47.141 at airframe end only:—					
220	EEAS.12/1	Bolt, special	1	S.96		C	
1122	EEAS.63	Nut, special	1	S.96		C	
28P/9527619	SP.90/C7	Pin, split	1	—		C	
28W/9419475	SP.15/C	Washer	2	—		C	
	E.B7.50.31	VALVE, HOT AIR, ASSEMBLY	—	—		—	
		Consisting of:—					
	E.E. Co. Ltd.						
5W/400	TYPE 234	ACTUATOR	1	—		A	
	TEDDINGTON						
27V/4604668	FKH/A/16	VALVE, 1 1/2"	1	—		A	
		Attaching parts for E.B7.50.31:—					
28M/9480017	AGS.2001/E1/66	Nut, 1" BSF	4	—		C	
28W/9418921	SP.13/E	Washer	4	—		C	
	E.B6.20.181	VENT SYSTEM, ENGINE, INSTALLATION	—	—		—	
		Spares for:—					
	E.B6.20.959	AIR INTAKE, FOR ZONE 2 COOLING, IN INNER WING, LEADING EDGE, ASSEMBLY	—	—		—	
		Spares for:—					
	E.B7.20.420	BRACKET, pipe support	1	L.59		C	
		Attaching parts for E.B7.20.420:—					
28D/9419452	A25/3B	Bolt, 4 BA	2	—		C	
28M/1278189	AGS.2001/B/1	Nut, 4 BA	2	—		C	
28W/9419465	SP.13/B	Washer	2	—		C	
	18541	DUCT, air spill, upper, engine bay	1	L.59		C/MR	
	18542	DUCT, air spill, lower, engine bay	1	L.59		C/MR	
		Attaching parts for E.B6.20.129 or E.B6.20.130:—					
28D/9133011	A25/2C	Bolt, 2 BA	1	—		C	
28M/1278190	AGS.2001/C/1	Nut, 2 BA	1	—		C	
28W/9419402	SP.13/C	Washer	1	—		C	

**POWER INSTALLATION
RA7 ENGINE, INSTALLATION, PORT**

Ref. No.	Part No.	Description	No. off	Matl Spec.	Cl. of Equip.	Plate No.
					M.R. L.M.	
		1 2 3 4 5 6				
13211	E.B7.20.289	DUCT, air spill, inboard, on inboard engine rib	1	L.59	C	
13212	E.B7.20.291	DUCT, air spill, outboard, on inboard engine rib	1	L.59	C	
		Attaching parts for E.B7.20.289 and E.B7.20.291:—				
28D/9419452	A25/3B	Bolt, 4 BA	9	—	C	
28M/1278189	AGS.2001/B/1	Nut, 4 BA	9	—	C	
28W/9419465	SP.13/B	Washer	9	—	C	
13213	E.A9.20.3241	DUCT, air entry	1	L.59	B	
		Attaching parts for E.A9.20.3241:—				
1026	EEAS.1/1½C	Screw, 2 BA	8	S.96	C	
12349	E.A9.20.1025	HOSE, rubber, pipe connection	2	—	C	
12350	E.A9.20.1017	PIPE, air intake, continuation to inboard engine rib	1	L.81	C	
27502	E.B7.20.427	PLATE, reinforcing, air intake	1	L.72	C/MR	
18586	E.B6.20.559	BRACKET, support, top nozzle pipe	1	—	C/MR	
5647	EEAS.143/26	CLIP, pipe	4	L.72	C	
		Attaching parts for EEAS.143/26:—				
28D/9436920	A25/1C	Bolt, 2 BA	1	—	C	
28M/1278190	AGS.2001/C/1	Nut, 2 BA	1	—	C	
12030	EEAS.21/2ER	Washer, "D"	1	L.72	C	
28W/9419402	SP.13/C	Washer	1	—	C	
18543	E.B6.20.131	DUCT, air spill, L.H. outer wing	1	L.81	C/MR	
18544	E.B6.20.132	DUCT, air spill, L.H. outer wing	1	L.81	C/MR	
		Attaching parts for E.B6.20.131 and E.B6.20.132:—				
28D/9133011	A25/2C	Bolt, 2 BA	1	—	C	
28M/1278190	AGS.2001/C/1	Nut, 2 BA	1	—	C	
28W/9419402	SP.13/C	Washer	1	—	C	
18545	E.B6.20.133	DUCT, air spill, R.H. on outboard engine rib ...	1	L.81	C/MR	
		Attaching parts for E.B6.20.133:—				
28D/1010658	A25/1B	Bolt, 4 BA	12	—	C	
28M/1278189	AGS.2001/B/1	Nut, 4 BA	12	—	C	
28W/9419465	SP.13/B	Washer	12	—	C	
18584	E.B6.20.557	GASKET, sealing, top and bottom nozzle pipes ...	4	—	C/MR	
4762	E.A3.57.185	HOSE, rubber, pipe connection	2	—	C/MR	
18582	E.B6.20.555	PIPE, connecting top and bottom nozzle pipes, front spar cooling	1	—	C/MR	
	E.B6.50.21	PIPE, ENGINE VENT, GROUND RUNNING, ASSEMBLY	—	—	—	
		Spares for:—				
18629	E.B6.50.29	CLIP, pipe support	2	L.72	C	
18630	E.B6.50.31	CLIP, pipe support	2	L.72	C	
		Attaching parts for E.B6.50.29 and E.B6.50.31:—				
28D/9133011	A25/2C	Bolt, 2 BA	2	—	C	
28M/1278190	AGS.2001/C/1	Nut, 2 BA	2	—	C	
28W/9419402	SP.13/C	Washer	2	—	C	
18627	E.B6.50.23	PIPE	1	L.54	C	
18580	E.B6.20.553	PIPE, nozzle, bottom	1	—	C/MR	

**POWER INSTALLATION
RA7 ENGINE, INSTALLATION, PORT**

Ref. No.	Part No.	Description						No. off	Matl Spec.	Cl. of Equip. M.R. L.M.	Plate No.
		1	2	3	4	5	6				
	E.B6.20.561	PIPE, NOZZLE, TOP, ASSEMBLY						1	—	—	
18576	E.B6.20.541	Spares for:— ADAPTOR						1	—	C	
28D/1011014	A25/19B	Attaching parts for E.B6.20.541:— Bolt, 4 BA						1	—	C	
28M/1006504	A27/BT	Nut, 4 BA						1	—	C	
28W/9419465	SP.13/B	Washer						1	—	C	
18578	E.B6.20.547	PIPE, nozzle						1	—	C/MR	
18577	E.B6.20.543	SPRING, compression						1	—	C/MR	
28D/9436920	A25/1C	Attaching parts for E.B6.20.561:— Bolt, 1 BA						1	—	C	
28D/9133011	A25/2C	Bolt, 2 BA						2	—	C	
28M/1278190	AGS.2001/C/1	Nut, 2 BA						3	—	C	
28W/9419402	SP.13/C	Washer						3	—	C	
18863	EEAS.66/9	RENG, clamping, for hose clips						4	—	C	
	E.B6.20.505	SHROUD, HEAT, FORWARD, ASSEMBLY						—	—	—	
18565	E.B6.20.509	Spares for:— BRACKET, angle, shroud support						12	—	C/MR	
27616	E.B6.20.503	SHROUD, heat, forward (to Drg. E.A3.00.865)						1	—	B/MR	
	E.B6.20.511	SHROUD, HEAT, REAR, ASSEMBLY						—	—	—	
18569	E.B6.20.519	Spares for:— BRACKET, shroud support, inboard and out-board						4	DTD.124	C	
18571	E.B6.20.523	BRACKET, shroud support, inboard and out-board						4	DTD.124	C	
28D/9140203	AS.1246/3C	Attaching parts for E.B6.20.519 and E.B6.20.523:— Bolt, 2 BA						1	—	C	
28M/1278190	AGS.2001/C/1	Nut, 2 BA						1	—	C	
18574	E.B6.20.531	Washer, "D"						2	—	C	
28W/9419402	SP.13/C	Washer						1	—	C	
18570	E.B6.20.521	BRACKET, shroud support, top and bottom						4	DTD.124	C	
18572	E.B6.20.525	BRACKET, shroud support, top and bottom						4	DTD.124	C	
28D/9130082	AS.1246/3B	Attaching parts for E.B6.20.521 and E.B6.20.525:— Bolt, 4 BA						1	—	C	
28M/1278189	AGS.2001/B/1	Nut, 4 BA						1	—	C	
18575	E.B6.20.533	Washer, "D"						2	—	C	
28W/9419465	SP.13/B	Washer						1	—	C	
18566	E.B6.20.513	SHROUD, top						1	S.521	C	
18567	E.B6.20.515	SHROUD, bottom						1	S.521	C	
28D/9436920	A25/1C	Attaching parts for E.B6.20.513 and E.B6.20.515:— Bolt, 2 BA						4	—	C	
28M/1278190	AGS.2001/C/1	Nut, 2 BA						4	—	C	
28W/9419402	SP.13/C	Washer						4	—	C	
2149	E.A3.75.143	SLEEVE, pipe connecting, 1" i/d. x 2"5 long						2	Silastic	C	

**POWER INSTALLATION
RA7 ENGINE, INSTALLATION, STARBOARD**

Ref. No.	Part No.	Description						No. off	Matl Spec.	Cl. of Equip. M.R. L.M.	Plate No.
		1	2	3	4	5	6				
	E.A6.00.14	RA7 ENGINE INSTALLATION, STARBOARD						—	—	—	
		Spares for:—									
5706	E.B7.75.117	ADAPTER , screwed, cabin pressure system connection at engine						1	S.91	C	
12K/9631036	†	CARTRIDGE , No. 10, Mk. 3						QR	—	C	
5707	K.A.C. Co. Ltd. C.4205/1½"-1½"B	CLAMP , pipe toggle, at hot air valve						2	—	C	
18634	E.B7.50.85	CONNECTION , banjo, fuel drain						1	DTD.683	C	
5719	E.B7.50.33	ELBOW , pipe, assembly, hot air valve to engine						1	—	—	
	E.A1.60.6	FIRE PROTECTION SYSTEM IN ENGINE BAY						—	—	—	
		Spares for:—									
16481	E.A1.60.51	BRACKET , mounting, L.H. detector unit						1	—	C	
		Attaching parts for E.A1.60.51:—									
28D/9436920	A25/1C	Bolt, 2 BA						2	—	C	
28D/9140645	A25/10C	Bolt, 2 BA						2	—	C	
28M/1278190	AGS.2001/C/1	Nut, 2 BA						4	—	C	
	E.A1.60.43	Tube, distance						2	—	—	
28W/9419475	SP.15/C	Washer						4	—	C	
27N/91	HS/RS.300	UNIT , fire detecting, resetting (Pre-Mod. 4303)						8	—	B	
27N/340	150D/01/300(2)	UNIT , fire detecting, resetting (Mod. 4303)						8	—	B	
		Attaching parts for HS/RS 300 or 150D/01/300 (2):—									
28D/9435710	A25/11C	Bolt, 2 BA (As required)						2	—	C	
28D/9453970	A25/15C	Bolt, 2 BA (As required)						2	—	C	
28M/1278190	AGS.2001/C/1	Nut, 2 BA						2	—	C	
	AS.2807/5/035	Tube, distance (As required)						2	—	LM	
28W/9419475	SP.15/C	Washer						2	—	C	
16448	E.B7.50.25	FITTING , end, hot air valve						1	DTD.683	C	
		Attaching parts for E.B7.50.25:—									
28M/9480017	AGS.2001/E/1	Nut, ¼" BSF						4	—	C	
28W/9418921	SP.13/E	Washer						4	—	C	
6521	E.B7.50.73	GASKET , for shut off valve end fitting						1	L.59	C	
6522	E.B7.50.75	GASKET , for shut off valve elbow						1	L.59	C	
5710	E.B7.75.119	GASKET , for anti-icing and cabin pressure pipe, engine connection						2	L.59	C	
5709	E.B7.75.115	GASKET , for wheel case breather pipe, engine connection						1	L.59	C	
5720	E.B7.50.21	HOSE , metallic, from hot air valve to anti-icing pipe						1	—	C	
36VV/1827	BA.33792	PIPE-JET						1	—	A	
1383	E.A1.57.15	PIPE , flexible, engine fuel (Dunlop Pt. No. AHM.541/21.0)						1	WH2/1	C	
1384	E.A1.57.16	PIPE , flexible, engine fuel (Dunlop Pt. No. AHM.542/21.0)						1	WH2/1	C	
1382	E.A1.60.58	PIPE , flexible, fire protection system (Dunlop Pt. No. AHO.24509/10.75)						1	WH2/1	C	
18626	E.A6.50.869	PIPE , assembly, fuel drain (Pre-Mod. 4726)						1	DTD.323	C	
	E.A3.50.37	PIPE, ASSEMBLY, FUEL DRAIN, INSTALLATION (MOD. 4726)						—	—	—	
		Spares for:—									
5K/0011351	SP.93/A12	GROMMET						2	—	C	
	E.A3.50.35	PIPE , assembly, fuel drain						1	DTD.5019	—	
19846	E.B6.57.83	PIPE , flexible, drop tank air supply						1	No. 501	C	
12632	E.B7.50.106	PIPE , assembly, continuation, wheel case breather, 1½" o/d. x 20 SWG						1	L.54	C	
12353	E.B7.50.134	PIPE , flanged, engine wheel case breather, 1½" o/d x 20 SWG						1	T.26	C	
6970	E.B7.61.85	PIPE , flexible, air cooling for 2-speed generator (Pre-Mod. 3460)						1	—	C	

**POWER INSTALLATION
RA7 ENGINE, INSTALLATION, STARBOARD**

Ref. No.	Part No.	Description	No. off	Matl Spec.	Cl. of Equip.	Plate No.
					M.R. L.M.	
		1 2 3 4 5 6				
39473	E.B7.61.135	PIPE, flexible, air cooling for 2-speed generator (Mod. 3460)	1	—	C	
5717	E.B7.75.109	PIPE, flexible, cabin pressure system	1	—	C	
1446	EEAS.66/5	RING, clamping	4	L.72	C	
36VV/3784	↑	RING, sealing, front flange, jet pipe	1	—	C	
28F/17675	BELLS ASBESTOS AS.5402	RING, sealing, anti-icing pipe connection	2	—	C	
12326	DUNLOP DAS.393/24/3	SLEEVE, connecting, for wheel case breather	2	—	C	
	E.A3.81.1105	THERMO-COUPLE, ASSEMBLY	4	—	—	
		Spares for:—				
6A/3811	↑	THERMO-COUPLE	1	—	C	
or						
6A/5452	↑					
3613	↑	TUBE, silicon rubber, 3/8" i/d. x 16" long	1	Shore 75-80	C	
	or					
	HELLERMANN SLP.80	TUBING, 16" long	1	—	—	
1395	E.A1.47.519	TUBE, CONTROL, THROTTLE, ASSEMBLY	1	—	C	
		Spares for:—				
28N/544	AGS.385	BALL-JOINT	1	—	C	
	E.A3.47.41	FORK-END	1	—	—	
19813	E.A1.47.359	TURNBUCKLE	1	—	C/MR	
6826	E.A6.47.145	TUBE, CONTROL, SHUT-OFF COCK, ASSEMBLY	1	—	C	
		Spares for:—				
28N/544	AGS.385	BALL-JOINT	1	—	C	
	E.A3.47.41	FORK-END	1	—	—	
19813	E.A1.47.359	TURNBUCKLE	1	—	C/MR	
		Attaching parts for E.A1.47.519 or E.A6.47.145:—				
		At airframe end only				
220	EEAS.12/1	Bolt, special	1	S.96	C	
1122	EEAS.63	Nut, special	1	S.96	C	
28P/9527619	SP.90/C7	Pin, split	1	—	C	
28W/9419475	SP.15/C	Washer	2	—	C	
	E.B7.50.31	VALVE, HOT AIR, ASSEMBLY	—	—	—	
		Consisting of:—				
5W/400	E.E. Co. Ltd. TYPE 234	ACTUATOR	1	—	A	
	TEDDINGTON					
27V/4604668	FKH/A/16	VALVE, 1 1/2"	1	—	A	
		Attaching parts for E.B7.50.31:—				
28M/9480017	AGS.2001/E1/66	Nut, 1/2" BSF	4	—	C	
28W/9418921	SP.13/E	Washer	4	—	C	
	E.B6.20.182	VENT SYSTEM, ENGINE, INSTALLATION	—	—	—	
		Spares for:—				
	E.B6.20.960	AIR INTAKE, FOR ZONE 2 COOLING, IN INNER WING, LEADING EDGE, ASSEMBLY	—	—	—	
		Spares for:—				
	E.B6.20.961	BRACKET, pipe support	1	L.72	—	
		Attaching parts for E.B6.20.961:—				
28D/9419452	A25/3B	Bolt, 4 BA	2	—	C	
28M/1278189	AGS.2001/B/1	Nut, 4 BA	2	—	C	
28W/9419465	SP.13/B	Washer	2	—	C	
18541	E.B6.20.129	DUCT, air spill, lower, engine bay	1	L.59	C/MR	
18542	E.B6.20.130	DUCT, air spill, upper, engine bay	1	L.59	C/MR	
		Attaching parts for E.B6.20.129 or E.B6.20.130:—				
28D/9133011	A25/2C	Bolt, 2 BA	1	—	C	
28M/1278190	AGS.2001/C/1	Nut, 2 BA	1	—	C	
28W/9419402	SP.13/C	Washer	1	—	C	

**POWER INSTALLATION
RA7 ENGINE INSTALLATION, STARBOARD**

Ref. No.	Part No.	Description	No. off	Matl. Spec.	Cl. of Equip.		Plate No.
					M.R.	L.M.	
		1 2 3 4 5 6					
13211	E.B7.20.289	DUCT, air spill, L.H. on inboard engine rib ...	1	L.59	C		
13212	E.B7.20.291	DUCT, air spill, R.H. on inboard engine rib ...	1	L.59	C		
		Attaching parts for E.B7.20.289 and E.B7.20.291:—					
28D/9419452	A25/3B	Bolt, 4 BA	9	—	C		
28M/10287	AGS.2001/B/1	Nut, 4 BA	9	—	C		
28W/9419465	SP.13/B	Washer	9	—	C		
13213	E.A9.20.3241	DUCT, air entry	1	L.59	B		
		Attaching parts for E.A9.20.3241:—					
1026	EEAS.1/1½ C	Screw, 2 BA	8	5.96	C		
12349	E.A9.20.1025	HOSE, rubber, pipe connection	2	—	C		
12352	E.A9.20.1018	PIPE, air intake, continuation to inboard engine rib	1	L.59	C		
27502	E.B7.20.427	PLATE, reinforcing, air intake	1	L.72	C/MR		
18586	E.B6.20.559	BRACKET, support, top nozzle pipe	1	—	C/MR		
5647	EEAS.143/26	CLIP, pipe	4	L.72	C		
		Attaching parts for EEAS.143/26:—					
28D/9436920	A25/1C	Bolt, 2 BA	1	—	C		
28M/10288	AGS.2001/C/1	Nut, 2 BA	1	—	C		
12030	EEAS.21/2ER	Washer, "D"	1	L.72	C		
28W/9419402	SP.13/C	Washer	1	—	C		
18543	E.B6.20.131	DUCT, air spill, R.H. outer wing	1	L.59	C/MR		
18544	E.B6.20.132	DUCT, air spill, R.H. outer wing	1	L.59	C/MR		
		Attaching parts for E.B6.20.131 and E.B6.20.132:—					
28D/12513	A25/2C	Bolt, 2 BA	1	—	C		
28M/10288	AGS.2001/C/1	Nut, 2 BA	1	—	C		
28W/9419402	SP.13/C	Washer	1	—	C		
18546	E.B6.20.134	DUCT, air spill, L.H. on outboard engine rib ...	1	L.59	C/MR		
		Attaching parts for E.B6.20.134:—					
28D/12528	A25/1B	Bolt, 4 BA	12	—	C		
28M/10287	AGS.2001/B/1	Nut, 4 BA	12	—	C		
28W/9419465	SP.13/B	Washer	12	—	C		
18584	E.B6.20.557	GASKET, sealing, top and bottom nozzle pipes ...	4	—	C/MR		
4762	E.A3.57.185	HOSE, rubber, pipe connection	2	—	C/MR		
18583	E.B6.20.556	PIPE, connecting, top and bottom nozzle pipes, front spar cooling	1	—	C/MR		
	E.B6.50.22	PIPE, ENGINE VENT, GROUND RUNNING, ASSEMBLY	—	—	—		
		Spares for:—					
18629	E.B6.50.29	CLIP, pipe support	2	L.72	C		
18630	E.B6.50.31	CLIP, pipe support	2	L.72	C		
		Attaching parts for E.B6.50.29 and E.B6.50.31:—					
28D/12513	A25/2C	Bolt, 2 BA	2	—	C		
28M/10288	AGS.2001/C/1	Nut, 2 BA	2	—	C		
28W/9419402	SP.13/C	Washer	2	—	C		
18628	E.B6.50.24	PIPE	1	L.54	C		

**POWER INSTALLATION
RA7 ENGINE INSTALLATION, STARBOARD**

Ref. No.	Part No.	Description	No. off	Matl. Spec.	Cl. of Equip.	Plate No.
					M.R. L.M.	
18581	E.B6.20.554	PIPE, nozzle, bottom... ..	1	—	C/MR	
	E.B6.20.562	PIPE, NOZZLE, TOP, ASSEMBLY	1	—	—	
		Spares for:—				
18576	E.B6.20.541	ADAPTOR	1	—	C	
		Attaching parts for E.B6.20.541:—				
28D/13087	A25/19B	Bolt, 4 BA	1	—	C	
28M/13140	A27/BT	Nut, 4 BA	1	—	C	
28W/9419465	SP.13/B	Washer	1	—	C	
18579	E.B6.20.548	PIPE, nozzle	1	—	C/MR	
18577	E.B6.20.543	SPRING, compression	1	—	C/MR	
		Attaching parts for E.B6.20.562:—				
28D/9436920	A25/1C	Bolt, 2 BA	1	—	C	
28D/12513	A25/2C	Bolt, 2 BA	2	—	C	
28M/10288	AGS.2001/C/1	Nut, 2 BA	3	—	C	
28W/9419402	SP.13/C	Washer	3	—	C	
18863	EEAS.66/9	RING, clamping, for hose clips	4	—	C	
	E.B6.20.506	SHROUD, HEAT, FORWARD, ASSEMBLY	—	—	—	
		Spares for:—				
18565	E.B6.20.509	BRACKET, angle, shroud support	12	—	C/MR	
27617	E.B6.20.504	SHROUD, heat, forward	1	—	B/MR	
		(supplied to Drg. E.A3.00.866)				
	E.B6.20.511	SHROUD, HEAT, REAR, ASSEMBLY	—	—	—	
		Spares for:—				
18569	E.B6.20.519	BRACKET, shroud support, inboard and out-board	4	DTD.124	C	
18571	E.B6.20.523	BRACKET, shroud support, inboard and out-board	4	DTD.124	C	
		Attaching parts for E.B6.20.519 and E.B6.20.523:—				
28D/11210	AS.1246/3C	Bolt, 2 BA	1	—	C	
28M/10288	AGS.2001/C/1	Nut, 2 BA	1	—	C	
18574	E.B6.20.531	Washer, "D"	2	—	C	
28W/9419402	SP.13/C	Washer	1	—	C	
18570	E.B6.20.521	BRACKET, shroud support, top and bottom ...	4	DTD.124	C	
18572	E.B6.20.525	BRACKET, shroud support, top and bottom ...	4	DTD.124	C	
		Attaching parts for E.B6.20.521 and E.B6.20.525:—				
28D/12948	AS.1246/3B	Bolt, 4 BA	1	—	C	
28M/10287	AGS.2001/B/1	Nut, 4 BA	1	—	C	
18575	E.B6.20.533	Washer, "D"	2	—	C	
28W/9419465	SP.13/B	Washer	1	—	C	
18566	E.B6.20.513	SHROUD, top	1	DTD.171	C	
18567	E.B6.20.515	SHROUD, bottom	1	DTD.171	C	
		Attaching parts for E.B6.20.513 and E.B6.20.515:—				
28D/9436920	A25/1C	Bolt, 2 BA	4	—	C	
28M/10288	AGS.2001/C/1	Nut, 2 BA	4	—	C	
28W/9419402	SP.13/C	Washer	4	—	C	
2149	E.A3.75.143	SLEEVE, pipe connecting, 1" i/d x 2"5 long ...	2	Silastic	C	

Plate P1

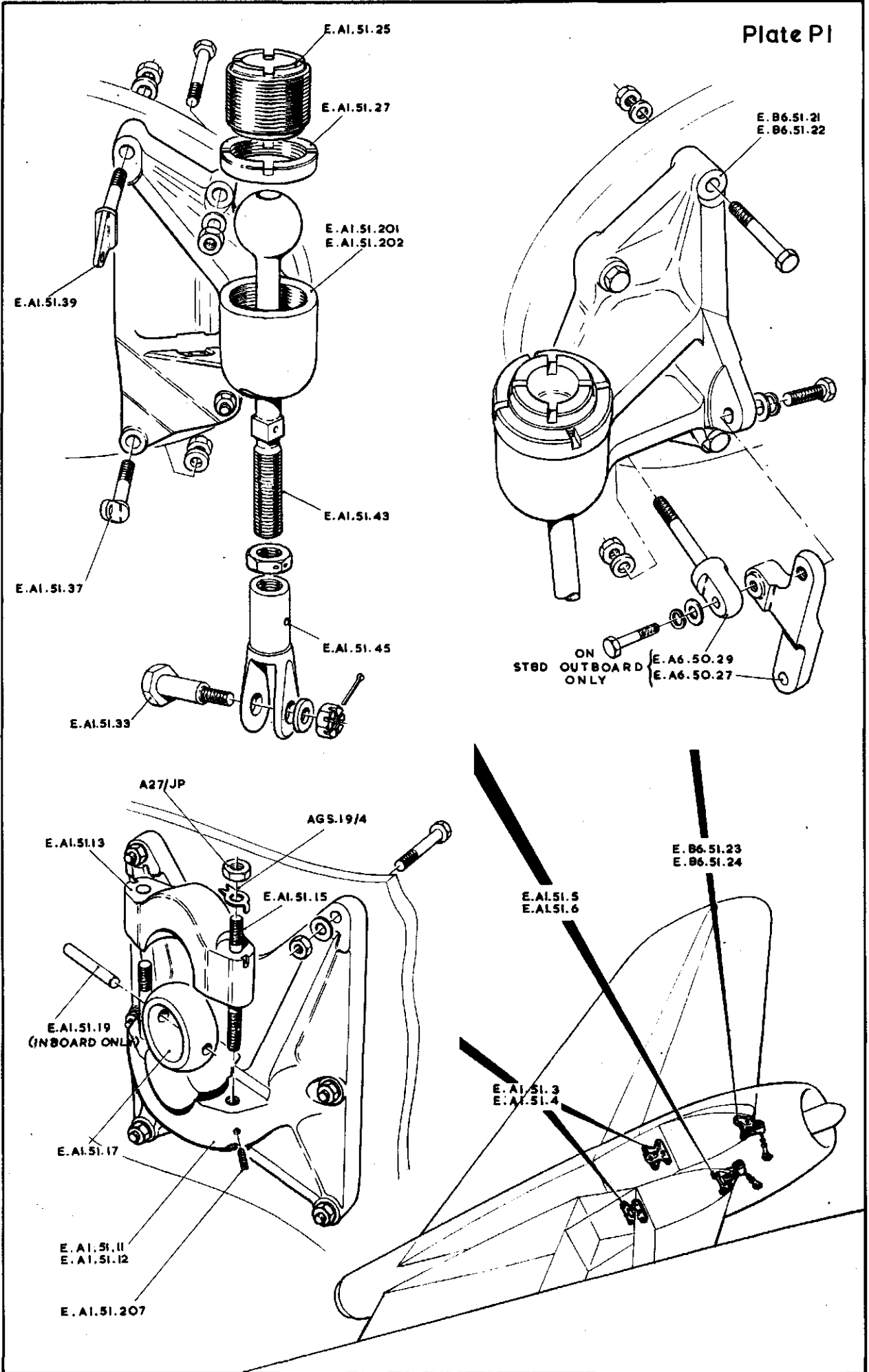

ENGINE MOUNTINGS

PLATE P2

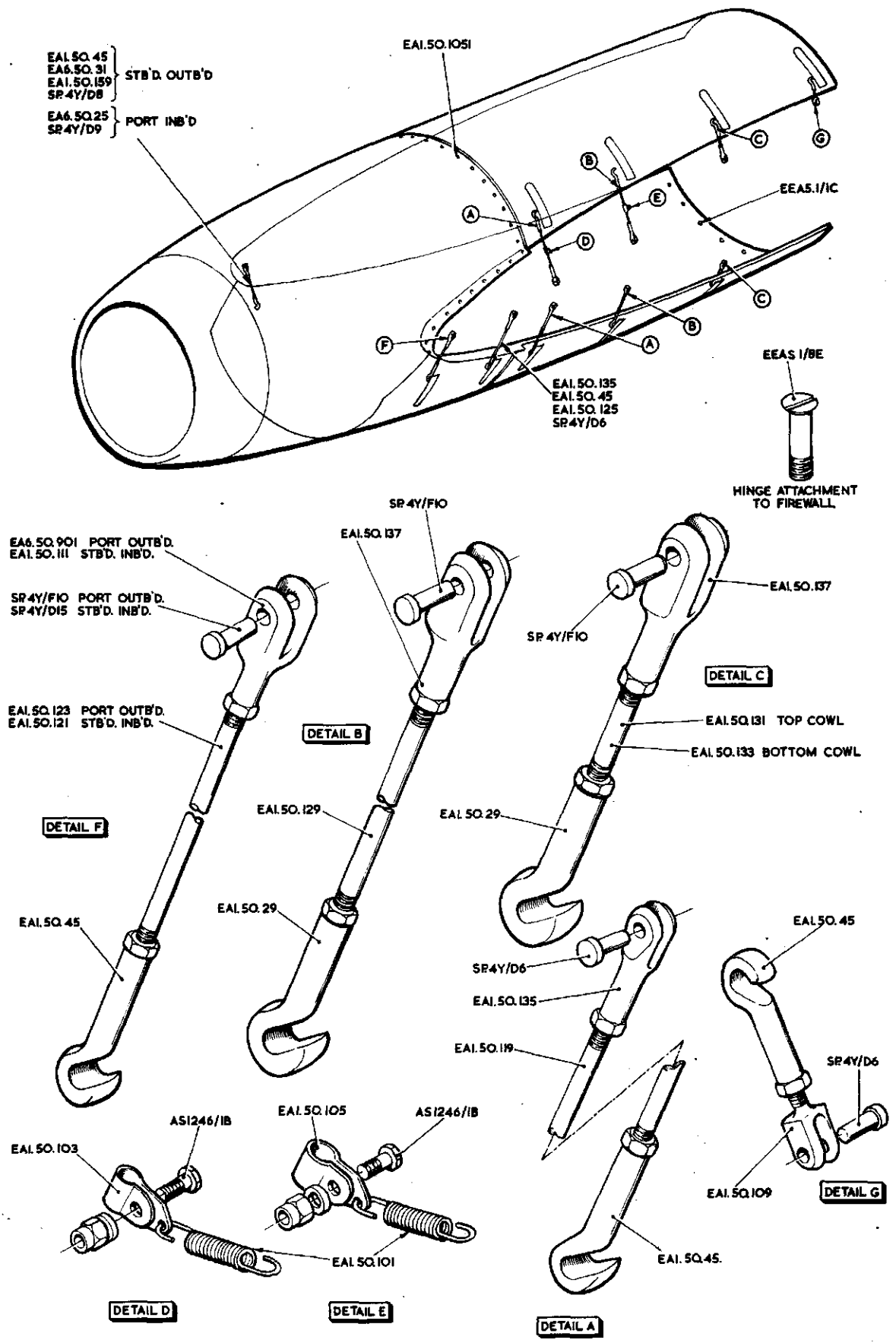

ENGINE COWLING ATTACHMENTS

This file was downloaded
from the RTFM Library.
Link: www.scottbouch.com/rtfm

Please see site for usage terms,
and more aircraft documents.

