

**UNDERCARRIAGE
MAIN UNDERCARRIAGE, PORT**

Ref. No.	Part No.	Description	No. off	Matl Spec.	Cl. of Equip.	Plate No.
					M.R. L.M.	
	E.A1.40.727	MAIN UNDERCARRIAGE, PORT, ASSEMBLY ...	1	—	—	
	E.A1.40.729	Consisting of:— LEG, OLEO (LESS WHEEL, BRAKE UNIT AND FIXED FAIRINGS), ASSEMBLY	1	—	—	W.1
	DUNLOP	Consisting of:—				
27G/4085	AS.9780	BRAKE unit (For spares see A.P.4515C, Vol. 3, Pct. 1, Sect. 2)	1	—	A	W.1
	2168	Attaching parts for AS.9780:— Bolt, securing ...	10	S.97	C	W.1
28M/13259	A27/NS	Nut, 1/2" BSF ...	10	—	C	
	2169	Washer, special ...	10	DTD.124A	C	W.1
	6848	FAIRING, FIXED, ASSEMBLY ... (Supplied with trim allowance)	1	—	B	W.1
	17735	Spares for:— BRACKET , bottom ...	1	L.72	C	W.1
28D/9133012	A25/3C	Attaching parts for E.A6.73.277:—				
	5970	Bolt, 2 BA ...	2	—	C	
	3060	Washer ...	2	L.72	C	W.1
	21164	FAIRING, FIXED, SUB-ASSEMBLY ... Spares for:— PANEL, HINGE, ASSEMBLY ...	1	—	B	
	E.A1.20.1679	Spares for:— HINGE (Make from 28N/9486785) ...	1	—	LM	
	E.A1.20.1675	PANEL , hinge, 16 SWG ...	1	L.72	C	
	E.A1.40.435	SPRING ...	2	Spring Steel	C	
	E.A1.20.6817	PANEL , access, picket point ...	1	—	C	W.1
	E.A3.20.1627	SEAL , 3/4" dia. x 90" long (Make from Ref. 4432)	1	Syn. Rub.	LM	W.1
	4174	Attaching parts for E.B6.20.729:— Bolt, securing fixed fairing mounting brackets to leg (Made from A25/5G)	8	H.T.S.	C	
28W/1086617	AGS.162/E	Washer, spring ...	8	—	C	
	32314	LEG, SLIDING, AND OLEO HEAD, ASSEMBLY (PRE-MOD. 4270)	1	—	A	
	34712	LEG, SLIDING, AND OLEO HEAD, ASSEMBLY (MOD. 4270)	1	—	A	
	E.A6.40.3	Spares for:— HEAD, OLEO, ASSEMBLY (PRE-MOD. 4270)	1	—	—	
	E.A9.40.57	HEAD, OLEO, ASSEMBLY (MOD. 4270) ...	1	—	—	
	663	Spares for:— BEARING , spherical seated, ball joint side stay	1	S.96	C	W.2
	664	Attaching parts for E.A1.40.89:— Bush, bearing ...	1	DTD.412	C	W.2
	674	Ring, lower, retaining, ball joint ...	1	DTD.124	C	W.2
	676	Ring, upper, retaining, ball joint ...	1	DTD.124	C	W.2
	680	Stud, for retaining rings at ball joint ...	12	S.96	C	W.2
	665	BUSH , pivot (Pre-Mod. 4270) ...	2	—	C	W.2
1438501	E.A9.40.63	BUSH , pivot (Mod. 4270) ...	2	DTD.412	MR	
	666	BUSH , torque link lug ...	2	DTD.412	C	W.2
	673	Attaching parts for E.A1.40.111:— Plug, pivot bearing bush, retaining ...	2	L.65	C	W.2
	667	DISC , sealing piston dowel plug ...	2	L.65	C	W.2
	679	Attaching parts for E.A1.40.133:— Screw, retaining, plug, dowel seal ...	2	L.65	C	W.2

**UNDERCARRIAGE
MAIN UNDERCARRIAGE, PORT**

Ref. No.	Part No.	Description	No. off	Matl Spec.	Cl. of Equip.	Plate No
					M.R. L.M.	
668	E.A1.40.131	DOWEL, piston	2	S.96	C	W.2
21495	E.A1.40.19	HEAD, oleo, forging (Pre-Mod. 4270) ...	1	DTD.683	A/MR	W.2
42058	E.A9.40.55	HEAD, oleo, forging (Mod. 4270) ... Supplied to Drg. E.A9.07.35 for spares purposes	1	DTD.5094	B/MR	
669	E.A1.40.103	HOOK, "S" shaped, 16 SWG	2	M.S. Wire	C	W.2
20656	E.A1.40.127	PIPE, stack, assembly Attaching parts for E.A1.40.127:—	1	—	B/MR	W.2
28F/9428453	AGS.1186/B	Seal, bonded	1	—	C	
	E.A6.40.5	PISTON, OPERATING, ASSEMBLY Consisting of:—	1	—	—	W.2
1099	EEAS.37/22A	NIPPLE, 2 BA	2	S.96	C	
670	E.A1.40.647	PISTON	1	DTD.197	C	W.2
22528	E.A6.40.33	PLATE, orifice enclosure, control Attaching parts for E.A6.40.33:—	1	S.96	C	W.2
683	E.A1.40.61	Bolt, attachment, enclosure orifice plate ...	3	S.96	C	W.2
672	E.A1.40.651	RING, piston	1	—	C	W.2
	EEAS.38/3A	SPOKE, 2 BA (Make from 28R/6328) ...	1	S.96	LM	
22227	E.A1.40.117	STRUT, piston, main	1	L.62	MR	W.2
678	E.A1.40.155	RING, sealing, at dowel	2	Syn. Rub.	C	W.2
681	E.A1.40.105	TUBE, distance, packing, for locking washer	1	L.65	C	W.2
28Y/9701165	H. PRESSURE COMPONENTS GYP.A58	VALVE, charging Attaching parts for GYP.A58:—	1	—	C	W.2
28F/9428453	AGS.1186/B	Seal, bonded	1	—	C	
682	E.A1.40.149	Washer, locking, 14 SWG	1	DTD.124	C	W.2
	E.A3.40.225	LEG, SLIDING, COMPRESSION, ASSEMBLY (PRE-MOD. 4270)	1	—	—	W.2
	E.A9.40.61	LEG, SLIDING, COMPRESSION, ASSEMBLY (MOD. 4270) Spares for:—	1	—	—	
26640	E.A3.40.201	BOLT, clamp, locking	1	S.95 or S.96	C	
684	E.A1.40.161	BUSH, bearing, in lug	2	DTD.124	C	W.2
2467	E.A3.40.45	BUSH, bearing	1	—	C	W.2
	E.A3.40.217	CLAMP, AXLE, ASSEMBLY	1	—	—	
21355	E.A3.40.23	BUSH	1	L.16	C	
13024	E.A3.40.183	CLAMP, axle body	1	—	C	W.2
1753	E.A3.40.19	LINK, towing	1	—	C	W.2
21537	E.A3.40.21	WASHER, tow link	1	—	C	W.2
14706	E.A3.40.209	HOUSING, seal (Mod. 2361)	1	L.65	C	
1462	E.A3.40.9	LEG, sliding, c/w integral axle	1	—	A	W.2
691	E.A1.40.41	NUT, stop	1	S.96	C	W.2
32210	E.A3.40.221	PIN, locking, piston	3	S.97	C	
	E.A3.40.219	PISTON, sliding, leg	1	DTD.197	—	W.2
693	E.A1.40.175	PLATE, orifice Attaching parts for E.A1.40.175:—	1	S.65	C	
683	E.A1.40.61	Bolt, stud	6	S.96	C	

UNDERCARRIAGE
MAIN UNDERCARRIAGE, PORT

Ref. No.	Part No.	Description						No. off	Matl Spec.	Cl. of Equip. M.R. L.M.	Plate No.
		1	2	3	4	5	6				
14701	E.A3.40.203							1	DTD.683	C	W.2
14705	E.A3.40.215							2	Fabric CX.18	C	W.2
14700	E.A3.40.207							1	L.64	C	W.2
697	E.A1.40.57							1	—	C	W.2
12915	E.A1.40.45							1	M.S.	C	W.2
28D/1007285	AS.1242/1B							8	—	C	
14703	E.A3.40.213							2	Synthetic Rubber	C	W.2
14702	E.A3.40.205							1	Synthetic Rubber	C	W.2
14704	E.A3.40.211							1	Soft Rubber	C	W.2
21354	E.A1.40.659							1	DTD.683	C	W.2
12913	E.A1.40.657							1	DTD.683	C	W.2
700	E.A1.40.167							1	S.1	C	
701	E.A1.40.39							1	BS.216	C	W.2
702	E.A1.40.43							1	Hard Felt	C	W.2
3631	E.A1.40.27							1	DTD.683	C	W.2
661	E.A1.40.153							2	DTD.412	C	W.2
28M/4095931	A27/SS							1	—	C	
704	E.A1.40.69							1	S.11	C	W.2
1500	E.A3.40.27							1	S.97	C	W.2
708	E.A1.40.139							1	M.S.	C	W.2
707	E.A1.40.77							1	S.11	C	W.2
709	E.A1.40.619							1	L.A.	C	W.2
711	E.A1.40.73							1	DTD.412	C	W.2
718	E.A1.40.147							1	DTD.412	C	W.2
713	E.A1.40.75							1	M.S.	C	W.2
714	E.A1.40.79							1	S.11	C	W.2
715	E.A1.40.83							1	S.11	C	W.2
1514	E.A3.40.29							1	S.96	C	W.2
1515	E.A3.40.31							1	S.96	C	W.2
3632	E.A1.40.28							1	DTD.683	C	W.2
661	E.A1.40.153							2	DTD.412	C	W.2
28M/4095931	A27/SS							1	—	C	
703	E.A1.40.67							1	S.11	C	W.2
1500	E.A3.40.27							1	S.97	C	W.2
708	E.A1.40.139							1	M.S.	C	W.2
707	E.A1.40.77							1	S.11	C	W.2

Continued

**UNDERCARRIAGE
MAIN UNDERCARRIAGE, PORT**

Ref. No.	Part No.	Description						No. off	Matl Spec.	Cl. of Equip. M.R. L.M.	Plate No.
		1	2	3	4	5	6				
709	E.A1.40.619							1	LA.	C	W.2
710	E.A1.40.71							1	S.11	C	W.2
713	E.A1.40.75							1	DTD.412	C	W.2
718	E.A1.40.147							1	DTD.412	C	W.2
714	E.A1.40.79							1	MS.	C	W.2
715	E.A1.40.83							1	S.11	C	W.2
1514	E.A3.40.29							1	S.96	C	W.2
1515	E.A3.40.31							1	S.96	C	W.2
28N/9156370	SP.21							5	L.A.	C	
712	E.A1.40.137							1	MS.	C	W.2
28S/1200034	A31/B16							1	—	C	
28W/1010155	AGS.162/B							1	—	C	
521	E.A1.40.467							1	—	C	W.2
522	E.A1.40.465							2	L.40	C	W.2
28D/9453970	A25/15C							1	—	C	
28M/1278190	AGS.2001/C/1							1	—	C	
	E.A1.40.529							1	—	—	W.2
4173	E.A1.40.517							4	HTS.	C	W.2
27G/6566	DUNLOP AHM.5651							1	—	B	
27G/6567	DUNLOP AHM.5653							1	—	B	
27A/1450834	DUNLOP DT.1609							1	—	A	W.1
27A/3152	DUNLOP DT.1621							1	—	A	W.1
27A/3152	or FIRESTONE ZA.101							1	—	A	
27A/4655	or DUNLOP DR.1623							1	—	A	
27A/4655	or GOODYEAR GA.1266							1	—	A	
27A/4655	or FIRESTONE ZA.303							1	—	A	
27G/2382	DUNLOP AC.11516							1	—	A	W.1
27A/4217	DUNLOP AH.51337							1	—	A	W.1
27A/1450713	AH.52692							1	—	A	

**UNDERCARRIAGE
MAIN UNDERCARRIAGE, PORT**

Ref. No.	Part No.	Description						No. off	Matl Spec.	Cl. of Equip. M.R. L.M.	Plate No.
		1	2	3	4	5	6				
523	E.A1.40.29	STAY, SIDE, UNDERCARRIAGE, ASSEMBLY (PRE-MOD. 3585)						1	—	A	W.1
34172	E.A9.40.43	STAY, SIDE, UNDERCARRIAGE, ASSEMBLY (MOD. 3585) (PRE-MOD. 5051)						1	—	A	
6119299	E.A9.40.73	STAY, SIDE, UNDERCARRIAGE, ASSEMBLY (MOD. 5051)						1	—	A	
		Spares for:—									
528	E.A1.40.221	BOLT , connecting, undercarriage operating jack						1	S.65 or S.81	C	W.3
529	E.A1.40.239	BOLT , stop link stay						1	S.65 or S.81	C	W.3
		Attaching parts for E.A1.40.239:—									
537	E.A1.40.353	Nut, lock						1	S.96	C	W.3
530	E.A1.40.405	BOLT , sequence valve operating						1	S.96	C	W.3
7112	E.A1.40.229	BRACKET , stop bolt						1	S.96	C	W.3
		Attaching parts for E.A1.40.229:—									
28D/1212690	A25/15L	Bolt, 7/8" BSF						1	HTS.	C	
28D/1011310	A25/8L	Bolt, 7/8" BSF						2	HTS.	C	
28M/9129449	A27/LS	Nut, 7/8" BSF						3	—	C	
28P/9560929	SP.90/E8	Pin, split						1	—	C	
7114	E.A1.40.403	BRACKET , sequence valve operating stud ...						1	L.65	C	W.3
		Attaching parts for E.A1.40.403:—									
28D/1212688	A25/18L	Bolt, 7/8" BSF						1	HTS.	C	
28D/9133011	A25/2C	Bolt, 2 BA						1	—	C	
28M/9129449	A27/LS	Nut, 7/8" BSF						1	—	C	
28P/9560929	SP.90/E8	Pin, split						1	—	C	
29C/1006946	AGS.2035/C	Washer, shakeproof						1	—	C	
531	E.A1.40.199	LEVER, UNDERCARRIAGE LOCK, ASSEMBLY						1	—	C	W.3
		Consisting of:—									
532	E.A1.40.213	BUSH						1	DTD.197	C	W.3
	E.A1.40.201	LEVER						1	S.96	—	
533	E.A1.40.200	LEVER, UNDERCARRIAGE LOCK, ASSEMBLY						1	—	C	W.3
		Consisting of:—									
532	E.A1.40.213	BUSH						1	DTD.197	C	W.3
	E.A1.40.202	LEVER						1	S.96	—	
		Attaching parts for E.A1.40.199 and E.A1.40.200:—									
525	E.A1.40.195	Bolt, hook catch						1	S.65 or S.81	C	W.3
22176	E.A1.40.351	Nut, slotted, for hook catch pin bolt (Make from A27/QS)						1	MS.	LM	W.3
28P/19157	SP.90/G10	Pin, split						1	—	C	
543	E.A1.40.219	Tube, distance, for undercarriage "down" switch operating bracket						1	L.65	C	W.3
28W/9419481	SP.15/Q	Washer, 5/8"						1	—	C	
544	E.A1.40.291	Washer, tab at undercarriage hook catch bolt, 20 SWG						1	S.3	C	W.3
547	E.A1.40.417	Washer, under tab and connecting bolts, 24 SWG						1	L.72	C	W.3
13168	E.A3.40.191	LEVER, UNDERCARRIAGE "DOWN" MICRO SWITCH, ASSEMBLY						1	—	C	W.3
		Spares for:—									
179	E.A1.40.569	SCREW , tappet						1	S.96	C	W.3

**UNDERCARRIAGE
MAIN UNDERCARRIAGE, PORT**

Ref. No.	Part No.	Description						No. off	Matl Spec.	Cl. of Equip. M.R. L.M.	Plate No.
		1	2	3	4	5	6				
6472	E.A1.40.225	LINK, SIDE STAY, ASSEMBLY						1	—	B/MR	W.3
		Spares for:—									
536	E.A1.40.227	BUSH , bearing						2	DTD.197	C	W.3
		Attaching parts for E.A1.40.225:—									
526	E.A1.20.197	Bolt, connecting stay link						1	S.65 or S.81	C	W.3
12916	E.A1.40.347	Nut, slotted (Made from A27/WS)						1	MS.	C	W.3
28P/19245	SP.90/K17	Pin, split						1	—	C	
538	E.A1.40.223	Plug, adaptor						1	L.65	C	W.3
546	E.A1.40.357	Washer, link and link stay connecting bolt, 18 SWG						1	S.3	C	W.3
	or E.A1.40.765										
28N/9156370	SP.21	NIPPLE , lubricating, 1/4" BSF						3	LA.	C	
28M/1011470	A27/GT	NUT , 1/8" BSF, sequence valve operating bolt ...						1	—	C	
26667	E.A3.40.193	NUT , slotted, for undercarriage operating jack bolt (Make from A27/JS)						1	—	C	W.3
13184	E.A3.40.199	PLATE						1	DTD.124	C	W.3
539	E.A1.40.205	ROLLER , stop, lever, assembly						1	—	C	W.3
		Attaching parts for E.A1.40.205:—									
527	E.A1.40.203	Bolt						1	S.96	C	W.3
	E.A1.40.349	Nut slotted (Make from A27/JS)						1	MS.	LM	W.3
28P/9527619	SP.90/C7	Pin, split						1	—	C	
7113	E.A1.40.233	SLEEVE , operating spring, for undercarriage lock stop						1	DTD.197	C	W.3
540	E.A1.40.237	SPRING , compression, at lock stop						1	Spring Steel	C	W.3
38706	E.A1.40.31	STAY , side (Pre-Mod. 3585)						1	DTD.683	MR	W.3
40650	E.A9.40.39	STAY , side (Mod. 3585) (Pre-Mod. 5051) ...						1	—	MR	
6119308	E.A9.40.79	STAY , side (Mod. 5051)						1	—	MR	
541	E.A1.40.235	STOP , undercarriage lock						1	S.96	C	W.3
542	E.A1.40.217	TUBE , distance, undercarriage jack bolt undercarriage "Down" switch						1	L.65	C	W.3
545	E.A1.40.355	WASHER , link and link stay connecting bolt ...						1	L.72	C	W.3

**UNDERCARRIAGE
MAIN UNDERCARRIAGE, STARBOARD**

Ref. No.	Part No.	Description						No. off	Matl Spec.	Cl. of Equip. M.R. L.M.	Plate No.
		1	2	3	4	5	6				
	E.A1.40.728	MAIN UNDERCARRIAGE, STARBOARD, ASSEMBLY						1	—	—	
	E.A1.40.730	Consisting of:— LEG, OLEO (LESS WHEEL, BRAKE UNIT AND FIXED FAIRINGS), ASSEMBLY						1	—	—	
		Consisting of:—									
27G/4086	DUNLOP AH.9781	BRAKE unit (For spares see A.P.4515C, Vol. 3, Pt. 1, Sect. 2)						1	—	A	W.1
		Attaching parts for AH.9781:—									
2168	E.A6.40.35	Bolt, securing						10	S.97	C	W.1
28M/13259	A27/NS	Nut, ½" BSF						10	—	C	
2169	E.A3.40.43	Washer, special						10	DTD.124A	C	W.1
6849	E.B6.20.730	FAIRING, FIXED, ASSEMBLY						1	—	B	W.1
		(Supplied with trim allowance)									
		Spares for:—									
17736	E.A6.73.278	BRACKET , bottom						1	L.72	C	W.1
		Attaching parts for E.A6.73.278:—									
5970	E.A6.73.93	Bolt, 2 BA						2	—	C	
28D/9133012	A25/3C	Washer						2	L.72	C	W.1
3061	E.A3.20.854	FAIRING, FIXED, SUB-ASSEMBLY						1	—	LM	
		Spares for:—									
21721	E.A3.20.2870	PANEL, HINGE, ASSEMBLY						1	—	B	
		Spares for:—									
3026	E.A1.20.1679	HINGE (Make from 28N/9486785)						1	—	LM	
1887	E.A1.20.1676	PANEL , hinge, 16 SWG						1	L.72	C	
1413	E.A1.40.436	SPRING						2	Spring Steel	C	
	E.A1.20.6817	PANEL , access, picket point						1	—	C	W.1
	E.A3.20.1627	SEAL , ½" dia. x 90" long (Make from Ref. 4432)						1	Syn. Rub.	LM	W.1
		Attaching parts for E.B6.20.730:—									
4174	E.A1.40.519	Bolt, securing fixed fairing mounting brackets to leg (Made from A25/5G)						8	H.T.S.	C	
28W/1086617	AGS.162/E	Washer, spring						8	—	C	
32315	E.A9.40.24	LEG, SLIDING, AND OLEO HEAD, ASSEMBLY (PRE-MOD. 4270)						1	—	A	
34713	E.A9.40.60	LEG, SLIDING, AND OLEO HEAD, ASSEMBLY (MOD. 4270)						1	—	A	
		Spares for:—									
660	E.A1.40.639	BRACKET , angle, micro-switch mounting, 20 SWG						1	L.72	C	W.1
		Attaching parts for E.A1.40.639:—									
28D/9140638	A25/4B	Bolt, 4 BA						4	—	C	
28M/9403519	A27/BP	Nut, 4 BA						4	—	C	
706	E.A1.40.335	Plate, packing						1	L.A.	C	W.1
28W/1010155	AGS.162/B	Washer, spring						4	—	C	
662	E.A1.40.671	FINGER , operating, micro-switch						1	—	C	W.2
		Attaching parts for E.A1.40.671:—									
28S/9435713	A31/C20	Screw, 2 BA						2	—	C	
28W/1007983	AGS.162/C	Washer, spring						2	—	C	
	E.A6.40.4	HEAD, OLEO, ASSEMBLY (PRE-MOD. 4270)						1	—	—	
	E.A9.40.58	HEAD, OLEO, ASSEMBLY (MOD. 4270)						1	—	—	
		Spares for:—									
663	E.A1.40.89	BEARING , spherical seated, ball joint side stay						1	S.96	C	W.2

**UNDERCARRIAGE
MAIN UNDERCARRIAGE, STARBOARD**

Ref. No.	Part No.	Description						No. off	Matl Spec.	Cl. of Equip.		Plate No.
		1	2	3	4	5	6			M.R.	L.M.	
		Attaching parts for E.A1.40.89:—										
664	E.A1.40.101	Bush, bearing						1	DTD.412	C		W.2
675	E.A1.40.96	Ring, lower, retaining, ball joint						1	DTD.412	C		W.2
677	E.A1.40.98	Ring, upper, retaining, ball joint						1	DTD.412	C		W.2
680	E.A1.40.99	Stud, for retaining rings at ball joint						12	S.96	C		W.2
665	E.A1.40.109	BUSH , pivot (Pre-Mod. 4270)						2	—	C		W.2
1438501	E.A9.40.63	BUSH , pivot (Mod. 4270)						2	DTD.412	MR		
666	E.A1.40.111	BUSH , torque link lug						2	DTD.412	C		W.2
		Attaching parts for E.A1.40.111:—										
673	E.A1.40.679	Plug, pivot bearing bush, retaining						2	L.65	C		W.2
667	E.A1.40.133	DISC , sealing, piston dowel plug						2	L.65	C		W.2
		Attaching parts for E.A1.40.133:—										
679	E.A1.40.625	Screw, retaining, plug, dowel seal						2	L.65	C		W.2
668	E.A1.40.131	DOWEL , piston						2	S.96	C		W.2
21482	E.A1.40.20	HEAD , oleo, forging (Pre-Mod. 4270)						1	DTD.683	A/MR		W.2
42059	E.A9.40.56	HEAD , oleo, forging (Mod. 4270)						1	DTD.5094	B/MR		
		Supplied to Drg. E.A9.07.36 for spares purposes										
669	E.A1.40.103	HOOK , "S" shaped, 16 SWG						2	M.S. Wire	C		W.2
20656	E.A1.40.127	PIPE , stack, assembly						1	—	B/MR		W.2
		Attaching parts for E.A1.40.127:—										
28F/9428453	AGS.1186/B	Seal, bonded						1	—	C		
	E.A6.40.6	PISTON, OPERATING, ASSEMBLY						1	—	—		W.2
		Consisting of:—										
1099	EEAS.37/22A	NIPPLE , 2 BA						2	S.96	C		
670	E.A1.40.647	PISTON						1	DTD.197	C		W.2
22528	E.A6.40.33	PLATE , orifice enclosure, control						1	S.96	C		W.2
		Attaching parts for E.A6.40.33:—										
683	E.A1.40.61	Bolt, attachment, enclosure orifice plate						3	S.96	C		W.2
672	E.A1.40.651	RING , piston						1	—	C		W.2
	EEAS.38/3A	SPOKE , 2 BA (Make from 28R/6328)						1	S.96	—		
12914	E.A1.40.118	STRUT , piston, main						1	L.62	C		W.2
678	E.A1.40.155	RING , sealing, at dowel						2	Syn. Rub.	C		W.2
681	E.A1.40.105	TUBE , distance, packing, for locking washer						1	L.65	C		W.2
	H. P. COMP.											
28Y/9701165	GYP.A58	VALVE , charging						1	—	C		W.2
		Attaching parts for GYP.A58:—										
28F/9428453	AGS.1138/B	Seal, bonded						1	—	C		
682	E.A1.40.149	Washer, locking, 14 SWG						1	DTD.124	C		W.2
	E.A3.40.226	LEG, SLIDING, COMPRESSION, ASSEMBLY (PRE-MOD. 4270)						1	—	—		W.2
	E.A9.40.62	LEG, SLIDING, COMPRESSION, ASSEMBLY (MOD. 4270)						1	—	—		
		Spares for:—										
26640	E.A3.40.201	BOLT , clamp, locking						1	S.95 or S.96	C		
684	E.A1.40.161	BUSH , bearing, in lug						2	DTD.124	C		W.2
2467	E.A3.40.45	BUSH , bearing						1	—	C		W.2
	E.A3.40.217	CLAMP, AXLE, ASSEMBLY						1	—	—		
		Spares for:—										
21355	E.A3.40.23	BUSH						1	L.16	C		
13024	E.A3.40.183	CLAMP , axle body						1	—	C		W.2
1753	E.A3.40.19	LINK , towing						1	—	C		W.2

**UNDERCARRIAGE
MAIN UNDERCARRIAGE, STARBOARD**

Ref. No.	Part No.	Description						No. off	Matl Spec.	Cl. of Equip. M.R. L.M.	Plate No.
		1	2	3	4	5	6				
21537	E.A3.40.21							1	—	C	W.2
14706	E.A3.40.209							1	L.56	C	
1463	E.A3.40.10							1	—	A	W.2
691	E.A1.40.41							1	S.11	C	W.2
32210	E.A3.40.221							3	S.97	C	
	E.A3.40.219							1	DTD.197	C	
693	E.A1.40.175							1	S.65	C	W.2
683	E.A1.40.61							6	S.11	C	
695	E.A1.40.677							2	L.40	C	W.2
14701	E.A3.40.203							1	DTD.683	C	W.2
14705	E.A3.40.215							2	—	C	W.2
14700	E.A3.40.207							1	L.64	C	W.2
697	E.A1.40.57							1	—	C	W.2
12915	E.A1.40.45							1	MS.	C	W.2
28D/1007285	AS.1242/1B							8	—	C	
14703	E.A3.40.213							2	Soft Rubber	C	W.2
14702	E.A3.40.205							1	Soft Rubber	C	W.2
14704	E.A3.40.211							1	Soft Rubber	C	W.2
21354	E.A1.40.659							1	DTD.683	C	W.2
12913	E.A1.40.657							1	DTD.683	C	W.2
700	E.A1.40.167							1	S.1	C	
701	E.A1.40.39							1	BS.216	C	W.2
702	E.A1.40.43							1	Hard Felt	C	W.2
3632	E.A1.40.28							1	DTD.683	C	W.2
661	E.A1.40.153							2	DTD.412	C	W.2
28M/4095931	A27/55							1	—	C	
704	E.A1.40.69							1	S.11	C	W.2
1500	E.A3.40.27							1	S.97	C	W.2
708	E.A1.40.139							1	MS.	C	W.2
707	E.A1.40.77							1	S.11	C	W.2
709	E.A1.40.619							1	LA.	C	W.2
711	E.A1.40.73							1	S.11	C	W.2
718	E.A1.40.147							1	DTD.412	C	W.2
713	E.A1.40.75							1	DTD.412	C	W.2
714	E.A1.40.79							1	MS.	C	W.2
715	E.A1.40.83							1	S.11	C	W.2
1514	E.A3.40.29							1	S.96	C	W.2
1515	E.A3.40.31							1	S.96	C	W.2

**UNDERCARRIAGE
MAIN UNDERCARRIAGE, STARBOARD**

Ref. No.	Part No.	Description						No. off	Matl Spec.	Cl. of Equip. M.R. L.M.	Plate No.
		1	2	3	4	5	6				
3631	E.A1.40.27	LINK, torque, bottom						1	DTD.683	C	W.2
		Attaching parts for E.A1.40.27:—									
661	E.A1.40.153	Bush, bearing						2	DTD.412	C	W.2
28M/4095931	A27/SS	Nut, ½" BSF						1	—	C	
703	E.A1.40.67	Pin, bearing, bottom torque link						1	S.11	C	W.2
1500	E.A3.40.27	Pin, bearing, torque link joint						1	S.97	C	W.2
708	E.A1.40.139	Screw, grub, locking, bottom bearing pin						1	MS.	C	W.2
707	E.A1.40.77	Screw, retaining, bearing pin						1	S.11	C	W.2
709	E.A1.40.619	Shim, bearing, pin, sleeve						1	LA.	C	W.2
710	E.A1.40.71	Sleeve, bearing, for torque link						1	S.11	C	W.2
713	E.A1.40.75	Washer, bearing, thrust						1	DTD.412	C	W.2
718	E.A1.40.147	Washer, bearing, thrust						1	DTD.412	C	W.2
714	E.A1.40.79	Washer, locking, bearing pin retaining screw, 16 SWG						1	MS.	C	W.2
715	E.A1.40.83	Washer, spacing, at torque link joint, between link bearings						1	S.11	C	W.2
1514	E.A3.40.29	Washer, torque link joint						1	S.96	C	W.2
1515	E.A3.40.31	Washer, torque link joint						1	S.96	C	W.2
28N/9156370	SP.21	NIPPLE, lubricating, ½" BSF						5	LA.	C	
712	E.A1.40.137	TAB, locking, 16 SWG						1	MS.	C	W.2
		Attaching parts for E.A1.40.137:—									
28S/1200034	A31/B16	Screw, 4 BA						1	—	C	
28W/1010155	AGS.162/B	Washer, spring						1	—	C	
521	E.A1.40.467	LEVER, COWL DOOR MECHANISM, ASSEMBLY						1	—	C	W.2
		Spares for:—									
522	E.A1.40.465	BUSH, bearing						2	L.40	C	W.2
		Attaching parts for E.A1.40.465:—									
28D/9453970	A25/15C	Bolt, 2 BA						1	—	C	
28M/1278190	AGS.2001/C/1	Nut, 2 BA						1	—	C	
	E.A1.40.529	LEVER, operating						1	—	—	W.2
		Attaching parts for E.A1.40.467:—									
4173	E.A1.40.517	Bolt, securing cowl door mechanism to leg (Make from A25/5E)						4	HTS.	C	W.2
27G/2487	DUNLOP AHM.2576	PIPE, feed, for maxaret unit						1	—	B	
27G/2488	DUNLOP AHM.2578	PIPE, feed, for maxaret unit						1	—	B	
27A/1450834	DUNLOP DT.1609	TUBE, 43" x 12"5 x 21"						1	—	A	W.1
27A/3152	DUNLOP DF.1621	TYRE, 43" x 12"5 x 21"						1	—	A	W.1
	or FIRESTONE										
27A/3152	ZA.101	TYRE, 43" x 12"5 x 21"						1	—	A	
	or DUNLOP										
27A/4655	DR.1623	TYRE, 43" x 12"5 x 21"						1	—	A	
	or GOODYEAR										
27A/4655	GA.1266	TYRE, 43" x 12"5 x 21"						1	—	A	

**UNDERCARRIAGE
MAIN UNDERCARRIAGE, STARBOARD**

Ref. No.	Part No.	Description	No. off	Matl Spec.	Cl. of Equip.	Plate No.
					M.R. L.M.	
		1 2 3 4 5 6				
27A/4655	or FIRESTONE ZA.303	TYRE, 43" x 12"5 x 21"	1	—	A	
27G/2381	DUNLOP AC.11514	UNIT, maxaret automatic brake control	1	—	A	W.1
27A/4217	DUNLOP AH.51337	WHEEL, undercarriage (For spares see A.P.1086, Part II) (Pre-Mod. 4481)	1	—	A	W.1
27A/1450713	AH.52692	WHEEL, undercarriage (Mod. 4481)	1	—	A	W.1
524	E.A1.40.30	STAY, SIDE, UNDERCARRIAGE, ASSEMBLY (PRE- MOD. 3585)	1	—	A	W.1
34173	E.A9.40.44	STAY, SIDE, UNDERCARRIAGE, ASSEMBLY (MOD. 3585) (PRE-MOD. 5051)	1	—	A	
6119300	E.A9.40.74	STAY, SIDE, UNDERCARRIAGE, ASSEMBLY (MOD. 5051)	1	—	A	
		Spares for:—				
528	E.A1.40.221	BOLT, connecting, undercarriage operating jack	1	S.65 or S.81	C	W.3
529	E.A1.40.239	BOLT, stop link stay	1	S.65 or S.81	C	W.3
		Attaching parts for E.A1.40.239:—				
537	E.A1.40.353	Nut, lock	1	S.96	C	W.3
530	E.A1.40.405	BOLT, sequence valve operating	1	S.96	C	W.3
7112	E.A1.40.229	BRACKET, stop bolt	1	S.96	C	W.3
		Attaching parts for E.A1.40.229:—				
28D/1212690	A25/15L	Bolt, 1/2" BSF	1	HTS.	C	
28D/1011310	A25/8L	Bolt, 1/2" BSF	2	HTS.	C	
28M/9129449	A27/LS	Nut, 1/2" BSF	3	—	C	
28P/9560929	SP.90/E8	Pin, split	3	—	C	
32721	E.A1.40.404	BRACKET, sequence valve operating stud ...	1	L.65	C	W.3
		Attaching parts for E.A1.40.404:—				
28D/1212688	A25/18L	Bolt, 1/2" BSF	1	HTS.	C	
28D/9133011	A25/2C	Bolt, 2 BA	1	—	C	
28M/9129449	A27/LS	Nut, 1/2" BSF	1	—	C	
28P/9560929	SP.90/E8	Pin, split	1	—	C	
28W/1006946	AGS.2035/C	Washer, shakeproof	1	—	C	
531	E.A1.40.199	LEVER, UNDERCARRIAGE LOCK, ASSEMBLY	1	—	C	W.3
		Consisting of:—				
532	E.A1.40.213	BUSH	1	DTD.197	C	W.3
	E.A1.40.201	LEVER	1	S.96	—	
533	E.A1.40.200	LEVER, UNDERCARRIAGE LOCK, ASSEMBLY	1	—	C	W.3
		Consisting of:—				
532	E.A1.40.213	BUSH	1	DTD.197	C	W.3
	E.A1.40.202	LEVER	1	S.96	—	
		Attaching parts for E.A1.40.199 and E.A1.40.200:—				
525	E.A1.40.195	Bolt, hook catch	1	S.65 or S.81	C	W.3
22176	E.A1.40.351	Nut, slotted, for hook catch pin bolt (Make from A27/QS)	1	MS.	LM	W.3
28P/19157	SP.90/G10	Pin, split	1	—	C	
543	E.A1.40.219	Tube, distance, for undercarriage "Down" switch operating bracket	1	L.65	C	W.3
28W/9419481	SP.15/Q	Washer	1	—	C	
544	E.A1.40.291	Washer, tab at undercarriage hook catch bolt, 20 SWG	1	S.3	C	W.3
547	E.A1.40.417	Washer, under tab and connecting bolts, 24 SWG	1	L.72	C	W.3

**UNDERCARRIAGE
MAIN UNDERCARRIAGE, STARBOARD**

Ref. No.	Part No.	Description						No. off	Matl Spec.	Cl. of Equip. M.R. L.M.	Plate No.
		1	2	3	4	5	6				
13169	E.A3.40.192	LEVER, UNDERCARRIAGE "DOWN" MICRO SWITCH, ASSEMBLY						1	—	C	W.3
		Spares for:—									
179	E.A1.40.569	SCREW , tappet						1	S.96	C	W.3
6472	E.A1.40.225	LINK, SIDE STAY, ASSEMBLY						1	—	B/MR	W.3
		Spares for:—									
536	E.A1.40.227	BUSH , bearing						2	DTD.197	C	W.3
		Attaching parts for E.A1.40.225:—									
526	E.A1.40.197	Bolt, connecting stay and link						1	S.65 or S.81	C	W.3
12916	E.A1.40.347	Nut, slotted (Make from A27/WS)						1	MS.	C	W.3
28P/19245	SP.90/K17	Pin, split						1	—	C	
538	E.A1.40.223	Plug, adaptor						1	L.65	C	W.3
546	E.A1.40.357	Washer, link and link stay connecting bolt, 18 SWG						1	S.3	C	W.3
	or E.A1.40.765										
28N/9156370	SP.21	NIPPLE , lubricating, 1/2" BSF						3	LA.	C	
28M/1011470	A27/GT	NUT , 5/8" BSF, sequence, valve operating bolt ...						1	—	C	
26667	E.A3.40.193	NUT , slotted, for undercarriage operating jack bolt (Make from A27/JS)						1	—	C	W.3
13184	E.A3.40.199	PLATE						1	DTD.124	C	W.3
539	E.A1.40.205	ROLLER , stop lever, assembly						1	—	C	W.3
		Attaching parts for E.A1.40.205:—									
527	E.A1.40.203	Bolt						1	S.96	C	W.3
	E.A1.40.349	Nut, slotted (Make from A27/JS)						1	MS.	—	W.3
28P/9527619	SP.90/C7	Pin, split						1	—	C	
7113	E.A1.40.233	SLEEVE , operating spring, for undercarriage lock stop						1	DTD.197	C	W.3
540	E.A1.40.237	SPRING , compression at lock stop						1	Spring Steel	C	W.3
38707	E.A1.40.32	STAY , side (Pre-Mod. 3585)						1	DTD.683	MR	W.3
40651	E.A9.40.40	STAY , side (Mod. 3585) (Pre-Mod. 5051)						1	—	MR	
6119309	E.A9.40.80	STAY , side (Mod. 5051)						1	—	MR	
541	E.A1.40.235	STOP , undercarriage lock						1	S.96	C	W.3
542	E.A1.40.217	TUBE , distance, undercarriage jack bolt undercarriage "Down" switch						1	L.65	C	W.3
545	E.A1.40.355	WASHER , link and link stay connecting bolt ...						1	L.72	C	W.3

**UNDERCARRIAGE
NOSEWHEEL**

Ref. No.	Part No.	Description	No. off	Matl Spec.	Cl. of Equip.	Plate No.
					M.R. L.M.	
		1 2 3 4 5 6				
	E.A9.40.1	NOSEWHEEL, ASSEMBLY	—	—	—	
		Spares for:—				
22055	E.A9.40.15	BLOCK , flexible hose support	2	BS.2572	C	W.6
		Attaching parts for E.A9.40.15:—				
28D/9133011	A25/2C	Bolt, 2 BA	1	—	C	
22057	E.A9.40.13	Clip	1	L.72	C	W.6
28M/1278190	AGS.2001/C/1	Nut, 2 BA	1	—	C	
22329	E.A9.40.17	Washer, corner	1	L.72	C	W.6
3753	E.A1.40.617	BOLT , adjusting, undercarriage door crosshead stop (made from Ref. 28D/1008145)	2	H.T.S.	C	W.6
22373	E.A9.40.19	BOLT , connecting operating jack to undercarriage locking lever (Pre-Mod. 2704)	1	S.96	C	
32172	E.A9.40.21	BOLT , connecting operating jack to undercarriage locking lever (Mod. 2704)	1	S.96	C	
169	E.A1.40.605	BOLT , hydraulic jack anchor	1	S.97	C	W.6
4507	E.A3.40.139	BOLT , jack attachment to crosshead	1	S.95	C	W.6
163	E.A1.40.491	BOLT , nosewheel door "Up" latch forward	1	S.96	C	W.4
164	E.A1.40.493	BOLT , nosewheel door "Up" latch aft	1	S.96	C	W.6
22056	E.A9.40.11	BOLT , nose undercarriage jack hinge	1	S.95	C	W.6
12023	E.A3.40.159	BRACKET, UNDERCARRIAGE "UP" HOOK, ASSEMBLY (PRE-MOD. 4449)	1	—	B	
1439142	E.A3.40.251	BRACKET, UNDERCARRIAGE "UP" HOOK, ASSEMBLY (MOD. 4449—S.O.O.) Consisting of:—	1	—	B	
	E.A1.40.385	BEAM, BRACKET, LOCKING HOOK, ASSEMBLY (PRE-MOD. 5100)	1	—	—	W.4
	E.A3.40.265	BEAM, BRACKET, LOCKING HOOK, ASSEMBLY (ALT. R60/304—MOD. 5100) Spares for:—	1	—	—	
20845	E.A1.40.369	LUG (Pre-Mod. 5100)	1	L.65	C/MR	W.4
	E.A3.40.263	LUG (Alt. R60/304—Mod. 5100)	1	L.65	—	
		Attaching parts for E.A3.40.263:—				
28D/9133012	A25/3C	Bolt, 2 BA	2	—	C	
28M/9433473	AGS.2002/C/1	Nut, 2 BA	2	—	C	
28V/9457834	SP.124/D	Washer	4	—	C	
25628	E.A1.40.377	PLATE , locking	1	L.72	C	W.4
		Attaching parts for E.A1.40.385:—				
28D/1012995	A25/22C	Bolt, 2 BA	8	—	C	
28M/9403520	A27/CP	Nut, 2 BA	8	—	C	
	E.A1.40.381	Tube, distance	8	L.62	LM	W.4
28W/1007483	AGS.162/C	Washer	8	—	C	
28V/9416643	SP.47/C	Washer, spring (Mod. 4449—S.O.O.)	8	—	C	
12024	E.A3.40.151	BOLT , stop, for buffer, assembly	2	—	C	W.4
		Attaching parts for E.A3.40.151:—				
28M/4095808	AGS.2001/J/1	Nut, $\frac{1}{8}$ " BSF	1	M.S.	C	
174	E.A1.40.399	Washer, laminum	1	L.A.	C	W.4
22251	E.A1.40.373	BRACKET , hook suspension	1	S.96	C	W.4
		Attaching parts for E.A1.40.373:—				
28M/4095808	AGS.2001/J/1	Nut, $\frac{1}{8}$ " BSF	1	M.S.	C	
28W/9419489	SP.16/J	Washer	1	—	C	
174	E.A1.40.399	Washer, laminum	1	L.A.	C	W.4

**UNDERCARRIAGE
NOSEWHEEL**

Ref. No.	Part No.	1	2	3	4	5	6	Description	No. off	Matl Spec.	Cl. of Equip.	Plate No.
											M.R.	
												L.M.
12025	E.A3.40.143	HOOK, UNDERCARRIAGE "UP" LATCH, ASSEMBLY (PRE-MOD. 4449)						1	—	B	W.4	
1439143	E.A3.40.249	HOOK, UNDERCARRIAGE "UP" LATCH, ASSEMBLY (MOD. 4449—S.O.O.)						1	—	B	W.4	
Consisting of:—												
13109	E.A3.40.147	BOLT , special						1	DTD.126A	C	W.4	
	E.A1.40.393	BUSH						1	DTD.197	—	W.4	
	E.A3.40.145	HOOK , "UP" latch (Pre-Mod. 4449)						1	H.T.S.	—	W.4	
	E.A3.40.243	HOOK , "UP" latch (Mod. 4449—S.O.O.)						1	H.T.S.	—	W.4	
28M/9403520	A27/CP	NUT , 2 BA						1	—	C		
28W/1007983	AGS.162/C	WASHER , spring						1	—	C		
Attaching parts for E.A3.40.143 or E.A3.20.249:—												
171	E.A1.40.371	Bolt, pivot for hook						1	S.96	C	W.4	
28M/1011407	A27/ES	Nut, 1/2" BSF						1	—	C		
28P/9527619	SP.90/C7	Pin, split						1	—	C		
20846	E.A1.40.389	SCREW , adjusting, hook stop						1	S.96	C/MR	W.4	
Attaching parts for E.A1.40.389:—												
28M/1011475	A27/EP	Nut, adjusting, 1/2" BSF						1	—	C		
4694	E.A3.40.93	CROSSHEAD, NOSEWHEEL DOORS, C/W VALVE TRIP, ASSEMBLY						1	—	B/MR		
Spares for:—												
5514	E.A3.40.97	PIN , roller top						1	S.96	C	W.6	
12926	E.A3.40.181	PIN , roller, bottom						1	S.96	C	W.6	
178	E.A1.40.553	ROLLER , guide						2	DTD.683	C	W.6	
5515	E.A1.40.561	VALVE , trip						1	—	C	W.6	
Attaching parts for E.A1.40.561:—												
28S/1011504	A33/C32	Screw, 2 BA, 1" long						1	—	C		
	E.A3.40.95	YOKE , crosshead						1	—	—	W.6	
39181	E.A9.40.35	LEVER , micro-switch operating, undercarriage door front latch						1	—	C	W.4	
Attaching parts for E.A9.40.35:—												
28D/9140647	A25/14C	Bolt, 2 BA						1	H.T.S.	1		
28M/1278190	AGS.2001/C/1	Nut, 2 BA						1	M.S.	1		
3755	E.A1.40.731	Piece, distance						1	—	C	W.4	
4141	E.A1.45.989	Shim						2	—	C		
	AS.2811-7-023	Spacer						2	L.62	LM		
3751	E.A1.40.567	LEVER, UNDERCARRIAGE SEQUENCE VALVE, ASSEMBLY						1	—	B/MR	W.6	
Spares for:—												
179	E.A1.40.569	TAPPET , valve screw						1	S.96	C	W.4	
Attaching parts for E.A1.40.569:—												
28M/1007403	A27/ET	Nut, 1/2" BSF, adjusting						1	—	C		
Attaching parts for E.A1.40.567:—												
166	E.A1.40.581	Bolt, fulcrum, undercarriage door actuating sequence valve						1	S.96	C	W.6	
28M/1006939	A27/GP	Nut, 1/2" BSF						1	—	C		
1078	EEAS.28/35FU	Washer, packing, 0"33 dia.						1	DTD.124	C		

**UNDERCARRIAGE
NOSEWHEEL**

Ref. No.	Part No.	Description	No. off	Mati Spec.	Cl. of Equip.	Plate No.
					M.R. L.M.	
		1 2 3 4 5 6				
3754	E.A1.40.703	LEVER, BRACKET, UNDERCARRIAGE SEQUENCE VALVE, ASSEMBLY	1	—	B/MR	W.4
		Spares for:—				
	E.A1.40.707	BRACKET , valve, sequence, front	1	—	—	W.4
	E.A1.40.705	BRACKET , valve, sequence, rear	1	—	—	
		Attaching parts for E.A1.40.707 and E.A1.40.705:—				
28D/9133012	A25/3C	Bolt, 2 BA	2	—	C	
28M/1278190	AGS.2001/C/1	Nut, 2 BA	2	—	C	
1438863	E.A1.40.573	LEVER , sequence valve operating	1	DTD.683	C	W.4
		Attaching parts for E.A1.40.573:—				
13182	E.A1.40.709	Bolt, operating lever fulcrum	1	S.96	C	W.4
28M/5808573	A27/CS	Nut, 2 BA	1	—	C	
28W/9419475	SP.15/C	Washer, 2 BA	1	—	C	
	E.A1.40.711	Washer, fulcrum bolt	2	S.96	—	W.4
179	E.A1.40.569	TAPPET , valve screw	1	S.96	C	W.6
		Attaching parts for E.A1.40.569:—				
28M/1007403	A27/ET	Nut, adjusting	1	—	C	

**UNDERCARRIAGE
NOSEWHEEL**

Ref. No.	Part No.	Description	No. off	Matl. Spec.	Cl. of Equip.		Plate No.
					M.R.	L.M.	
		1 2 3 4 5 6					
180	E.A1.40.531	LINK DOOR, OPERATING, ASSEMBLY	2	—	C		W.6
		Spares for:—					
4778	E.A1.40.535	BOLT , eye, assembly	2	—	C		W.6
		Attaching parts for E.A1.40.535:—					
33793	E.A1.40.541	Nut (Make from Ref. 14533)	2	MS.	C		W.6
	E.A1.40.533	TUBE , assembly	1	—	—		W.6
		Attaching parts for E.A1.40.533:—					
168	E.A1.40.595	Bolt , link to crosshead	1	—	C		W.6
167	E.A1.40.593	Bolt , link to door	1	—	C		W.6
28M/1011467	A27/ES	Nut , 1/2" BSF	2	—	C		
8987	E.A3.40.169	MUDGUARD, NOSEWHEEL, ASSEMBLY	1	—	B		W.4
		Consisting of:—					
5503	E.A3.40.133	FLAP , rubber, nosewheel mudguard	1	Shore 40	C		W.4
5504	E.A3.40.127	MUDGUARD , nosewheel	1	L.72	C		W.4
		Attaching parts for E.A3.40.127:—					
28D/1013177	AS.1242/2E	Bolt , 1/2" BSF	9	HTS.	C		
5505	E.A3.40.131	Nut , 1/2" BSF	3	S.95	C		
28M/1007403	A27/ET	Nut , 1/2" BSF	6	MS.	C		
6948	E.A3.40.165	STAY , mudguard, assembly	1	—	C		W.4
6949	E.A3.40.167	STAY , end, mudguard, attachment	3	DTD.683	C		W.4
		Attaching parts for E.A3.40.167:—					
28D/9133012	A25/3C	Bolt , 2 BA	12	HTS.	C		
28M/1006473	A27/CT	Nut , 2 BA	12	MS.	C		
28W/9419475	SP.15/C	Washer	12	—	C		
20930	E.A3.40.135	STRIP , backing	1	L.72	C/MR		W.4
		Attaching parts for E.A3.40.135:—					
28D/1007974	AS.1242/1/2C	Bolt , 2 BA	3	HTS.	C		
5506	E.A3.40.137	Nut , 2 BA	3	S.95	C		
		Attaching parts for E.A3.40.169:—					
28D/1011300	A25/7J	Bolt , 1/2" BSF	3	HTS.	C		
28W/9419477	SP.15/J	Washer , 1/2" BSF	3	LA.	C		
8988	E.A3.40.170	MUDGUARD, NOSEWHEEL, ASSEMBLY	1	—	B		W.4
		Spares for this assembly are identical with those for Part No. E.A3.40.169					
28N/9156370	SP.21	NIPPLE , lubricating	1	—	C		
3688	E.A6.40.37	ROD, RADIUS, ASSEMBLY	1	—	A		
		Consisting of:—					
5126	E.A3.40.77	BRACKET , micro switch	1	L.72	C		W.5
		Attaching parts for E.A3.40.77:—					
28D/9436920	A25/1C	Bolt , 2 BA	3	—	C		
28W/9416643	SP.47/C	Washer , spring	3	—	C		
3656	E.A3.40.65	BUSH , spring, plunger	1	DTD.197	C		W.5
186	E.A1.40.621	DOWEL	2	S.11	C		W.5
1893	E.A6.40.21	END, PLUG, RADIUS ROD, ASSEMBLY	1	—	B		W.5
		Spares for:—					
187	E.A1.40.363	BUSH , bearing	2	DTD.197	C		W.5
28N/9156370	SP.21	NIPPLE , lubricating	1	—	C		

**UNDERCARRIAGE
NOSEWHEEL**

Ref. No.	Part No.	1	2	3	4	5	6	Description	No. off	Matl. Spec.	Cl. of Equip.		Place No.
											M.R.	L.M.	
4937	E.A1.40.311							FINGER , operating, undercarriage "up" micro switch	1	L.40	C		W.5
								Attaching parts for E.A1.40.311:—					
4447	E.A1.40.321							Bolt, bearing, for micro switch operating finger ...	1	DTD.126A	C		W.5
28M/9436836	AGS.2001/C/2							Nut, 2 BA ...	1	—	C		
28W/9419402	SP.13/C							Washer ...	1	—	C		
1894	E.A6.40.29							FORK , strut end ...	1	DTD.683	C		W.5
3655	E.A3.40.73							HOUSING , spring locking plunger ...	1	L.40	C		W.5
								Attaching parts for E.A3.40.73:—					
28D/1011240	A25/5E							Bolt, 1/2" BSF ...	4	—	C		
28W/9416644	SP.47/E							Washer, 1/2" BSF ...	4	—	C		
41255	E.A9.40.49							LEVER, LOCKING, NOSEWHEEL UNDER-CARRIAGE, ASSEMBLY	1	—	B		W.5
								Spares for:—					
190	E.A1.40.337							BUSH , bearing ...	2	DTD.197	C		W.5
28N/9156370	SP.21							NIPPLE , lubricating ...	1	—	C		
192	E.A1.40.339							ROLLER , assembly ...	1	—	C		W.5
								Attaching parts for E.A1.40.339:—					
188	E.A1.40.343							Bolt ...	1	S.11	C		W.5
28M/1011467	A27/ES							Nut, 1/2" BSF ...	1	—	C		
28P/1007741	SP.9/C8							Pin, split ...	1	—	C		
28W/9419405	SP.15/E							Washer ...	1	—	C		
191	E.A1.40.341							ROLLER , assembly ...	1	—	C		W.5
								Attaching parts for E.A1.40.341:—					
189	E.A1.40.345							Bolt ...	1	S.11	C		W.5
28M/1011467	A27/ES							Nut, 1/2" BSF ...	1	—	C		
28P/1007741	SP.9/C8							Pin, split ...	1	—	C		
28W/9419405	SP.15/E							Washer ...	1	—	C		
								Attaching parts for E.A9.40.49:—					
34309	E.A9.40.47							Bolt, operating lever bearing ...	1	S.96	C		W.5
28M/1011476	A27/JS							Nut, 1/2" BSF ...	1	—	C		
203	E.A1.40.327							Washer, at operating lever bearing ...	1	DTD.126A	C		W.5
1889	E.A6.40.23							LINK, STAY, NOSEWHEEL UNDERCARRIAGE AT RADIUS ROD, ASSEMBLY	1	—	C		W.5
								Spares for:—					
194	E.A1.40.359							BUSH , bearing ...	2	DTD.197	C		W.5
195	E.A1.40.361							BUSH , bearing ...	2	DTD.197	C		W.5
28N/9156370	SP.21							NIPPLE , lubricating ...	2	—	C		
								Attaching parts for E.A6.40.23:—					
184	E.A1.40.681							Bolt, connecting radius rod and stay link ...	1	S.11	C		W.5
170	E.A1.40.683							Bolt, connecting stay link and undercarriage leg ...	1	S.11	C		W.4
28M/9129449	A27/LS							Nut, 3/8" BSF ...	2	—	C		
28S/9146378	A35/C8							Screw, 2 BA ...	1	—	C		
202	E.A1.40.325							Washer, cap ...	2	DTD.126A	C		W.5
28W/9416643	SP.47/C							Washer, spring ...	1	—	C		
28N/9156370	SP.21							NIPPLE , lubricating ...	1	—	C		
1100	EEAS.37/24A							NIPPLE , 1/2" ...	24	—	C		W.5

**UNDERCARRIAGE
NOSEWHEEL**

Ref. No.	Part No.	Description	No. Off	Matl Spec.	Cl. of Equip.	Plate No.
					M.R. L.M.	
		1 2 3 4 5 6				
6187	E.A1.40.415	PAD , switch, undercarriage "Down" micro switch	1	L.40	C	W.5
28D/9133012	A25/3C	Attaching parts for E.A1.40.415:—				
		Bolt, 2 BA	3	—	C	
28W/9416643	SP.47/C	Washer, spring	3	—	C	
3659	E.A3.40.75	PIN , latch	1	S.96	C	W.5
197	E.A1.40.277	PLATE , stop stay link	1	S.96	C	W.5
		Attaching parts for E.A1.40.277:—				
28D/1011240	A25/5E	Bolt, 1/2" BSF	2	—	C	
28W/9416644	SP.47/E	Washer	2	—	C	
3657	E.A3.40.67	SCREW , cap retaining, undercarriage locking plunger	1	L.40	C	W.5
3660	E.A3.40.71	SCREW , grub, latch pin and bush, retaining ...	1	S.97	C	W.5
199	E.A1.40.431	SPINDLE , hook latch, nosewheel undercarriage stay	1	S.96	C	W.5
		Attaching parts for E.A1.40.431:—				
28N/2001540	AGS.2031/4	Circlip, "Seegar" external, 3/8" dia.	2	—	C	
	E.A1.40.309	Tube, distance	1	—	—	W.5
	EEAS.38/4A	SPOKE , 1/4" BSF (Make from 28R/6330)	12	S.96	LM	W.5
3658	E.A3.40.69	SPRING , compression, operating locking plunger, 14 SWG	1	Spring Wire	C	W.5
201	E.A1.40.313	SPRING , leaf, for micro switch operating finger	1	Spring Steel	C	W.5
5CW/9438275	BURGESS BZ.38H	SWITCH , sensitive, undercarriage "up" lock, type 1A (Pre-Mod. 4080)	1	—	B	
5CW/1085884	HONEYWELL 1H.Y1	SWITCH , limit, undercarriage "up" lock (Mod. 4080)	1	—	B	
		Attaching parts for switches:—				
28D/1011011	A25/8B	Bolt, 4 BA	2	—	C	
28M/1278189	AGS.2001/B/1	Nut, 4 BA	2	—	C	
28W/9419474	SP.15/B	Washer	2	—	C	
5CW/9994686	BURGESS	SWITCH , micro, type 4A, undercarriage "down" lock (Pre-Mod. 4080)	1	—	C	
5CW/1085884	HONEYWELL 1H.Y1	SWITCH , limit, undercarriage "down" lock (Mod. 4080)	1	—	B	
		Attaching parts for switches:—				
28D/1214303	AS.1242/10B	Bolt, 4 BA	2	—	C	
28M/1278189	AGS.2001/B/1	Nut, 4 BA	2	—	C	
28W/1278189	SP.15/B	Washer	2	—	C	
1895	E.A6.40.27	TUBE , strut, nose, undercarriage	1	T.60	C	W.5
		Attaching parts for E.A6.40.27:—				
161	E.A1.40.451	Bolt, c/w spoke and nut, radius rod strut bearing	1	—	C	W.6
28M/9129449	A27/LS	Nut, 3/8" BSF	1	—	C	
181	E.A1.40.449	Pin, strut, pivot radius rod bearing	1	S.65	C	W.6
202	E.A1.40.325	Washer	2	DTD.226A	C	W.6
1439144	E.A3.40.261	ROD, RADIUS, ASSEMBLY (S.O.O.) (MOD. 4449) ...	1	—	A	
		Spares for this assembly are identical with those for assembly Part No. E.A6.40.37, Page WC.3, except for the following deletions and additions				
		Delete:—				
5126	E.A3.40.77	BRACKET , micro switch	1	L.72	C	W.5
6187	E.A1.40.415	PAD , switch, undercarriage "Down" micro switch	1	L.65	C	W.5

**UNDERCARRIAGE
NOSEWHEEL**

Ref. No.	Part No.	Description						No. Off	Matl Spec.	Cl. of Equip. M.R. L.M.	Plate No.
		1	2	3	4	5	6				
		Delete:— (continued)									
201	E.A1.40.313	SPRING , leaf, for micro switch operating finger						1	S.S	B	W.5
5CW/1085884	HONEYWELL 1H.Y1	SWITCH , limit, undercarriage "up" and "down" lock (Mod. 4080)						2	—	B	
		Add:—									
1439148	E.A3.40.255	BRACKET , micro switch						1	L.72	C	W.5
1439145	E.A3.40.241	PAD , switch, undercarriage "down" micro switch						1	L.65	C	W.5
1439146	E.A3.40.259	SPRING , leaf, for micro switch operating finger						1	S.513	C	W.5
5CW/12444	DN.1322Z Mk. 2	SWITCH , limit, undercarriage "up" and "down" lock (Mod. 4449-S.O.O.) (Pre-Mod. 4959)						2	—	B	
5CW/13598	DN.1322Z Mk. 3	SWITCH , limit, undercarriage "up" and "down" lock (Mod. 4959)						2	—	B	
3748	E.A1.40.455	SCREW , grub, 2 BA, strut bearing retaining ...						1	S.96	C/MR	W.6
343	E.A1.31.277	SHIM						2	—	C	
	or										
4141	EEAS.27/8/4	SHIM						2	—	C	
204	E.A1.40.599	SPRING , return, undercarriage hook, 14 SWG ...						1	Spring Steel	C	W.4
1439147	E.A3.40.245	SPRING , return, u/c hook (S.O.O.) (Mod. 4449) ...						1	S-201	C	
205	E.A1.40.601	SPRING , tension, undercarriage sequence valve ...						1	Spring Steel	C	W.6
1587	E.A1.40.719	SPRING , forward door latch						1	Spring Steel	C	W.4
4693	E.A3.40.157	STOP , door jack extension						2	S.96	C/MR	W.6
		Attaching parts for E.A3.40.157:—									
28M/1011467	A27/ES	Nut, 3/8" BSF						1	—	C	
992	E.A1.40.701	STOP , sequence valve lifter						1	S.96	C	W.6
		Attaching parts for E.A1.40.701:—									
28W/9419475	SP.15/C	Washer						1	—	C	
39182	E.A9.40.37	TAPPET , front latch lever						1	—	C	W.4
		Attaching parts for E.A9.40.37:—									
28M/1006473	A27/CT	Nut, 2 BA						1	—	C	
3755	E.A1.40.731	TUBE , distance						1	M.S.	C	
27A/2655	DUNLOP KK.2	TUBE						2	—	A	
27A/4683	DUNLOP DR.2565	TYRE , 26" x 6"5 x 14"						2	—	A	
	or										
27A/2654	DUNLOP KKEN.14N	TYRE , 26" x 6"5 x 14"						2	—	A	
	or										
27A/4683	GOODYEAR GA.1202	TYRE , 26" x 6"5 x 14"						2	—	A	
	or										
27A/4683	FIRESTONE ZA.297	TYRE , 26" x 6"5 x 14"						2	—	A	
27QM/	DOWTY 2'0039.6040	UNIT , undercarriage (For spares see AP.4515B, Vol. 3, Pt. 1) (Mod. 4855)						1	—	A	
3752	E.A1.40.587	WASHER , special packing, undercarriage sequence valve, mounting bolt						2	DTD.5044	C	W.4
1877	EEAS.28/30.EU DUNLOP	WASHER , special, 18 SWG						1	DTD.124	C	
27A/2814	AH.9590	WHEEL , landing						2	—	A	

Plate W.I.

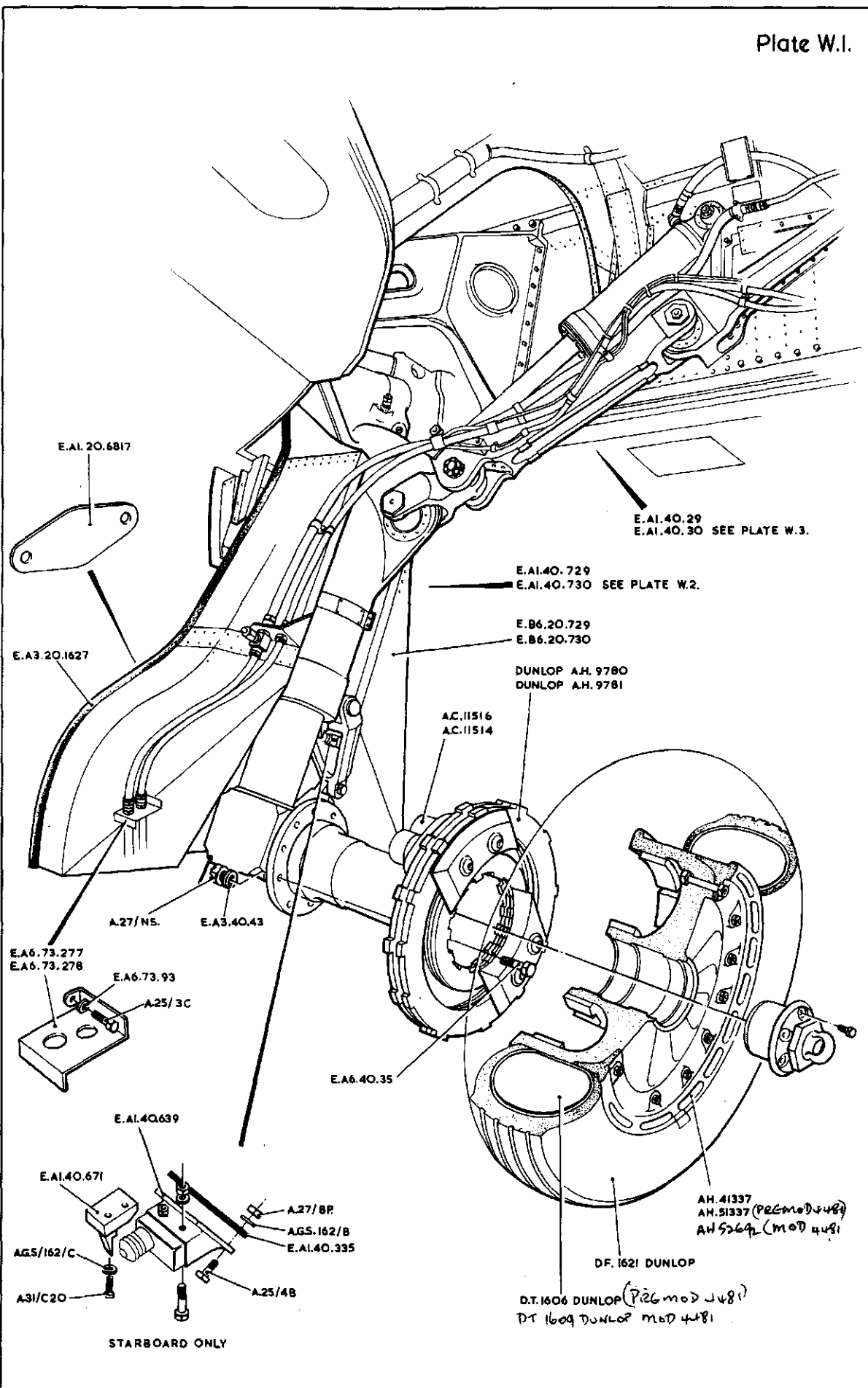

MAIN UNDERCARRIAGE
RESTRICTED

Plate W.2.

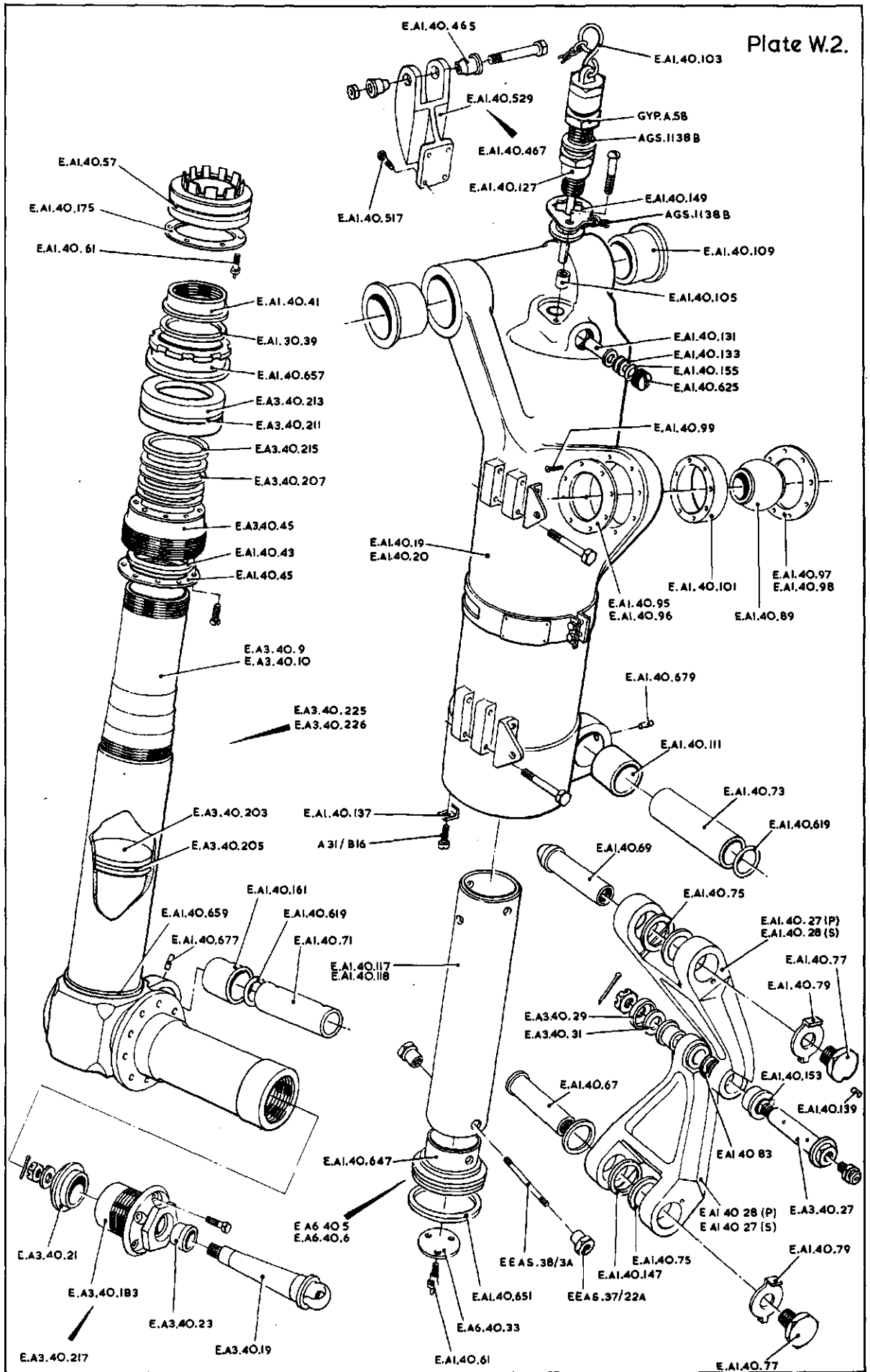

MAIN UNDERCARRIAGE OLEO

RESTRICTED

Plate W.3.

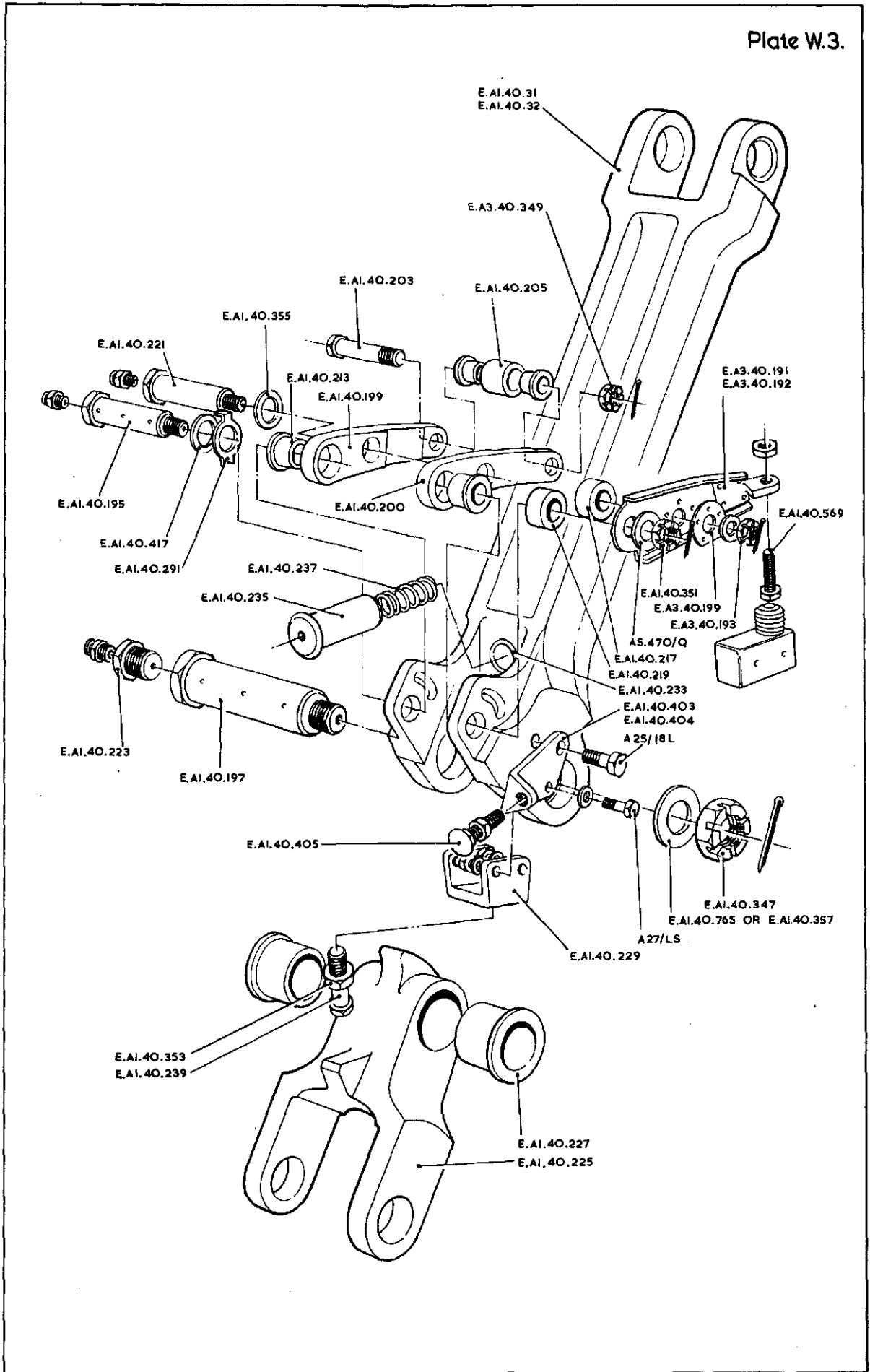

MAIN UNDERCARRIAGE SIDE STAY

Plate W4

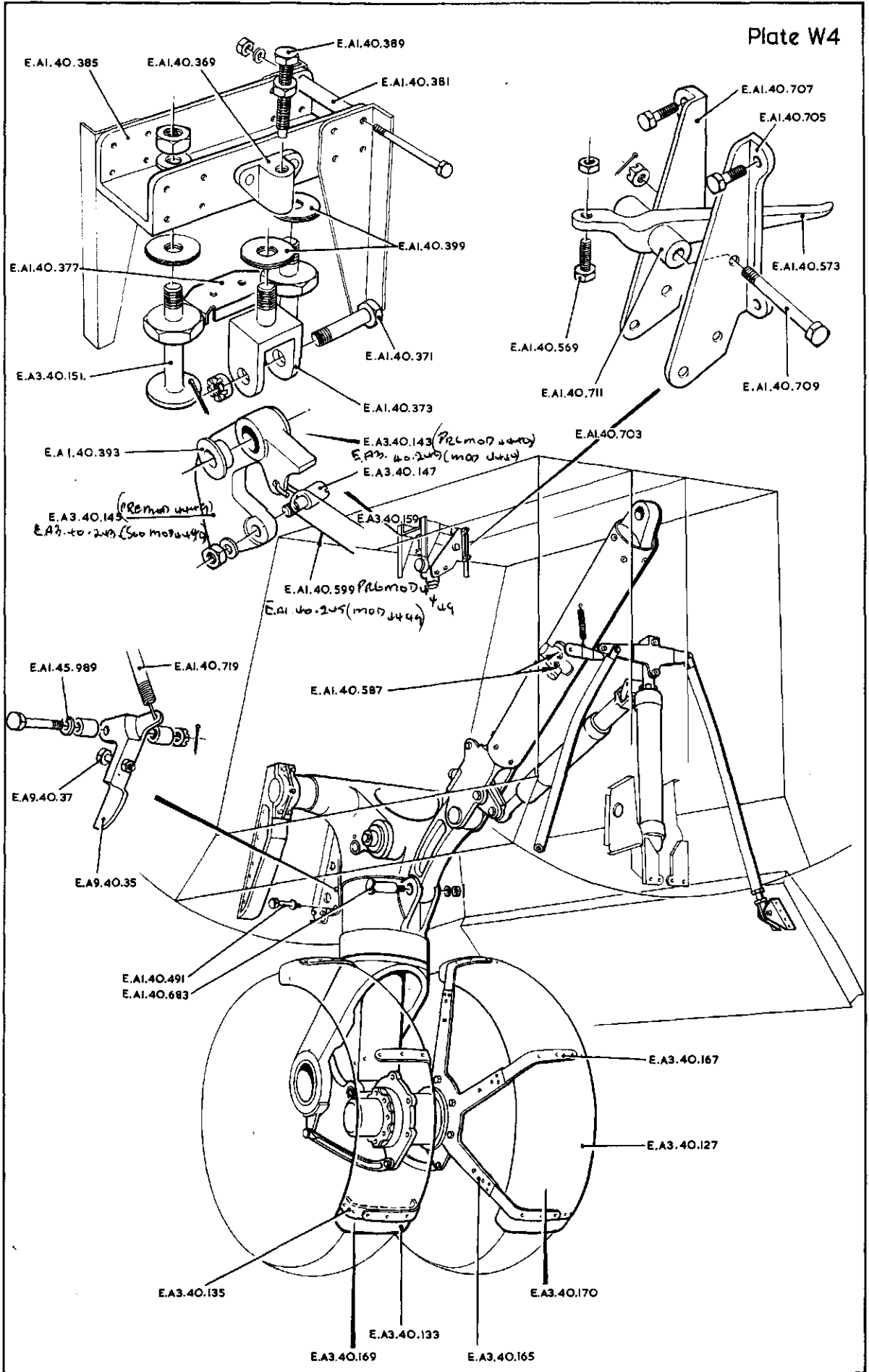

NOSE UNDERCARRIAGE

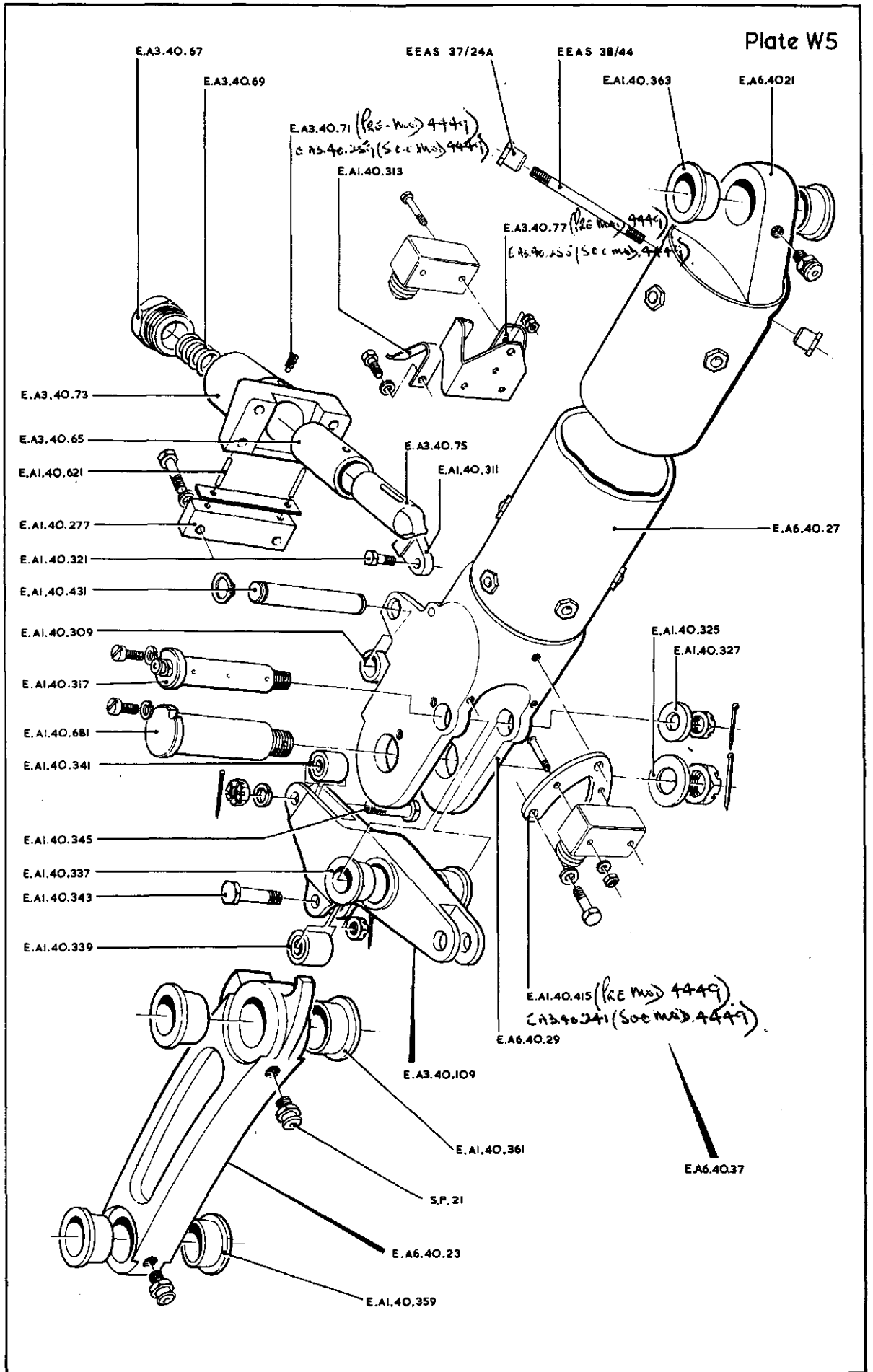

NOSEWHEEL RADIUS ROD

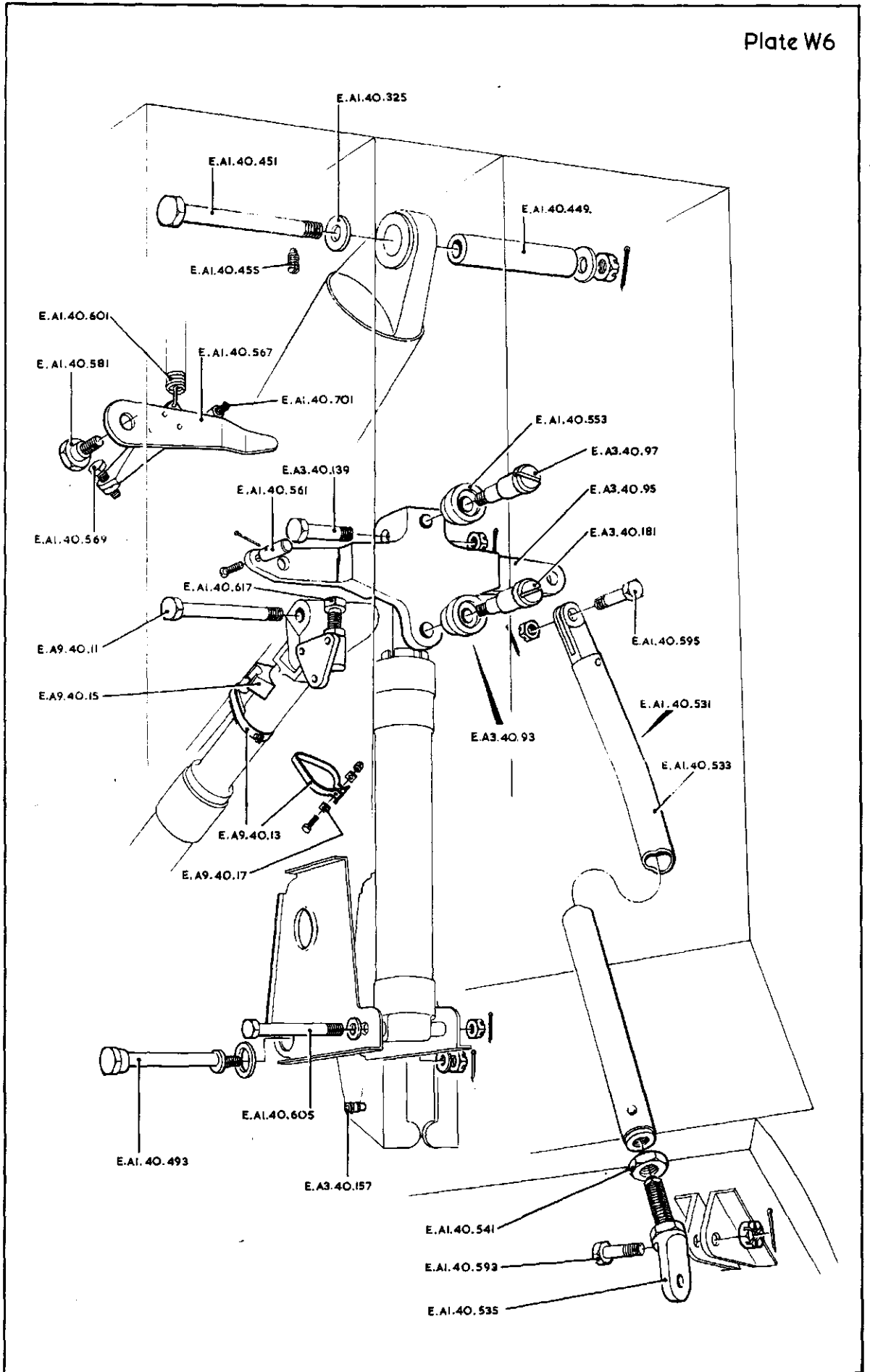

NOSEWHEEL DOOR MECHANISM

This file was downloaded
from the RTFM Library.

Link: www.scottbouch.com/rtfm

Please see site for usage terms,
and more aircraft documents.

