

SHACKLETON Mk. 2

UNDERCARRIAGE

MAIN

Ref. No.	Part No.	Description				No. off	Matl. Spec.	Cl. of St.	Plate and Illust'n No.
		1	2	3	4			M.R.	
		UNDERCARRIAGE, MAIN ASSEMBLY (Complementary parts e.g. Inter-component attachments listed at the end of this assembly will not be supplied with the assembly spare and must be demanded separately when required, except where stated)				2	—		
		Spares for:—							
27G/4072	Dunlop AH9506	BRAKE, UNIT, GROUP				2	—	A	94/1
		Spares for:—							
27G/4886	AHM1664	BAG, PRESSURE, GROUP				2	—	C	
27G/4887	AHO27176	Collar, valve, inner pressure bag				2	—	C	
27G/4888	AHO27177	Collar, valve, outer pressure bag				2	—	C	
27G/4889	AHO27175	Connection, valve air				2	—	C	
27G/4890	AHO26964	LINING, BRAKE, GROUP				1 set	—	C	
27G/4891	AHO27178	Screw, clamping, connection				4	—	C	
27G/5024	AHO27835	Seal, screw clamping				4	—	C	
27G/4892	AHO27182	Seal, nut valve				8	—	C	
27G/4893	AHO27183	Separators				20	—	C	
27G/4894	AHO27174	Spring				20	—	C	
30A/3055	—	Wire, locking				QR	—	C	
27Q/590	Dowty A472Y Mk.A	JACK, UNDERCARRIAGE, RH, GROUP				1	—	A	94/2
27Q/591	Dowty A472Y Mk.B	JACK, UNDERCARRIAGE, LH, GROUP				1	—	A	94/3
	Dowty A994Y	UNDERCARRIAGE, MAIN, GROUP ...				1	—		
		Consisting of:—							
27Q/603	Dowty A940	STRUT, RETRACTING, GROUP (Pre Mod. 358)				2	—	A	
27Q/1110	Dowty 567557	STRUT, RETRACTING, GROUP (Mod. 358)				2	—	A	94/4
27Q/1149	Dowty A7088Y	STRUT, SHOCK ABSORBER, BRACING AND AXLE, GROUP				1	—	A	94/5

UNDERCARRIAGE
MAIN

Ref. No.	Part No.	Description				No. off	Matl. Spec.	Cl. of St.	Plate and Illust'n No.
		1	2	3	4			M.R.	
3309	1Q1850	UP-CATCH, PIN & SWITCH, UNDER-CARRIAGE, OUTBOARD, STARBOARD				1	—	A	94/6
3306	2Q1850	UP-CATCH, PIN & SWITCH, UNDER-CARRIAGE, INBOARD, PORT				1	—	A	94/7
3307	3Q1850	UP-CATCH, PIN & SWITCH, UNDER-CARRIAGE, INBOARD, STARBOARD				1	—	A	94/8
3308	4Q1850	UP-CATCH, PIN & SWITCH, UNDER-CARRIAGE, OUTBOARD, PORT				1	—	A	94/9
		Spares for :—							
	3Q646	Angle , lateral, inboard, starboard and outboard, port				2	DTD610		
	4Q646	Angle , lateral, outboard, starboard and inboard, port				2	DTD610		
13600	10Q646	Barrel , adjusting				2	S1	C	94/10
	14Q1580	Block , packing (Make from Ref. 5F/2137) ...				1	BSS668		94/11
28D/12846	A25/15B	Bolt , hex. hd, 4 BA x 1.5" plain				2	—	C	
28D/12513	A25/2C	Bolt , hex. hd, 2 BA				5	—	C	
28D/12531	A25/3C	Bolt , hex. hd, 2 BA				7	—	C	
28D/12532	A25/4C	Bolt , hex. hd, 2 BA				14	—	C	
28D/12533	A25/5C	Bolt , hex. hd, 2 BA				2	—	C	
3311	9Q1850	Bracket , stringer, outboard, starboard, and inboard, port				2	DTD610	C	94/12
3312	10Q1850	Bracket , stringer, inboard, starboard and outboard, port				2	DTD610	C	94/13
3814	5Q1156	CHANNEL, CATCH & BRACKETS, GROUP				1	—	C	94/14
		Consisting of:—							
	15Q646	Bracket , catch channel				4	DTD610		
	5Q646	Channel , catch				1	DTD610		
28Q/6672	AS2227/606	Rivet , snap hd, $\frac{5}{32}$ " dia. x $\frac{3}{8}$ " long ...				8	—	C	
3815	6Q1156	CHANNEL, CATCH & BRACKETS, GROUP				1	—	C	94/15
		Consisting of:—							
	15Q646	Bracket , catch channel				4	DTD610		
	5aQ646	Channel , catch				1	DTD610		
28Q/6672	AS2227/606	Rivet , snap hd, $\frac{5}{32}$ " dia. x $\frac{3}{8}$ " long ...				8	—	C	

SHACKLETON Mk. 2

UNDERCARRIAGE

MAIN

Ref. No.	Part No.	Description				No. off	Matl. Spec.	Cl. of St.	Plate and Illust'n No.
		1	2	3	4			M.R.	
		UNDERCARRIAGE, MAIN ASSEMBLY (Complementary parts e.g. Inter-component attachments listed at the end of this assembly will not be supplied with the assembly spare and must be demanded separately when required, except where stated)				2	—		
		Spares for:—							
27G/4072	Dunlop AH9506	BRAKE, UNIT, GROUP				2	—	A	94/1
		Spares for:—							
27G/4886	AHM1664	BAG, PRESSURE, GROUP				2	—	C	
27G/4887	AHO27176	Collar, valve, inner pressure bag				2	—	C	
27G/4888	AHO27177	Collar, valve, outer pressure bag				2	—	C	
27G/4889	AHO27175	Connection, valve air				2	—	C	
27G/4890	AHO26964	LINING, BRAKE, GROUP				1 set	—	C	
27G/4891	AHO27178	Screw, clamping, connection				4	—	C	
27G/5024	AHO27835	Seal, screw clamping				4	—	C	
27G/4892	AHO27182	Seal, nut valve				8	—	C	
27G/4893	AHO27183	Separators				20	—	C	
27G/4894	AHO27174	Spring				20	—	C	
30A/3055	—	Wire, locking				QR	—	C	
27Q/70614	Dowty 1/01108/001	JACK, UNDERCARRIAGE, RH, GROUP				1	—	A	94/2
27Q/70634	Dowty 1/01108/002	JACK, UNDERCARRIAGE, LH, GROUP				1	—	A	94/3
	Dowty A994Y	UNDERCARRIAGE, MAIN, GROUP ...				1	—		
		Consisting of:—							
27Q/603	Dowty A940	STRUT, RETRACTING, GROUP (Pre Mod. 358)				2	—	A	
27Q/1110	Dowty E6755Y	STRUT, RETRACTING, GROUP (Mod. 358)				2	—	A	94/4
27Q/1149	Dowty A7088Y	STRUT, SHOCK ABSORBER, BRACING AND AXLE, GROUP				1	—	A	94/5

UNDERCARRIAGE

MAIN

Ref. No.	Part No.	Description				No. off	Matl. Spec.	Cl. of St.	Plate and Illust'n No.
		1	2	3	4			M.R.	
3309	1Q1850	UP-CATCH, PIN & SWITCH, UNDER-CARRIAGE, OUTBOARD, STARBOARD				1	—	A	94/6
3306	2Q1850	UP-CATCH, PIN & SWITCH, UNDER-CARRIAGE, INBOARD, PORT				1	—	A	94/7
3307	3Q1850	UP-CATCH, PIN & SWITCH, UNDER-CARRIAGE, INBOARD, STARBOARD				1	—	A	94/8
3308	4Q1850	UP-CATCH, PIN & SWITCH, UNDER-CARRIAGE, OUTBOARD, PORT				1	—	A	94/9
		Spares for :—							
	3Q646	Angle, lateral, inboard, starboard and outboard, port				2	DTD610		
	4Q646	Angle, lateral, outboard, starboard and inboard, port				2	DTD610		
13600	10Q646	Barrel, adjusting				2	S1	C	94/10
	14Q1850	Block, packing (Make from Ref. 5F/2137) ...				1	BSS668		94/11
28D/12846	A25/15B	Bolt, hex. hd, 4 BA x 1.5" plain				2	—	C	
28D/9133011	A25/2C	Bolt, hex. hd, 2 BA				5	—	C	
28D/12531	A25/3C	Bolt, hex. hd, 2 BA				7	—	C	
28D/1200119	A25/4C	Bolt, hex. hd, 2 BA				14	—	C	
28D/12533	A25/5C	Bolt, hex. hd, 2 BA				2	—	C	
3311	9Q1850	Bracket, stringer, outboard, starboard, and inboard, port				2	DTD610	C	94/12
3312	10Q1850	Bracket, stringer, inboard, starboard and outboard, port				2	DTD610	C	94/13
3814	5Q1156	CHANNEL, CATCH & BRACKETS, GROUP				1	—	C	94/14
		Consisting of:—							
	15Q646	Bracket, catch channel				4	DTD610		
	5Q646	Channel, catch				1	DTD610		
28Q/6672	AS2227/606	Rivet, snap hd, $\frac{5}{16}$ " dia. x $\frac{3}{4}$ " long ...				8	—	C	
3815	6Q1156	CHANNEL, CATCH & BRACKETS, GROUP				1	—	C	94/15
		Consisting of:—							
	15Q646	Bracket, catch channel				4	DTD610		
	5aQ646	Channel, catch				1	DTD610		
28Q/6672	AS2227/606	Rivet, snap hd, $\frac{5}{16}$ " dia. x $\frac{3}{4}$ " long ...				8	—	C	

SHACKLETON Mk 2

UNDERCARRIAGE
MAIN

Ref. No.	Part No.	Description				No. off	Matl. Spec.	Cl. of St.	Plate and Illust'n No.
		1	2	3	4			M.R.	
		UP-CATCH, PIN & SWITCH, UNDER-CARRIAGE, OUTBOARD & INBOARD, PORT & OUTBOARD & INBOARD, STARBOARD (1, 2, 3, 4Q1850) (Cont'd)							
28M/10287	AGS2001/B/1					2	—	C	
28M/10288	AGS2001/C/1					12	—	C	
28L/13326	A27/GT					6	—	C	
28L/12464	A27/GTL					4	—	C	
28M/13121	A27/CS					16	—	C	
28M/13123	A27/JS					2	—	C	
26EA/19166	22Q646					4	—	C	
13409	23Q646					4	—	C	
	15Q1850					1	DTD610	C	
13063	11Q646					4	S1	C	
3310	5Q1850					1	—	C	94/16
		PIN, CATCH, UNDERCARRIAGE, GROUP							
	5aQ1850	Consisting of:— BEARER, SWITCH AND END BEARING, GROUP				1	—		94/17
28P/13626	5dQ1850					1	—		
	SP28/H10					2	—	C	
	5fQ1850					1	S82		
	6Q1850					58	EN31		
	5eQ1850					1	DTD331		
28Q/6667	AS2227/406					3	—	C	
28P/12462	SP9/C8					20	—	C	
13064	12Q646					2	S1	C	94/18
13065	13Q646					2	S1	C	94/19
13060	14Q646					2	S1	C	94/20
13656	9Q646					2	S1	C	94/21
28W/12306	SP15/B					2	—	C	
28W/12252	SP13/C					28	—	C	
27A/2837	Dunlop AH9505					1	—	A	94/22
		WHEEL, MAIN, GROUP (Outer cover and inner tube as follows)							
27A/2316	Dunlop HJ-R16-N					1	—	A	94/23
27A/2084	Dunlop HJ8					1	—	A	94/24

UNDERCARRIAGE

MAIN

Ref. No.	Part No.	Description				No. off	Matl. Spec.	Cl. of St.	Plate and Illust'n No.
		1	2	3	4			M.R.	
		COMPLEMENTARY ITEMS							
		ATTACHMENT FITTINGS, UNDER-CARRIAGE SHOCK ABSORBER AND AXLE GROUP TO UNDERCARRIAGE BEAM, PORT & STARBOARD							
		Consisting of:—							
13200	39.O.2312	Bolt, hex. hd, 1 1/4" BSF	2	S2 or S11	C	1/95
		ATTACHMENT FITTINGS, RADIUS ROD TO REAR SPAR, CENTRE PORTION, PORT & STARBOARD							1/96
		Consisting of:—							
27Q/4385	5K1512	Bolt	2	S1 or S6	C	
28N/9796	SP/21	Nipple, 1/4" BSF...	2	—	C	
28M/775	A16Y/NS	Nut, slotted, 1/2" BSF	2	—	C	
28P/5039	AGS784/12	Pin, split, 3/32" dia. x 1/4" long	2	—	C	
28W/3086	AGS161/H	Washer	2	—	C	
		(Note: The above items are supplied complete with radius rod)							

SHACKLETON Mk. 2

UNDERCARRIAGE

TAIL

Ref. No.	Part No.	Description				No. off	Matl. Spec.	Cl. of St.	Plate and Illust'n No.
		1	2	3	4			M.R.	
		UNDERCARRIAGE, TAIL, ASSEMBLY (Complementary parts e.g. Inter-component attachments listed at the end of this assembly will not be supplied with the assembly spare and must be demanded separately when required)							
27Q/1729	Dowty A9004Y	JACK, TAILWHEEL, GROUP (Mod. 649)				1	—	A	94/25
27Q/971	Dowty E4530Y	STRUT, RETRACTING, TAILWHEEL, UNDERCARRIAGE, GROUP				1	—	A	94/26
27Q/970	Dowty A4485Y	STRUT, SHOCK ABSORBER, TAILWHEEL, UNDERCARRIAGE, GROUP (Pre Mod. 417)				1	—	A	94/27
27Q/1156	Dowty A7007Y	STRUT, SHOCK ABSORBER, TAILWHEEL, UNDERCARRIAGE, GROUP (Mod. 417)				1	—	A	94/27
		TAILWHEEL, COMPLETE Consisting of:—							
27A/2654	Dunlop K.K.E.N.14.N	Cover, outer alternative				1	—	A	94/28
27A/2654	Dunlop D.R.2565	Cover, outer				1	—	A	94/29
27EA/2655	Dunlop K.K.2	Tube, inner				1	—	A	94/30
27A/2814	Dunlop AH9590	Tailwheel (Hub) (Pre-Mod. 655)				1	—	A	94/31
	Dunlop AH50930	Tailwheel (Hub) (Mod. 655)				1	—	A	00/00

**UNDERCARRIAGE
TAIL**

Ref. No.	Part No.	Description				No. off	Matl. Spec.	Cl. of St.	Plate and Illust'n No.
		1	2	3	4			M.R.	
		COMPLEMENTARY ITEMS							
		ATTACHMENT FITTINGS UNDER-CARRIAGE TAIL ASSEMBLY							
		Consisting of:—							
		ATTACHMENT OF TAILWHEEL JACK							
		Consisting of:—							
28N/7116	AGS899/15					1	—	C	1/97
		Collar , for pin jack attachment to retracting strut							
28M/14015	A27/NC					1	—	C	
		Nut , castellated, $\frac{1}{2}$ " BSF for pin jack attachment to mounting bracket							
4448	5K2709					1	S11	C	
		Pin , $\frac{1}{2}$ " BSF x 3.9" long c/w lubricating nipple, jack attachment to mounting bracket							
27Q/12528	Dowty D4427Y/5					1	—	C	
		Pin , U/C jack attachment to retracting strut (Supplied with retracting strut)							
28P/12720	SP9/H12					1	—	C	
		Pin , split, for pin, jack attachment to retracting strut							
28P/12462	SP9/C8					1	—	C	
		Pin , split, for pin jack attachment to mounting bracket							
28W/12701	SP10/N					1	—	C	
		Washer , $\frac{1}{2}$ " for pin, jack attachment to mounting bracket							
		ATTACHMENT OF TAILWHEEL RETRACTING STRUT							1/98
		Consisting of:—							
4450	7K2709					1	—	C	
		Bolt , hex. hd, $\frac{3}{4}$ " BSF x .9" long c/w lubricating nipple attachment of retracting strut to top bearing bracket							
4451	8K2709					1	S11	C	
		Bolt , hex. hd, $\frac{3}{4}$ " BSF x .9" long attachment of retracting strut to top bearing bracket							
27Q/12507	Dowty 4427Y/4					1	—	C	
		Nut , for pin, retracting strut attachment to shock absorber strut (Supplied with shock absorber strut)							
27Q/12508	Dowty 4177Y/2					1	—	C	
		Pin , U/C retracting strut attachment to tailwheel shock absorber strut (Supplied with shock absorber strut)							
4449	6K2709					1	S11	C	
		Pin , distance, retracting strut attachment to top bearing bracket							

RESTRICTED

PLATE NO. 94
ISSUE NO. 1

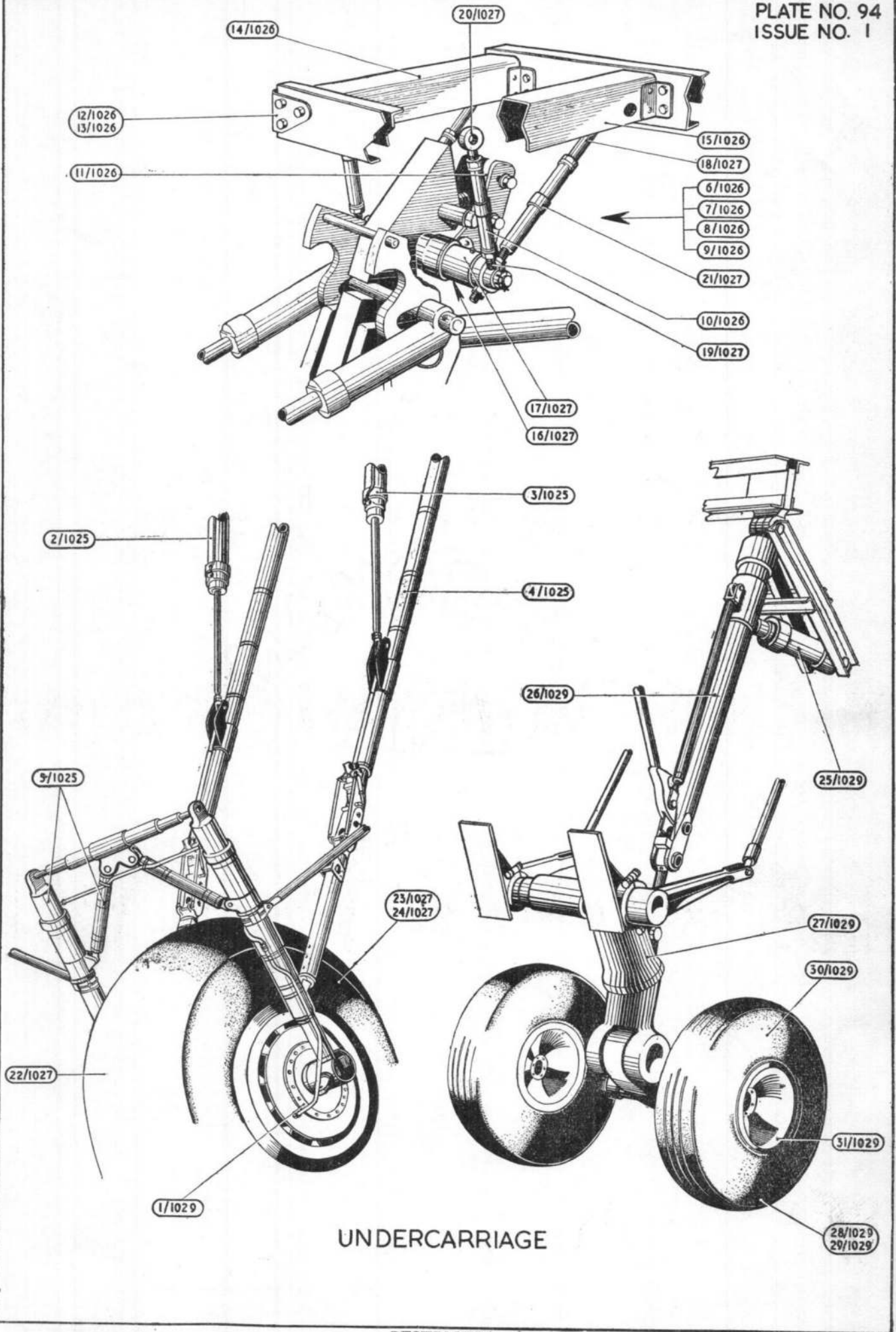

UNDERCARRIAGE

RESTRICTED

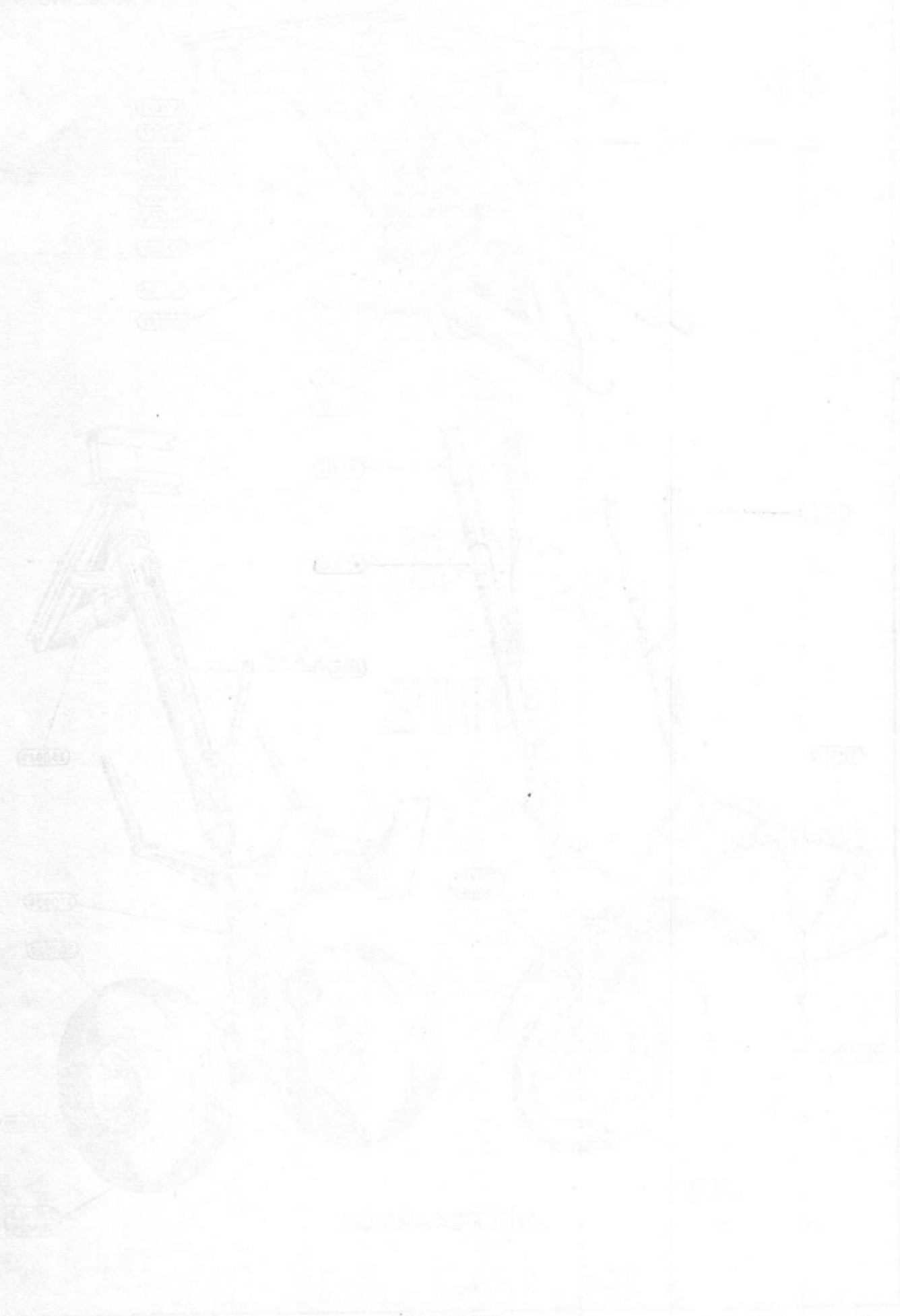

This file was downloaded
from the RTFM Library.

Link: www.scottbouch.com/rtfm

Please see site for usage terms,
and more aircraft documents.

