

**UNDERCARRIAGE
MAIN UNDERCARRIAGE, PORT**

Ref. No.	Part No.	Description	No. off	Matl. Spec.	Cl. of Equip.		Plate No.
					M.R.	L.M.	
	E.A1.40.727	MAIN UNDERCARRIAGE, PORT, ASSEMBLY ...	1	—	—		
	E.A1.40.729	Consisting of:— LEG, OLEO (LESS WHEEL BRAKE UNIT AND FIXED FAIRING) ASSEMBLY	1	—	—		U.1
		Consisting of:—					
2168	E.A6.40.35	BOLT , special, securing	10	S.97	C		U.1
4173	E.A1.40.517	BOLT , special, securing cowl door mechanism to leg (Made from A25/5E)	4	H.T.S.	C		U.2
4174	E.A1.40.519	BOLT , special, securing fixed fairing mounting bracket to leg (Made from A25/5G)	8	H.T.S.	C		
27G/4085	DUNLOP AS-9780 AM 9780	BRAKE , unit (For spares see AP.4515C, Vol. 3, Part 1, sect. 2, Chap. 37)	1	—	A		U.1
6848	E.B6.20.729	FAIRING, MIXED, ASSEMBLY (Supplied with trim allowance)	1	—	B		U.1
		Spares for:—					
3060	E.A3.20.853	FAIRING, FIXED, GROUP	1	—	B		
		Spares for:—					
16205	E.A3.20.831	MEMBER , edge	1	—	C		
16214	E.A3.20.847	MEMBER , edge	1	—	C		
21164	E.A3.20.2869	PANEL, HINGE, ASSEMBLY	1	—	B		
		Spares for:—					
3025	E.A1.20.1679	HINGE (Made from 28N/9486785) ...	1	—	LM		
520	E.A1.20.1675	PANEL , hinge, 16 SWG	1	L.72	C		
1413	E.A1.20.6817	SPRING	2	Spring Steel	C		
	E.A1.20.6817	PANEL , access picket point	1	—	C		U.1
	E.A3.20.1627	SEAL , 3/8" dia. x 90" long (Make from Ref. 4432)	1	Synthetic Rubber	LM		U.1
16160	E.A1.20.9367	STIFFENER	1	—	C		
5970	E.A3.73.93	WASHER , special, for flexible pipe, bottom bracket	2	L.72	C		U.1
34712	E.A9.40.59	LEG, SLIDING AND OLEO HEAD, GROUP (MOD. 4270)	1	—	A		
		Spares for:—					
661	E.A1.40.153	BUSH , bearing	4	DTD.412	C		U.2
	E.A9.40.57	HEAD, OLEO, GROUP (MOD. 4270)	1	—	—		
		Spares for:—					
663	E.A1.40.89	BEARING , spherical, seated ball joint side stay	1	S.11	C		U.2
664	E.A1.40.101	BUSH , bearing	1	DTD.412	C		U.2
1438501	E.A9.40.63	BUSH , pivot (Mod. 4270)	2	—	C/MR		U.2
666	E.A1.40.111	BUSH , torque, link leg	2	DTD.412	C		U.2
667	E.A1.40.133	DISC , sealing, piston dowel plug	2	L.40	C		U.2
668	E.A1.40.131	DOWEL , special, piston	2	S.11	C		U.2
	or						
36258	E.A3.03.101	DOWEL , piston, (First repair)	2	—	C		
	or						
36259	E.A3.03.103	DOWEL , piston (Second repair)	2	—	C		
42058	E.A9.40.55	HEAD , oleo, forging (Mod. 4270)	1	DTD.5094	A/MR		U.2
669	E.A1.40.103	HOOK , "S" shaped, 16 SWG	2	M.S. Wire	C		U.2
20656	E.A1.40.127	PIPE , stack, assembly	1	—	B/MR		U.2

No PAGES 1309-1310

**UNDERCARRIAGE
MAIN UNDERCARRIAGE, PORT**

Ref. No.	Part No.	Description						No. off	Matl. Spec.	Cl. of Equip. M.R. L.M.	Plate No.
		1	2	3	4	5	6				
21221	E.A1.40.635							3	DTD.138	C	
14700	E.A3.40.207							1	L.64	C	U.2
12913	E.A1.40.657							1	DTD.683	C	U.2
21354	E.A1.40.659							1	DTD.683	C	U.2
698	E.A1.40.661							1	Synthetic Rubber	C	
14702	E.A3.40.205							1	Synthetic Rubber	C	
14704	E.A3.40.211							1	Soft rubber	C	U.2
700	E.A1.40.167							1	S.1	C	
701	E.A1.40.39							1	BS.216	C	U.2
702	E.A1.40.43							1	Hard Felt	C	
3631	E.A1.40.27							1	DTD.683	C	U.2
3632	E.A1.40.28							1	DTD.683	C	U.2
703	E.A1.40.67							1	S.11	C	U.2
704	E.A1.40.69							1	S.11	C	U.2
1500	E.A3.40.27							1	S.97	C	U.2
707	E.A1.40.77							2	S.11	C	U.2
708	E.A1.40.139							2	M.S.	C	U.2
709	E.A1.40.619							2	LA	C	U.2
710	E.A1.40.71							1	S.11	C	U.2
711	E.A1.40.73							1	S.11	C	U.2
712	E.A1.40.137							1	M.S.	C	U.2
713	E.A1.40.75							2	DTD.412	C	U.2
714	E.A1.40.79							2	M.S.	C	U.2
715	E.A1.40.83							1	S.11	C	U.2
1514	E.A3.40.29							1	S.96	C	U.2
1515	E.A3.40.31							1	S.96	C	U.2
718	E.A1.40.147							2	DTD.412	C	U.2
521	E.A1.40.467							1	—	C	U.2
522	E.A1.40.465							2	L.40	C	U.2
	E.A1.40.529							1	—	—	U.2
27G/2485	A.H.M.2572							1	—	B	
27G/2486	A.H.M.2574							1	—	B	
27A/3153	D.T.1606							1	—	A	U.1
27A/3152	DF.1621							1	—	A	U.1
	FIRESTONE ZA.101										
	or										
	DUNLOP DR.1623										
27A/4655	GOODYEAR GA.1266										
	FIRESTONE ZA.303										

**UNDERCARRIAGE
MAIN UNDERCARRIAGE, PORT**

Ref. No.	Part No.	Description						No. off	Matl. Spec.	Cl. of Equip. M.R. L.M.	Plate No.
		1	2	3	4	5	6				
27G/2382	AC.11516	UNIT , maxaret automatic brake control						1	—	A	U.1
2169	EA3.40.43	WASHER						10	DTD.124A	C	U.1
27A/4217	DUNLOP AH.51337	WHEEL , undercarriage (Pre-Mod. 4481) (For spares see AP.4515C, Vol. 3)						1	—	A	U.1
27A/1450713	DUNLOP AH.52692	WHEEL , undercarriage (Mod. 4481) (For spares see AP.4515C, Vol. 3)						1	—	A	
30A/9140209	†	WIRE , locking, 20 SWG						QR	—	C	
523	EA1.40.29	STAY, SIDE UNDERCARRIAGE, GROUP (PRE-MOD. 3585) Spares for:—						1	—	A	
525	EA1.40.195	BOLT , special, hook						1	S.65 or S.81	C	U.3
526	EA1.40.197	BOLT , special, connecting stay and link						1	S.65 or S.81	C	U.3
527	EA1.40.203	BOLT , special, for roller, assembly, locking gear						1	S.11	C	U.3
528	EA1.40.221	BOLT , special, connecting undercarriage operating jack						1	S.65 or S.81	C	U.3
529	EA1.40.239	BOLT , stop, special, link stay						1	S.65 or S.81	C	U.3
530	EA1.40.405	BOLT , special, sequence valve operating						1	S.11	C	U.3
7112	EA1.40.229	BRACKET , stop bolt						1	S.11	C	U.3
7114	EA1.40.403	BRACKET , sequence valve operating stud						1	L.40	C	U.3
531	EA1.40.199	LEVER, UNDERCARRIAGE, LOCK, GROUP Consisting of:—						1	—	C	U.3
532	EA1.40.213	BUSH						1	DTD.197	C	U.3
	EA1.40.201	LEVER						1	S.11	—	
533	EA1.40.200	LEVER, UNDERCARRIAGE, LOCK, GROUP Consisting of:—						1	—	C	U.3
532	EA1.40.213	BUSH						1	DTD.197	C	U.3
	EA1.40.202	LEVER						1	S.11	—	
13168	EA3.40.191	LEVER, UNDERCARRIAGE, "DOWN", MICRO SWITCH, ASSEMBLY (MOD. 2151) Spares for:—						1	—	C	U.3
179	EA1.40.569	SCREW , tappet						1	S.11	C	U.3
6472	EA1.40.225	LINK, SIDE STAY, GROUP Spares for:—						1	—	B	U.3
536	EA1.40.227	BUSH , bearing						2	DTD.197	C	U.3
26667	EA3.40.193	NUT , special, slotted for undercarriage operating jack bolt (Make from A27/JS)						1	MT.5	C	U.3
12916	EA1.40.347	NUT , special, slotted, for link and link stay connecting bolt (Make from A27/WS)						1	M.S.	C	U.3
	EA1.40.351	NUT , special, slotted, for hook catch pin bolt (Make from A27/QS)						1	M.S.	C	U.3
	EA1.40.349	NUT , special, slotted, for undercarriage roller locking bolt (Make from A27/JS)						1	M.S.	—	U.3
537	EA1.40.353	NUT , special, lock for stay link stop bolt						1	S.11	C	U.3
13184	EA3.40.199	PLATE						1	DTD.124	C	U.3
538	EA1.40.223	PLUG , adaptor, for Tecalemit grease nipple in link and stay connecting bolt						1	L.40	C	U.3
539	EA1.40.205	ROLLER , stop lever, assembly						1	—	C	U.3
7113	EA1.40.233	SLEEVE , operating spring for undercarriage lock stop						1	DTD.197	C	U.3
540	EA1.40.237	SPRING , compression at lock stop						1	Spring Steel	C	U.3
39706	EA1.40.31	STAY , side						1	DTD.683	MR	

**UNDERCARRIAGE
MAIN UNDERCARRIAGE, PORT**

Ref. No.	Part No.	1	2	3	4	5	6	Description	No. off	Matl. Spec.	Cl. of Equip.	Plate No.
											M.R.	
												L.M.
541	EA1.40.235							STOP , undercarriage lock	1	S.11	C	U.3
542	EA1.40.217							TUBE , distance, for undercarriage "down" switch operating bracket	1	L.40	C	U.3
543	EA1.40.219							TUBE , distance, for undercarriage "down" switch operating bracket	1	L.40	C	U.3
544	EA1.40.291							WASHER , tab at undercarriage hook catch bolt 20 SWG	1	S.3	C	U.3
545	EA1.40.355							WASHER , special, for link and link stay connecting bolt, 18 SWG	1	L.72	C	U.3
546	EA1.40.357 or EA1.40.765							WASHER , special, for link and link stay connecting bolt, 18 SWG	1	S.3	C	U.3
547	EA1.40.417							WASHER , special, under tab and connecting bolts, 24 SWG	1	L.72	C	U.3
34172	EA9.40.43							STAY, SIDE, UNDERCARRIAGE, GROUP (MOD. 3585) spares for this group are identical with those for group Part No. EA1.40.29 on page 1314, except for the following deletion and addition Delete:—	1	—	A	U.1
	EA1.40.31							STAY , side Add:—	1	DTD.683	—	
	EA9.40.39							STAY , side	1	DTD.5024	—	U.3

1317

Pages 1319 to 1328 not issued

**UNDERCARRIAGE
MAIN UNDERCARRIAGE, STARBOARD**

Ref. No.	Part No.	Description	No. off	Matl. Spec.	Cl. of Equip.	Plate No.
					M.R. L.M.	
		1 2 3 4 5 6				
	EA1.40.728	MAIN, UNDERCARRIAGE, STARBOARD, ASSEMBLY Consisting of—	1	—	—	
	EA1.40.730	LEG, OLEO (LESS WHEEL BRAKE UNIT AND FIXED FAIRING), GROUP Consisting of:—	1	—	—	U.1
2168	E.A6.40.35	BOLT , special, securing	10	S.97	C	U.1
4173	EA1.40.517	BOLT , special, securing cowl door mechanism to leg (Made from A25/5E)	4	H.T.S.	C	U.2
4174	EA1.40.519	BOLT , special, securing fixed fairing mounting bracket to leg (Made from A25/5G)	8	H.T.S.	C	
27G/4086	DUNLOP AH.9781	BRAKE , unit (For spares see AP.4515C, 1641E and 4303B, Vol. 3, Part 1, Sect. 2, Chap. 37)	1	—	A	U.1
6849	EB6.20.730	FAIRING, FIXED, ASSEMBLY (Supplied with trim allowance) Spares for:—	1	—	B	U.1
3061	EA3.20.854	FAIRING, FIXED, GROUP Spares for:—	1	—	B	
16206	EA3.20.832	MEMBER , edge	1	—	C	
16215	EA3.20.848	MEMBER , edge	1	—	C	
21721	EA3.20.2870	PANEL, HINGE, ASSEMBLY Spares for:—	1	—	B	
3026	EA1.20.1679	HINGE (Made from 28N/9486785)	1	—	LM	
1887	EA1.40.436	PANEL , hinge, 16 SWG	1	L.72	C	
1413	EA1.40.436	SPRING	2	Spring Steel	C	
	EA1.20.6817	PANEL , access	1	—	C	
	EA3.20.1627	SEAL , 1/8" dia. x 90" long (Make from Ref. 4432)	1	Synthetic rubber	LM	
16161	EA1.20.9368	STIFFENER	1	—	C	
5970	EA6.73.93	WASHER , special, for flexible pipe, bottom bracket	2	L.72	C	U.1
34713	EA9.40.60	LEG, SLIDING OLEO HEAD, GROUP (MOD. 4270) Spares for:—	1	—	A	
660	EA1.40.639	BRACKET , angle, micro switch mounting, 20 SWG	1	L.72	C	U.1
661	EA1.40.153	BUSH , bearing	4	DTD.462	C	U.2
662	EA1.40.671	FINGER , operating micro switch	1	—	C	U.1
	EA9.40.58	HEAD, OLEO, GROUP (MOD. 4270) Spares for:—	1	—	—	
663	EA1.40.89	BEARING , special, seated ball joint side stay	1	S.11	C	U.2
664	EA1.40.101	BUSH , bearing	1	DTD.412	C	U.2
1438501	EA9.40.63	BUSH , pivot (Mod. 4270)	2	DTD.412	MR	U.2
666	EA1.40.111	BUSH , torque, link leg	2	DTD.412	C	U.2
667	EA1.40.133	DISC , sealing, piston dowel plug	2	L.40	C	U.2
668	EA1.40.131	DOWEL , special, piston	2	S.11	C	U.2
	or					
36258	EA3.03.101	DOWEL , piston (First repair)	2	—	C	
	or					
36259	EA3.03.103	DOWEL , piston (Second repair)	2	—	C	

**UNDERCARRIAGE
MAIN UNDERCARRIAGE, STARBOARD**

Ref. No.	Part No.	Description						No. off	Matl. Spec.	Cl. of Equip.		Plate No.
		1	2	3	4	5	6			M.R.	L.M.	
42059	EA9.40.56	HEAD , oleo forging (Mod. 4270)						1	DTD.5094	A/MR		U.2
669	EA1.40.103	HOOK , "S" shaped, 6 SWG						2	M.S. Wire	C		U.2
20656	EA1.40.127	PIPE , stack, assembly						1	—	B/MR		U.2
	EA6.40.6	PISTON, OPERATING, GROUP						1	—	—		U.2
		Consisting of:—										
683	EA1.40.61	BOLT , special, attachment enclosure orifice plate						3	S.11	C		U.2
1099	EEAS.37/22A	NIPPLE , 2 BA						2	S.11	C		U.2
670	EA1.40.647	PISTON						1	DTD.197	C		U.2
22528	EA6.40.33	PLATE , orifice enclosure control						1	S.11	C/MR		U.2
672	EA1.40.651	RING , piston						1	—	C		U.2
	EEAS.38/3A	SPOKE , 2 BA (Make from 28R/6328)						1	S.11	LM		U.2
12914	EA1.40.118	STRUT , piston, main						1	T.4	C		U.2
30A/9140209	†	WIRE , locking, 20 SWG						QR	Soft Iron	C		
673	EA1.40.679	PLUG , pivot bearing bush retaining						2	L.40	C		U.2
675	EA1.40.96	RING , lower, retaining ball joint						1	DTD.124	C		U.2
677	EA1.40.98	RING , upper, retaining ball joint						1	DTD.124	C		U.2
678	EA1.40.155	RING , sealing at dowel						2	Synthetic Rubber	C		U.2
679	EA1.40.625	SCREW , special, retaining plug dowel seal						2	L.40	C		U.2
680	EA1.40.99	STUD , for retaining rings at ball joint						12	S.11	C		U.2
681	EA1.40.105	TUBE , distance, packing for locking washer						1	L.40	C		U.2
15486	AGS.2096	VALVE , charging, hydraulic						1	—	C		U.2
682	EA1.40.149	WASHER , special, locking, 14 SWG						1	DTD.124	C		U.2
	EA9.40.62	LEG, SLIDING, COMPRESSION, GROUP (MOD. 4270)						1	—	—		U.2
		Spares for:—										
26640	EA3.40.201	BOLT , special, clamp locking (Mod. 2308)						1	S.95 or S.96	C		
683	EA1.40.61	BOLT , special, stud						6	S.11	C		U.2
684	EA1.40.161	BUSH , bearing, in lug						2	DTD.124	C		U.2
2467	EA3.40.45	BUSH , bearing						1	—	C		U.2
	EA3.40.217	CLAMP, AXLE, GROUP						1	—	MR		U.2
		Spares for:—										
21355	EA3.40.23	BUSH						1	L.16	C		U.2
13024	EA3.40.183	CLAMP , axle body (Mod. 1999)						1	—	C		U.2
1753	EA3.40.19	LINK , towing						1	—	C		U.2
21537	EA3.40.21	WASHER , special, tow link						1	—	C		U.2
14706	EA3.40.209	HOUSING , seals (Mod. 2361)						1	L.65	C		
1463	EA3.40.10	LEG, SLIDING, C/W INTEGRAL AXLE, ASSEMBLY						1	—	A		
		Spares for:—										
6627	EA3.40.51	PIN , shear						1	S.65	C		
6500	EA3.40.53	SCREW , grub						1	S.95	C		
691	EA3.40.41	NUT , stop, special						1	S.11	C		U.2
32210	EA3.40.221	PIN , locking, piston						3	S.97	C		
	EA3.40.219	PISTON , sliding leg						1	DTD.197	—		
693	EA1.40.175	PLATE , orifice						1	S.65	C		U.2
694	EA1.40.655	PLUG , sealing (Pre-Mod. 2361)						1	DTD.683	C		U.2
4701	EA3.40.203	PLUG , sealing, (Mod. 2361)						1	DTD.683	C		U.2
695	EA1.40.677	PLUG , pivot bearing bush retaining						2	L.40	C		U.2

**UNDERCARRIAGE
MAIN UNDERCARRIAGE, STARBOARD**

Ref. No.	Part No.	Description						No. off	Matl. Spec.	Cl. of Equip. M.R. L.M.	Plate No.
		1	2	3	4	5	6				
696	EA1.40.37							2	Synthetic Rubber	—	
14703	EA3.40.213							2	Soft Rubber	C	U.2
12915	EA1.40.45							1	M.S.	C	U.2
697	EA1.40.57							1	—	C	U.2
14705	EA3.40.215							2	Fabric CX.18	C	U.2
21221	EA1.40.635							3	DTD.138	C	
14700	EA3.40.207							1	L.64	C	U.2
12913	EA1.40.657							1	DTD.683	C	U.2
21354	EA1.40.659							1	DTD.683	C	
698	EA1.40.661							1	Synthetic Rubber	C	
14702	EA3.40.205							1	Soft Rubber	C	U.2
14704	EA3.40.211							1	Soft Rubber	C	U.2
700	EA1.40.167							1	S.L.	C	
701	EA1.40.39							1	BS.216	C	U.2
702	EA1.40.43							1	Hard Felt	C	U.2
3631	EA1.40.27							1	DTD.683	C	U.2
3632	EA1.40.28							1	DTD.683	C	U.2
703	EA1.40.67							1	S.11	C	U.2
704	EA1.40.69							1	S.11	C	U.2
1500	EA3.40.27							1	S.97	C	U.2
706	EA1.40.335							1	L.A.	C	U.1
707	EA1.40.77							2	S.11	C	U.2
708	EA1.40.139							2	S.11	C	U.2
709	EA1.40.619							2	L.40	C	U.2
710	EA1.40.71							1	S.11	C	U.2
711	EA1.40.73							1	S.11	C	U.2
712	EA1.40.137							1	M.S.	C	U.2
713	EA1.40.75							2	DTD.412	C	U.2
714	EA1.40.79							2	M.S.	C	U.2
715	EA1.40.83							1	S.11	C	U.2
1514	EA3.40.29							1	S.96	C	U.2
718	EA1.40.147							2	DTD.412	C	U.2
1515	EA3.40.31							1	S.96	C	U.2
521	EA1.40.467							1	—	C	U.2
522	EA1.40.465							2	L.40	C	U.2
	EA1.40.529							1	—	—	U.2
	DUNLOP										
27G/2487	AHM.2576							1	—	C	
	DUNLOP										
27G/2488	AHM.2578							1	—	C	
	DUNLOP										
27A/3153	DT.1606							1	—	A	U.1

1333

Pages 1335 to 1344 not issued

**UNDERCARRIAGE
MAIN UNDERCARRIAGE, PORT AND STARBOARD**

Ref. No.	Part No.	Description						No. off	Matl. Spec.	Cl. of Equip. M.R. L.M	Plate No.
		1	2	3	4	5	6				
SUMMARY OF STOCK ITEMS USED ON MAIN UNDERCARRIAGE, PORT AND STARBOARD, ASSEMBLY											
28D/9140638	A25/4B	Bolt,	4	BA		C	
28D/1010142	A25/9B	Bolt,	4	BA		C	
28D/9436920	A25/1C	Bolt,	2	BA		C	
28D/9133011	A25/2C	Bolt,	2	BA		C	
28D/9133012	A25/3C	Bolt,	2	BA		C	
28D/9133013	A25/5C	Bolt,	2	BA		C	
28D/7002428	A25/6C	Bolt,	2	BA		C	
28D/1011019	A25/8C	Bolt,	2	BA		C	
28D/9140644	A25/9C	Bolt,	2	BA		C	
28D/9453970	A25/15C	Bolt,	2	BA		C	
28D/1206739	A25/4J	Bolt,	$\frac{3}{8}$ "	BSF		C	
28D/1011299	A25/6J	Bolt,	$\frac{3}{8}$ "	BSF		C	
28D/1011310	A25/8L	Bolt,	$\frac{1}{2}$ "	BSF		C	
28D/1212690	A25/15L	Bolt,	$\frac{1}{2}$ "	BSF		C	
28D/1212688	A25/18L	Bolt,	$\frac{1}{2}$ "	BSF		C	
28D/1007285	AS.1242/1B	Bolt,	4	BA		C	
28D/1215078	AS.1246/5C	Bolt,	2	BA		C	
28N/9156370	SP.21	Nipple, lubricating		C	
28M/1011001	A24/NS	Nut,	$\frac{1}{4}$ "	BSF		C	
28M/9403519	A27/BP	Nut,	4	BA		C	
28M/9403520	A27/CP	Nut,	2	BA		C	
28M/1011470	A27/GT	Nut,	$\frac{3}{8}$ "	BSF		C	
28M/1011476	A27/JS	Nut,	$\frac{3}{8}$ "	BSF		C	
28M/13259	A27/NS	Nut,	$\frac{1}{4}$ "	BSF		C	
28M/13590	A27/SS	Nut,	$\frac{1}{4}$ "	BSF		C	
28M/1278190	AGS.2001/C/1	Nut, stiff,	2	BA		C	
28M/12050	AGS.2007/C/3	Nut, plate,	2	BA		C	
28P/19157	SP.90/G10	Pin, split		C	
28P/1207	AGS.166/3	Pin, split		C	
28P/19241	SP.90/G16	Pin, split		C	
28P/9486478	SP.90/C5	Pin, split		C	
28P/9527619	SP.90/C7	Pin, split		C	
28P/1011034	SP.9/E12	Pin, split		C	
28P/20112	SP.90/K20	Pin, split		C	
28S/1200034	A31/B16	Screw,	4	BA		C	
28S/9437020	A31/C12	Screw,	2	BA		C	
28F/9435713	A31/C20	Screw,	2	BA		C	
28W/9419466	SP.13/J	Washer		C	
28W/9419474	SP.15/B	Washer		C	
28W/9419475	SP.15/C	Washer		C	
28W/9416642	SP.47/B	Washer, spring		C	
28W/9416643	SP.47/C	Washer, spring		C	
28W/9416644	SP.47/E	Washer, spring		C	

**UNDERCARRIAGE
NOSEWHEEL**

Ref. No.	Part No.	Description	No. Off	Mati Spec.	Cl. of Equip.	Plate No.
					M.R. L.M.	
	E.A9.40.1	NOSEWHEEL, ASSEMBLY (MOD. 1740) Spares for:—	1	—	—	
22055	E.A9.40.15	BLOCK , flexible hose support	2	LFS.21	C	U.6
161	E.A1.40.451	BOLT , special, c/w spoke and nut, radius rod, strut bearing	1	—	C	U.6
22373	E.A9.40.19	BOLT , special, connecting operating jack to undercarriage locking lever (Pre-Mod. 2704)	1	S.96	C	
32172	E.A9.40.21	BOLT , special, connecting operating jack to undercarriage locking lever (Mod. 2704)	1	S.96	C	
163	E.A1.40.491	BOLT , special, nosewheel door "up" latch ...	1	S.11	C	U.4
164	E.A1.40.493	BOLT , special, nosewheel door "up" catch ...	1	S.11	C	U.6
4507	E.A3.40.139	BOLT , special, jack attachment to crosshead ...	1	S.11	C	U.6
166	E.A1.40.581	BOLT , special, fulcrum, undercarriage door actuating sequence valve	1	S.11	C	U.6
167	E.A1.40.593	BOLT , special, connecting door operating strut to door	2	S.11	C	U.6
168	E.A1.40.595	BOLT , special, attachment door actuating link to crosshead	2	S.11	C	U.6
169	E.A1.40.605	BOLT , special, hydraulic jack anchor	1	S.65	C	U.6
3753	E.A1.40.617	BOLT , special, adjusting undercarriage door crosshead (Made from 28D/1008145)	2	H.T.S.	C	U.6
170	E.A1.40.683	BOLT , special, connecting stay link and undercarriage unit	1	S.11	C	U.4
22056	E.A9.40.11	BOLT , special, nose undercarriage jack hinge ...	1	S.96	C	U.6
12023	E.A3.40.159	BRACKET, UNDERCARRIAGE "UP" HOOK, GROUP	1	—	B/MR	U.4
1439142	E.A3.40.251	BRACKET, UNDERCARRIAGE "UP" HOOK, GROUP (MOD. 4449—S.O.O.) Consisting of:—	1	—	B/MR	
	E.A1.40.385	BEAM, BRACKET, LOCKING HOOK, GROUP ... Spares for:—	1	—	—	U.4
20845	E.A1.40.369	LUG	1	L.40	C/MR	U.4
25628	E.A1.40.377	PLATE , locking	1	L.72	C	U.4
171	E.A1.40.371	BOLT , special, pivot hook	1	S.11	C	U.4
12024	E.A3.40.151	BOLT , special, for buffer, assembly	2	—	C	U.4
22251	E.A1.40.373	BRACKET , hook suspension	1	S.11	C	U.4
12025	E.A3.40.143	HOOK, UNDERCARRIAGE "UP" LATCH, GROUP	1	—	B	U.4
1439143	E.A3.40.249	HOOK, UNDERCARRIAGE "UP" LATCH, GROUP (MOD. 4449—S.O.O.) Consisting of:—	1	—	B	
13109	E.A3.40.147	BOLT , special	1	DTD.126A	C	U.4
	E.A1.40.393	BUSH	1	DTD.197	—	U.4
	E.A3.40.145	HOOK , "up" latch	1	H.T.S.	—	U.4
	E.A3.40.243	HOOK , "up" latch (Mod. 4449—S.O.O.) ...	1	—	—	
20846	E.A1.40.389	SCREW , special, hook stop	1	S.11	C/MR	U.4
	E.A1.40.381	TUBE , distance, for beam mounting bolts ...	8	T.4	—	U.4
174	E.A1.40.399	WASHER , special, laminum, at buffer bolts ...	3	L.A.	C	U.4
22057	E.A9.40.13	CLIP , flexible hose support	2	L.72	C	U.6
4694	E.A3.40.93	CROSSHEAD, NOSEWHEEL DOORS, C/W VALVE TRIP, ASSEMBLY Spares for:—	1	—	B/MR	U.6
5514	E.A3.40.97	PIN , roller top	1	S.11	C	U.6
12926	E.A3.40.181	PIN , roller, bottom	1	S.11	C	U.6
178	E.A1.40.553	ROLLER , guide	2	DTD.683	C	U.6
5515	E.A1.40.561	VALVE , trip	1	—	C	U.6

**UNDERCARRIAGE
NOSEWHEEL**

Ref. No.	Part No.	Description	No. Off	Matl Spec.	Cl. of Equip.		Plate No.
					M.R.	L.M.	
3751	E.A1.40.567	LEVER, UNDERCARRIAGE SEQUENCE VALVE, GROUP	1	—	B/MR		U.6
		Spares for:—					
179	E.A1.40.569	TAPPET, valve screw	1	S.11	C		U.6
3754	E.A1.40.703	LEVER, BRACKET, UNDERCARRIAGE SEQUENCE VALVE, GROUP	1	—	B/MR		U.4
		Spares for:—					
13182	E.A1.40.709	BOLT, special, operating lever fulcrum	1	S.11	C		U.4
	E.A1.40.573	LEVER, sequence valve operating	1	DTD.683	—		U.4
179	E.A1.40.569	TAPPET, valve screw	1	S.11	C		U.4
	E.A1.40.711	WASHER, special, fulcrum bolt	2	L.40	—		U.4
39181	E.A9.40.35	LEVER, micro switch operating, undercarriage (Mod. 2183)	1	—	C		U.4
		Attaching parts for E.A9.40.35:—					
28D/9140647	A25/14C	Bolt, 2 BA	1	—	C		
28M/1278190	AGS.2001/C/1	Nut, 2 BA	1	—	C		
4141	E.A1.45.989	Shim	2	Alumn.	C		U.4
	AS.2811/7/023	Spacer	2	T.4	LM		
180	E.A1.40.531	LINK, DOOR, OPERATING, GROUP	2	—	C		U.6
		Spares for:—					
4778	E.A1.40.535	BOLT, eye, assembly	2	—	C		U.6
33793	E.A1.40.541	NUT, special (Make from 28M/14533)	2	M.S.	C		U.6
8987	E.A3.40.169	MUDGUARD, NOSEWHEEL, ASSEMBLY	1	—	B		U.4
		Consisting of:—					
28D/9133012	A25/3C	BOLT, 2 BA	12	H.T.S.	C		
28D/1007974	AS.1242/1/2C	BOLT, 2 BA	3	H.T.S.	C		
28D/1013177	AS.1242/2E	BOLT, 1" BSF	9	H.T.S.	C		
5503	E.A3.40.133	FLAP, rubber, nosewheel mudguard	1	Shore 40	C		U.4
5504	E.A3.40.127	MUDGUARD, nosewheel	1	L.72	C		U.4
28M/1006473	A27/CT	NUT, 2 BA	12	M.S.	C		
28M/1007403	A27/ET	NUT, 1" BSF	6	M.S.	C		
5505	E.A3.40.131	NUT, special, shoulder, 1/2" BSF	3	S.95	C		
5506	E.A3.40.137	NUT, special, shoulder, 2 BA	3	S.95	C		
6948	E.A3.40.165	STAY, mudguard	1	—	C		U.4
6949	E.A3.40.167	STAY, end, mudguard attachment	3	DTD.683	C		U.4
20930	E.A3.40.135	STRIP, backing	1	L.72	C/MR		U.4
28W/9419475	SP.15/C	WASHER	12	Alumn.	C		
8988	E.A3.40.170	MUDGUARD, NOSEWHEEL, ASSEMBLY	1	—	B		U.4
		Spares for this assembly are identical with those for Part No. E.A3.40.169					
28N/9156370	SP.21	NIPPLE, lubricating	1	—	C		
181	E.A1.40.449	PIN, strut pivot, radius rod bearing	1	S.65	C		U.6
3688	E.A6.40.37	ROD, RADIUS, GROUP	1	—	A		U.5
1439144	E.A3.40.261	ROD, RADIUS, GROUP (MOD. 4449—S.O.O.)	1	—	A		
		Consisting of:—					
34309	E.A9.40.47	BOLT, special, operating lever bearing (Mod. 3487)	1	S.96	C		U.5
4447	E.A1.40.321	BOLT, special, bearing for undercarriage "up" micro switch, operating finger	1	DTD.126A	C		U.5
184	E.A1.40.681	BOLT, special, connecting radius rod and stay link	1	S.11	C		U.5
5126	E.A3.40.77	BRACKET, micro switch	1	L.72	C		U.5
1439148	E.A3.40.255	BRACKET, micro switch (Mod. 4449—S.O.O.) ...	1	—	C		

**UNDERCARRIAGE
NOSEWHEEL**

Ref. No.	Part No.	Description	No. Off	Matl Spec.	Cl. of Equip.		Plate No.
					M.R.	L.M.	
		1 2 3 4 5 6					
5CW/12444	DOWTY DN1322Z MK.2	SWITCH, limit, undercarriage "up" lock (Mod. 4449—S.O.O.) (Pre-Mod. 4959)	1	—		B	
5CW/13598	DN1322Z MK.3	SWITCH, limit, undercarriage "up" lock (Mod. 4959)	1	—		B	
5CW/6672	BURGESS MS.5750	SWITCH, micro, undercarriage "down" lock (Mod. 3562) (Pre-Mod. 4080)	1	—		C	
5CW/1085884	HONEYWELL 1H.Y1	SWITCH, limit, undercarriage "down" lock (Mod. 4080)	1	—		B	
5CW/12444	DOWTY DN1322Z MK.2	SWITCH, limit, undercarriage "down" lock (Mod. 4449—S.O.O.) (Pre-Mod. 4959)	1	—		B	
5CW/13598	DN1322Z MK.3	SWITCH, limit, undercarriage "down" lock (Mod. 4959)	1	—		B	
28D/1214303	AS.1242/10B	Attaching parts for switches:— Bolt, 4 BA	2	—		C	
28M/1278189	AGS.2001/B/1	Nut, 4 BA	2	—		C	
28W/9419474	SP.15/B	Washer	2	—		C	
1895	E.A.6.40.27	TUBE, strut nose, undercarriage	1	T.60		C	U.5
6182	E.A.1.40.309	TUBE, distance spindle	1	—		C	U.5
202	E.A.1.40.325	WASHER, special, cap	1	DTD.126A		C	U.5
203	E.A.1.40.327	WASHER, special, at operating lever bearing ...	1	DTD.126A		C	U.5
3748	E.A.1.40.455	SCREW, grub, 2 BA, special, strut bearing retaining	1	S.11		C/MR	U.6
343	E.A.1.31.277	SHIM or	2	Alumn.		C	
4141	EEAS.27/8/4 E.A.1.45.989	SHIM	2	Alumn.		C	
204	E.A.1.40.599	SPRING, return undercarriage hook, 14 SWG ...	1	Spring Steel		C	U.4
1439147	E.A.3.40.245	SPRING, return, undercarriage hook, 11 SWG (Mod. 4449—S.O.O.)	1	DTD.215		C	
205	E.A.1.40.601	SPRING, tension, undercarriage sequence valve, 18 SWG	1	Spring Steel		C	U.6
1587	E.A.1.40.719	SPRING	1	Spring Steel		C	U.4
4693	E.A.3.40.157	STOP, door jack extension	2	S.11		C/MR	U.6
992	E.A.1.40.701	STOP, sequence valve filter	1	S.11		C	U.6
39182	E.A.9.40.37	TAPPET (Mod. 2183)	1	S.1		C	
3755	E.A.1.40.731	TUBE, distance	1	M.S.		C	
27A/2655	DUNLOP KK.2	TUBE	2	—		A	
27A/2654	DUNLOP K.K.E.N.14N	TYRE, 26" x 6"5 x 14"	2	—		A	
27A/4683	or DUNLOP DR.2565 GOODYEAR GA.1202 FIRESTONE ZA.297						

**UNDERCARRIAGE
NOSEWHEEL**

Ref. No.	Part No.	Description						No. Off	Matl Spec.	Cl. of Equip.		Plate No.
		1	2	3	4	5	6			M.R.	L.M.	
27QM/	DOWTY 2'0039.6040	UNIT, undercarriage (For spares see A.P.4515B, Vol. 3, Part 1) (Mod. 4855)						1	—	A		
202	E.A1.40.325	WASHER, special, cup						3	DTD.126A	C		U.6
3752	E.A1.40.587	WASHER, special, packing undercarriage sequence valve mounting bolt						2	DTD.683	C		U.4
22329	E.A9.40.17	WASHER, corner						2	L.72	C		U.6
1877	EEAS.28/30EU	WASHER, special, 18 SWG						1	DTD.124	C		
1078	EEAS.28/35FU	WASHER, special, sequence valve fulcrum						1	DTD.124	C		
27A/2814	DUNLOP AH.9590	WHEEL, landing						2	—	A		

Pages 1353 to 1362 not issued

**UNDERCARRIAGE
NOSEWHEEL**

Ref. No.	Part No.	Description						No. off	Matl. Spec.	Cl. of Equip.	Plate No.
		1	2	3	4	5	6			M.R. L.M.	
SUMMARY OF STOCK ITEMS USED ON NOSEWHEEL ASSEMBLY											
28D/1011011	A25/8B	Bolt,	4	BA		C	
28D/1200120	A25/14B	Bolt,	4	BA		C	
28D/9436920	A25/1C	Bolt,	2	BA		C	
28D/9133011	A25/2C	Bolt,	2	BA		C	
28D/9133012	A25/3C	Bolt,	2	BA		C	
28D/9140647	A25/14C	Bolt,	2	BA		C	
28D/1012995	A25/22C	Bolt,	2	BA		C	
28D/9140649	A25/23C	Bolt,	2	BA		C	
28D/1011240	A25/5E	Bolt,	1/4"	BSF		C	
28D/1008145	A25/6E	Bolt,	1/4"	BSF		C	
28D/1011242	A25/7E	Bolt,	1/4"	BSF		C	
28D/1010031	A25/8E	Bolt,	1/4"	BSF		C	
28D/12282	AS.1242/10B	Bolt,	4	BA		C	
28M/9403519	A27/BP	Nut,	4	BA		C	
28M/9403520	A27/CP	Nut,	2	BA		C	
28M/1006473	A27/CT	Nut,	2	BA		C	
28M/12928	A27/EP	Nut,	1/4"	BSF		C	
28M/1011467	A27/ES	Nut,	1/4"	BSF		C	
28M/12931	A27/ET	Nut,	1/4"	BSF		C	
28M/1006939	A27/GP	Nut,	5/16"	BSF		C	
28M/13122	A27/GS	Nut,	3/16"	BSF		C	
28M/1011470	A27/GT	Nut,	3/16"	BSF		C	
28M/1011476	A27/JS	Nut,	3/8"	BSF		C	
28M/9129449	A27/LS	Nut,	1/16"	BSF		C	
28M/13266	A24/ES	Nut,	1/4"	BSF		C	
28M/1011001	A24/NS	Nut,	1/4"	BSF		C	
28M/10287	AGS.2001/B/1	Nut, stiff,	4	BA		C	
28M/10288	AGS.2001/C/1	Nut, stiff,	2	BA		C	
28M/10290	AGS.2001/E/1	Nut, stiff,	1/4"	BSF		C	
28M/10292	AGS.2001/J/1	Nut, stiff,	3/8"	BSF		C	
28M/10339	AGS.2002/C/2	Nut, stiff,	2	BA		C	
28P/1007741	SP.9/C8	Pin, split,	3/8"	dia. x 1" long		C	
28P/9429652	SP.9/E10	Pin, split,	3/8"	dia. x 1 1/4" long		C	
28P/9429653	SP.9/G12	Pin, split,	1/2"	dia. x 1 1/2" long		C	
28S/9437020	A31/C12	Screw,	2	BA		C	
28S/9997545	A31/C16	Screw,	2	BA		C	
28S/9416378	A35/C8	Screw,	2	BA		C	
28W/9419402	SP.13/C	Washer		C	
28W/9418921	SP.13/E	Washer		C	
28W/9419403	SP.13/G	Washer		C	
28W/9419467	SP.13/L	Washer		C	
28W/9419474	SP.15/B	Washer		C	
28W/9419475	SP.15/C	Washer		C	
28W/9419405	SP.15/E	Washer		C	
28W/9419478	SP.15/L	Washer		C	
28W/9419489	SP.16/J	Washer		C	
28W/9416442	SP.47/B	Washer, spring		C	
28W/9416643	SP.47/C	Washer, spring		C	
28W/9416644	SP.47/E	Washer, spring		C	
28W/1005599	SP.55/C	Washer, spring		C	

Plate U1

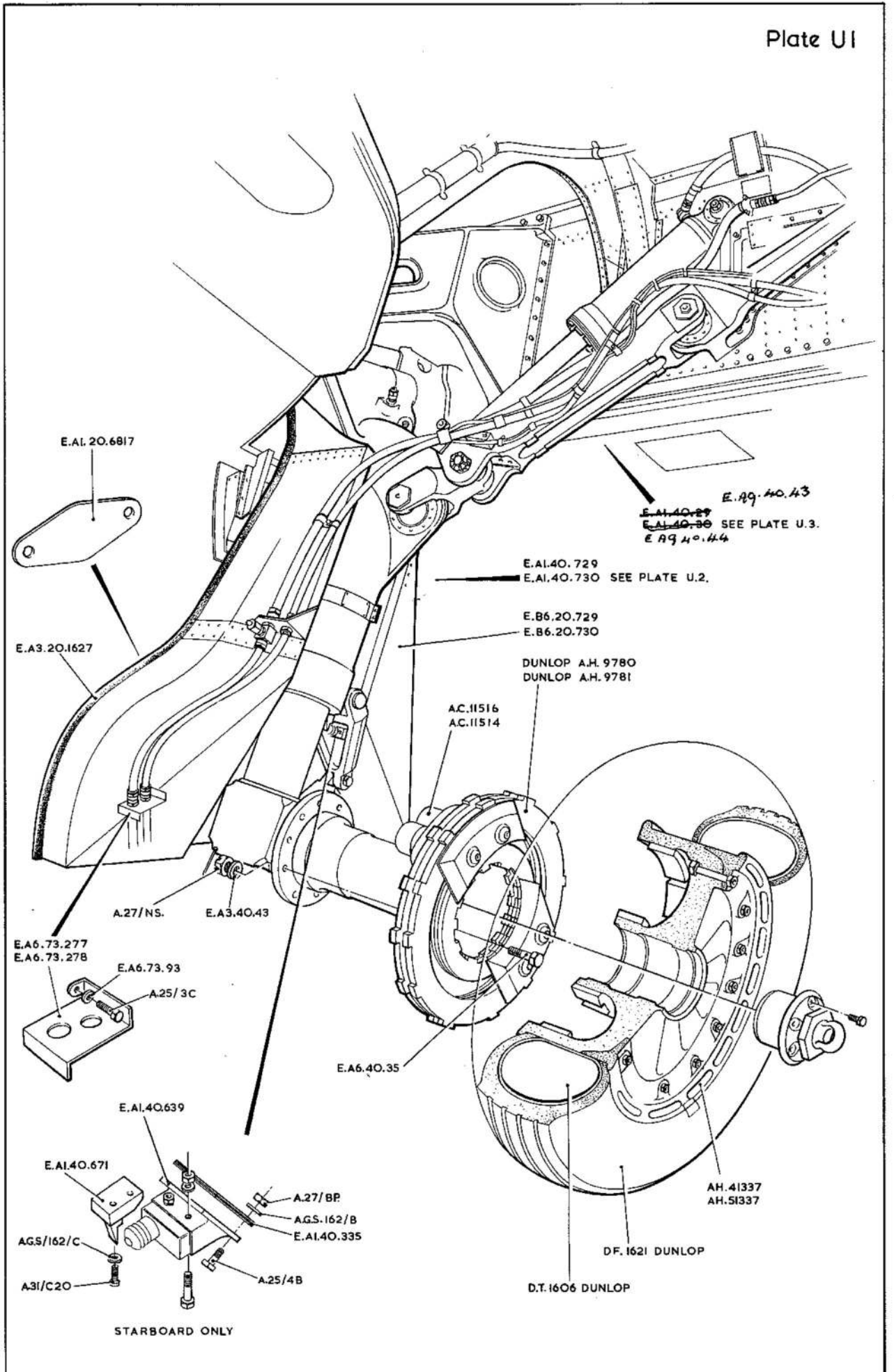

MAIN UNDERCARRIAGE

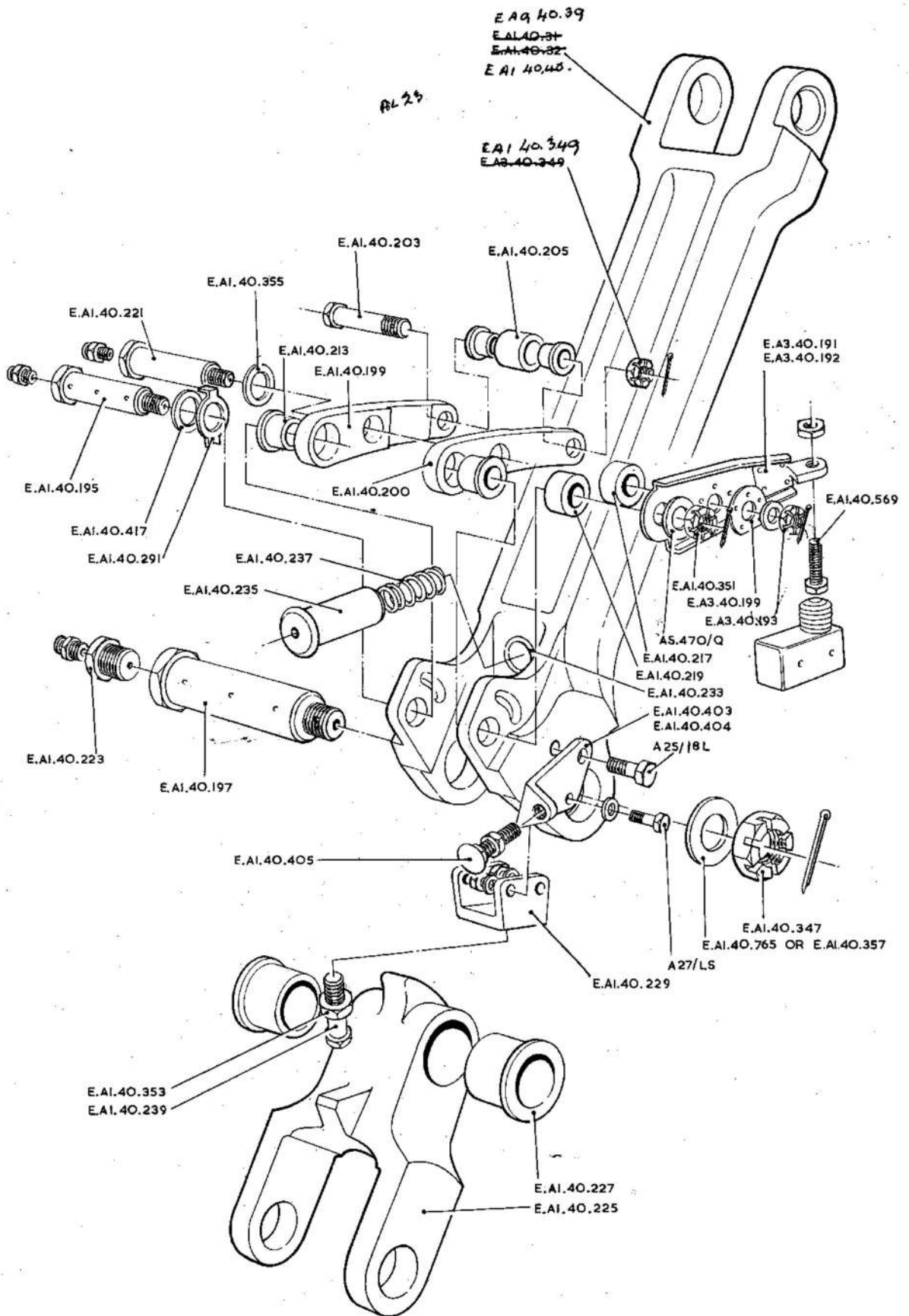

MAIN UNDERCARRIAGE SIDE STAY

Plate U 4

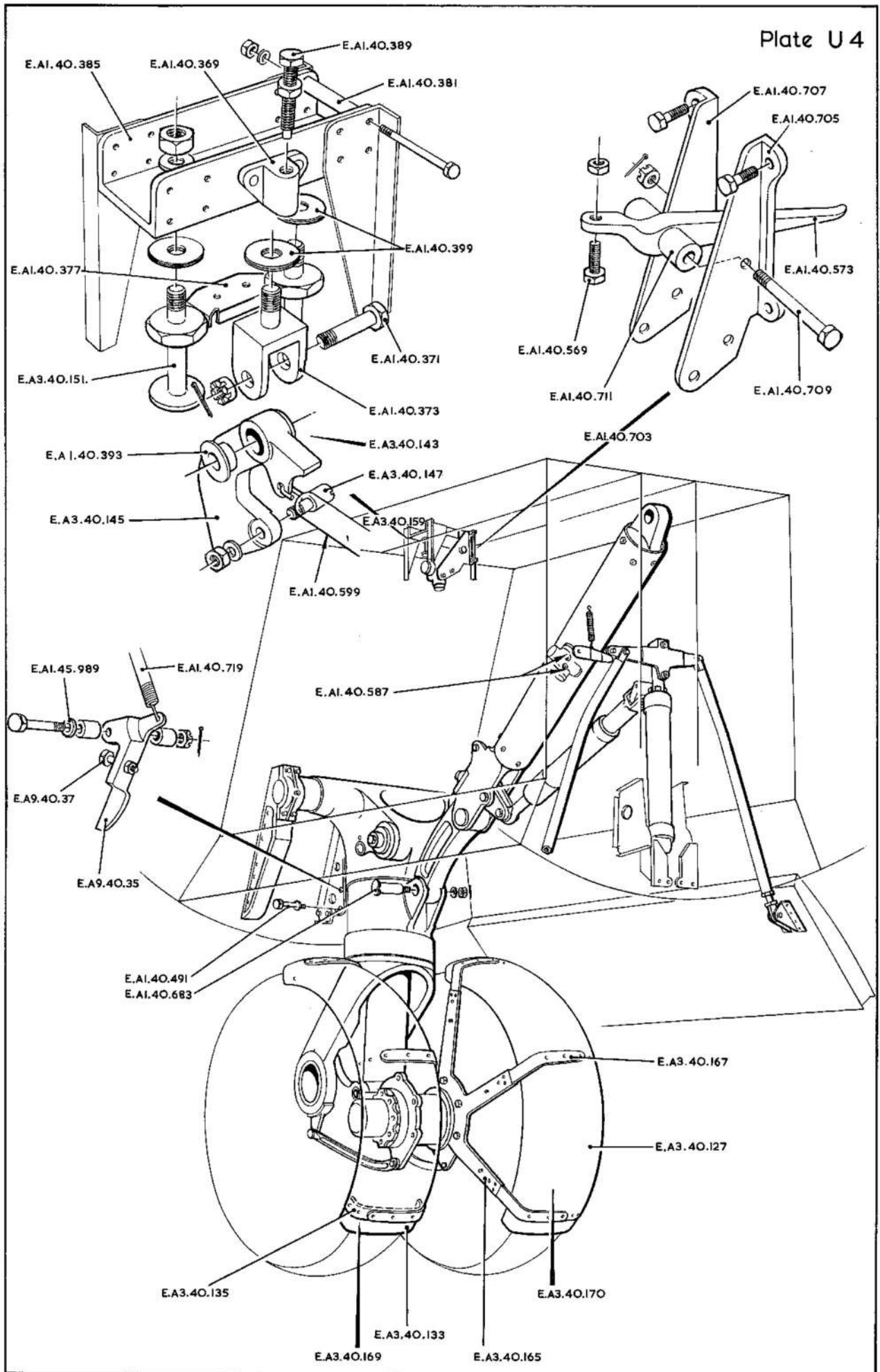

NOSE UNDERCARRIAGE

Plate U5

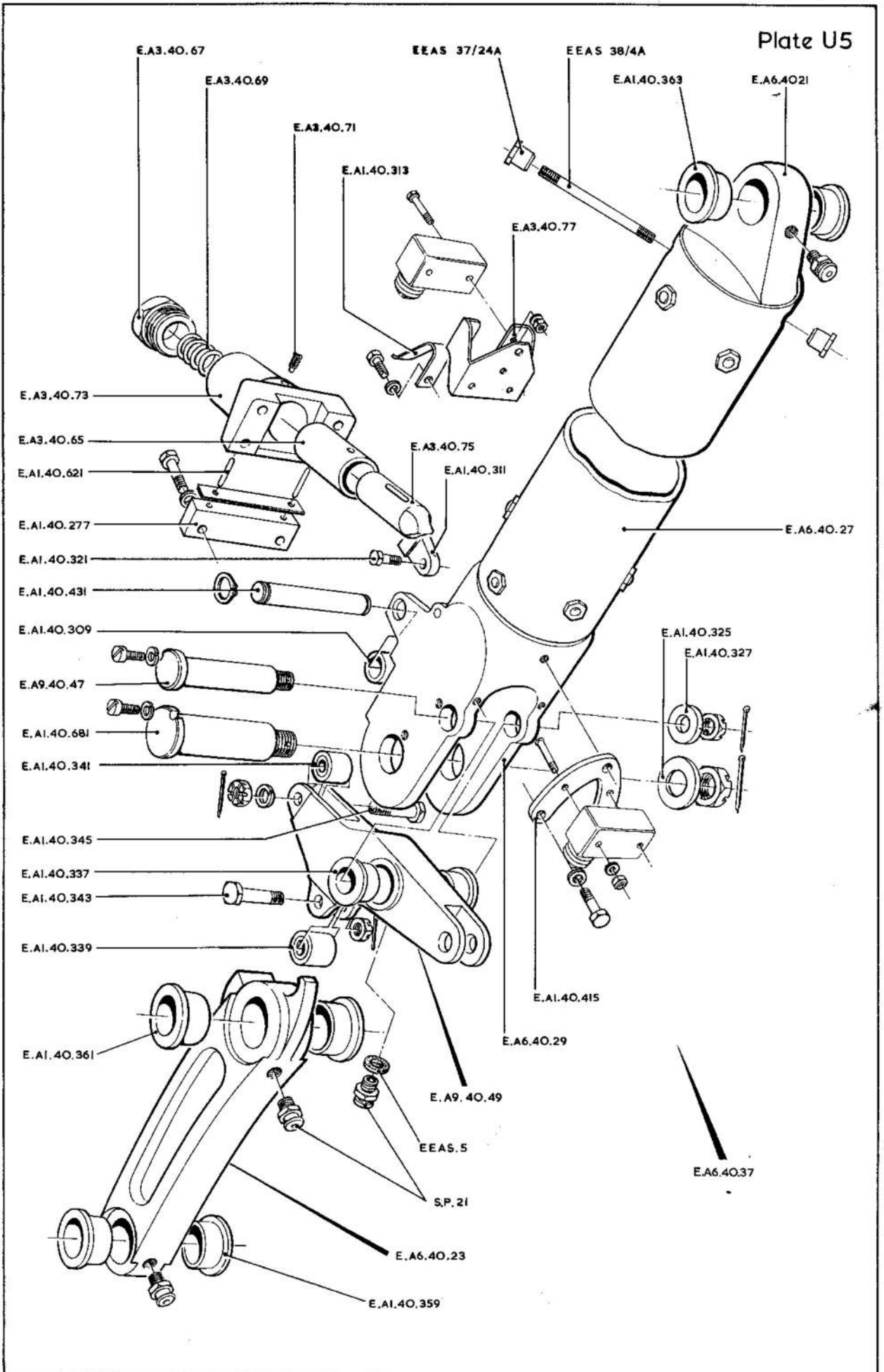

NOSEWHEEL RADIUS ROD

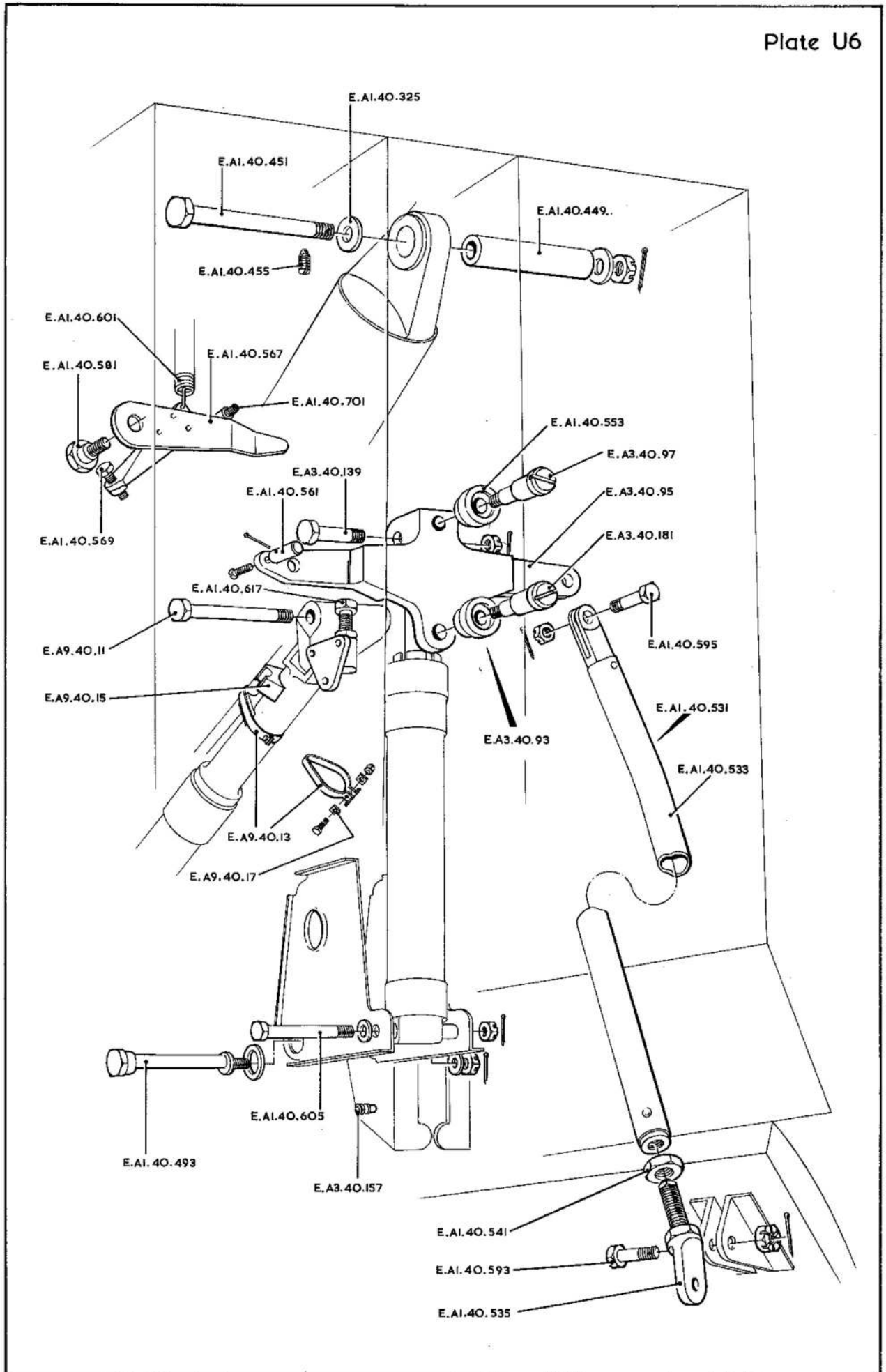

NOSEWHEEL DOOR MECHANISM

This file was downloaded
from the RTFM Library.

Link: www.scottbouch.com/rtfm

Please see site for usage terms,
and more aircraft documents.

