

KEY DIAGRAM OF RIB AND FRAME POSITIONS

11. **COMPILATION OF TEXT**

The multi-indentation system has been used in which the main assemblies, sub-assemblies, groups and detail items indicate their relationship by the indentation of the descriptive titles. This indentation is in accordance with the following outline:—

- (a) Main assembly, sub-assemblies, separate groups and detail parts of the main assembly start at the left-hand margin. The main assembly is distinguished by bold capital type from the remainder.
- (b) First division: sub-sub-assemblies, groups or detail parts of the major breakdown listed in the preceding paragraph are indented one space.
- (c) Second division: groups or items are indented one further space.
- (d) Third and subsequent divisions: in sequence.

12. **MAIN ASSEMBLY DRAWINGS**

Where for description or identification purposes only a Main Assembly drawing is shown, that drawing number is shown in brackets at the end of the description.

13. **PIPE LINES AND FLEXIBLE CABLES**

Local manufacture of these items is intended wherever possible. Charts showing the various materials and parts required are included as appendices at the end of the schedule.

14. **AMENDMENT LISTS**

Amendments are to be correctly inserted and entered in the Amendment Certificate which is to be found in front of the schedule. Manuscript amendments are to be made in ink.

Amendment Lists are numbered consecutively and will be issued at regular intervals. This schedule is to be checked with the statement of Amendment Lists issued, which is published periodically by A.M.O.s.

15. **SERIAL NUMBER**

This schedule is Serial Numbered and is to be accounted for in accordance with A.M.O. A.772/47.

16. **ASSOCIATED PUBLICATIONS**

The following associated Schedules of Spare Parts for Airframe Accessory Equipment are to be used in conjunction with this schedule:—

A.P. 4515, Vol. 3, Part 1  
B, C, E, F, R and S

17. **CLASSIFICATION OF EQUIPMENT**

The letters denoting the Class of Store are defined as follows:—

**CLASS "A"**—Class "A" items are those items of equipment which remain on charge and cannot be replaced except on return to store. Repairable items which are beyond the capacity or authority of the unit to repair are to be returned to the appropriate Maintenance Unit categorised R/D.

**CLASS "B"**—Class "B" items are those items of equipment which remain on charge and cannot be replaced except on return to store. Items which are beyond the capacity of the unit to repair, or which for technical reasons are not capable of being repaired whatever the defect are to be disposed of locally by units.

**CLASS "C"**—Class "C" items are items of equipment other than Class "A" or "B" which are consumable in use, or are incapable of being economically repaired and are not of a nature which would necessitate detailed accounting as Class "A" or "B" equipment.

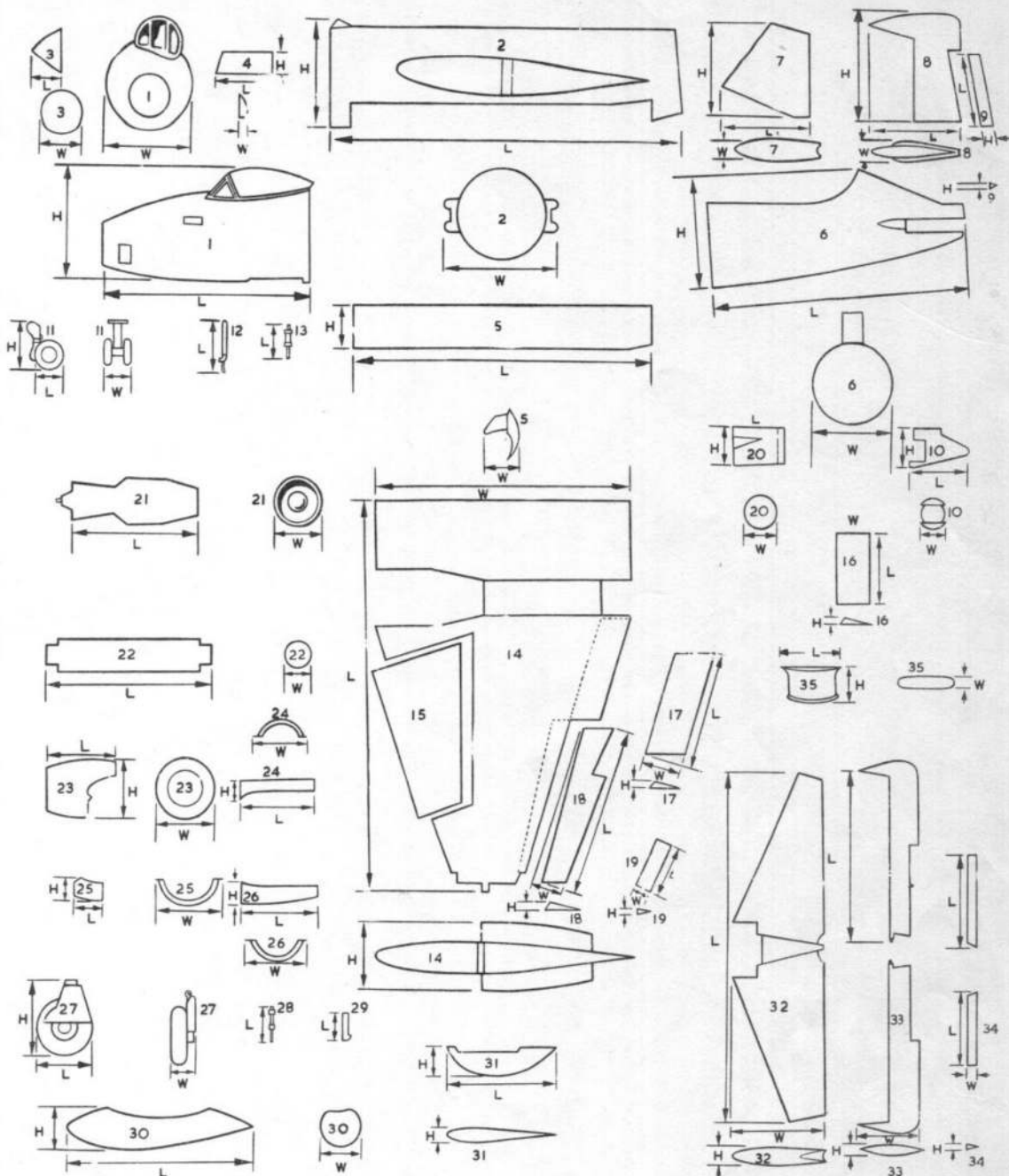

COMPONENTS WEIGHTS AND DIMENSIONS

Item No.	Component	Length	Width	Height	Tare Wt. (lbs.)	Empd. Wt. (lbs.)	Item	Component	Length	Width	Height	Tare Wt. (lbs.)	Empd. Wt. (lbs.)
1	FRONT FUSELAGE	15ft. 0in.	8ft. 6in.	-	-	-	19	AILERON TAB	4ft. 2in.	0ft. 8in.	0ft. 2in.	4	-
2	CENTRE FUSELAGE	25ft. 11in.	7ft. 7in.	6ft. 6in.	2,000	3,500	20	JET PIPE COWLING	3ft. 8in.	2ft. 8in.	2ft. 7in.	21	-
3	NOSE FAIRING	1ft. 5in.	2ft. 7in.	-	56	-	21	ENGINE CHANGE UNIT	1ft. 0in.	3ft. 6in. (dia.)	-	2,500	-
4	NOSE UNDERCARRIAGE DOORS	4ft. 2in.	0ft. 3in.	1ft. 5in.	10	-	22	JET PIPE	12ft. 3in.	2ft. 2in. (dia.)	-	180	-
5	BOMB DOORS	22ft. 1in.	1ft. 8in.	3ft. 0in.	290 (booms) 250 (inter.)	50	23	ENGINE FRONT COWLING	4ft. 9in.	3ft. 10in.	3ft. 10in.	59	-
6	REAR FUSELAGE	19ft. 1in.	5ft. 10in.	7ft. 1in.	94	-	24	ENGINE TOP REAR COWLING	5ft. 5in.	2ft. 0in.	1ft. 3in.	30	-
7	FIN	6ft. 4in.	1ft. 8in.	6ft. 9in.	94	-	25	SERVICE PANEL	2ft. 2in.	2ft. 2in.	1ft. 9in.	15	-
8	RUDDER	7ft. 1in.	1ft. 3in.	7ft. 0in.	132	-	26	ENGINE BOTTOM REAR COWLING	5ft. 5in.	2ft. 0in.	1ft. 3in.	33	-
9	RUDDER TAB	5ft. 5in.	0ft. 2in.	0ft. 9in.	7	-	27	MAIN UNDERCARRIAGE WHEEL & LEG	3ft. 1in.	2ft. 1in.	6ft. 3in.	870	-
10	REAR CONE	4ft. 9in.	2ft. 5in.	2ft. 10in.	25	-	28	MAIN UNDERCARRIAGE JACK	1ft. 1in.	0ft. 4in.	0ft. 7in.	14	16 (filled)
11	NUSE UNDERCARRIAGE WHEEL & LEG	2ft. 2in.	1ft. 7in.	3ft. 7in.	230	-	29	MAIN UNDERCARRIAGE SIDE STAY	2ft. 9in.	0ft. 8in.	0ft. 8in.	36	-
12	NOSF UNDERCARRIAGE RADIUS ROD	3ft. 1in.	0ft. 4in.	0ft. 8in.	20	-	30	WING-TIP TANK	14ft. 7in.	1ft. 11in.	1ft. 10in.	120	-
13	NOSE UNDERCARRIAGE JACK	1ft. 1in.	0ft. 5in.	0ft. 8in.	9	-	31	WING TIP	7ft. 8in.	1ft. 8in.	0ft. 10in.	16	-
14	MAIN PLANE	29ft. 1in.	19ft. 0in.	4ft. 3in.	2,576	10 (filling) 9.02 (with in-leg tanks)	32	TAIL PLANE	26ft. 0in.	7ft. 8in.	1ft. 6in.	495	-
15	MAIN PLANE INTEGRAL TANK	11ft. 4in.	8ft. 9in.	2ft. 1in.	4.8	-	33	ELEVATOR	13ft. 11in.	4ft. 5in.	0ft. 5in.	85	10 (with ball-ance wts.)
16	INBOARD FLAP	5ft. 7in.	2ft. 8in.	0ft. 3in.	22	-	34	ELEVATOR TAB	5ft. 7in.	0ft. 8in.	0ft. 2in.	7	-
17	OUTBOARD FLAP	8ft. 11in.	2ft. 9in.	0ft. 3in.	31	-	35	WING PYLON MOUNTING	2ft. 6in.	0ft. 6in.	1ft. 1in.	24	-
18	AILERON	12ft. 8in.	1ft. 3in.	0ft. 9in.	93	-							

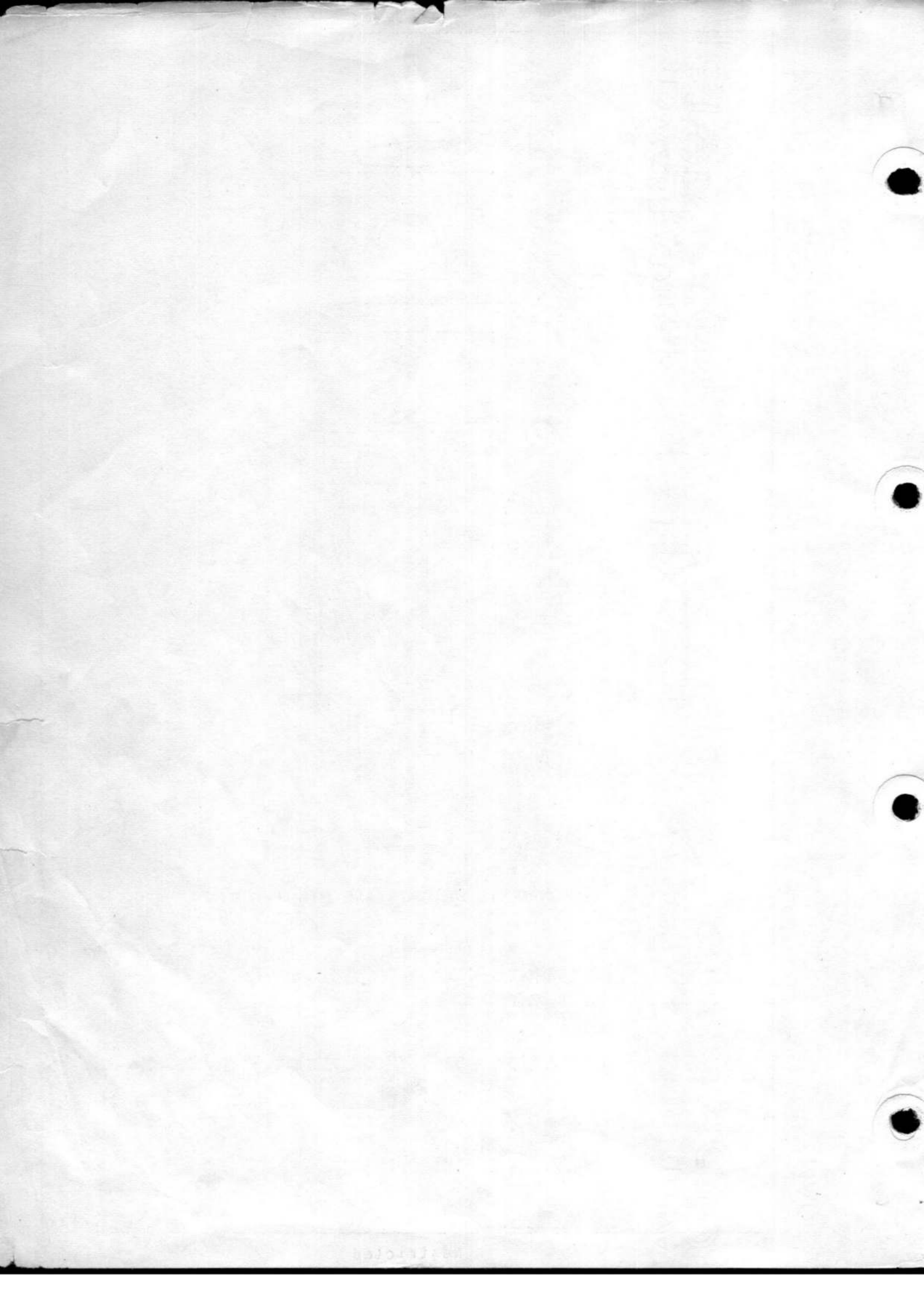

## CANBERRA B.(I) MK.8

## MODIFICATION AND AMENDMENT SHEET

(Airframe)

Mod. No.	A.L. No.	Mod. No.	A.L. No.	Mod. No.	A.L. No.	Mod. No.	A.L. No.	Mod. No.	A.L. No.	Mod. No.	A.L. No.
1(M)	‡	29		57(M)	‡	85(M)	‡	113		141	
2(M)	‡	30		58		86		114		142	
3(M)	‡	31		59		87(M)	‡	115		143	
4(M)	‡	32		60		88		116		144	
5		33		61		89(M)	‡	117		145	
6(M)	‡	34		62(M)	‡	90(M)	‡	118		146	
7		35		63(M)	‡	91		119		147	
8(M)	‡	36		64		92		120		148	
9(M)	‡	37		65(M)	‡	93		121		149	
10(M)	‡	38		66(M)	‡	94		122		150(M)	‡
11(M)	‡	39		67(M)	‡	95		123		151	
12(M)	‡	40		68(M)	‡	96(M)	‡	124		152	
13(M)	‡	41		69(M)	‡	97(M)	‡	125		153(M)	‡
14(M)	‡	42		70		98		126		154(M)	‡
15(M)	‡	43		71(M)	‡	99(M)	‡	127		155(M)	‡
16(M)	‡	44		72		100		128		156(M)	‡
17	‡	45		73(M)	‡	101		129		157(M)	‡
18(M)	‡	46		74(M)	‡	102		130		158(M)	‡
19(M)	‡	47		75		103		131		159	
20		48		76		104		132		160	
21		49		77		105		133		161(M)	‡
22		50		78		106		134		162	
23		51(M)	‡	79(M)	‡	107		135		163(M)	‡
24		52		80(M)	‡	108		136		164(M)	‡
25		53(M)	‡	81		109		137		165(M)	‡
26		54(M)	‡	82		110		138		166	
27		55(M)	‡	83(M)	‡	111		139		167(M)	‡
28		56(M)	‡	84		112		140		168	

‡ Incorporated in initial issue of Schedule.  
 N.A. Modification/Amendment not applicable to this Schedule.  
 C. Modification/Amendment cancelled.  
 (A) Amendment.  
 (M) Modification.

**MODIFICATION AND AMENDMENT SHEET**  
(Airframe)

Mod. No.	A.L. No.	Mod. No.	A.L. No.	Mod. No.	A.L. No.	Mod. No.	A.L. No.	Mod. No.	A.L. No.	Mod. No.	A.L. No.
169(M)	‡	197		225		253		281(M)	‡	309(M)	‡
170(M)	‡	198(M)	‡	226		254		282		310(M)	‡
171(M)	‡	199(M)	‡	227		255(M)	‡	283		311(M)	‡
172		200		228		256(M)	‡	284		312	
173		201		229		257(M)	‡	285(M)	‡	313(M)	‡
174(M)	‡	202		230		258(M)	‡	286(M)	‡	314(M)	‡
175(M)	‡	203		231		259		287		315(M)	‡
176(M)	‡	204		232		260(M)	‡	288(M)	‡	316(M)	‡
177(M)	‡	205		233		261(M)	‡	289		317	
178(M)	‡	206		234		262(M)	‡	290		318(M)	‡
179		207		235		263(M)	‡	291(M)	‡	319	
180(M)	‡	208		236		264(M)	‡	292(M)	‡	320	
181(M)	‡	209		237		265(M)	‡	293(M)	‡	321(M)	‡
182(M)	‡	210		238		266(M)	‡	294(M)	‡	322(M)	‡
183		211		239		267(M)	‡	295(M)	‡	323(M)	‡
184(M)	‡	212		240		268(M)	‡	296(M)	‡	324	
185(M)	‡	213		241		269(M)	‡	297		325(M)	‡
186(M)	‡	214		242		270(M)	‡	298		326(M)	‡
187(M)	‡	215		243		271(M)	‡	299(M)	‡	327	
188(M)	‡	216		244		272(M)	‡	300		328(M)	‡
189		217		245		273		301(M)	‡	329(M)	‡
190		218		246		274		302(M)	‡	330(M)	‡
191		219		247		275(M)	‡	303		331	
192		220		248		276(M)	‡	304		332(M)	‡
193		221		249		277(M)	‡	305(M)	‡	333	
194		222		250(M)	‡	278(M)	‡	306(M)	‡	334(M)	‡
195(M)	‡	223		251(M)	‡	279(M)	‡	307(M)	‡	335(M)	‡
196(M)	‡	224		252(M)	‡	280(M)	‡	308		336	

‡ Incorporated in initial issue of Schedule.  
 N.A. Modification/Amendment not applicable to this Schedule.  
 C. Modification/Amendment cancelled.  
 (A) Amendment.  
 (M) Modification.

## CANBERRA B.(I) MK.8

## MODIFICATION AND AMENDMENT SHEET

(Airframe)

Mod. No.	A.L. No.	Mod. No.	A.L. No.	Mod. No.	A.L. No.	Mod. No.	A.L. No.	Mod. No.	A.L. No.	Mod. No.	A.L. No.
337(M)	‡	365		393		421		449(M)	‡	477	
338		366		394		422(M)	‡	450(M)	‡	478	
339(M)	‡	367		395		423		451		479	
340(M)	‡	368		396		424(M)	‡	452		480	
341(M)	‡	369		397		425		453		481	
342		370		398		426		454		482	
343(M)	‡	371		399		427(M)	‡	445		483	
344(M)	‡	372		400(M)	‡	428(M)	‡	456		484	
345(M)	‡	373		401(M)	‡	429(M)	‡	457		485	
346		374		402(M)	‡	430		458		486	
347(M)	‡	375		403(M)	‡	431		459		487	
348		376		404(M)	‡	432		460		488	
349(M)	‡	377		405(M)	‡	433(M)	‡	461		489	
350		378		406(M)	‡	434(M)	‡	462		490	
351		379		407(M)	‡	435		463		491	
352		380		408		436		464		492	
353		381		409(M)	‡	437(M)	‡	465		493	
354		382		410(M)	‡	438(M)	‡	466		494	
355		383		411(M)	‡	439		467		495	
356		384		412(M)	‡	440		468		496	
357		385		413		441		469		497	
358		386		414		442(M)	‡	470		498	
359		387		415		443		471		499	
360		388		416		444(M)	‡	472		500	
361		389		417		445(M)	‡	473		501	
362		390		418		446(M)	‡	474		502(M)	‡
363		391		419(M)	‡	447(M)	‡	475		503(M)	‡
364		392		420(M)	‡	448		476		504(M)	‡

‡ Incorporated in initial issue of Schedule.  
 N.A. Modification/Amendment not applicable to this Schedule.  
 C. Modification/Amendment cancelled.  
 (A) Amendment.  
 (M) Modification.

**MODIFICATION AND AMENDMENT SHEET**  
(Airframe)

Mod. No.	A.L. No.	Mod. No.	A.L. No.	Mod. No.	A.L. No.	Mod. No.	A.L. No.	Mod. No.	A.L. No.	Mod. No.	A.L. No.
505(M)	‡	532		560		589		617(M)	‡	645	
506(M)	‡	533(M)	‡	561		590		618(M)	‡	646	
507		534		562		591		619		647	
508(M)	‡	535(M)	‡	563		592		620		648(M)	‡
509(M)	‡	536(M)	‡	564		593		621		649	
510		537(M)	‡	565		594		622(M)	‡	650(M)	‡
511(M)	‡	538(M)	‡	566		595		623		651	
512(M)	‡	539		567		596		624		652	
513(M)	‡	540(M)	‡	568		597		625		653	
514(M)	‡	541(M)	‡	569		598		626		654	
515		542(M)	‡	570		599		627		655	
516		543		571		600		628(M)	‡	656	
517		544		572		601		629		657	
518		545(M)	‡	573		602		630		658	
519		546(M)	‡	574		603(M)	‡	631(M)	‡	659	
520		547(M)	‡	575		604		632(M)	‡	660	
521		548(M)	‡	576		605		633		661	
522		549		578		606(M)	‡	634		662	
523(M)	‡	550		579		607(M)	‡	635		663	
524		551		580		608		636(M)	‡	664	
524		552		581		609		637		665	
525		553		582		610		638		666	
526		554		583		611(M)	‡	639		667	
527		555		584		612(M)	‡	640(M)	‡	668	
528(M)	‡	556		585		613		641(M)	‡	669	
529		557		586		614		642		670	
530		558		587		615		643(M)	‡	671	
531(M)	‡	559		588		616(M)	‡	644(M)	‡	672	

‡ Incorporated in initial issue of Schedule.  
 N.A. Modification/Amendment not applicable to this Schedule.  
 C. Modification/Amendment cancelled.  
 (A) Amendment.  
 (M) Modification.

## CANBERRA B.(I) MK.8

**MODIFICATION AND AMENDMENT SHEET**  
(Airframe)

Mod. No.	A.L. No.	Mod. No.	A.L. No.	Mod. No.	A.L. No.	Mod. No.	A.L. No.	Mod. No.	A.L. No.	Mod. No.	A.L. No.
673		701		729(M)	‡	757		785		813	
674		702		730(M)	‡	758		786		814	
675		703		731(M)	‡	759		787		815	
676		704		732		760		788		816	
677		705		733(M)	‡	761		789		817	
678		706(M)	‡	734		762		790		818	
679		707		735(M)	‡	763		791		819	
680		708		736		764		792		820	
681		709		737		765		793		821	
682		710(M)	‡	738(M)	‡	766		794		822	
683		711(M)	‡	739(M)	‡	767		795		823	
684		712		740(M)	‡	768		796		824	
685		713(M)	‡	741		769		797		825	
686		714		742		770		798		826	
687		715(M)	‡	743		771		799		827	
688		716(M)	‡	744		772		800		828	
689		717(M)	‡	745(M)	‡	773		801		829	
690		718		746		774		802		830	
691		719		747		775		803		831	
692		720(M)	‡	748		776		804		832	
693		721		749(M)	‡	777		805		833	
694		722		750(M)	‡	778		806		834	
695		723		751		779		807		835	
696		724(M)	‡	752		780		808		836	
697		725		753		781		809		837	
698		726		754		782		810		838	
699		727		755		783		811		839	
700		728		756		784		812		840	

‡ Incorporated in initial issue of Schedule.  
 N.A. Modification/Amendment not applicable to this Schedule.  
 C. Modification/Amendment cancelled.  
 (A) Amendment.  
 (M) Modification.

**MODIFICATION AND AMENDMENT SHEET**  
(Airframe)

Mod. No.	A.L. No.	Mod. No.	A.L. No.	Mod. No.	A.L. No.	Mod. No.	A.L. No.	Mod. No.	A.L. No.	Mod. No.	A.L. No.
841		869		897		925		953		981	
842		870		898		926		954		982	
843		871		899		927		955		983	
844		872(M)	‡	900		928		956		984	
845		873		901		929		957		985	
846		874(M)	‡	902		930		958		986	
847		875(M)	‡	903		931		959		987	
848		876		904		932		960		988	
849		877		905		933		961		989	
850		878(M)	‡	906		934		962		990	
851		879		907		935		963		991	
852(M)	‡	880(M)	‡	908		936		964		992	
853(M)	‡	881		909		937		965		993	
854		882		910(A)	‡	938		966		994	
855		883		911		939		967		995	
856(M)	‡	884		912		940		968		996	
857(M)	‡	885(M)	‡	913		941		969		997	
858		886(M)	‡	914		942		970		998	
859(M)	‡	887(M)	‡	915		943		971		999	
860(M)	‡	888		916		944		972		1000	
861		889		917		945		973		1001(M)	‡
862(M)	‡	890(M)	‡	918		946		974		1002(M)	‡
863		891		919		947		975		1003	
864(M)	‡	892		920		948		976		1004(M)	‡
865		893		921		949		977		1005	
866		894(M)	‡	922		950		978		1006	
867		895(M)	‡	923		951		979		1007(M)	‡
868(M)	‡	896(M)	‡	924		952		980		1008(M)	‡

‡ Incorporated in initial issue of Schedule.  
N.A. Modification/Amendment not applicable to this Schedule.  
C. Modification/Amendment cancelled.  
(A) Amendment.  
(M) Modification.

CANBERRA B.(I) MK.8

**MODIFICATION AND AMENDMENT SHEET**  
(Airframe)

Mod. No.	A.L. No.	Mod. No.	A.L. No.	Mod. No.	A.L. No.	Mod. No.	A.L. No.	Mod. No.	A.L. No.	Mod. No.	A.L. No.
1009(M)	‡	1037		1065		1093		1121		1149	
1010		1038		1066		1094		1122		1150	
1011(M)	‡	1039		1067		1095		1123		1151(M)	‡
1012(M)	‡	1040(M)	‡	1068		1096		1124		1152(M)	‡
1013(M)	‡	1041		1069		1097		1125		1153	
1014		1042		1070		1098		1126		1154	
1015		1043		1071		1099		1127		1155(M)	‡
1016(M)	‡	1044		1072		1100		1128		1156	
1017		1045		1073		1101		1129		1157	
1018(M)	‡	1046		1074		1102		1130		1158	
1019		1047(M)	‡	1075		1103		1131		1159	
1020		1048(M)	‡	1076		1104		1132		1160(M)	‡
1021(M)	‡	1049		1077		1105		1133		1161	
1022(M)	‡	1050(M)	‡	1078		1106		1134		1162	
1023(M)	‡	1051		1079		1107		1135		1163(M)	‡
1024(M)	‡	1052		1080		1108		1136		1164	
1025		1053		1081		1109		1137		1165	
1026		1054		1082		1110		1138		1166	
1027		1055		1083		1111		1139		1167	
1028		1056		1084		1112		1140		1168	
1029(M)	‡	1057		1085		1113		1141		1169(M)	‡
1030(M)	‡	1058		1086		1114		1142		1170(M)	‡
1031		1059		1087		1115		1143		1171(M)	‡
1032		1060		1088		1116		1144		1172	
1033(M)	‡	1061		1089		1117		1145		1173	
1034		1062		1090		1118		1146		1174	
1035		1063		1091		1119		1147		1175	
1036(M)	‡	1064		1092		1120		1148		1176(M)	‡

‡ Incorporated in initial issue of Schedule.  
 N.A. Modification/Amendment not applicable to this Schedule.  
 C. Modification/Amendment cancelled.  
 (A) Amendment.  
 (M) Modification.

## MODIFICATION AND AMENDMENT SHEET

(Airframe)

Mod. No.	A.L. No.	Mod. No.	A.L. No.	Mod. No.	A.L. No.	Mod. No.	A.L. No.	Mod. No.	A.L. No.	Mod. No.	A.L. No.
1177		1205		1233		1261		1289		1317	
1178		1206		1234		1262		1290(M)	‡	1318	
1179		1207		1235		1263		1291(M)	‡	1319	
1180		1208		1236		1264(M)	‡	1292		1320	
1181		1209		1237		1265(M)	‡	1293(M)	‡	1321	
1182		1210		1238		1266(M)	‡	1294(M)	‡	1322	
1183		1211		1239		1267		1295(M)	‡	1323	
1184		1212		1240		1268(M)	‡	1296(M)	‡	1324	
1185		1213		1241		1269		1297		1325	
1186		1214		1242		1270(M)	‡	1298		1326	
1187		1215		1243		1271(M)	‡	1299(M)	‡	1327	
1189		1216		1244		1272		1300		1328	
1189(M)	‡	1217		1245		1273		1301		1329	
1190		1218		1246		1274		1302		1330	
1191		1219		1247		1275		1303		1331	
1192		1220		1248		1276(M)	‡	1304		1332	
1193		1221		1249		1277		1305		1333	
1194		1222		1250		1278		1306		1334	
1195		1223		1251		1279		1307		1335	
1196		1224		1252		1280(M)	‡	1308		1336	
1197(M)	‡	1225		1253		1281		1309		1337	
1198(M)	‡	1226		1254(M)	‡	1282		1310		1338	
1199(M)	‡	1227		1255		1283		1311		1339	
1200		1228		1256		1284		1312		1340	
1201		1229		1257		1285		1313		1341	
1202		1230		1258(M)	‡	1286		1314		1342	
1203		1231		1259(M)	‡	1287		1315		1343	
1204		1232		1260		1288		1316		1344	

‡ Incorporated in initial issue of Schedule.  
 N.A. Modification/Amendment not applicable to this Schedule.  
 C. Modification/Amendment cancelled.  
 (A) Amendment.  
 (M) Modification.

### MODIFICATION AND AMENDMENT SHEET (Airframe)

Mod. No.	A.L. No.	Mod. No.	A.L. No.	Mod. No.	A.L. No.	Mod. No.	A.L. No.	Mod. No.	A.L. No.	Mod. No.	A.L. No.
1345		1373		1401		1429(M)	C	1457	NA	1485	NA
1346		1374		1402(M)	‡	1430	11	1458	NA	1486	NA
1347		1375		1403(M)	A	1431	NA	1459(M)	‡	1487(M)	‡
1348		1376		1404		1432	NA	1460(M)	‡	1488	NA
1349		1377		1405(M)	‡	1433(M)	‡	1461	NA	1489	NA
1350		1378		1406		1434(M)	‡	1462	NA	1490	NA
1351		1379		1407		1435(M)	‡	1463(M)	‡	1491(M)	‡
1352		1380		1408		1436	NA	1464(M)	11	1492	NA
1353		1381		1409		1437	NA	1465(M)	‡	1493(M)	‡
1354		1382		1410		1438(M)	‡	1466(M)	‡	1494	NA
1355		1383		1411		1439	NA	1467	C	1495	NA
1356		1384		1412		1440	NA	1468		1496	NA
1357		1385		1413		1441(M)	‡	1469(M)	A	1497(M)	10
1358		1386		1414		1442(M)	NA	1470	NA	1498(M)	‡
1359		1387		1415		1443	NA	1471	NA	1499	NA
1360		1388		1416		1444	NA	1472	NA	1500(M)	10
1361		1389		1417		1445	NA	1473(M)	‡	1501	
1362		1390		1418		1446	NA	1474	NA	1502	
1363		1391		1419		1447	NA	1475	C	1503	
1364		1392		1420(M)	‡	1448	C	1476	NA	1504	
1365		1393		1421(M)	‡	1449	NA	1477(M)	‡	1505	
1366		1394		1422	NA	1450(M)	‡	1478(M)	‡	1506	
1367		1395		1423	NA	1451	NA	1479	NA	1507	
1368		1396		1424	NA	1452	NA	1480	NA	1508	
1369		1397		1425(M)	‡	1453	NA	1481	NA	1509	
1370		1398		1426(M)	‡	1454(M)	‡	1482	NA	1510	
1371		1399		1427	NA	1455	C	1483	NA	1511	
1372		1400		1428	NA	1456	NA	1484	NA	1512	

‡ Incorporated in initial issue of this schedule.  
 NA Modification/Amendment not applicable to this schedule.  
 C Modification/Amendment cancelled.  
 (A) Amendment.  
 (M) Modification.

**MODIFICATION AND AMENDMENT SHEET  
(Airframe)**

Mod. No.	A.L. No.	Mod. No.	A.L. No.	Mod. No.	A.L. No.	Mod. No.	A.L. No.	Mod. No.	A.L. No.	Mod. No.	A.L. No.
1513		1541		1569		1597		1625		1653	
1514		1542		1570		1598		1626		1654	
1515		1543		1571		1599		1627		1655	
1516		1544		1572		1600		1628		1656	
1517		1545		1573		1601		1629		1657	
1518		1546		1574		1602		1630		1658	
1519		1547		1575		1603		1631		1659	
1520		1548		1576		1604		1632		1660	
1521		1549		1577		1605		1633		1661	
1522		1550		1578		1606		1634		1662	
1523		1551		1579		1607		1635		1663	
1524		1552		1580		1608		1636		1664	
1525		1553		1581		1609		1637		1665	
1526		1554		1582		1610		1638		1666	
1527		1555		1583		1611		1639		1667	
1528		1556		1584		1612		1640		1668	
1529		1557		1585		1613		1641		1669	
1530		1558		1586		1614		1642		1670	
1531		1559		1587		1615		1643		1671	
1532		1560		1588		1616		1644		1672	
1533		1561		1589		1617		1645		1673	
1534		1562		1590		1618		1646		1674	
1535		1563		1591		1619		1647		1675	
1536		1564		1592		1620		1648		1676	
1537		1565		1593		1621		1649		1677	
1538		1566		1594		1622		1650		1678	
1539		1567		1595		1623		1651		1679	
1540		1568		1596		1624		1652		1680	

‡ Incorporated in initial issue of this schedule.  
 NA Modification/Amendment not applicable to this schedule.  
 C Modification/Amendment cancelled.  
 (A) Amendment.  
 (M) Modification.

### MODIFICATION AND AMENDMENT SHEET (Airframe)

Mod. No.	A.L. No.	Mod. No.	A.L. No.	Mod. No.	A.L. No.	Mod. No.	A.L. No.	Mod. No.	A.L. No.	Mod. No.	A.L. No.
1681		1709	NA	1737	NA	1765(M)	‡	1793(M)	NA	1821	
1682		1710	C	1738(M)	‡	1766(M)	‡	1794(M)	11	1822	
1683		1711(M)	C	1739(M)	NA	1767	10	1795(M)	10	1823(A)	NA
1684		1712	11	1740	NA	1768(M)	NA	1796(M)	NA	1824	
1685		1713	NA	1741	C	1769(M)	‡	1797(M)	10	1825	
1686		1714	10	1742	NA	1770	C	1798(M)	NA	1826(A)	NA
1687		1715(M)	NA	1743	NA	1771	NA	1799(M)	6	1827	
1688		1716	NA	1744	NA	1772	C	1800	C	1828(A)	‡
1689		1717	C	1745	NA	1773	NA	1801		1829	
1690		1718	C	1746	C	1774	NA	1802		1830	
1691		1719	C	1747(M)	C	1775	C	1803		1831	
1692		1720(M)	‡	1748	NA	1776	C	1804		1832(A)	NA
1693		1721(M)	‡	1749	C	1777	C	1805		1833(A)	NA
1694		1722(M)	‡	1750	NA	1778(M)	NA	1806		1834	
1695		1723	NA	1751(M)	NA	1779	C	1807		1835	
1696		1724	NA	1752(M)	‡	1780	C	1808		1836(A)	NA
1697		1725	NA	1753(M)	‡	1781(M)	11	1809(A)	‡	1837	
1698		1726(M)	NA	1754(M)	NA	1782	NA	1810		1838	
1699		1727	NA	1755(M)	‡	1783	NA	1811		1839(A)	NA
1700		1728(M)	10	1756(M)	NA	1784(M)	NA	1812		1840(A)	NA
1701(M)	‡	1729	C	1757(M)	NA	1785	C	1813		1841	
1702	NA	1730(M)	5	1758(M)	NA	1786(M)	‡	1814		1842	
1703(M)	‡	1731	NA	1759(M)	‡	1787(M)	5	1815		1843	
1704	NA	1732	NA	1760(M)	NA	1788(M)	6	1816		1844(A)	‡
1705(M)	10	1733	NA	1761(M)	‡	1789(M)	NA	1817		1845(A)	NA
1706	NA	1734	10	1762(M)	‡	1790(M)	NA	1818		1846(A)	NA
1707	NA	1735	NA	1763(M)	NA	1791(M)	NA	1819		1847(A)	
1708	NA	1736	NA	1764(M)	‡	1792(M)	NA	1820		1848	

‡ Incorporated in initial issue of this schedule.  
 NA Modification/Amendment not applicable to this schedule.  
 C Modification/Amendment cancelled.  
 (A) Amendment.  
 (M) Modification.

**MODIFICATION AND AMENDMENT SHEET  
(Airframe)**

Mod. No.	A.L. No.	Mod. No.	A.L. No.	Mod. No.	A.L. No.	Mod. No.	A.L. No.	Mod. No.	A.L. No.	Mod. No.	A.L. No.
1849		1877(A)	NA	1905	NA	1933(M)	10	1961(M)	10	1989	C
1850(A)	NA	1878(A)	NA	1906	NA	1934	NA	1962(M)	10	1990(M)	10
1851(A)	NA	1879(A)	NA	1907	NA	1935(M)	NA	1963(M)	10	1991	C
1852(A)	NA	1880(A)	‡	1908	NA	1936(M)	NA	1964	C	1992	C
1853(A)	‡	1881(A)	NA	1909	NA	1937(M)	6	1965	NA	1993(M)	NA
1854		1882(A)	NA	1910	NA	1938	NA	1966(M)	NA	1994	C
1855(A)	NA	1883(A)	NA	1911	NA	1939(M)	11	1967	NA	1995(M)	NA
1856(A)	‡	1884(A)	NA	1912(M)	5	1940	NA	1968	NA	1996(M)	NA
1857(A)	NA	1885(A)	NA	1913(M)	6	1941	C	1969(M)	NA	1997(M)	10
1858		1886(A)	NA	1914	C	1942	C	1970	NA	1998	C
1859(A)	NA	1887(A)	NA	1915(M)	6	1943	C	1971(M)	NA	1999(M)	11
1860(A)	NA	1888(A)	NA	1916(M)	5	1944	NA	1972	C	2000	NA
1861		1889(A)	NA	1917(M)	10	1945	NA	1973	NA	2001(A)	NA
1862(A)	NA	1890(A)	NA	1918	NA	1946(M)	NA	1974(M)	NA	2002(A)	NA
1863(A)	NA	1891(A)	NA	1919	NA	1947(M)	10	1975(M)	10	2003(A)	NA
1864(A)	NA	1892(A)	NA	1920(M)	11	1948(M)	10	1976	C	2004(A)	‡
1865(A)	NA	1893(A)	NA	1921	NA	1949	12	1977(M)	NA	2005(A)	NA
1866(A)	NA	1894(A)	NA	1922	NA	1950(M)	6	1978(M)	NA	2006(A)	NA
1867		1895(A)	NA	1923	NA	1951(M)	11	1979	C	2007(A)	NA
1868(A)	NA	1896(A)	NA	1924	NA	1952(M)	C	1980	C	2008(A)	NA
1869(A)	‡	1897(A)	NA	1925	NA	1953(M)	C	1981	NA	2009(A)	‡
1870(A)	NA	1898(A)	NA	1926	NA	1954(M)	10	1982	NA	2010(A)	NA
1871(A)	NA	1899(A)	NA	1927	NA	1955(M)	11	1983(M)	11	2011	
1872		1900(A)	NA	1928	NA	1956(M)	5	1984	NA	2012(A)	NA
1873(A)	NA	1901(M)	‡	1929	NA	1957	NA	1985(M)	NA	2013(A)	NA
1874(A)	NA	1902(M)	NA	1930(M)	11	1958(M)	10	1986(M)	C	2014(A)	NA
1875(A)	NA	1903(M)	NA	1931(M)	10	1959	C	1987	C	2015(A)	NA
1876(A)	NA	1904	NA	1932(M)	10	1960(M)	11	1988(M)	C	2016(A)	NA

‡ Incorporated in initial issue of this schedule.  
 NA Modification/Amendment not applicable to this schedule.  
 C Modification/Amendment cancelled.  
 (A) Amendment.  
 (M) Modification.

**MODIFICATION AND AMENDMENT SHEET**  
**(Airframe)**

Mod. No.	A.L. No.	Mod. No.	A.L. No.	Mod. No.	A.L. No.	Mod. No.	A.L. No.	Mod. No.	A.L. No.	Mod. No.	A.L. No.
2017(A)	NA	2045	NA	2073(A)	NA	2101(A)	C	2129(M)	10	2157	C
2018(A)	NA	2046(A)	A	2074(A)	A	2102(M)	10	2130	C	2158	NA
2019(A)	NA	2047(A)	A	2075(A)	NA	2103(M)	10	2131	NA	2159	NA
2020(A)	‡	2048(A)	NA	2076(A)	NA	2104(M)	10	2132	NA	2160	NA
2021(A)	NA	2049(A)	A	2077	NA	2105(M)	6	2133	NA	2161	13
2022	NA	2050(A)	NA	2078(A)	A	2106	C	2134(M)	10	2162	C
2023(A)	‡	2051(A)	NA	2079(A)	A	2107	NA	2135	12	2163	C
2024(A)	‡	2052	NA	2080(A)	A	2108	NA	2136	13	2164	C
2025(A)	‡	2053(A)	NA	2081	NA	2109(M)	6	2137	C	2165	C
2026(A)	NA	2054(A)	NA	2082(A)	A	2110	NA	2138	C	2166(M)	NA
2027	NA	2055(A)	A	2083	NA	2111	C	2139	C	2167	
2028(A)	‡	2056(A)	NA	2084(A)	NA	2112	C	2140	C	2168	C
2029(A)	A	2057(A)	NA	2085(A)	A	2113	C	2141	C	2169	C
2030(A)	‡	2058	NA	2086(A)	NA	2114(M)	10	2142	14	2170	NA
2031(A)	A	2059(A)	NA	2087(A)	NA	2115	C	2143	18	2171	NA
2032(A)	NA	2060(A)	NA	2088(A)	A	2116	C	2144(M)	11	2172	NA
2033(A)	‡	2061(A)	A	2089(A)	A	2117	C	2145	C	2173	NA
2034(A)	NA	2062(A)	A	2090(A)	NA	2118	C	2146(M)	11	2174(M)	5
2035(A)	‡	2063(A)	A	2091(A)	NA	2119	C	2147(M)	10	2175	C
2036(A)	‡	2064(A)	NA	2092(A)	A	2120	C	2148(M)	8	2176(M)	NA
2037(A)	NA	2065(A)	A	2093(A)	NA	2121(M)	11	2149	10	2177	NA
2038(A)	NA	2066(A)	A	2094(A)	A	2122	NA	2150(M)	11	2178	NA
2039(A)	NA	2067(A)	A	2095(A)	NA	2123	NA	2151(M)	11	2179(M)	11
2040(A)	‡	2068(A)	A	2096(A)	A	2124	C	2152	C	2180(M)	5
2041(A)	NA	2069(A)	A	2097(A)	NA	2125(M)	8	2153	C	2181(M)	5
2042(A)	A	2070(A)	NA	2098(A)	A	2126(M)	10	2154	NA	2182(M)	8
2043(A)	NA	2071	NA	2099	NA	2127(M)	10	2155	NA	2183	13
2044(A)	A	2072(A)	A	2100	NA	2128	NA	2156	NA	2184(M)	5

‡ Incorporated in initial issue of this schedule.  
 NA Modification/Amendment not applicable to this schedule.  
 C Modification/Amendment cancelled  
 (A) Amendment.  
 (M) Modification.

**MODIFICATION AND AMENDMENT SHEET**  
**(Airframe)**

Mod. No.	A.L. No.	Mod. No.	A.L. No.	Mod. No.	A.L. No.	Mod. No.	A.L. No.	Mod. No.	A.L. No.	Mod. No.	A.L. No.
2185	C	2213(A)	NA	2241	NA	2269	NA	2297	NA	2325	NA
2186	NA	2214(A)	A	2242(A)	A	2270	NA	2298(A)	A	2326	NA
2187	NA	2215(A)	NA	2243(A)	A	2271	NA	2299	NA	2327	NA
2188	C	2216(A)	NA	2244(A)	A	2272	NA	2300(M)	A	2328	C
2189(M)	10	2217(A)	NA	2245(A)	NA	2273	NA	2301	NA	2329	NA
2190	C	2218(A)	A	2246	NA	2274	NA	2302(M)	NA	2330(M)	10
2191(M)	11	2219(A)	A	2247(A)	A	2275	NA	2303(M)	NA	2331(M)	5
2192	NA	2220	NA	2248	NA	2276	NA	2304(M)	11	2332	NA
2193	NA	2221(A)	A	2249(A)	A	2277	NA	2305(M)	NA	2333	17
2194	13	2222(A)	A	2250(A)	NA	2278	NA	2306(M)	6	2334(M)	NA
2195	13	2223(A)	NA	2251	NA	2279	NA	2307	C	2335(M)	11
2196(M)	18	2224	NA	2252	NA	2280	NA	2308(M)	11	2336	NA
2197	NA	2225(A)	A	2253	NA	2281	NA	2309(M)	5	2337	NA
2198	NA	2226(A)	NA	2254	NA	2282	NA	2310	NA	2338	C
2199	NA	2227(A)	A	2255	NA	2283	NA	2311(M)	5	2339	NA
2200(M)	10	2228(A)	NA	2256	NA	2284	NA	2312	NA	2340	13
2201(A)	NA	2229(A)	NA	2257	NA	2285	NA	2313(M)	C	2341	NA
2202(A)	NA	2230(A)	NA	2258	NA	2286	NA	2314	C	2342	15
2203(A)	A	2231	NA	2259	NA	2287	NA	2315(M)	NA	2343	C
2204	NA	2232(A)	A	2260	NA	2288	NA	2316	17	2344	C
2205	NA	2233(A)	A	2261	NA	2289	NA	2317	NA	2345	C
2206(A)	NA	2234(A)	A	2262	NA	2290	NA	2318	NA	2346	C
2207(A)	A	2235(A)	A	2263	NA	2291	NA	2319	NA	2347	NA
2208(A)	NA	2236	NA	2264	NA	2292	NA	2320	NA	2348	NA
2209	NA	2237(A)	NA	2265	NA	2293	NA	2321	NA	2349	C
2210(A)	NA	2238	NA	2266	NA	2294	NA	2322(M)	13	2350	NA
2211(A)	NA	2239(A)	NA	2267	NA	2295	NA	2323	13	2351	C
2212(A)	A	2240(A)	NA	2268	NA	2296	NA	2324	NA	2352	NA

‡ Incorporated in initial issue of this schedule.  
 NA Modification/Amendment not applicable to this schedule.  
 C Modification/Amendment cancelled  
 (A) Amendment.  
 (M) Modification.

**MODIFICATION AND AMENDMENT SHEET**  
(Airframe)

Mod. No.	A.L. No.	Mod. No.	A.L. No.	Mod. No.	A.L. No.	Mod. No.	A.L. No.	Mod. No.	A.L. No.	Mod. No.	A.L. No.
2353	NA	2381	C	2409		2526	NA	2554	C	2582	C
2354	C	2382	C	TO	NA	2527	NA	2555	NA	2583	NA
2355	NA	2383	14	2500		2528	NA	2556	NA	2584	NA
2356	13	2384	11	2501	10	2529	C	2557	NA	2585	NA
2357	C	2385	NA	2502	NA	2530	NA	2558	NA	2586	NA
2358	NA	2386	NA	2503	NA	2531	11	2559	NA	2587	NA
2359	NA	2387	C	2504	NA	2532	NA	2560	10	2588	16
2360	NA	2388	NA	2505	13	2533	18	2561	8	2589	10
2361	11	2389	NA	2506	NA	2534	14	2562	NA	2590	NA
2362	15	2390	13	2507	18	2535	11	2563	13	2591	C
2363	12	2391	NA	2508	17	2536	NA	2564	10	2592	16
2364	NA	2392	NA	2509	C	2537	NA	2565	NA	2593	NA
2365	C	2393	NA	2510	C	2538	11	2566	NA	2594	18
2366	C	2394	NA	2511	NA	2539	NA	2567	NA	2595	10
2367	NA	2395	11	2512	NA	2540	18	2568	17	2596	NA
2368	NA	2396	10	2513	C	2541	NA	2569	6	2597	C
2369	NA	2397	C	2514	C	2542	NA	2570	C	2598	C
2370	14	2398	NA	2515	12	2543	C	2571	NA	2599	
2371	NA	2399	NA	2516	NA	2544	NA	2572	8	2600	NA
2372	NA	2400	NA	2517	NA	2545	10	2573	NA	2601	NA
2373	12	2401	NA	2518	NA	2546	15	2574	C	2602	NA
2374	C	2402	NA	2519	C	2547	C	2575	NA	2603	NA
2375	NA	2403	NA	2520	C	2548	NA	2576	NA	2604	13
2376	NA	2404	NA	2521	C	2549	13	2577	NA	2605	13
2377	NA	2405	NA	2522	C	2550	NA	2578	NA	2606	12
2378	NA	2406	NA	2523	NA	2551	NA	2579	NA	2607	C
2379	11	2407	NA	2524	C	2552	NA	2580	NA	2608	C
2380	11	2408	NA	2525	NA	2553	NA	2581	C	2609	C

‡ Incorporated in initial issue of this schedule.  
 NA Modification/Amendment not applicable to this schedule.  
 C Modification/Amendment cancelled.  
 (A) Amendment.  
 (M) Modification.

**MODIFICATION AND AMENDMENT SHEET  
(Airframe)**

Mod. No.	A.L. No.	Mod. No.	A.L. No.	Mod. No.	A.L. No.	Mod. No.	A.L. No.	Mod. No.	A.L. No.	Mod. No.	A.L. No.
2610	C	2639	17	2668	C	2697	13	2726	NA	3137	NA
2611	8	2640		2669		2698	18	2727	NA	3138	NA
2612	NA	2641	NA	2670	18	2699		2728	NA	3139	NA
2613	18	2642	NA	2671		2700		2729	NA	3140	
2614	11	2643	NA	2672	13	2701	16	2730		3141	NA
2615	11	2644	13	2673	18	2702	NA	2731	NA	3142	NA
2616		2645	NA	2674		2703	NA	2732		3143	NA
2617		2646	NA	2675		2704	11	2733	NA	3144	NA
2618		2647	NA	2676	13	2705	11	2734	NA	3145	NA
2619	NA	2648		2677	15	2706	NA	2735	C	3146	NA
2620	NA	2649		2678	NA	2707	NA	2736		3147	NA
2621	8	2650		2679		2708		2737	NA	3148	NA
2622	NA	2651		2680	NA	2709		2738	NA	3149	
2623	NA	2652		2681	NA	2710		2739	NA	3150	NA
2624	15	2653		2682	NA	2711		2740		3151	
2625	15	2654		2683	NA	2712	NA	2741		3152	NA
2626	13	2655	18	2684	13	2713	NA	2742		3153	NA
2627	17	2656	NA	2685	NA	2714		2743		3154	17
2628		2657		2686	NA	2715	C	2744	NA	3155	13
2629		2658		2687	18	2716	C	2745		3156	18
2630	NA	2659	NA	2688	NA	2717	NA	2746		3157	18
2631		2660	NA	2689	15	2718	NA	2747		3158	10
2632		2661		2690	18	2719		2748		3159	15
2633	NA	2662		2691		2720	16	2749		3160	
2634	NA	2663		2692	NA	2721	16	2750		TO	NA
2635		2664	NA	2693	14	2722	NA	2751		3180	
2636		2665		2694	NA	2723	NA	TO	NA	3181	15
2637		2666		2695	NA	2724	C	3135		3182	NA
2638		2667	NA	2696		2725	NA	3136	NA	3183	NA

‡ Incorporated in initial issue of this schedule.  
 NA Modification/Amendment not applicable to this schedule.  
 C Modification/Amendment cancelled  
 (A) Amendment.  
 (M) Modification.

**MODIFICATION AND AMENDMENT SHEET  
(Airframe)**

Mod. No.	A.L. No.	Mod. No.	A.L. No.	Mod. No.	A.L. No.	Mod. No.	A.L. No.	Mod. No.	A.L. No.	Mod. No.	A.L. No.
3184	C	3213	18	3242	NA	3278	NA	3326	13	3371	NA
3185	NA	3214	C	3243	NA	3279	C	3327	13	3372	NA
3186	C	3215	NA	3244	18	3280	NA	3328	16	3373	C
3187	NA	3216	NA	3245	14	3281	NA	3329		3374	NA
3188	18	3217	NA	3246		3282	18	3330	14	3375	NA
3189		3218	NA	3247		3283		3331	18	3376	NA
3190		3219		3248	NA	3284		3332	C	3377	NA
3191	C	3220		3249	NA	3285		3333	16	3378	NA
3192	13	3221	16	3250	NA	3286		3334		3379	NA
3193	NA	3222	NA	3251	C	3287		TO	} NA	3380	NA
3194	C	3223	9	3252	NA	3288		3349			3381
3195		3224	18	3253	NA	3289		3350		3382	13
3196	C	3225	NA	3254	NA	3290	NA	3351	18	3383	NA
3197	NA	3226	C	3255	NA	3291	C	3352	NA	3384	NA
3198	NA	3227		3256		3292	15	3353	NA	3385	NA
3199	NA	3228	NA	3257		3293	NA	3354	NA	3386	NA
3200	NA	3229	NA	3258	NA	3294		3355	NA	3387	NA
3201	NA	3230	NA	3259		3295	18	3356	NA	3388	NA
3202	NA	3231	NA	3260		3296	NA	3357	NA	3389	NA
3203	NA	3232	NA	3261	NA	3297	NA	3358	C	3390	NA
3204	C	3233	NA	3262	NA	3298	NA	3359		3391	18
3205	NA	3234	18	3263	} NA	3299	NA	TO	} NA	3392	C
3206	NA	3235	NA	TO		3300	NA	3364			3393
3207	C	3236	NA	3272		3301	NA	3365		3394	18
3208	C	3237	NA	3273		3302	NA	3366		3395	C
3209	NA	3238	NA	3274	NA	3303		3367	18	3396	NA
3210	NA	3239	NA	3275	18	TO	} NA	3368	17	3397	NA
3211	11	3240	NA	3276	NA	3324			3369	18	3398
3212		3241	NA	3277	NA	3325	NA	3370	C	3399	

‡ Incorporated in initial issue of this schedule.  
 NA Modification/Amendment not applicable to this schedule.  
 C Modification/Amendment cancelled  
 (A) Amendment.  
 (M) Modification.

**MODIFICATION AND AMENDMENT SHEET  
(Airframe)**

Mod. No.	A.L. No.	Mod. No.	A.L. No.	Mod. No.	A.L. No.	Mod. No.	A.L. No.	Mod. No.	A.L. No.	Mod. No.	A.L. No.
3400	NA	3439	NA	3478	NA	3514	C	3543	18	3580	NA
3401	NA	3440	NA	3479	NA	3515	NA	3544	NA	3581	NA
3402	NA	3441	NA	3480	NA	3516	NA	3545	16	3582	C
3403	NA	3442	NA	3481	NA	3517	NA	3546	13	3583	NA
3404	15	3443	14	3482	15	3518	NA	3547	NA	3584	NA
3405	C	3444	13	3483	NA	3519	NA	3548	NA	3585	17
3406		3445	NA	3484	NA	3520	NA	3549	NA	3586	NA
3407	} NA	3446	18	3485	18	3521	18	3550	NA	3587	NA
TO		3447	NA	3486	C	3522	18	3551	NA	3588	NA
3419		3448	NA	3487	17	3523	NA	3552		3589	NA
3420	NA	3449	13	3488	NA	3524	NA	3553		3590	C
3421	NA	3450	C	3489	18	3525	18	3554		3591	C
3422	16	3451	C	3490	C	3526	NA	3555	NA	3592	C
3423	NA	3452	18	3491	17	3527	NA	3556	NA	3593	16
3424	C	3453	13	3492	NA	3528	NA	3557	NA	3594	18
3425	NA	3454	NA	3493	C	3529	NA	3558	16	3595	NA
3426	17	3455	NA	3494	} NA	3530	C	3559		3596	NA
3427	NA	3456	NA	TO		3531	C	3560	NA	3597	18
3428	NA	3457	NA	3503		3532	16	3561	17	3598	NA
3429	NA	3458	C	3504		3533	NA	3562	NA	3599	NA
3430	NA	3459		3505	NA	3534	NA	3563	NA	3600	NA
3431	NA	3460	18	3506	18	3535	NA	3564	NA	3601(A)	} NA
3432	16	3461	NA	3507	18	3536	NA	3565		TO	
3433	C	3462	NA	3508	18	3537		3566		3700(A)	
3434	C	3463	} NA	3509	16	3538		TO	} NA	3701	15
3435	TO			3510	16	3539	NA	3576			3702
3436	NA	3475		3511		3540	C	3577	NA	3703	11
3437		3476		3512	NA	3541	C	3578	NA	3704	NA
3438	NA	3477	C	3513	NA	3542	C	3579	NA	3705	15

‡ Incorporated in initial issue of this schedule.  
 NA Modification/Amendment not applicable to this schedule.  
 C Modification/Amendment cancelled  
 (A) Amendment.  
 (M) Modification.

**MODIFICATION AND AMENDMENT SHEET**  
(Airframe)

Mod. No.	A.L. No.	Mod. No.	A.L. No.	Mod. No.	A.L. No.	Mod. No.	A.L. No.	Mod. No.	A.L. No.	Mod. No.	A.L. No.
3706	NA	3735	18	3764	NA	3793	NA	3822	NA	3851	C
3707	17	3736	18	3765	18	3794	NA	3823	NA	3852	NA
3708	NA	3737	NA	3766	NA	3795	C	3824	NA	3853	NA
3709	C	3738	NA	3767	NA	3796	NA	3825	NA	3854	NA
3710	18	3739	NA	3768	18	3797	NA	3826	NA	3855	17
3711	NA	3740	18	3769	NA	3798	NA	3827	NA	3856	NA
3712	NA	3741	NA	3770	16	3799	NA	3828	NA	3857	NA
3713	C	3742	17	3771	NA	3800	18	3829		3858	NA
3714	13	3743	NA	3772	C	3801	NA	3830	NA	3859	NA
3715	NA	3744	C	3773	18	3802	C	3831	NA	3860	C
3716	NA	3745	NA	3774	NA	3803	C	3832	17	3861	NA
3717	NA	3746	NA	3775	C	3804	C	3833	NA	3862	C
3718	NA	3747	NA	3776	NA	3805	18	3834	NA	3863	NA
3719	NA	3748	C	3777	NA	3806	NA	3835	NA	3864	NA
3720	NA	3749	NA	3778	NA	3807	18	3836	NA	3865	NA
3721	NA	3750	18	3779	NA	3808	NA	3837	NA	3866	NA
3722	18	3751	NA	3780	NA	3809	C	3838	NA	3867	
3723	NA	3752	NA	3781	NA	3810	C	3839	NA	3868	NA
3724	NA	3753	NA	3782	NA	3811	C	3840	NA	3869	NA
3725	NA	3754	NA	3783	NA	3812	C	3841	15	3870	C
3726	17	3755	NA	3784	C	3813	C	3842	18	3871	C
3727	NA	3756	NA	3785	NA	3814	NA	3843	NA	3872	NA
3728	NA	3757	NA	3786	NA	3815	NA	3844	NA	3873	NA
3729	NA	3758	NA	3787	NA	3816	NA	3845	NA	3874	C
3730	NA	3759	18	3788	NA	3817	NA	3846	18	3875	18
3731	18	3760	C	3789	NA	3818	NA	3847	18	3876	NA
3732	NA	3761	18	3790	NA	3819	NA	3848	C	3877	18
3733	NA	3762	C	3791	C	3820	18	3849	18	3878	NA
3734	18	3763	17	3792	NA	3821	NA	3850	NA	3879	NA

‡ Incorporated in initial issue of this schedule  
 NA Modification/Amendment not applicable to this schedule  
 C Modification/Amendment cancelled  
 (A) Amendment  
 (M) Modification

**MODIFICATION AND AMENDMENT SHEET**  
**(Airframe)**

Mod. No.	A.L. No.	Mod. No.	A.L. No.	Mod. No.	A.L. No.	Mod. No.	A.L. No.	Mod. No.	A.L. No.	Mod. No.	A.L. No.
3880	NA	3909	NA	3938	NA	3967	NA	3996	NA	4025	NA
3881	18	3910	NA	3939	NA	3968	NA	3997	NA	4026	NA
3882	NA	3911	17	3940	NA	3969	C	3998	18	4027	NA
3883	18	3912	NA	3941	NA	3970	NA	3999	17	4028	NA
3884	NA	3913	NA	3942	NA	3971	18	4000	NA	4029	NA
3885	NA	3914	NA	3943	NA	3972	C	4001	NA	4030	NA
3886	NA	3915	C	3944	18	3973	C	4002	NA	4031	NA
3887	NA	3916	C	3945	NA	3974	C	4003	18	4032	NA
3888	NA	3917	17	3946	C	3975	18	4004	NA	4033	NA
3889	NA	3918	18	3947	NA	3976	18	4005	18	4034	C
3890	NA	3919	18	3948	NA	3977	C	4006	NA	4035	C
3891	NA	3920	18	3949	NA	3978	NA	4007		4036	NA
3892	NA	3921	NA	3950	C	3979	NA	4008	NA	4037	C
3893	NA	3922	NA	3951	NA	3980	NA	4009	18	4038	NA
3894	NA	3923	NA	3952	NA	3981	NA	4010	18	4039	18
3895	NA	3924	NA	3953	NA	3982	NA	4011	NA	4040	18
3896	NA	3925	C	3954	NA	3983	NA	4012	NA	4041	NA
3897	18	3926	NA	3955	17	3984	NA	4013	NA	4042	NA
3898	NA	3927	NA	3956	NA	3985	NA	4014	C	4043	NA
3899	NA	3928	NA	3957	NA	3986	C	4015	NA	4044	NA
3900	NA	3929	18	3958	NA	3987	C	4016	NA	4045	NA
3901	C	3930	19	3959	NA	3988	C	4017	NA	4046	NA
3902	C	3931	NA	3960	NA	3989	C	4018	NA	4047	17
3903	NA	3932	NA	3961	17	3990	C	4019	NA	4048	NA
3904	NA	3933	NA	3962	NA	3991	C	4020	NA	4049	NA
3905	NA	3934	C	3963	NA	3992	C	4021	18	4050	NA
3906	17	3935	C	3964	NA	3993	C	4022	NA	4051	NA
3907	18	3936	NA	3965	NA	3994	C	4023	NA	4052	NA
3908	NA	3937	17	3966	NA	3995	NA	4024	NA	4053	NA

‡ Incorporated in initial issue of this schedule  
 NA Modification/Amendment not applicable to this schedule  
 C Modification/Amendment cancelled  
 (A) Amendment  
 (M) Modification

**MODIFICATION AND AMENDMENT SHEET**  
**(Airframe)**

Mod. No.	A.L. No.	Mod. No.	A.L. No.	Mod. No.	A.L. No.	Mod. No.	A.L. No.	Mod. No.	A.L. No.	Mod. No.	A.L. No.
4054	NA	4111	NA	4227		4304		4346	NA	4449	NA
4055	18	4112	17	to	NA	to	NA	4347	18	4450	NA
4056	NA	4113		4269		4307		4348	18	4451	19
4057	18	to	NA	4270	17	4308	18	4349	NA	4452	NA
4058		4128		4271	18	4309		4350	18	4453	NA
to	NA	4129	18	4272	NA	to	NA	4351	18	4454	19
4062		4130		4273	NA	4319		4352		4455	NA
4063	18	to	NA	4274	18	4320	18	to	NA	4456	NA
4064		4136		4275		4321		4355		4457	19
to	NA	4137	17	to	NA	to	NA	4356	18	4458	19
4069		4138	17	4278		4324		4357	NA	4459	19
4070	C	4139	18	4279	18	4325	C	4358	C	4460	NA
4071	18	4140		4280	17	4326		4359	18	4461	NA
4072	NA	to	NA	4281		to	NA	4360		4462	19
4073	NA	4151		to	NA	4329		to	NA	4463	
4074	C	4152	18	4285		4330	18	4423		to	NA
4075	NA	4153		4286	17	4331	18	4424	19	4465	
4076	NA	to	NA	4287	18	4332		4425	NA	4466	19
4077	17	4159		4288	18	to	NA	4426	NA	4467	
4078	17	4160	17	4289	NA	4334		4427	19	to	NA
4079	NA	4161	NA	4290	C	4335	18	4428	NA	4488	
4080	18	4162	18	4291		4336		4429	NA	4489	19
4081		4163		to	NA	to	NA	4430		4490	NA
to	NA	to	NA	4299		4340		4431		4491	NA
4106		4222		4300	C	4341	18	to	NA	4492	
4107	18	4223	18	4301	NA	4342	18	4445		4493	
4108	NA	4224	NA	4302	NA	4343	18	4446	19	4494	
4109	18	4225	NA	4303	18	4344	18	4447	NA	4495	
4110	NA	4226	18			4345	NA	4448	19	4496	

‡ Incorporated in initial issue of this schedule  
 NA Modification/Amendment not applicable to this schedule  
 C Modification/Amendment cancelled  
 (A) Amendment  
 (M) Modification



**MODIFICATION AND AMENDMENT SHEET**  
(Armament)

Mod. No.	A.L. No.	Mod. No.	A.L. No.	Mod. No.	A.L. No.	Mod. No.	A.L. No.	Mod. No.	A.L. No.	Mod. No.	A.L. No.
1	NA	29	17	57		85		113		141	
2	NA	30	17	58		86		114		142	
3	NA	31	NA	59		87		115		143	
4	NA	32		60		88		116		144	
5	NA	33	17	61		89		117		145	
6	NA	34	17	62	19	90		118		146	
7	NA	35		63	19	91		119		147	
8	NA	36		64		92		120		148	
9	C	37	NA	65		93		121		149	
10	NA	38	NA	66		94		122		150	
11	NA	39		67		95		123		151	
12	NA	40	NA	68		96		124		152	
13	NA	41	17	69		97		125		153	
14	NA	42	NA	70		98		126		154	
15	C	43		71		99		127		155	
16	NA	44	NA	72		100		128		156	
17	‡	45	NA	73		101		129		157	
18	NA	46	NA	74		102		130		158	
19	NA	47		75		103		131		159	
20		48		76		104		132		160	
21	5	49	NA	77		105		133		161	
22(M)	‡	50		78		106		134		162	
23		51		79		107		135		163	
24	17	52		80		108		136		164	
25	5	53	17	81		109		137		165	
26	17	54		82		110		138		166	
27	5	55		83		111		139		167	
28	NA	56		84		112		140		168	

‡ Incorporated in initial issue of this schedule  
 NA Modification/Amendment not applicable to this schedule  
 C Modification/Amendment cancelled  
 (A) Amendment  
 (M) Modification

--	--	--	--	--	--	--	--	--	--	--	--

--	--	--	--	--	--	--	--	--	--	--	--

--	--	--	--	--	--	--	--	--	--	--	--

--	--	--	--	--	--	--	--	--	--	--	--

This file was downloaded  
from the RTFM Library.

Link: [www.scottbouch.com/rtfm](http://www.scottbouch.com/rtfm)

Please see site for usage terms,  
and more aircraft documents.



LIGHTNING MK. 1  
COVER PITOT HEAD  
EB2-88-511