

RADIO-RADAR RANGING INSTALLATION

Ref. No.	Part No.	Description	No. Off	Material Specification	M.R. Class of Store	Plate No.
	D.225310	<b>RADAR RANGING INSTALLATION, ASSEMBLY</b> (Mod. 414)	-	-		
10D/18533	—	Box, junction ... ..	1	—	A.	
10D/19679	—	Box, junction (Mod. 414) ... ..	1	—	A.	
	F.221149	Bracket, switch (Mod. 414) ... ..	1	L.72	—	
	—	Cable, electrical (see cable chart) ... ..	1	—	—	
1587	F.191915	Clamp, cable, at frame 3 ... ..	2	LFS.21	C.	MA.1
10H/19445	—	Connector, bulkhead, 3-way ... ..	1	—	B.	
10H/19439	—	Connector, bulkhead, 2-way ... ..	1	—	B.	
10H/19451	—	Connector, bulkhead, 4-way ... ..	1	—	B.	
10H/19457	—	Connector, bulkhead, 6-way ... ..	1	—	B.	
10HA/12719	—	Connector, type B6/20B/2 ... ..	1	—	B.	
10HA/12720	—	Connector, type B12/40F/2 ... ..	1	—	B.	
10HA/12709	—	Connector, type B18/20C/3 ... ..	1	—	B.	
10HA/12716	—	Connector, type B18/40F/1 ... ..	1	—	B.	
10HA/12710	—	Connector, type B18/20C/2 ... ..	1	—	B.	
10HA/12711	—	Connector, type B8/10C/1 ... ..	1	—	B.	
10HA/12712	—	Connector, type B4/11C/1 ... ..	1	—	B.	
10HA/12714	—	Connector, type B22/10C/1 ... ..	1	—	B.	
10HA/12718	—	Connector, type B6/21C/1 ... ..	1	—	B.	
10HA/16658	—	Connector, (Mod. 359) ... ..	1	—	B.	
10HA/12715	—	Connector, type B22/50E/12 ... ..	1	—	B.	
10HA/12713	—	Connector, type B4/50F/7 ... ..	1	—	B.	
10HA/16657	—	Connector, (Mod. 359) ... ..	1	—	B.	
10HB/1175	—	Connector, (Mod. 414) ... ..	1	—	B.	
10HB/1176	—	Connector, (Mod. 414) ... ..	1	—	B.	
	C.196025	<b>COOLING SYSTEM, ASSEMBLY</b> ... ..	-	-		
3410	A.192388	Bracket, duct support ... ..	1	DTD.610	MR/C	MA.1
924	Std.1682/12	Clip, pipe coupling ... ..	4	S.3	C.	5
1680	Std.1166/4	Clip, half, attachment of cooling pipe at air intake ... ..	1	S.3	C.	4
5699	Std.1188/10	Clip, pipe coupling ... ..	1	DTD.610	MR/C	4
—	C.196025/1	Connection, at cooling pipes, 1-0" i/d x 1 1/8" o/d x 4-30" long (Make from 32C/376)	1	Petrof & Oil Resisting Rubber	—	
27KD/12	Normalair 504300	Coupling, ground cooling ... ..	1	—	C.	
10B/16395	—	Coupling, R.H., at flexible pipe connection ... ..	2	—	B.	
3772	Std.1306/G25	Hose, pipe connection to ground cooling coupling ... ..	1	DTD.625	MR/C	4
676	A.187146	Pipe, 4-way piece to flexible connection ... ..	1	T.9	C.	MA.1
678	A.185957	Pipe, 4-way piece to ground cooling coupling ... ..	1	T.9	C.	MA.1
1592	A.191858	Pipe, cooling, rubber connection to air intake ... ..	1	—	C.	MA.1
5696	B.205329	Pipe, junction, 4-way piece ... ..	1	—	C.	MA.1
4123	A.198927	Pipe, cooling, rubber connection to inverter ... ..	1	—	C.	MA.1
1715	Std.1744/12	Sleeve, at pipe coupling ... ..	2	Silicone Rubber	C.	5
680	F.185654	Support, for pipe at frame 3 ... ..	2	LFS.21	C.	MA.1

RADIO-RADAR RANGING INSTALLATION

Ref. No.	Part No.	Description					No. Off	Material Specification	M.R. Class of Store	Plate No.
		1	2	3	4	5				
5697	B.205318					Valve, non-return, group	1	—	MR/B	MA.1
	F.194329					Packing	1	DTD.610		
7069	F.212314					Plate, valve group	1	—		MA.1
	F.212314/1					Seating	1	Rubber		
	F.205324					Stud	1	—		MA.1
5785	Std.915/C.16					Washer	1	DTD.610	C.	4
669	F.185406					Pin, pivot	1	DTD.364	C.	MA.1
	A.205319					Shroud	1	—		MA.1
671	F.185336					Spring	1	Bronze Wire	C.	MA.1
	Std.821/15					Washer, at attachment of cooling pipe to inverter	1	L.4 or L.34	MR/C	4
5L/X951273	—					Filament, lamp, 28v. 3-5w.	1	—	B.	
5CZ/880	—					Fuse, 5 amp (Mod. 359)	1	—	C.	
8197	A.210733					Fuseholder, screen, group (Mod. 359)	1	—	MR/C	MA.1
	A.210735					Box	1	L.59		
5CZ/3741	—					Fuseholder, type A	1	—	B.	
7015	A.210734					Lid	1	L.59	C.	MA.1
10H/Z.560230	Plessey CZ.49217					Socket, panel	2	—	C.	
10H/Z.970049	Plessey Z.54105					Washer, panel mounting	2	—	C.	
	F.223942					Guard, switch (Mod. 414)	1	Nylon		
4121	F.200057					Handle, target rejector switch	1	Rubber	C.	MA.1
5UB/5083	—					Inverter, type 200	1	—	A.	
	F.211197					Label, fuse (Mod. 359)	1	L.59		
5CX/1644	—					Light, indicating	1	—	A.	
	C.223028					<b>MOUNTING, RADAR UNITS, ASSEMBLY</b> (Mod. 624)	—	—		
1588	F.181900					Angle, bracing strut attachment to side beam	2	DTD.610	C.	MA.1
	F.200945					Angle, for cross member	1	L.72		
	F.200946					Angle, for cross member	1	L.72		
	F.200947					Angle, for cross member	1	L.72		
	F.200948					Angle, for cross member	1	L.72		
6789	C.181894					Beam, mounting, port	1	DTD.610	MR/C	MA.1
6790	C.181895					Beam, mounting, starboard	1	DTD.610	MR/C	MA.1
660	F.183841					Bolt, pivot, for mounting tray	2	S.61.B	C.	MA.1
661	A.183664					Bracket, stop, port	1	S.3	C.	MA.1
658	A.183665					Bracket, stop, starboard	1	S.3	C.	MA.1
1589	A.181898					Bracket, channel, bracing strut attachment to side beam, port	1	DTD.610	C.	MA.1
	B.213059					Bracket, at front cross member (Mod. 413)	1	L.72		
1590	A.181899					Bracket, channel, bracing strut attachment to side beam, starboard	1	DTD.610	C.	MA.1
9101	—					Catch, radar head, unit attachment, group (C.221872, C.223028)	2	—	B.	
	A.222846					Consisting of:—				
	RID.1004/3					Button	1	—		
	RID.1004/4					Nut	1	—		
	RID.1004/1					Spring	1	—		
	RID.1004/2					Stud	1	—		
						Washer	1	—		

**RADAR-RADIO RANGING INSTALLATION**

Ref. No.	Part No.	Description	No. Off					Material Specification	M.R. Class of Store	Plate No.	
			1	2	3	4	5				
	B.183311	Channel, mounting of camera gun ... ..						1	DTD.610		
	A.213097	Channel, for diagonal strut (Mod. 413) ... ..						1	—		
752	Std.1166/8	Clip, half, for support clip at 4-way piece ... ..						1	S.3	C.	4
656	A.185955	Clip, support, at 4-way piece ... ..						1	S.3	C.	MA.1
	B.200943	Cross member ... ..						1	L.72		
	B.200944	Cross member ... ..						1	L.72		
6791	B.181896	Cross member ... ..						1	DTD.610	MR/C	MA.1
14A/1042	—	Mounting, for camera, type 27 ... ..						1	—	A.	
2703	F.183512	Packing, bracing strut attachment to side beam, port						1	DTD.610	MR/C	MA.1
2704	F.183513	Packing, bracing strut attachment to side beam, starboard						1	DTD.610	MR/C	MA.1
9102	F.220373	Plug, end (Mod. 624) ... ..						2	L.65.C	C.	MA.1
2705	F.181902	Shim, at attachment of channel, frame 3 ... ..						2	DTD.610	MR/C	MA.1
9100	A.221873	Strut, bracing (Mod. 624) ... ..						2	L.62	C.	MA.1
	A.213102	Strut, diagonal (Mod. 413) ... ..						1	—		
9099	C.221872	Tray, mounting, group (Mod. 624) ... ..						1	—	B.	MA.1
	A.183662	Bracket, latch, port ... ..						1	DTD.610		
	A.183663	Bracket, latch, starboard ... ..						1	DTD.610		
9101	—	Catch, mounting, group (C.221872, C.223028) Consisting of :—						2	—	B.	
	A.222846	Button ... ..						1	—		
	RID.1004/3	Nut ... ..						1	—		
	RID.1004/4	Spring ... ..						1	—		
	RID.1004/1	Stud ... ..						1	—		
	RID.1004/2	Washer ... ..						1	—		
663	F.183670	Collar, catch pin retaining ... ..						2	S.1	C.	MA.1
664	F.183668	Pin, catch ... ..						2	S.62.B	C.	MA.1
	F.220374	Plate, spigot (Mod. 624) ... ..						2	—	MR/C	MA.1
1327	Std.1547/24/12	Packing, at spigot plate attachment ... ..						4	DTD.610	C.	4
665	F.186750	Spring, catch pin ... ..						2	Sp. St.	C.	MA.1
3804	Std.1509/2/068	Tube, distance, 1/4" o/d x 22 S.W.G. x 0.68" long						4	T.4	MR/C	4
	Std.1510/2/038	Tube, distance at diagonal strut (Mod. 413) ... ..						2	T.4		4
1327	Std.1547/24/12	Washer, packing ... ..						4	DTD.610	C.	4
673	Std.1547/28/10	Washer, profile ... ..						8	DTD.610	C.	4
675	F.186124	Washer, at attachment of support clip to side beam						2	DTD.610	C.	
2789	Std.914/G/20	Washer, at attachment of channel, frame 3 ... ..						2	DTD.610	C.	4
5244	F.206012	Plate, mounting, for "locked on" light ... ..						1	L.72	C.	MA.1
3411	A.188919	Plate, adaptor, at inverter ... ..						1	—	MR/C	MA.1
8548	F.219178	Plate, nut (Mod. 572) ... ..						2	—	C.	MA.1
10H/18893	—	Plug, shorting, Mk. 4, 18-way ... ..						1	—	B.	
10H/18892	—	Plug, shorting, Mk. 4, 12-way ... ..						1	—	B.	
10D/18554	—	Radar-Head, type 2 ... ..						1	—	A.	
3838	Std.1606/44/B8	Screw ... ..						2	Brass	C.	
3413	F.192842	Spacer, at inverter ... ..						10	DTD.610	MR/C	MA.1
5F/2282	Hellermann NY.3342	Stud, at cable strapping ... ..						QR	—	C.	
5F/2280	Hellerman HV.3255	Stud, at cable strapping ... ..						QR	—	C.	
5F/2301	Hellerman NY.18007	Strapping, cable 1/2" wide ... ..						QR	—	C.	
5F/2279	Hellerman HV.3254	Strapping, cable 5/8" wide ... ..						QR	—	C.	

RADIO-RADAR RANGING INSTALLATION

Ref. No.	Part No.	Description					No. Off	Material Specification	M.R. Class of Store	Plate No.
		1	2	3	4	5				
5CW/4178	—						1	—	B.	
5CW/5043	N.S.F. Ltd. 8372/B.3						1	—	A.	
5CW/4346	—						1	—	C.	
5CW/4347	—						1	—	C.	
	Std.1509/23/024						1	T.4		
10Q/16076	—						1	—	A.	
10A/17930	—						4	—	C.	
10H/Z.970050	—						1	—	—	
10H/Z.970051	—						1	—	C.	

RADIO-RADAR RANGING INSTALLATION

Ref. No.	Part No.	Description					No. Off	Material Specification	M.R. Class of Score	Plate No.
		1	2	3	4	5				
<b>SUMMARY OF STOCK ITEMS</b>										
28D/13868	A25.1B	Bolt, 4	B.A.	...	...	...	...	...	...	...
28D/12512	A25.1C	Bolt, 2	B.A.	...	...	...	...	...	...	...
28D/12513	A25.2C	Bolt, 2	B.A.	...	...	...	...	...	...	...
28D/12531	A25.3C	Bolt, 2	B.A.	...	...	...	...	...	...	...
28D/12533	A25.5C	Bolt, 2	B.A.	...	...	...	...	...	...	...
28D/12566	A25.6C	Bolt, 2	B.A.	...	...	...	...	...	...	...
28D/12629	A25.8C	Bolt, 2	B.A.	...	...	...	...	...	...	...
28D/12515	A25.10C	Bolt, 2	B.A.	...	...	...	...	...	...	...
28D/12516	A25.11C	Bolt, 2	B.A.	...	...	...	...	...	...	...
28D/8306	AS.1242/1C	Bolt, 2	B.A.	...	...	...	...	...	...	...
28D/8308	AS.1242/3C	Bolt, 2	B.A.	...	...	...	...	...	...	...
28D/12707	A25.1E	Bolt, 1/4"	B.S.F.	...	...	...	...	...	...	...
28D/12519	A25.3E	Bolt, 1/4"	B.S.F.	...	...	...	...	...	...	...
27E/8185	AGS.605/Mk. 3	Clip, jubilee	...	...	...	...	...	...	...	...
28E/8183	AGS.1000/1	Clip, hose	...	...	...	...	...	...	...	...
5K/119	AGS.1661/H	Clip, bonding	...	...	...	...	...	...	...	...
5K/121	AGS.1661/K	Clip, bonding	...	...	...	...	...	...	...	...
5K/3355	AS.3360.B4B	Lead, bonding	...	...	...	...	...	...	...	...
5K/3371	AS.3360.B4C	Lead, bonding	...	...	...	...	...	...	...	...
5K/3373	AS.3360.B5B	Lead, bonding	...	...	...	...	...	...	...	...
5K/3372	AS.3360.B5C	Lead, bonding	...	...	...	...	...	...	...	...
5K/3394	AS.3360.B6B	Lead, bonding	...	...	...	...	...	...	...	...
28M/12929	A27.C.P.	Nut, 2	B.A.	...	...	...	...	...	...	...
28M/10328	AGS.2002/C1	Nut, 2	B.A.	...	...	...	...	...	...	...
28M/12930	A27.E.S.	Nut, 1/4"	B.S.F.	...	...	...	...	...	...	...
28M/10290	AGS.2001/E1	Nut, 1/4"	B.S.F.	...	...	...	...	...	...	...
28M/10288	AGS.2001/C1	Nut, 2	B.A.	...	...	...	...	...	...	...
28M/10328	AGS.2002.C1	Nut, 2	B.A.	...	...	...	...	...	...	...
28M/10330	AGS.2002.E1	Nut, 1/4"	B.S.F.	...	...	...	...	...	...	...
28W/12305	SP.13B	Washer, 4	B.A.	...	...	...	...	...	...	...
28W/12296	SP.15C	Washer, 2	B.A.	...	...	...	...	...	...	...
28W/12355	SP.16C	Washer, 2	B.A.	...	...	...	...	...	...	...
28W/12496	SP.15E	Washer, 1/4"	B.S.F.	...	...	...	...	...	...	...
28W/12297	SP.16E	Washer, 1/4"	B.S.F.	...	...	...	...	...	...	...

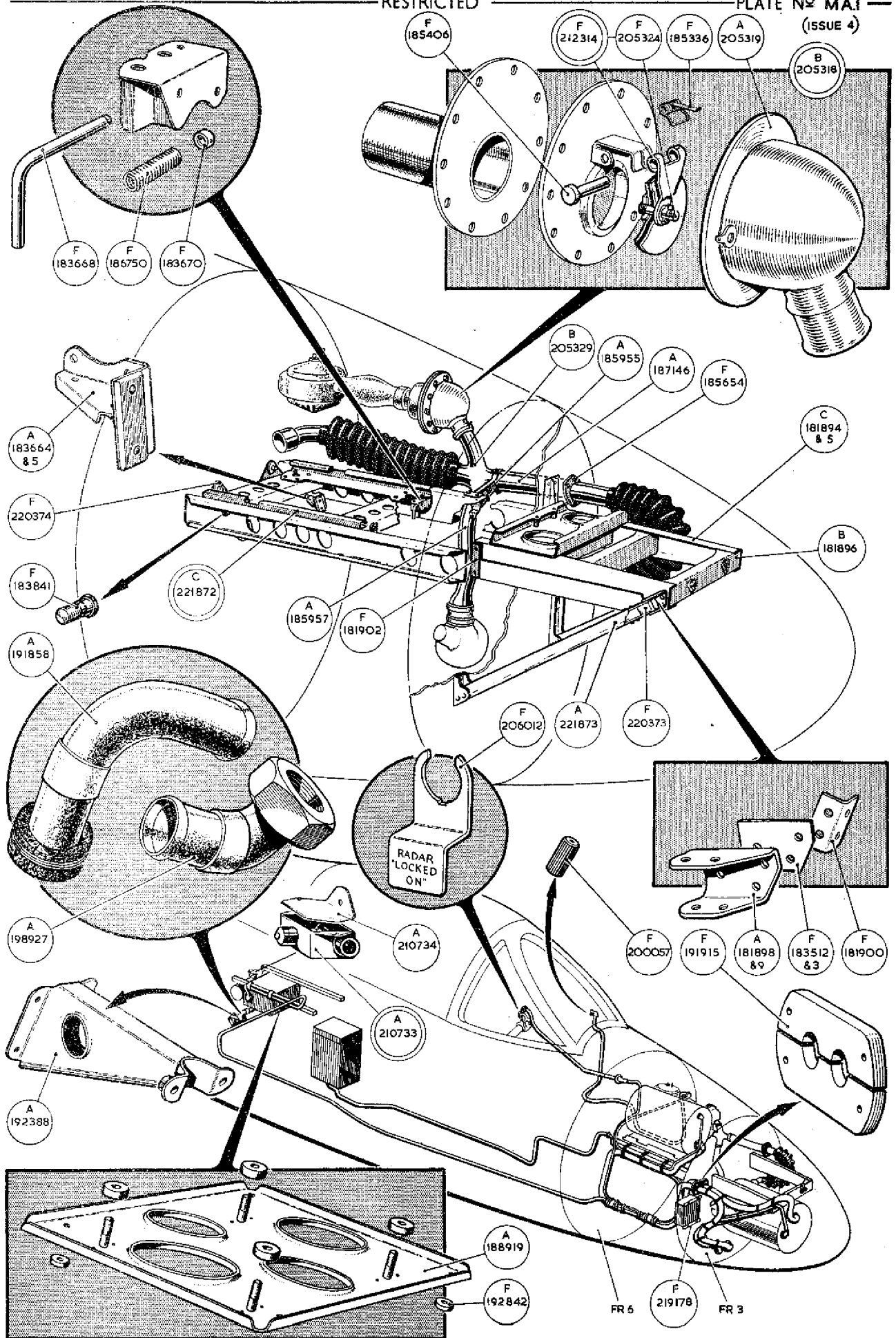



This file was downloaded  
from the RTFM Library.

Link: [www.scottbouch.com/rtfm](http://www.scottbouch.com/rtfm)

Please see site for usage terms,  
and more aircraft documents.