

SERVICES—HYDRAULICS IN WINGS

Ref. No.	Part No.	Description	No. Off					Material Specification	M.R. Class of Store	Plate No.
			1	2	3	4	5			
	E.200037-8	HYDRAULIC EQUIPMENT IN WINGS, ASSEMBLY					-	-	-	
27Q/1540	Dowty C.8394Y	Accumulator unit (Mod. 416)	1					A.		
27Q/1471	Dowty C.8294Y	Accumulator unit (Pre Mod. 416)	1					A.		
1929	F.180037	Adaptor, bleed screws	2				DTD.364	C.	NH.1	
1930	F.196234*	Adaptor, 1/8" cone to 1/2" hose (Pre Mod. 197) ...	2					C.	NH.1	
1931	F.144413	Adaptor, 3/8" cone to 1/2" hose	2				L.1	C.	NH.1	
4582	F.201231	Adaptor, bleed screw	2					C.	NH.1	
2082	F.196060	Block, clamp, at interspar ribs "A" and "C" ...	5				LFS.21	C.		
2094	F.196061	Block, clamp, at interspar rib "A"	1				LFS.21	C.		
2052	F.194338	Block, clamp, on sub spar, front spar, undercarriage girder and ribs "C," "D," and "E"	21				LFS.21	C.		
2053	F.194339	Block, clamp, on sub spar and ribs "D," "E" and "F1"	13				LFS.21	C.		
3901	F.194724	Block, clamp, on bottom skin, port	2				LFS.21	C.		
3903	F.194874	Block, clamp, on port interspar rib "A"	2				LFS.21	C.		
3904	F.196078	Block, clamp, on port interspar rib "B"	1				LFS.21	C.		
3905	F.196092	Block, clamp, on port interspar rib "E" and starboard front spar	5				LFS.21	C.		
3906	F.196069	Block, clamp, on interspar rib "D"	1				LFS.21	C.		
3907	F.196070	Block, clamp, on port interspar rib "D"	1				LFS.21	C.		
3908	F.196071*	Block, clamp, on port interspar rib "D" (Pre Mod. 197)	1				LFS.21	C.		
3909	F.196072*	Block, clamp, on port interspar rib "D" (Pre Mod. 197)	1				LFS.21	C.		
2083	F.196073	Block, clamp, on interspar rib "D" and u/c girder ...	5				LFS.21	C.		
3910	F.196081	Block, clamp, on port interspar rib "C"	2				LFS.21	C.		
3911	F.196082*	Block, clamp, on port interspar rib "E" (Pre Mod. 197)	2				LFS.21	C.		
3913	F.195831	Block, clamp, on top skin	2				LFS.21	C.		
3914	F.196066	Block, clamp, on starboard interspar rib "A" ...	2				LFS.21	C.		
3915	F.194932	Block, clamp, on starboard interspar rib "C" ...	2				LFS.21	C.		
3916	F.196094	Block, clamp, on starboard interspar rib "C" ...	2				LFS.21	C.		
3917	F.196067	Block, clamp, on starboard interspar rib "D" ...	2				LFS.21	C.		
2079	F.196064	Block, clamp, on sub spars and rib "D"	10				LFS.21	C.		
5136	A.199970	Block, clamp, on port rib "S"	1				LFS.21	C.		
5137	A.199971	Block, clamp, on starboard rib "S"	1				LFS.21	C.		
3919	F.196068	Block, clamp, on front spar	1				LFS.21	C.		
3920	F.196093	Block, clamp, on bottom skin	2				LFS.21	C.		
2080	F.196074	Block, clamp, on front spar	1				LFS.21	C.		
2084	F.196075*	Block, clamp, on st'bd interspar rib "E" (Pre Mod. 197)	2				LFS.21	C.		
5138	F.203159*	Block, clamp, on interspar rib "F" (Pre Mod. 197)	2				LFS.21	C.		
4585	F.202581	Block, clamp, on inboard diaphragm	2				LFS.21	C.		
4586	F.202582	Block, clamp, on inboard diaphragm	2				LFS.21	C.		
5139	F.203396	Block, clamp, on port interspar rib "A"	2				LFS.21	C.		
5140	F.204355	Block, clamp, on port interspar rib "A"	1				LFS.21	C.		
5141	F.204356	Block, clamp, on port interspar rib "A"	1				LFS.21	C.		
4877	F.203780	Block, clamp, on port interspar rib "D" (Pre Mod. 510)	1				LFS.21	C.		
4878	F.203781	Block, clamp, on port interspar rib "D" (Pre Mod. 510)	1				LFS.21	C.		
5142	F.204833	Block, clamp, on port interspar rib "E"	1				LFS.21	C.		
5143	F.204834	Block, clamp, on port interspar rib "E"	1				LFS.21	C.		
5144	F.205014	Block, clamp, on port interspar rib "E"	4				LFS.21	C.		
5145	F.205189	Block, clamp, on port interspar rib "D"	2				LFS.21	C.		
5146	F.204830	Block, clamp, on port interspar rib "B"	1				LFS.21	C.		
5147	F.204831	Block, clamp, on port interspar rib "B"	1				LFS.21	C.		
5148	F.204868	Block, clamp, between interspar ribs "M" and "L"	2				LFS.21	C.		
4583	F.202489	Block, clamp, on port interspar rib "F1"	1				LFS.21	C.		
2081	F.195583	Block, clamp, on interspar rib "D"	2				LFS.21	C.		
2072	F.193854	Block, clamp, on interspar rib "F" (Mod. 197) ...	2				LFS.21	C.		
8301	F.206023	Block, clamp, on interspar rib "E" (Mod. 197) ...	2				LFS.21	C.		
8302	F.206022	Block, clamp, on interspar rib "E" (Mod. 197) ...	2				LFS.21	C.		
8305	F.215471	Block, clamp, on interspar rib "D" (Mod. 197) ...	1				LFS.21	C.		
8306	F.215472	Block, clamp, on interspar rib "D" (Mod. 197) ...	1				LFS.21	C.		
8309	F.215478	Block, clamp, on interspar rib "F" (Mod. 197) ...	2				LFS.21	C.		
8310	F.217880	Block, clamp, on interspar rib "E" (Mod. 197) ...	1				LFS.21	C.		
8364	F.216872	Block, clamp, on interspar rib "D" (Mod. 510) ...	2				LFS.21	C.		

SERVICES—HYDRAULICS IN WINGS

Ref. No.	Part No.	Description	No. Off					Material Specification	M.R. Class of Store	Place No.
			1	2	3	4	5			
4584	F.202490	Block, clamp, on port interspar rib "F1" ...						LFS.21	C.	
5149	F.204957	Block, clamp, on top skin ...						LFS.21	C.	
5150	F.205916	Block, clamp, on top skin ...						LFS.21	C.	
5151	F.204687	Block, clamp, on undercarriage girder ...						LFS.21	C.	
5152	F.204867	Block, clamp, on undercarriage girder ...						LFS.21	C.	
4875	F.203778	Block, clamp, on st'bd interspar rib "D" (Pre Mod. 510)						LFS.21	C.	
4876	F.203779	Block, clamp, on st'bd interspar rib "D" (Pre Mod. 510)						LFS.21	C.	
	F.214114	Block, clamp, on starboard interspar rib "D" ...						LFS.21	C.	
5154	F.204869	Block, clamp, on starboard interspar rib "E" ...						LFS.21	C.	
8363	F.216870	Block, clamp, on interspar rib "D" (Mod. 510) ...						LFS.21	C.	
8085	F.214887	Block, clamp, for air pipe (Mod. 330) ...						LFS.21	C.	
5478	Std.1639/16/CX	Bolt, for clamp block on front spar ...						S.95	MR/C	
	B.190650-1	CLIPS AND PIPES ON UNDERCARRIAGE LEGS, ASSEMBLY (Pre Mod. 197)								
5236	F.203197	Clamp ...						LFS.21	C.	NH.1
4909	A.202676	Clip, guide, port ...						S.3	C.	NH.1
4910	A.202677	Clip, guide, starboard ...						S.3	C.	NH.1
5235	A.203196	Clip, for clamp ...						S.3	C.	NH.1
5479	F.203959	Bracket, for clamp blocks on rib "C" ...						L.72	MR/C	NH.1
5155	B.201084	Bracket, mounting, for accumulator on st'bd rib "F"						S.3	C.	NH.1
	A.205865	Channel, on rib "S" ...								
4873	F.201509	Clamp, supporting pipe on tail rib "G" ...						S.3	MR/C	NH.1
1047	F.187998	Clip, shuttle valve attachment, rib "D," starboard						S.3	C.	NH.1
1048	F.188356	Clip, shuttle valve attachment on interspar rib "F," port						S.3	C.	NH.1
1883	F.193723	Clip, for throttling valve ...						S.3	C.	NH.1
5156	A.201085	Clip, half, for accumulator mounting ...						S.3	C.	NH.1
4146	F.193863	Clip, for reducing valve ...						S.84	C.	NE.1
	F.217579	Clip, for air pipe on interspar rib "D" (Mod. 510)						L.72	L.M.	
3734	Std.840/14	Clip, for earthing connector on ribs "A," "C" and "E"						DTD.610	C.	4
	Std.842/15	Clip, $\frac{7}{16}$ " wide x 22 S.W.G. x 1-5" long ...						S.3		
3752	Std.842/16	Clip, supporting pipe on rib "D" (Make from 30A/549)						S.3	MR/C	4
	Std.850/32	Clip, securing pipes between ribs "A" and "B" ...						DTD.610		
5481	F.204992	Clip, supporting pipe on undercarriage girder ...						S.3	MR/C	NH.1
	C.223630	DETAILS OF EQUIPMENT, ASSEMBLY ...								
	A.215212	Bracket, mounting for filter unit ...								
9421	F.215214	Clip, attachment of filter unit ...							C.	
27KC/1547	Fairey FHS.1211Z	Filter, unit (For spares see AP.4515P, Vol. 3)							A.	
6A/2693	—	Gauge, pressure Mk. 14LL (Mod. 330) ...							A.	
27M/9889	Auto Prod. AVA.322/22-5/A	Hose, flexible, $\frac{1}{4}$ ", at aileron booster ...							C.	
28M/10607	Auto Prod. AVA.322/22-5/B	Hose, flexible, $\frac{1}{4}$ ", at aileron booster ...							C.	
27VA/3807	Dunlop DC/101/A/27*	Hose, flexible, $\frac{1}{8}$ ", at top of undercarriage leg (Pre Mod. 197)							C.	
27VA/4559	Dunlop DC/112/A/27*	Hose, flexible, $\frac{1}{8}$ ", at top of undercarriage leg (Pre Mod. 197)							C.	
27Q/	Dowty 07965/P/CO.1	Jack, undercarriage, port ...							A.	
27Q/	Dowty 07965/S/CO.1	Jack, undercarriage, starboard ...							A.	
27Q/1232	Dowty C.7581Y	Jack, flap ...							A.	
27Q/1230	Dowty C.7390Y Mk.A	Jack, flap synchronising, port ...							A.	
27Q/1231	Dowty C.7390Y Mk.B	Jack, flap synchronising starboard ...							A.	

SERVICES—HYDRAULICS IN WINGS

Ref. No.	Part No.	Description					No. Off	Material Specification	M.R. Class of Store	Plate No.
		1	2	3	4	5				
6A/2771	—						1	—		
2144	Std.1231/3						1	S.3	C.	4
1394	Std.1547/24/14						1	DTD.610	C.	4
2030	C.189160/2						1	DTD.323	C.	
2034	C.189160/12						1	DTD.323	C.	
†	C.189160/26						1	DTD.323	—	
†	C.189160/29						1	DTD.323	—	
†	C.189160/30						1	DTD.323	—	
3702	C.189160/32*						1	DTD.323	C.	
†	C.189160/36						1	DTD.323	—	
2040	C.189160/37						1	DTD.323	C.	
2041	C.189160/42						1	DTD.323	C.	
2042	C.189160/43						1	DTD.323	C.	
†	C.189160/44						1	DTD.323	—	
2043	C.189160/45						1	DTD.323	C.	
†	C.189160/46						1	DTD.323	—	
2045	C.189160/48						1	DTD.323	C.	
†	C.189160/49						1	DTD.323	—	
†	C.189160/50						1	DTD.323	—	
2047	C.189160/52						1	DTD.323	C.	
†	C.189160/53						1	DTD.323	—	
†	C.189160/58						1	DTD.323	—	
†	C.189160/61						1	DTD.323	—	
4477	C.189160/71						1	DTD.323	C.	
†	C.189160/79						1	DTD.323	—	
†	C.189160/83						1	DTD.323	—	
†	C.189160/84						1	DTD.323	—	
†	C.189160/85						1	DTD.323	—	
†	C.189160/86						1	DTD.323	—	
5427	C.189160/87						1	DTD.323	MR/C	
5292	C.189160/88						1	DTD.323	C.	
†	C.189160/89						1	DTD.323	—	
5293	C.189160/90						1	DTD.323	C.	
†	C.189160/91						1	DTD.323	—	
5294	C.189160/92						1	DTD.323	C.	
†	C.189160/93						1	DTD.323	—	
†	C.189160/94						1	DTD.323	—	
†	C.189160/95						1	DTD.323	—	
5295	C.189160/96						1	DTD.323	C.	
5296	C.189160/97						1	DTD.323	C.	
	C.189160/98						1	DTD.323	—	
	C.189160/99						1	DTD.323	—	
4569	C.189160/107						1	DTD.323	C.	
4562	C.189160/108						1	DTD.323	C.	
4567	C.189160/110						1	DTD.323	C.	
4570	C.189160/112						1	DTD.323	C.	

† For details see Piping Chart

SERVICES—HYDRAULICS IN WINGS

Ref. No.	Part No.	Description					No. Off	Material Specification	M.R. Class of Store	Plate No.
		1	2	3	4	5				
5297	C.189160/117*	Pipe, wheel brake torsion link to "Maxaret" unit (Pre Mod. 197)					1	DTD.323	C.	
†	C.198160/118*	Pipe, return, torsion link to flexible hose (Pre Mod. 197)					1	DTD.323	—	
†	C.189160/119*	Pipe, return, flexible hose to 4-way piece (Pre Mod. 197)					1	DTD.323	—	
4566	C.189160/123	Pipe, flap balancing, union to flap down connection					1	DTD.323	C.	
5237	C.189160/126	Pipe, flap balancing, union to union					1	DTD.323	C.	
5238	C.189160/127	Pipe, flap balancing, selector to union					1	DTD.323	C.	
5239	C.189160/128	Pipe, flap balancing, tee piece to union					1	DTD.323	C.	
5299	C.189160/142	Pipe, undercarriage down, 4-way piece to undercarriage jack					1	DTD.323	C.	
5302	C.189160/147	Pipe, undercarriage down, union to 4-way piece ...					1	DTD.323	C.	
5304	C.189160/149	Pipe, undercarriage air, non-return valve to 4-way piece					1	DTD.323	C.	
5305	C.189160/150	Pipe, undercarriage down, 4-way piece to union ...					1	DTD.323	C.	
5306	C.189160/151	Pipe, undercarriage down, union to jettison valve ...					1	DTD.323	C.	
†	C.189160/152	Pipe, undercarriage up, tee piece to thermal relief valve					1	DTD.323	—	
5308	C.189160/155	Pipe, undercarriage up, tee piece to jettison valve ...					1	DTD.323	C.	
†	C.189160/156	Pipe, undercarriage up, tee piece to union (Pre Mod. 579)					1	DTD.323	—	
†	C.189160/159	Pipe, undercarriage air, pressure release valve to non-return valve					1	DTD.323	—	
†	C.189160/160	Pipe, undercarriage air, pressure release valve to union					1	DTD.323	—	
†	C.189160/161	Pipe, undercarriage air, union to union					1	DTD.323	—	
†	C.189160/163	Pipe, undercarriage up, union to elbow					1	DTD.323	—	
†	C.189160/165	Pipe, flap air, union to union					1	DTD.323	—	
5310	C.189160/167	Pipe, flap down, union to union					1	DTD.323	C.	
†	C.189160/168	Pipe, undercarriage up, jettison valve to tee piece ...					1	DTD.323	—	
5311	C.189160/169	Pipe, flap down, bleed adaptor to flap jack					1	DTD.323	C.	
5312	C.189160/170	Pipe, flap up, bleed adaptor to flap jack					1	DTD.323	C.	
5313	C.189160/171	Pipe, pressure, union to flap control valve					1	DTD.323	C.	
5314	C.189160/182	Pipe, flap air, jettison valve to union					1	DTD.323	C.	
†	C.189160/183	Pipe, flap air, union to atmosphere					1	DTD.323	—	
5219	C.189160/184	Pipe, undercarriage up, restrictor valve to undercarriage jack					1	DTD.323	C.	
†	C.189160/192*	Pipe, flexible, wheel brake, port wing, union to union (Pre Mod. 197)					1	DTD.323	—	
5286	C.189160/193	Pipe, flap down, port wing, flap control valve to pressure relief valve					1	DTD.323	C.	
†	C.189160/194	Pipe, flap air, port wing, union to fluid jettison valve					1	DTD.323	—	
5287	C.189160/195	Pipe, flap air, port wing, fluid jettison valve to shuttle valve (Pre Mod. 510)					1	DTD.323	C.	
†	C.189160/196	Pipe, flap balancing, port wing break, union to union					1	DTD.323	—	
†	C.189160/197	Pipe, flap down, tee piece to union					1	DTD.323	—	
5288	C.189160/198	Pipe, flap balance, port wing break, union to tee piece					1	DTD.323	C.	
†	C.189160/199	Pipe, flap balance, union to port wing break... ..					1	DTD.323	—	
5289	C.189160/200	Pipe, undercarriage up, tee piece to sequence valve					1	DTD.323	C.	
7109†	C.189160/211*	Pipe, return, torsion link to Maxaret unit (Pre Mod. 197)					1	DTD.323	MR/C	
8202†	C.189160/214	Pipe, return, port wing, tee piece to tee piece (Mod. 265)					1	DTD.323	MR/C	

† For details see Piping Chart

SERVICES—HYDRAULICS IN WINGS

Ref. No.	Part No.	Description					No. Off	Material Specification	M.R. Class of Store	Plate No.
		1	2	3	4	5				
8203†	C.189160/215					Pipe, return, tee piece to flap pressure relief valve ... (Mod. 265)	1	DTD.323	MR/C	
8204†	C.189160/216					Pipe, return, tee piece to tee piece (Mod. 265) ...	1	DTD.323	MR/C	
8205†	C.189160/217					Pipe, return, tee piece to flap selector valve (Mod. 265)	1	DTD.323	MR/C	
8206†	C.189160/218					Pipe, return, 4-way piece to tee piece (Mod. 265) ...	1	DTD.323	MR/C	
	C.189160/220					Pipe, wheel brake, leg pivot (B) to adaptor (Mod 197)	1	DTD.323	—	
	C.189160/221					Pipe, recuperator, leg pivot (C) to union (Mod. 197)	1	DTD.323	—	
	C.189160/222					Pipe, recuperator, union to union (Mod. 197) ...	1	DTD.323	—	
	C.189160/224					Pipe, wheel brake, leg pivot (A) to 4-way piece (Mod. 197)	1	DTD.323	—	
8365	C.189160/229					Pipe, flap, air, fluid jettison valve to shuttle valve (Mod. 510)	1	DTD.323	C.	
9087	C.189160/231					Pipe, undercarriage up, P.R.V. to union (Mod. 579) ...	1	DTD.323	C.	
9088	C.189160/232					Pipe, undercarriage up, union to union (Mod. 579) ...	1	DTD.323	C.	
9085	C.189160/233					Pipe, pressure, union to P.R.V. (Mod. 579) ...	1	DTD.323	C.	
9086	C.189160/234					Pipe, pressure, P.R.V. to union (Mod. 579) ...	1	DTD.323	C.	
9089	C.189160/238					Pipe, undercarriage up, tee-piece to union (Mod. 579)	1	DTD.323	C.	
†	C.189161/2					Pipe, pressure, starboard wing, union to union ...	1	DTD.323	—	
3417	C.189161/3					Pipe, pressure, starboard wing, union to pressure regulating valve	1	DTD.323	C.	
3418	C.189161/4					Pipe, pressure, starboard wing, pressure regulating valve to undercarriage control valve	1	DTD.323	C.	
3419	C.189161/5					Pipe, pressure, starboard wing, pressure regulating valve to union	1	DTD.323	C.	
†	C.189161/13					Pipe, return, starboard wing, tee piece to tee piece	1	DTD.323	—	
3428	C.189161/14					Pipe, return, starboard wing, tee piece to undercarriage control valve	1	DTD.323	C.	
3430	C.189161/16					Pipe, return, starboard wing, tee piece to thermal relief valve	1	DTD.323	C.	
†	C.189161/17					Pipe, return, starboard wing, tee piece to thermal relief valve	1	DTD.323	—	
3435	C.189161/21					Pipe, return, starboard wing, tee piece to tee piece	1	DTD.323	C.	
3436	C.189161/22					Pipe, return, starboard wing, tee piece to aileron control valve	1	DTD.323	C.	
3443	C.189161/29					Pipe, undercarriage up, starboard wing, undercarriage control valve to 4-way piece	1	DTD.323	C.	
3445	C.189161/31					Pipe, undercarriage up, starboard wing, 4-way piece to tee piece	1	DTD.323	C.	
†	C.189161/32					Pipe, undercarriage up, starboard wing, tee piece to union	1	DTD.323	—	
†	C.189161/34					Pipe, undercarriage up, starboard wing, 4-way piece to tee piece	1	DTD.323	—	
†	C.189161/47					Pipe, undercarriage down, starboard wing, shuttle valve to union	1	DTD.323	—	
†	C.189161/48					Pipe, undercarriage down, union to starboard wing break	1	DTD.323	—	
†	C.189161/52					Pipe, undercarriage down, starboard wing, union to union	1	DTD.323	—	
†	C.189161/54					Pipe, undercarriage down, starboard wing, tee piece to thermal relief valve	1	DTD.323	—	
†	C.189161/60*					Pipe, wheel brake, starboard wing, union to union (Pre Mod. 197)	1	DTD.323	—	

† For details see Piping Chart

SERVICES—HYDRAULICS IN WINGS

Ref. No.	Part No.	Description	No. Off	Material Specification	M.R. Class of Store	Plate No.
3476	C.189161/62*	Pipe, wheel brake, starboard wing, flexible hose to torsion link (Pre Mod. 197)	1	DTD.323	C.	
3486	C.189161/72	Pipe, flap up, starboard wing break to union ...	1	DTD.323	C.	
3487	C.189161/73	Pipe, flap up, starboard wing, union to bleed adaptor	1	DTD.323	C.	
†	C.189161/75	Pipe, flap down, starboard wing break to union ...	1	DTD.323	—	
3490	C.189161/76	Pipe, flap down, starboard wing, union to bleed adaptor	1	DTD.323	C.	
3494	C.189161/80	Pipe, flap balance, starboard wing break to union ...	1	DTD.323	C.	
†	C.189161/97	Pipe, undercarriage up, tee piece to restrictor valve	1	DTD.323	—	
5317	C.189161/98	Pipe, undercarriage up, tee piece to thermal relief valve	1	DTD.323	C.	
†	C.189161/99	Pipe, return, thermal relief valve to tee piece... ..	1	DTD.323	—	
5318	C.189161/100	Pipe, return, tee piece to tee piece	1	DTD.323	C.	
5319	C.189161/101	Pipe, return, tee piece to tee piece	1	DTD.323	C.	
†	C.189161/103	Pipe, undercarriage up, union to union	1	DTD.323	—	
5320	C.189161/104	Pipe, undercarriage up, sequence valve to pressure regulator valve	1	DTD.323	C.	
5321	C.189161/105	Pipe, undercarriage up, pressure regulator valve to union	1	DTD.323	C.	
†	C.189161/106	Pipe, undercarriage up, union to union	1	DTD.323	—	
5322	C.189161/107	Pipe, aileron power assisted, tee piece to union ...	1	DTD.323	C.	
†	C.189161/108	Pipe, aileron power assisted, union to union ...	1	DTD.323	—	
5323	C.189161/109	Pipe, aileron power assisted, union to union ...	1	DTD.323	C.	
†	C.189161/110	Pipe, aileron power assisted, union to union ...	1	DTD.323	—	
5324	C.189161/111	Pipe, aileron power assisted, union to union ...	1	DTD.323	C.	
†	C.189161/112	Pipe, aileron power assisted, union to tee piece ...	1	DTD.323	—	
5325	C.189161/113	Pipe, aileron power assisted, tee piece to jack lock ...	1	DTD.323	C.	
†	C.189161/114	Pipe, return, flexible hose to union	1	DTD.323	—	
5326	C.189161/115	Pipe, return, union to union	1	DTD.323	C.	
†	C.189161/116	Pipe, return, union to union	1	DTD.323	—	
5327	C.189161/117	Pipe, return, union to union	1	DTD.323	C.	
5328	C.189161/118	Pipe, return, union to union	1	DTD.323	C.	
5329	C.189161/119	Pipe, return, union to tee piece	1	DTD.323	C.	
7089†	C.189161/124	Pipe, pressure, tee piece to accumulator	1	DTD.323	MR/C	
4575	C.189161/126	Pipe, flap balance, tee piece to jack up connection ...	1	DTD.323	C.	
4577	C.189161/127	Pipe, flap balance, tee piece to selector	1	DTD.323	C.	
5461	C.189161/132*	Pipe, wheel brake, torsion link to "Maxaret" unit (Pre Mod. 197)	1	DTD.323	C.	
†	C.189161/133*	Pipe, return, flexible hose to torsion link (Pre Mod. 197)	1	DTD.323	—	
4574	C.189161/138	Pipe, flap balance, union to flap down connection ...	1	DTD.323	C.	
5240	C.189161/139	Pipe, flap balance, union to union (Mod. 30) ...	1	DTD.323	C.	
5241	C.189161/140	Pipe, flap balance, selector to union (Mod. 30) ...	1	DTD.323	C.	
5242	C.189161/141	Pipe, flap balance, tee piece to union (Mod. 30) ...	1	DTD.323	C.	
5332	C.189161/153	Pipe, undercarriage air, non-return valve to 4-way piece	1	DTD.323	C.	
5333	C.189161/154	Pipe, undercarriage down, undercarriage jack to 4-way piece	1	DTD.323	C.	
†	C.189161/162*	Pipe, wheel brake, union to flexible pipe (Pre Mod. 197)	1	DTD.323	—	
5335	C.189161/164	Pipe, undercarriage up, tee piece to tee piece ...	1	DTD.323	C.	
5336	C.189161/165	Pipe, undercarriage up, tee piece to thermal relief valve	1	DTD.323	C.	
†	C.189161/167	Pipe, undercarriage up, tee piece to union	1	DTD.323	—	

† For details see Piping Chart

SERVICES—HYDRAULICS IN WINGS

Ref. No.	Part No.	Description					No. Off	Material Specification	M.R. Class of Store	Plate No.
		1	2	3	4	5				
5338	C.189161/169					Pipe, undercarriage, jettison valve to tee piece ...	1	DTD.323	C.	
†	C.189161/170					Pipe, undercarriage down, union to tee piece ...	1	DTD.323	—	
†	C.189161/171					Pipe, undercarriage down, starboard wing break to union	1	DTD.323	—	
†	C.189161/174					Pipe, undercarriage down, tee piece to union ...	1	DTD.323	—	
†	C.189161/175					Pipe, undercarriage down, union to starboard wing break	1	DTD.323	—	
†	C.189161/176					Pipe, undercarriage down, 4-way piece to union ...	1	DTD.323	—	
5339	C.189161/179					Pipe, power assisted aileron, aileron control valve to tee piece	1	DTD.323	C.	
5340	C.189161/180					Pipe, power assisted aileron, tee piece to union ...	1	DTD.323	C.	
5341	C.189161/181					Pipe, undercarriage up, tee piece to sequence valve	1	DTD.323	C.	
†	C.189161/182					Pipe, undercarriage air, union to pressure release valve	1	DTD.323	—	
†	C.189161/183					Pipe, undercarriage air, non-return valve to pressure release valve	1	DTD.323	—	
5342	C.189161/185					Pipe, flap up, bleed adaptor to flap jack ...	1	DTD.323	C.	
5343	C.189161/186					Pipe, flap down, bleed adaptor to flap jack ...	1	DTD.323	C.	
5344	C.189161/188					Pipe, pressure, tee piece to aileron control valve ...	1	DTD.323	C.	
5220	C.189161/191					Pipe, undercarriage up, restrictor valve to undercarriage jack	1	DTD.323	C.	
5290	C.189161/213					Pipe, undercarriage down, starboard wing, undercarriage control valve to tee piece	1	DTD.323	C.	
†	C.189161/214					Pipe, undercarriage down, starboard wing, tee piece to shuttle valve	1	DTD.323	—	
5291	C.189161/215					Pipe, undercarriage down, starboard wing, shuttle valve to tee piece	1	DTD.323	C.	
†	C.189161/216					Pipe, undercarriage down, starboard wing, tee piece to union	1	DTD.323	—	
†	C.189161/220					Pipe, flap balance, starboard wing break, union to tee piece	1	DTD.323	—	
†	C.189161/221					Pipe, flap balance, union to wing break ...	1	DTD.323	—	
6958†	C.189161/228*					Pipe, return, torsion link to Maxaret unit (Pre Mod. 197)	1	DTD.323	MR/C	
8207†	C.189161/229*					Pipe, pressure, starboard wing, union to non-return valve (Mod. 265) (Pre Mod. 197)	1	DTD.323	MR/C	
8208†	C.189161/230					Pipe, pressure, tee piece to tee piece (Mod. 265) ...	1	DTD.323	MR/C	
8209†	C.189161/231*					Pipe, pressure, starboard wing, tee piece to thermal relief valve (Mod. 265)	1	DTD.323	MR/C	
6994	C.189161/232					Pipe, return, starboard wing, tee piece to 4-way piece (Mod. 265)	1	DTD.323	C.	
8211†	C.189161/234					Pipe, return, starboard wing, non-return valve to 4-way piece (Mod. 265)	1	DTD.323	MR/C	
8212†	C.189161/235*					Pipe, return, flexible hose to 4-way piece (Mod. 265) (Pre Mod. 197)	1	DTD.323	MR/C	
6993	C.189161/236					Pipe, undercarriage up, union to jettison valve (Mod. 265)	1	DTD.323	C.	
8086	C.189161/244					Pipe, air charging, accumulator to tee piece (Mod. 330)	1	DTD.323	C.	
8087	C.189161/245					Pipe, air charging, tee piece to charging connection (Mod. 330)	1	DTD.323	C.	
8088	C.189161/246					Pipe, air charging, tee piece to pressure gauge ... (Mod. 330)	1	DTD.323	C.	
	C.189161/248					Pipe, recuperator, union to union (Mod. 197) ...	1	DTD.323	—	
	C.189161/249					Pipe, recuperator, union to tee piece (Mod. 197) ...	1	DTD.323	—	
	C.189161/250					Pipe, recuperator, tee piece to leg pivot connection (C) (Mod. 197)	1	DTD.323	—	
	C.189161/251					Pipe, recuperator, tee piece to P.R.Valve (Mod. 197)	1	DTD.323	—	
	C.189161/252					Pipe, recuperator, P.R. Valve to tee piece (Mod. 197)	1	DTD.323	—	

† For details see Piping Chart

SERVICES—HYDRAULICS IN WINGS

Ref. No.	Part No.	Description					No. Off	Material Specification	M.R. Class of Store	Plate No.
		1	2	3	4	5				
	C.189161/253	Pipe, pressure, union to tee piece (Mod. 197)	1	DTD.323			
	C.189161/254	Pipe, pressure, tee piece to N.R.V. (Mod. 197)	1	DTD.323			
	C.189161/255	Pipe, wheel brake, leg pivot connection (A) to adaptor (Mod. 197)	1	DTD.323			
	C.189161/256	Pipe, wheel brake, adaptor to union (Mod. 197)	1	DTD.323			
	C.189161/257	Pipe, return, leg pivot connection (B) to tee piece (Mod. 197)	1	DTD.323			
	C.189161/259	Pipe, recuperator, tee piece to P.R.V. (Mod. 197)	1	DTD.323			
	C.189161/267	Pipe, pressure, N.R.V. to filter (inlet) (Mod. 486)	1	DTD.323			
	C.189161/268	Pipe, pressure, filter (outlet) to tee piece (Mod. 486)	1	DTD.323			
	C.189161/273	Pipe, return, 4-way piece to tee piece (Mod. 197)	1	DTD.323			
	C.189161/274	Pipe, undercarriage up, 4-way piece to union (Mod. 486)	1	DTD.323			
	C.189161/275	Pipe, undercarriage up, union to jettison valve (Mod. 486)	1	DTD.323			
	C.189161/276	Pipe, oil jettison, jettison valve to atmosphere (Mod. 486)	1	DTD.323			
	C.189161/277	Pipe, undercarriage, air, union to union (Mod. 486)	1	DTD.323			
	C.189161/278	Pipe, undercarriage, air, union to jettison valve (Mod. 486)	1	DTD.323			
	C.189161/279	Pipe, undercarriage, air, jettison valve to shuttle valve (Mod. 486)	1	DTD.323			
	C.189161/280	Pipe, return, 4-way piece to N.R.V. (Mod. 486)	1	DTD.323			
	C.189161/281	Pipe, undercarriage down, sequence valve to union (Mod. 486)	1	DTD.323			
27Q/1125	Dowty C.4862Y Mk. C	Regulator, undercarriage pressure	1	—	A.		
27Q/1224	Dowty D.6207Y B.203004	Restrictor, one-way	2	—	A.		
		Rod, spacer, group	2	—			
		Consisting of:—								
4131	F.197484	Block, clamp	4	LFS.21	C.	NH.1	
28M/10328	AGS.2002/C1	Nut	2	—	C.		
28P/12462	SP.9.C8	Pin, split	6	—	C.		
	B.203004/1	Rod, $\frac{3}{16}$ " dia. x 44" long	1	DTD.364			
27Q/12006	Dowty SP.900/19	Ring, "O" type	4	—	C.		
—	Std.1509/23/050	Tube, distance (Make from 30B/1784)	6	T.4	—		
28W/12296	SP.15.C	Washer	2	—	C.		
	B.203005	Rod, spacer, group	2	—			
		Consisting of:—								
4131	F.197484	Block, clamp	3	LFS.21	C.		
28M/10328	AGS.2002/C1	Nut	2	—	C.		
28P/12462	SP.9.C8	Pin, split	4	—	C.		
	B.203005/1	Rod, $\frac{3}{16}$ " dia. x 37.70" long	1	DTD.364			
27Q/12006	Dowty SP.900/19	Ring, "O" type	3	—	C.		
—	Std.1509/23/050	Tube, distance (Make from 30B/1784)	4	T.4	—		
28W/12296	SP.15.C	Washer	2	—	C.		
5160	Std.1208/100/49/10	Shim, for sequence valve adjustment	QR	Steel	C.	4	
1932	F.194934	Tee-piece, $\frac{1}{8}$ " x $\frac{1}{2}$ " x $\frac{1}{4}$ "	2	LA	C.		
5161	F.199039	Tee-piece, $\frac{1}{4}$ " x $\frac{3}{16}$ " x $\frac{3}{16}$ "	2	LA	C.	NH.1	
3792	Std.1509/23/025	Tube, distance, $\frac{3}{16}$ " o/d x 17 s.w.g.	1	T.4	MR/C	4	
—	Std.1509/23/050	Tube, distance, $\frac{3}{16}$ " o/d x 17 s.w.g.	1	T.4	—		
—	Std.1507/2/150	Tube, distance (Make from 30A/959)	4	T.26	—		
5769	Std.1509/12/026	Tube, distance (Make from 30B/1804)	1	T.4	MR/C	4	
5767	Std.1509/12/030	Tube, distance (Make from 30B/1804)	3	T.4	MR/C	4	

SERVICES—HYDRAULICS IN WINGS

Ref. No.	Part No.	Description					No. Off	Material Specification	M.R. Class of Store	Plate No.
		1	2	3	4	5				
869	F.140778						4	L.1	C.	
27Q/	Dowty 08808Y-AO.2						1	—	A.	
27Q/	Dowty 08817Y-AO.5						1	—	A.	
27Q/	Dowty 08817Y-AO.6						1	—	A.	
5482	F.202794						1	—	MR/B	NH.1
27Q/1443	Dowty D.5212Y						2	—	A.	
27Q/926	Dowty D.5220Y						3	—	A.	
27Q/930	Dowty C.4651Y Mk.A						1	—	A.	
27Q/1632	Dowty C.8950Y Mk.B						1	—	A.	
27Q/1633	Dowty C.8950Y Mk.C						1	—	A.	
27Q/945	Dowty C.4122Y Mk.A						1	—	A.	
27Q/927	Dowty C.4603Y Mk.A						6	—	A.	
27Q/1205	Dowty D.7523Y						1	—	A.	
27Q/845	Dowty C.3651Y						2	—	A.	
27Q/1287	Dowty C.4862Y Mk.E						1	—	A.	
27Q/1034	Dowty D.4930Y						2	—	A.	
28Q/1221	Dowty C.7375Y						2	—	A.	
27Q/1223	Dowty C.7596Y Mk.B						1	—	A.	
27Q/1817	Dowty C.7596Y Mk.C						1	—	A.	
27Q/1204	Dowty C.4122Y Mk.G						1	—	A.	
27Q/1198	Dowty C.2701Y Mk.H						2	—	A.	
27Q/1381	Dowty C.4809Y Mk.B						1	—	A.	
5162	F.202820						4	—	C.	NH.1

SERVICES—HYDRAULICS IN WINGS

Ref. No.	Part No.	Description					No. Off	Material Specification	M.R. Class of Store	Plate No.
		1	2	3	4	5				
	C.207895	WING FUSELAGE CONNECTIONS, ASSEMBLY (Mk. 4)					-	-		
2081	F.195583	Block , clamp, on port side of diaphragm G ...					2	LFS.21	C.	
2100	F.195658	Block , clamp, between diaphragm "G" and wing rib "A"					1	LFS.21	C.	
2101	F.195659	Block , clamp, between diaphragm "G" and wing rib "A"					1	LFS.21	C.	
2102	F.195660	Block , clamp, between diaphragm "G" and wing rib "A"					1	LFS.21	C.	
2103	F.195767*	Block , clamp, on starboard side of diaphragm "G" (Pre Mod. 197)					1	LFS.21	C.	
2104	F.195768*	Block , clamp, on starboard side of diaphragm "G" (Pre Mod. 197)					1	LFS.21	C.	
8307	F.215473	Block , clamp, starboard diaphragm "G" (Mod. 197)					1	LFS.21	C.	
8308	F.215474	Block , clamp, starboard diaphragm "G" (Mod. 197)					1	LFS.21	C.	
	† C.189160/28	Pipe , wheel brake, port wing break, union to union					1	DTD.323	—	
	† C.189160/35	Pipe , power assisted aileron, port wing break, union to union					1	DTD.323	—	
3717	† C.189160/59	Pipe , flap air, port wing break, union to union ...					1	DTD.323	—	
	† C.189160/158	Pipe , pressure, elbow to union ...					1	DTD.323	—	
	† C.189160/162	Pipe , undercarriage air, port wing break union to union					1	DTD.323	—	
	† C.189160/166	Pipe , return, port wing break to tee piece ...					1	DTD.323	—	
7107	† C.189160/201	Pipe , undercarriage up, union to elbow at port wing break					1	DTD.323	MR/C	
7108	† C.189160/202	Pipe , undercarriage up, union to port wing break					1	DTD.323	MR/C	
	† C.189160/223	Pipe , recuperator, union to union (Mod. 197) ...					1	DTD.323	—	
	† C.189161/1	Pipe , pressure, starboard wing break to union					1	DTD.323	—	
3426	† C.189161/12	Pipe , return, starboard wing break to tee piece					1	DTD.323	C.	
	† C.189161/33	Pipe , undercarriage up, union to starboard wing break					1	DTD.323	—	
3454	† C.189161/40	Pipe , undercarriage up, union to starboard wing break					1	DTD.323	C.	
	† C.189161/53	Pipe , undercarriage down, union to starboard wing break					1	DTD.323	—	
3473	† C.189161/59	Pipe , wheel brake, starboard wing break to union					1	DTD.323	—	
5316	† C.189161/90	Pipe , undercarriage air tee piece to starboard wing break					1	DTD.323	C.	
	† C.189161/189	Pipe , undercarriage air, starboard wing break to union					1	DTD.323	—	
5345	† C.189161/190	Pipe , undercarriage air tee piece to tee piece ...					1	DTD.323	C.	
5754	† C.189161/217	Pipe , power assisted aileron union to starboard wing break					1	DTD.323	—	
5755	† C.189161/218	Pipe , undercarriage air union to tee piece ...					1	DTD.323	—	
	† C.189161/247	Pipe , recuperator, union to union (Mod. 197) ...					1	DTD.323	—	

SERVICES—HYDRAULICS IN WINGS

Ref. No.	Part No.	Description					No. Off	Material Specification	M.R. Class of Store	Plate No.
		1	2	3	4	5				
SUMMARY OF STOCK ITEMS										
28Y/12849	AGS.1212	Adaptor	—	—	—
28F/10798	AGS.1129B	Body, banjo	—	—	—
28D/12528	A25.1.B	Bolt, 4 B.A.	—	—	—
28D/12511	A25.2.B	Bolt, 4 B.A.	—	—	—
28D/12622	A25.3.B	Bolt, 4 B.A.	—	—	—
28D/12529	A25.4.B	Bolt, 4 B.A.	—	—	—
28D/12623	A25.5.B	Bolt, 4 B.A.	—	—	—
28D/12530	A25.6.B	Bolt, 4 B.A.	—	—	—
28D/12624	A25.7.B	Bolt, 4 B.A.	—	—	—
28D/12565	A25.8.B	Bolt, 4 B.A.	—	—	—
28D/12625	A25.9.B	Bolt, 4 B.A.	—	—	—
28D/12626	A25.10.B	Bolt, 4 B.A.	—	—	—
28D/12627	A25.11.B	Bolt, 4 B.A.	—	—	—
28D/12673	A25.12.B	Bolt, 4 B.A.	—	—	—
28D/12810	A25.13.B	Bolt, 4 B.A.	—	—	—
28D/12811	A25.16.B	Bolt, 4 B.A.	—	—	—
28D/12512	A25.1.C	Bolt, 2 B.A.	—	—	—
28D/12531	A25.3.C	Bolt, 2 B.A.	—	—	—
28D/12533	A25.5.C	Bolt, 2 B.A.	—	—	—
28D/12566	A25.6.C	Bolt, 2 B.A.	—	—	—
28D/12514	A25.7.C	Bolt, 2 B.A.	—	—	—
28D/12629	A25.8.C	Bolt, 2 B.A.	—	—	—
28D/12534	A25.9.C	Bolt, 2 B.A.	—	—	—
28D/12515	A25.10.C	Bolt, 2 B.A.	—	—	—
28D/12516	A25.11.C	Bolt, 2 B.A.	—	—	—
28D/12536	A25.13.C	Bolt, 2 B.A.	—	—	—
28D/12537	A25.14.C	Bolt, 2 B.A.	—	—	—
28D/12538	A25.15.C	Bolt, 2 B.A.	—	—	—
28D/12539	A25.16.C	Bolt, 2 B.A.	—	—	—
28D/12540	A25.18.C	Bolt, 2 B.A.	—	—	—
28D/12630	A25.19.C	Bolt, 2 B.A.	—	—	—
28D/12567	A25.20.C	Bolt, 2 B.A.	—	—	—
28D/12547	A25.15.E	Bolt, 1/2" B.S.F.	—	—	—
28E/15930	AS.5419/3	Clip	—	—	—
28E/14336	AS.5419/4	Clip	—	—	—
28E/15139	AS.5419/5	Clip	—	—	—
28F/11177	AGS.1159/A	Cap, cone	—	—	—
28F/11018	AGS.1159/B	Cap, cone	—	—	—
28F/10020	AGS.1120/1	Cone, tee	—	—	—
28F/9720	AGS.1120/3	Cone, tee	—	—	—
28F/9722	AGS.1120/6	Cone, tee	—	—	—
28F/13290	AGS.1120/11	Cone, tee	—	—	—
28F/9716	AGS.1118C	Cone, tee	—	—	—
28F/10610	AGS.1118/B	Cone, tee	—	—	—
28F/10782	AGS.1118/A	Cone, tee	—	—	—
28F/9715	AGS.1116/B	Cone, elbow	—	—	—
28F/14384	AGS.1116/C	Cone, elbow	—	—	—

SERVICES-HYDRAULICS IN WINGS

Ref. No.	Part No.	Description					No. Off	Material Specification	M.R. Class of Store	Plate No.
		1	2	3	4	5				
SUMMARY OF STOCK ITEMS (continued)										
28Y/10145 5K/3390	AGS.1200 AS.3360.B3.B	Connector, charging	-	-	-
		Lead, bonding	-	-	-
28F/9735	AGS.1142/A	Nipple	-	-	-
28F/14528	AGS.1170/A	Nipple	-	-	-
28F/14123	AGS.1170/B	Nipple	-	-	-
28F/14529	AGS.1170/C	Nipple	-	-	-
28F/14530	AGS.1170/D	Nipple	-	-	-
28L/13124	A27.C.T.	Nut	-	-	-
28M/10327	AGS.2002/B1	Nut, 4 B.A.	-	-	-
28M/10328	AGS.2002/C1	Nut, 2 B.A.	-	-	-
28M/10330	AGS.2002/E1	Nut, 3/8" B.S.F.	-	-	-
28F/11966	AGS.1174	Screw, bleed	-	-	-
28F/5721	AGS.904/A	Sleeve	-	-	-
28F/5722	AGS.904/B	Sleeve	-	-	-
28F/11080	AGS.1106/B	Union, cone to nipple	-	-	-
28F/11855	AGS.1113/A	Union, bulkhead	-	-	-
28F/11273	AGS.1113/B	Union, bulkhead	-	-	-
28F/12373	AGS.1125/1	Union, tee 4-way	-	-	-
28F/9726	AGS.1123/C	Union, cone 4-way	-	-	-
28F/10509	AGS.1107A	Union, reducing	-	-	-
28S/2791	A31.B32	Screw	-	-	-
28S/14005	A32B14	Screw	-	-	-
28S/2875	A32.B24	Screw	-	-	-
28W/12306	SP.15.B	Washer, 4 B.A....	-	-	-
28W/12296	SP.15.C	Washer, 2 B.A.	-	-	-
28W/12496	SP.15.E	Washer, 1/2" dia.	-	-	-
28W/12355	SP.16.C	Washer, 2 B.A.	-	-	-
28W/12731	SP.16.B	Washer	-	-	-
28F/12048	AGS.1186B	Washer	-	-	-

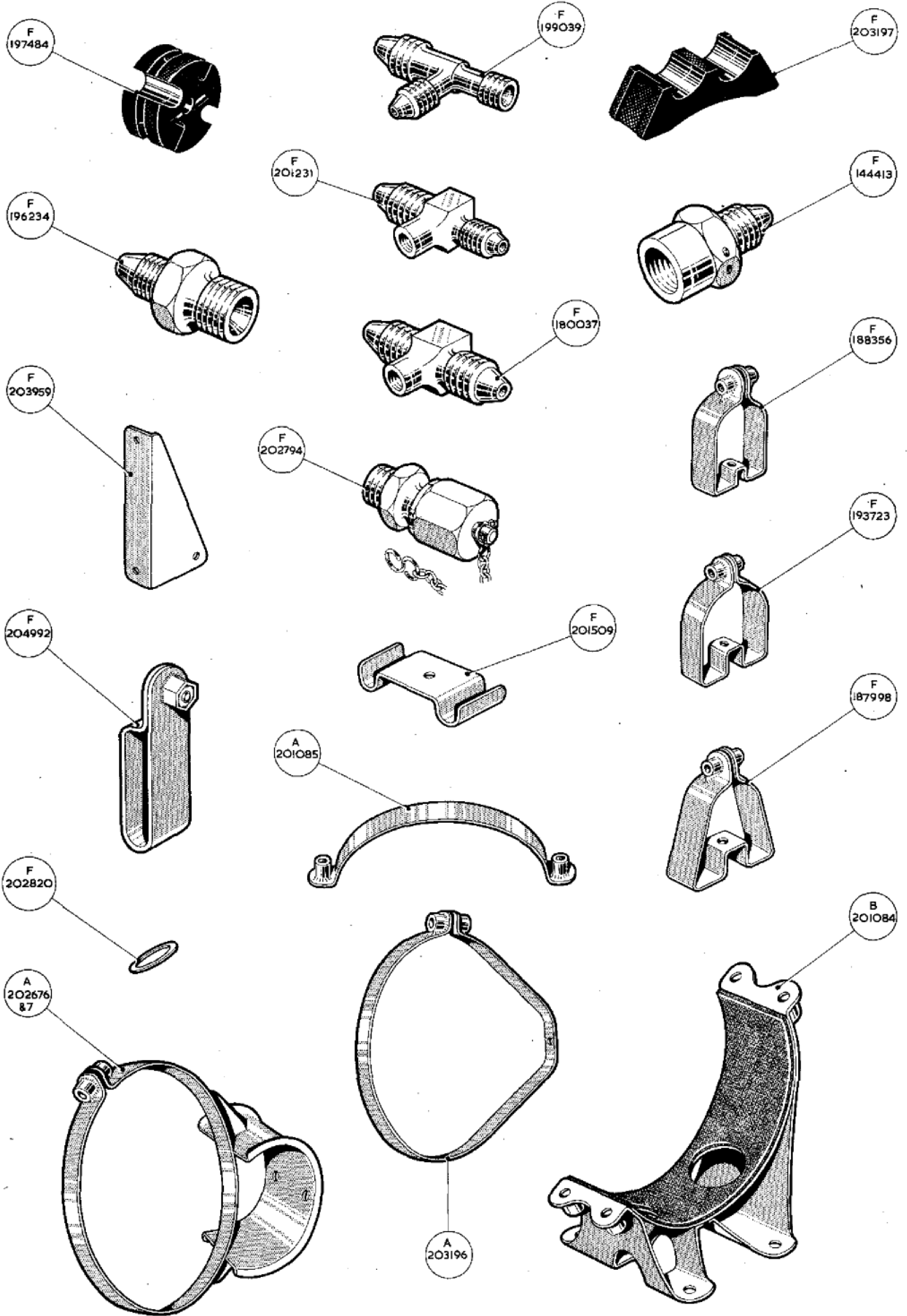

This file was downloaded
from the RTFM Library.

Link: www.scottbouch.com/rtfm

Please see site for usage terms,
and more aircraft documents.

