

RESTRICTED

AP.4515C  
VOLUME 3  
PART 1  
SECTION 2  
CHAPTER 5

COPY No. 302

1st EDITION

MAY, 1953

SCHEDULE OF SPARE PARTS  
FOR  
**DUNLOP EQUIPMENT**  
FITTED TO  
**VAMPIRE & SEA VAMPIRE**  
AIRCRAFT

R MINISTRY

RESTRICTED

RESTRICTED

AP. 4515C  
VOLUME 3  
PART 1  
SECTION 2  
CHAPTER 5

COPY No. 302

1st EDITION

MAY, 1953

SCHEDULE OF SPARE PARTS  
FOR  
**DUNLOP EQUIPMENT**  
FITTED TO  
**VAMPIRE & SEA VAMPIRE**  
AIRCRAFT

PREPARED BY  
THE DUNLOP RUBBER CO. LTD.  
AVIATION DIVISION  
FOLESHILL, COVENTRY  
FOR  
THE DIRECTORATE OF EQUIPMENT, AIR MINISTRY

RESTRICTED

## MEMORANDUM OF INSTRUCTIONS

- |   |   |
|---|---|
| 1. CONTENTS ... ..                      | This Schedule contains a list of Dunlop parts embodied in the VAMPIRE and SEA VAMPIRE Airframes (All Service Marks).  |
| 2. DEMANDS ... ..                       | <p>(a) Normally only parts which bear a reference number are to be demanded but if other parts are required the Part Number must be shown on the demand.</p> <p>(b) Demands for parts to make an airframe serviceable must invariably bear the serial number of the airframe.</p> <p>(c) Certain parts in this schedule do not bear reference numbers. These parts, if required, should be made up from local resources or if the manufacture of such parts is beyond the capacity of the unit, the parts are to be demanded, and the demand endorsed "Unable to manufacture locally".</p> <p>(d) Parts quoted in this schedule are held in various Vocabulary Stores sections, the relevant section and reference number being shown in the Reference number column.</p> <p>(e) Demands are to be made out strictly in accordance with the procedure laid down in Air Publication 830, Volume I.</p> |
| 3. EXHAUSTION OF EXISTING STOCKS ... .. | An asterisk placed in the Part Number column against an item or group, indicates that further purchases to that design will not be made, but that existing stocks are to be used until exhausted.   |
| 4. COMPILATION OF TEXT ... ..           | <p>The multi-indentation system has been used in which the main assembly, consisting of sub-assemblies, groups and detail items, indicates their relationship by the indentation of the descriptive titles. This indentation is in accordance with the following outlines :—</p> <p>(a) Assemblies, separate Groups and detail parts, start at the left-hand margin.</p> <p>(b) First division—sub-assemblies, groups or detail of the Assembly breakdown listed in the preceding paragraph are indented one column.</p> <p>(c) Second division—groups or details of the first division sub-assemblies or groups are indented one further column.</p> <p>(d) Component items.</p>   |
| 5. NUMBERS OFF ... ..                   | <p>Numerals in the No. Off column adjacent to the Description column indicate the quantity used for one only of that particular assembly, sub-assembly or group in which they occur.</p> <p>Numerals in the column under the heading Mark Applicability and No. Off Per Aircraft, indicate the quantity of each assembly, separate group or detail used per Mark of Aircraft. Where details of the quantities used have not been available to date of compilation of this Schedule, the applicability is indicated by "X".</p>  |

Page ii

- |   |   |
|---|---|
| 6. SERVICING ...<br>TOOLS               | Special tools, if required, for servicing any Dunlop component listed in this schedule, will be shown in composite form at the end of the text.   |
| 7. MAJOR REPAIRS ...                    | The letter "M" against a group or part indicates that the item is required only for the major repair purposes and will not normally be held in stock by units other than those carrying out Major Repair Work.  |
| 8. AMENDMENTS ...                       | to this schedule will be published by means of Amendment Lists. These Amendment Lists will be numbered consecutively, and Commanding Officers are to issue the necessary instructions for the upkeep of the schedule and the completion of the Amendment Certificate. It is intended, where practicable, to amend the schedule by the insertion of reprinted pages. A Statement of all Amendment Lists distributed during the quarter will be published in Air Ministry Orders. |
| 9. PART NUMBERS ...                     | When an item or group does not bear a part number in the part number column the drawing on which the item or group is assembled is quoted in parenthesis after the description. This part number, however, must not be quoted on demands.   |
| 10. INCORPORATED MODS<br>AND AMENDMENTS | See Modification and Amendment Record Sheet commencing on Page v.   |
| 11. SERIAL NUMBER ...                   | This schedule is serially numbered and is to be accounted for in accordance with A.M.O. A.772/47.   |

**THE AMENDMENTS PROMULGATED IN THE UNDERMENTIONED  
AMENDMENT LISTS HAVE BEEN MADE IN THIS SCHEDULE  
VAMPIRE & SEA VAMPIRE**

Amendment List		Amendments made by	Date
Number	Date		
1 2 3 4 5 6 7 8.	May 1963.	 B Hall. Dunlop Rubbers Co. Ltd.	24.9.61.  6.5.65.

**THE AMENDMENTS PROMULGATED IN THE UNDERMENTIONED  
AMENDMENT LISTS HAVE BEEN MADE IN THIS SCHEDULE  
VAMPIRE & SEA VAMPIRE**

Amendment List		Amendments made by	Date
Number	Date		

**MODIFICATION AND AMENDMENT SHEET  
VAMPIRE AND SEA VAMPIRE**

Dunlop Mod. No.	Aircraft Mod. No.	A.L. No.	Dunlop Mod. No.	Aircraft Mod. No.	A.L. No.	Dunlop Mod. No.	Aircraft Mod. No.	A.L. No.	Dunlop Mod. No.	Aircraft Mod. No.	A.L. No.
11(A)		N.A.	498(A)		N.A.	1734(A)		†	5104(A)		N.A.
12(A)		N.A.	515(A)		N.A.	1735(A)		N.A.	5125(A)		N.A.
13(A)		N.A.	527(A)		N.A.	1738(M)		N.A.	5165(A)		N.A.
14(A)		N.A.	570(M)	944	†	1740(M)		N.A.	5200(A)		N.A.
15(A)		N.A.	571(M)	944	†	1743(A)		N.A.	5230(A)		N.A.
16(A)		N.A.	589(A)		N.A.	1796(M)		†	5338(A)		N.A.
17(A)		N.A.	609(M)		†	1799(M)		†	5365(A)		N.A.
19(A)		N.A.	630(M)		†	2022(M)		†	5366(A)		N.A.
99(A)		N.A.	657(M)		†	2023(M)		†	5367(A)		N.A.
100(A)		N.A.	664(A)		N.A.	2091(M)		1	5427(A)		3
101(A)		N.A.	667(A)		N.A.	2092(M)		1	5437(A)		3
102(A)		N.A.	741(M)		†	2165(M)		2	5481(A)		N.A.
103(A)		N.A.	742(M)		2	2182(M)		2	5489(A)		N.A.
104(A)		N.A.	753(A)		N.A.	2277(M)		N.A.	5490(A)		N.A.
107(A)		N.A.	769(A)		†	2278(M)		N.A.	5581(A)		1
132(A)		N.A.	813(A)		N.A.	2279(M)		2	5716(A)		1
133(A)		N.A.	815(A)		N.A.	2300(M)		2	5717(A)		1
168(M)	591	†	816(A)		N.A.	2301(M)		2	5718(A)		1
169(M)	591	†	817(A)		N.A.	2302(M)		2	5719(A)		N.A.
172(M)		†	871(A)		N.A.	2316(M)		2	5720(A)		N.A.
189(M)		†	879(M)		N.A.	2389(M)		2	5721(A)		1
198(M)		†	884(A)		N.A.	2421(M)		2	5722(A)		1
239(M)		†	885(A)		N.A.	2375(M)		3	5723(A)		1
258(M)		N.A.	886(A)		N.A.	2456(M)		3	5724(A)		1
263(M)		†	887(A)		N.A.				5725(A)		1
264(M)	756	†	892(A)		N.A.				5726(A)		1
265(M)	756	†	981(A)		N.A.				5727(A)		1
280(A)		<del>N.A.</del>	997(M)		†				5729(A)		1
287(M)	683	†	998(M)		†				5730(A)		1
292(M)	683	†	1026(M)		N.A.				5731(A)		1
298(A)		N.A.	1115(M)	3166	†				5734(A)		1
306(A)		N.A.	1116(M)	3166	†				5742(A)		N.A.
341(M)		†	1142(A)		†				5749(A)		N.A.
350(A)		N.A.	1209(A)		N.A.				5754(A)		N.A.
352(A)		N.A.	1218(M)		N.A.				5830(A)		N.A.
353(A)		N.A.	1225(A)		N.A.				5866(A)		N.A.
354(A)		N.A.	1269(A)		N.A.				5941(A)		N.A.
355(A)		N.A.	1283(A)		N.A.						
370(A)		N.A.	1309(M)		†						
387(M)		†	1387(A)		N.A.						
447(M)	924	†	1389(A)		N.A.						
458(M)	882	†	1391(A)		N.A.						
461(M)	882	†	1392(A)		N.A.						
465(A)		N.A.	1394(A)		N.A.						
485(A)		N.A.	1518(M)	3068	†						
490(A)		N.A.	1519(M)	3068	†						
494(A)		N.A.	1524(A)		N.A.	3005		6			
			1543(A)		N.A.						
			1544(A)		N.A.						
			1567(A)		†						
			1589(M)	842	†	3370(N)		7			
			1590(M)	842	†						

† Incorporated in initial issue of Schedule.  
 N.A. Modification/Amendment not applicable to this Schedule.  
 C. Modification/Amendment cancelled.  
 (A) Amendment.  
 (M) Modification.

**MODIFICATION AND AMENDMENT SHEET  
VAMPIRE AND SEA VAMPIRE**

Dunlop Mod. No.	Aircraft Mod. No.	A.L. No.	Dunlop Mod. No.	Aircraft Mod. No.	A.L. No.	Dunlop Mod. No.	Aircraft Mod. No.	A.L. No.	Dunlop Mod. No.	Aircraft Mod. No.	A.L. No.
6087(A)		N.A.	20016(A)		N.A.						
6088(A)		N.A.	20335(A)		†						
6090(A)		N.A.	20350(A)		N.A.						
6091(A)		N.A.	20450(A)		3						
6092(A)		N.A.	21292(A)		2						
6093(A)		N.A.	21501(A)		N.A.						
6094(A)		N.A.	21135(A)		N.A.						
6095(A)		N.A.	21696(A)		3						
6180(A)		N.A.	21752(A)		4						
6193(A)		N.A.	22115(A)		2						
6200(A)		N.A.	22116(A)		2						
6320(A)		N.A.	22124(A)		2						
6350(A)		N.A.	22352(A)		3						
6352(A)		N.A.	2287(A)		4						
6353(A)		N.A.	22975(A)		4						
6360(A)		N.A.									
6361(A)		N.A.									
6629(A)		N.A.									
6724(A)		N.A.									
6742(A)		N.A.									
6802(A)		N.A.									
6828(A)		N.A.									
6927(A)		N.A.									
7268(M)		3									
7408(M)		3	23736		6						
7489(A)		2	23741		N.A.						
7490(A)		2	24324		N.A.						
			24350		6						
			24357		6						
			24491		6						
			24499		N.A.						
			25104		N.A.						
			25235(A)		7						
			25236(A)		7						
			25237(A)		7						
			25239(A)		7						
			25483(A)		N.A.						
			26608(A)		8						
			26681(A)		8						
			28007(A)		8						
			28267(A)		N.A.						

† Incorporated in initial issue of Schedule.  
 N.A. Modification/Amendment not applicable to this Schedule.  
 C. Modification/Amendment cancelled.  
 (A) Amendment.  
 (M) Modification.



VAMPIRE & SEA VAMPIRE

ISSUED WITH AMENDMENT LIST No. 3

Ref. No.	Part No.	Description	No. Off	Matl. Spec.	Cl. of St.	Mark Applicability and No. Off Per Aircraft																		
						M.R.	F1	F3	FB 5	FB 9	NF 10	T 11			F 20	F 21	T 22							

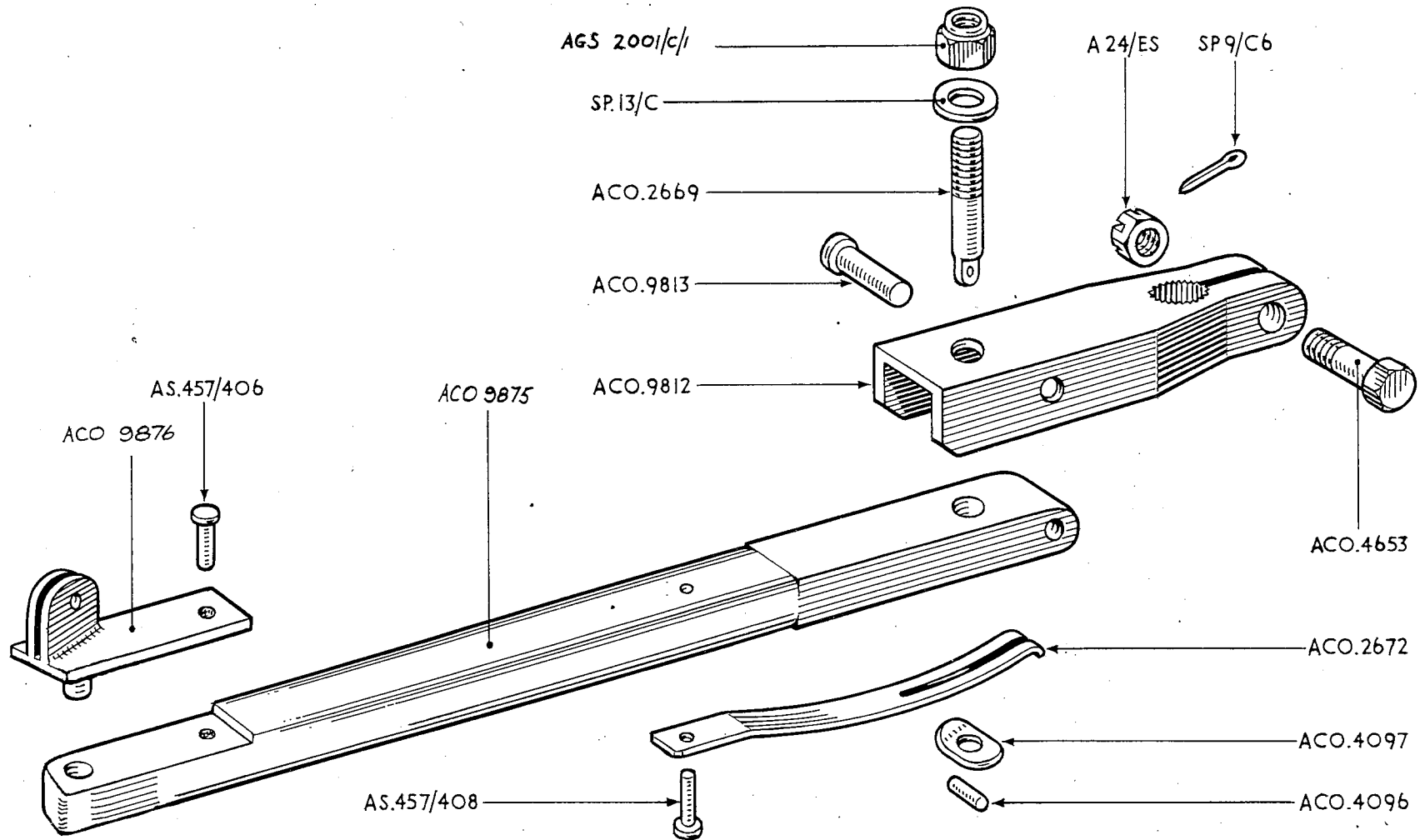

ACM 17376

RESTRICTED

Ref. No.	Part No.	Description	No. Off	Matl. Spec.	Cl. of St. M.R.	Mark Applicability and No. Off Per Aircraft															
						1	2	3	4	5	FI	F3	FB 5	FB 9	NF 10	T 11	F 20	F 21	T 22		
						27G/4024	AH.8219	<b>BRAKE UNIT</b> ... (Pre Dunlop Mod. 1589/Vampire Mod. 842 for Mks. F1 and F3 A/C)	—	—	A	2	2								
AL 27G/4619	AHO.17411	Spares for :— Bag, pressure, c/w Nut AHO.492/5, Valve AHO.17030* or AHO.25485 and Washer AHO.492/4 <i>Pre Dunlop Mod 2300</i>	1	—	C																
27G/4508	AHO.1139	Cup, locking, valve ...	1	DTD.171	C																
27G/4705	AHO.25499	<b>LINING, BRAKE, GROUP</b> ... (Pre Dunlop Mod. 997)	5	—	C																
27G/4898	AHO.27955	<b>LINING, BRAKE, GROUP</b> ... (Dunlop Mod. 997)	5	—	C																
27G/4511	AHO.492/5	Nut, valve ...	3	BSS.249	C																
27G/4518	AHO.17031	Plate, locking, c/w Peg AHO.17018 <i>Pre Dunlop Mod 24351</i>	1	—	C																
27G/4620	AHO.17949*	Separator (Pre Dunlop Mod. 630)	5	DTD.171	C																
27G/4841	AHO.26470	Separator (Dunlop Mod. 630)	5	Phosphor Bronze Gauze	C																
27G/4529	AHO.16939	Spring ...	5	DTD.215	C																
27G/4621	AHO.17410	Strap, spring ...	5	Dunlop Spec. 18	C																
27G/4522	AHO.17032	Washer, tab ...	2	DTD.171	C																
30A/3055	—	Wire, locking, 22 SWG ...	QR	DTD.189	C																
AL 27G/5434	AHO 35385	Bag Pressure c/w Nut AHO 492/5, Valve AHO 25485 and washer AHO 492/4 (Dunlop Mod 2300).	1	—	C																
27G/6106	AHO 38858	Plate Locking and Peg Group (Dunlop Modt 24350)..	1	—	C																

VAMPIRE AND SEA VAMPIRE

RESTRICTED

VAMPIRE AND SEA VAMPIRE

Ref. No.	Part No.	Description	No. Off	Matl. Spec.	Cl. of St.	Mark Applicability and No. Off Per Aircraft											
						M.R.	F1	F3	FB 5	FB 9	NF 10	T 11	F 20	F 21	T 22		
27G/4046	AH.8902	<b>BRAKE UNIT</b> ... (Pre Dunlop Mod. 1590/Vampire Mod. 842 for Mks. FB5 and FB9 A/C)	—	—	A				2	2					2		
		Spares for :—															
AL2 27G/4619	AHO.17411	Bag, pressure, c/w Nut AHO.492/5, Valve AHO.17030* or AHO.25485 and Washer AHO.492/4 (Pre Dunlop Mod 2301)	1	—	C												
27G/4508	AHO.1139	Cup, locking, valve	1	DTD.171	C												
27G/4705	AHO.25499	<b>LINING, BRAKE, GROUP</b> ... (Pre Dunlop Mod. 998)	5	—	C												
27G/4898	AHO.27955	<b>LINING, BRAKE, GROUP</b> ... (Dunlop Mod. 998)	5	—	C												
27G/4511	AHO.492/5	Nut	3	BSS.249	C												
27G/4518	AHO.17031	Plate, locking, c/w Peg AHO.17018 (Pre Dunlop Mod 24350)	1	—	C												
27G/4620	AHO.17949*	Separator (Pre Dunlop Mod. 387)	5	DTD.171	C												
27G/4841	AHO.26470	Separator (Dunlop Mod. 387)	5	Phosphor Bronze Gauze	C												
27G/4529	AHO.16939	Spring	5	DTD.215	C												
27G/4621	AHO.17410	Strap, spring	5	Dunlop Spec. 18	C												
27G/4522	AHO.17032	Washer, tab	2	DTD.171	C												
30A/3055	—	Wire, locking, 22 SWG	QR	DTD.189	C												
AL2 27G/5434	AHO 35385	Bag Pressure c/w Nut AHO.492/5, Valve AHO 25485 and washer AHO.492/4 (Dunlop Mod 2301)	1	—	C												
ALL 27G/6106	AHO 38858	Plate, locking i Rag Group (Dunlop Mod. 24350)	1	—	C												

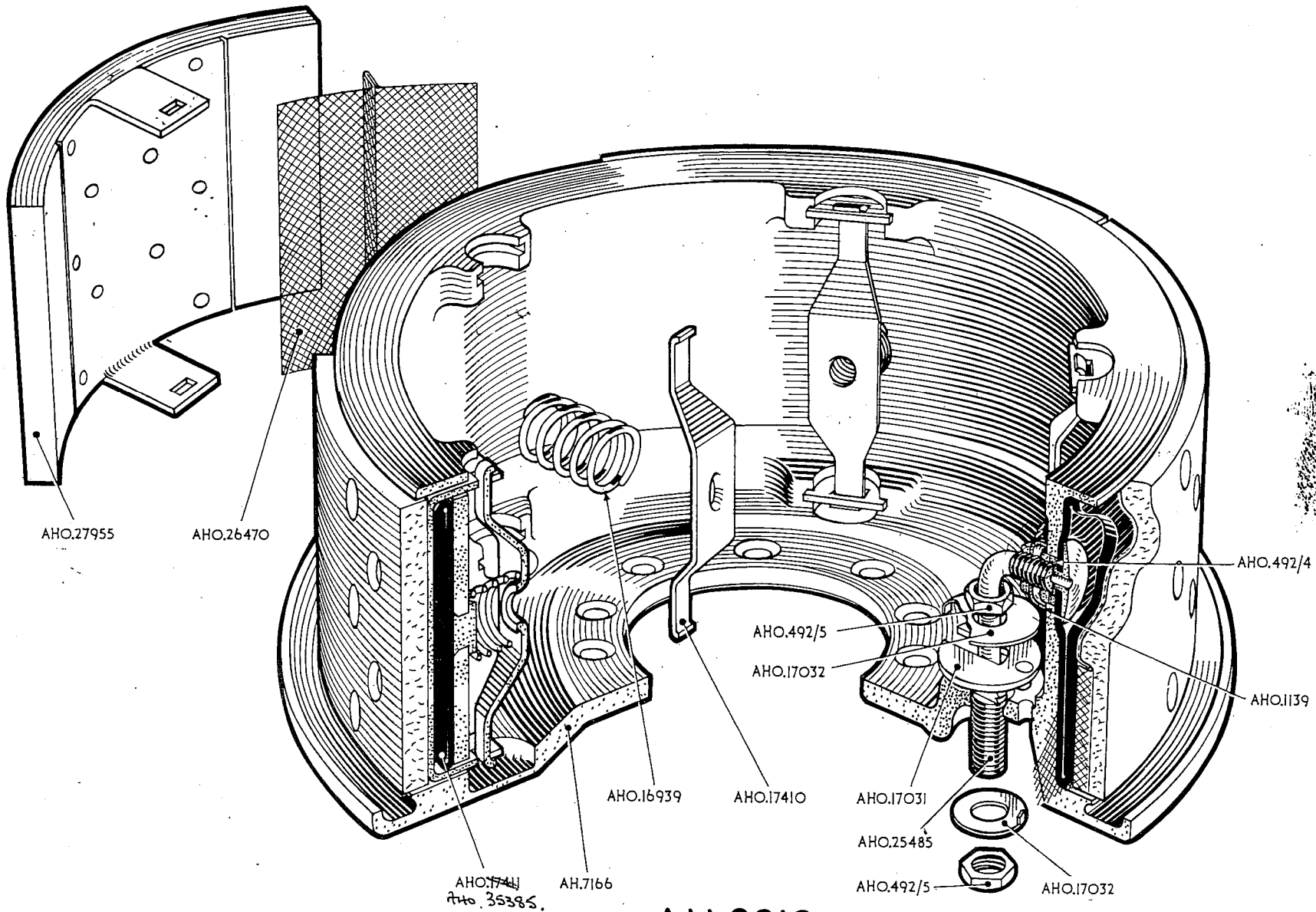

AH.8219

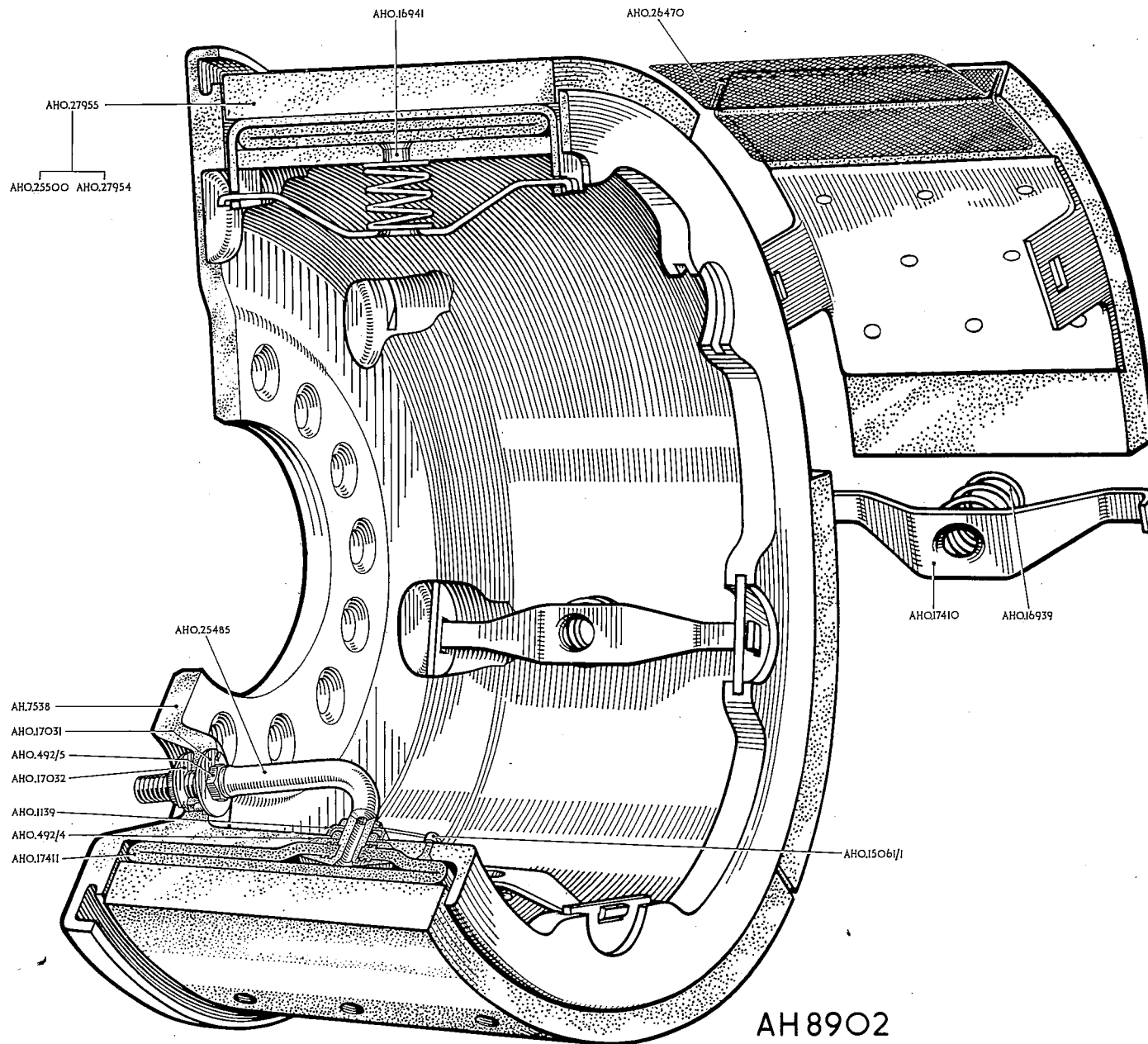

AH 8902

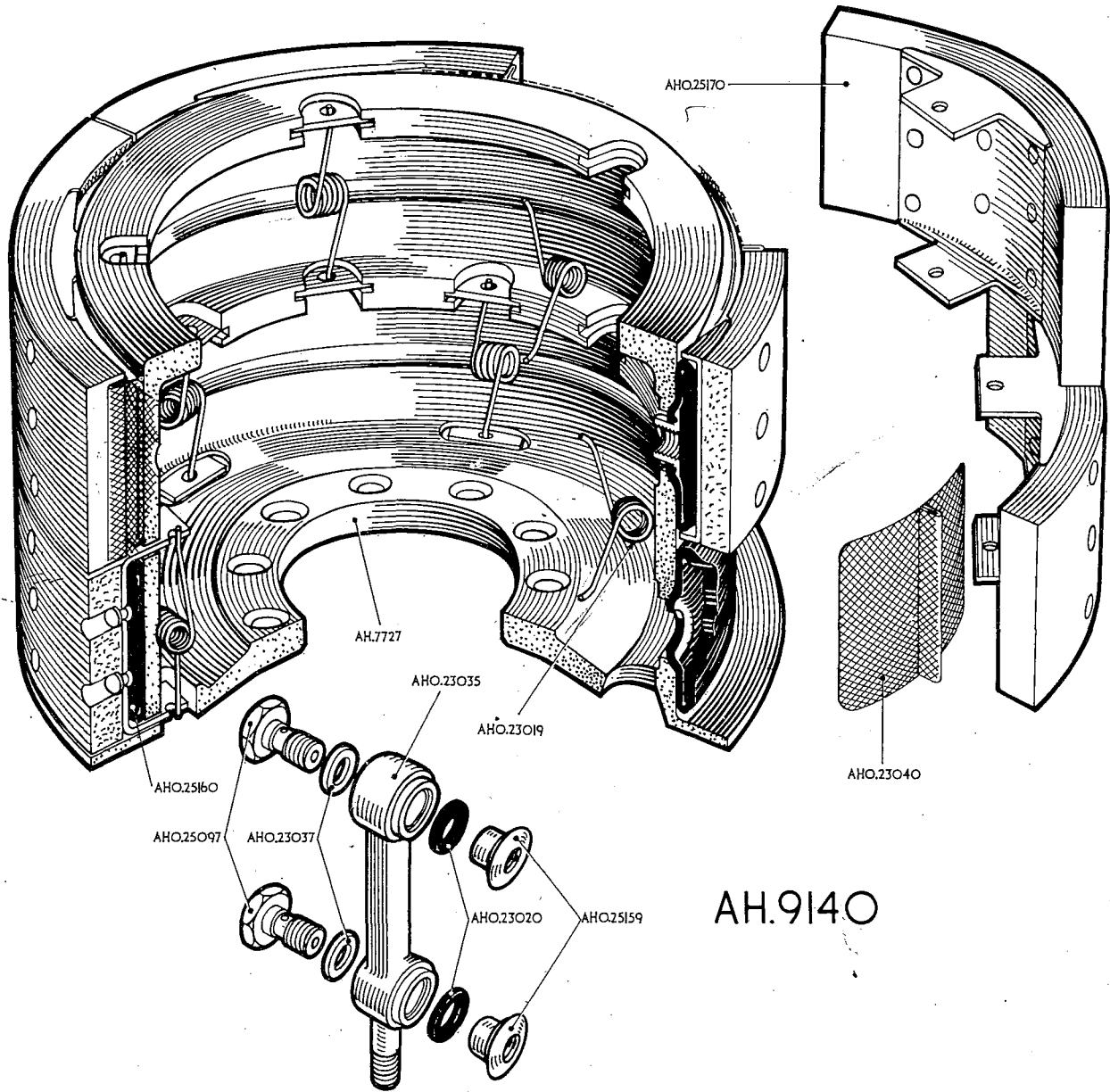

AH.9140

RESTRICTED

Ref. No.	Part No.	Description	No. Off	Matl. Spec.	Cl. of St.	Mark Applicability and No. Off Per Aircraft																
											M.R.	FI	F3	FB 5	FB 9	NF 10	T 11			F 20	F 21	T 22
						1	2	3	4	5												
27G/4067	AH.9140	<b>BRAKE UNIT</b> ... (Mks. FI and F3 A/C embodying Dunlop Mod. 1589/Vampire Mod. 842, and Mks. FB5 and FB9 A/C embodying Dunlop Mod. 1590/Vampire Mod. 842) <i>Pre Dunlop Mod 2165 for Mk 1, 3, 5, 9, 10, 11 - Pre Dunlop Mod 2316 for Mk 22</i>	—	—	A	2	2	2	2	2	2							2				
<i>ALZ</i>	27G/4839	AHO.25160																				
<i>ALZ</i>	27G/4708	AHO.25097	Bag, pressure, c/w Valve AHO.25159 <i>Pre Dunlop Mod 2302</i>	—	C																	
	27G/4709	AHO.23035	Bolt, connection ...	2	S.2 or S.11	C																
	27G/4840	AHO.25170	Connection, twin ...	1	L.1	C																
	27G/4711	AHO.23020	<b>LINING, BRAKE, GROUP</b> ...	10	—	C																
			Ring, sealing ...	2	Rubber Compound No. 614	C																
	27G/4712	AHO.23040	Separator ...	10	Phosphor Bronze Gauze	C																
	27G/4713	AHO.23019	Spring ...	10	DTD.215	C																
	27G/4714	AHO.23037	Washer, sealing ...	2	L.17 or L.34	C																
	30A/3055	—	Wire, locking, 22 SWG ...	QR	DTD.189	C																
<i>ALZ</i>	<del>AHO 35386</del> 2 27G 5403	AHO 35386	Bag Pressure c/w Valve AHO 25159 (Dunlop Mod 2302)	2		C																

VAMPIRE AND SEA VAMPIRE

RESTRICTED



RESTRICTED

Ref. No.	Part No.	Description	No. Off	Matl. Spec.	Cl. of St.	Mark Applicability and No. Off Per Aircraft													
											F1	F3	FB 5	FB 9	NF 10	T 11	F 20	F 21	T 22
						1	2	3	4	5									
27G/4105	AH.50329	<b>BRAKE UNIT</b> ... (Dunlop Mod. 2165 for Mks. 1, 3, 5, 9, 10, 11) (Dunlop Mod. 2316 for Mk. 22)	—	—	A	2	2	2	2	2	2					2			
		Spares for :—																	
27G/5403	AHO.35386	<b>Bag</b> , pressure, c/w Valve AHO.25159 ...	2	—	C														
27G/4708	<del>AHO.25097</del>	<b>Bolt</b> , connecting ...	2	S.94, S.95 or S.96	C														
27G/4709	AHO.23035 ✓	<b>Connection</b> , twin ...	1	L.64	C														
27G/5202	AHO.29658 ✓	<b>LINING, BRAKE, GROUP</b> ...	10	—	C														
27G/4711	AHO.23020 ✓	<b>Ring</b> , sealing ...	2	Rubber Compound 614	C														
27G/4712	AHO.23040 ✓	<b>Separator</b> ...	10	Phosphor Bronze Gauze	C														
27G/4713	AHO.23019 ✓	<b>Spring</b> ...	10	DTD.215	C														
28F/12047	AGS.1186/A	<b>Washer</b> , sealing ...	2	—	C														
30A/3055	—	<b>Wire</b> , locking, 22 SWG ...	QR	DTD.189	C														

VAMPIRE & SEA VAMPIRE

ISSUED WITH AMENDMENT LIST No. 2

RESTRICTED



RESTRICTED

Ref. No.	Part No.	Description	No. Off	Matl. Spec.	Cl. of St.	Mark Applicability and No. Off Per Aircraft															
											F1	F3	FB 5	FB 9	NF 10	T 11			F 20	F 21	T 22
						1	2	3	4	5											
26FC/6455	ACM.16525	<b>CABLE ASSEMBLY</b> (De Havilland Part No. K.001537A)	—	—	C		I	I	I	I						I	I				
26FC/6566	ACM.16980	<b>CABLE ASSEMBLY</b> (De Havilland Part No. 13CF.407A/1)	—	—	C																
27A/2222	FC-R16-N	<b>Cover, outer, main wheel</b> (26 × 7.75 — 13) ... ..	—	—	A		2	2													
27A/2087	FC-R17-N	<b>Cover, outer, main wheel</b> (26 × 7.75 — 13) ... ..	—	—	A				2	2	2	2				2	2	2			
27A/2070	NF-R30	<b>Cover, outer, nose wheel</b> (6.50 — 5½) ... ..	—	—	A		I	I	I	I	I	I				I	I	I			
AL + 27A/3433.	NF-R31.	<b>COVER, OUTER NOSE WHEEL.</b> (6.50 — 5½) (Alternative items)	—	—	A																I

VAMPIRE AND SEA VAMPIRE

RESTRICTED

VAMPIRE AND SEA VAMPIRE

Ref. No.	Part No.	Description	No. Off	Matl. Spec.	Cl. of St.	Mark Applicability and No. Off Per Aircraft																
						M.R.	F1	F3	FB 5	FB 9	NF 10	T 11			F 20	F 21	T 22					
																		1	2	3	4	5
27G/1994	AHO.2337*	<b>FILTER, AIR ASSEMBLY</b> ... .. Spares for :—	—	—	A		1	1	1	1							1	1				
27G/2000	AHO.1056	<b>Element, filter</b> ... ..	1	Felt, Code SSD/B	C																	
28L/13028	A27/JT	<b>Nut, thin, 3/8" BSF</b> ... ..	1	—	C																	
27G/2484	ACO.8991	<b>Plate, perforated</b> ... ..	2	DTD.182	C																	
27G/1998	AHO.1666	<b>Seal, filter body</b> ... ..	1	Black Rubber S.I	C																	
27G/2154	AHO.1068	<b>Valve, drain</b> ... ..	1	S.I	C																	
27G/2091	ACO.1268	<b>FILTER, AIR, ASSEMBLY</b> ... .. Spares for :—	—	—	A		1	1	1	1	1	1					1	1	1			
27G/2116	ACO.1283	<b>Connection, pipe, 1/4" BSP</b> ... ..	1	L.I	C																	
27G/2000	AHO.1056	<b>Element, filter</b> ... ..	1	Felt, Code SSD/B	C																	
28L/13028	A27/JT	<b>Nut, thin, 3/8" BSF</b> ... ..	1	—	C																	
27G/2284	ACO.8991	<b>Plate, perforated</b> ... ..	2	DTD.182	C																	
27G/1998	AHO.1666	<b>Seal, filter body</b> ... ..	1	Black Rubber S.I	C																	
27G/2154	AHO.1068	<b>Valve, drain</b> ... ..	1	S.I	C																	
27G/1970	AHO.4727	<b>Washer, connection</b> ... ..	2	L.17 or L.34	C																	

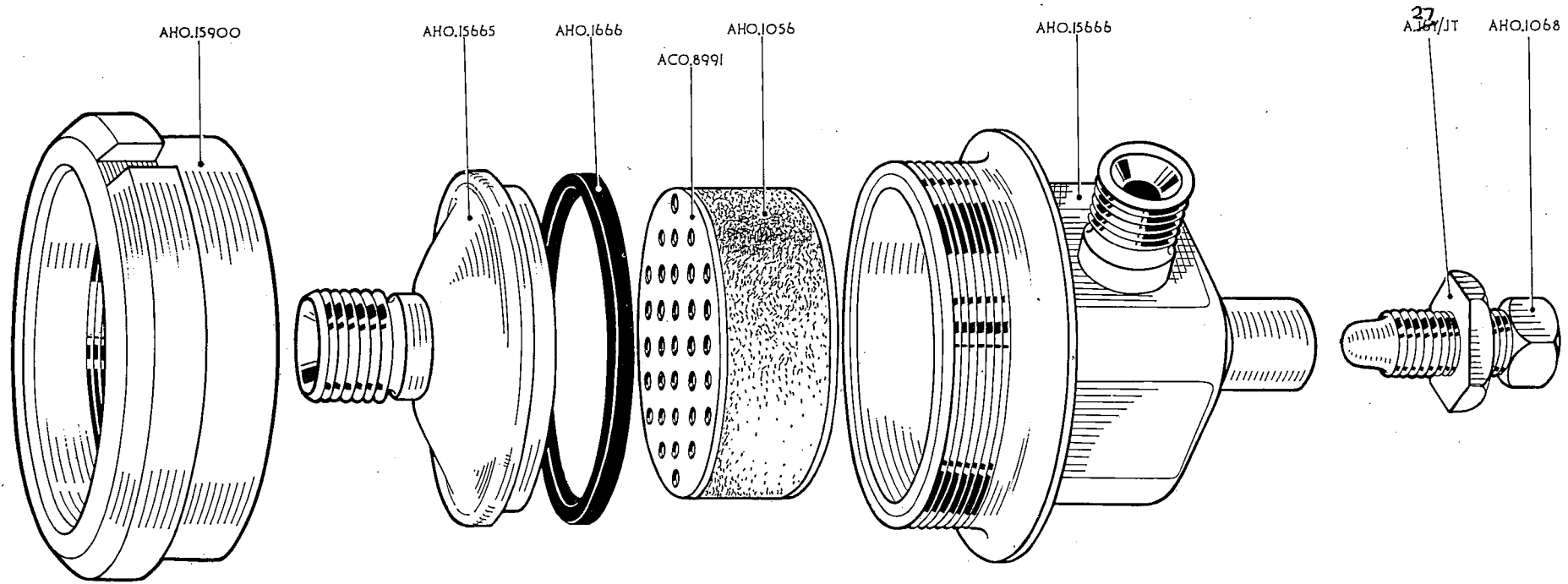

AHO.2337

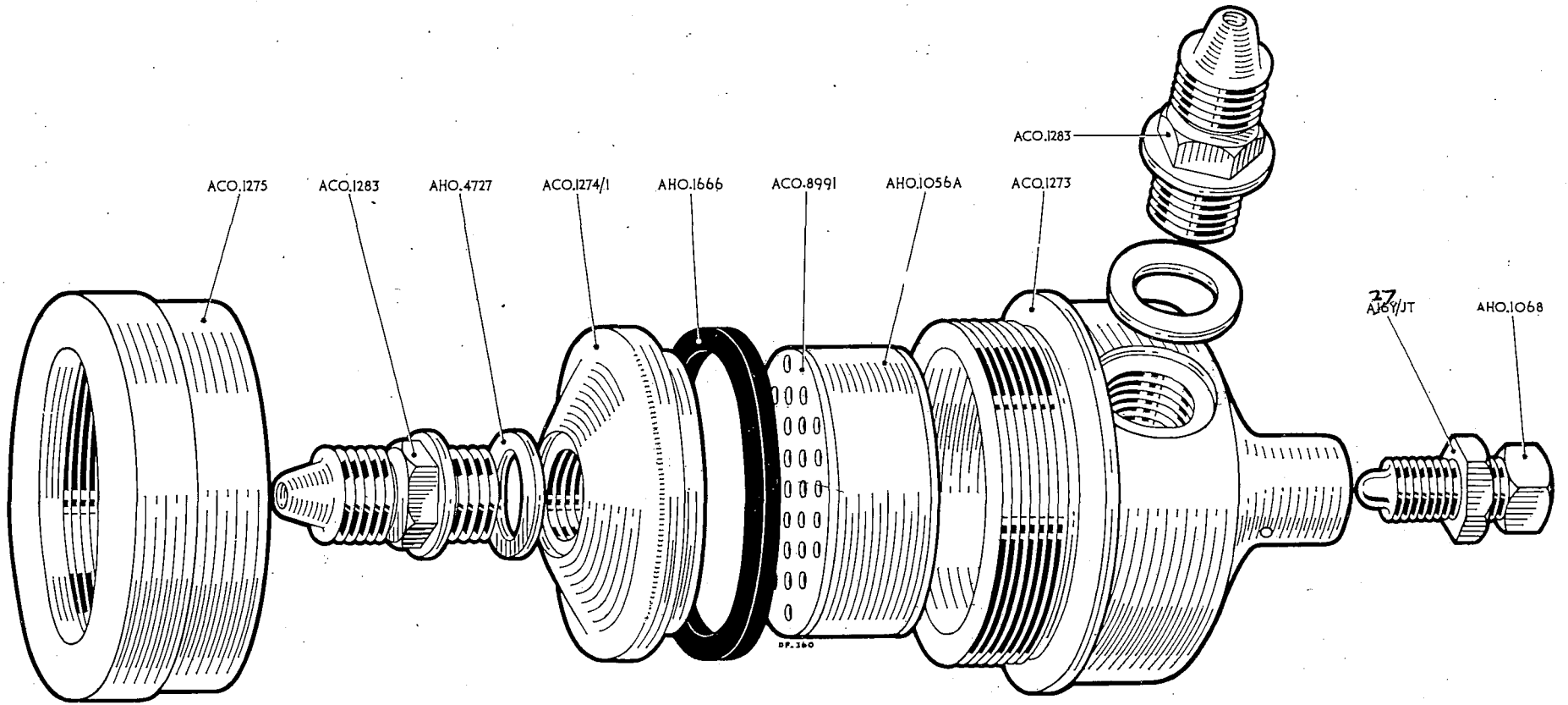

ACO.1268

Ref. No.	Part No.	Description	No. Off	Matl. Spec.	Cl. of St.	Mark Applicability and No. Off Per Aircraft														
						M.R.						F1	F3	FB 5	FB 9	NF 10	T 11	F 20	F 21	T 22
						1	2	3	4	5										
5D/1489	AH.8360*	<b>FIRING UNIT (MAXIFLUX)</b> ... ..	—	—	A	4	4	4	4	4	4			4	4					
		Spares for :—																		
5D/1595	AHO.18523 AHO.18836	<b>Body, switch</b> ... ..	1	Bakelite																
		<b>BOLT, SECURING, AND SEAR SPRING PLUNGER, GROUP</b>	1	—	C															
5D/1598	AHO.18504*	<b>Catch, plug (Pre Dunlop Mod. 609)</b> ... ..	1	M.S.	C															
5D 1736	ACO.5767	<b>Catch, plug (Dunlop Mod. 609)</b> ... ..	1	S.1 or EN.6	C															
5D/1600	AHO.18490	<b>Circlip, switch</b> ... ..	1	Piano Wire	C															
	AHO.18753	<b>Contact</b> ... ..	2	—																
5D/1602	AHO.18477 AHO.18467	<b>Cover, switch</b> ... ..	1	Bakelite																
		<b>Disc, contact</b> ... ..	1	Palladium Silver	C															
5D/1594	AHO.18924	<b>PIECE, LOCKING, GROUP</b> ... ..	1	—	C															
5D/1591	AHO.18500	<b>Pin, fulcrum</b> ... ..	1	S.80	C															
28P/13625	SP.9/A3	<b>Pin, split</b> ... ..	2	—	C															
5D/1597	AHM.391	<b>Plate, base</b> ... ..	1	S.6	C															
5D/1590	AHO.18922 AHO.18678	<b>PLUNGER, AND TRIGGER LEVER, GROUP</b> ... ..	1	—	A															
		<b>Shim, switch</b> ... ..	1	Empire Cloth																
5D/1603	AHO.18474	<b>Spacer, contact</b> ... ..	1	Tufnol	C															
5D/1599	AHO.18505	<b>Spring, plug catch</b> ... ..	1	Piano Wire	C															
5D/1593	AHO.18494	<b>Spring, return, plunger</b> ... ..	1	Piano Wire	C															
5D/1601	AHO.18475	<b>Spring, switch</b> ... ..	1	DTD.236	C															
	AHO.18476	<b>Switch, push</b> ... ..	1	Bakelite																
30A/3055	—	<b>Wire, locking, 22 SWG</b> ... ..	QR	DTD.189	C															
	AHO.18686	<b>TRANSPORT ITEM</b> <b>Plug, protector</b> ... ..	1	Bakelite																
<del>30A/3055</del>	<del>NFR31</del>	<del>Cover, Outer, Nose Wheel (1.50x5.1)</del> <del>Alternative Item for sub 711 4722 only</del>	<del>1</del>	<del>—</del>	<del>—</del>															

VAMPIRE AND SEA VAMPIRE

Ref. No.	Part No.	Description	No. Off	Matl. Spec.	Cl. of St.	Mark Applicability and No. Off Per Aircraft														
						1 2 3 4 5					M.R.	F1	F3	FB 5	FB 9	NF 10	T 11	F 20	F 21	T 22
5D/1737	AC.11066	FIRING UNIT (MAXIFLUX, MK. 2)	—	—	A	4	4	4	4	4	4			4	4					
5D/1595	AHO.18836	Spares for :— BOLT, SECURING, AND SEAR SPRING	1	—	C															
—	AC.11078	PLUNGER, GROUP CASE, SOLENOID, GROUP	1	—	—															
5D/1600	AHO.18523 AHO.18490	Spares for :— Body, switch ... Circlip, switch ...	1 1	Bakelite Piano Wire	C															
5D/1602	AHO.18753 AHO.18477 AHO.18467	Contact ... Cover, switch ... Disc, contact ...	2 1 1	— Bakelite Palladium	C															
5D/1603	AHO.18678	Shim, switch ...	1	Empire Cloth																
5D/1601	AHO.18474 AHO.18475 AHO.18476	Spacer, contact ... Spring, switch ... Switch, push ...	1 1 1	Tufnol DTD.326 Bakelite	C C															
ALC 5D/1736	ACO.5767	Catch, plug (Pre. Devlop Mod. 2182)	1	S.1 or EN.6																
ALC 5D/1594	AHO.18924	PIECE, LOCKING, GROUP	1	—	C															
5D/1591	AHO.18500	Pin, fulcrum ...	1	S.80	C															
28P/13625	SP.9/A3	Pin, split ...	2	—	C															
5D/1597	AHM.391	Plate, base ...	1	S.6	C															
5D/1590	AHO.18922	PLUNGER, AND TRIGGER LEVER, GROUP...	1	—	A															
5D/1599	AHO.18505	Spring, plug, catch ...	1	Piano Wire	C															
5D/1593	AHO.18494	Spring, return, plunger ...	1	Piano Wire	C															
30A/3055	—	Wire, locking, 22 SWG ...	QR	DTD.189	C															
ALC 5D1809	ACO20233	Ball Plug (Devlop Mod 2182)	1	S1	C															
	AHO.18686	TRANSPORT ITEM Plug, protector ...	1	Bakelite																

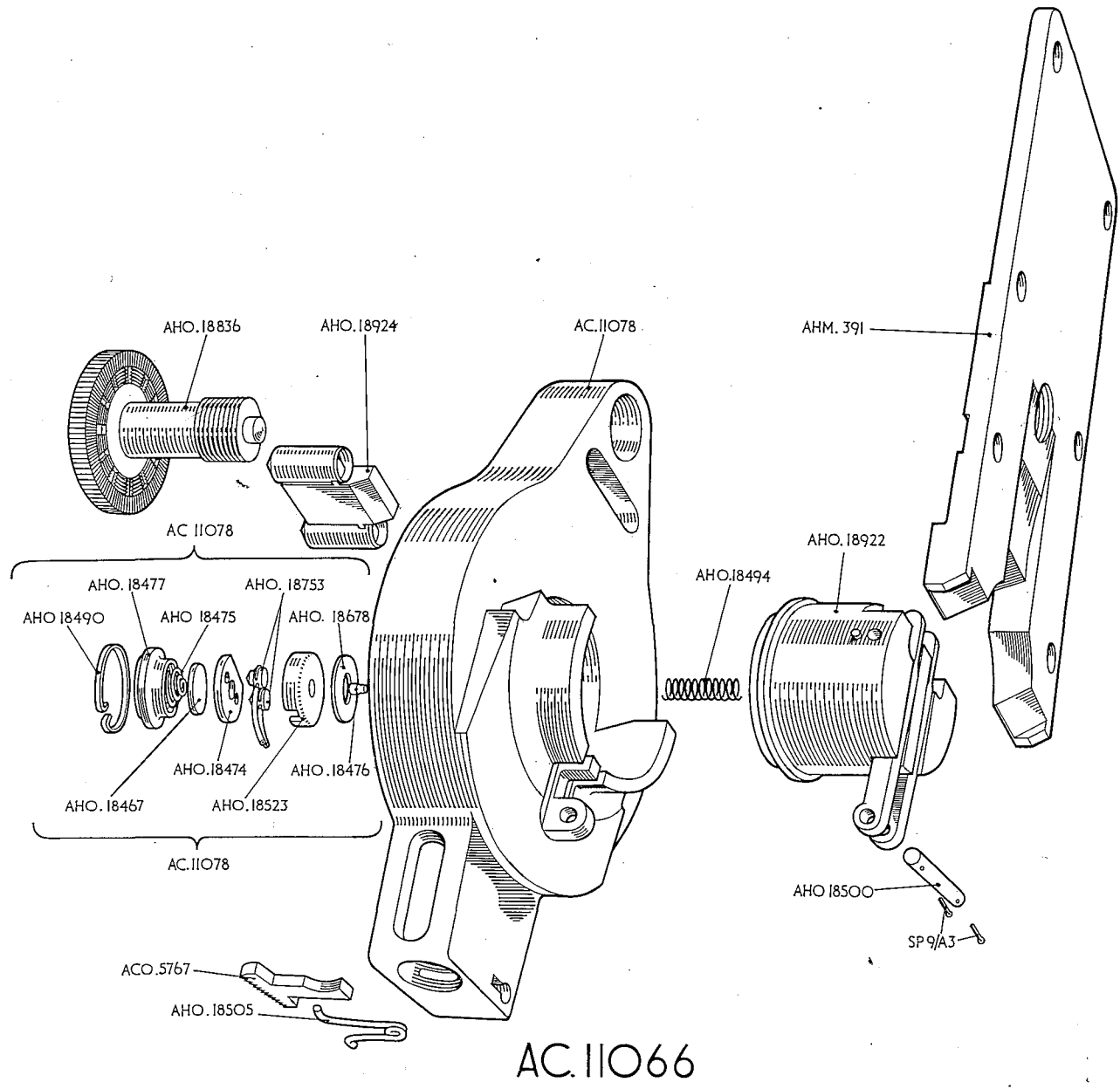

AC.11066

RESTRICTED

Ref. No.	Part No.	Description 1 2 3 4 5	No. Off	Matl. Spec.	Cl. of St. M.R.	Mark Applicability and No. Off Per Aircraft															
						FI	F3	FB 5	FB 9	NF 10	T 11			F 20	F 21	T 22					
27J/235	AH.8400	HANDLE, CONTROL, RING, ASSEMBLY ...	—	—	A	I	I	I	I							I	I				
27J/202	AH.8200	Spares for :— BUTTON, GUN-FIRING, SELECTRIC, ASSEMBLY	1	—	A																
27J/207	AHO.17311	Spares for :— Bearing, flap ... ..	1	BSS.249 or BSS.250	C																
27J/226	AHO.17442	BODY, C/W CONNECTION ROD, SPRING AND SPINDLE, GROUP	1	—	A																
27J/222	AHO.17321	Cap ... ..	1	Black Bakelite	C																
27J/225	AHO.17313	CONTACT, GROUP ASSEMBLY ... ..	2	—	A																
27J/216	AHO.17305	Spares for :— Retainer, socket ... ..	1	Beryllium Bronze	C																
27J/223	AHO.17326	Core, c/w Bush AHO.17459 ... ..	1	—	C																
27J/237	AHM.402	Flap, safety ... ..	1	Beryllium Copper	C																
27J/209	AHO.17334	Pin, retaining ... ..	1	Beryllium Copper or Brass	C																
27J/210	AH.7160	Plate, finger ... ..	1	Black Bakelite	C																
27J/213	AHO.17391	PLATE, POSITIVE CONTACT, AND SOCKET, GROUP	1	—	C																

VAMPIRE AND SEA VAMPIRE

RESTRICTED





VAMPIRE AND SEA VAMPIRE

Ref. No.	Part No.	Description					No. Off	Matl. Spec.	Cl. of St. M.R.	Mark Applicability and No. Off Per Aircraft										
		1	2	3	4	5				FI	P3	FB 5	FB 9	NF 10	T 11	F 20	F 21	T 22		
	AH.8400	<b>HANDLE, CONTROL, RING, ASSEMBLY</b> (Continued)																		
ALC. 271/331	AHO.26654	<b>PLATE, THUMB, "PRESS TO TRANSMIT", GROUP</b> (Vampire Mod. 924)					1	—												
28S/6472	A.33/A.6	<b>Screw</b> , 6 BA, csk. hd. ... ..					4	—	C											
28W/3089	AGS.163/C	<b>Washer</b> , double spring, parking catch (Dunlop Mod. 1309)					1	—	C											
28W/12296	SP.15/C	<b>Washer</b> , plain, parking catch (Dunlop Mod. 1309) ...					1	—	C											
ALC. 28W/3071	AGS.160/C	<b>Washer</b> , plain ... ..					1	—	C											
27G/1848	AHO.4186	<b>Washer</b> , spring, parking catch (Pre Dunlop Mod. 1309)					2	Spr. Stl.	C											
		<b>COMPLEMENTARY ITEMS</b>																		
5K/2578	—	<b>Sleeve</b> , "Hellerman", No. 3 x 1 in. (Supplied with Assembly AH.8200)					1	—	C											
ALC. 271/332	—	<b>Sleeve</b> , "Microflex", 6.5 mm. bore x .45 mm. wall thickness x 9 ins. long (Supplied with Assembly AH.8200)					1	Duratube S.10	C											

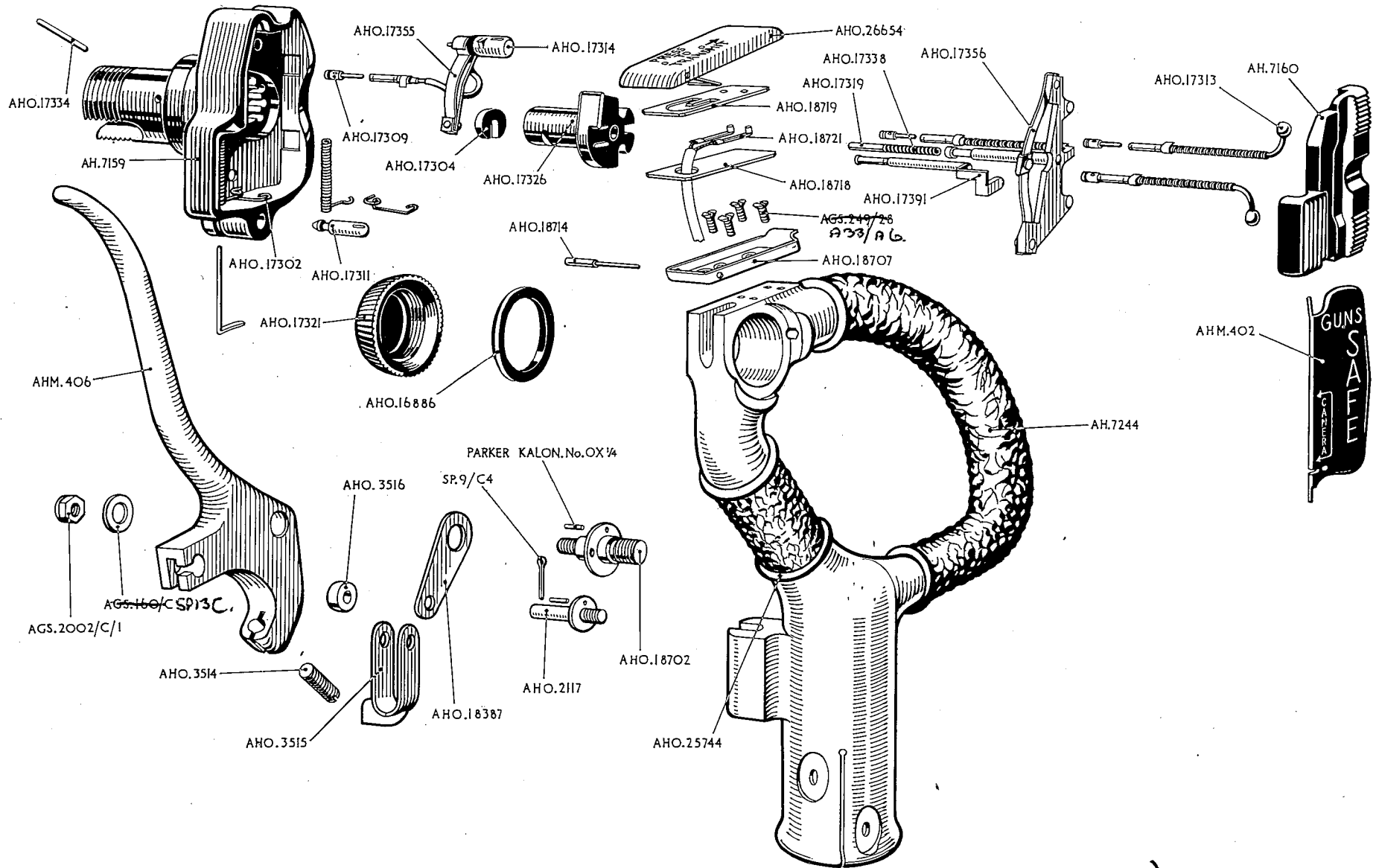

AH.8400 AND AH.9365

(LESS PARKING CATCH)



RESTRICTED  
**VAMPIRE & SEA VAMPIRE**

Ref. No.	Part No.	Description	No. Off	Matl. Spec.	Cl. of St.	Mark Applicability and No. Off Per Aircraft																	
						M.R.																	
						F1	F3	FB 5	FB 9	NF 10	T 11		F 20	F 21	T 22								
—	AC.1400	<b>HANDLE, CONTROL, ASSEMBLY</b> (Continued)	—	—	—																		
27J/285	ACO.3113	Spring, clicker, brake lever adjusting screw ... ..	1	DTD.236 or W.10	C																		
27J/300	ACO.3117	Spring, plunger, parking catch ... ..	1	DTD.236 or W.10	C																		
27J/301	ACO.4073	Spring, safety flap ... ..	1	DTD.187	C																		
27J/389	ACM.17764	<b>SWITCH, PUSH-BUTTON (BOMB.), ASSY., COMPLETE</b> ... ..	1	—	A																		
27J/390	ACM.17763	<b>SWITCH, PUSH-BUTTON (CAMERA), ASSY. COMPLETE</b> ... ..	1	—	A																		
27G/2170	AHO.17298	Washer, spring ... ..	4	Spr. Stl.	C																		
27J/252	AC.10300	<b>HANDLE, CONTROL, ASSEMBLY</b> (Vampire Mod. 3167) This assembly is identical to Ref. No. 27J/250, AC.1400 shown on Page 17, except for the following :— Delete :—	—	—	A										1								
27J/309	ACO.4310	Flap, safety ... ..	1																				
27J/274	ACM.15209	Lever, brake ... ..	1																				
27J/299	ACO.3865	Retainer, switch ... ..	1																				
27J/301	ACO.4073	Spring, safety flap ... ..	1																				
27J/391	AC.12901	<b>MECHANISM, TRIGGER, GUN, ASSEMBLY</b> Add :—	1																				
27J/317	ACM.15738	Lever, brake ... ..	1	L.40	C																		
27J/319	ACO.5503	Retainer, switch ... ..	1	Bakelite	C																		
27J/318	ACO.5514	Plate, insulating ... ..	1	Bakelite	C																		
27J/394	AC.12904	<b>MECHANISM, TRIGGER, GUN, ASSEMBLY</b>	1	—	A																		

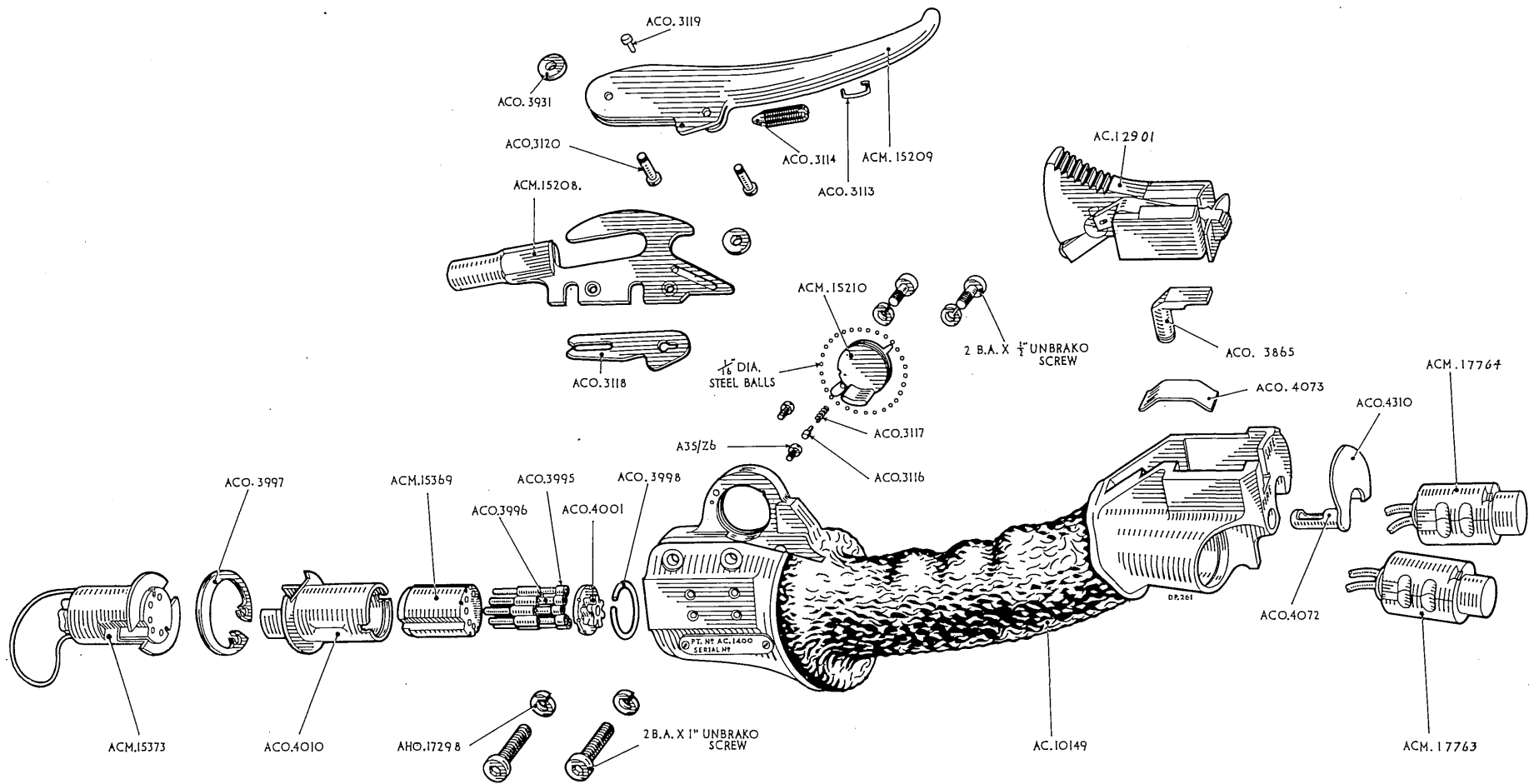

AC.1400

RESTRICTED

Ref. No.	Part No.	Description	No. Off	Matl. Spec.	Cl. of St.	Mark Applicability and No. Off Per Aircraft															
											F1	F3	FB 5	FB 9	NF 10	T 11			F 20	F 21	T 22
						1	2	3	4	5	M.R.										
27VA/3692	DH.120B/14	HOSE, ASSEMBLY (At Brake Pressure Gauge) ...	—	—	B					3											
26FC/10323	AHO.16203	HOSE, ASSEMBLY (At Compression Leg) ...	—	—	B	2	2	2	2	2					2	2	2				
26FC/587	AHO.17731	HOSE, ASSEMBLY (At Wheel Brake) ...	—	—	B	2	2	2	2						2	2					
26FC/556	DAS.160/16	HOSE, ASSEMBLY (At Wing Tanks) ...	—	—	B	2															
26FC/4633	DAS.160/21	HOSE, ASSEMBLY (At Wing Tanks) ...	—	—	B		2	2	2						2	2					
27VA/4856	GDH.120/B.18	HOSE, ASSEMBLY (Vampire Mod.3296) ...	—	—	B						1										
5D/1810	ACM.17780	PLUG, ASSEMBLY, COMPLETE (For use with Firing Units) ...	—	—	A	4	4	4	4	4	4				4	4					

ISSUED WITH AMENDMENT LIST No. 7

VAMPIRE & SEA VAMPIRE

RESTRICTED



Ref. No.	Part No.	Description	No. Off	Matl. Spec.	Cl. of St.	Mark Applicability and No. Off Per Aircraft																
											M.R.	F1	F3	FB 5	FB 9	NF 10	T 11			F 20	F 21	T 22
						1	2	3	4	5												
	AC.60246	<b>MOTOR, WINDSCREEN WIPER, ASSEMBLY</b> (Continued)																				
28M/13266	A.24/ES	Nut, slotted, 1/4" B.S.F., at bolts securing rack and pinion housing	1	—	C																	
28M/10326	AGS.2002/A/1	Nut, stiff, 6 BA., retaining valve...	1	—	C																	
28M/10288	AGS.2001/C/1	Nut, stiff, 2 BA., retaining piston	1	—	C																	
27WW/233	ACO.5696	Piece, distance	1	S.1 or S.48	C																	
27WW/534	ACO.21313	Piece, distance	1	S.80	C																	
27WW/137	AHO.21014	Pin, outer tube and catch	1	DTD.5 or DTD.215	C																	
27WW/188	ACO.6788	Pin, outer tube and valve stem	1	DTD.5 or DTD.215	C																	
27WW/136	AHO.22040	Pin, pivot, crank	1	S.2, S.11 or S.94	C																	
28P/12431	SP.9/C.6	Pin, split, 1/16" dia.	1	—	C																	
27WW/234	ACO.5698	Piston	1	S.1 or EN.6	C																	
28R/1396	AGS.216/A	Plug, 1/8" B.S.P.	3	—	C																	
28R/1397	AGS.216/B	Plug, 1/4" B.S.P., valve bore	1	—	C																	
27WW/189	ACO.6980	Plug, 1/8" B.S.P., valve bore	1	S.80	C																	
27WW/348	ACO.20551	Plug, banjo	2	S.1	C																	
27WW/427	ACO.9785	Plug, housing, pinion shaft, oil seal	1	BSS.249 or BSS.251	C																	
27WW/428	ACO.4594	Plug, retaining pinion, shaft bearing	1	L.64 or DTD.130	C																	
27WW/429	ACM.17356	<b>RACK AND PISTON ROD, GROUP</b>	1	—	C																	
27WW/238	ACO.5694	Retainer, oil seal	1	S.1 or EN.6	C																	
28S/2814	A.33/C.16	Screw, 2 BA., csk. hd., inspection cover	5	—	C																	
28F/12047	AGS.1186/A	Seal, bonded, 1/8" B.S.P. plug, inlet and outlet banjo	7	—	C																	
27WW/42	AHO.22044	Seal, inspection cover	1	Rubber No. 1151	C																	

VAMPIRE & SEA VAMPIRE

ISSUED WITH AMENDMENT LIST No. 7

Ref. No.	Part No.	Description	No. Off	Mati. Spec.	Cl. of St.	Mark Applicability and No. Off Per Aircraft															
						M.R.	F1	F3	FB 5	FB 9	NF 10	T 11	F 20	F 21	T 22						
	AC.60246	<b>MOTOR, WINDSCREEN WIPER, ASSEMBLY (Continued)</b>	—	—	—																
27WW/430	AHO.21386	Seal, pinion shaft ... ..	1	Gaco P.90	C																
27WW/231	AHO.22147	Seal, piston ... ..	1	Gaco E.90	C																
27WW/232	ACO.5695	Seal, piston rod ... ..	1	Gaco E.90	C																
27WW/37	AHO.21053	Seal, rack and pinion housing/body ... ..	1	Rubber Compound No. 614	C																
27WW/89	AHO.21038	Seal, valve stem ... ..	1	Gaco ZP.90	C																
	ACO.9861	Shaft, pinion ... ..	1	St.Stl.	C																
27WW/96	AHO.21021	Spring, valve mechanism ... ..	2	DTD.215	C																
27WW/432	ACO.9787	Stem, valve ... ..	1	S.94, S.95 or S.96	C																
27WW/194	ACO.5699	Stop, bottom ... ..	1	S.11 or S.95	C																
27WW/147	ACO.4457	Stop, top ... ..	1	S.80	C																
27WW/148	AHO.21010	Tube, locking ... ..	1	S.94, S.95 or S.96	C																
27WW/196	ACO.6790	Tube, outer ... ..	1	S.61, S.62 or S.80	C																
27WW/197	ACO.7286	Tube, stationary ... ..	1	S.80	C																
27WW/236	ACO.5808	Washer, at piston retaining nut ... ..	1	S.11 or S.95	C																
	ACO.27294	Washer, distance ... ..	1	M.S.	C																
27WW/237	ACO.5697	Washer, piston ... ..	1	S.1 or EN.6	C																
27WW/154	ACO.5809	Washer, retaining valve stem oil seal ... ..	1	S.11 or S.95	C																
28F/12083	AGS.1186/CC	Washer, sealing, parking cylinder ... ..	1	—	C																
28F/8215	AGS.1138/B	Washer, sealing, 1/4" B.S.P. ... ..	1	—	C																
27WW/155	AHO.22152	Washer, sealing, 1/2" B.S.P. plug ... ..	1	L.34	C																
27WW/536	ACO.4599	Washer, shim ... ..	1	Dural	C																
30A/3055	—	Wire, locking, 22 S.W.G. ... ..	QR	DTD.189	C																

RESTRICTED

Ref. No.	Part No.	Description	No. Off	Matl. Spec.	Cl. of St. M.R.	Mark Applicability and No. Off Per Aircraft															
						F1	F3	FB 5	FB 9	NF 10	T 11	F 20	F 21	T 22							
	AC.60246	<b>MOTOR, WINDSCREEN WIPER, ASSEMBLY (Continued)</b>	—	—	—																
		<b>TRANSPORTATION &amp; STORAGE ITEMS</b>																			
28F/11177	AGS.1159/A	Cap, cone	2	—	C																
28F/11018	AGS.1159/B	Cap, cone (Pre-Dunlop Amtd. 26681)	1	—	C																
28P/12587	SP.9/C.4	Pin, split	2	—	C																
28P/12431	SP.9/C.6	Pin, split	1	—	C																
28F/5721	AGS.904/A	Sleeve, outer	2	—	C																
28F/5722	AGS.904/B	Sleeve, outer	1	—	C																
ALL 28F/15504	AGS.1236/A.	loop, cone. (Dunlop Amtd. 26681)	2	—	C																
28F/15505	AGS.1236/B.	loop, cone. (Dunlop Amtd. 26681)	1	—	C																

VAMPIRE & SEA VAMPIRE

ISSUED WITH AMENDMENT LIST No. 7

RESTRICTED

VAMPIRE & SEA VAMPIRE

ISSUED WITH AMENDMENT LIST No. 7

Ref. No.	Part No.	Description	No. Off	Matl. Spec.	Cl. of St. M.R.	Mark Applicability and No. Off Per Aircraft																
						F1	F3	FB 5	FB 9	NF 10	T 11	F 20	F 21	T 22								
27A/2255	FC.9	<b>TUBE, INNER, MAIN WHEEL</b> (26×7-75—13) ... (Pre Dunlop Mod. 1589/Vampire Mod. 842 for Mks. F.1 and F.3 A/C, and pre Dunlop Mod. 1590/Vampire Mod. 842 for Mks. FB5 and FB9 A/C)  Spares for :—	—	—	B	2	2	2	2						2	2						
27A/3173	Schrader 2525	Cap, valve ... ..	1	—	C																	
27A/3174	Schrader 6100E	Core, valve ... ..	1	—	C																	
27A/2786	FC.7	<b>TUBE, INNER, MAIN WHEEL</b> (26×7-75—13) ... (Dunlop Mod. 1589/Vampire Mod. 842 for Mks. F1 and F3 A/C, and Dunlop Mod. 1590/Vampire Mod. 842 for Mks. FB.5 and FB.9 A/C)  Spares for :—	—	—	B	2	2	2	2	2	2											2
27A/3173	Schrader 2525	Cap, valve ... ..	1	—	C																	
27A/3174	Schrader 6100E	Core, valve ... ..	1	—	C																	
27A/2071	NF.2	<b>TUBE, INNER, NOSE WHEEL</b> (6-50—5½) ...  Spares for :—	—	—	B	1	1	1	1	1	1				1	1	1					
27A/3173	Schrader 2525	Cap, valve ... ..	1	—	C																	
27A/3174	Schrader 6100E	Core, valve ... ..	1	—	C																	



RESTRICTED

Ref. No.	Part No.	Description	No. Off	Matl. Spec.	Cl. of St.	Mark Applicability and No. Off Per Aircraft														
						M.R.														
						F1	F3	FB 5	FB 9	NF 10	T 11			F 20	F 21	T 22				
27G/2014	AH.8241	<b>VALVE, BRAKE RELAY, MARK 2, ASSEMBLY ...</b>	—	—	A	I	I	I	I	I	I				I	I	I			
		Spares for :—																		
27G/2012	AHO.19567	<b>BARREL, REGULATOR, GROUP</b> (Pre-delivered Unit 3005)	2	—	C															
27G/1900	AHM.289	Body, top ... ..	1	L.1	C															
27G/2269	AHO.26961*	Bolt, 2 BA, securing cover ... ..	4	DTD.398, S.1 or EN.6	C															
AL2. 28D/7030 i2513	A25/2C A25/2C	Bolt, 2 BA, securing cover ... .. (Alternative to AHO.26961)	4	—	C															
27G/2174	AHO.4868	Cap, adjustment, elevator rod ... ..	2	S.1 or EN.6	C															
27G/2218	AHO.17999	Connection, banjo, inlet and outlet ... ..	3	L.1	C															
27G/2159	ACO.3988	<b>CONNECTION, INLET, GROUP</b>	1	—	C															
27G/2016	AHO.20374	Connection, outlet ... ..	2	L.40	C															
27G/2009	AHO.18134	Head, exhaust ... ..	2	S.1 or EN.6	C															
27G/2013	AHO.17011	Key, locking, distance piece ... ..	2	DTD.161	C															
27G/2176	AHO.4869	Peg, locking, adjuster ... ..	2	DTD.181	C															
27G/2010	AHO.18133	Piece, distance, exhaust head ... ..	2	DTD.97	C															
27G/2011	AHO.4853	Pin, fulcrum, push rod and elevator rod ... ..	4	S.61 or S.62	C															
27G/1899	AHO.3576	Pin, hinge ... ..	4	S.61 or S.62	C															
27G/1870	AHO.4858	Plug, pressure ... ..	2	S.1 or EN.6	C															
27G/1898	AHO.4849	Plunger, exhaust ... ..	2	—	C															
27G/2179	AHO.26299	<b>ROD, PUSH, AND GLAND, GROUP ASSEMBLY</b>	2	—	C															
		Spares for :—																		
27G/1991	AHO.4723	← Sleeve ... ..	1	Rubber	C															
27G/2180	AHO.4870	Screw, adjustment, elevator rod ... ..	2	Silver	C															
27G/2169	AHO.3549	Screw, cheese head ... ..	8	S.2, S.11, S.65, S.69 or S.81	C															
28S/2766	A.31/C.16	Screw, cheese head ... ..	2	—	C															
27G/2181	AHO.3550	Screw, grub ... ..	2	S.80	C															
27G/2903	ACO 25010	Barrel Regulator Group (Pre-delivered Unit 3005)	2	—	A															

VAMPIRE AND SEA VAMPIRE

RESTRICTED

VAMPIRE AND SEA VAMPIRE

Ref. No.	Part No.	Description	No. Off	Matl. Spec.	Cl. of St.	Mark Applicability and No. Off Per Aircraft																
											M.R.	F1	F3	FB 5	FB 9	NF 10	T 11			F 20	F 21	T 22
						1	2	3	4	5												
	AH.8241	<b>VALVE, BRAKE RELAY, MARK 2, ASSEMBLY</b> (Continued)																				
	AHO.16277	Screw, locking, cable ... ..	1	S.1																		
27G/1878	AHO.16620	Seal, valve body ... ..	2	Rubber	C																	
27G/1876	AHO.16615	Seat, valve, inlet ... ..	2	S.61 or S.62	C																	
27G/2131	AHO.18130	Spring, pressure, auxiliary ... ..	2	DTD.215	C																	
	<del>AHO.22727</del>	<del>Spring, return, cable adjuster ... ..</del>	<del>1</del>	<del>DTD.215</del>	<del>C</del>																	
MVJ 27G/2020	AHO.4949/3-4	Springs, valve, exhaust, inner ... ..	1	DTD.215	C																	
27G/1872	AHO.4860	Spring, valve, inlet ... ..	2	DTD.215	C																	
27G/1873	AHO.17056	<b>VALVE, INLET, GROUP</b> ... ..	2	—	C																	
27G/2182	AHO.4948	Washer, adjustment cap ... ..	2	L.17	C																	
27G/1970	AHO.4727	Washer, connection ... ..	6	L.17 or L.34	C																	
27G/1871	AHO.4861	Washer, pressure ... ..	2	L.17	C																	
27G/2018	AHO.4878	Washer, sealing, push rod gland ... ..	2	Rubber Compound Dowty H.10	C																	
27G/1885	AHO.15876	Washer, sealing, stocking ... ..	2	Rubber Compound No. 410 or Dowty H.10	C																	
27G/2170	AHO.17298	Washer, spring ... ..	12	Spr. Stl.	C																	
27G/1879	AHO.16619	Washer, valve seat ... ..	2	Hard Black Rubber	C																	
30A/3055	—	Wire, locking, 22 SWG ... ..	QR	DTD.189	C																	

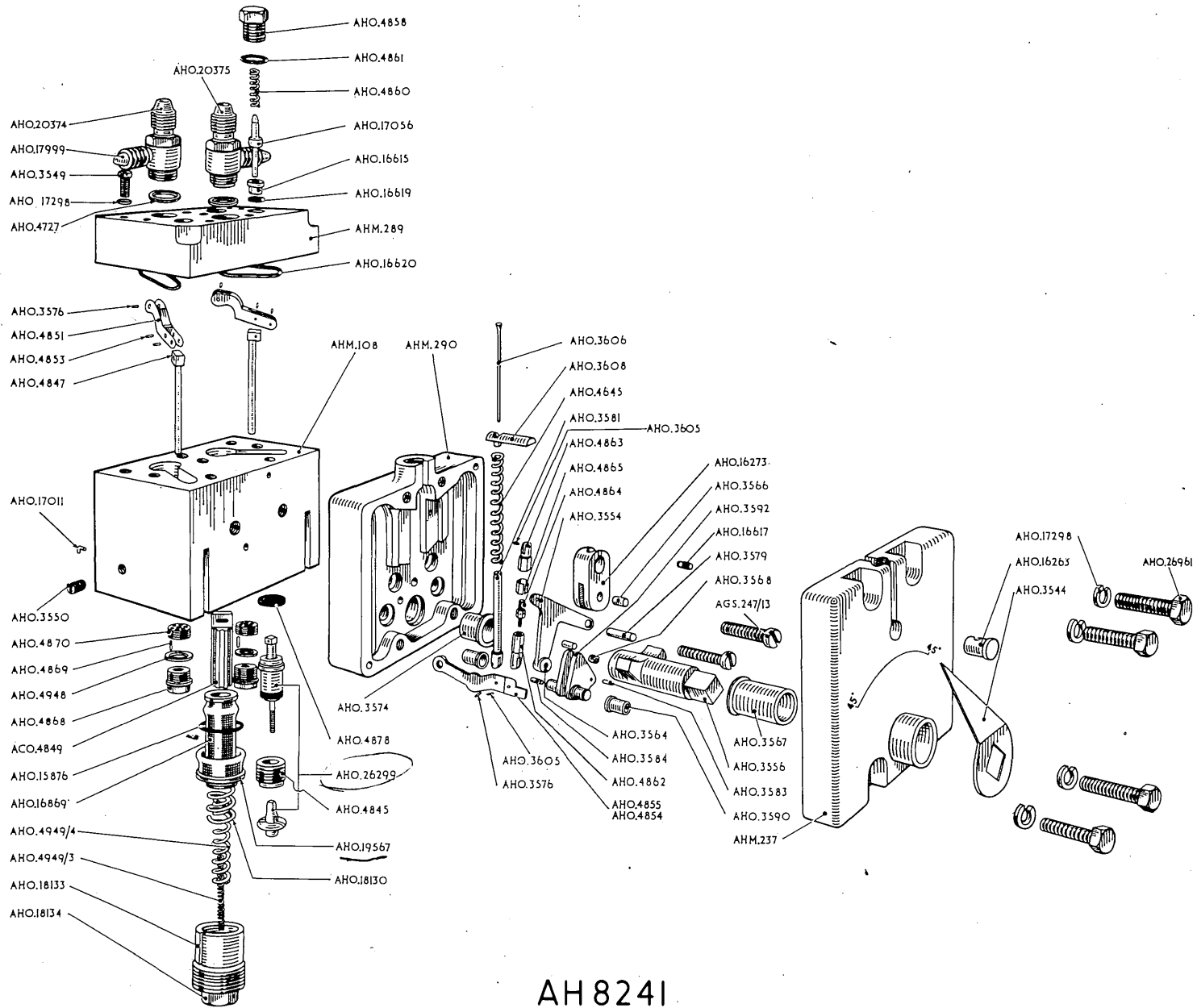

AH 8241





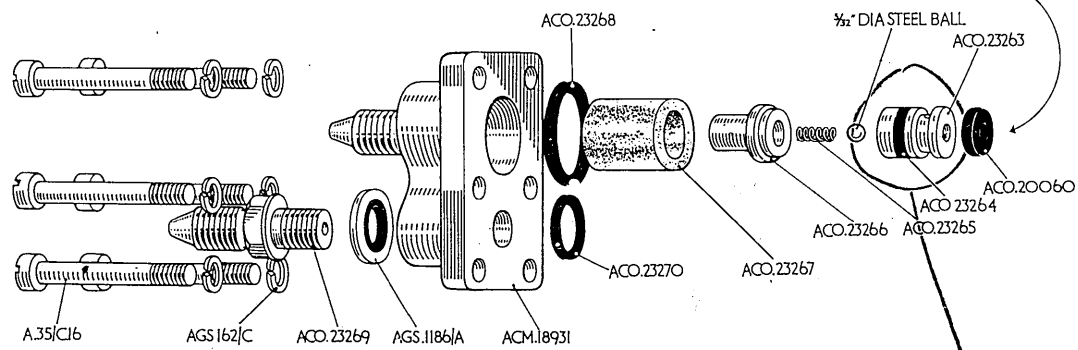
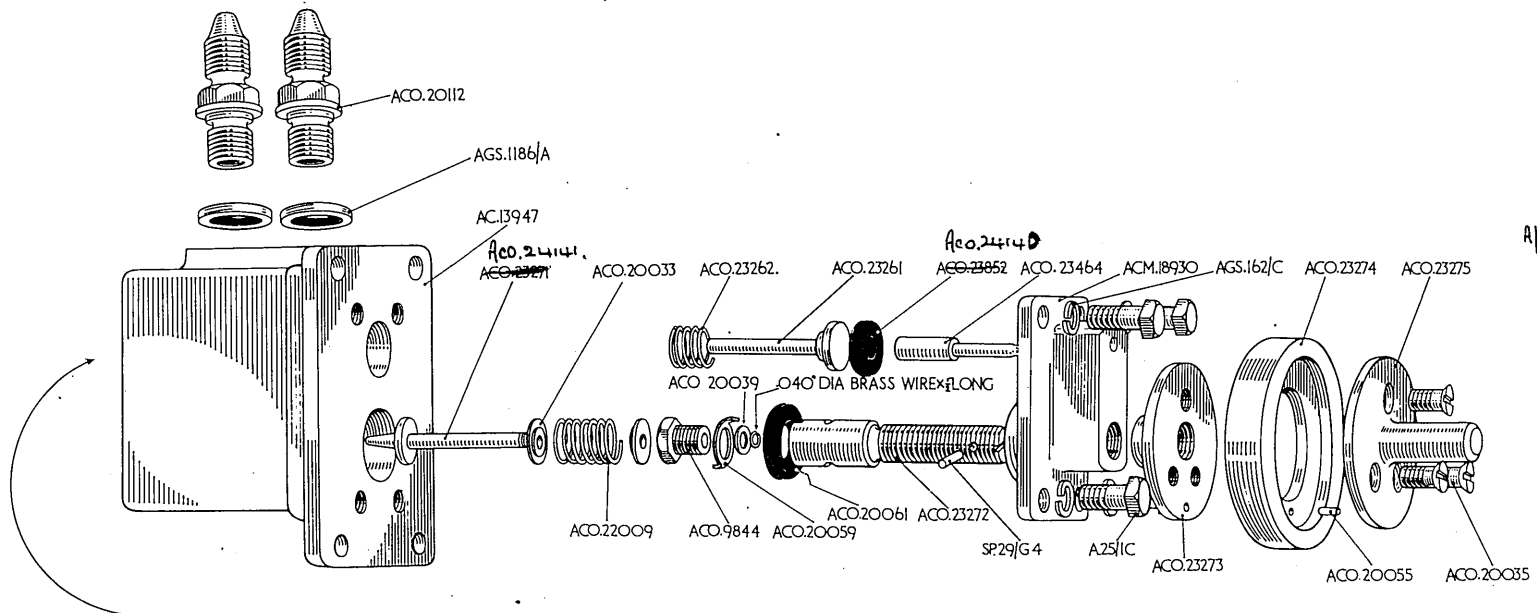

AC.13854

RESTRICTED

Ref. No.	Part No.	Description	No. Off	Matl. Spec.	Cl. of St.	Mark Applicability and No. Off Per Aircraft															
						M.R.															
						F1	F3	FB 5	FB 9	NF 10	T 11				F 20	F 21	T 22				
27G/2022	AHO.5712	<b>VALVE, PRESSURE REDUCING, ASSEMBLY</b> ...	—	—	<b>A</b>	I	I	I	I	I	I					I	I				
		Spares for :—																			
27G/2082	AHO.19249	<b>Adjuster, Spring</b> ...	I	L.1	C																
27G/2023	AHO.15502	<b>BELLCRANK AND LINKS, GROUP</b> ...	I	—	C																
27G/2066	AHO.18010	<b>BELLOWS, GROUP</b> ...	I	—	C																
27G/2088	AHO.19246	<b>Body, blow-off valve</b> ...	I	L.1 or L.40	C																
28D/12536	A.25/13C	<b>Bolt, 2 BA</b> ...	4	—	C																
27G/2026	AHO.15535	<b>Connection, delivery</b> ...	I	L.1, L.40 or DTD.297	C																
27G/2027	AHO.15534	<b>Connection, inlet</b> ...	I	S.61 or S.62	C																
27G/2028	AHO.15517	<b>Pin, bellcrank</b> ...	I	S.61 or S.62	C																
27G/2029	AHO.15512	<b>Pin, guide</b> ...	I	DTD.164 or Immadium 5	C																
27G/2030	AHO.15503	<b>Pin, swivel, spindle and valve</b> ...	2	S.61 or S.62	C																
27G/2085	AHO.19243	<b>Screw, adjusting</b> ...	I	S.61 or S.62	C																
27G/2134	AHO.19245	<b>Seat, blow-off valve</b> ...	I	S.80 or S.62	C																
27G/2034	AHO.16885	<b>Spring, blow-off valve</b> ...	I	DTD.215 or Terry's HD.1	C																
27G/2075	AHO.16151/2	<b>Spring, pressure, inner</b> ...	I	Terry's HD.1	C																
27G/2035	AHO.16151/1	<b>Spring, pressure, outer</b> ...	I	Terry's HD.1	C																

VAMPIRE AND SEA VAMPIRE

RESTRICTED

VAMPIRE AND SEA VAMPIRE

Ref. No.	Part No.	Description	No. Off	Matl. Spec.	Cl. of St. M.R.	Mark Applicability and No. Off Per Aircraft																	
						F1	F3	FB 5	FB 9	NF 10	T 11	F 20	F 21	T 22									
	AHO.5712	<b>VALVE, PRESSURE REDUCING, ASSEMBLY</b> (Continued)																					
27G/2127	AHO.19252	Valve, blow-off ... ..	1	—	C																		
27G/2037	AHO.15532	Valve, inlet, plunger, complete ... ..	1	—	C																		
27G/2038	AHO.15523	Washer, blow-off valve ... ..	1	Black Rubber Compound 4072	C																		
27G/2039	AHO.15526	Washer, sealing, connection ... ..	2	L.17	C																		
27G/2040	AHO.15513	Washer, sealing, valve casing ... ..	2	Black Rubber Compound 4072	C																		
28W/13889	SP.47/C	Washer, spring ... ..	4	—	C																		
30A/3055	—	Wire, locking, 22 SWG ... ..	QR	DTD.189	C																		

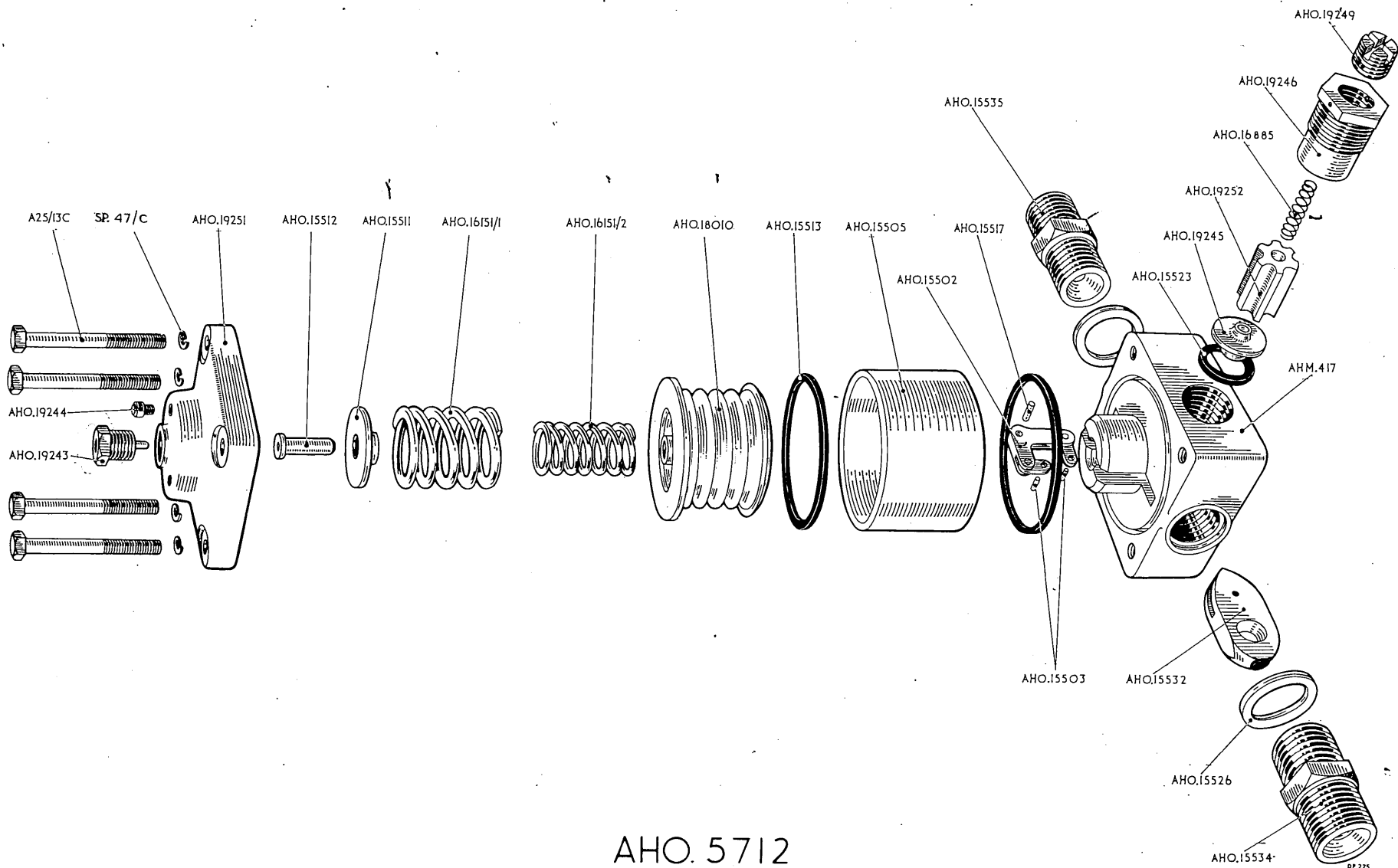

AHO. 5712

RESTRICTED

Ref. No.	Part No.	Description	No. Off	Matl. Spec.	Cl. of St.	Mark Applicability and No. Off Per Aircraft															
											FI	F3	FB 5	FB 9	NF 10	T 11			F 20	F 21	T 22
						1	2	3	4	5											
27G/2090	AHO.19682 —	<b>VALVE, PRESSURE REDUCING, ASSEMBLY</b> ...	—	—	<b>A</b>	I	I	I	I	I	I				I	I	I				
		Spares for :—																			
27G/2082	AHO.19249	<b>Adjuster</b> , spring ...	1	L.1	C																
27G/2023	AHO.15502	<b>BELLCRANK, AND LINKS, GROUP</b> ...	1	—	C																
27G/2083	AHO.19132 —	<b>BELLOWS, GROUP</b> ...	1	—	C																
27G/2086	AHO.19217	<b>Blank</b> , blow-off valve ...	1	S.61 or S.62	C																
27G/2088	AHO.19246	<b>Body</b> , blow-off valve ...	1	L.1	C																
28D/1253	A.25/1 <del>25</del> 13C	<b>Bolt</b> , 2 BA ...	4	—	C																
27G/2042	AHO.15539	<b>Connection</b> , delivery ...	1	L.1, L.40 or DTD.194	C																
27G/2084	AHO.19219	<b>Connection</b> , inlet ...	1	S.61 or S.62	C																
27G/2028	AHO.15517	<b>Pin</b> , bellcrank ...	1	S.61 or S.62	C																
27G/2030	AHO.15503	<b>Pin</b> , swivel, spindle and valve ...	2	S.61 or S.62	C																
27G/2085	AHO.19243	<b>Screw</b> , adjusting, delivery pressure ...	1	S.61 or S.62	C																
27G/2087	AHO.19216	<b>Spring</b> , pressure ...	1	Terry's HD.1	C																
27G/2089	AHO.19221	<b>Valve</b> , inlet plunger, complete ...	1	—	C																
27G/2038	AHO.15523	<b>Washer</b> , sealing, blow-off valve blank ...	1	Rubber Compound No. 4072	C																
27G/2039	AHO.15526	<b>Washer</b> , sealing, connection ...	2	L.17	C																
27G/2040	AHO.15513	<b>Washer</b> , sealing, valve casing ...	2	Rubber Compound No. 4072 or Dowty H.52	C																
28W/13889	SP.47/C	<b>Washer</b> , spring ...	4	—	C																
30A/3055	—	<b>Wire</b> , locking, 22 SWG ...	QR	DTD.189	C																

VAMPIRE AND SEA VAMPIRE

RESTRICTED

VAMPIRE AND SEA VAMPIRE

Ref. No.	Part No.	Description	No. Off	Matl. Spec.	Cl. of St.	Mark Applicability and No. Off Per Aircraft																
											M.R.	F1	F3	FB 5	FB 9	NF 10	T 11			F 20	F 21	T 22
						1	2	3	4	5												
27G/2081	AHO.19208	<b>VALVE, PRESSURE REDUCING (FUEL TRANSFER SYSTEM), ASSEMBLY</b> (Pre Vampire Mod. 683 for Mks. F3 and FB5 A/C) Spares for :—	—	—	A		1	2	2													
27G/2023	AHO.15502	<b>BELLCRANK AND LINKS, GROUP</b>	1	—	C																	
27G/2083	AHO.19132	<b>BELLOWS, GROUP</b>	1	—	C																	
27G/2088	AHO.19246	<b>Body, blow-off valve</b>	1	L.1 or L.40	C																	
28D/12536	A.25/ <del>13C</del> 13C	<b>Bolt, 2 BA</b>	4	—	C																	
27G/2042	AHO.15539	<b>Connection, delivery</b>	1	L.1, L.40 or DTD.194	C																	
27G/2084	AHO.19219	<b>Connection, inlet</b>	1	S.61 or S.62	C																	
27G/2028	AHO.15517	<b>Pin, bellcrank</b>	1	S.61 or S.62	C																	
27G/2030	AHO.15503	<b>Pin, swivel, spindle and valve</b>	2	S.61 or S.62	C																	
27G/2085	AHO.19243	<b>Screw, adjusting, delivery pressure</b>	1	S.61 or S.62	C																	
27G/2087	AHO.19216	<b>Spring, pressure</b>	1	Terry's HD.1	C																	
27G/2089	AHO.19221	<b>Valve, inlet plunger, complete</b>	1	—	C																	
27G/2038	AHO.15523	<b>Washer, sealing, blow-off valve blank</b>	1	Rubber Compound No. 4072	C																	
27G/2039	AHO.15526	<b>Washer, sealing, connection</b>	2	L.17	C																	
27G/2040	AHO.15513	<b>Washer, sealing, valve casing</b>	2	Rubber Compound No. 4072	C																	
28W/13889	SP.47/C	<b>Washer, spring</b>	4	—	C																	
30A/3055	—	<b>Wire, locking, 22 SWG</b>	QR	DTD.189	C																	
AL3 27G/2082	AHO19249	<i>Adjusted spring</i>	1	L.1	C																	
AL3 27G/2086	AHO 19217	<i>Blank, Blow off valve.</i>	1	S.61 or S.62	C																	

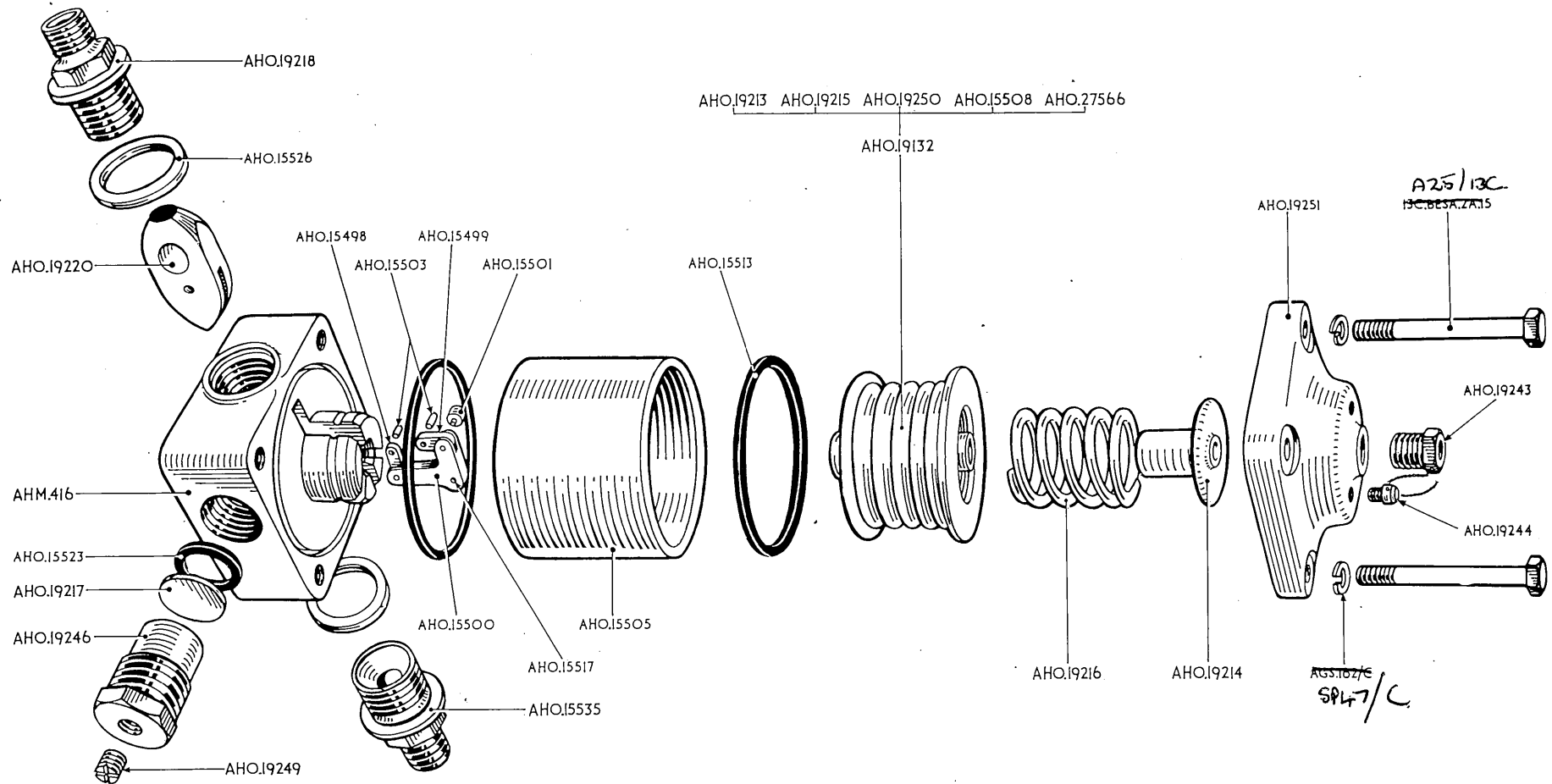

AHO.19682

RESTRICTED

Ref. No.	Part No.	Description	No. Off	Matl. Spec.	Cl. of St.	Mark Applicability and No. Off Per Aircraft															
											FI	F3	FB 5	FB 9	NF 10	T 11			F 20	F 21	T 22
						1	2	3	4	5											
27G/2107	ACO.3477	<b>VALVE, PRESSURE REDUCING (FUEL TRANSFER SYSTEM), ASSEMBLY</b> ... (Mks. F3 and FB5 A/C embodying Vampire Mod. 683. Pre Vampire/Sea Vampire Mod. 882 for all Mks. of A/C) Spares for :—	—	—	A		2	2		2					2	2					
27G/2136	ACO.3757	<b>Adjuster</b> , spring, blow-off valve ...	1	L.1	C																
27G/2023	AHO.15502	<b>BELLCRANK AND LINKS, GROUP</b> ...	1	—	C																
27G/2083	AHO.19132	<b>BELLOWS, GROUP</b> ...	1	—	C																
27G/2088	AHO.19246	<b>Body</b> , blow-off valve ...	1	L.1 or L.40	C																
28D/12536	A.25/120130	<b>Bolt</b> , 2 BA ...	4	—	C																
27G/2042	AHO.15539	<b>Connection</b> , delivery ...	1	L.1, L.40 or DTD.194	C																
27G/2084	AHO.19219	<b>Connection</b> , inlet ...	1	S.61 or S.62	C																
27G/2028	AHO.15517	<b>Pin</b> , bellcrank ...	1	S.61 or S.62	C																
27G/2030	AHO.15503	<b>Pin</b> , swivel, spindle and valve ...	2	S.61 or S.62	C																
27G/2085	AHO.19243	<b>Screw</b> , adjusting, delivery pressure ...	1	S.61 or S.62	C																
27G/2134	AHO.19245	<b>Seat</b> , blow-off valve ...	1	S.62 or S.80	C																
27G/2121	ACO.1118	<b>Spring</b> , blow-off valve ...	1	DTD.215	C																
27G/2087	AHO.19216	<b>Spring</b> , pressure ...	1	Terry's HD.1	C																
27G/2137	ACO.3756	<b>Valve</b> , blow-off ...	1	—	C																
27G/2089	AHO.19221	<b>Valve</b> , inlet plunger ...	1	—	C																

VAMPIRE AND SEA VAMPIRE

RESTRICTED

VAMPIRE AND SEA VAMPIRE

Ref. No.	Part No.	Description					No. Off	Matl. Spec.	Cl. of St.	Mark Applicability and No. Off Per Aircraft															
										M.R.															
										F1	F3	FB 5	FB 9	NF 10	T 11			F 20	F 21	T 22					
	ACO.3477	<b>VALVE, PRESSURE REDUCING, ASSEMBLY</b>																							
		(Continued)																							
27G/2038	AHO.15523	Washer, blow-off valve	...	...	...	...	1	Rubber Compound No. 4072	C																
27G/2039	AHO.15526	Washer, sealing, connection	...	...	...	...	2	L.17	C																
27G/2040	AHO.15513	Washer, sealing, valve casing	...	...	...	...	2	Rubber Compound No. 4072	C																
28W/13889	SP.47/C	Washer, spring	...	...	...	...	4	—	C																
30A/3055	—	Wire, locking, 22 SWG	...	...	...	...	QR	DTD.189	C																

RESTRICTED

Ref. No.	Part No.	Description	No. Off	Mati. Spec.	Cl. of St.	Mark Applicability and No. Off Per Aircraft															
						M.R.															
						F1	F3	FB 5	FB 9	NF 10	T 11			F 20	F 21	T 22					
27G/2153	ACO.4798	<b>VALVE, PRESSURE REDUCING (FUEL TRANSFER SYSTEM), ASSEMBLY</b> (Vampire/Sea Vampire Mod. 882. Pre Dunlop Mod. 1518/Vampire Mod. 3068 for Mk. F3 A/C, and pre Dunlop Mod. 1519/Vampire Mod. 3068 for Mks. FB5, FB9 and NF10 A/C)	—	—	A		2	2	2	2					2	2	2				
		Spares for :—																			
27G/2136	ACO:3757	<b>Adjuster, spring</b> ... ..	1	L.I	C																
27G/2023	AHO.15502	<b>BELLCRANK, AND LINKS, GROUP</b> ... ..	1	—	C																
27G/2083	AHO.19132	<b>BELLOWS, GROUP</b> ... ..	1	—	C																
27G/2088	AHO.19246	<b>Body, blow-off valve</b> ... ..	1	L.I or L.40	C																
28D/12536	A.25/12013C	<b>Bolt, 2:BA</b> ... ..	4	—	C																
27G/2042	AHO.15539	<b>Connection, delivery</b> ... ..	1	L.I or L.40	C																
27G/2084	AHO.19219	<b>Connection, inlet</b> ... ..	1	S.61 or S.62	C																
27G/2028	AHO.15517	<b>Pin, bellcrank</b> ... ..	1	S.61 or S.62	C																
27G/2030	AHO.15503	<b>Pin, swivel, spindle and valve</b> ... ..	2	S.61 or S.62	C																
27G/2085	AHO.19243	<b>Screw, adjusting</b> ... ..	1	S.61 or S.62	C																
27G/2134	AHO.19245	<b>Seat, blow-off valve</b> ... ..	1	S.62 or S.80	C																
27G/2121	ACO.1118	<b>Spring, blow-off valve</b> ... ..	1	DTD.215 or Terry's HD.I	C																
27G/2087	AHO.19216	<b>Spring, pressure</b> ... ..	1	Terry's HD.I	C																

VAMPIRE AND SEA VAMPIRE

RESTRICTED



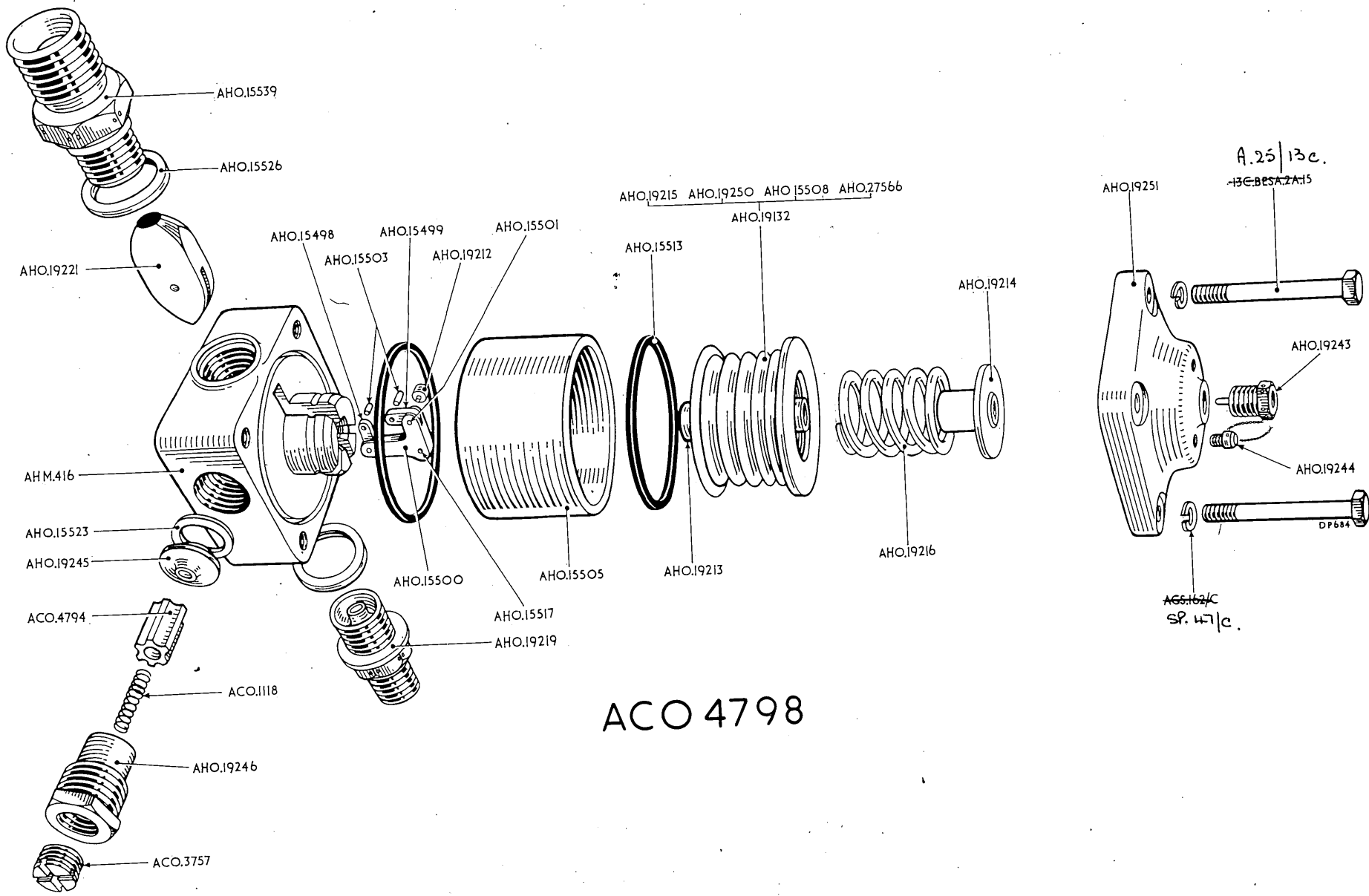

ACO 4798

RESTRICTED

Ref. No.	Part No.	Description	No. Off	Matl. Spec.	Cl. of St.	Mark Applicability and No. Off Per Aircraft																
											M.R.	F1	F3	FB 5	FB 9	NF 10	T 11			F 20	F 21	T 22
						1	2	3	4	5												
27VA/3400	ACM.16314	<b>VALVE, PRESSURE REDUCING (FUEL TRANSFER SYSTEM), ASSEMBLY</b> ... (Mk. F3 A/C embodying Dunlop Mod. 1518/Vampire Mod. 3068, and Mks. FB5, FB9 and NF10 A/C embodying Dunlop Mod. 1519/Vampire Mod. 3068)	—	—	A			2	2	2	2	2										
		Spares for :—																				
27G/2023	AHO.15502	<b>BELLCRANK, AND LINKS, GROUP</b> ...	1	—	C																	
27G/2083	AHO.19132	<b>BELLOWS, GROUP</b> ...	1	—	C																	
28D/12536	A.25/12C 13C	<b>Bolt</b> , 2 BA ...	4	—	C																	
27VA/3974	ACO.7798	<b>Bolt</b> , banjo ...	1	S.61 or S.62	C																	
28N/12353	AGS.2030/45	<b>Cirdip</b> , 1 $\frac{7}{16}$ " internal type ...	1	—	C																	
27G/2042	AHO.15539	<b>Connection</b> , delivery ...	1	L.1 or L.40	C																	
27G/2084	AHO.19219	<b>Connection</b> , inlet ...	1	S.61 or S.62	C																	
27VA/3975	ACO.7794	<b>COVER, AND GAUZE FILTER, GROUP</b> ...	1	—	C																	
27VA/3976	ACO.7364	<b>Holder</b> , seal ...	1	L.1	C																	
27VA/3977	ACO.7262	<b>Nut</b> , lock, adjusting screw ...	1	S.80	C																	
27G/2028	AHO.15517	<b>Pin</b> , bellcrank ...	1	S.61 or S.62	C																	
27G/2030	AHO.15503	<b>Pin</b> , swivel, spindle and valve ...	2	S.61 or S.62	C																	
27VA/3978	ACO.7374	<b>Ring</b> , sealing, banjo bolt and blow-off valve body ...	2	L.34	C																	
27VA/3979	ACO.7261	<b>Screw</b> , adjusting ...	1	S.61 or S.62	C																	
27VA/3980	ACO.7373	<b>Seal</b> , blow-off valve ...	1	Neoprene PXF or PXG	C																	

VAMPIRE AND SEA VAMPIRE

RESTRICTED

VAMPIRE AND SEA VAMPIRE

Ref. No.	Part No.	Description	No. Off	Matl. Spec.	Cl. of St.	Mark Applicability and No. Off Per Aircraft																
											M.R.	F1	F3	FB 5	FB 9	NF 10	T 11			F 20	F 21	T 22
						1	2	3	4	5												
	ACM.16314	<b>VALVE, PRESSURE REDUCING, ASSEMBLY</b> (Continued)																				
27G/2087	AHO.19216	Spring, pressure ... ..	1	Terry's HD.1	C																	
27VA/3981	ACO.7851	Springs, inner and outer, blow-off valve	1 set	DTD.215	C																	
27VA/3982	ACO.7363	Valve, blow-off ... ..	1	S.85	C																	
27G/2089	AHO.19221	Valve, inlet plunger, complete ... ..	1	—	C																	
27G/2039	AHO.15526	Washer, sealing, connection ... ..	2	L.17	C																	
27G/2040	AHO.15513	Washer, sealing, valve casing ... ..	2	Rubber Compound No. 4072	C																	
28W/13889	SP.47/C	Washer, spring ... ..	4	—	C																	
30A/3055	—	Wire, locking, 22 SWG ... ..	QR	DTD.189	C																	

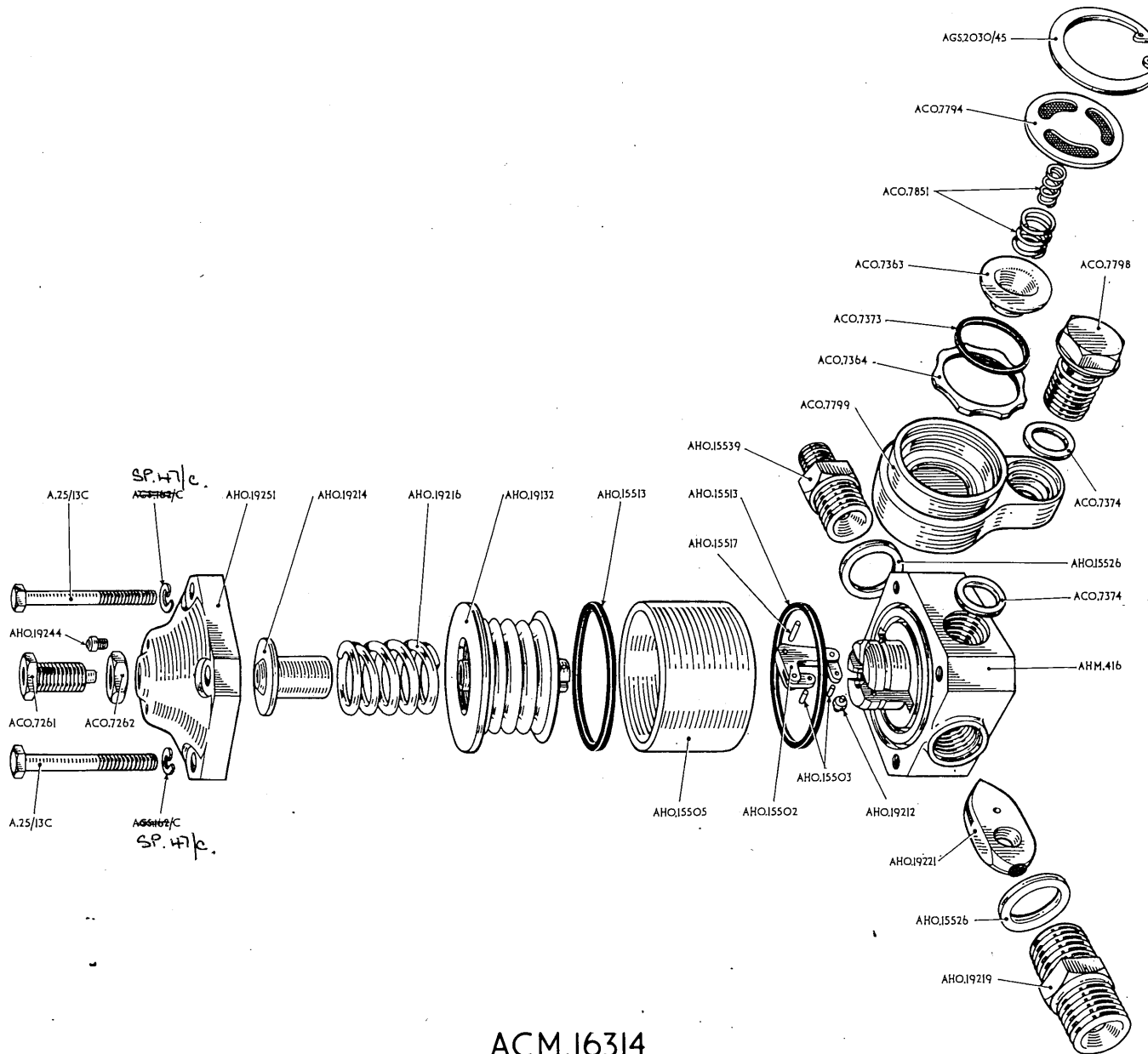

ACM.16314



VAMPIRE & SEA VAMPIRE

ISSUED WITH AMENDMENT LIST No. 3

Ref. No.	Part No.	Description	No. Off	Matl. Spec.	Cl. of St.	Mark Applicability and No. Off Per Aircraft														
						M.R.	F1	F3	FB 5	FB 9	NF 10	T 11		F 20	F 21	T 22				
		1 2 3 4 5																		

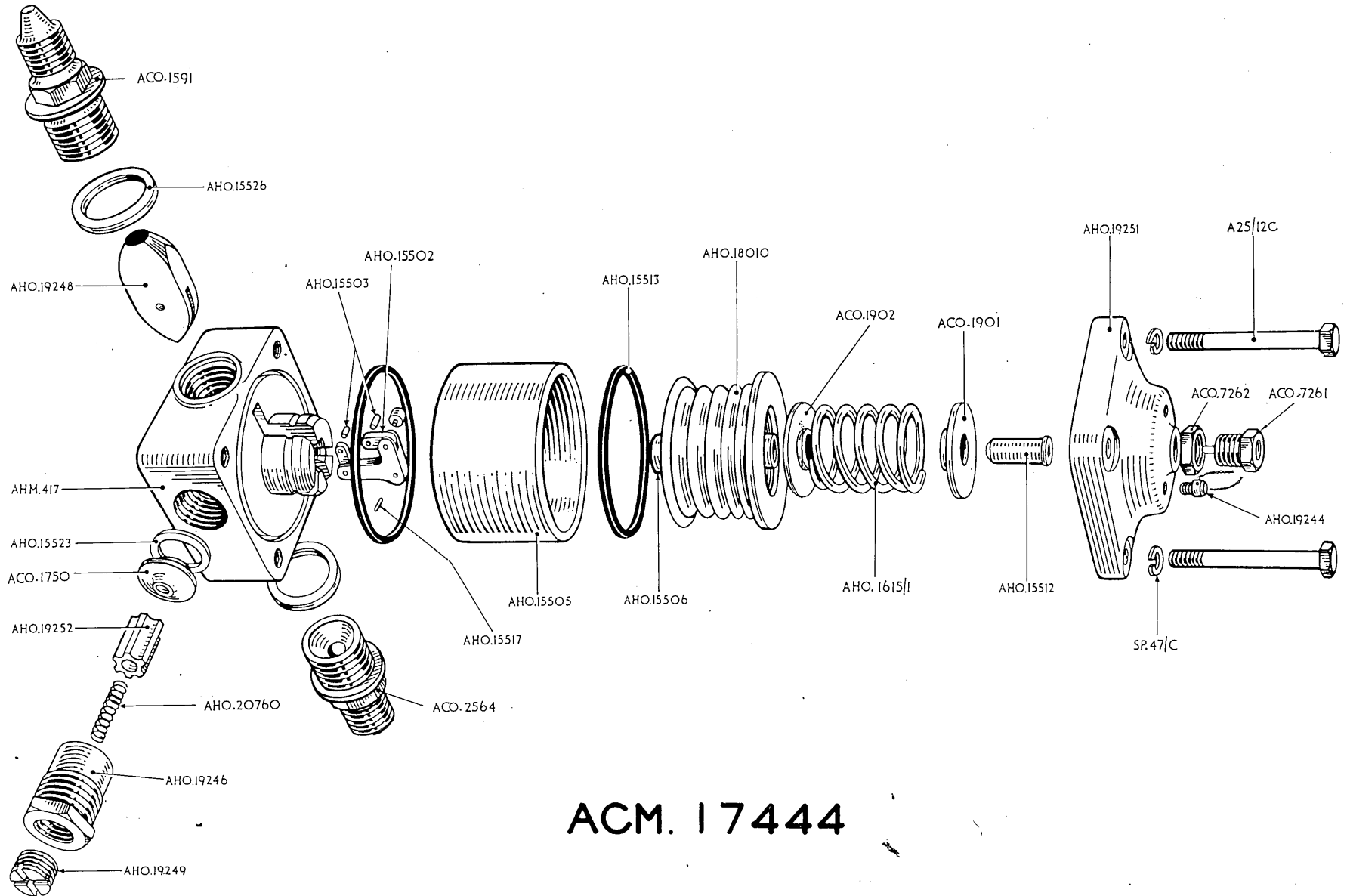

ACM. 17444

RESTRICTED

Ref. No.	Part No.	Description	No. Off	Matl. Spec.	Cl. of St.	Mark Applicability and No. Off Per Aircraft													
						M.R.						No. Off Per Aircraft							
						F1	F3	FB 5	FB 9	NF 10	T 11	F 20	F 21	T 22					
27A/2086	AH.8218	<b>WHEEL, MAIN UNDERCARRIAGE, ASSEMBLY</b> Pre Dunlop Mod. 1589/Vampire Mod. 842 for Mks. F1 and F3 A/C, and pre Dunlop Mod. 1590/Vampire Mod. 842 for Mks. FB5 and FB9 A/C)	—	—	A	2	2	2	2					2	2				
7 27S/309-	BSS.BRL.040 or Skefco 6208 or Hoffmann 140 or R.&M. LJ.40 or Fischer 6208	Bearing, ball (3 spot) ... ..	1	—	B														
7 27S/103-	BSS.BRL.050 or Skefco 6210 or Hoffmann 150 or R.&M. LJ.50 or Fischer 6210	Bearing, ball (3 spot) ... ..	1	—	B														
27A/2393	AHO.16608	Bolt, brake drum ... ..	6	H.T.S. "Unbrako"	C														
27A/2385	AHO.17682	Drum, brake ... ..	1	Quality Dunlop Spec. 33	C														
27A/2477	AHO.17132	Excluder ... ..	1	L.3 or DTD.910	C														
27A/2473	AH.7146	Flange	1	DTD.289	C														
27A/2475	AHO.17219	Housing, oil seal ... ..	1	L.39, DTD.423 or DTD.297	C														
27A/2105	AHO.3913	Nut, excluder ... ..	3	S.I	C														
27A/2222	AH. 40423	Flange (Dunlop Mod 2091)	1	—	C														

VAMPIRE AND SEA VAMPIRE

RESTRICTED

RESTRICTED

Ref. No.	Part No.	Description	No. Off	Matl. Spec.	Cl. of St.	Mark Applicability and No. Off Per Aircraft														
											M.R.	F1	F3	FB 5	FB 9	NF 10	T 11	F 20	F 21	T 22
						1	2	3	4	5										
27A/2086	AH.8218	<b>WHEEL, MAIN UNDERCARRIAGE, ASSEMBLY</b> Pre Dunlop Mod. 1589/Vampire Mod. 842 for Mks. F1 and F3 A/C, and pre Dunlop Mod. 1590/Vampire Mod. 842 for Mks. FB5 and FB9 A/C)	—	—	A	2	2	2	2						2	2				
AL-214/500057 7 27S/309-	BSS.BRL.040 or Skefco 6208 or Hoffmann 140 or R.&M. LJ.40 or Fischer 6208	Bearing, ball (3 spot) ... ..	1	—	B															
AL-214/500059 7 27S/103-	BSS.BRL.050 or Skefco 6210 or Hoffmann 150 or R.&M. LJ.50 or Fischer 6210	Bearing, ball (3 spot) ... ..	1	—	B															
27A/2393	AHO.16608	Bolt, brake drum ... ..	6	H.T.S. "Unbrako"	C															
27A/2385	AHO.17682	Drum, brake ... ..	1	Quality Dunlop Spec. 33	AC															
27A/2477	AHO.17138	Excluder ... ..	1	L.3 or DTD.910	C															
27A/2473	AH.7146 *	Flange (see Dunlop Mod 2091) ... ..	1	DTD.289	C															
27A/2475	AHO.17210	Housing, oil seal ... ..	1	L.39, DTD.423 or DTD.297	C															
27A/2105	AHO.3913	Nut, excluder ... ..	3	S.I	C															
214/3232	Alt. 40423	Flange (Dunlop Mod 2091)	1	—	C															

VAMPIRE AND SEA VAMPIRE

RESTRICTED





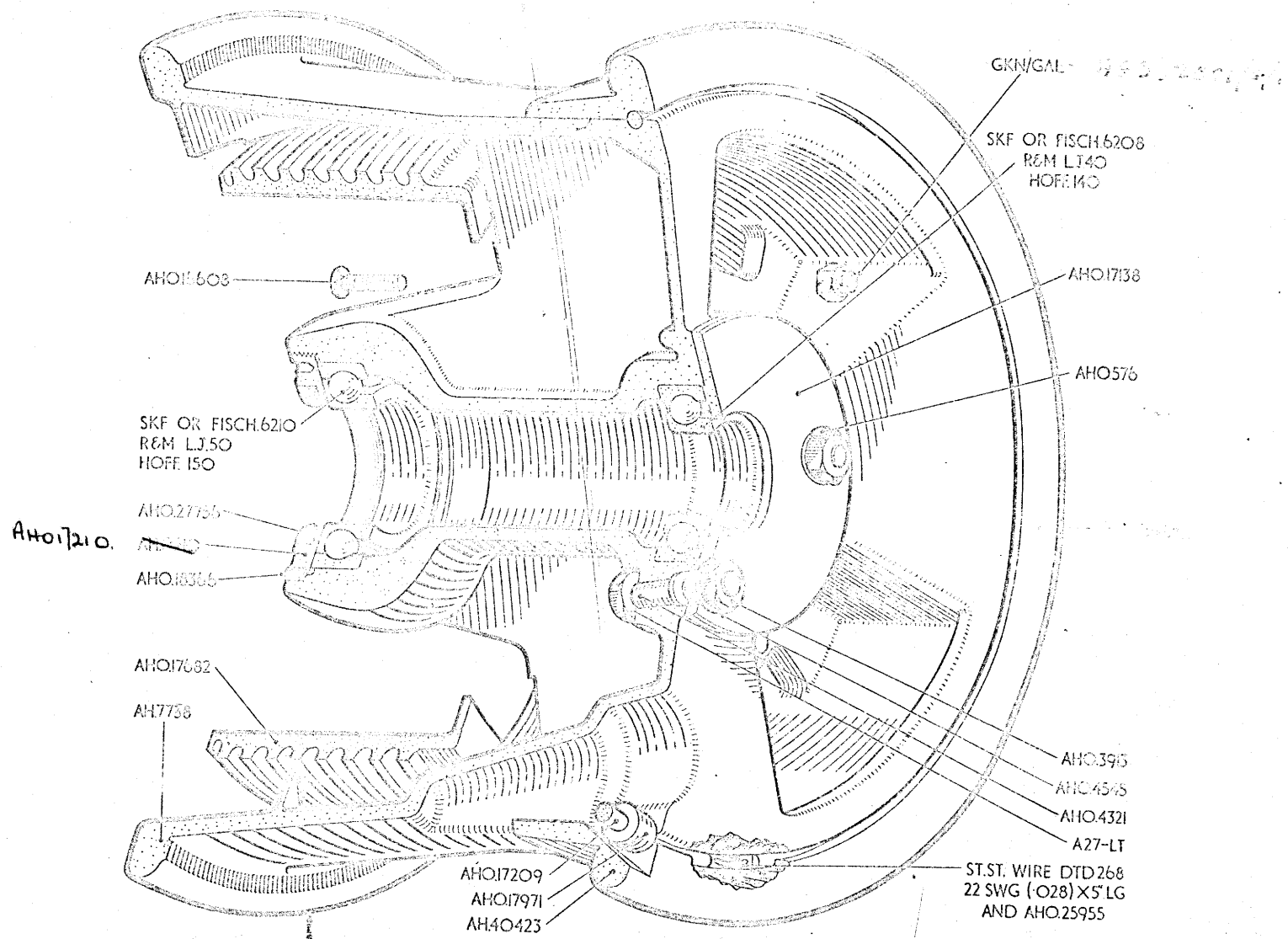

AHO17210

AH 8218

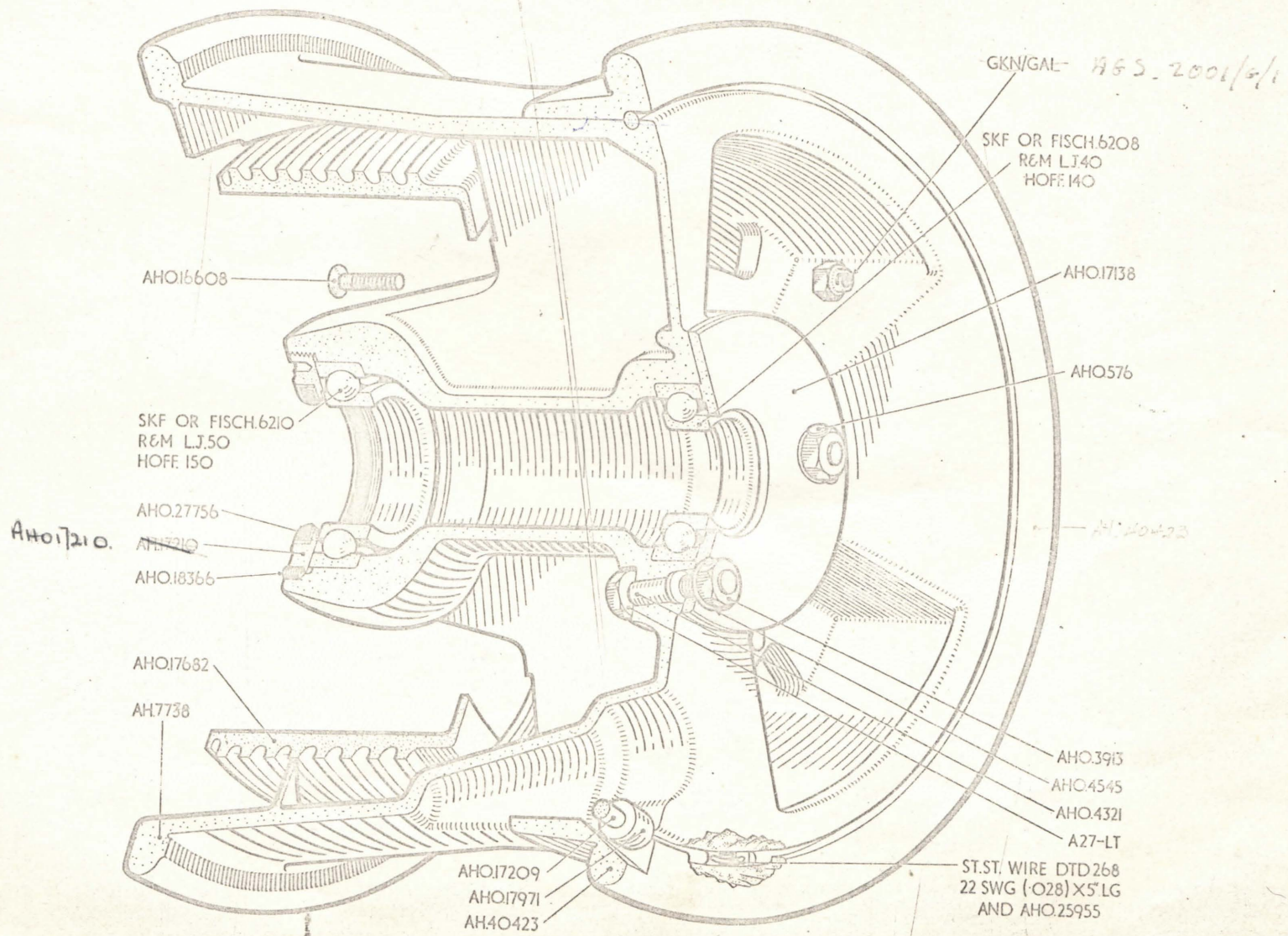

AH 8218

RESTRICTED

Ref. No.	Part No.	Description	No. Off	Matl. Spec.	Cl. of St. M.R.	Mark Applicability and No. Off															
											FI	F3	FB 5	FB 9	FB 10	T 11			F 20	F 21	F 22
						1	2	3	4	5											
27A/2785	AH.9139	WHEEL, MAIN UNDERCARRIAGE, ASSEMBLY (Mks. FI and F3 embodying Dunlop Mod. 1589/Vampire Mod. 842, and Mks FB5 and FB9 A/C embodying Dunlop Mod. 1590/Vampire Mod. 842)	—	—	A	2	2	2	2	2	2							2			
27S/309	BSS.BRL.040 or Skefko 6208 or Fischer 6208 or R.&M. LJ.40 or Hoffmann 140	Bearing, ball (3 spot) ... ..	1	—	B																
27S/103	BSS.BRL.050 or Skefko 6210 or Fischer 6210 or R.&M. LJ.50 or Hoffmann 150	Bearing, ball (3 spot) ... ..	1	—	B																
27A/2393	AHO.16603	Bolt, brake drum ... ..	6	H.T.S. "Unbrako"	C																
27A/2830	AHO.25171	Bolt, hub ... ..	3	Quality S.2, S.11, S.65, S.69, or S.81	C																
28N/12964	AGS.2030/112	Clamp, 3 1/2" internal type ... ..	1	—	C																
27A/2831	AHO.25185	Drum, brake ... ..	1	—	C																
27A/2832	AHO.25173	Excluder ... ..	1	L.39 or L.45	C																
27A/2807	AHO.35318	Drum, brake (Alternative to 27A/2831, AND 2808 when brake drum 276/404, AH.30829 is used.)	1	—	A																

VAMPIRE AND SEA VAMPIRE

RESTRICTED

RESTRICTED

Ref. No.	Part No.	Description	No. Off	Matl. Spec.	Cl. of St.	Mark Applicability and No. Off Per Aircraft															
											F1	F3	FB 5	FB 9	NF 10	T 11			F 20	F 21	T 22
						1	2	3	4	5											
27A/2785	AH.9139	<b>WHEEL, MAIN UNDERCARRIAGE, ASSEMBLY</b> (Mks. F1 and F3 embodying Dunlop Mod. 1589/Vampire Mod. 842, and Mks FB5 and FB9 A/C embodying Dunlop Mod. 1590/Vampire Mod. 842)	—	—	A	2	2	2	2	2	2							2			
<i>A/L 7 27S/309-20/930057</i>	BSS.BRL.040 or Skefko 6208 or Fischer 6208 or R.&M. LJ.40 or Hoffmann 140	Bearing, ball (3 spot) ... ..	1	—	B																
<i>A/L 7 27S/403-20/930059</i>	BSS.BRL.050 or Skefko 6210 or Fischer 6210 or R.&M. LJ.50 or Hoffmann 150	Bearing, ball (3 spot) ... ..	1	—	B																
27A/2393	AHO.16608	Bolt, brake drum ... ..	6	H.T.S. "Unbrako"	C																
27A/2830	AHO.25171	Bolt, hub ... ..	3	Quality S.2, S.11, S.65, S.69, or S.81	C																
28N/12964	AGS.2030/112	Circlip, 3 3/4" internal type ... ..	1	—	C																
27A/2831	AHO.25185	Drum, brake ... ..	1	—	<i>AC</i>																
27A/2832	AHO.25173	Excluder ... ..	1	L.39 or L.45	C																
<i>A/L 2 27A/2687</i>	<i>AHO.35348</i>	<i>Drum, brake (Alternative to 27A/2831, AHO.25185 when brake unit 276/410's, AH.50829 is used.)</i>	1	—	A																

VAMPIRE AND SEA VAMPIRE

RESTRICTED



RESTRICTED

Ref. No.	Part No.	Description	No. Off	Matl. Spec.	Cl. of St.	Mark Applicability and No. Off Per Aircraft																
											M.R.	F1	F3	FB 5	FB 9	NF 10	T 11			F 20	F 21	T 22
						1	2	3	4	5												
27A/2069	AHO.17219	<b>WHEEL, NOSE, ASSEMBLY</b> ... ..	—	—	A	I	I	I	I	I	I					I	I	I				
<del>27A/102</del> 2A/4500056	BSS.BRL.035 or Fischer 6207 or Hoffmann 135 or R.&M.LJ.35 or Skefko 6207	Spares for :— <b>Bearing</b> , ball (3 spot) ... ..	2	—	B																	
PL2 27A/1969	Schrader 9352525	<b>Cap</b> , valve extension ... ..	1	—	C																	
27A/1113	Schrader 1015	<b>Extension</b> , valve ... ..	1	—	C																	
27A/2479	AHM.346/1	<b>Flange</b> ... ..	1	—	C																	
27A/2137	AHO.3167	<b>Ring</b> , locating ... ..	2	—	C																	
27A/2480	AHO.16993	<b>Ring</b> , lock, c/w Collar AHO.16153 ... ..	1	—	C																	
27A/2482	AHO.17403	<b>Ring</b> , retaining, bearing ... ..	2	—	C																	
27A/2476	AHO.18366/2	<b>Screw</b> , grub ... ..	4	—	C																	
27A/2481	AHO.17402	<b>Tube</b> , spacer ... ..	1	—	C																	
30A/3055	—	<b>Wire</b> , locking, 22 SWG ... ..	QR	—	C																	
<del>27A/102</del>	<del>NFR3</del>	<del>Cover Outer Nose Wheel (6.50x5.1)</del> <del>Excluded from T11 &amp; T20 only.</del>	1	—	A																	



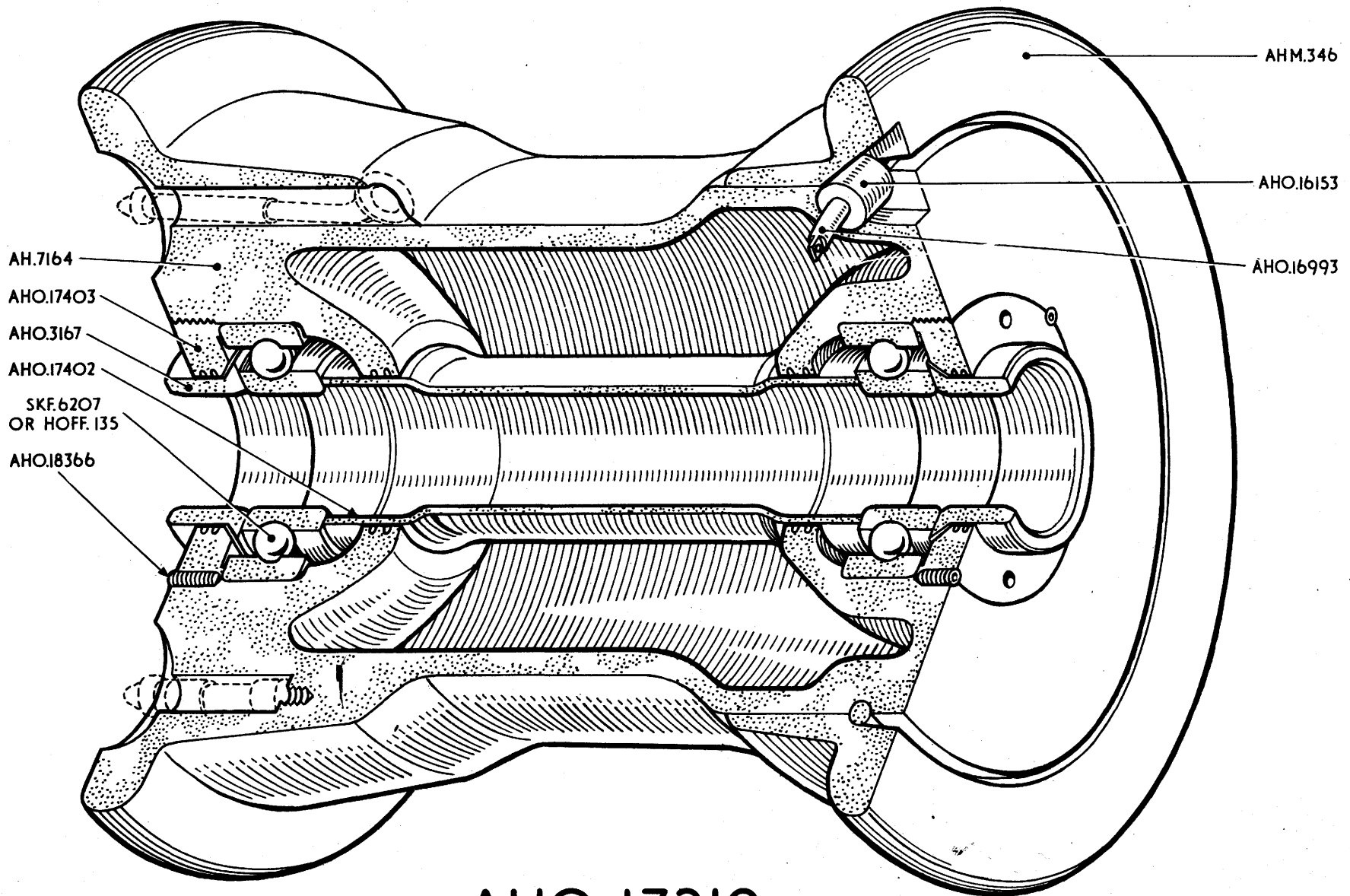

AHO 17219

RESTRICTED  
SERVICING TOOLS

UNIT			TOOLS REQUIRED			
Ref. No.	Part No.	Description	Ref. No.	Part No.	Description	No. Off
27VW/506	ACM.17376	<b>ARM, ACTUATING, WINDSCREEN WIPER ASSEMBLY</b> ... (For Spares Details see page 1)			No special tools required.	
<sup>all</sup> 27WV/599	ACM.19552/8	<b>BLADE, WINDSCREEN WIPER ASSEMBLY</b> ...			No special tools required.	
27G/4067	AH.9140	<b>BRAKE UNIT</b> ... ..	27G/4805	AM.6247	<b>Lever</b> , tension spring ... ..	1
27G/4105	AH.50329	<b>BRAKE UNIT</b> ... .. (For Spares Details see pages 5 and 7)		Britool No. 1111	<b>Wrench</b> ... ..	1
27G/1994	AHO.2337	<b>FILTER, AIR, ASSEMBLY</b> ... ..	27G/5324	AO.101006	<b>PLATE, ASSEMBLY, AIR BAG.</b>	1
27G/2091	ACO.1268	<b>FILTER, AIR, ASSEMBLY</b> ... .. (For Spares Details see page 10)	27VA/3734	AO.6838	<b>Spanner</b> , ring, for air filter cap ... ..	1
5D/1489	AH.8360	<b>FIRING UNIT (MAXIFLUX)</b> ... ..		AO.33698	<b>Base</b> , for holding body ... ..	1
5D/1737	AC.11066	<b>FIRING UNIT (MAXIFLUX)</b> ... .. (For Spares Details see pages 11 and 12)		AO.25582	<b>Gauge</b> , go plunger "Up" position ... ..	1
				AO.25583	<b>Gauge</b> , max-min, plunger "Down" position ... ..	1
				AO.33667	<b>Spanner</b> , special, for locking nut ... ..	1
27J/250	AC.1400	<b>HANDLE, CONTROL, ASSEMBLY</b> ... .. (For Spares Details see pages 17 and 18)		A.2965	<b>Pliers</b> , crimping ... ..	1
27J/252	AC.10300	<b>HANDLE, CONTROL, ASSEMBLY</b> ... .. (For Spares Details see page 18)			No special tools required.	
27J/235	AH.8400	<b>HANDLE, CONTROL, RING, ASSEMBLY</b> ... .. (For Spares Details see pages 13, 14, 15, 16)	27J/341	AO.45631	<b>Spanner</b> , peg, for pin centre lever ... ..	1
			27J/340	AO.45626	<b>Spanner</b> , pin, for centre catch ... ..	1

## VAMPIRE &amp; SEA VAMPIRE

ISSUED WITH AMENDMENT LIST No. 7

UNIT			TOOLS REQUIRED			
Ref. No.	Part No.	Description	Ref. No.	Part No.	Description	No. Off
27G/2014	AH.8241	<b>VALVE, BRAKE RELAY, MARK 2, ...</b> <b>ASSEMBLY</b> ... .. (For Spares Details see pages 27 and 28)	27G/2407	AO.100001	<b>Gauge</b> , 1-766", for push rods ... ..	1
			27G/2095	AO.17746	<b>Gauge</b> , filing, for inlet valve pins ... ..	1
			27G/2330	AO.45115	<b>Key</b> , adjusting, for lever slide ... ..	1
			27G/2328	AO.18396	<b>Peg</b> , for raising push rods (assembly of beam control) ... ..	1
			27G/2329	AO.17218	<b>Punch</b> , assembly, for inlet plug ... ..	1
			27G/2331	AO.13557	<b>Spanner</b> , peg, for adjusting screw of elevator rod	1
27G/2096	AO.13149	<b>Spanner</b> , peg, for heading cap (gland assembly)	1			
27G/2022	AHO.5712	<b>VALVE, PRESSURE REDUCING, ...</b> <b>ASSEMBLY</b> ... .. (For Spares Details see pages 31 and 32)	27G/2097	AO.19761	<b>Tool</b> , for inserting pin, inlet plunger valve ...	1
27G/2090	AHO.19682	<b>VALVE, PRESSURE REDUCING, ...</b> <b>ASSEMBLY</b> ... .. (For Spares Details see page 33)	27G/2097	AO.19761	<b>Tool</b> , for inserting pin, inlet plunger valve ...	1
27G/2081	AHO.19208	<b>VALVE, PRESSURE REDUCING, (FUEL</b> <b>TRANSFER SYSTEM), ASSEMBLY</b> ... .. (For Spares Details see page 34)	27G/2097	AO.19761	<b>Tool</b> , for inserting pin, inlet plunger valve ...	1
27G/2107	AC0.3477	<b>VALVE, PRESSURE REDUCING (FUEL</b> <b>TRANSFER SYSTEM), ASSEMBLY</b> ... .. (For Spares Details see pages 35 and 36)	27G/2097	AO.19761	<b>Tool</b> , for inserting pin, inlet plunger valve ...	1
27WW/505	AC.13854	<b>VALVE, CONTROL AND PARKING ...</b> <b>WINDSCREEN WIPER, ASSEMBLY</b> ... .. (For Spares Details see pages 29 and 30)			No special tools required.	
27VA/5003	ACM.17444	<b>VALVE, PRESSURE REDUCING, ...</b> <b>ASSEMBLY</b> ... .. (For Spares Details see page 41)	27G/2097	AO.19761	<b>Tool</b> , for inserting pin, inlet plunger valve ...	1

## SERVICING TOOLS

RESTRICTED

RESTRICTED  
SERVICING TOOLS

UNIT			TOOLS REQUIRED			
Ref. No.	Part No.	Description	Ref. No.	Part No.	Description	No. Off
27G/2153	ACO.4798	<b>VALVE, PRESSURE REDUCING (FUEL TRANSFER SYSTEM), ASSEMBLY</b> (For spares details see pages 37 and 38)	27G/2097	AO.19761	Tool, for inserting pin, inlet plunger valve ...	1
27VA/3400	ACM.16314	<b>VALVE, PRESSURE REDUCING (FUEL TRANSFER SYSTEM), ASSEMBLY</b> (For spares details see pages 39 and 40)	27G/2097	AO.19761	Tool, for inserting pin, inlet plunger valve ...	1
27A/2086	AH.82'8	<b>WHEEL, MAIN UNDERCARRIAGE, ASSEMBLY</b> (For spares details see pages 45 and 46)	27A/3085	AO.42853*	Base and Mandrel assembly ...	1
			27A/3104	AO.46505	Box, stud, $\frac{7}{16}$ " BSF ...	1
			27A/3061	AO.41720*	Collar ...	1
			27A/3052	AO.41557	Cutter, countersink, for brake drum ...	1
			27A/3045	AM.9410†	Extractor, bearing, large bearing ...	1
			27A/3074	AM.9967†	Extractor, bearing, small bearing ...	1
			27A/3081	AO.25155	Jig, drill, for grub screw holes, bearing retainer	1
			27A/3090	AM.9971	Mandrel, alignment, and gap gauge for bearings	1
			27A/3047	AM.10796†	Mandrel, pressing out, for bearings ...	1
			27A/3062	AO.24404	Punch, peening, $\frac{3}{16}$ " Whit. grub screw ...	1
			27A/3053	AO.33421	Screw, set, for brake drum ...	2
			27A/3049	AO.42466*	Sleeve, large bearing ...	1
			27A/3099	AO.42856*	Sleeve, small bearing ...	1
			27A/3101	AM.3371	Spanner, peg, for oil seal housing ...	1
			27A/4462.	AO.106115	SPANNER, TORQUE, VALVE CORE	1

NOTE : Items marked thus \* are used in conjunction with each other to press in bearings.

Items marked thus † are used in conjunction with each other to press out bearings.

A/L3

VAMPIRE & SEA VAMPIRE

ISSUED WITH AMENDMENT LIST No. 1.

UNIT			TOOLS REQUIRED						
Ref. No.	Part No.	Description	Ref. No.	Part No.	Description	No. Off			
27A/2785	AH.9139	<b>WHEEL, MAIN UNDERCARRIAGE, ASSEMBLY</b> (For spares details see pages 47 and 48)	27A/3085	AO.42853*	Base and Mandrel, assembly ... ..	1			
			27A/3061	AO.41720*	Collar ... ..	1			
			27A/3052	AO.41557	Cutter, countersink, for brake drum ... ..	1			
			27A/3068	AM.9784†	Extractor, bearing, large bearing ... ..	1			
			27A/3075	AM.9990†	Extractor, bearing, small bearing ... ..	1			
			27A/3091	AM.9986	Mandrel, alignment and gap gauge, for bearings	1			
			27A/3303	AO.49998†	Mandrel, pressing out, for bearings ... ..	1			
			27A/3053	AO.33421	Screw, set, for brake drum ... ..	2			
			27A/3049	AO.42466*	Sleeve, large bearing ... ..	1			
			27A/3099	AO.42856*	Sleeve, small bearing ... ..	1			
			27A/4462	AO.106115	SPANNER, TORQUE, VALVE CORE	1			
			NOTE : Items marked thus * are used in conjunction with each other to press in bearings.						
Items marked thus † are used in conjunction with each other to press out bearings.									
27A/2069	AHO.17219	<b>WHEEL, NOSE, ASSEMBLY</b> (For spares details see page 53)	27A/3048	AO.42469*	Base and Mandrel, assembly ... ..	1			
			27A/3067	AO.45784*	Collar ... ..	1			
			27A/3078	AM.10052†	Extractor, bearing ... ..	1			
			27A/3082	AO.33583	Jig, drill ... ..	1			
			27A/3092	AM.10022	Mandrel, alignment, bearing and gap gauge, for locating ring	1			
			27A/3334	AO.49915†	Mandrel, pressing out, for bearings ... ..	1			
			27A/3062 2646	AO.24404	Punch, peening, 3/16" Whit. grub screw ... ..	1			
			27A/3050	AO.42468*	Sleeve ... ..	2			
			27A/3102	AO.33582	Spanner, adjustable peg, for bearing retainer ...	1			
			Spares for :—						
			27A/3093	AO.45004	Peg, 1/8" dia ... ..	2			
			27A/4462	AO.106115	SPANNER, TORQUE, VALVE CORE	1			
NOTE : Items marked thus * are used in conjunction with each other to press in bearings.									
Items marked thus † are used in conjunction with each other to press out bearings.									

SERVICING TOOLS

**INDEX OF REFERENCE NUMBERS  
VAMPIRE AND SEA VAMPIRE**

Ref. No.	Part No.	Page	Ref. No.	Part No.	Page
2A/9424323	$\frac{1}{8}$ " Ball	20	27A/1113	Schrader	53
2A/9500056	3 spot Bearing	53		Extension 1015	
2A/9500057	3 spot Bearing	45, 47	27A/2069	AHO.17219	53, 64
2A/9500059	3 spot Bearing	45, 47	27A/2070	NF-R30	9
2A/9500415	1 spot Bearing	20	27A/2071	NF.2	24
2A/9500563	$\frac{1}{16}$ " Ball	17	27A/2086	AH.8218	45, 63
2A/9500566	$\frac{5}{32}$ " Ball	29	27A/2087	FC-R17-N	9
			27A/2098	AHO.576/1	46
			27A/2105	AHO.3913	45, 48
5D/1489	AH.8360	11, 61	27A/2106	AHO.4545	46, 48
5D/1590	AHO.18922	11, 12	27A/2137	AHO.3167	53
5D/1591	AHO.18500	11, 12	27A/2199	AHO.18552	46, 48
5D/1593	AHO.18494	11, 12	27A/2222	FC-R16-N	9
5D/1594	AHO.18924	11, 12	27A/2255	FC.9	24
5D/1595	AHO.18836	11, 12	27A/2385	AHO.17682	45
5D/1597	AHM.391	11, 12	27A/2393	AHO.16608	45, 47
5D/1598	AHO.18504	11	27A/2439	AHO.17209	46
5D/1599	AHO.18505	11, 12	27A/2473	AH.7146	45
5D/1600	AHO.18490	11, 12	27A/2475	AHO.17210	45
5D/1601	AHO.18475	11, 12	27A/2476	AHO.18366/2	46, 53
5D/1602	AHO.18467	11, 12	27A/2477	AHO.17138	45
5D/1603	AHO.18474	11, 12	27A/2478	AHO.4321	46
5D/1736	ACO.5767	11, 12	27A/2479	AHM.346/1	53
5D/1737	AC.11066	12, 61	27A/2480	AHO.16993	53
5D/1809	ACO.20233	12	27A/2481	AHO.17402	53
5D/1810	ACM.17780	19	27A/2482	AHO.17403	53
			27A/2646	AO.24404	63, 64
			27A/2658	AHO.22527	48
			27A/2675	AHO.18822/2	48
			27A/2785	AH.9139	47, 64
5K/2578	"Hellerman" Sleeve No. 3	16	27A/2786	FC.7	24
			27A/2830	AHO.25171	47
			27A/2831	AHO.25185	47
			27A/2832	AHO.25173	47
			27A/2833	AHO.25172	48
			27A/2834	AH.7724	48
26FC/556	DAS.160/16	19	27A/2835	AHO.26408	48
26FC/587	AHO.17731	19	27A/2836	AHO.25192	48
26FC/4633	DAS.160/21	19	27A/3027	AHO.27756	46, 48
26FC/6455	ACM.16525	9	27A/3045	AM.9410	63
26FC/6566	ACM.16980	9	27A/3047	AM.10796	63
26FC/10323	AHO.16203	19	27A/3048	AO.42469	64
			27A/3049	AO.42466	63, 64
			27A/3050	AO.42468	64
			27A/3052	AO.41557	63, 64
			27A/3053	AO.33421	63, 64
			27A/3061	AO.41720	63, 64
			27A/3067	AO.45784	64
			27A/3068	AM.9784	64
			27A/3070	AM.10052	64
			27A/3074	AM.9967	63
			27A/3075	AM.9990	64
			27A/3081	AO.25155	63

**INDEX OF REFERENCE NUMBERS  
VAMPIRE AND SEA VAMPIRE**

Ref. No.	Part No.	Page	Ref. No.	Part No.	Page
27A/3082	AO.33583	64	27G/2026	AHO.15535	31
27A/3085	AO.42853	63, 64	27G/2027	AHO.15534	31
27A/3090	AM.9971	63	27G/2028	AHO.15517	31, 33, 34, 35, 37, 39, 41
27A/3091	AM.9986	64			
27A/3092	AM.10022	64	27G/2029	AHO.15512	31, 41
27A/3093	AO.45004	64	27G/2030	AHO.15503	31, 33, 34, 35, 37, 39, 41
27A/3099	AO.42856	63, 64			
27A/3101	AM.3371	63	27G/2034	AHO.16885	31
27A/3102	AO.33582	64	27G/2035	AHO.16151/1	31, 41
27A/3104	AO.46505	63	27G/2037	AHO.15532	32, 41
27A/3173	Schrader Cap 2525	24, 53	27G/2038	AHO.15523	32, 33, 34, 36, 38, 41
27A/3174	Schrader Core 6100E	24	27G/2039	AHO.15526	32, 33, 34, 36, 38, 40, 41
27A/3232	AH.40423	45	27G/2040	AHO.15513	32, 33, 34, 36, 38, 40, 41
27A/3233	AH.40424	48			
27A/3303	AO.49998	64	27G/2042	AHO.15539	33, 34, 35, 37, 39
27A/3334	AO.49915	64			
27A/3433	NF-R.31	9	27G/2066	AHO.18010	31, 41
27A/3687	AHO.35345	47	27G/2075	AHO.16151/2	31
27A/4072	"Parker Kalon" Peg - $\frac{1}{4}$ "	15	27G/2081	AHO.19208	34, 62
27A/4462	AO.106115	62	27G/2082	AHO.19249	31, 33, 34, 41
			27G/2083	AHO.19132	33, 34, 35, 37, 39
			27G/2084	AHO.19219	33, 34, 35, 37, 39
27G/1848	AHO.4186	16	27G/2085	AHO.19243	31, 33, 34, 35, 37
27G/1870	AHO.4858	27			
27G/1871	AHO.4861	28	27G/2086	AHO.19217	33, 34
27G/1872	AHO.4860	28	27G/2087	AHO.19216	33, 34, 35, 37, 40
27G/1873	AHO.17056	28			
27G/1876	AHO.16615	28	27G/2088	AHO.19246	31, 33, 34, 35, 37, 41
27G/1878	AHO.16620	28			
27G/1879	AHO.16619	28	27G/2089	AHO.19221	33, 34, 35, 38, 40
27G/1885	AHO.15876	28			
27G/1898	AHO.4849	27	27G/2090	AHO.19682	33, 62
27G/1899	AHO.3576	27	27G/2091	ACO.1268	10, 61
27G/1900	AHM.289	27	27G/2095	AO.17746	62
27G/1970	AHO.4727	10, 28	27G/2096	AO.13149	62
27G/1991	AHO.4723	27	27G/2097	AO.19761	62, 63
27G/1994	AHO.2337	10, 61	27G/2107	ACO.3477	35, 62
27G/1998	AHO.1666	10	27G/2116	ACO.1283	10
27G/2000	AHO.1056	10	27G/2120	AHO.20760	41
27G/2009	AHO.18134	27	27G/2121	ACO.1118	35, 37
27G/2010	AHO.18133	27	27G/2127	AHO.19252	32, 41
27G/2011	AHO.4853	27	27G/2131	AHO.18130	28
27G/2012	AHO.19567	27	27G/2134	AHO.19245	31, 35, 37
27G/2013	AHO.17011	27	27G/2135	ACO.1750	41
27G/2014	AH.8241	27, 62	27G/2136	ACO.3757	35, 37
27G/2016	AHO.20374	27	27G/2137	ACO.3756	35
27G/2018	AHO.4878	28			
27G/2022	AHO.5712	31, 62			
27G/2023	AHO.15502	31, 33, 34, 35, 37, 39, 41			

**INDEX OF REFERENCE NUMBERS  
VAMPIRE AND SEA VAMPIRE**

Ref. No.	Part No.	Page	Ref. No.	Part No.	Page
27G/2153	ACO.4798	37, 63	27J/12	AHO.3515	14
27G/2154	AHO.1068	10	27J/21	AHO.2117	15
27G/2159	ACO.3988	27	27J/25	AHO.3516	15
27G/2169	AHO.3549	27	27J/26	AHO.2112	14
27G/2170	AHO.17298	14, 18, 28	27J/27	AHO.3514	15
27G/2174	AHO.4868	27	27J/191	AHO.16886	14
27G/2176	AHO.4869	27	27J/202	AH.8200	13
27G/2179	AHO.26299	27	27J/207	AHO.17311	13
27G/2180	AHO.4870	27	27J/208	AHO.17443	14
27G/2181	AHO.3550	27	27J/209	AHO.17334	13
27G/2182	AHO.4948	28	27J/210	AH.7160	13
27G/2218	AHO.17999	27	27J/211	AHO.17319	14
27G/2269	AHO.26961	27	27J/212	AHO.17309	14
27G/2320	AHO.4949/3.4	28	27J/213	AHO.17391	13
27G/2328	AO.18396	62	27J/214	AHO.17356	14
27G/2329	AO.17218	62	27J/215	AHO.17338	14
27G/2330	AO.45115	62	27J/216	AHO.17305	13, 14
27G/2331	AO.13557	62	27J/217	AHO.17304	14
27G/2407	AO.100001	62	27J/222	AHO.17321	13
27G/2484	ACO.8991	10	27J/223	AHO.17326	13
27G/2903	ACO.25010	27	27J/225	AHO.17313	13
27G/4024	AH.8219	3	27J/226	AHO.17442	13
27G/4046	AH.8902	4	27J/235	AH.8400	13, 61
27G/4067	AH.9140	5, 61	27J/237	AHM.402	13
27G/4105	AH.50329	7, 61	27J/250	AC.1400	17, 61
27G/4508	AHO.1139	3, 4	27J/252	AC.10300	18, 61
27G/4511	AHO.492/5	3, 4	27J/263	AHO.18722	15
27G/4518	AHO.17031	3, 4	27J/273	ACO.3118	17
27G/4522	AHO.17032	3, 4	27J/274	ACM.15209	17, 18
27G/4529	AHO.16939	3, 4	27J/275	ACO.3119	17
27G/4619	AHO.17411	3, 4	27J/276	ACO.3120	17
27G/4620	AHO.17949	3, 4	27J/277	ACO.3931	17
27G/4621	AHO.17410	3, 4	27J/278	ACO.3114	17
27G/4705	AHO.25499	3, 4	27J/279	'Unbrako Screw'	17
27G/4708	AHO.25097	5, 7	27J/280	'Unbrako Screw'	17
27G/4709	AHO.23035	5, 7	27J/282	ACO.3998	17
27G/4711	AHO.23020	5, 7	27J/285	ACO.3113	18
27G/4712	AHO.23040	5, 7	27J/290	AHO.18702	15
27G/4713	AHO.23019	5, 7	27J/293	ACM.15210	17
27G/4714	AHO.23037	5	27J/294	ACO.3997	17
27G/4805	AM.6247	61	27J/295	ACO.3996	17
27G/4839	AHO.25160	5	27J/296	ACO.3995	17
27G/4840	AHO.25170	5	27J/298	ACO.3116	17
27G/4841	AHO.26470	3, 4	27J/299	ACO.3865	17, 18
27G/4898	AHO.27955	3, 4	27J/300	ACO.3117	18
27G/5202	AHO.29658	7	27J/301	ACO.4073	18
27G/5324	AO.1010006	61	27J/309	ACO.4310	17, 18
27G/5403	AHO.35386	5, 7	27J/316	AHM.406	15
27G/5434	AHO.35385	3, 4	27J/317	ACM.15738	18
27G/6106	AHO.38858	3, 4	27J/318	ACO.5514	18
			27J/319	ACO.5503	18
			27J/325	AHO.26729	15
			27J/326	AHO.18707	15
			27J/327	AHO.18721	15
			27J/328	AHO.18714	15

**INDEX OF REFERENCE NUMBERS  
VAMPIRE AND SEA VAMPIRE**

Ref. No.	Part No.	Page	Ref. No.	Part No.	Page
27J/329	AHO.18718	15	27WW/189	ACO.6980	21
27J/330	AHO.18719	15	27WW/194	ACO.5699	22
27J/331	AHO.26654	16	27WW/196	ACO.6790	22
27J/332	'Microflex' Sleeve	16	27WW/197	ACO.7286	22
27J/340	AO.45626	61	27WW/210	ACO.4653	1
27J/341	AO.45631	61	27WW/231	AHO.22147	22
27J/367	AHO.18758	15	27WW/232	ACO.5695	22
27J/389	ACM.17764	18	27WW/233	ACO.5696	21
27J/390	ACM.17763	18	27WW/234	ACO.5698	21
27J/391	AC.12901	17, 18	27WW/236	ACO.5808	22
27J/394	AC.12904	18	27WW/237	ACO.5697	22
27J/447	AC.13450	17	27WW/238	ACO.5694	21
			27WW/348	ACO.20551	20, 21
			27WW/349	ACO.4598	20
			27WW/350	ACO.20523	20
27VA/3250	ACO.1591	41			
27VA/3400	ACM.16314	39, 63	27WW/420	ACO.9812	1
27VA/3692	DH.120B/14	19	27WW/421	ACO.9813	1
27VA/3734	AO.6838	61	27WW/423	ACO.9780	20
27VA/3974	ACO.7798	39	27WW/424	ACO.9786	20
27VA/3975	ACO.7794	39	27WW/425	ACO.9784	20
27VA/3976	ACO.7364	39	27WW/427	ACO.9785	21
27VA/3977	ACO.7262	39, 41	27WW/428	ACO.4594	21
27VA/3978	ACO.7374	39	27WW/429	ACM.17356	21
27VA/3979	ACO.7261	39, 41	27WW/430	AHO.21386	22
27VA/3980	ACO.7373	39	27WW/432	ACO.9787	22
27VA/3981	ACO.7851	40	27WW/434	ACO.20112	29
27VA/3982	ACO.7363	40	27WW/436	ACO.9844	29
27VA/4332	ACO.2564	41	27WW/437	ACO.20055	29
27VA/4856	GDH.120/B.18	19	27WW/440	ACO.20040	29
27VA/5003	ACM.17444	41, 62	27WW/443	ACO.20035	30
			27WW/444	ACO.20060	30
			27WW/445	ACO.20061	30
			27WW/455	ACO.20039	30
27WW/37	AHO.21053	22	27WW/456	ACO.20059	30
27WW/42	AHO.22044	21	27WW/457	ACO.20033	30
27WW/63	ACO.2669	1	27WW/488	ACO.20550	20
27WW/89	AHO.21038	22	27WW/489	ACO.21757	20
27WW/96	AHO.21021	22			
27WW/130	AHO.21015	20	27WW/505	AC.13854	29, 62
27WW/131	AHO.21020	20	27WW/506	ACM.17376	1, 61
27WW/136	AHO.22040	21	27WW/507	ACM.18350/8	1
27WW/137	AHO.21014	21	27WW/511	ACO.22009	30
27WW/147	ACO.4457	22	27WW/534	ACO.21313	21
27WW/148	AHO.21010	22	27WW/535	ACO.22682	20
27WW/154	ACO.5809	22	27WW/536	ACO.4599	22
27WW/155	AHO.22152	22	27WW/537	ACO.23269	29
27WW/182	ACO.4096	1	27WW/538	ACO.23267	29
27WW/183	ACO.4097	1	27WW/539	ACO.23268	29
27WW/188	ACO.6788	21	27WW/540	ACO.23270	29

**INDEX OF REFERENCE NUMBERS  
VAMPIRE AND SEA VAMPIRE**

Ref. No.	Part No.	Page	Ref. No.	Part No.	Page
27WW/580	ACO.23261	30			
27WW/581	ACO.23264	29			
27WW/582	ACO.24140	30			
27WW/583	ACO.23265	30			
27WW/584	ACO.23262	30			
27WW/585	ACO.23263	30			
27WW/598	ACM.19552/8	1, 61			
27WW/608	ACO.23274	29			
27WW/611	ACO.23273	29			
27WW/612	ACO.23266	29			
27WW/615	ACO.23272	30			
27WW/616	ACO.24141	30			
27WW/627	AC.60246	20			

**INDEX OF REFERENCE NUMBERS  
VAMPIRE AND SEA VAMPIRE**

Ref. No.	Part No.	Page	Ref. No.	Part No.	Page

**INDEX OF PART NUMBERS  
VAMPIRE AND SEA VAMPIRE**

Part No.	Ref. No.	Page	Part No.	Ref. No.	Page
AC.1400	27J/250	17, 18, 61	ACO.3756	27G/2137	35
AC.10300	27J/252	18, 61	ACO.3757	27G/2136	35, 37
AC.11066	5D/1737	12, 61	ACO.3865	27J/299	17, 18
AC.11078	—	12	ACO.3931	27J/277	17
AC.12901	27J/391	17, 18	ACO.3988	27G/2159	27
AC.12904	27J/394	18	ACO.3995	27J/296	17
AC.13450	27J/447	17	ACO.3996	27J/295	17
AC.13854	27WW/505	29, 30, 62	ACO.3997	27J/294	17
AC.60246	27WW/627	20, 21, 22, 23	ACO.3998	27J/282	17
			ACO.4073	27J/301	18
			ACO.4096	27WW/182	1
			ACO.4097	27WW/183	1
			ACO.4310	27J/309	17, 18
			ACO.4457	27WW/147	22
			ACO.4594	27WW/428	21
			ACO.4598	27WW/349	20
ACM.15209	27J/274	17, 18	ACO.4599	27WW/536	22
ACM.15210	27J/293	17	ACO.4653	27WW/210	1
ACM.15373	—	17	ACO.4794	—	38
ACM.15738	27J/317	18	ACO.4798	27G/2153	37, 38, 63
ACM.16314	27VA/3400	39, 40, 63	ACO.5503	27J/319	18
ACM.16525	26FC/6455	9	ACO.5514	27J/318	18
ACM.16980	26FC/6566	9	ACO.5694	27WW/238	21
ACM.17356	27WW/429	21	ACO.5695	27WW/232	22
ACM.17376	27WW/506	1, 61	ACO.5696	27WW/233	21
ACM.17444	27VA/5003	41, 62	ACO.5697	27WW/237	22
ACM.17763	27J/390	18	ACO.5698	27WW/234	21
ACM.17764	27J/389	18	ACO.5699	27WW/194	22
ACM.17780	5D/1810	19	ACO.5767	5D/1736	11, 12
ACM.18350/8	27WW/507	1	ACO.5808	27WW/236	22
ACM.18712	—	20	ACO.5809	27WW/154	22
ACM.18930	—	29	ACO.6788	27WW/188	21
ACM.18931	—	29	ACO.6790	27WW/196	22
ACM.19552/8	27WW/598	1, 61	ACO.6980	27WW/189	21
ACM.20793	—	20			
			ACO.7261	27VA/3979	39, 41
			ACO.7262	27VA/3977	39, 41
			ACO.7286	27WW/197	22
ACO.1118	27G/2121	35, 37	ACO.7363	27VA/3982	40
ACO.1268	27G/2091	10, 61	ACO.7364	27VA/3976	39
ACO.1283	27G/2116	10	ACO.7373	27VA/3980	39
ACO.1591	27VA/3250	41	ACO.7374	27VA/3978	39
ACO.1750	27G/2135	41	ACO.7794	27VA/3975	39
ACO.2564	27VA/4332	41	ACO.7798	27VA/3974	39
ACO.2669	27WW/63	1	ACO.7851	27VA/3981	40
ACO.3113	27J/285	18			
ACO.3114	27J/278	17	ACO.8991	27G/2484	10
ACO.3116	27J/298	17			
ACO.3117	27J/300	18	ACO.9780	27WW/423	20
ACO.3118	27J/273	17	ACO.9784	27WW/425	20
ACO.3119	27J/275	17	ACO.9785	27WW/427	21
ACO.3120	27J/276	17	ACO.9786	27WW/424	20
ACO.3477	27G/2107	35, 36, 62			

**INDEX OF PART NUMBERS  
VAMPIRE AND SEA VAMPIRE**

Part No.	Ref. No.	Page	Part No.	Ref. No.	Page
ACO.9787	27WW/432	22	ACO.23464	—	29
ACO.9812	27WW/420	1	ACO.23852	—	30
ACO.9813	27WW/421	1			
ACO.9844	27WW/436	29			
ACO.9861	—	22	ACO.24140	27WW/582	30
			ACO.24141	—	30
			ACO.25010	27G/2903	27
ACO.20033	27WW/457	30	ACO.27294	—	22
ACO.20035	27WW/443	30			
ACO.20039	27WW/455	30			
ACO.20040	27WW/440	29			
ACO.20055	27WW/437	29			
ACO.20059	27WW/456	30			
ACO.20060	27WW/444	30			
ACO.20061	27WW/445	30	AH.7146	27A/2473	45
ACO.20112	27WW/434	29	AH.7160	27J/210	13
ACO.20233	5D/1809	12	AH.7724	27A/2834	48
			AH.8200	27J/202	13
			AH.8218	27A/2086	45, 46, 63
			AH.8219	27G/4024	3
			AH.8241	27G/2014	27, 28, 62
ACO.20523	27WW/350	20	AH.8360	5D/1489	11, 61
ACO.20550	27WW/488	20	AH.8400	27J/235	13, 14, 15,
ACO.20551	27WW/348	20, 21			16, 61
			AH.8902	27G/4046	4
			AH.9139	27A/2785	47, 48, 64
			AH.9140	27G/4067	5, 61
ACO.21313	27WW/534	21			
ACO.21757	27WW/489	20	AH.40423	27A/3232	45
			AH.40424	27A/3233	48
			AH.50329	27G/4105	7, 61
ACO.22009	27WW/511	30			
ACO.22682	27WW/535	20			
ACO.23261	27WW/580	30			
ACO.23262	27WW/584	30			
ACO.23263	27WW/585	30	AHM.289	27G/1900	27
ACO.23264	27WW/581	29	AHM.346/1	27A/2479	53
ACO.23265	27WW/583	30	AHM.391	5D/1597	11, 12
ACO.23266	27WW/612	29	AHM.402	27J/237	13
ACO.23267	27WW/538	29	AHM.406	27J/316	15
ACO.23268	27WW/539	29			
ACO.23269	27WW/537	29			
ACO.23270	27WW/540	29			
ACO.23271	—	30			
ACO.23272	27WW/615	30			
ACO.23273	27WW/611	29			
ACO.23274	27WW/608	29			
ACO.23275	—	30			

**INDEX OF PART NUMBERS  
VAMPIRE AND SEA VAMPIRE**

Part No.	Ref. No.	Page	Part No.	Ref. No.	Page
AHO.429/5	27G/4511	3, 4	AHO.15526	27G/2039	32, 33, 34,
AHO.576/1	27A/2098	46			36, 38, 40,
AHO.1056	27G/2000	10			41
AHO.1068	27G/2154	10	AHO.15532	27G/2037	32, 41
AHO.1139	27G/4508	3, 4	AHO.15534	27G/2027	31
AHO.1666	27G/1998	10	AHO.15535	27G/2026	31
AHO.2112	27J/26	14	AHO.15539	27G/2042	33, 34, 35,
AHO.2117	27J/21	15			37, 39
AHO.2337	27G/1994	10, 61	AHO.15876	27G/1885	28
AHO.3167	27A/2137	53	AHO.16151/1	27G/2035	31, 41
AHO.3514	27J/27	15	AHO.16151/2	27G/2075	31
AHO.3515	27J/12	14	AHO.16203	26FC/10323	19
AHO.3516	27J/25	15	AHO.16277	—	28
AHO.3549	27G/2169	27	AHO.16608	27A/2393	45, 47
AHO.3550	27G/2181	27	AHO.16615	27G/1876	28
AHO.3576	27G/1899	27	AHO.16619	27G/1879	28
AHO.3913	27A/2105	45, 48	AHO.16620	27G/1878	28
AHO.4186	27G/1848	16	AHO.16885	27G/2034	31
AHO.4321	27A/2478	46	AHO.16886	27J/191	14
AHO.4545	27A/2106	46, 48	AHO.16939	27G/4529	3, 4
AHO.4723	27G/1991	27	AHO.16993	27A/2480	53
AHO.4727	27G/1970	10, 28	AHO.17011	27G/2013	27
AHO.4849	27G/1898	27	AHO.17031	27G/4518	3, 4
AHO.4853	27G/2011	27	AHO.17032	27G/4522	3, 4
AHO.4858	27G/1870	27	AHO.17056	27G/1873	28
AHO.4860	27G/1872	28	AHO.17138	27A/2477	45
AHO.4861	27G/1871	28	AHO.17209	27A/2439	46
AHO.4868	27G/2174	27	AHO.17210	27A/2475	45
AHO.4869	27G/2176	27	AHO.17219	27A/2069	53, 64
AHO.4870	27G/2180	27	AHO.17298	27G/2170	14, 18, 28
AHO.4878	27G/2018	28	AHO.17304	27J/217	14
AHO.4948	27G/2182	28	AHO.17305	27J/216	13, 14
AHO.4949/3.4	27G/2320	28	AHO.17309	27J/212	14
AHO.5712	27G/2022	31, 32, 62	AHO.17311	27J/207	13
			AHO.17313	27J/225	13
			AHO.17319	27J/211	14
AHO.15502	27G/2023	31, 33, 34, 35, 37, 39, 41	AHO.17321	27J/222	13
			AHO.17326	27J/223	13
AHO.15503	27G/2030	31, 33, 34, 35, 37, 39, 41	AHO.17334	27J/209	14
			AHO.17338	27J/215	14
AHO.15512	27G/2029	31, 41	AHO.17356	27J/214	14
AHO.15513	27G/2040	32, 33, 34, 36, 38, 40, 41	AHO.17391	27J/213	13
			AHO.17402	27A/2481	53
AHO.15517	27G/2028	31, 33, 34, 35, 37, 39, 41	AHO.17403	27A/2482	53
			AHO.17410	27G/4621	3, 4
AHO.15523	27G/2038	32, 33, 34, 36, 38, 41	AHO.17411	27G/4619	3, 4
			AHO.17442	27J/226	13
			AHO.17443	27J/208	14
			AHO.17682	27A/2385	45
			AHO.17731	26FC/587	19
			AHO.17949	27G/4620	3, 4
			AHO.17999	27G/2218	27

**INDEX OF PART NUMBERS  
VAMPIRE AND SEA VAMPIRE**

Part No.	Ref. No.	Page	Part No.	Ref. No.	Page
AHO.18010	27G/2066	31, 41	AHO.21010	27WW/148	22
AHO.18130	27G/2131	28	AHO.21014	27WW/137	21
AHO.18133	27G/2010	27	AHO.21015	27WW/130	20
AHO.18134	27G/2009	27	AHO.21020	27WW/131	20
AHO.18366/2	27A/2476	46, 53	AHO.21021	27WW/96	22
AHO.18467	5D/1602	11, 12	AHO.21038	27WW/89	22
AHO.18474	5D/1603	11, 12	AHO.21053	27WW/37	22
AHO.18475	5D/1601	11, 12	AHO.21386	27WW/430	22
AHO.18476	—	11, 12			
AHO.18477	—	11, 12			
AHO.18490	5D/1600	11, 12	AHO.22040	27WW/136	21
AHO.18494	5D/1593	11, 12	AHO.22044	27WW/42	21
AHO.18500	5D/1591	11, 12			
AHO.18504	5D/1598	11			
AHO.18505	5D/1599	11, 12	AHO.22147	27WW/231	22
AHO.18523	—	11, 12	AHO.22152	27WW/155	22
AHO.18552	27A/2199	46, 48			
AHO.18678	—	11, 12			
AHO.18686	—	11, 12	AHO.22527	27A/2658	48
AHO.18702	27J/290	15	AHO.23019	27G/4713	5, 7
AHO.18707	27J/326	15	AHO.23020	27G/4711	5, 7
AHO.18714	27J/328	15	AHO.23035	27G/4709	5, 7
AHO.18718	27J/329	15	AHO.23037	27G/4714	5
AHO.18719	27J/330	15	AHO.23040	27G/4712	5, 7
AHO.18721	27J/327	15			
AHO.18722	27J/263	15			
AHO.18753	—	11, 12			
AHO.18758	27J/367	15			
AHO.18822/2	27A/2675	48	AHO.25097	27G/4708	5, 7
AHO.18836	5D/1595	11, 12	AHO.25160	27G/4839	5
AHO.18922	5D/1590	11, 12	AHO.25170	27G/4840	5
AHO.18924	5D/1594	11, 12	AHO.25171	27A/2830	47
AHO.19132	27G/2083	33, 34, 35, 37, 39	AHO.25172	27A/2833	48
			AHO.25173	27A/2832	47
AHO.19208	27G/2081	34, 62	AHO.25185	27A/2831	47
AHO.19216	27G/2087	33, 34, 35, 37, 40	AHO.25192	27A/2836	48
			AHO.25499	27G/4705	3, 4
AHO.19217	27G/2086	33, 34	AHO.26299	27G/2179	27
AHO.19219	27G/2084	33, 34, 35, 37, 39	AHO.26408	27A/2835	48
			AHO.26470	27G/4841	3, 4
AHO.19221	27G/2089	33, 34, 35, 38, 40	AHO.26654	27J/331	16
			AHO.26729	27J/325	15
AHO.19243	27G/2085	31, 33, 34, 35, 37	AHO.26961	27G/2269	27
			AHO.27756	27A/3027	46, 48
AHO.19245	27G/2134	31, 35, 37	AHO.27955	27G/4898	3, 4
AHO.19246	27G/2088	31, 33, 34, 35, 37, 41	AHO.29658	27G/5202	7
AHO.19249	27G/2082	31, 33, 34, 41			
			AHO.35345	27A/3687	47
AHO.19252	27G/2127	32, 41	AHO.35385	27G/5434	3, 4
AHO.19567	27G/2012	27	AHO.35386	27G/5403	5, 7
AHO.19682	27G/2090	33, 62			
AHO.20374	27G/2016	27			
AHO.20760	27G/2120	41	AHO.38858	27G/6106	3, 4

**INDEX OF PART NUMBERS  
VAMPIRE AND SEA VAMPIRE**

Part No.	Ref. No.	Page	Part No.	Ref. No.	Page
A.2965	—	61	DAS.160/16 DAS.160/21	26FC/556 26FC/4633	19 19
AM.3371	27A/3101	63			
AM.6247	27G/4805	61			
AM.9410	27A/3045	63			
AM.9784	27A/3068	64	DH.120B/14	27VA/3692	19
AM.9967	27A/3074	63			
AM.9971	27A/3090	63			
AM.9986	27A/3091	64			
AM.9990	27A/3075	64	FC.7	27A/2786	24
AM.10022	27A/3092	64	FC.9	27A/2255	24
AM.10052	27A/3070	64			
AM.10796	27A/3047	63			
			FC-R.16-N FC-R.17-N	27A/2222 27A/2087	9 9
AO.6838	27VA/3734	61			
AO.13149	27G/2096	62			
AO.13557	27G/2331	62			
AO.17218	27G/2329	62			
AO.17746	27G/2095	62	GDH.120/B.18	27VA/4856	19
AO.18396	27G/2328	62			
AO.19761	27G/2097	62, 63			
AO.24404	27A/2646	63, 64			
AO.25155	27A/3081	63	NF.2	27A/2071	24
AO.25582	—	61			
AO.25583	—	61			
AO.33421	27A/3053	63, 64			
AO.33582	27A/3102	64	NF-R.30	27A/2070	9
AO.35583	27A/3082	64	NF-R.31	27A/3433	9
AO.33667	—	61			
AO.33698	—	61			
AO.41557	27A/3052	63, 64			
AO.41720	27A/3061	63, 64			
AO.42466	27A/3049	63, 64			
AO.42468	27A/3050	64			
AO.42469	27A/3048	64			
AO.42853	27A/3085	63, 64			
AO.42856	27A/3099	63, 64			
AO.45004	27A/3093	64			
AO.45115	27G/2330	62			
AO.45626	27J/340	61			
AO.45631	27J/341	61			
AO.45784	27A/3067	64			
AO.46505	27A/3104	63			
AO.49915	27A/3334	64			
AO.49998	27A/3303	64			
AO.100001	27G/2407	62			
AO.106115	27A/4462	62			
AO.101006	27G/5324	61			

**INDEX OF PART NUMBERS  
VAMPIRE AND SEA VAMPIRE**

Part No.	Ref. No.	Page	Part No.	Ref. No.	Page

**INDEX OF PROPRIETARY PARTS  
VAMPIRE AND SEA VAMPIRE**

Manufacturer	Description	Part No.	Ref. No.	Page No.
	Ball, steel, $\frac{1}{16}$ " dia.	—	2A/9500563	17
	Ball, steel, $\frac{3}{32}$ " dia.	—	2A/9500566	29
	Ball, steel, $\frac{1}{8}$ " dia.	—	2A/9424323	20
British Timken	Bearing	BSS. BRL.035	2A/9500056	53
	Bearing	BSS. BRL.040	2A/9500057	45, 47
	Bearing	BSS. BRL.050	2A/9500059	45, 47
Britool	Wrench	No. 1111	—	61
Fischer Bearings Co. Ltd.	Bearing	6207	2A/9500056	53
	Bearing	6208	2A/9500057	45, 47
	Bearing	6210	2A/9500059	45, 47
Guest, Keen & Nettlefold Limited	Peg, "Parker Kalon"	No. 0 $\times \frac{1}{4}$ "	27A/4072	15
Hellerman Electric Ltd.	Sleeve	No. 3 $\times$ 1"	5X/2578	16
Hoffmann Manufacturing Co. Ltd.	Bearing	135	2A/9500056	53
	Bearing	140	2A/9500057	45, 47
	Bearing	150	2A/9500059	45, 47
	Bearing	CS.5	2A/9500415	20
Micanite Insulators Co. Ltd.	Sleeve, "Microflex" 6.5 mm. Bore $\times$ .45 mm. wall $\times$ 9" long	—	27J/332	16
Ransome & Marles Bearing Co. Ltd.	Bearing	C.K. $\frac{1}{2}$ A	—	20
	Bearing	LJ.35	2A/9500056	53
	Bearing	LJ.40	2A/9500057	45, 47
	Bearing	LJ.50	2A/9500059	45, 47
A. Schraders' Son	Cap	2525	27A/3173	24, 53
	Core	6100E	27A/3174	24
	Extension	1015	27A/1113	53
Skefko Ball Bearing Co. Ltd.	Bearing	6207	2A/9500056	53
	Bearing	6208	2A/9500057	45, 47
	Bearing	6210	2A/9500059	45, 47
	Bearing	CBS.4	2A/9500415	20
Unbrako Socket Screw Co. Ltd.	Screw, socket head, type "C", 2 BA $\times \frac{1}{2}$ " long	—	27J/279	17
	Screw, socket head, type "C", 2 BA $\times$ 1" long	—	27J/280	17

**INDEX OF PROPRIETARY PARTS  
VAMPIRE AND SEA VAMPIRE**

Manufacturer	Description	Part No.	Ref. No.	Page No.



The P/Q Family

Why "P/Q"?

The P/Q family of Masks

MCA "Warning Connector"

P/Q 1

P/Q 2

P/Q 4

S-Airline

V-Type Superior

V-Type

A-11A

V-Type MK2

A-11A MK2

A-11A

Check Down

A-11A/1

A-11A/2

This file was downloaded from the RTFM Library. Link: [www.scottbouch.com/rtfm](http://www.scottbouch.com/rtfm) Please see site for usage terms, and more aircraft documents.