

TYPE / APPLICABILITY																
Section A — CONNECTIONS, GROUND CONDITIONING																
ACCESSORY :-		CONNECTION, GROUND CONDITIONING										502910				
AIRCRAFT	MK	No. OFF	MK	No. OFF	MK	No. OFF	MK	No. OFF	MK	No. OFF	MK	No. OFF	MK	No. OFF	MK	No. OFF
VICTOR VULCAN		1 1														
CONNECTION, GROUND CONDITIONING 508420																
VALIANT		2														
CONNECTION, GROUND CONDITIONING 502880																
BRITANNIA		1														

CONNECTIONS, GROUND CONDITIONING

Ref. No.	Part No.	Description	No. Off	Matl. Spec.	CL. OF ST.			Plate No.
					1	2	3	
47	502910	CONNECTION, GROUND CONDITIONING 5" ... Spares for:—	1	—			A	A 1
391	508902	ANCHOR, bracket	2	S.21			C	A 1
28L/13326	A27/GT	Nut, lock	2	—			C	
380	481930	BLOCK, anchor	1	S.11			C	A 1
	502846	BODY, connection	1	DTD.721				A 1
744	DDS.1092/Y2C	BOLT	2	—			C	A 1
28W/9419475	SP15/C	Washer	2	—			C	
388	481814	BOLT, carrier	2	DTD.126A			C	A 1
28M/10290	AGS.2001/E1	Nut	2	—			C	
28W/9418921	SP13/E	Washer	2	—			C	
395	502849	BOLT, pillar	2	L.40			C	A 1
396	502827	BOLT, special	2	L.40			C	A 1
384	508838	BOLT, special	6	S.95			C	A 1
28M/10327	AGS.2002/B1	Nut	6	—			C	
28W/9419474	SP15/B	Washer	6	—			C	
743	502848	BRACKET, hinge	1	S.510			C	A 1
	555116	BRACKET, hinge (AMD. 3AE)	1	S.510				A 1
389	508900	BRACKET, left hand	1	DTD.546B			C	A 1
390	508901	BRACKET, right hand	1	DTD.546B			C	A 1
28M/10328	AGS.2002/C1	Nut	2	—			C	
28Q/7132	AS.157/406	Rivet	2	—			C	
28S/2820	A33/C20	Screw	2	—			C	
28W/13378	SP26/C	Washer	2	—			C	
	508837	CARRIER, valve assembly	1	—				A 1
		Spares for:—						
	ND/S238	ARM, left hand, complete	1	—				A 3
	ND/S237	ARM, right hand, complete	1	—				A 3
	481810	BOLT, special	2	S.21				A 3
	500138	BUSH	2	S.21				A 3
	508833	PIECE, bridge	1	L.65				A 3
	508832	STOP, carrier	1	DTD.603				A 3
28M/13121	A27/CS	Nut	2	—			C	
28P/12349	SP9/C5	Pin, split	2	—			C	
28S/3421	A33/A8	Screw	2	—			C	
28W/9419402	SP13/C	Washer	2	—			C	

CONNECTION, GROUND CONDITIONING

Ref. No.	Part No.	Description	No. Off	Matl. Spec.	CL. OF ST.			Plate No.
					1	2	3	
479	502858	DOOR, curved assembly	1	—	B			A 1
		Spares for:—						
	502826	BOLT, special	5	L.65				A 3
	481910	BRACKET, hinge	1	S.3				A 3
	481911	BRACKET, hinge	1	S.3				A 3
28S/2814	A33/C16	Screw	4	—	C			
28M/10328	AGS.2002/C1	Nut	2	—	C			
28W/8516	AS.470/C	Washer	2	—	C			
	502879	PANEL, curved door	1	L.3				A 3
	502847	SPRING, curved door, complete	1	—				A 3
28Q/7848	AS.162/305	Rivet	32	—	C			
742	508831	HOUSING, pivot	1	S.92	C			A 1
534	500500	NAMEPLATE (R.N.)	1	L.4	C			A 1
28Q/7194	AS.162/304	Rivet	4	—	C			
383	508830	PIN, valve pivot	1	S.94	C			A 1
28M/10330	AGS.2002/E1	Nut	1	—	C			
28W/9418921	SP13/E	Washer	1	—	C			
745	502839	PLATE, peel off shim	2	ALUM.	C			A 1
382	481925	RING, retainer	1	S.3	C			A 1
481	481813	SCREW, door	1	DTD.525	C			A 1
704	555238	SEAL (AMDT. 5AE)	1	RUBBER	C			A 1
	ND/S232	SEAL (PRE. AMDT. 5AE)	1	RUBBER	C			A 1
386	481917	SPRING, tension	2	—	C			A 1
392	481923	SUPPORT, lug	4	S.11	C			A 1
28L/12931	A27/ET	Nut	4	—	C			
387	481914	TUBE, hinge	1	T.35	C			A 1
741	481904	VALVE	1	DTD.298	C			A 1

CONNECTIONS, GROUND CONDITIONING

Ref. No.	Part No.	Description	No. Off	Matl. Spec.	CL. OF ST.			Plate No.
					1	2	3	
184	508420	CONNECTION, GROUND CONDITIONING 5" ...	1	—			A	A 2
		Spares for:—						
391	508902	ANCHOR, bracket ...	2	S.21			C	A 2
28L/13326	A27/GT	Nut, lock ...	2	—			C	
380	481930	BLOCK, anchor ...	1	S.11			C	A 2
	508429	BODY, connection ...	1	DTD.281				A 2
744	DDS.1092/Y2C	BOLT ...	2	—			C	A 2
28W/9419475	SP15/C	Washer ...	2	—			C	
388	481814	BOLT, carrier ...	2	DTD.126A			C	A 2
28M/10290	AGS.2001/E1	Nut ...	2	—			C	
28W/9419405	SP13/E	Washer ...	2	—			C	
395	502849	BOLT, pillar ...	2	L.40			C	A 2
396	502827	BOLT, special ...	2	L.40			C	A 2
384	508838	BOLT, special ...	6	S.95			C	A 2
28M/10327	AGS.2002/B1	Nut ...	6	—			C	
28W/9419474	SP15/B	Washer ...	6	—			C	
393	508431	BRACKET, hinge ...	2	S.3			C	A 2
389	508900	BRACKET, left hand ...	1	DTD.546B			C	A 2
390	508901	BRACKET, right hand ...	1	DTD.546B			C	A 2
28M/10328	AGS.2002/C1	Nut ...	2	—			C	
28Q/7132	AS.157/406	Rivet ...	2	—			C	
28S/2814	A33/C16	Screw ...	2	—			C	
28W/13378	SP26/C	Washer ...	2	—			C	
	508837	CARRIER, valve assembly ...	1	—				A 2
		Spares for:—						
	ND/S238	ARM, left hand, complete ...	1	—				A 3
	ND/S237	ARM, right hand, complete ...	1	—				A 3
	481810	BOLT, special ...	2	S.21				A 3
	500138	BUSH ...	2	S.21				A 3
	508833	PIECE, bridge ...	1	L.65				A 3
	508832	STOP, carrier ...	1	DTD.603				A 3
28M/13121	A27/CS	Nut ...	2	—			C	
28P/12349	SP9/C5	Pin, split ...	2	—			C	
28S/3421	A33/A8	Screw ...	2	—			C	
28W/9419402	SP13/C	Washer ...	2	—			C	

CONNECTION, GROUND CONDITIONING

Ref. No.	Part No.	Description					No. Off	Matl. Spec.	CL. OF ST.			Plate No.
		1	2	3	4	5			M.R.	L.M.		
379	508424	DOOR , curved assembly					1	—	B			A 2
		Spares for:—										
	508427	BRACKET , hinge					1	S.3				A 3
	508428	BRACKET , hinge					1	S.3				A 3
28S/2814	A33/C16	Screw					4	—	C			
28M/10328	AGS.2002/C1	Nut					2	—	C			
28W/8516	AS.470/C	Washer					2	—	C			
	508425	PANEL , curved door					1	DTD.603B				A 3
	508426	SPRING , curved door, complete					1	—				A 3
28Q/7848	AS.162/305	Rivet					32	—	C			
28D/12528	A25/1B	Bolt					5	—	C			
742	508831	HOUSING , pivot					1	S.92	C			A 2
534	500500	NAMEPLATE (R.N.)					1	L.4	C			A 2
28Q/7194	AS.162/304	Rivet					4	—	C			
383	508830	PIN , valve pivot					1	S.94	C			A 2
28M/10330	AGS.2002/E1	Nut					1	—	C			
28W/12253	SP13/E	Washer					1	—	C			
382	481925	RING , retainer					1	S.3	C			A 2
481	481813	SCREW , door					1	DTD.525	C			A 2
704	555238	SEAL (AMDT. 5AE)					1	RUBBER	C			A 2
	ND/S232	SEAL (PRE. AMDT. 5AE)					1	RUBBER	C			A 2
386	481917	SPRING , tension					2	DTD.215	C			A 2
392	481923	SUPPORT , lug					4	S.11	C			A 2
28L/12931	A27/ET	Nut					4	—	C			
387	481914	TUBE , hinge					1	T.35	C			A 2
741	481904	VALVE					1	DTD.298	C			A 2
593	508430/1	WASHER					A.R.	DTD.603B	C			A 2
594	508430/2	WASHER					A.R.	SHIM	C			A 2

CONNECTION, GROUND CONDITIONING

Ref. No.	Part No.	Description	No. Off	Matl. Spec.	CL. OF ST.			Plate No.
					1	2	3	
883	502880	CONNECTION, GROUND CONDITIONING, 8.000". Spares for :—	1	—				A 4
884	481820	ANCHOR, spring	2	S.21			C	A 4
	502884	BODY, connection	1	L.124				A 4
	55194	BOLT, DOOR HINGE BRACKET	4	580				
388	481814	BOLT, valve carrier attachment to connection body.	2	S.92			C	A 4
28M/10290	AGS.2001/E1	Nut, 1/4" B.S.F.	2	—			C	
28W/9418921	SP13/E	Washer, 1/4" B.S.F.	2	—			C	
886	550289	BRACKET, anchor, hinge door retaining screw complete.	1	—			C	A 4
1108	481818/1	BRACKET, door hinge	1	S.1				A-4
1109	481818/2	BRACKET, door hinge	1	S.1				A-4
28D/12513	A25/2C	Bolt, 2 B.A.	4	—			C	
28W/9419475	SP15/C	Washer, 2 B.A.	4	—			C	
887	550291	CARRIER, valve assembly	1	—			C	A 4
	481810	Spares for :—						
		BOLT, special bridge piece attachment to carrier.	2	S.21				A 5
28M/13121	A27/CS	Nut, 2 B.A.	2	—			C	
28P/16320	SP9/C9	Pin, split	2	—			C	
28W/9419402	SP13/C	Washer, 2 B.A.	2	—			C	
	508833	PIECE, bridge	1	L.65				A 5
888	550281	DOOR, curved assembly	1	—			C	A 4
		Spares for :—						
889	505378	BRACKET, door hinge	1	S.3			C	A 5
890	505379	BRACKET, door hinge	1	S.3			C	A 5
	550285	BUSH, centre	1	L.65				A 5
28M/10328	AGS.2002/C1	Nut, 2 B.A.	2	—			C	
28S/2820	A33/C20	Screw, 2 B.A.	4	—			C	
28W/9419475	SP15/C	Washer, 2 B.A.	2	—			C	
	550288	BOLT, stop adjustable door setting	6	S.94				A 5
	550283	DOOR	1	DTD.546B				A 5
1468	558342	RING, retaining	1	S.1				A 5
	550282	SPRING, curved door, complete	1	—				A 5
891	550287	SCREW, centre clamping	1	S.105			C	A 5
742	508831	HOUSING, pivot	1	S.92			C	A 4

CONNECTIONS, GROUND CONDITIONING

Ref. No.	Part No.	Description					No. Off	Matl. Spec.	CL. OF ST.			Plate No.
		1	2	3	4	5			M.R.	L.M.		
534	500500	NAMEPLATE (R.N.)					1	L.4		C		A 4
28Q/7194	AS.162/304	Rivet					4	—		C		
383	508830	PIN , valve pivot					1	S.94				A 4
28M/10290	AGS.2001/E1	Nut, 1/4" B.S.F.					1	—		C		
28W/9418921	SP13/E	Washer, 1/4" B.S.F.					1	—		C		
892	506190	PLATE , valve assembly					1	—				A 4
		Spares for :—										
	506192	BRACKET , handle attachment					1	DTD.310				A 4
	506191	HANDLE					1	T.4				A 5
28D/12855	A25/27C	Bolt, 2 B.A.					1	—		C		
28M/10328	AGS.2002/C1	Nut, 2 B.A.					1	—		C		
28W/9419454	SP10/C	Washer, 2 B.A.					2	—		C		
28W/9416643	SP47/C	Washer, 2 B.A. spring					1	—		C		
	498832	SCREW , handle bracket attachment to plate ...					4	S.1				A 5
28M/10327	AGS.2002/B1	Nut, 4 B.A.					4	—		C		
28W/9419401	SP10/B	Washer, 4 B.A.					8	—		C		
	506193	WASHER , at attachment of handle brackets ...					4	PHIB.				A 5
28D/13040	A26/3B	Bolt					2	—		C		
28D/13138	A26/4B	Bolt					4	—		C		
28M/10329	AGS.2002/B1	Nut, 4 B.A.					6	—		C		
28W/9419401	SP10/B	Washer, 4 B.A.					6	—		C		
	501292	PLATE , locking ground conditioning hose adaptor ...					2	S.65				A 4
28S/2810	A33/A12	Screw, 6 B.A.					8	—		C		
893	551110	SEAL , between valve plate and body					1	RUBBER		C		A 4
	550292	SHIM , between valve plate and anchor nut bracket.					1	L.A.		C		A 4
894	481812	SPRING , tension spring loading valve plate					2	DTD.215		C		A 4
895	481819	TUBE , hinge door					1	T.35		C		A 4

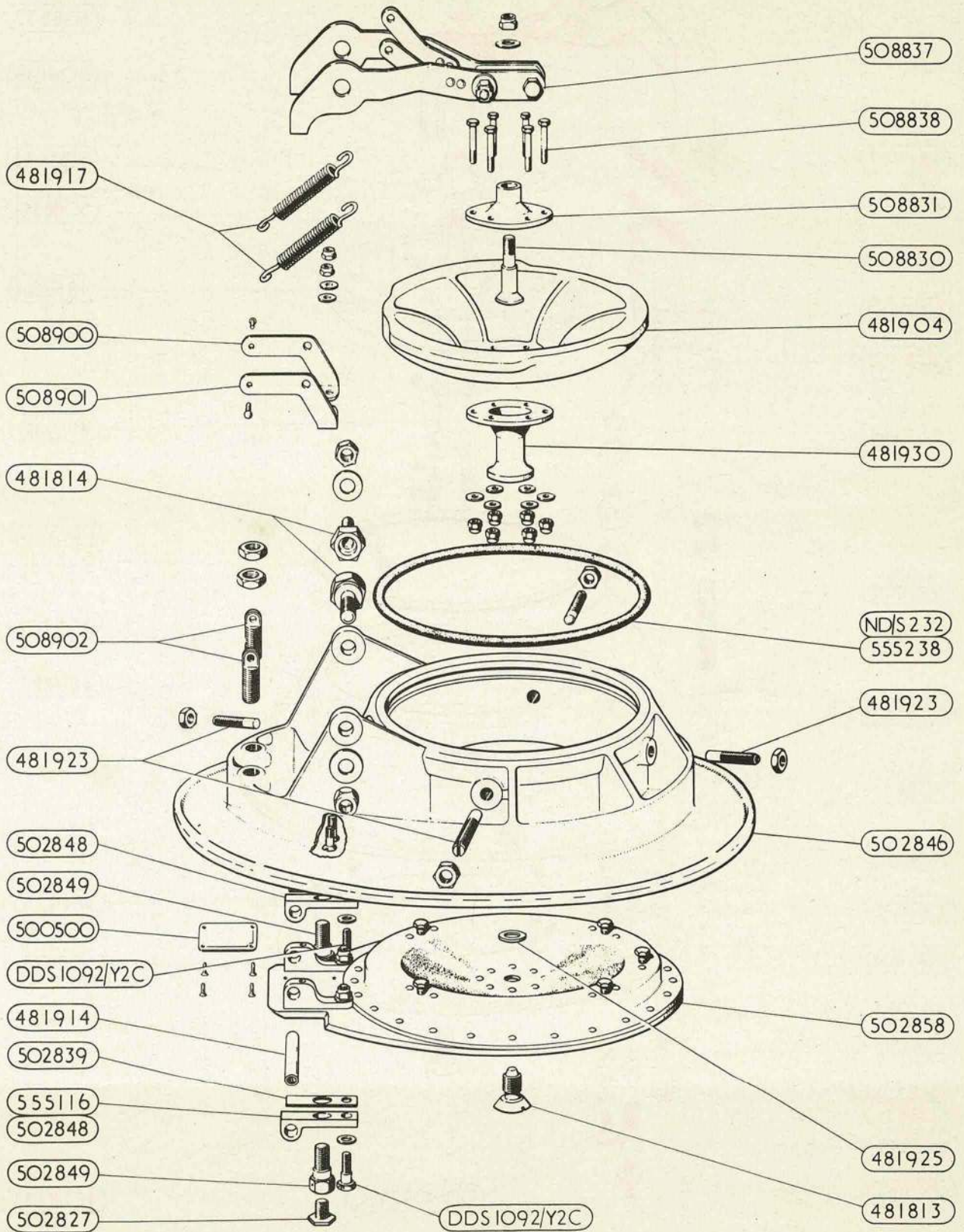

CONNECTION, GROUND CONDITIONING

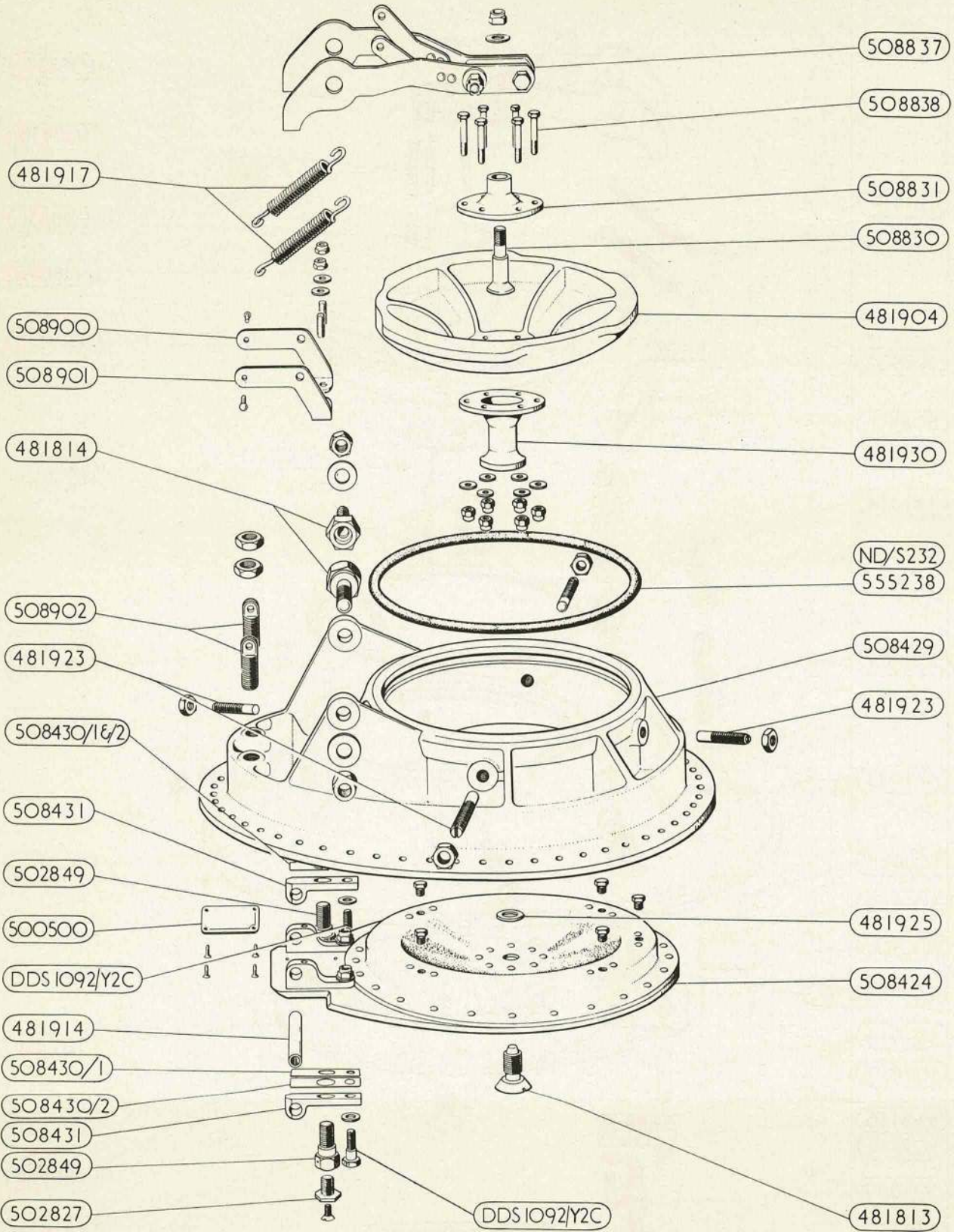

CONNECTION, GROUND CONDITIONING

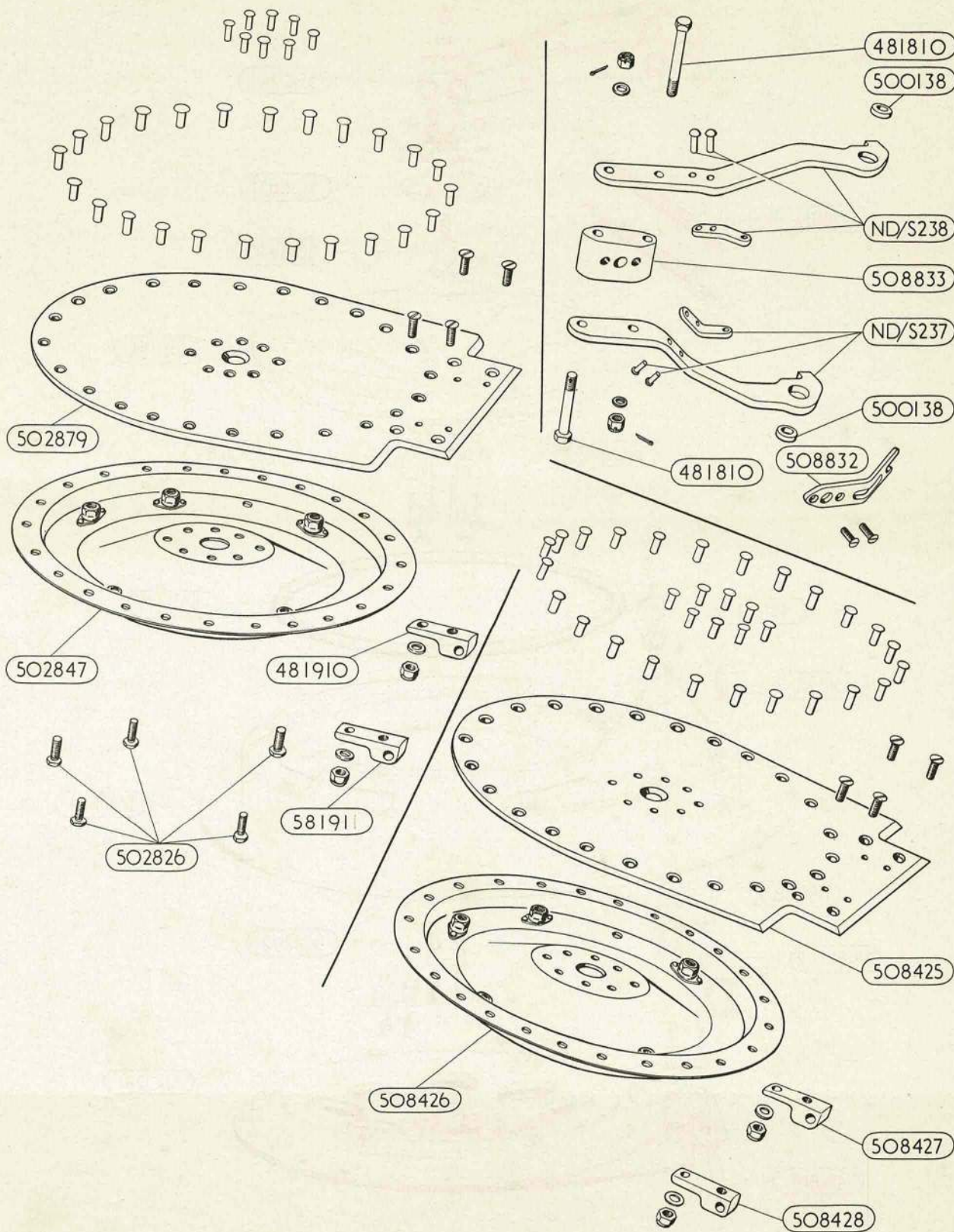

ASSEMBLIES VARIOUS

PLATE. A4.

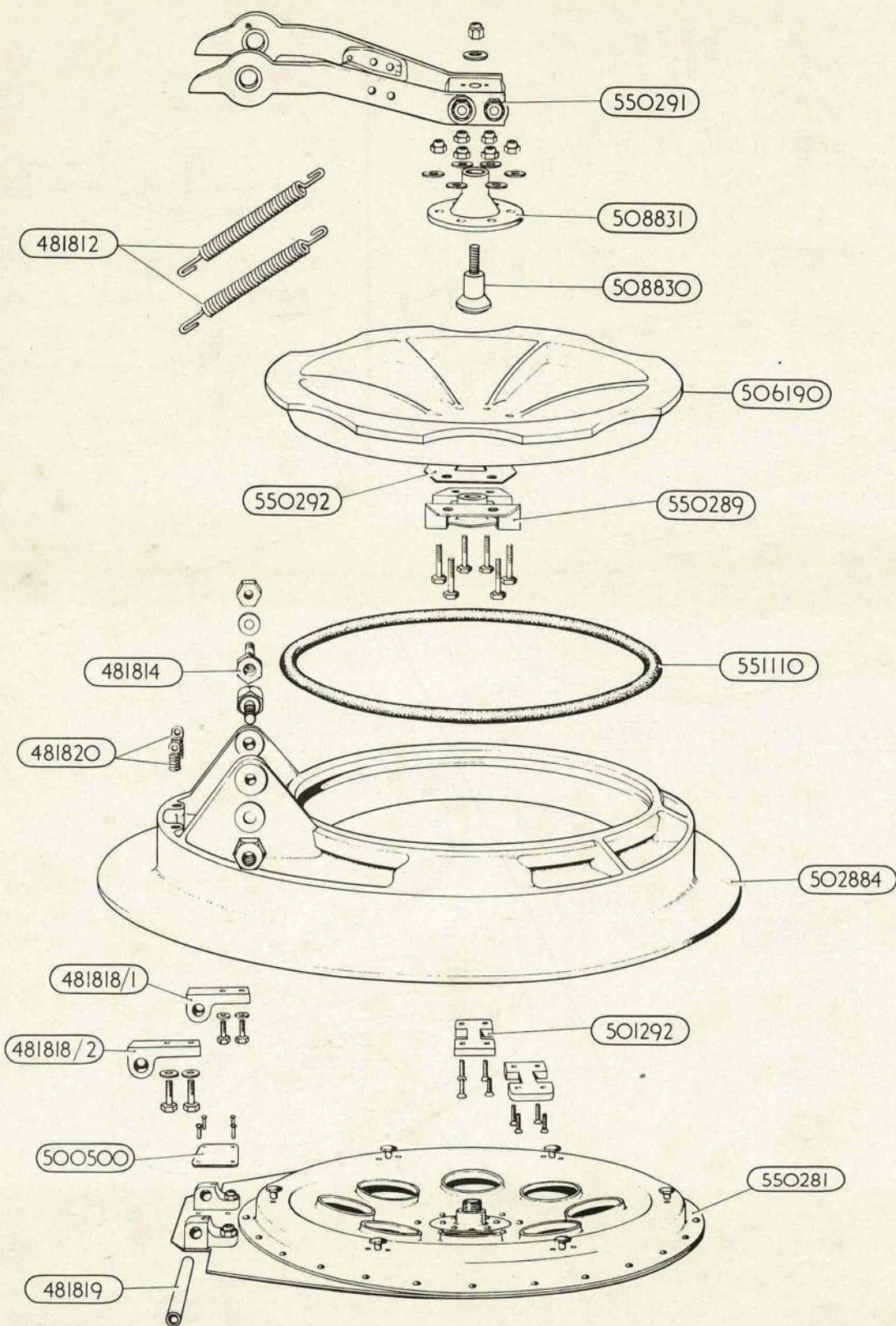

CONNECTION, GROUND CONDITIONING,

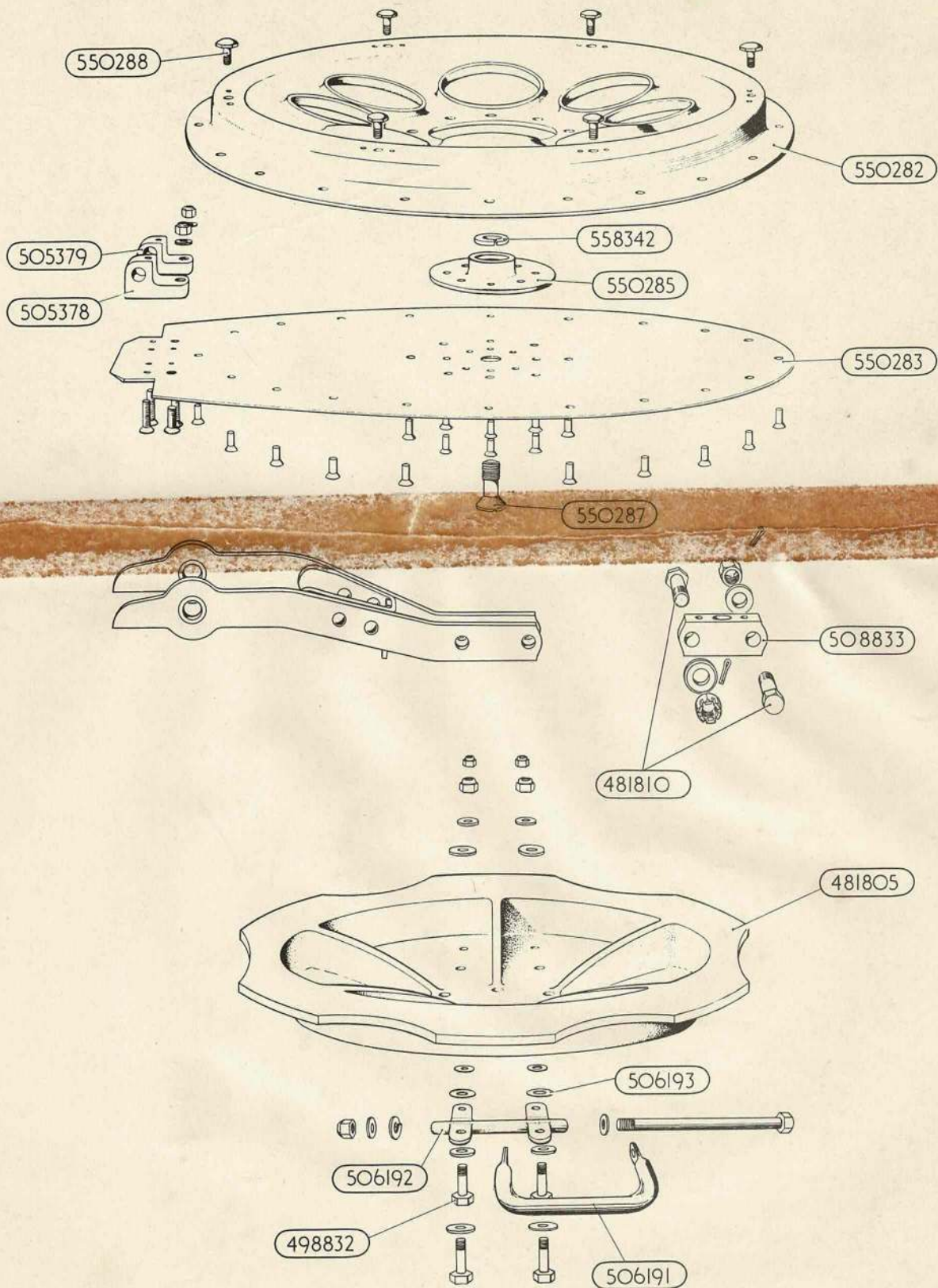

ASSEMBLIES, VARIOUS.



This file was downloaded
from the RTFM Library.

Link: www.scottbouch.com/rtfm

Please see site for usage terms,
and more aircraft documents.