

MANIFOLDS

DD



SECTION 10

BOOK OF HOURS

101

102

103



TYPE / APPLICABILITY  
Section DD — MANIFOLD

ACCESSORY :-

MANIFOLD 513090

AIRCRAFT	MK	No. OFF	MK	No. OFF	MK	No. OFF	MK	No. OFF	MK	No. OFF	MK	No. OFF	MK	No. OFF	MK	No. OFF
VULCAN	1	1	2	1												

Section 107 - HARBOR

DATE: 10/10/00

10

MANIFOLDS

Ref. No.	Part No.	Description	No. Off	Matl. Spec.	CL. OF ST.			Plate No.
					1	2	3	
972	513090	<b>MANIFOLD ASSEMBLY</b> ... ..	1	—	A			DD 1
		Spares for :—						
433	504724	<b>BOLT</b> , pipe attachment to pressure controller (PRE. AMDT. 4BY).	1	S.2	C			
28F/14253	AGS.1186/4	Washer, 6 B.A. (PRE. AMDT. 4BY) ... ..	2	—	C			
	553884	<b>BRACKET</b> , complete thermostat mounting ... ..	1	—				DD 1
	553867	<b>BRACKET</b> , pressure controller mounting ... ..	1	DTD.610				DD 1
28M/10327	AGS.2002/B1	Nut, 4 B.A. ... ..	3	—	C			
28L/11067	AGS.2035/B	Washer, 4 B.A., shakeproof ... ..	3	—	C			
	ND/S303	<b>CASTING</b> , manifold, complete with studs ... ..	1	—				DD 1
	553865	<b>CONTROLLER</b> , pressure, assembly ... ..	1	—				DD 1
		Spares for :—						
1639	553876	<b>BANJO (AMDT. 4BY)</b> ... ..	1	S.94	C			DD 3
	553858	<b>BLOCK</b> , tripod attachment ... ..	2	L.65				DD 3
	553859	<b>BLOCK</b> , tripod attachment ... ..	1	L.65				DD 3
	553860	<b>BODY</b> , pressure controller ... ..	1	L.65				DD 3
	558615	<b>BOLT</b> , special (AMDT. 3BY) ... ..	1	—				DD 3
	558620	<b>BOLT</b> , special (AMDT. 3BY) ... ..	2	—				DD 3
	504724	<b>BOLT</b> , banjo (AMDT. 4BY) ... ..	1	—				DD 3
	553864	<b>HOUSING</b> , valve, complete ... ..	1	—				DD 3
	553856	<b>NUT</b> , special, attachment of capsule to stabilizer.	1	—				DD 3
	553855	<b>PACK</b> , absolute capsule, complete ... ..	1	—				DD 3
28L/13140	A27/BT	Nut, 4 B.A. ... ..	1	—	C			
28W/14456	SP11/B	Washer, 4 B.A. ... ..	3	—	C			
28W/13664	SP14/B	Washer, 4 B.A. ... ..	AR	—	C			
28F/14253	AGS.1186/4	Washer, sealing (AMDT. 4BY) ... ..	2	—	C			
	553866	<b>PLATE</b> , base ... ..	1	L.65				DD 3
28D/14256	A25/3A	Bolt, 6 B.A. (PRE. AMDT. 3BY) ... ..	1	—	C			
28D/13065	A25/5A	Bolt, 6 B.A. (PRE. AMDT. 3BY) ... ..	2	—	C			
28M/13026	AGS.2002/A1	Nut, 6 B.A. (PRE. AMDT. 3BY) ... ..	3	—	C			
28W/15318	SP11/A	Washer, 6 B.A. (PRE. AMDT. 3BY) ... ..	3	—	C			
28F/16140	AGS.1186/1	Washer ... ..	3	—	C			
28M/13243	A27/AT	Nut (AMDT. 3BY) ... ..	3	—	C			
28W/11066	AGS.2035/A	Washer (AMDT. 3BY) ... ..	3	—	C			
	SP.915/20	<b>RING</b> — DOWTY, base plate sealing at housing.	1	—				DD 3
	SP.900/3	<b>RING</b> — DOWTY, sealing at valve pad and housing.	1	—				DD 3
	SP.915/C	<b>RING</b> — DOWTY, sealing between base plate and valve housing.	1	—				DD 3
	5002/187	<b>RING</b> — TRUARC, base plate retaining ... ..	1	—				DD 3
	553873	<b>SPACER</b> , at attachment of capsule to tripod ...	1	L.65				DD 3
	553874	<b>SPACER</b> , at attachment of capsule to stabilizer ...	1	L.65				DD 3
	553861	<b>STABILIZER</b> , capsule pack ... ..	1	BS.407/3				DD 3
JF/2337	CP.1	<b>SLEEVE</b> — HELSYN (AMDT. 4BY) ... ..	1	—	C			DD 3
32C/176	N.D.	<b>TUBING</b> , braided rubber, 1/4" o/d x 1/8" i/d x 4.500" L. (AMDT. 4BY).	1	DTD.373A	C			DD 3

MANIFOLDS

Ref. No.	Part No.	Description	No. Off	Matl. Spec.	CL. OF			Plate No.		
					ST.	M.R.	L.M.			
						1	2	3	4	5
28S/13931	557639	TRIPOD, capsule pack mounting ... ..	1	—						
	A31/Z4	Screw ... ..	3	—			C			DD 3
	553871	VALVE, pad, complete ... ..	1	—						DD 3
	557570	WASHER, at attachment of capsule to tripod ...	1	—						DD 3
28M/10287	ND/S310	COVER, end, complete with studs ... ..	1	DTD.304						DD 1
	AGS.2001/B1	Nut, 4 B.A. ... ..	6	—			C			
28L/11067	AGS.2035/B	Washer, 4 B.A., shakeproof ... ..	6	—			C			
SE/2698	N.D.	FLEX, WT. PVC., 1.25" long ... ..	2	—			C			
	556018	GASKET, sealing, temperature sensing unit to manifold casting.	1	RUBBER						DD 1
	556015	GASKET, sealing, at attachment of valve to casing.	1	RUBBER						DD 1
534	500500	NAMEPLATE (R.N.) ... ..	1	L.4			C			DD 1
1594	556481	NUT, cap, temperature sensing unit ... ..	1	L.65			C			DD 1
1472	559342	MOUNTING, anti-vibration, pressure controller (AMDT. 7BY).	3	—			C			DD 1
973	553854	MOUNTING, anti-vibration, pressure controller (made from AYM.106) (PRE. AMDT. 7BY).	3	—			C			
28M/10327	AGS.2002/B1	Nut, 4 B.A. ... ..	3	—			C			
28W/9419474	SP15/B	Washer, 4 B.A. ... ..	3	—			C			
1638	553528	PIPE, complete (AMDT. 4BY) ... ..	1	—			C			DD 1
974	556014	PIPE, assembly (PRE. AMDT. 4BY) ... ..	1	—			C			
		Spares for:—								
1639	553876	BANJO ... ..	1	5.94			C			DD 2
1638	553528	PIPE, complete ... ..	1	—			C			DD 2
JF/2337	CP.1	SLEEVE — HELSYN ... ..	2	—			C			DD 2
32C/176	N.D.	Tubing, braided rubber, 1/4" o/d x 1/8" i/d x 4.500" long.	1	—			C			
28F/10797	AGS.1129/A	Banjo ... ..	1	—			C			
28F/12852	AGS.1213/A	Bolt, banjo ... ..	1	—			C			
28F/12047	AGS.1186/A	Washer ... ..	2	—			C			
	553869	PLATE, clamp, venturi retaining ... ..	2	DTD.610						DD 1
28M/10328	AGS.2002/C1	Nut, 2 B.A. ... ..	6	—			C			
28W/9419475	SP15/C	Washer, 2 B.A. ... ..	6	—			C			
27Q/	SP.915/42	RING — DOWTY, end cover sealing ... ..	1	—			C			DD 1
27Q/12006	SP.900/19	RING — DOWTY, venturi sealing ... ..	6	—			C			DD 1
	556016	SHROUD, valve ... ..	1	L.59						DD 1
JF/2337	CP.1	SLEEVE — HELSYN (AMDT. 4BY) ... ..	1	—			C			DD 1
	553880	SPACER, at attachment of temperature sensing unit.	2	L.65						DD 1
	556012	STUD, shroud attachment to valve ... ..	4	5.94						DD 1
28M/10326	AGS.2002/A1	Nut, 6 B.A. ... ..	4	—			C			
28W/9419473	SP15/A	Washer, 6 B.A. ... ..	4	—			C			
	N.D.	TERMINAL — ROSS COURTNEY No. 00 ... ..	2	—						

MANIFOLDS

Ref. No.	Part No.	Description	No. Off	Matl. Spec.	CL. OF ST.	Plate No.
					M.R.	
		1 2 3 4 5				
28D/12528 28M/10287 28W/9419465	N.D.	<b>THERMOSTAT</b> , miniature — <b>OTTER</b> , Type T Mk. 6.	1	—		DD 1
	A25/1B	Bolt, 4 B.A. ... ..	2	—	C	
	AGS.2001/B1	Nut, 4 B.A. ... ..	2	—	C	
	SP13/B	Washer, 4 B.A. ... ..	2	—	C	
	CZ.49216	<b>UNIT</b> , cable — <b>PLESSEY</b> ... ..	1	—		DD 1
	CZ.49217	<b>UNIT</b> , panel — <b>PLESSEY</b> ... ..	1	—		DD 1
	553889	<b>UNIT</b> , temperature sensing, assembly ... ..	1	—		DD 1
1598	557635	Spares for :— <b>BANJO</b> ... ..	1	—	C	DD 2
	559193	<b>BRACKET (AMDT. 6Y)</b> ... ..	1	L.65		DD 2
1596	552620	<b>BRACKET</b> , bi-metal strip, support ( <b>PRE. AMDT. 6BY</b> ). Screw, 6 B.A. ... ..	1 3	DTD.546 —	C C	DD 2 DD 2
28S/13026	A37/A6	<b>HOUSING</b> ... ..	1	L.65	C	DD 2
1592	552617	Washer, sealing ... ..	2	—	C	
28F/12048	AGS.1186/B1	<b>NUT</b> , pipe coupling retaining ... ..	1	L.65	C	DD 2
1593	556480	<b>PAD</b> , at bi-metal strip ... ..	2	TUFNOL		DD 2
	552619	<b>RING</b> — <b>DOWTY</b> , sealing at spindle ... ..	2	—		DD 2
	SP.900/B5	<b>SEAT</b> , control valve ... ..	1	BS.249	C	DD 2
1591	551400	<b>SPINDLE</b> , centre ... ..	1	L.64	C	DD 2
28M/10319	AGS.2002/C3	Nut, 2 B.A. ... ..	1	—	C	
28W/14319	SP11/C	Washer, 2 B.A. ... ..	1	—	C	
	552618	<b>STRIP</b> , bi-metal, 'High Flex 45' ... ..	1	—		DD 2
28M/10337	AGS.2002/A2	Nut, 6 B.A. ... ..	2	—	C	
28S/14843	A37/A14	Screw, 6 B.A. ... ..	2	—	C	
28W/15318	SP11/A	Washer, 6 B.A. ... ..	2	—	C	
	552621	<b>WASHER</b> , insulating, at bi-metal strip ... ..	2	TUFNOL		DD 2
28D/12511	A25/2B	Bolt, 4 B.A. ... ..	2	—	C	
28D/12623	A25/4B	Bolt, 4 B.A. ... ..	2	—	C	
28M/10287	AGS.2002/B1	Nut, 4 B.A. ... ..	4	—	C	
28W/9419465	SP13/B	Washer, 4 B.A. ... ..	4	—	C	
28F/14656	AGS.1186/2	Washer, 4 B.A. ... ..	4	—	C	
	550540	<b>UNION</b> , assembly ... ..	1	—		DD 1
	550537	Spares for :— <b>ORIFICE</b> ... ..	1	DTD.171		DD 2
773	550539	<b>SCREW</b> , locking, orifice retaining ... ..	1	DTD.171	C	DD 2
975	550536	<b>UNION</b> , special ... ..	1	L.65	C	DD 2
775	550538	<b>WASHER</b> , orifice seating ... ..	1	RUBBER	C	DD 2
28F/12048	AGS.1186/B	Washer ... ..	1	—	C	

MANIFOLDS

Ref. No.	Part No.	Description	No. Off	Matl. Spec.	CL. OF ST.			Plate No.
					1	2	3	
					M.R.			
					L.M.			
	555837	VALVE, assembly ... ..	1	—				DD 1
	N.D.	Spares for:— BUSH — GLACIER, 7/8", 08/DP/14 ... ..	1	—				DD 2
	555385	CASING, top ... ..	1	L.65				DD 2
	555386	CASING, bottom ... ..	1	L.65				DD 2
28M/10326	AGS.2002/A1	Nut, 6 B.A. ... ..	8	—		C		
28S/14661	A31/A14	Screw, 6 B.A. ... ..	8	—		C		
28W/151318	SP11/A	Washer, 6 B.A. ... ..	16	—		C		
	N.D.	CIRCLIP — ANDERTON, Type 1700, item 9 ...	1	—				DD 2
	N.D.	CIRCLIP — ANDERTON, Type 1000, item 37, sleeve retaining to top casing.	1	—				DD 2
	555392	DIAPHRAGM, nylon fabric ... ..	1	DTD.795				DD 2
	555389	HEAD, valve ... ..	1	L.65				DD 2
	555390	HOUSING ... ..	1	L.65				DD 2
28M/10326	AGS.2002/A1	Nut, 6 B.A. ... ..	6	—		C		
28S/2762	A31/A12	Screw, 6 B.A. ... ..	6	—		C		
28W/15318	SP11/A	Washer, 6 B.A. ... ..	6	—		C		
28F/16140	AGS.1186/1	Washer, sealing ... ..	6	—		C		
	558184	RING, seating (AMDT. 1BY) ... ..	1	—				
	555388	RING, seating, complete (PRE. AMDT. 1BY) ...	1	—				DD 2
28S/9419436	A33/A6	Screw, csk., 6 B.A. ... ..	4	—		C		
	555391	SLEEVE ... ..	1	S.1				DD 2
	555393	SPRING ... ..	1	DTD.215				DD 2
28M/10327	AGS.2002/B1	Nut, 4 B.A. ... ..	8	—		C		
28L/11067	AGS.2035/B	Washer, 4 B.A., shakeproof ... ..	8	—		C		
	553850	VENTURI, 'Bakelite moulding' ... ..	6	X.17352				DD 1
	557345	WASHER, at clamp plate attachment to casting ...	6	—				DD 1

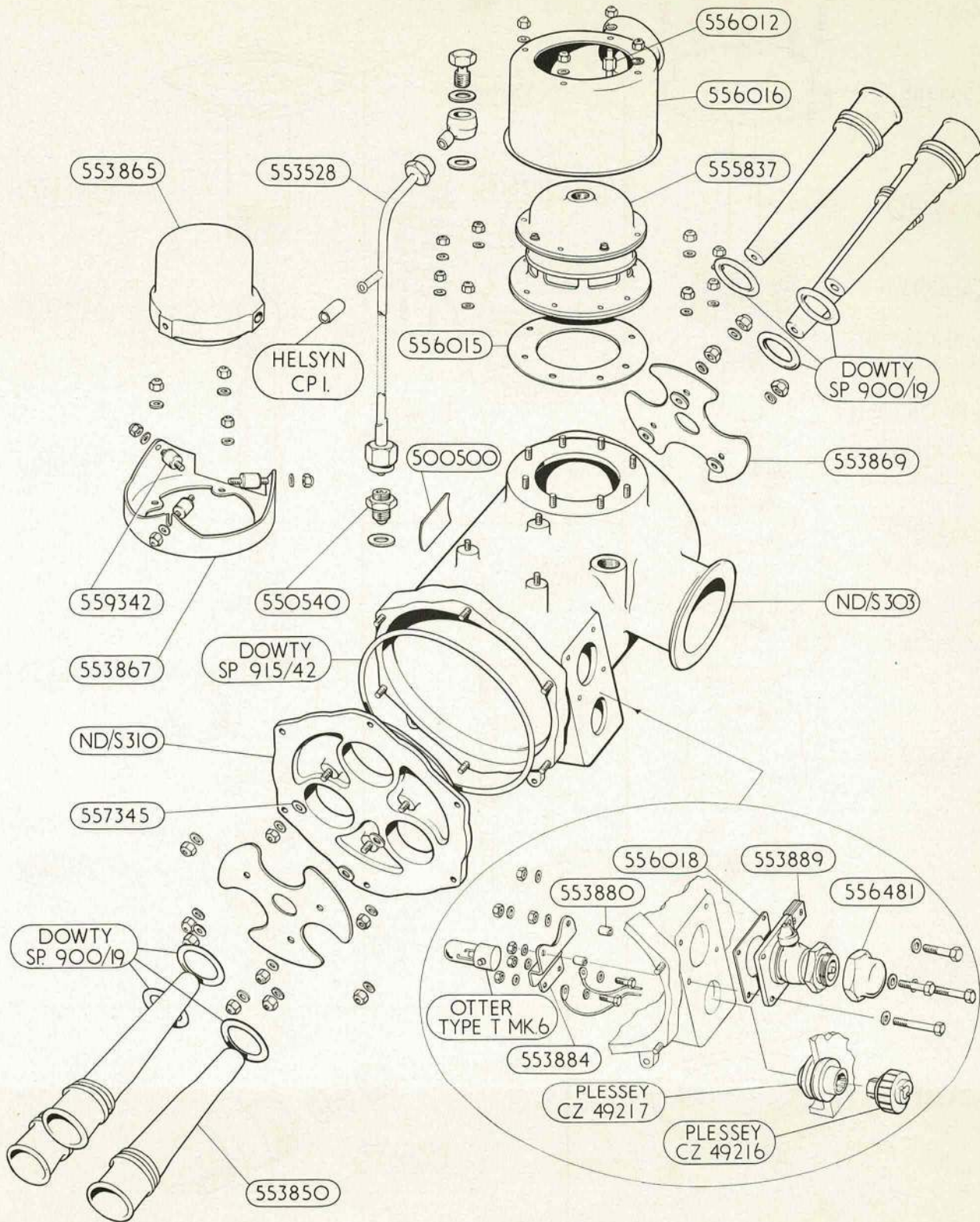

MANIFOLD

PLATE DD2

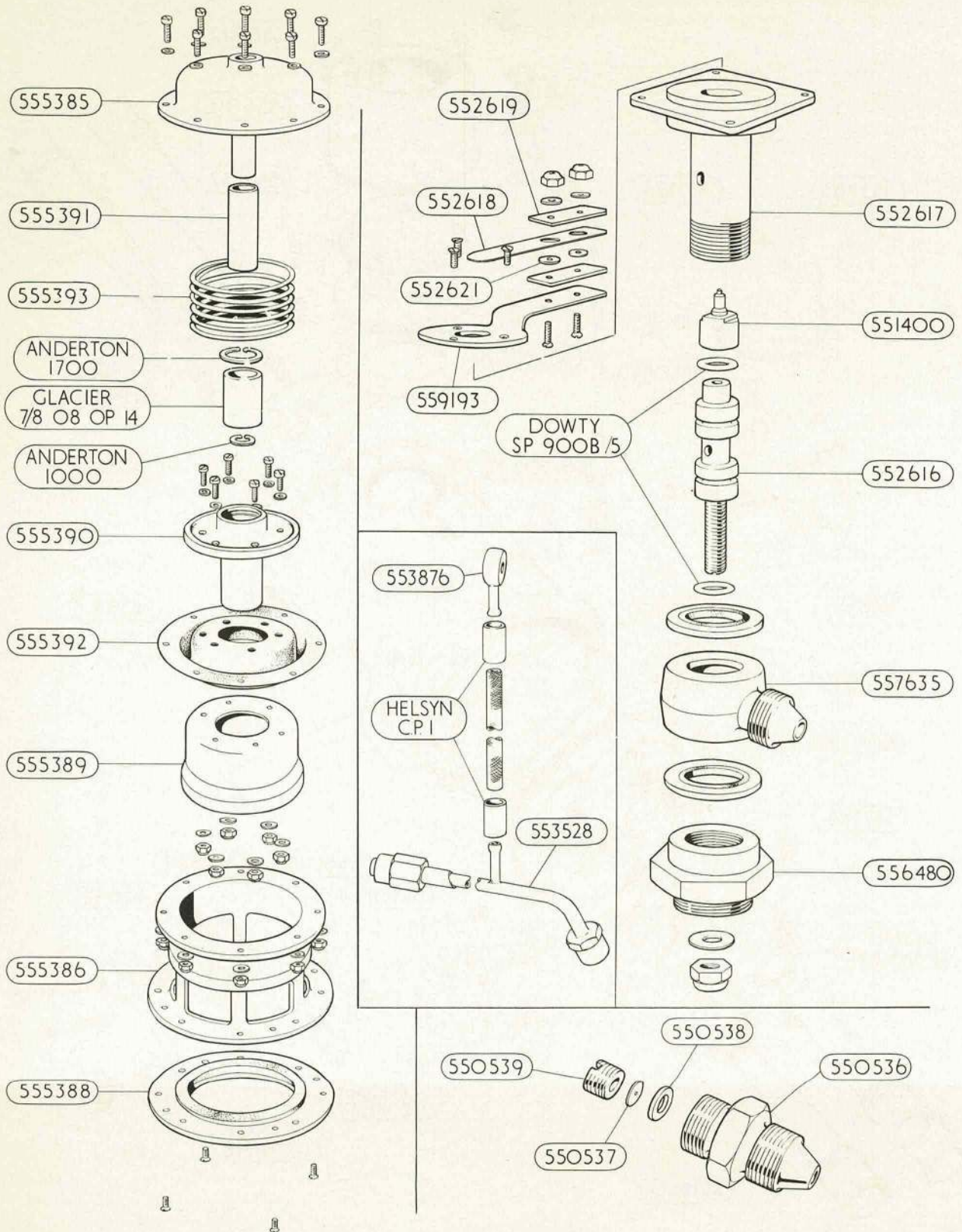

ASSEMBLIES VARIOUS

PLATE DD3

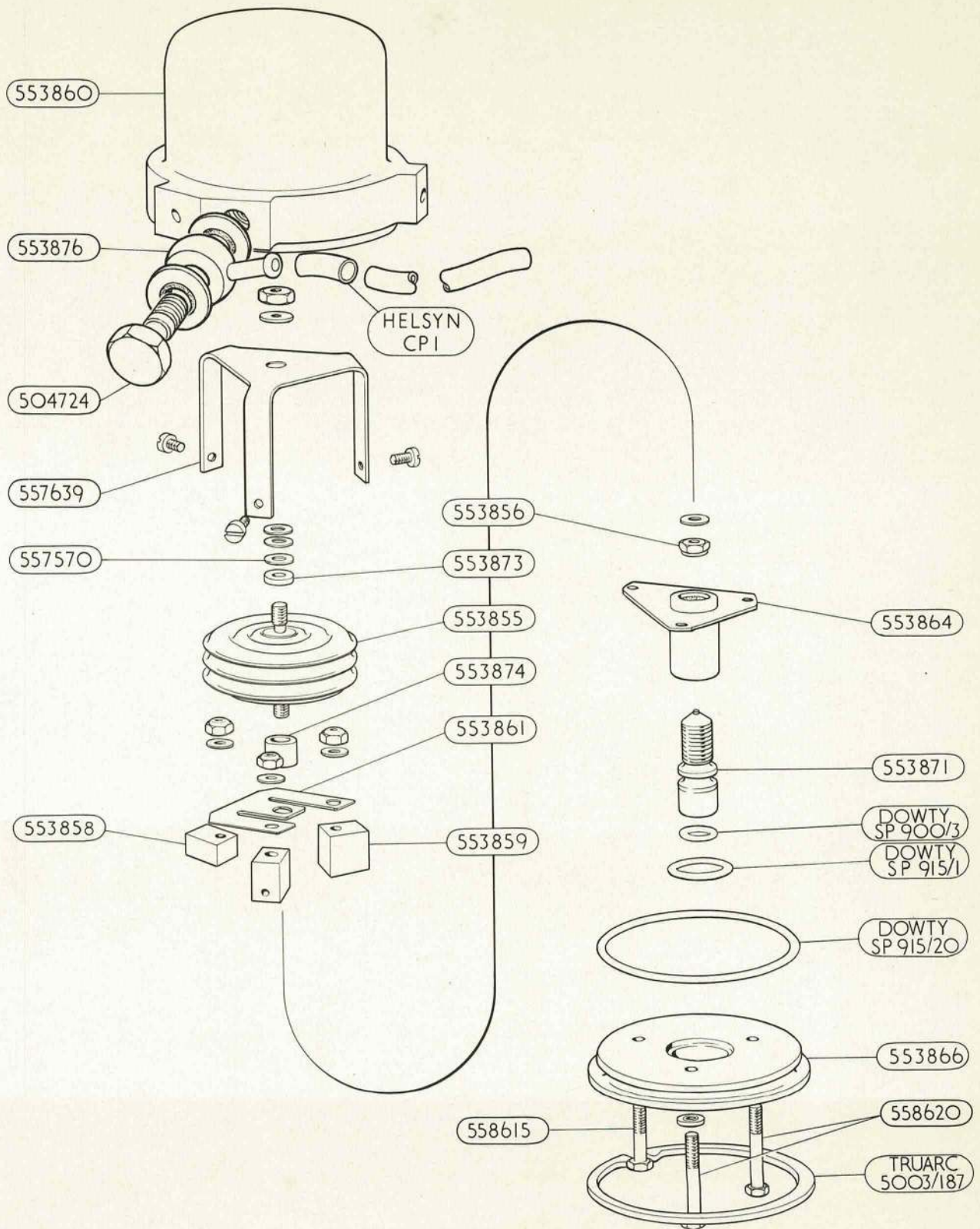

ASSEMBLIES VARIOUS

PLATE DD3

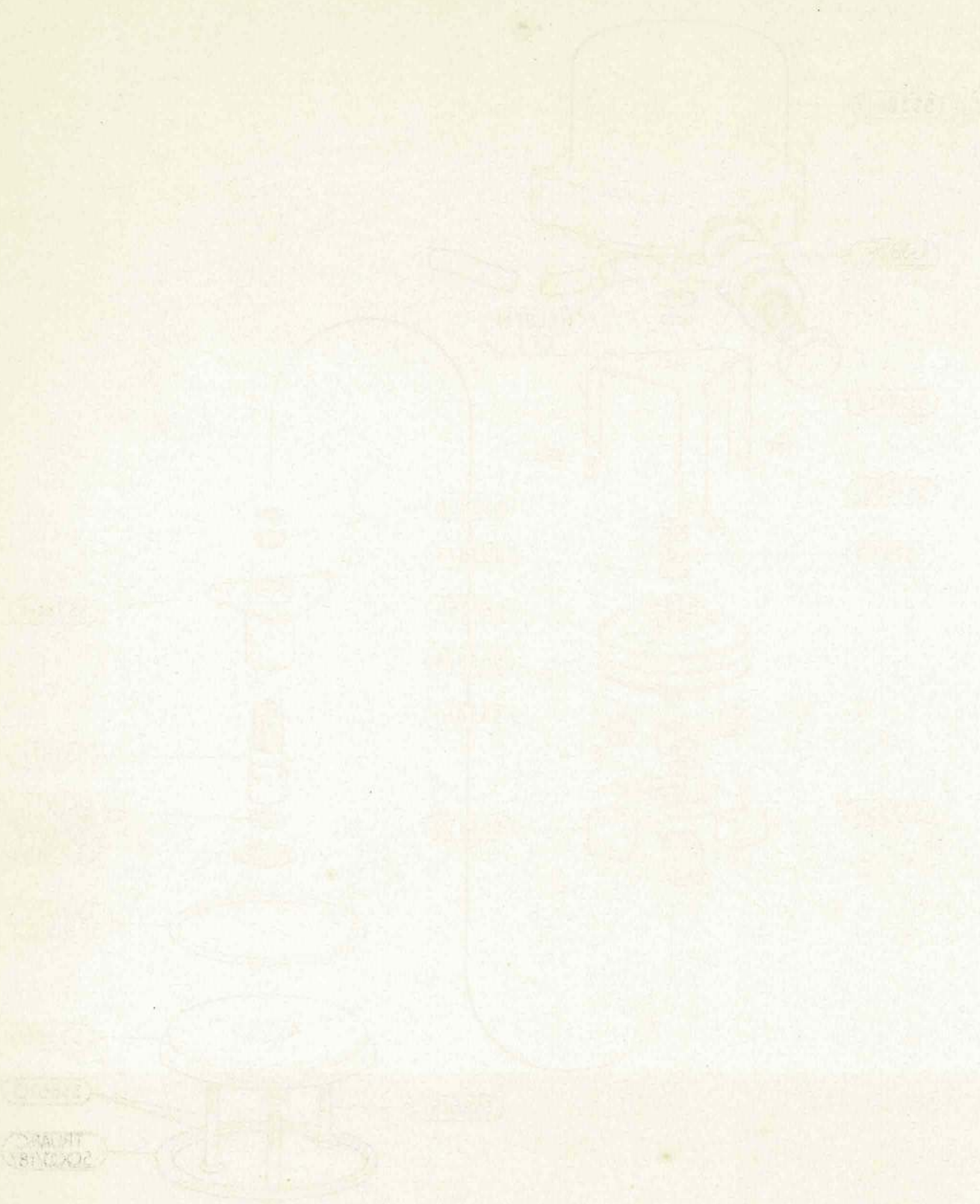

ASSEMBLED VARIANTS

This file was downloaded  
from the RTFM Library.

Link: [www.scottbouch.com/rtfm](http://www.scottbouch.com/rtfm)

Please see site for usage terms,  
and more aircraft documents.

