

VALVES, LINE

KK









VALVE, LINE

Ref. No.	Part No.	Description					No. Off	Matl. Spec.	CL. OF	Plate No.
		1	2	3	4	5			ST.	
934	511980	<b>VALVE, LINE</b> ... ..					1	—	A	KK 1
		Spares for:—								
	ND/S 327	<b>BODY</b> , valve, complete with guide bush ... ..					1	—		KK 1
28N/11404	AGS.596/B	Cap, dust, protection ... ..					2	—	C	
	OP.12140	<b>HANDWHEEL</b> , complete ... ..					1	—		KK 1
28M/10319	AGS.2002/C3	Nut, 2 B.A. ... ..					1	—	C	
28W/14319	SP11/C	Washer, 2 B.A. ... ..					1	—	C	
28W/14621	SP11/E	Washer, 1/4" B.S.F. ... ..					2	—	C	
	504124	<b>NAMEPLATE</b> ... ..					1	L.4		KK 1
	OP.12107	<b>NUT</b> , actuating ... ..					1	DTD.525		KK 1
	OP.12111	<b>NUT</b> , housing ... ..					1	L.65		KK 1
	OP.12110	<b>PLATE</b> , pressure, at housing nut ... ..					1	DTD.525		KK 1
	OP.12132	<b>PLATE</b> , panel ... ..					1	L.34		KK 1
28D/8342	AS.1248/2C	Bolt, 2 B.A. ... ..					2	—	C	
	OP.12105	<b>VALVE</b> , assembly ... ..					1	—		KK 1
		Spares for:—								
937	OP.10631	<b>INSERT</b> ... ..					1	NYLON	C	KK 1
	OP.10632	<b>PIN</b> , guide ... ..					1	DTD.525		KK 1
938	OP.12397	<b>WASHER</b> , sealing at pressure plate ... ..					1	NYLON	C	KK 1
	DP.1005	<b>WASHER</b> . "Crinkle" — D. POWIS & SONS ... ..					1	—		



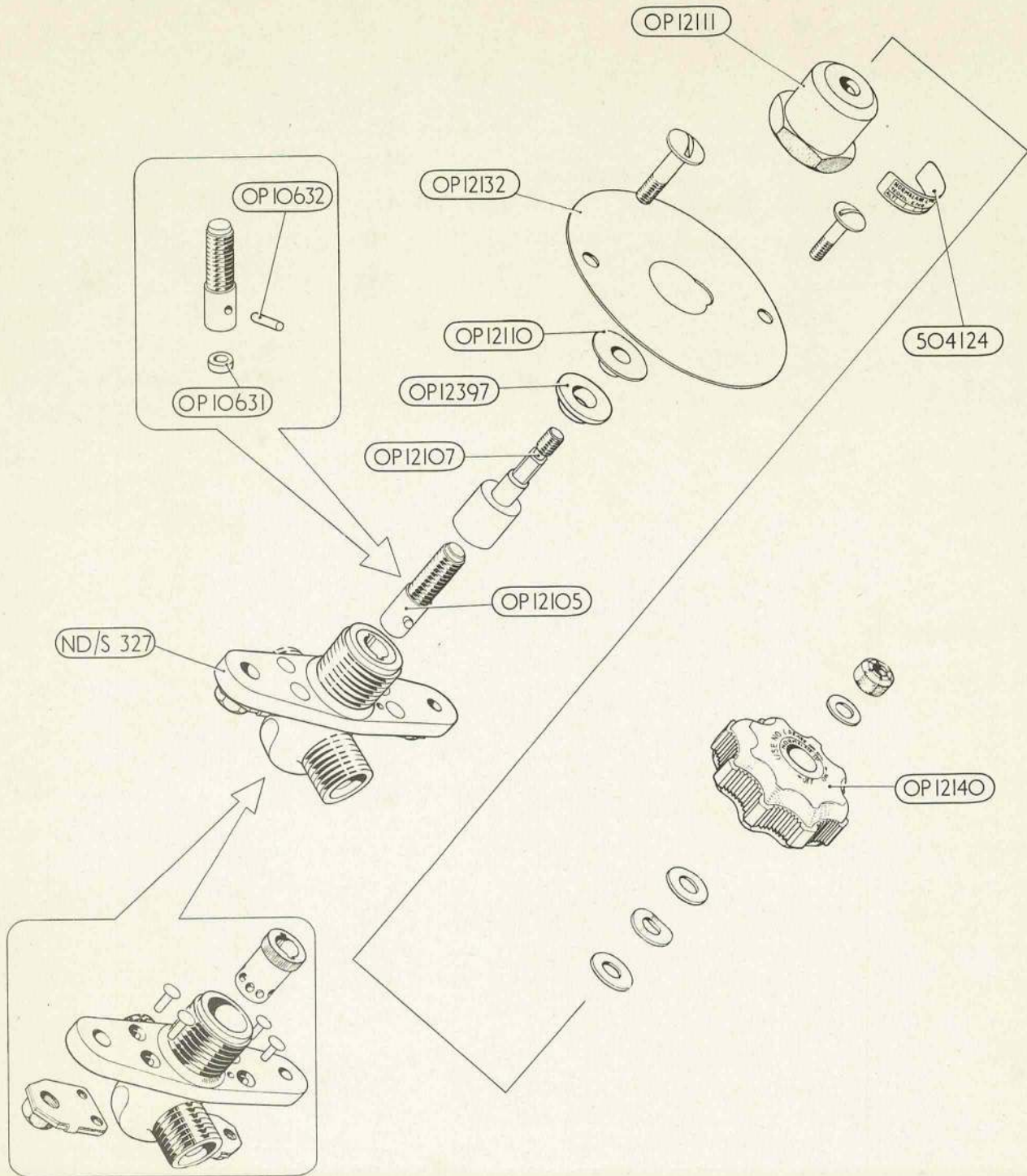

VALVE, LINE

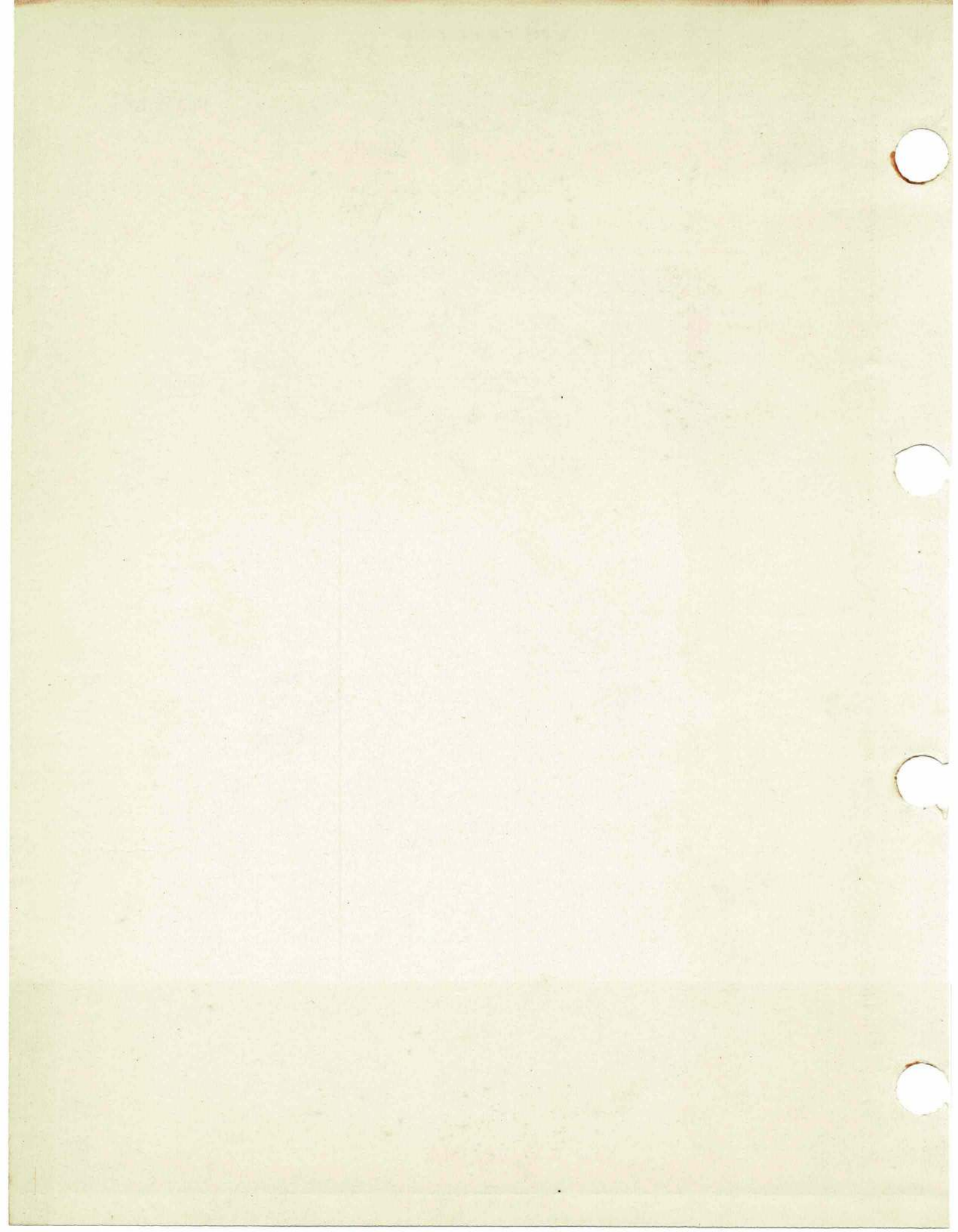

This file was downloaded  
from the RTFM Library.

Link: [www.scottbouch.com/rtfm](http://www.scottbouch.com/rtfm)

Please see site for usage terms,  
and more aircraft documents.

