

VALVES, EMERGENCY
RAM VENTILATING



TYPE / APPLICABILITY

Section L — VALVES, EMERGENCY RAM VENTILATING

ACCESSORY :-		VALVE, EMERGENCY RAM VENTILATING 503400														
AIRCRAFT	MK	No. OFF	MK	No. OFF	MK	No. OFF	MK	No. OFF	MK	No. OFF	MK	No. OFF	MK	No. OFF	MK	No. OFF
VULCAN		1														
		VALVE, EMERGENCY RAM VENTILATING 509220														
VICTOR		1														
		VALVE, EMERGENCY RAM VENTILATING 517590														
VICTOR		1														

VALVES, EMERGENCY RAM VENTILATING

Ref. No.	Part No.	Description	No. Off	Matl. Spec.	CL. OF ST.		Plate No.
					M.R.	L.M.	
		1 2 3 4 5					
475	503400	VALVE, EMERGENCY RAM VENTILATING ...	1	—	A	L1	
		Spares for :—					
5W/429	C.5511/2	ACTUATOR — ROTAX ...	1	—	A	L1	
28D/12528	A25/1B	Bolt ...	4	—	C		
28W/3097	AGS.162/B	Washer ...	4	—	C		
28W/9419401	SP10/B	Washer ...	4	—	C		
756	504203	ARM, indicating ...	1	L.40	C	L1	
28Q/9015	AGS.162/207	Rivet ...	1	—	C		
747	506897	ARM, link ...	1	L.1	C	L1	
28N/5549	AGS.899/2	Collar (PRE. AMDT. 8AH) ...	1	—	C		
28P/834	SP4/B8	Pin ...	1	—	C		
28P/12587	SP9/C4	Pin, split ...	1	—	C		
28W/9419402	SP13/C	Washer, 2 B.A. (AMDT. 8AH) ...	2	—	C		
940	504201	ARM, lever, complete ...	1	—	C	L1	
476	504192	ARM, transmitter ...	1	DTD.610	C	L1	
754	504190	BEARING, pivot ...	1	L.64	C	L1	
	ND/S228	BODY, assembly ...	1	—		L1	
		Spares for :—					
766	504202	STUD ...	8	S.1	C	L1	
765	508624	STUD ...	8	S.94	C	L1	
28M/10328	AGS.2002/C1	Nut ...	8	—	C		
28W/9419402	SP13/C	Washer ...	8	—	C		
	504217	BRACKET, assembly (PRE. MOD. 6AH) ...	1	—		L1	
		Spares for :—					
	504181	BRACKET ...	1	L.3		L1	
764	504204	PLATE, indicator ...	1	L.3	C	L1	
28Q/8139	AS.157/204	Rivet ...	3	—	C		
	555110	BRACKET, assembly (MOD. 6AH) ...	1	—		L1	
		Spares for :—					
	555111	BRACKET ...	1	L.70		L1	
764	504204	PLATE, indicator ...	1	L.3	C	L1	
28M/13279	AGS.2019/C1	Nut ...	4	—	C		
28Q/8139	AS.157/204	Rivet ...	3	—	C		
28Q/7680	AS.165/305	Rivet ...	8	—	C		
762	504188	CAP, bearing ...	1	L.40	C	L1	
28D/12528	A25/1B	Bolt ...	3	—	C		
28W/3097	AGS.162/B	Washer ...	6	—	C		
	506768	CONNECTOR ...	1	L.64		L1	
28D/12528	A25/1B	Bolt ...	3	—	C		
28W/9419401	SP10/B	Washer ...	6	—	C		
	506199	DOWEL ...	1	L.1		L1	

VALVES, EMERGENCY RAM VENTILATING

Ref. No.	Part No.	Description	No. Off	Matl. Spec.	CL. OF			Plate No.
					ST.	M.R.	L.M.	
		1 2 3 4 5						
746	504183	END, fork	1	L.40	C		L1	
534	500500	NAMEPLATE (R.N.)	1	L.4	C		L1	
28S/6470	2R 3/16"	Screw	4	—	C			
748	506898	PIN, adjusting	1	S.110	C		L1	
28M/12931	A27/ET	Nut	2	—	C			
28P/834	SP4/B8	Pin	1	—	C			
28P/12587	SP9/C4	Pin, split	1	—	C			
28W/11060	AGS.2037/E	Washer	2	—	C			
28W/9418921	SP13/E	Washer	1	—	C			
752	504189	PIN, pivot	1	DTD.142	C		L1	
763	506896	PLATE, keep	1	DTD.546	C		L1	
28S/5799	A31/B6	Screw	1	—	C			
749	503406	PLATE, valve assembly Spares for :—	1	—	C		L1	
	503409	PLATE, retaining	1	DTD.118A			L2	
	503407	PLATE, valve	1	L.124			L2	
	503408	RING, sealing	1	RUBBER			L2	
28S/2810	A33/A12	Screw	12	—	C			
28S/14545	A31/B10	Screw (AMDT. 13AH)	1	—	C			
759	504194	SCREW (PRE. AMDT. 13AH)	1	S.1	C		L1	
28W/3097	AGS.162/B	Washer	1	—	C			
755	504196	SCREW, grub	1	L.40	C		L1	
750	504186	SEAL	AR	KLING	C		L1	
	504186/1	SEAL (AMDT. 8AH)	AR	KLING				
	504186/2	SEAL (AMDT. 8AH)	AR	KLING				
751	503405	SEATING, valve plate	1	L.45	C		L1	
	504218	SHAFT, driving assembly (PRE. MOD. 5AH) Spares for :—	1	—			L1	
	504182	ADAPTER	1	L.41			L2	
	504197	PIN, locking	1	L.40			L2	
	504184	SHAFT, driving	1	L.40			L2	
761	555237	SHAFT, driving assembly (MOD. 5AH) Spares for :—	1	—	C		L1	
	553491	ADAPTER	1	DTD.525			L2	
	555235	PIN, shear	1	L.44			L2	
	555236	SHAFT, driving	1	L.65			L2	
753	504185	SPINDLE	1	S.110	C		L1	
6A/2134	135FL	TRANSMITTER, position — SMITH	1	—	A		L1	
28D/12531	A25/3C	Bolt	4	—	C			
28W/9419402	SP13/C	Washer	4	—	C			
1461	DDS.1019/A	WASHER	2	—	C		L1	
760	504199	WASHER, sealing	2	ALUM.	C		L1	

VALVES, EMERGENCY RAM VENTILATING

Ref. No.	Part No.	Description	No. Off	Matl. Spec.	CL. OF ST.	Plate No.
					M.R.	
		1 2 3 4 5				
524	509220	VALVE, EMERGENCY RAM VENTILATING ...	1	—	A	L3
		Spares for:—				
5CW/435	CZ.75792	ACTUATOR — PLESSEY ...	1	—	A	L3
5CW/2594	CZ.135792	ACTUATOR — PLESSEY (alternative to CZ.75792) (AMDT. 8AH).	1	—	A	
	550461	ARM, lever, complete ...	1	—		L3
28S/209	A33/B12	Screw ...	1	—	C	
747	506897	ARM, link ...	1	L.1	C	L3
	AGS.672/2	Collar (PRE. AMDT. 8AH) ...	1	—	C	
28P/834	SP4/B8	Pin ...	1	—	C	
28P/12587	SP9/C4	Pin, split ...	1	—	C	
28W/9419402	SP13/C	Washer (AMDT. 8AH) ...	1	—	C	
476	504192	ARM, transmitter ...	1	DTD.160	C	L3
	ND/S249	BODY, assembly ...	1	—		L3
		Spares for:—				
766	504202	STUD ...	8	S.1	C	L3
28M/10328	AGS.2002/C1	Nut ...	8	—	C	
28W/9419402	SP13/C	Washer ...	8	—	C	
	550468	BOLT, special ...	2	S.95		L3
28L/13124	A27/CT	Nut ...	2	—	C	
	550459	BRACKET ...	1	L.59		L3
28D/12528	A25/1B	Bolt ...	3	—	C	
28W/3097	AGS.162/B	Washer ...	3	—	C	
	550460	BRACKET, support ...	1	L.51		L3
28M/10327	AGS.2002/B1	Nut ...	4	—	C	
28W/9419465	SP13/B	Washer ...	4	—	C	
762	504188	CAP, bearing ...	1	L.40	C	L3
28D/12528	A25/1B	Bolt ...	3	—	C	
28W/9419401	SP10/B	Washer ...	6	—	C	
	551020	CONNECTOR ...	1	L.65		L3
28L/13140	A27/BT	Nut ...	3	—	C	
28W/3097	AGS.162/B	Washer, spring ...	6	—	C	
746	504183	END, fork ...	1	L.40	C	L3
5W/986	CZ.79350	GEARBOX — PLESSEY ...	1	—	A	L3
28D/12520	A25/4E	Bolt ...	2	—	C	
28M/10330	AGS.2002/E1	Nut ...	2	—	C	
28W/9418921	SP13/E	Washer ...	4	—	C	
534	500500	NAMEPLATE (R.N.) ...	1	—	C	L3
28S/6470	2R 3/16"	Screw ...	4	—	C	
	553238	NUT (AMDT. 3AH) ...	2	S.113		L3

VALVES, EMERGENCY RAM VENTILATING

Ref. No.	Part No.	Description	No. Off	Matl. Spec.	CL. OF ST.			Plate No.
					1	2	3	
	506898	PIN , adjusting	1	S.110				L 3
28N/5549	AGS.899/2	Collar	1	—			C	
28M/12931	A27/ET	Nut	2	—			C	
28P/835	SP4/B9	Pin	1	—			C	
28P/12587	SP9/C4	Pin, split	1	—			C	
28W/11060	AGS.2037/E	Washer	2	—			C	
	504189	PIN , pivot	1	DTD.142				L 3
	550453	PIN , pivot bearing	1	L.64				L 3
	550462	PLATE , actuator mounting, complete	1	—				L 3
28D/12519	A25/3E	Bolt	1	—			C	
28W/3099	AGS.162/D	Washer	1	—			C	
28W/9418921	SP13/E	Washer	1	—			C	
	503406	PLATE , valve assembly Spares for :—	1	—				L 3
	503409	PLATE , retaining	1	DTD.118A				L 2
	503407	PLATE , valve	1	L.124				L 2
	503408	RING , sealing	1	RUBBER				L 2
28S/2810	A33/A12	Screw	12	—			C	
750	504186	SEAL	AR	KLING			C	L 3
	504186/1	SEAL (AMDT. 13AH)	AR	KLING				
	504186/2	SEAL (AMDT. 13AH)	AR	KLING				
	R.105	SEAL — GACO	1	—				L 3
	R.113	SEAL — GACO	1	—				L 3
	504245	SEATING , valve	1	L.45				L 3
	550465	SHAFT , driving assembly Spares for :—	1	—				L 3
	550464	COUPLING	1	S.80				L 2
	550457	SHAFT , driving	1	L.65				L 2
28P/5322	SP29/E4	Pin, taper	2	—			C	
	550458	SPINDLE	1	S.110				L 3
6A/2134	135FL	TRANSMITTER , position — SMITH	1	—			A	L 3
28D/12531	A25/3C	Bolt	4	—			C	
28M/10328	AGS.2002/C1	Nut	4	—			C	
28W/9419402	SP13/C	Washer	4	—			C	
1461	DDS.1019/A	WASHER	2	—			C	L 3
	504199	WASHER , sealing	2	—				L 3

VALVES, EMERGENCY RAM VENTILATING

Ref. No.	Part No.	Description	No. Off	Matl. Spec.	CL. OF ST.			Plate No.
					1	2	3	
1454	517590	VALVE, EMERGENCY RAM VENTILATING ... (MANUALLY OPERATED)	1	—	A			L 4
		Spares for :—						
747	506897	ARM, link	1	L.1	C			L 4
28P/834	SP4/B8	Pin	1	—	C			
28P/12587	SP9/C4	Pin, split	1	—	C			
28W/9419402	SP13/C	Washer	1	—	C			
	557845	BEARING	1	L.65				L 4
28D/12528	A25/1B	Bolt	3	—	C			
28W/3097	AGS.162/B	Washer, spring	3	—	C			
	560514	BEARING, sprocket (MOD. 2CA)	1	L.65				
	557844	BEARING, sprocket (PRE. MOD. 2CA)	1	L.65				L 4
28M/13140	A27/BT	Nut	3	—	C			
28W/3097	AGS.162/B	Washer, spring	3	—	C			
	ND/S.333	BODY, assembly	1	—				L 4
		Spares for :—						
766	504202	STUD	8	S.1	C			L 4
1455	550452	STUD	3	S.94	C			L 4
	AGS.2002/C1	Nut	8	—	C			
28M/10328	SP13/C	Washer	8	—	C			
	560515	CARRIER, sprocket (MOD. 2CA)	1	S.110				
1459	557847	CARRIER, sprocket (PRE. MOD. 2CA)	1	S.110	C			L 4
	504183	END, fork	1	L.40	C			L 4
28P/834	SP4/8B	Pin	1	—	C			
28P/12587	SP9/C4	Pin, split	1	—	C			
28W/9419402	SP13/C	Washer	1	—	C			
	560517	GUARD, chain (MOD. 2CA)	1	L.70				
	557848	GUARD, chain (PRE. MOD. 2CA)	1	L.54				L 4
28Q/7189	AS.157/304	Rivet	3	—	C			
	500500	NAMEPLATE (R.N.)	1	L.4	C			L 4
28S/6470	2R-3/16"	Screw	4	—	C			
	506898	PIN, adjusting	1	S.110	C			L 4
28M/12931	A27/ET	Nut	2	—	C			
28P/834	SP4/B8	Pin	1	—	C			
28P/12587	SP9/C4	Pin, split	1	—	C			
28W/9419402	SP13/C	Washer	1	—	C			
28W/11060	AGS.2037/E	Washer	2	—	C			
	504189	PIN, pivot	2	DTD.142	C			L 4
	560516	PLATE, stop (MOD. 2CA)	1	S.110				
28M/17600	A52/B	Nut	1	—	C			
28S/13572	A39/B16	Screw	1	—	C			

VALVES, EMERGENCY RAM VENTILATING

Ref. No.	Part No.	Description	No. Off	Matl. Spec.	CL. OF		Plate No.
					ST.	M.R.	
		1 2 3 4 5				L.M.	
749	503406	PLATE, valve, assembly Spares for :-	1	—	C		L4
	503409	PLATE, retaining	1	DTD.118A			L2
	503407	PLATE, valve	1	L.124			L2
	503408	RING, sealing... ..	1	RUBBER			L2
28S/2810	A33/A12	Screw:	12	—	C		
27QA/300	SP900/C5	RING, 'O' — DOWTY	2	—	C		L4
750	504186	SEAL	1	KLING	C		L4
	504245	SEATING, valve plate	1	L.45			L4
1456	557843	SHAFT	1	S.80	C		L4
28M/13411	A24/CS	Nut	1	—	C		
28P/9429619	SP9/C5	Pin, split	1	—	C		
1458	557846	SPROCKET	1	S.3	C		L4
28Q/1790	AS.460/404	Rivet	4	—	C		
28M/10339	AGS.2002/C2	Nut	1	—	C		
1457	480983	WASHER	1	L.3	C		L4
1460	554270	WASHER	1	S.110	C		L4
760	504199	WASHER	AR	ALUM.	C		L4
1461	DDS.1019/A	WASHER	2	—	C		L4

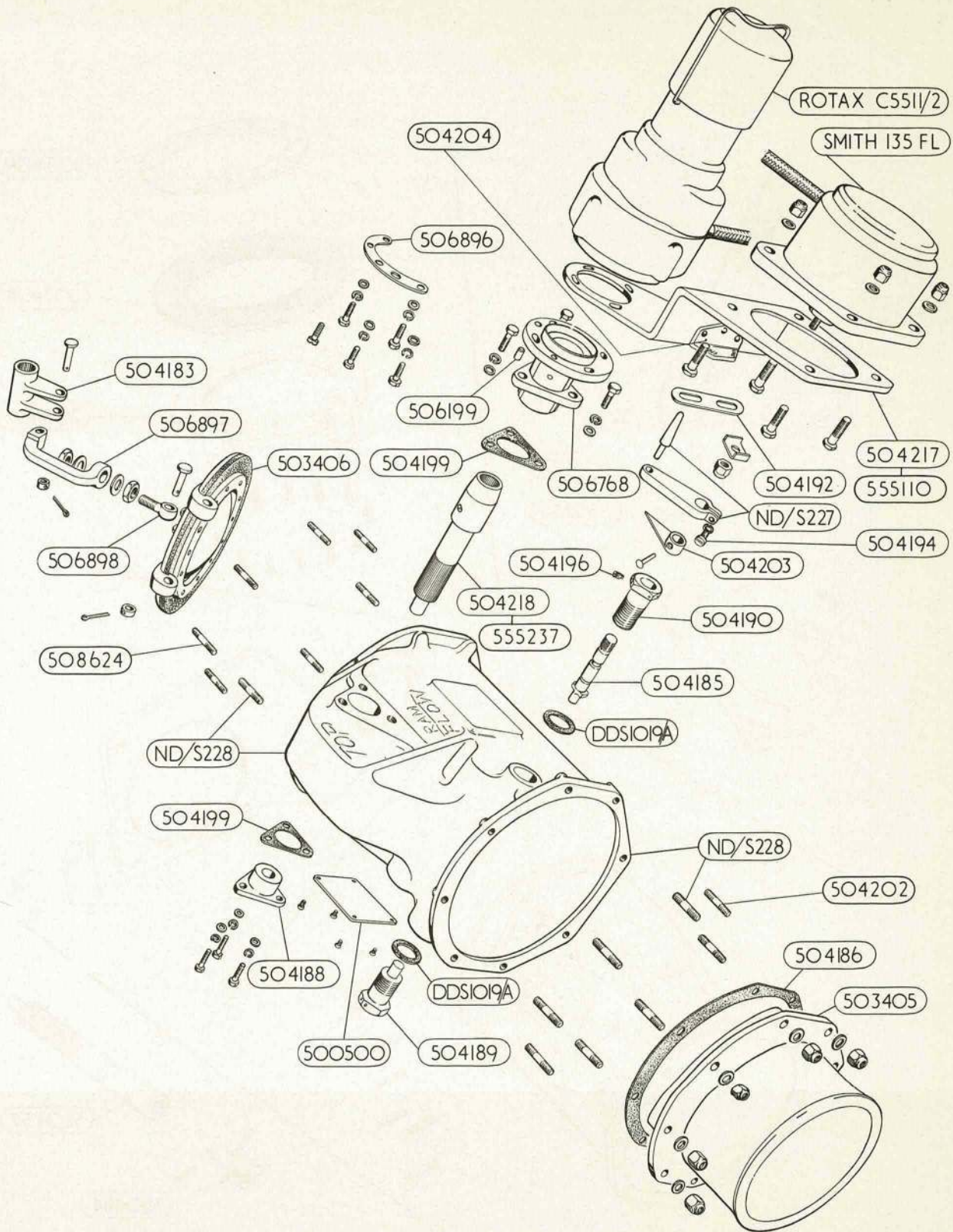

VALVE, EMERGENCY RAM VENTILATING

PLATE L 2

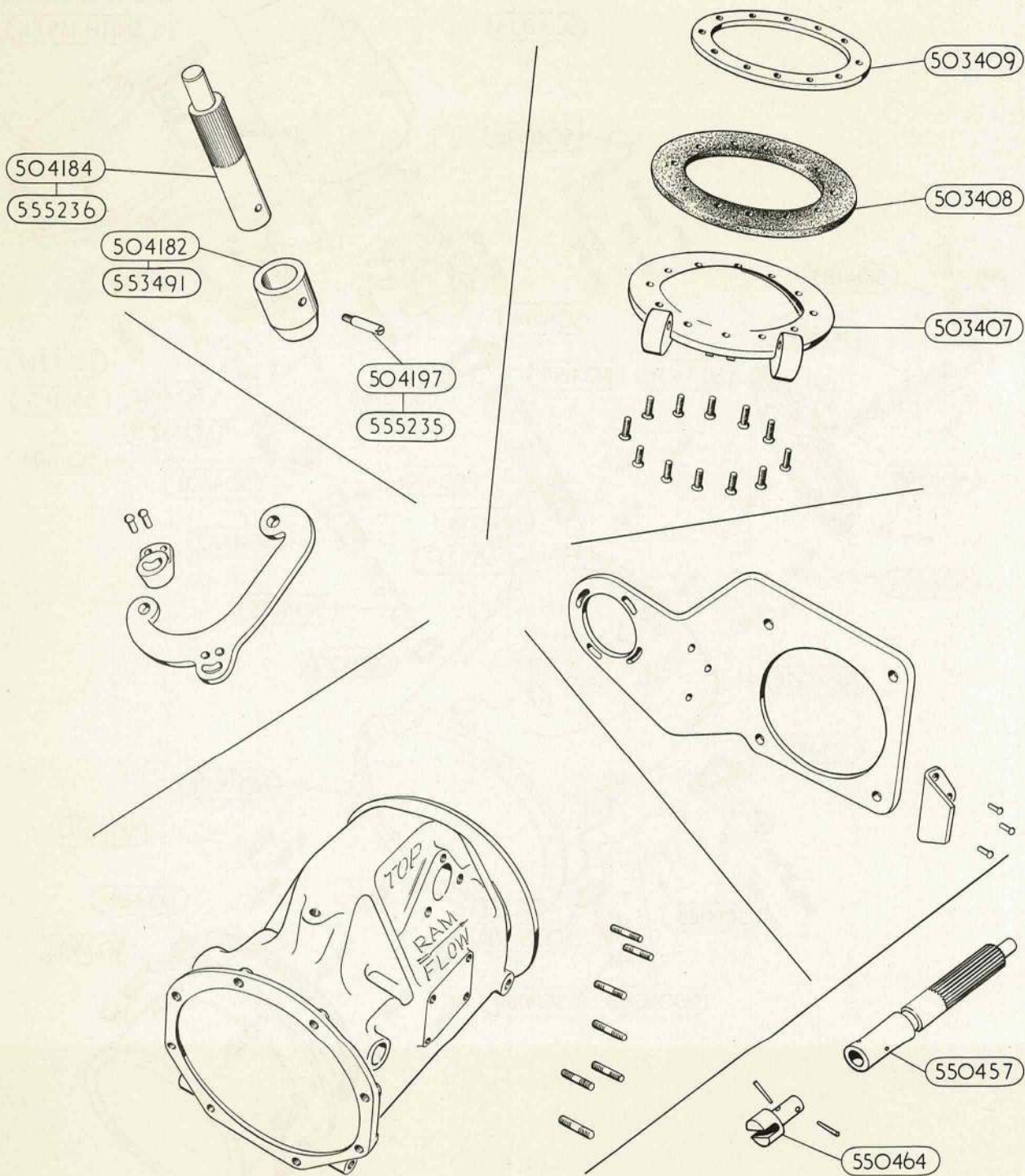

ASSEMBLIES VARIOUS

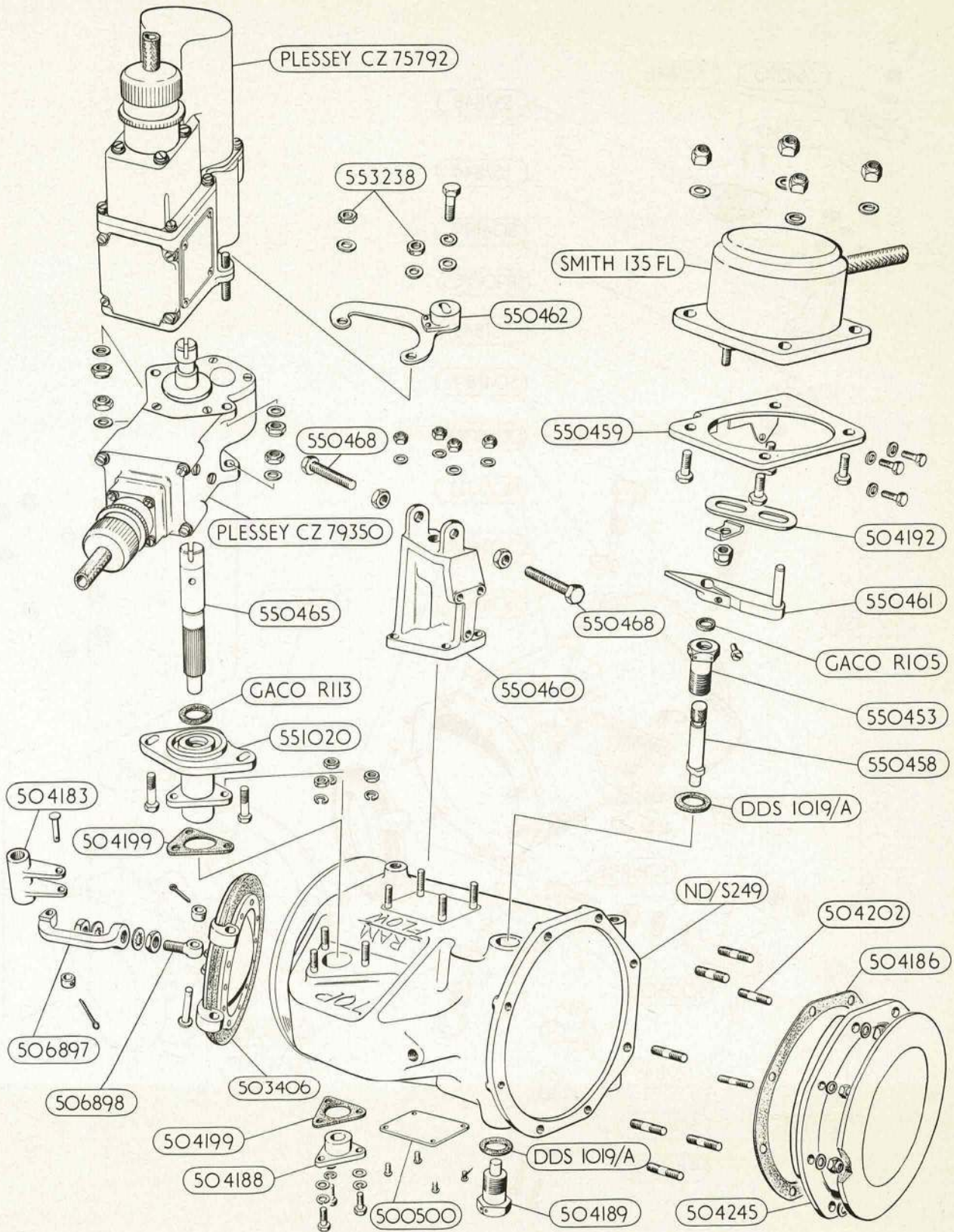

VALVE, EMERGENCY RAM VENTILATING

PLATE L4

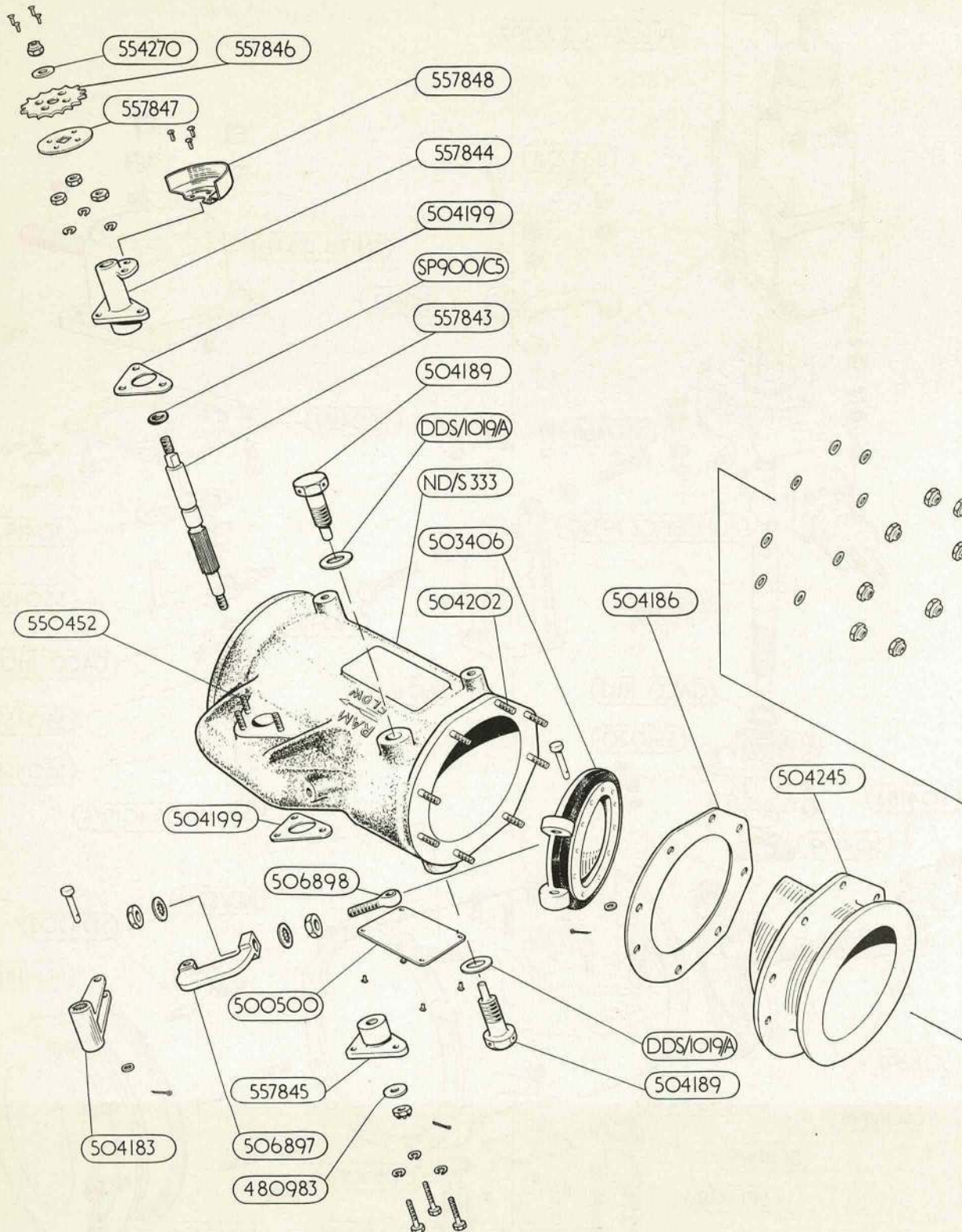

VALVE, EMERGENCY, RAM VENTILATING.

This file was downloaded
from the RTFM Library.

Link: www.scottbouch.com/rtfm

Please see site for usage terms,
and more aircraft documents.

