

Z VALVES, REDUCING

VALVES, REDUCING

Ref. No.	Part No.	Description	No. Off	Matl. Spec.	CL. OF ST.			Plate No.
					1	2	3	
31	504360	VALVE, REDUCING	1	—	A			N 1
		Spares for :—						
344	497426	BANJO, special	1	DTD.126	C			N 1
338	497851	BODY, valve	1	DTD.133C	C			N 1
348	DDS.1092/1B	BOLT	6	M.S.	C			N 1
345	497948	BOLT, special	1	DTD.126	C			N 1
	497856	BRACKET, mounting	1	L.3				N 1
	497857	BRACKET, mounting	1	L.3				N 1
353	497854	CAP, retaining, assembly	1	—	B			N 1
		Spares for :—						
	497849	CAP, retaining	1	L.1				N 2
27H/2948	100P 1/2	MOUNTING, Lord — SPERRY	1	—	B			N 2
28S/6287	A32/B6	Screw	4	—	C			
28L/11067	AGS.2035/B	Washer	4	—	C			
339	497852	CAPSULE, atmospheric, complete	1	—	C			N 1
112	498135	FILTER	1	PHR.BR.	C			N 1
340	501242	GLAND, packing	1	KAUTEX	C			N 1
27H/2948	100P 1/2	MOUNTING, Lord — SPERRY	5	—	B			N 1
28D/12565	A25/8B	Bolt	3	—	C			
28M/5315	A16/BP	Nut	16	—	C			
28M/10327	AGS.2002/B1	Nut	3	—	C			
28S/3426	A32/B8	Screw	12	—	C			
28S/2857	A32/B12	Screw	8	—	C			
28S/2856	A32/C12	Screw	4	—	C			
28L/11067	AGS.2035/B	Washer	20	—	C			
28L/11069	AGS.2035/C	Washer	4	—	C			
586	494031	NAMEPLATE (R.N.)	1	L.4	C			N 1
28S/6470	2R 3/16	Screw	4	—	C			
343	496636	NUT, cap	1	L.1	C			N 1
28W/12676	SP22/B	Washer	1	—	C			
341	497481	NUT, lock	1	—	C			N 1
346	497855	PLATE, cover, complete	1	—	B			N 1
	503086	PLATE, locking, complete	1	—				N 1
352	501534	RING, packing	1	SPR.S.	C			N 1
	497947	STOP, complete	2	—				N 1
	497965	TAB, locking	1	DTD.124A				N 1
349	503087	TAB, locking	1	DTD.124	C			N 1
28M/10326	AGS.2002/A1	Nut	1	—	C			
28S/3501	A32/A8	Screw	1	—	C			

VALVES, REDUCING

Ref. No.	Part No.	Description	No. Off	Matl. Spec.	CL. OF ST.			Plate No.
					1	2	3	
350	506730/5	VALVE, safety assembly	1	—			B	N 1
		Spares for :—						
	506729	RETAINER, spring	1	L.40				N 2
	497845/3	SPRING	1	SPR.ST.				N 2
28M/12931	A27/ET	Nut	1	—			C	
52	400468	WASHER	4	DTD.37A			C	N 1
105	497438	WASHER	3	DDS.1017			C	N 1
351	497847	WASHER	1	RUBBER			C	N 1
342	400451/1	WASHER	1	DDS.1017			C	N 1

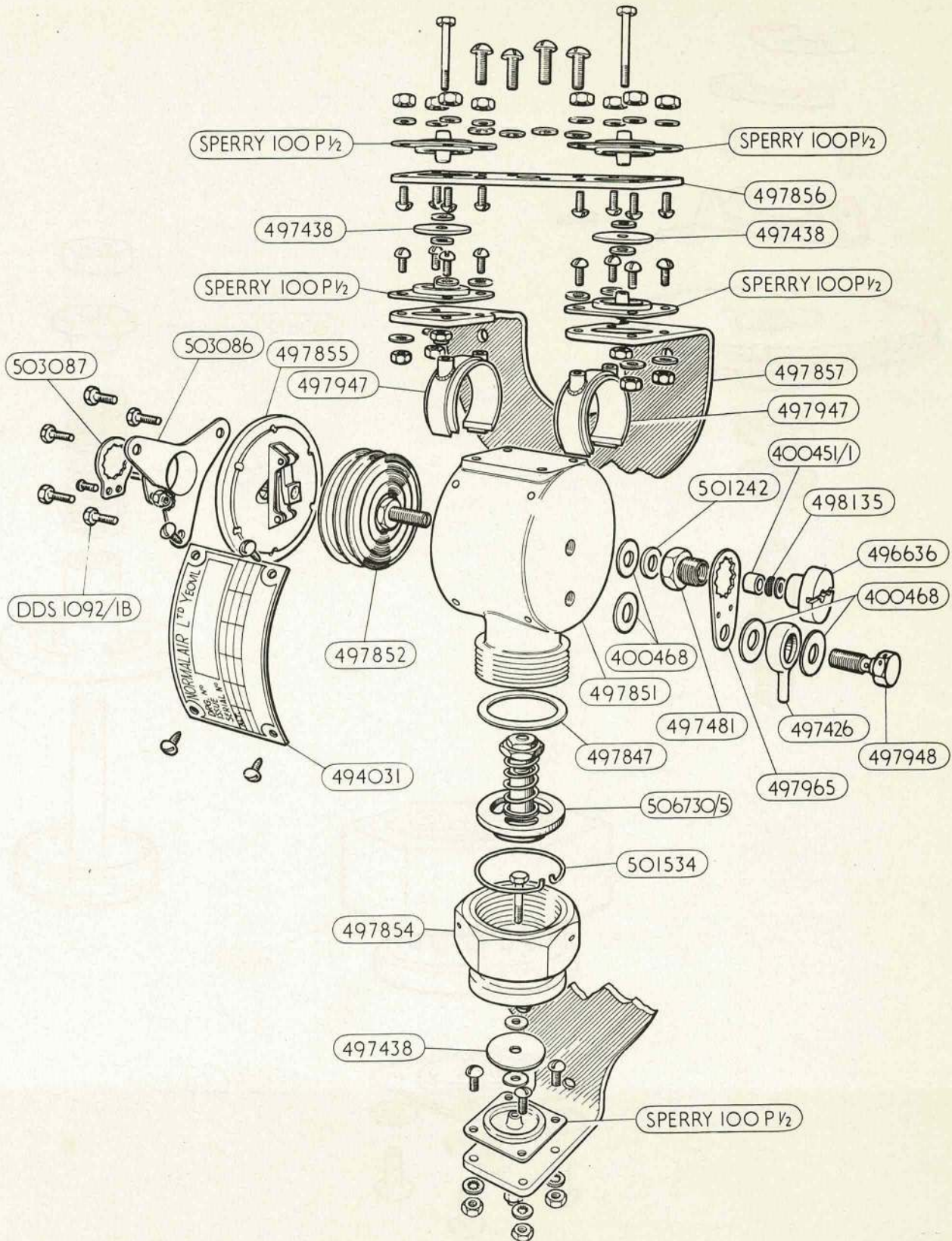

VALVE , REDUCING

PLATE N2

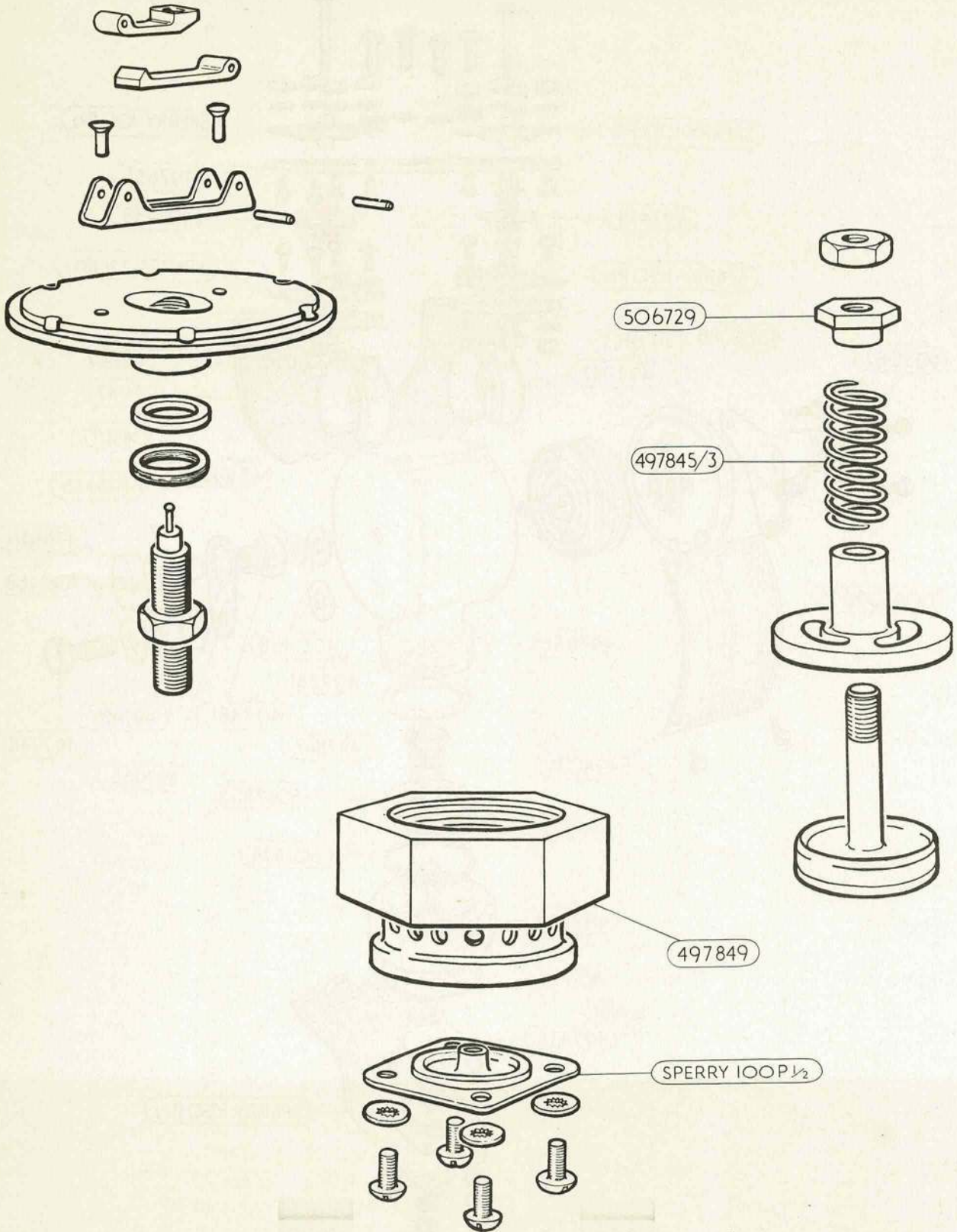

ASSEMBLIES VARIOUS

This file was downloaded
from the RTFM Library.

Link: www.scottbouch.com/rtfm

Please see site for usage terms,
and more aircraft documents.

