

R VALVES,
SYLPHON OPERATED

TYPE / APPLICABILITY

Section R — VALVES, SYLPHON OPERATED

ACCESSORY :-		VALVE, SYLPHON OPERATED 504280														
AIRCRAFT	MK	No. OFF	MK	No. OFF	MK	No. OFF	MK	No. OFF	MK	No. OFF	MK	No. OFF	MK	No. OFF	MK	No. OFF
VALIANT		1														
		VALVE, SYLPHON OPERATED 513320														
VICTOR	1	2	2	2												
		VALVE SYLPHON OPERATED 521080														
VICTOR	1	1	2	1												

VALVES, SYLPHON OPERATED

Ref. No.	Part No.	Description	No. Off	Matl. Spec.	CL. OF ST.			Plate No.
					1	2	3	
39	504280	VALVE, SYLPHON OPERATED	1	—			A	R 1
		Spares for :—						
	503794	BEAM, complete	1	—				R 1
	501955	BELLOWS, complete	1	—				R 1
941	DDS.1092/Y/1B	BOLT (MOD. 6AQ)	1	—			C	R 1
28D/12528	A25/1B	Bolt	12	—			C	
28L/11049	AGS.2034/B	Washer	13	—			C	
	503863	BOLT, special	1	S.3				R 1
28W/13701	SP23/B	Washer (AMDT. 7AQ)	1	—			C	
	501964	CASING, complete with bracket	1	—				R 1
28S/2756	A31/A8	Screw	4	—			C	
28S/2761	A31/B12	Screw	3	—			C	
28W/3096	AGS.162/A	Washer	4	—			C	
28W/3088	AGS.163/B	Washer	3	—			C	
28W/9419464	SP13/A	Washer	4	—			C	
	503798	COUPLING, special, complete (PRE. MOD. 1AQ) ...	1	—				R 1
	550840	COUPLING, special, complete (MOD. 1AQ) ...	1	—				R 1
28F/12047	AGS.1186/A	Seal, bonded	2	—			C	
	503858	COVER assembly	1	—				R 1
		Spares for :—						
728	ND/S152	COVER, complete	1	—			C	R 2
731	503861	CAP	1	L.40			C	R 2
677	503859	PLATE, locking	1	S.3			C	R 2
676	503865	WASHER	1	DDS.1017			C	R 2
	501962	GASKET	1	RUBBER				R 1
729	504850	GASKET	1	DDS.1017			C	R 1
	481586	NAMEPLATE	1	L.4				R 1
28S/6470	2R 3/16"	Screw	4	—			C	
	503735	NUT, filter, complete	1	—				R 1
	503892	PIN	1	S.110				R 1
	503894	PIN	1	S.1				R 1
	503878	PIPE, complete	1	—				R 1
28F/9838	AGS.1104/A	Coupling, pipe	1	—			C	
28S/2761	A31/B12	Screw	2	—			C	
28F/12047	AGS.1186/A	Seal, bonded	2	—			C	
28W/3097	AGS.162/B	Washer	2	—			C	
	503856	PLATE, base	1	L.51				R 1
28F/9708	AGS.1104/B	Coupling, pipe	1	—			C	
28F/12048	AGS.1186/B	Seal, bonded	1	—			C	

VALVES, SYLPHON OPERATED

Ref. No.	Part No.	Description					No. Off	Matl. Spec.	CL. OF		Plate No.
		1	2	3	4	5			ST.	M.R.	
28S/2762 28W/3087	501967	PLATE, cover, complete	1	—			R 1
	A31/A12	Screw	4	—	C		
	AGS.163/A	Washer	4	—	C		
732	A.6370	SEAL, lead	2	—	C		R 2
	501965	SPRING	2	SPR.S.			R 1
727 28F/12082	503834	UNION, filter, complete	1	—	C		R 1
	AGS.1186/BB	Seal, bonded	1	—	C		
939	555972	UNION, special (MOD. 6AQ)	1	DTD.423	C		R 1
	503890	VALVE, charging, complete (PRE. MOD .1AQ)	1	—			R 1
	550874	VALVE, charging assembly (MOD. 1AQ)	1	—			R 1
ND/S210		Spares for:—									
		VALVE, miniature	1	—			R 2
311	DDS.1019/B	WASHER	1	ALUM.	C		R 1
	503895	WASHER	1	S.1			R 1
	503893	WASHER, special	2	S.3			R 1
	501953	YOKE, spring, complete	1	—			R 1

VALVES, SYLPHON OPERATED

Ref. No.	Part No.	Description	No. Off	Matl. Spec.	CL. OF ST.		Plate No.
					M.R.	L.M.	
1096	513320	VALVE, SYLPHON OPERATED (MOD. 8AQ) ...	1	—	A		R 1
		Spares for:— <i>PRE MOD 13AQ</i>					
	503794	BEAM, complete ...	1	—			R 1
1911	<i>521090</i>	<i>VALVE SYLPHON OPERATED MOD 13AQ</i>					
	501955	BELLOWS, complete ...	1	—			R 1
28S/2756	A31/A8	Screw, 6 B.A. ...	4	—	C		
28W/3096	AGS.162/A	Washer, 6 B.A. ...	4	—	C		
28W/9419464	SP13/A	Washer, 6 B.A. ...	4	—	C		
941	DDS.1092/Y/1B	BOLT, cover attachment to base plate and locking of special union.	3	—	C		R 1
	503863	BOLT, special spring yoke attachment ...	1	S.3			R 1
28W/9419465	SP13/B	Washer, 4 B.A. ...	1	—	C		
	501964	CASING, complete with beam attachment bracket.	1	—			R 1
28S/2761	A31/B12	Screw, 4 B.A. ...	3	—	C		
28W/3088	AGS.163/B	Washer, 4 B.A. ...	3	—	C		
	503858	COVER assembly ...	1	—			R 1
		Spares for:—					
728	NDS/152	COVER, complete ...	1	—	C		R 2
731	503861	CAP ...	1	L.40	C		R 2
677	503859	PLATE, locking ...	1	S.3	C		R 2
676	503865	WASHER ...	1	DDS.1017	C		R 2
28D/12528	A25/1B	Bolt, 4 B.A. ...	10	—	C		
28L/11049	AGS.2034/B	Washer, 4 B.A. ...	13	—	C		
	501962	GASKET, at pipe attachment to bellows ...	1	RUBBER			R 1
729	504850	GASKET, at attachment of casing to base plate ...	1	DDS.1017	C		R 1
	481586	NAMEPLATE ...	1	L.4	C		R 1
28S/6470	2R 3/16"	Screw ...	4	—	C		
	503892	PIN, beam attachment to bracket ...	1	S.110			R 1
	503894	PIN, beam stop ...	1	S.1			R 1
	503878	PIPE, complete ...	1	—			R 1
28F/9838	AGS.1104/A	Coupling, pipe ...	1	—	C		
28S/2761	A31/B12	Screw, 4 B.A. ...	2	—	C		
28F/12047	AGS.1186/A	Seal, bonded ...	1	—	C		
28W/3097	AGS.162/B	Washer, 4 B.A. ...	2	—	C		

VALVES, SYLPHON OPERATED

Ref. No.	Part No.	Description					No. Off	Matl. Spec.	CL. OF		Plate No.
		1	2	3	4	5			ST.	M.R.	
28F/9708 28F/12047 28F/12048	503856	PLATE, base	1	L.51			R 1
	AGS.1104/B	Coupling, pipe	1	—	C		
	AGS.565/A	Plug	1	—	C		
	AGS.1186/A	Seal, bonded	1	—	C		
	AGS.1186/B	Seal, bonded	1	—	C		
28S/2762 28W/3087	501967	PLATE, cover, complete	1	—			R 1
	A31/A12	Screw, 6 B.A.	4	—	C		
	AGS.163/A	Washer, 6 B.A.	4	—	C		
732	A6370	SEAL, lead	2	—	C		R 2
	501965	SPRING	2	SPR.S.			R 1
727 28F/12082	503834	UNION, filter, complete	1	—	C		R 1
	AGS.1186/BB	Seal, bonded	1	—	C		
939	555972	UNION, special	1	DTD.423	C		R 1
	550874	VALVE, charging assembly	1	—			R 1
	ND/S210	VALVE, miniature	1	—			R 2
311	DDS.1019/B	WASHER, valve seating	1	ALUM.	C		R 1
	503895	WASHER, attachment of beam stop pin to casing	1	S.1			R 1
	503893	WASHER, attachment of beam attachment pin to bracket.	2	S.3			R 1
	501953	YOKE, spring, complete	1	—			R 1

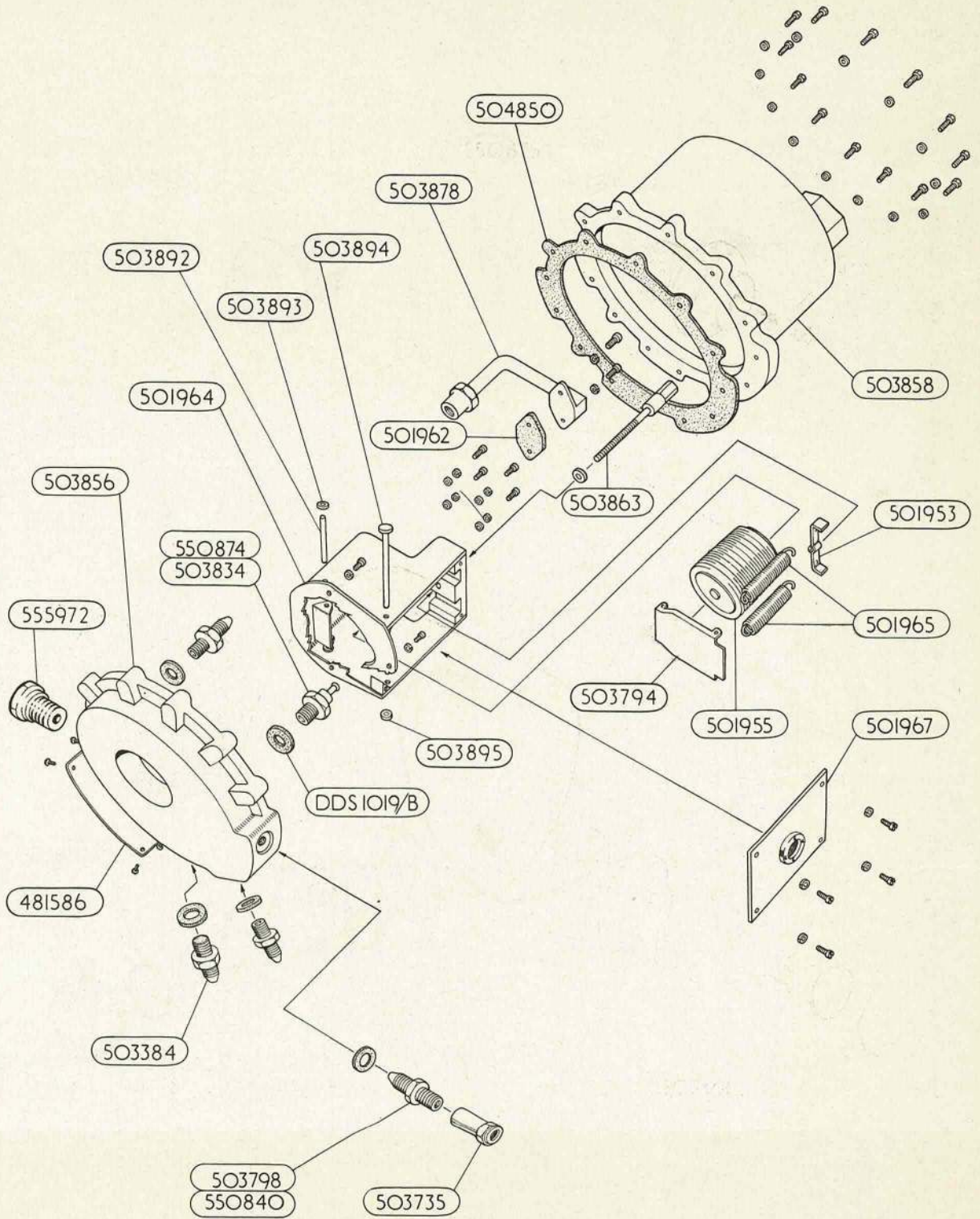

VALVE, SYLPHON OPERATED

PLATE R 2

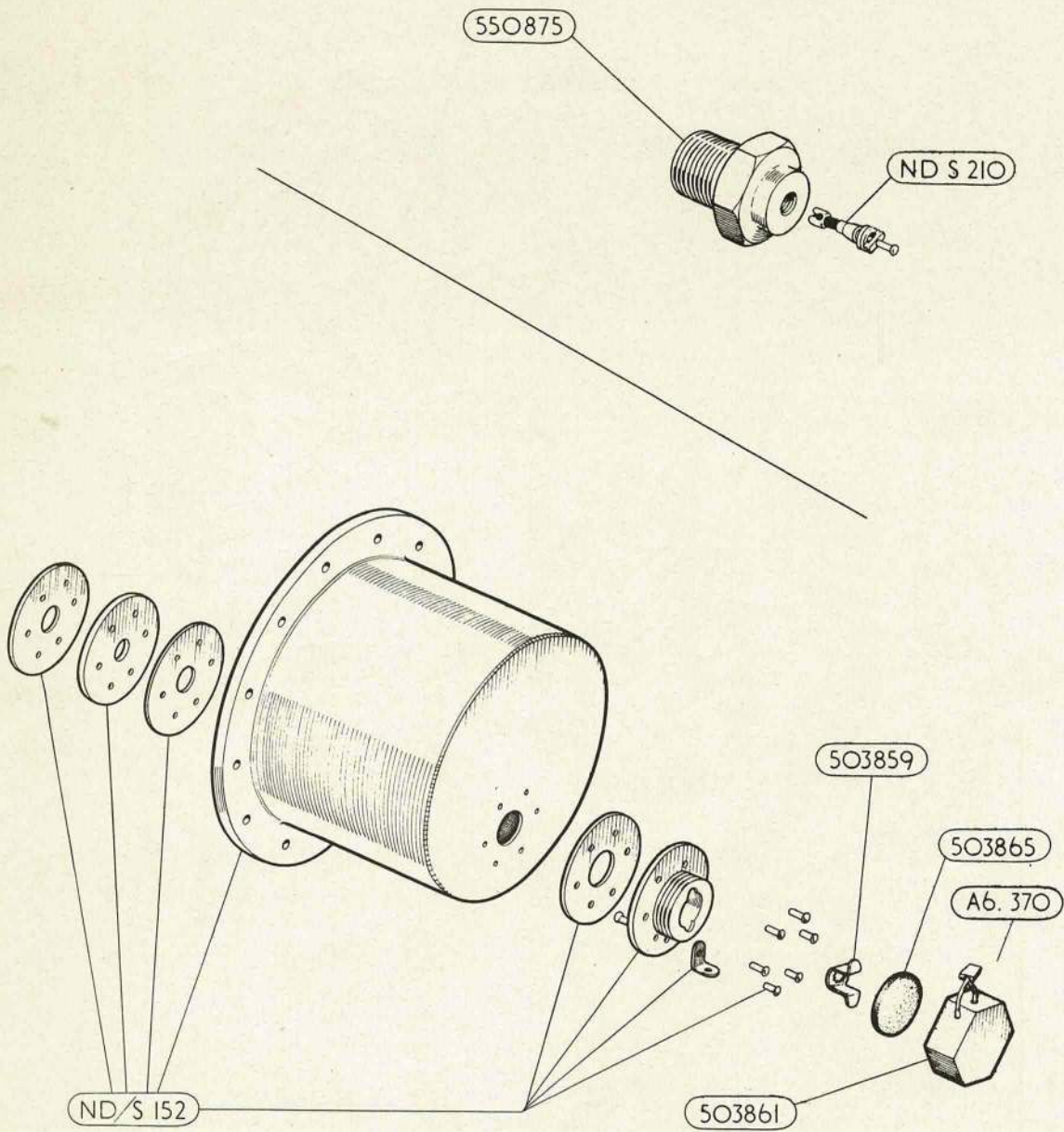

ASSEMBLIES VARIOUS

This file was downloaded from the RTFM Library.
Link: www.scottbouch.com/rtfm

Please see site for usage terms, and more aircraft documents.

