

VALVES, RELAY

C

VALVES, RELAY

Ref. No.	Part No.	Description	No. Off	Matl. Spec.	CL. OF ST.			Plate No.
					1	2	3	
625	510540	VALVE, RELAY	1	—			A	U 1
		Spares for :—						
	551866	BANJO	1	DTD.423B				U 1
	506956	BOLT, banjo	3	—				U 1
28F/10797	AGS.1129/A	Banjo	2	—			C	
28F/9428452	AGS.1186/A	Washer, sealing	6	—			C	
	551526	CASTING, centre chamber	1	L.124				U 1
	506168	CASTING, lower chamber	1	L.124				U 1
	551535	CASTING, upper chamber assembly	1	—				U 1
		Spares for :—						
	551521	CASTING, upper chamber	1	L.124				U 2
	506182	SCREW, grub	1	S.1				U 2
28D/12846	A25/15B	Bolt	12	—			C	
28M/10327	AGS.2002/B1	Nut	12	—			C	
28W/9419465	SP13/B	Washer	24	—			C	
	506914	CLAMP, valve	2	S.80				U 1
28S/2808	A33/C12	Screw	2	—			C	
	551533	DIAPHRAGM	2	RUBBER				U 1
	506918	GASKET	4	PHIB.				U 1
	506923	GASKET	1	RUBBER				U 1
	551525	GASKET	2	PHIB.				U 1
	504287	NAMEPLATE	1	DTD.610				U 1
28S/6237	4R 3/16"	Screw	2	—			C	
	551038	PIECE, centre	1	L.65				U 1
	506041	PIN, dowel	1	S.80				U 1
	506019	PLATE, diaphragm	2	DTD.603				U 1
	551524	PLATE, diaphragm	1	DTD.610				U 1
	551600	PLATE, diaphragm assembly	1	—				U 1
		Spares for :—						
	551523	PLATE	1	DTD.610				U 2
	551522	SPRING, leaf	2	DTD.187				U 2
28Q/7138	AS.157/303	Rivet	4	—			C	
28D/13147	A25/8A	Bolt	6	—			C	
28M/10286	AGS.2001/A1	Nut	6	—			C	
28F/16140	AGS.1186/1	Washer, sealing	6	—			C	
28W/15882	SP23/A	Washer	6	—			C	
	505922	PLATE, cover	1	L.64				U 1
28S/3421	A33/A8	Screw	3	—			C	
28S/2820	A33/C20	Screw	1	—			C	

VALVES, RELAY

Ref. No.	Part No.	Description	No. Off	Matl. Spec.	CL. OF ST.			Plate No.
					1	2	3	
	506919	SCREW, locking	1	S.1				U1
	551306	SCREW, locking	2	S.1				U1
	R.114	SEAL — GACO	2	—				U1
	R.116	SEAL — GACO	2	—				U1
	551040	SYLPHON, lower unit, complete	1	—				U1
	551039	SYLPHON, upper unit, complete	1	—				U1
28D/12621	A25/2A	Bolt	12	—			C	
28F/9433464	AGS.1186/1	Washer, sealing	12	—			C	
809	506012	UNION, special	3	BS.250			C	U1
28F/9428452	AGS.1186/A	Washer, sealing	3	—			C	
	506992	VALVE, assembly Spares for :—	2	—				U1
	506999	ADJUSTER, spring	2	S.1				U2
	506993	BODY, complete	2	—				U2
	550523	CORE, valve	2	BS.249				U2
	506997	PLUG	2	S.1				U2
	506998	SCREW, grub	4	S.1				U2
	R.105	SEAL — GACO	2	—				U2
	ND/S219	SPRING	2	—				U2
28R/6340	AGS.566/A	Plug, blanking	1	—			C	
28F/9428452	AGS.1186/A	Washer, sealing	1	—			C	

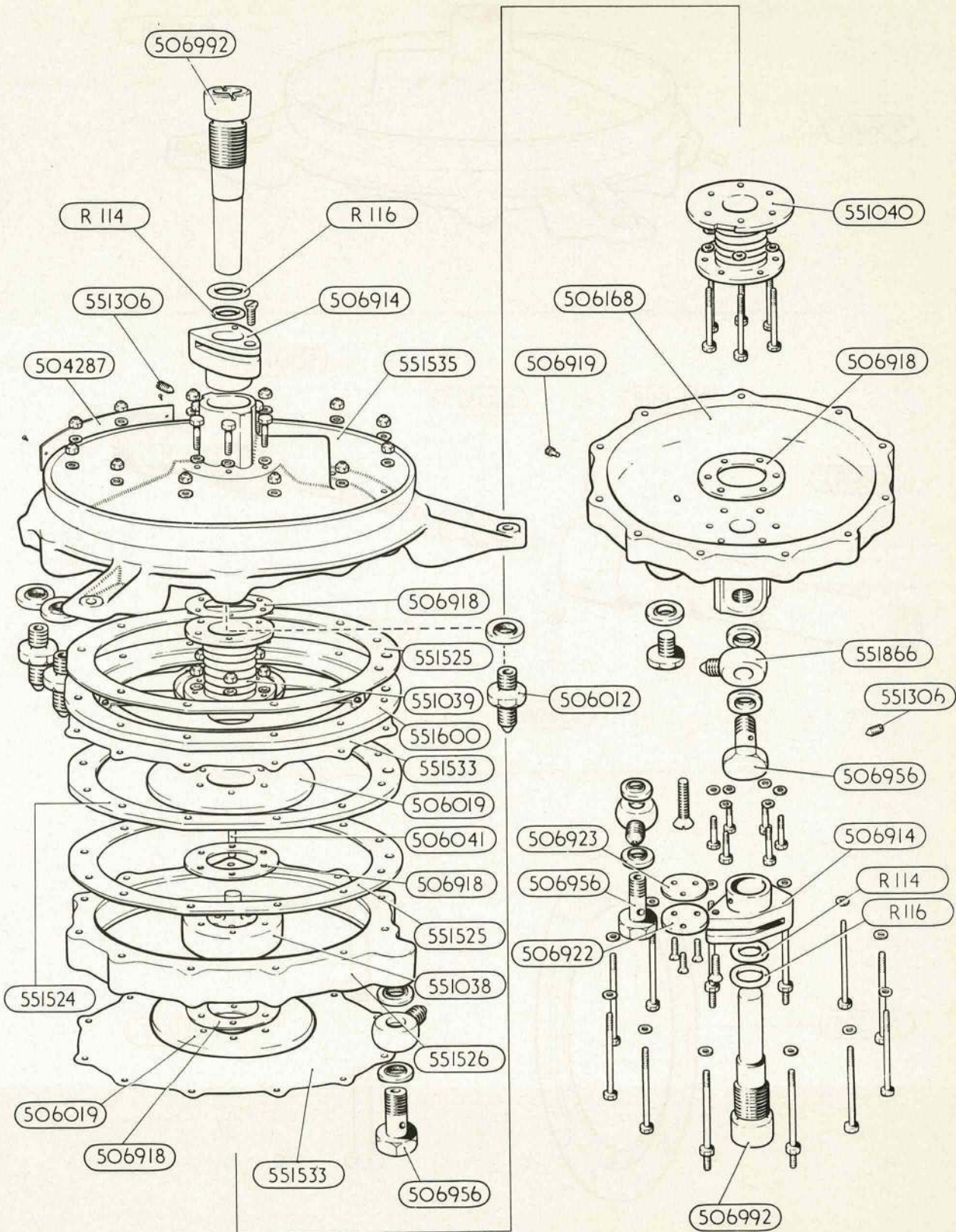

VALVE, RELAY

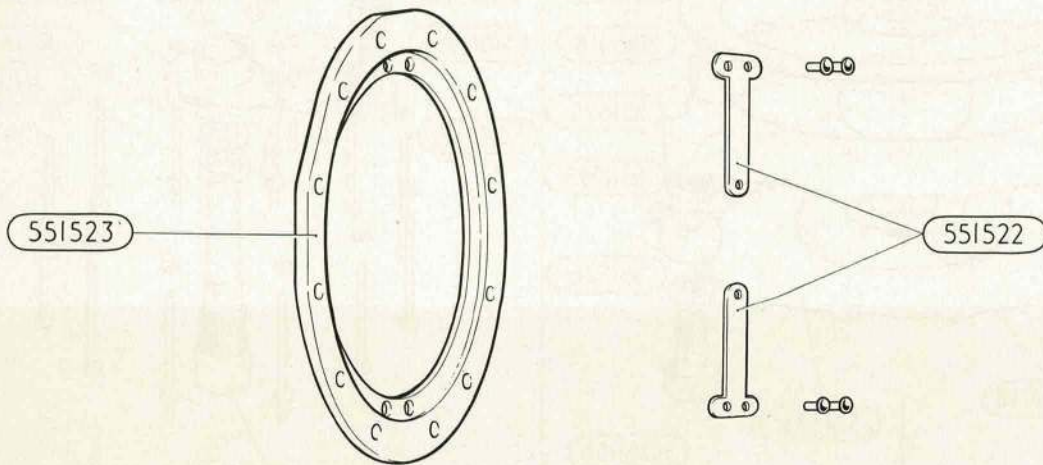
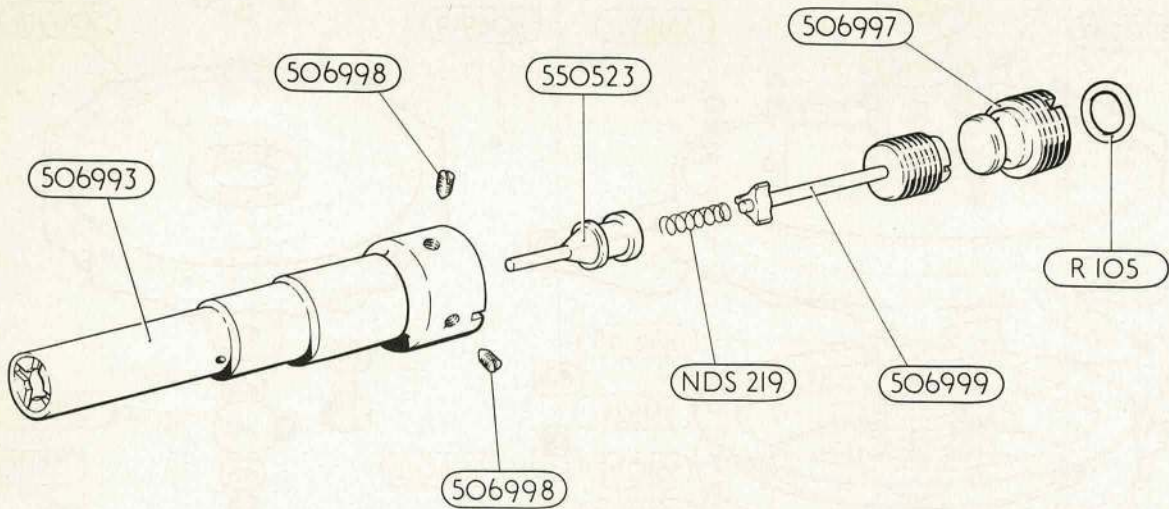
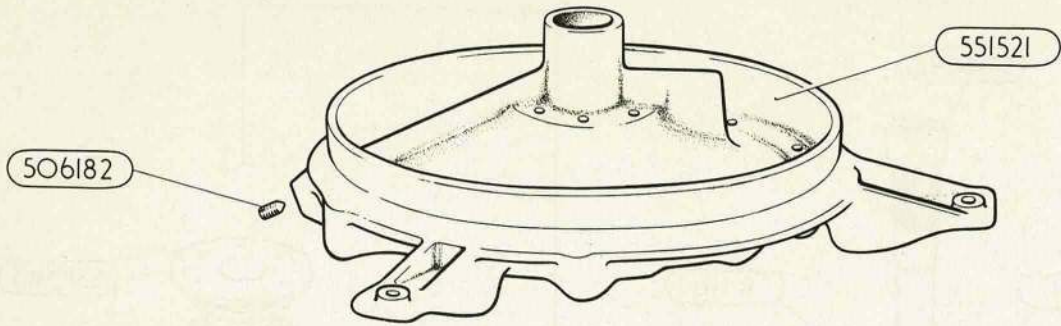

ASSEMBLIES, VARIOUS



This file was downloaded
from the RTFM Library.

Link: www.scottbouch.com/rtfm

Please see site for usage terms,
and more aircraft documents.