

VALVES, DISCHARGE







TYPE / APPLICABILITY

Section W — VALVES, DISCHARGE

ACCESSORY :-

VALVE, DISCHARGE 509190

AIRCRAFT	MK	No. OFF	MK	No. OFF	MK	No. OFF	MK	No. OFF	MK	No. OFF	MK	No. OFF	MK	No. OFF	MK	No. OFF
COMET	2	1														

VALVE, DISCHARGE 512440

SEA VIXEN		1														
-----------	--	---	--	--	--	--	--	--	--	--	--	--	--	--	--	--

VALVE, DISCHARGE 516000

BRITANNIA	1	2														
-----------	---	---	--	--	--	--	--	--	--	--	--	--	--	--	--	--

--	--	--	--	--	--	--	--	--	--	--	--	--	--	--	--	--



VALVES, DISCHARGE

Ref. No.	Part No.	Description	No. Off	Matl. Spec.	CL. OF ST.			Plate No.
					1	2	3	
	509190	VALVE, DISCHARGE 30-LB. ... ..	1	—				W 1
	ND/S 349	Spares for:— BELLOWS, upper group (MOD. B29) ... ..	1	—				W 1
	500369	Spares for:— CASING, half assembly ... ..	1	—				W 2
	500677	Spares for:— BRACKET, suspension ... ..	4	L.3				W 3
	500892	CASING, half ... ..	1	L.4				W 3
28D/7013	A1/1B	Bolt ... ..	8	—			C	
28M/10287	AGS.2001/B1	Nut ... ..	16	—			C	
28S/2815	A33/B16	Screw ... ..	8	—			C	
28W/9419465	SP13/B	Washer ... ..	16	—			C	
28W/9419486	SP16/B	Washer ... ..	8	—			C	
	508666/1	DIAPHRAGM, upper assembly (MOD. B29) ...	1	—				W 2
	558418	Spares for:— BELLOWS (MOD. B29) ... ..	1	RUBBER				W 4
	498680/3	BOLT ... ..	8	DTD.126A				W 4
28W/9419465	SP13/B	Washer ... ..	8	—			C	
	500679	BRACKET, complete ... ..	4	—				W 4
28D/12528	A25/1B	Bolt ... ..	8	—			C	
28M/10327	AGS.2002/B1	Nut ... ..	8	—			C	
28W/9419465	SP13/B	Washer ... ..	8	—			C	
28W/9419474	SP15/B	Washer ... ..	16	—			C	
	508034	BUSH ... ..	2	CARBON				W 4
	500884	FAIRING, complete ... ..	1	—				W 4
28D/12528	A25/1B	Bolt ... ..	4	—			C	
28W/9419465	SP13/B	Washer ... ..	4	—			C	
	501638	GASKET, sealing ... ..	1	RUBBER				W 4
	508035	GASKET, sealing ... ..	1	RUBBER				W 4
	508433	GASKET ... ..	1	OAKEN				W 4
	500839	GUIDE, diaphragm ... ..	1	S.80				W 4
28D/12511	A25/2B	Bolt ... ..	8	—			C	
	508031	GUIDE, diaphragm ... ..	1	S.80				W 4
28D/12511	A25/2B	Bolt ... ..	8	—			C	
	498688	PANEL, inspection ... ..	1	L.4				W 4
28S/3426	A32/B8	Screw ... ..	4	—			C	
	508033	PIECE, distance ... ..	1	L.4				W 4
	500372	PIPE, upper, complete ... ..	1	—				W 4

VALVES, DISCHARGE

Ref. No.	Part No.	Description					No. Off	Matl. Spec.	CL. OF ST.	Plate No.
		1	2	3	4	5			M.R.	
28D/12528 28M/10327 28W/9419465	508092						1	—		W 4
	A25/1B						8	—	C	
	AGS.2002/B1						8	—	C	
	SP13/B						16	—	C	
	500366						1	—		W 4
	500838						1	—		W 4
	500879						1	—		W 4
28M/10327 28S/2762 28W/9419465	AGS.2002/B1						8	—	C	
	A31/A12						36	—	C	
	SP13/B						8	—	C	
28N/14943	508032						2	DTD.263		W 4
	AGS.2030/35						1	—	C	
	496330						2	L.3		W 4
	498610						3	DTD.126		W 4
	508438						1	S.S.		W 4
	496661						1	SPR.S.		W 4
	508437						1	FELT		W 4
28D/12622 28M/10327 28W/9419465	496654						1	L.3		W 2
	A25/3B						16	—	C	
	AGS.2002/B1						16	—	C	
	SP13/B						16	—	C	
	501879						1	—		W 2
	501868						1	L.3		W 3
28S/2810	501878						1	L.3		W 3
	AGS.249/30						12	—	C	
28D/12624 28M/10327 28W/9419465							4	—	C	
	A25/7B						4	—	C	
	AGS.2002/B1						8	—	C	
	SP13/B						8	—	C	
	ND/S 348						1	—		W 1
28L/13124 28W/9419402	508049						4	S.94		
	A27/CT						8	—	C	
	SP13/C						8	—	C	
28Q/7131	508036						4	DTD.124		
	AS.157/405						16	—	C	

VALVES, DISCHARGE

Ref. No.	Part No.	Description					No. Off	Matl. Spec.	CL. OF ST.		Plate No.
		1	2	3	4	5			M.R.	L.M.	
	508054					<b>CASING</b> , half assembly ... ..	1	—			W 2
						Spares for :—					
	508055					<b>BRACKET</b> , suspension, complete ... ..	4	—			
28D/12528	A25/1B					Bolt ... ..	8	—	C		
28M/10327	AGS.2002/B1					Nut ... ..	8	—	C		
28W/9419465	SP13/B					Washer ... ..	16	—	C		
	500892					<b>CASING</b> , half ... ..	1	L.4			W 3
	508432					<b>WASHER</b> , packing ... ..	8	L.64			W 2
28M/10327	AGS.2002/B1					Nut ... ..	8	—	C		
<del>28D/12528</del>	<del>A25/1B</del>					Screw ... ..	8	—	C		
28W/9419465	SP13/B					Washer ... ..	8	—	C		
	508053/1					<b>DIAPHRAGM</b> , lower assembly (MOD. B29) ...	1	—			W 2
						Spares for :—					
	558418					<b>BELLOWS</b> ... ..	1	RUBBER			W 5
1616	500876					<b>BLOCK</b> , sealing ... ..	1	RUBBER			W 5
1610	500873					<b>BODY</b> , valve ... ..	1	L.40			W 5
	498680/3					<b>BOLT</b> ... ..	8	DTD.126A			W 5
28W/9419465	SP13/B					Washer ... ..	8	—	C		
	508052					<b>BRACKET</b> , diaphragm mounting, complete ...	4	—			W 5
28D/12528	A25/1B					Bolt ... ..	8	—	C		
28M/10327	AGS.2002/B1					Nut ... ..	8	—	C		
28W/9419465	SP13/B					Washer ... ..	24	—	C		
	500875					<b>BRIDLE</b> ... ..	1	L.3			W 5
28P/5491	SP4/A4					Pin, headed ... ..	1	—	C		
28P/826	SP4/A16					Pin, headed ... ..	1	—	C		
28P/12587	SP9/C4					Pin, split ... ..	2	—	C		
	508034					<b>BUSH</b> ... ..	2	CARBON			W 5
	501638					<b>GASKET</b> , sealing ... ..	1	RUBBER			W 5
	508035					<b>GASKET</b> , sealing ... ..	1	RUBBER			W 5
	500839					<b>GUIDE</b> , diaphragm ... ..	1	S.80			W 5
28D/12511	A25/2B					Bolt ... ..	8	—	C		
	508031					<b>GUIDE</b> , diaphragm ... ..	1	DTD.525			W 5
28D/12511	A25/2B					Bolt ... ..	8	—	C		
1617	501154					<b>LOCKNUT</b> ... ..	1	L.1			W 5
	508033					<b>PIECE</b> , distance ... ..	1	L.65			W 5
	508046					<b>PIECE</b> , packing, valve head ... ..	1	L.59			W 5
1611	500874					<b>PISTON</b> ... ..	1	L.1			W 5
	500867					<b>PIPE</b> , lower, complete ... ..	1	—			W 5
	506678					<b>PLATE</b> , diaphragm sealing, complete ... ..	1	—			W 5

VALVES, DISCHARGE

Ref. No.	Part No.	Description					No. Off.	Matl. Spec.	CL. OF ST.			Plate No.
		1	2	3	4	5			M.R.	L.M.		
28M/10327 28W/9419465	AGS.2002/B1 SP13/B	Nut ... ..					8	—		C		
		Washer ... ..					8	—		C		
	508092	PLATE, retaining, complete ... ..					1	—				W 5
	500366	PLATE, spring locating, complete ... ..					1	—				W 5
	500838	PLATE, spring locating ... ..					1	—				W 5
28D/12528	A25/1B—	Bolt ... ..					8	—		C		
28M/10327 28W/9419465	AGS.2002/B1 SP13/B	Nut ... ..					8	—		C		
		Washer ... ..					16	—		C		
28N/14943	508032 AGS.2030/35	RING, retaining ... ..					2	DTD.263				W 5
		Circlip ... ..					1	—		C		
	496330	RING, stiffening ... ..					2	L.3				W 5
	498610	RING, stiffening ... ..					3	DTD.126				W 5
	508438	RING, gauze ... ..					1	S.S.				W 5
28S/13633	508045 A33/A18	SEAT, valve head ... ..					1	L.70				W 5
		Screw ... ..					36	—		C		
	496661	SPRING, return ... ..					1	SPR.S.				W 5
1613	501157	WASHER ... ..					1	RUBBER				W 5
	508437	WASHER ... ..					1	FELT				W 5
	508047	RING, stiffening ... ..					1	L.59				W 2
	508044	RING, seating, complete ... ..					1	—				W 2
28M/10327 28S/2821 28W/9419465	AGS.2002/B1 A33/B20 SP13/B	Nut ... ..					16	—		C		
		Screw ... ..					16	—		C		
		Washer ... ..					16	—		C		
941 28W/9419465	DDS.1092Y/1B SP13/B	BOLT ... ..					4	—				W 1
		Washer ... ..					4	—		C		
	500370	CASING, centre assembly ... ..					1	—				W 1
		Spares for :—										
	500888	CASING, centre, complete ... ..					1	—				W 3
	494046	UNION, pipe ... ..					1	L.40				W 3
	508398	WASHER, jointing ... ..					1	PHIBEROID				W 3
28Q/7189	AS.157/304	Rivet ... ..					6	—		C		
	502824	CASING, end assembly ... ..					1	—				W 1
		Spares for :—										
	500872	BUSH, guide ... ..					1	L.1				W 3
28Q/7189	AS.157/304	Rivet ... ..					6	—		C		

VALVES, DISCHARGE

Ref. No.	Part No.	Description	No. Off	Matl. Spec.	CL. OF ST.			Plate No.
					1	2	3	
		4			M.R.			
		5			L.M.			
28Q/7189	502825	CASING, end, complete ... ..	1	—				W 3
	494046	UNION, pipe ... ..	1	L.40				W 3
	508398	WASHER, jointing ... ..	2	PHIBEROID				W 3
	AS.157/304	Rivet ... ..	6	—		C		
28D/12624	A25/7B	Bolt ... ..	24	—		C		
28M/10327	AGS.2002/B1	Nut ... ..	24	—		C		
28W/9419465	SP13/B	Washer ... ..	47	—		C		
28D/12624	500894	CASING, half, for upper diaphragm ... ..	1	L.4				W 1
	A25/7B	Bolt ... ..	24	—		C		
	28M/10327	AGS.2002/B1	Nut ... ..	24	—		C	
	28W/9419465	SP13/B	Washer ... ..	48	—		C	
1612	496740	COVER, complete ... ..	1	FABRIC				W 1
	500864	FAIRING, rear, complete ... ..	1	—				W 1
28D/12511	674	GUARD, valve front ... ..	1	L.3		C		W 1
	A25/2B	Bolt ... ..	12	—		C		
	28M/10327	AGS.2002/B1	Nut ... ..	12	—		C	
	28W/9419465	SP13/B	Washer ... ..	24	—		C	
28Q/7138	502117	LABEL ... ..	1	L.4				W 1
	AS.157/303	Rivet ... ..	4	—		C		
	N.D.	LANYARD ... ..	1	CORD		LM		W 1
28Q/7189	586	NAMEPLATE (R.N.) ... ..	1	L.4		C		W 1
	AS.157/304	Rivet ... ..	4	—		C		
1614	500877	PIN, "pip", quick release ... ..	1	—				W 1
	498529	RING, support ... ..	3	L.3				W 1
	R.105	SEAL — GACO ... ..	1	—				W 1
	502118	TAG, lanyard ... ..	1	DTD.124				W 1
	498532	WASHER, sealing ... ..	4	DDS.1017				W 1
28F/10509	1615	WASHER, sealing ... ..	2	—				W 1
	AGS.1107/A	Union, reducing ... ..	2	—		C		



VALVES, DISCHARGE

Ref. No.	Part No.	Description	No. Off	Matl. Spec.	CL. OF ST.			Plate No.
					1	2	3	
1002	512440	VALVE, DISCHARGE, 4" AXIAL FLOW ... ..	1	—	A			W 6
		Spares for:—						
1260	551819	ADAPTOR ... ..	1	S.94	C			W 6
28F/12048	AGS.1186/B	Washer, sealing ... ..	1	—	C			
	555047	ADAPTOR ... ..	1	L.65				W 6
28S/	A35/C24	Screw ... ..	9	—	C			
28F/14252	AGS.1186/3	Washer, sealing ... ..	9	—	C			
	558161	CASING, inlet (MOD. 3BM) ... ..	1	L.65				W 6
	558055	CASING, inlet (MOD. 4BM) (PRE. MOD. 3BM).	1	S.80	C			W 6
	507760	CASING, inlet (PRE. MOD. 4BM) ... ..	1	S.80				W 6
28D/13136	A26/1B	Bolt (PRE. AMDT. 2BM) ... ..	10	—	C			
28S/6472	A33/A6	Screw ... ..	2	—	C			
28L/11057	AGS.2037/B	Washer ... ..	10	—	C			
28D/15157	A26/1B	Bolt (AMDT. 2BM) ... ..	10	—				
1262	507762	GASKET ... ..	2	DTD.378A	C			W 6
1267	555048	GASKET ... ..	1	RUBBER	C			W 6
1266	555205	GASKET ... ..	1	RUBBER	C			W 6
	555046	HOSE, assembly ... ..	1	—				W 6
		Spares for:—						
1259	553224	ADAPTOR, angle assembly ... ..	2	—	C			W 8
	551826	CONNECTION, hose ... ..	2	L.65				W 8
	553223	PLUG ... ..	2	L.65				W 8
1258	555046/1	HOSE, 3/16" i/d. x 5/16" o/d. x 5-500" long ...	1	DTD.373	C			
	SP900/5	SEAL — DOWTY ... ..	2	—				
1251	507533	LABEL ... ..	1	L.59	C			W 6
567	503327	NAMEPLATE ... ..	1	L.4				W 6
1257	555042	PLATE, locking ... ..	1	DTD.124	C			W 6
28D/	A25/1A	Bolt (AMDT. 2BM) ... ..	1	—	C			
28S/6192	A31/A6	Screw (PRE. AMDT. 2BM) ... ..	1	—	C			
28W/9419473	SP15/A	Washer ... ..	1	—	C			
1261	555043	PLATE, locking ... ..	1	DTD.124	C			W 6
28S/6192	A31/A6	Screw ... ..	1	—	C			
28W/9419485	SP16/A	Washer ... ..	1	—	C			
1428	556699	SHROUD, complete ... ..	1	—	C			W 6
	553935	VALVE, discharge assembly ... ..	1	—	C			W 6
		Spares for:—						
	553945	BODY, valve, bottom ... ..	1	L.51	C			W 7
28M/10326	AGS.2002/A1	Nut ... ..	16	—	C			
28S/2762	A31/A12	Screw ... ..	16	—	C			

VALVES, DISCHARGE

Ref. No.	Part No.	Description	No. Off	Matl. Spec.	CL. OF ST.			Plate No.
					1	2	3	
	ND/S 369	<b>BODY</b> , valve, top, group ... ..	1	—				
		Consisting of :—						
1426	06/DP/08	<b>BEARING — GLACIER</b> ... ..	2	—		C		W 7
1425	1700/3	<b>CIRCLIP</b> , internal — <b>ANDERTON</b> ... ..	1	—		C		W 7
	553946	<b>SPACER</b> ... ..	1	L.65		C		W 7
1271	553947	<b>DIAPHRAGM</b> ... ..	1	DTD.793		C		W 7
	553943	<b>HEAD</b> , valve, inner ... ..	1	L.4		C		W 7
	553940	<b>HEAD</b> , valve, outer, complete ... ..	1	—		C		W 7
28S/2762	A31/A12	Screw ... ..	12	—		C		
28F/16140	AGS.1186/1	Washer, sealing ... ..	12	—		C		
1270	553827	<b>RING</b> , seating, complete ( <b>PRE. AMDT. 5BM</b> ) ... ..	1	—		C		W 7
28S/6472	A33/A6	Screw ... ..	3	—		C		
	556123	<b>RING</b> , support ... ..	1	S.94		C		W 7
	558185	<b>RING</b> , seating ( <b>AMDT. 5BM</b> ) ... ..	1	L.65		C		W 7
1269	553825	<b>SCREW</b> , special ... ..	3	S.94		C		W 7
28F/14252	AGS.1186/3	Washer, sealing ... ..	3	—		C		
	553937	<b>SPINDLE</b> , complete ... ..	1	—		C		W 7
1272	553948	<b>SPRING</b> ... ..	1	DTD.215		C		W 7
1427	15 x 5.2 x .5	<b>SPRING</b> , disc — <b>SCHNORR</b> ... ..	6	—		C		W 7
	555045	<b>VALVE</b> , assembly ( <b>PRE. MOD. 3BM</b> ) ... ..	1	—				W 6
		Spares for :—						
	552763	<b>BRACKET</b> , flaps ... ..	2	L.65		C		W 8
1264	552759	<b>FLAP</b> , valve ... ..	2	L.52		C		W 8
	552756	<b>FLAP</b> , valve, complete ... ..			—		C	
	555044	<b>RING</b> , intake ... ..	1	DTD.525		C		W 8
1360	552761	<b>SCREW</b> , special ... ..	2	S.80		C		W 8
28M/10326	AGS.2002/A1	Nut ... ..	2	—		C		
1263	552760	<b>SPINDLE</b> , flaps ... ..	1	S.80		C		W 8
1265	552762	<b>SPRING</b> , torsion ... ..	1	DTD.189		C		W 8
	558177	<b>VALVE</b> , assembly ( <b>MOD. 3BM</b> ) ... ..	1	—				
		Spares for :—						
	557255	<b>BRACKET</b> , flaps ... ..	2	L.65				
	557149	<b>FERRULE</b> ... ..	2	—				
	557256	<b>FLAP</b> , valve ... ..	2	L.65				
	557257	<b>FLAP</b> , valve, complete ... ..			—			
	558160	<b>RING</b> , intake ... ..	1	L.65				
	552761	<b>SCREW</b> , special ... ..	2	S.80				
	A49/A	Nut ... ..	2	—				
	557259	<b>SPINDLE</b> , flaps ... ..	1	S.80				
	557258	<b>SPRING</b> , torsion ... ..	1	DTD.189				
1603	557066	<b>WASHER</b> , tab ... ..	2	S.521				

VALVES, DISCHARGE

Ref. No.	Part No.	Description	No. Off	Matl. Spec.	CL. OF ST.			Plate No.
					1	2	3	
1099	516000	VALVE, DISCHARGE, 30 S/C ... ..	2	—	A			W 9
		Spares for:—						
882	511040/CC	CLAMP, attachment of No. 1 and 2 units assembly.	1	—	C			W 9
		Spares for:—						
1055	504374/F	BOLT (R.N.) ... ..	2	S.1	C			W 12
	551357	CLAMP, half ... ..	2	DTD.304				W 12
28M/10330	AGS.2002/E1	Nut, 1/4" B.S.F. ... ..	2	—	C			
28W/9419405	SP15/E	Washer, 1/4" B.S.F. ... ..	2	—	C			
783	504372/CC	RING, sealing, at No. 1 and 2 units clamp attachment.	1	SILASTIC	C			W 9
1100	516020	UNIT, No. 1 assembly ... ..	1	—	A			W 9
		Spares for:—						
	557356	BASE, controller assembly ... ..	1	—				W 10
	SS.365	BASE, controller (alternative 557356) ... ..	1	—				W 10
	SS.366	BASE, controller (alternative 557356) ... ..	1	—				W 10
		Spares for:—						
	508140	MOUNTING, sandwich ... ..	3	RUBBER				W 12
28D/14256	A25/3A	Bolt, 6 B.A. ... ..	6	—	C			
28M/10326	AGS.2002/A1	Nut, 6 B.A. ... ..	6	—	C			
28W/9419446	SP10A	Washer, 6 B.A. ... ..	6	—	C			
	556763	PLUG, blanking assembly (SS 365 and SS 366 only).	2	—				
		Spares for:—						
	556762	PLUG, blanking ... ..	2	—				
	SP900/23	RING, 'O' — DOWTY ... ..	2	—				
	1106	WASHER — BARBER & COLMAN LTD. ... ..	4	—				
28S/2767	A31/B16	Screw ... ..	4	—				
	508791	STUD ... ..	6	S.1				W 12
28M/10330	AGS.2002/E1	Nut, 1/4" B.S.F. ... ..	3	—	C			
28W/9418921	SP13/E	Washer, 1/4" B.S.F. ... ..	3	—	C			
	555812	BELLOWS assembly ... ..	1	—				W 10
		Spares for:—						
	551771	BELLOWS ... ..	1	—				W 13
	AGS.1000	Clip, hose ... ..	1	—	C			
	506971	BOLT, draw socket attachment to valve head ...	1	L.65				W 13
	CT.171	BUSH — OILITE, at socket ... ..	2	—				
	555811	HEAD, valve, complete ... ..	1	—				W 13
	506968	NUT, socket attachment to valve head ... ..	1	S.1				W 13
	506969	PIN, stop ... ..	1	S.96				W 13
	506967	PLUG, draw bolt ... ..	1	S.1				W 13
	498610	RING, stiffening, external ... ..	2	DTD.126				W 13
	496330	RING, internal ... ..	3	L.3				W 13
	R.106	RING, seal — GACO, sealing at socket plug ...	1	—				W 13
	R.114	RING, seal — GACO, draw bolt sealing at socket.	1	—				W 13
	R.132	RING, seal — GACO, socket sealing at valve head.	1	—				W 13
	506972	SOCKET, bellows attachment ... ..	1	L.65				W 13
	508747	STIFFENER, end bellows ... ..	1	DTD.610B				W 13

VALVES, DISCHARGE

Ref. No.	Part No.	Description	No. Off	Matl. Spec.	CL. OF ST.			Plate No.
					1	2	3	
	506984	WASHER, seating of socket attachment nut ...	1	DTD.124				W 13
	GD.1259/2	WASHER, seal — DOWTY at stop pin ...	1	—				W 13
	AGS.1000	CLIP, hose ...	1	—		C		
28F/10797	508523	BODY, pitot head (PRE. ALT. B32) ...	1	L.64				W 10
	AGS.1129/A	Banjo (PRE. ALT. B32) ...	1	—		C		
28F/12047	506956	BOLT, banjo at static connection controller base.	1	S.94				W 10
	AGS.1186/A	Washer, sealing ...	2	—		C		
	506981	BRACKET, L.H., Torsion spring mounting ...	1	DTD.610B				W 10
	506980	BRACKET, R.H., Torsion spring mounting ...	1	DTD.610B				W 10
	556812	CASING, assembly ...	1	—				W 10
		Spares for:—						
	508124	BRACKET, controller base mounting ...	3	—				W 14
	508132	CONNECTION, banjo hose cabin connecting tube.	1	DTD.423B				W 14
800	506090	GASKET, sealing at cabin vent and blanking plate connections.	3	PHIB		C		W 14
28M/10327	556769	PLATE, blanking ...	2	DTD.610				W 14
28S/9419435	AGS.2002/B1	Nut, 4 B.A. ...	6	—		C		
	A31/B12	Screw, 4 B.A. ...	6	—		C		
	AGS.1151/1	Washer ...	1	—		C		
28M/10327	508112	SCREW, attachment of control box mounting bracket.	6	S.1				W 14
	AGS.2002/B1	Nut, 4 B.A. ...	6	—		C		
	556818	TUBE, cabin connecting assembly ...	1	—				W 14
		Spares for:—						
	556490	CONNECTION, bulkhead hose ...	1	L.65				W 18
	556818/1	TUBE, braided rubber ...	1	DTD.373A				W 18
28M/10327	AGS.2002/B1	Nut, 4 B.A. ...	6	—		C		
28S/9419435	A31/B12	Screw, 4 B.A. ...	6	—		C		
	AGS.1151/1	Washer ...	1	—		C		
	508788	TUBE, vent connecting assembly (PRE. ALT. B33).	1	—				W 14
		Spares for:—						
	508131	CONNECTION, bulkhead hose ...	1	DTD.434B				W 18
	508788/1	TUBE, braided rubber ...	1	DTD.373A				W 18
28M/10327	AGS.2002/B1	Nut, 4 B.A. ...	6	—		C		
28S/9419435	A31/B12	Screw, 4 B.A. ...	6	—		C		
	AGS.1151/1	Washer ...	1	—		C		

VALVES, DISCHARGE

Ref. No.	Part No.	Description					No. Off	Matl. Spec.	CL. OF ST.	Plate No.
		1	2	3	4	5			M.R.	
	508122						6	DTD.610		W 14
	508549						6	DTD.610		W 14
	508515						1	PHIB		W 10
	508134						1	PHIB		W 10
795	508513						1	—		W 10
	557481						1	—		W 10
	550985						1	—		W 10
	506947						2	S.1		W 15
28M/10328	AGS.2002/C1						2	—	C	
28W/9419402	SP13/C						2	—	C	
	550989						1	S.1		W 15
28D/12811	A25/16B						1	—	C	
28M/10327	AGS.2002/B1						1	—	C	
	CT.171						4	OILITE		W 15
	506908						1	—		W 15
	550987						1	—		W 15
28D/12625	A25/9B						2	—	C	
28M/10327	AGS.2002/B1						2	—	C	
	AS.2305/080						2	—	C	
28W/9419401	SP10/B						1	—	C	
	506932						1	—		W 15
28D/12625	A25/9B						1	—	C	
28M/10327	AGS.2002/B1						1	—	C	
	AS.2305/080						1	—	C	
	506952						2	—		W 15
	506950						1	S.80		W 15
	506951						1	S.3		W 15
	506955						2	—		W 15
	506953						1	S.80		W 15
	506954						1	S.3		W 15
28W/9419402	SP13/C						2	—	C	
	508116						1	L.64		W 15
	508117						1	L.64		W 15

VALVES, DISCHARGE

Ref. No.	Part No.	Description					No. Off	Matl. Spec.	CL. OF ST.			Plate No.
		1	2	3	4	5			M.R.	L.M.		
	506913	<b>SPINDLE</b> , outer guide lever ... ..					1	S.80				W 15
28M/10327	AGS.2002/B1	Nut, 4 B.A. ... ..					2	—	C			
28W/9419401	SP10/B	Washer, 4 B.A. ... ..					2	—	C			
28W/9419465	SP13/B	Washer, 4 B.A. ... ..					2	—	C			
	550515	<b>SPRING</b> , tension ... ..					2	DTD.215				W 15
28M/10328	AGS.2002/C1	Nut, 2 B.A. ... ..					2	—	C			
28S/2826	A33/C24	Screw, 2 B.A. ... ..					2	—	C			
28W/9419402	SP13/C	Washer, 2 B.A. ... ..					2	—	C			
	551518	<b>LEVER</b> , stop, ditching lever ... ..					1	—				W 10
	500585	<b>NAMEPLATE</b> ... ..					1	L.4				W 10
28Q/7138	AS.157/303	Rivet ... ..					2	—	C			
	557482	<b>PIN</b> , pivot, ditching lever stop ... ..					1	S.96				W 10
28M/10328	AGS.2002/C1	Nut, 2 B.A. ... ..					1	—	C			
	550668	<b>PLATE</b> , valve stop ... ..					1	L.4				W 10
28M/10328	AGS.2002/C1	Nut, 2 B.A. ... ..					2	—	C			
28S/2820	A33/C20	Screw, 2 B.A. ... ..					2	—	C			
28W/14206	SP23/C	Washer, 2 B.A. ... ..					2	—	C			
	551045	<b>PLATE</b> , ditching lever locking ... ..					1	L.59				W 10
	508518	<b>PLUG</b> , vent pipe connection ( <b>PRE. ALT. B33</b> ) ... ..					1	L.64				W 10
	556768	<b>PLUG</b> ... ..					1	L.65				W 10
28P/817	SP4/Y/A7	Pin, headed ... ..					1	—	C			
28P/12587	SP9/C4	Pin, split ... ..					1	—	C			
28W/9419402	SP13/C	Washer, 2 B.A. ... ..					1	—	C			
	506966	<b>RING</b> , stiffening, ditching and guide lever mounting. ... ..					1	DTD.546B				W 10
27KC/615	R.105	<b>RING</b> , seal — <b>GACO</b> , at vent pipe connection ( <b>PRE. ALT. B33</b> ). ... ..					1	—	C			
27Q/11578	SP900/3	<b>RING</b> — <b>DOWTY</b> ... ..					1	—	C			
	508940	<b>SEAT</b> , valve, complete ... ..					1	—				W 10
28M/10327	AGS.2002/B1	Nut, 4 B.A. ... ..					18	—	C			
28S/2821	A33/B20	Screw, 4 B.A. ... ..					18	—	C			
28W/9419465	SP13/B	Washer, 4 B.A. ... ..					18	—	C			
	508133	<b>SOCKET</b> , flanged, at static pipe connection controller base. ... ..					1	DTD.423B				W 10
28M/10327	AGS.2002/B1	Nut, 2 B.A. ... ..					6	—	C			
28W/9419465	SP13/B	Washer, 2 B.A. ... ..					6	—	C			

VALVES, DISCHARGE

Ref. No.	Part No.	Description					No. Off	Matl. Spec.	CL. OF ST.	Plate No.
		1	2	3	4	5			M.R.	
28D/12536 28M/10328 28W/9419402	509512	<b>SPRING</b> , torsion ditching lever ... ..					1	—		W 10
	A25/13C	Bolt, 2 B.A. ... ..					1	—	C	
	AGS.2002/C1	Nut, 2 B.A. ... ..					1	—	C	
	SP13/C	Washer, 2 B.A. ... ..					1	—	C	
	508511	<b>SPRING</b> , tension, ditching lever stop lever ...					1	DTD.215		W 10
	553355	<b>STUD</b> , special attachment of ditching lever locking plate.					2	S.1		W 10
28M/10318 28W/9419474	AGS.2002/B3	Nut, 4 B.A. ... ..					2	—	C	
	SP15/B	Washer, 4 B.A. ... ..					2	—	C	
	N.D.	<b>STUD — ODDIE</b> (Type 554W) grid attachment to body.					4	—		
28M/14536	508524	<b>TUBE</b> , pitot head ( <b>PRE. ALT. B32</b> ) ... ..					1	DTD.215		W 10
	A27/ET	Nut, 1/4" B.S.F. ( <b>PRE. ALT. B32</b> ) ... ..					1	—	C	
	508509	<b>WASHER</b> , saddle, at pivot pin ... ..					1	DTD.610		W 10
	N.D.	<b>WASHER — ODDIE</b> (Type 214) grid attachment to body.					4	—		
1101	516030	<b>UNIT</b> , No. 2 assembly ... ..					1	—	A	W 9
		Spares for:—								
	555812	<b>BELLOWS</b> assembly ... ..					1	—		W 11
		Spares for:—								
	551771	<b>BELLOWS</b> ... ..					1	—		W 13
	AGS.1000	Clip, hose, 6-500" dia. ... ..					1	—	C	
	506971	<b>BOLT</b> , draw ... ..					1	L.65		W 13
	CT.171	<b>BUSH — MANGANESE</b> , at socket ... ..					2	OILITE		
	555811	<b>HEAD</b> , valve, complete ... ..					1	—		W 13
	506968	<b>NUT</b> , socket attachment ... ..					1	S.1		W 13
	506969	<b>PIN</b> , stop ... ..					1	S.96		W 13
	506967	<b>PLUG</b> ... ..					1	S.1		W 13
	498610	<b>RING</b> , stiffening ... ..					2	DTD.126		W 13
	496330	<b>RING</b> , stiffening ... ..					3	L.3		W 13
	R.106	<b>RING — GACO</b> ... ..					1	—		W 13
	R.114	<b>RING — GACO</b> , sealing at draw bolt ... ..					1	—		W 13
	506972	<b>SOCKET</b> ... ..					1	L.65		W 13
	508747	<b>STIFFENER</b> , bellows end ... ..					2	DTD.610B		W 13
	506984	<b>WASHER</b> , socket attachment nut ... ..					1	DTD.124		W 13
	GD.1259/2	<b>WASHER — DOWTY</b> , at stop pin ... ..					1	—		W 13
	AGS.1000	Clip, hose, 6-500" dia. ... ..					1	—	C	
	508126	<b>CONE</b> ... ..					1	L.59		W 11
	556813	<b>CASING</b> , assembly ... ..					1	—		W 11
		Spares for:—								
800	506090	<b>GASKET</b> , sealing, at bellows pipe bulkhead union.					1	—	C	W 16

VALVES, DISCHARGE

Ref. No.	Part No.	Description					No. Off	Matl. Spec.	CL. OF ST.			Plate No.
		1	2	3	4	5			M.R.	L.M.		
801	506939						3	PHIB		C		W 16
800	506090						1	—		C		W 16
	558623						1	—		C		W 16
27KC/615	R.105						1	—		C		W 16
	496253						1	—				W 16
798	506940						2	DTD.423B		C		W 16
28M/10327	AGS.2002/B1						12	—		C		
28S/9419435	A31/B12						12	—		C		
	508114						1	DTD.423		C		W 16
28M/10327	AGS.2002/B1						6	—		C		
28S/9419435	A31/B12						6	—		C		
	506900/1						1	—				W 11
	506933						1	L.65				W 17
28S/6472	A33/A6						2	—		C		
	506956						2	S.94				W 17
28F/10787	AGS.1129/A						2	—		C		
28F/12047	AGS.1186/A						4	—		C		
	551709						4	S.1				W 17
	506168						1	L.124				W 17
	506169						1	L.124				W 17
	506180						1	—				W 17
28D/12846	A25/15B						8	—		C		
28M/10327	AGS.2002/B1						12	—		C		
28V/9419465	SP13/B						24	—		C		
	506914						2	DTD.525				W 17
28S/2808	A33/C12						2	—		C		
	551533						2	RUBBER				W 17
	506918						4	PHIB				W 17
	506923						1	RUBBER				W 17
	506920						1	NYLON				W 17
	506163						1	—				W 17

VALVES, DISCHARGE

Ref. No.	Part No.	Description					No. Off	Matl. Spec.	CL. OF ST.	Plate No.
		1	2	3	4	5			M.R.	
	551038						1	L.65		W 17
	506041						1	—		W 17
	506165						1	DTD.525		W 17
28P/12645	SP9/B4						1	—	C	
28W/9419465	SP13/B						1	—	C	
	506019						2	DTD.603		W 17
28S/3421	506922						1	L.64		W 17
	A33/A8						3	—	C	
27KC/575	R.114						2	—	C	W 17
27KC/576	R.116						2	—	C	W 17
	R.103						1	—		W 17
	551306						2	S.1		W 17
	550674						1	—		W 17
	559136						1	—		
	SP900B/3						1	—		
	506919						1	S.1		W 17
	550541						1	DTD.215		W 17
	553830						1	—		W 17
	551040						1	—		W 17
28D/12621	A25/2A						12	—	C	
28D/13147	A25/8A						6	—	C	
28M/10286	AGS.2001/A1						6	—	C	
28F/9433484	AGS.1186/1						18	—	C	
28W/15882	SP23/A						6	—	C	
	506992						2	—		W 17
	506999						2	S.1		W
	506993						2	—		W
	550523						2	BS.249		W
	506997						2	S.1		W
	506998						4	S.1		W
27KC/615	R.105						2	—	C	
	ND/S 219						2	—		W
	506164						1	—		W 17
28D/12532	A25/4C						3	—	C	
28W/9419402	SP13/C						3	—	C	

VALVES, DISCHARGE

Ref. No.	Part No.	Description					No. Off	Matl. Spec.	CL. OF ST.	Plate No.
		1	2	3	4	5			M.R.	
802	551727	<b>COVER</b> , assembly ... ..					1	—	C	W 11
		Spares for :—								
	551731	<b>COVER</b> ... ..					1	L.17		W 18
	508537	<b>PIPE</b> , vent ... ..					1	L.54		W 18
28E/14066	AGS.3181/4B	Clip, pipe ... ..					1	—	C	
28S/2857	A32/B12	Screw, 4 B.A. ... ..					1	—	C	
28W/9419465	SP13/B	Washer, 4 B.A. ... ..					1	—	C	
28M/10327	AGS.2002/B1	Nut, 4 B.A. ... ..					4	—	C	
28W/9419465	SP13/B	Washer, 4 B.A. ... ..					4	—	C	
	508127	<b>GASKET</b> , at rubber seating ... ..					1	PHIB		W 11
	550984	<b>LEVER</b> , guide and bracket assembly ... ..					1	—		W 11
		Spares for :—								
	506947	<b>ADJUSTER</b> , spring ... ..					2	S.1		W 18
28M/10328	AGS.2002/C1	Nut, 2 B.A. ... ..					2	—	C	
28W/9419402	SP13/C	Washer, 2 B.A. ... ..					2	—	C	
	550989	<b>ANCHOR</b> , spring ... ..					1	S.1		W 18
28D/12811	A25/16B	Bolt, 4 B.A. ... ..					1	—	C	
28M/10327	AGS.2002/B1	Nut, 4 B.A. ... ..					1	—	C	
	CT.171	<b>BUSH — MANGANESE</b> , at outer and inner guide lever hinges .625" long.					4	OILITE		
	506908	<b>HOUSING</b> , bush, complete ... ..					1	—		W 18
	506932	<b>LEVER</b> , outer guide, complete ... ..					1	—		W 18
28D/12625	A25/9B	Bolt, 4 B.A. ... ..					1	—	C	
28M/10327	AGS.2002/B1	Nut, 4 B.A. ... ..					1	—	C	
	AS.2305/080	Spacer ... ..					1	—	C	
	550986	<b>LEVER</b> , inner guide, complete ... ..					1	—		W 18
28D/12625	A25/9B	Bolt, 4 B.A. ... ..					1	—	C	
28M/10327	AGS.2002/B1	Nut, 4 B.A. ... ..					1	—	C	
	AS.2305/080	Spacer ... ..					1	—	C	
	506952	<b>PIN</b> , bearing, assembly ... ..					2	—		W 18
		Spares for :—								
	506950	<b>PIN</b> , bearing ... ..					2	S.80		W 18
	506951	<b>PLATE</b> , locking ... ..					2	S.3		W 18
	506955	<b>PIN</b> , bearing, assembly ... ..					2	—		W 18
		Spares for :—								
	506953	<b>PIN</b> , bearing ... ..					2	S.80		W 18
	506954	<b>PLATE</b> , locking ... ..					2	S.3		W 18
28W/9419402	SP13/C	Washer, 2 B.A. ... ..					2	—	C	
	508116	<b>SPACER</b> , inner bearing hinge ... ..					1	L.64		W 18
	508117	<b>SPACER</b> , outer bearing hinge ... ..					1	L.64		W 18
	506913	<b>SPINDLE</b> , outer guide lever ... ..					1	S.80		W 18
28M/10327	AGS.2002/B1	Nut, 4 B.A. ... ..					2	—	C	
28W/9419465	SP13/B	Washer, 4 B.A. ... ..					2	—	C	
28W/9419401	SP10/B	Washer, 4 B.A. ... ..					2	—	C	

VALVES, DISCHARGE

Ref. No.	Part No.	Description	No. Off	Matl. Spec.	CL. OF			Plate No.
					ST.	M.R.	L.M.	
		1 2 3 4 5						
28M/10328	AGS 2002/C1	Nut, 2 B.A. ... ..	2	—				
28W/9419402	SP13/C	Washer, 2 B.A. ... ..	2	—			C	
28S/2826	A33/C24	Screw, 2 B.A. ... ..	2	—			C	
	508585	<b>NAMEPLATE</b> ... ..	1	—				
28Q/7138	AS.157/303	Rivet ... ..	1	—			C	W 11
807	550685	<b>PIPE, bellows, complete</b> ... ..	1	—			C	W 11
28F/11177	AGS.1159/A	Cap, cone ... ..	1	—			C	
28F/5721	AGS.904/A	Coupling, pipe ... ..	1	—			C	
28F/9838	AGS.1104/A	Union ... ..	1	—			C	
28F/12047	AGS.1186/A	Washer ... ..	1	—			C	
803	508500	<b>PIPE, cabin, complete</b> ... ..	1	—			C	W 11
28F/6353	AGS.952/B	Collar ... ..	1	—			C	
28F/5722	AGS.904/B	Sleeve, outer ... ..	1	—			C	
804	508501	<b>PIPE, duct, complete</b> ... ..	1	—			C	W 11
805	508502	<b>PIPE, master unit, complete</b> ... ..	1	—			C	W 11
806	508503	<b>PIPE, static, complete</b> ... ..	1	—			C	W 11
	506906	<b>RING, stiffening, at rubber seating</b> ... ..	1	DTD.546B				W 11
	508942	<b>SEATING, rubber, complete</b> ... ..	1	—				W 11
28M/10327	AGS.2002/B1	Nut, 4 B.A. ... ..	15	—			C	
28S/2821	A33/B20	Screw, 4 B.A. ... ..	15	—			C	
28W/9419465	SP13/B	Washer, 4 B.A. ... ..	15	—			C	
	N.D.	<b>STUD — ODDIE (Type 213), cone attachment</b> ... ..	4	—				
808	506046	<b>UNION, duct pipe, complete</b> ... ..	1	—			C	W 11
28F/12047	AGS.1186/A	Seal ... ..	1	—			C	
809	506012	<b>UNION, cabin pipe</b> ... ..	1	BS.250			C	W 11
28F/12047	AGS.1186/A	Seal ... ..	1	—			C	
	N.D.	<b>WASHER — ODDIE (Type 214), cone attachment.</b> ... ..	4	—				



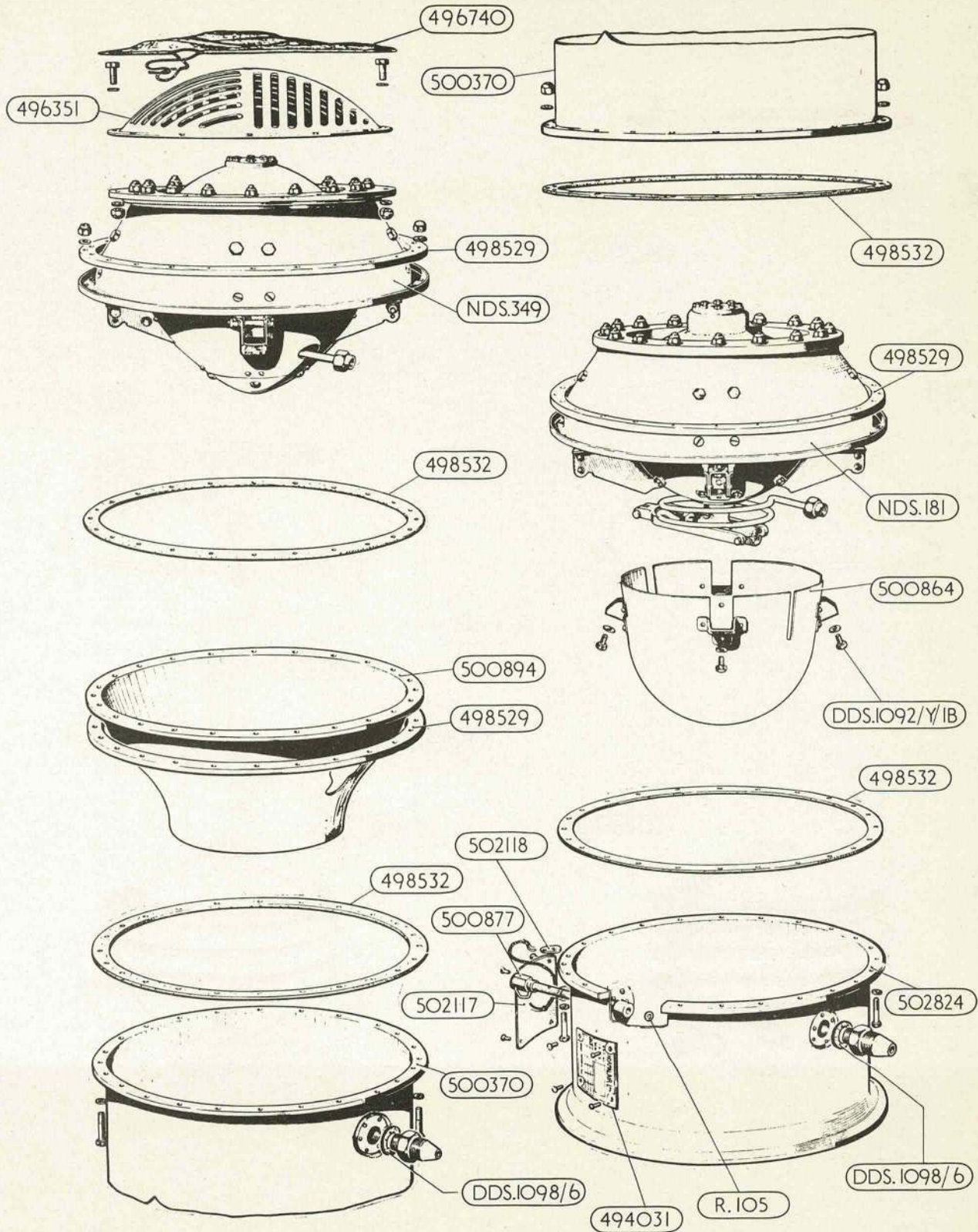

VALVE, DISCHARGE

PLATE W2

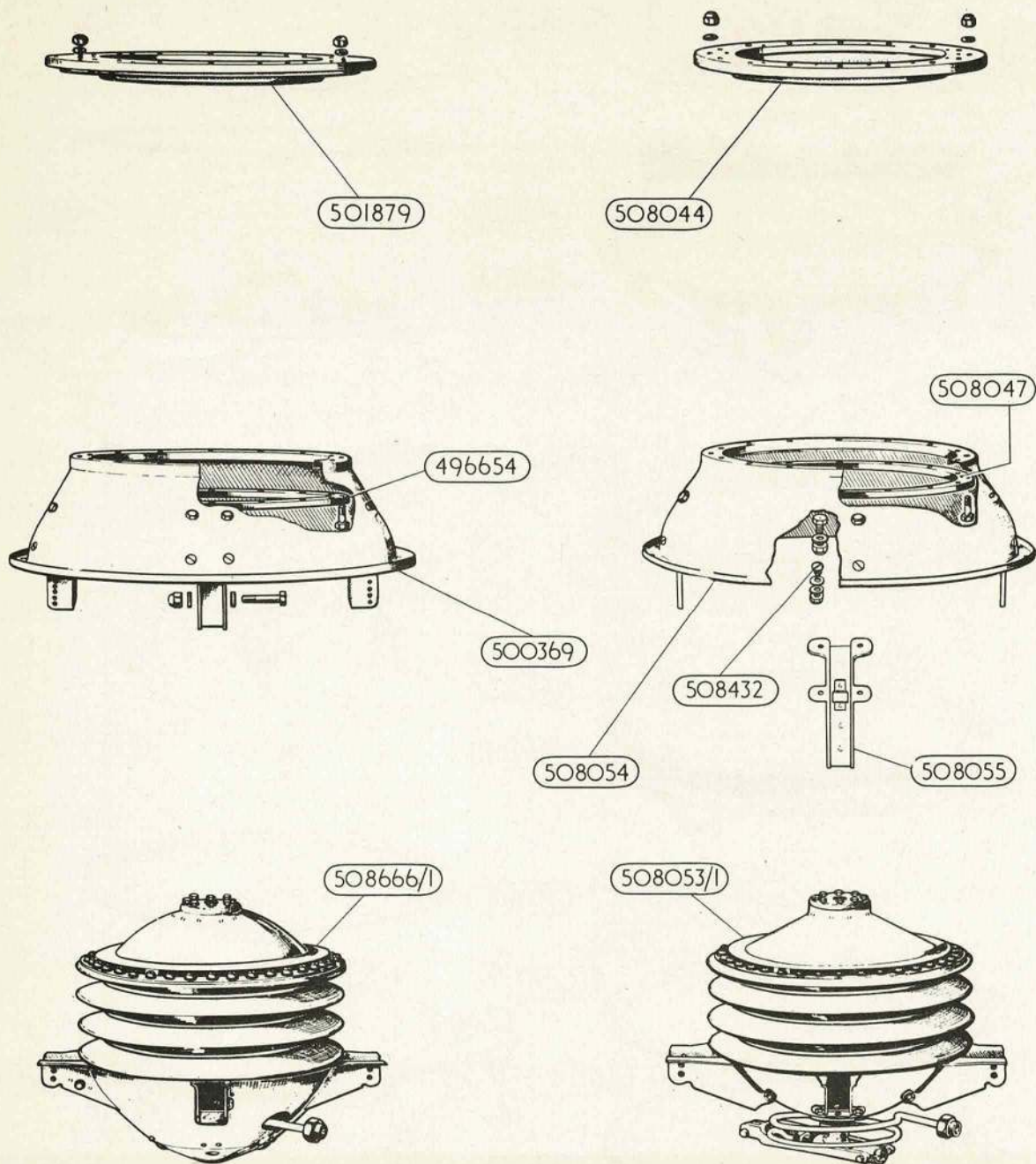

GROUPS, LOWER & UPPER BELLOWS

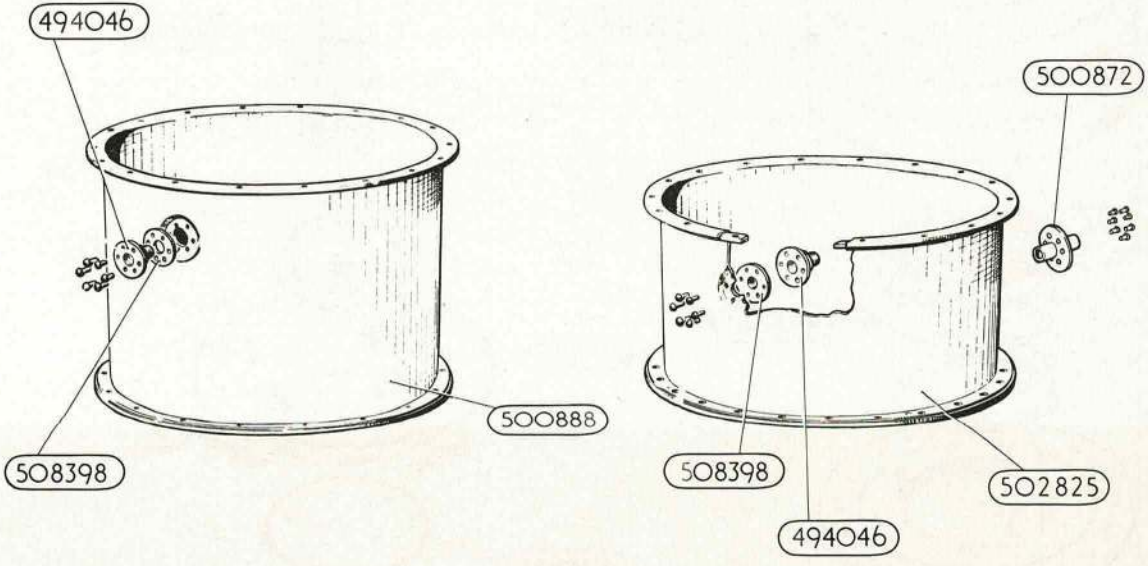
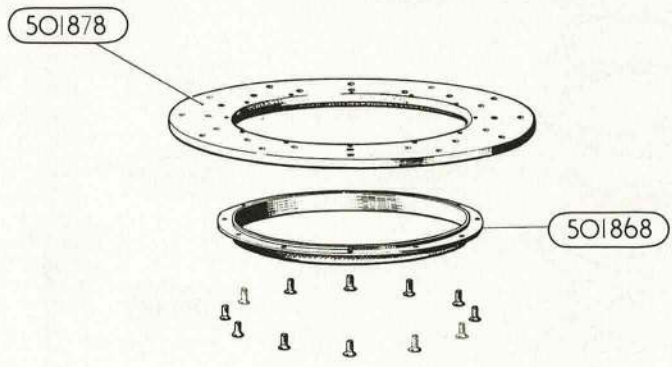
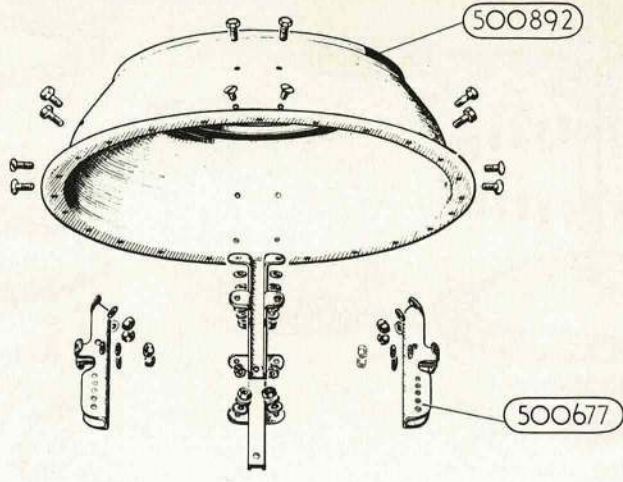

ASSEMBLIES, VARIOUS

PLATE W 4

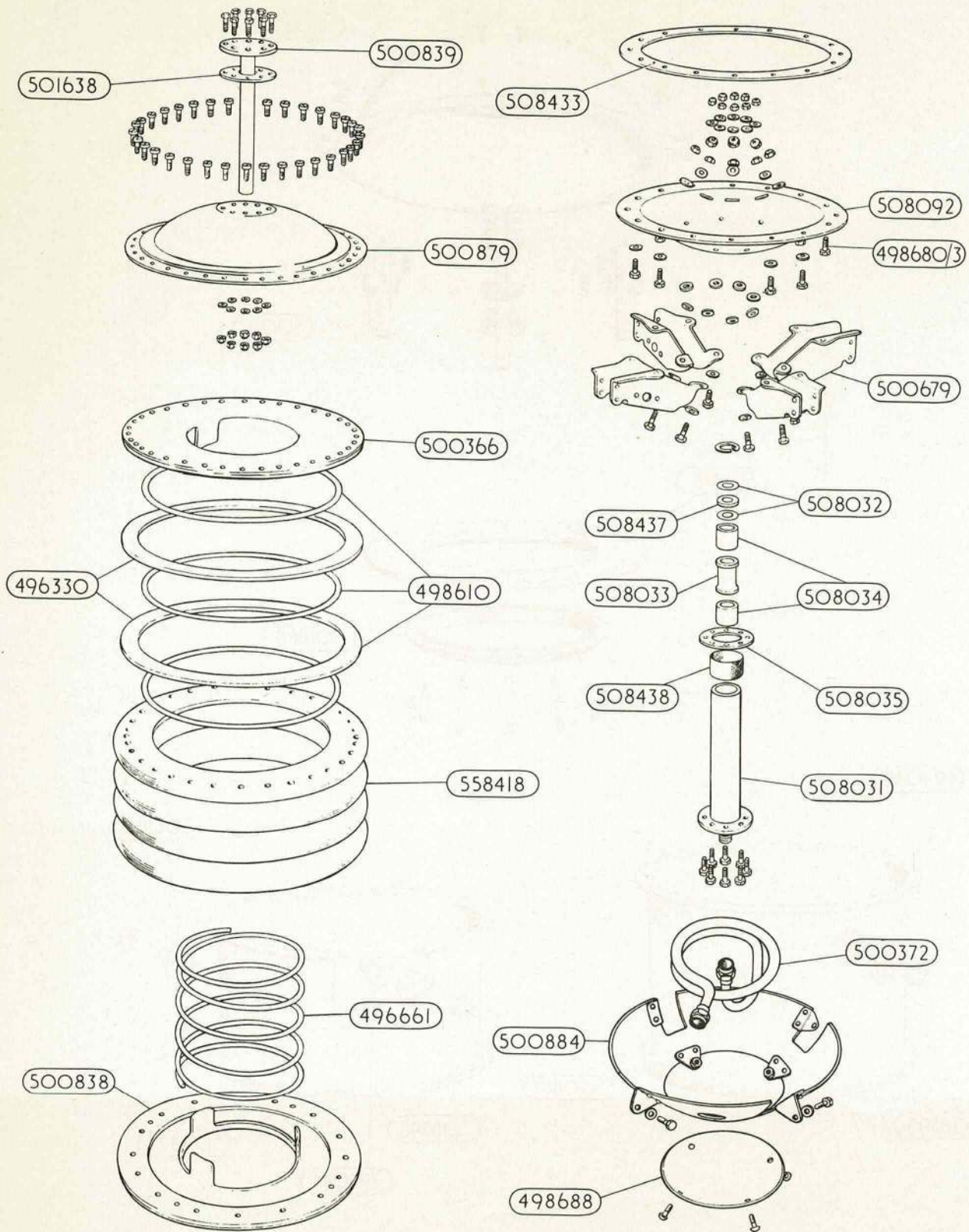

DIAPHRAGM, UPPER ASSEMBLY

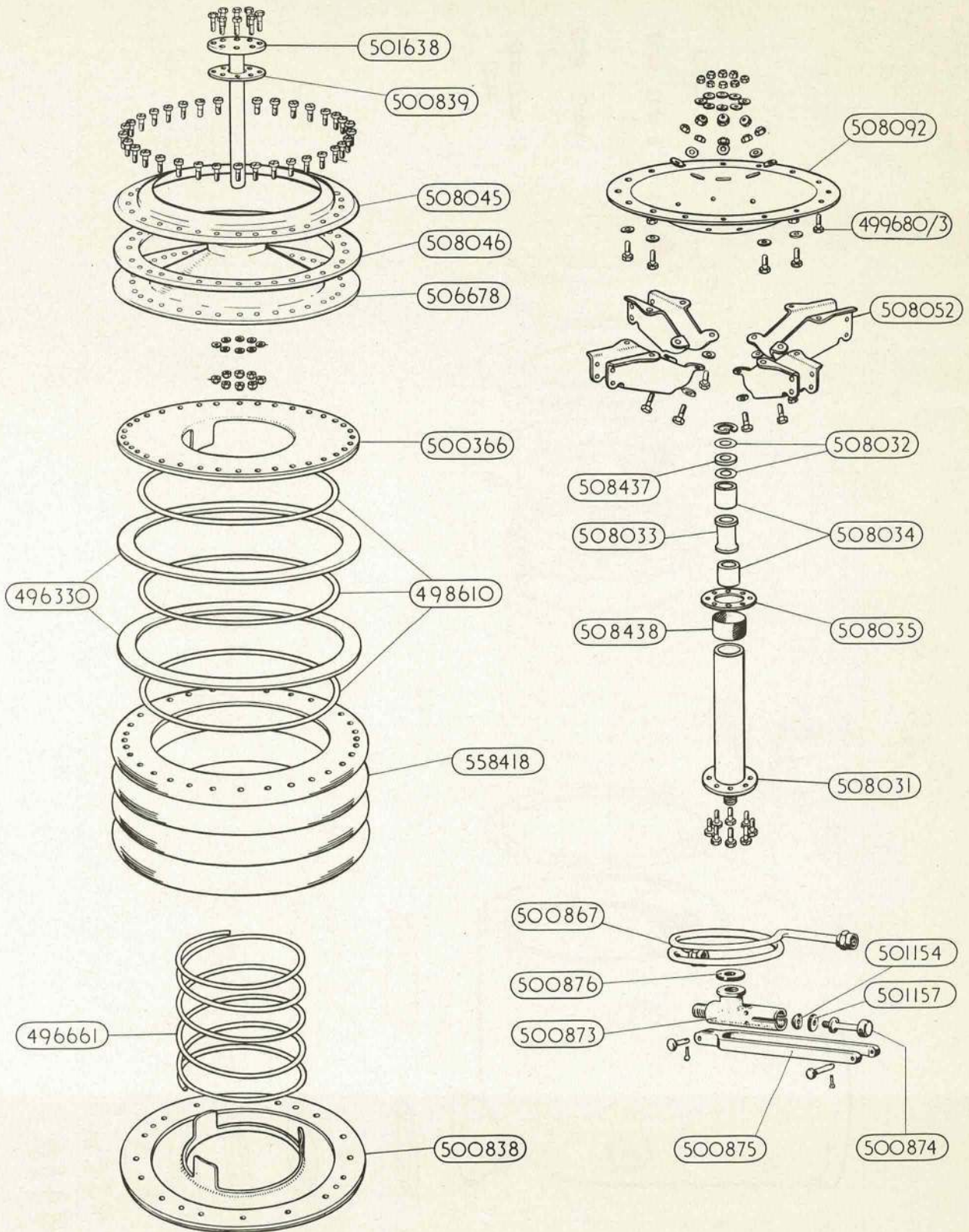

DIAPHRAGM, LOWER ASSEMBLY

PLATE. W6.

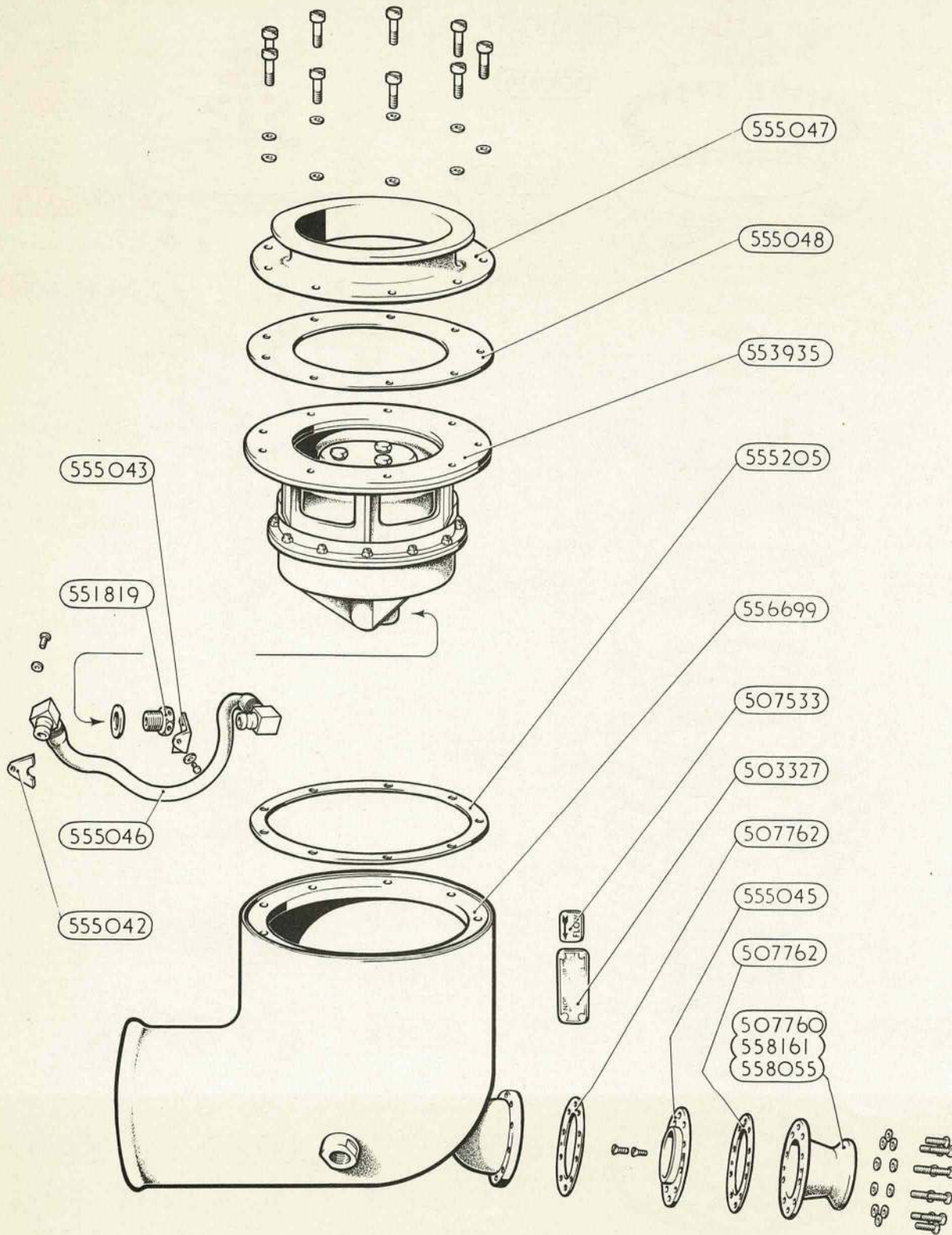

VALVE, DISCHARGE.

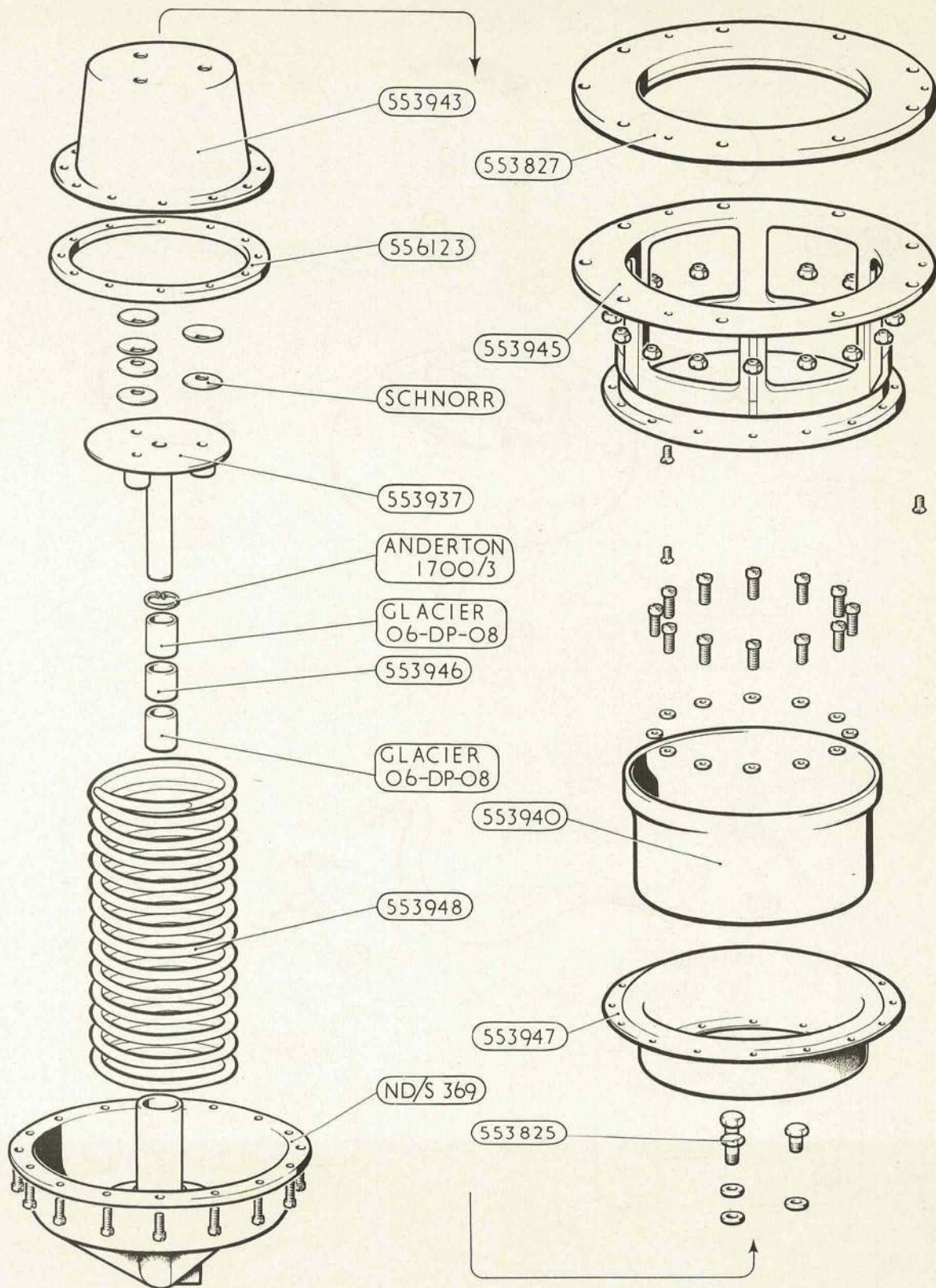

VALVE, DISCHARGE.

PLATE. W8.

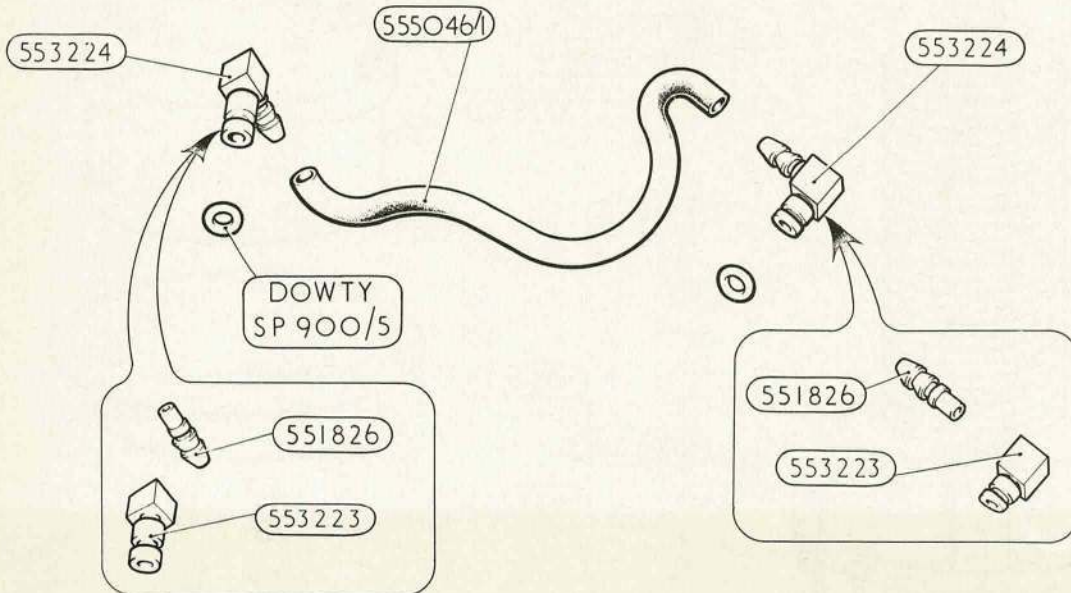
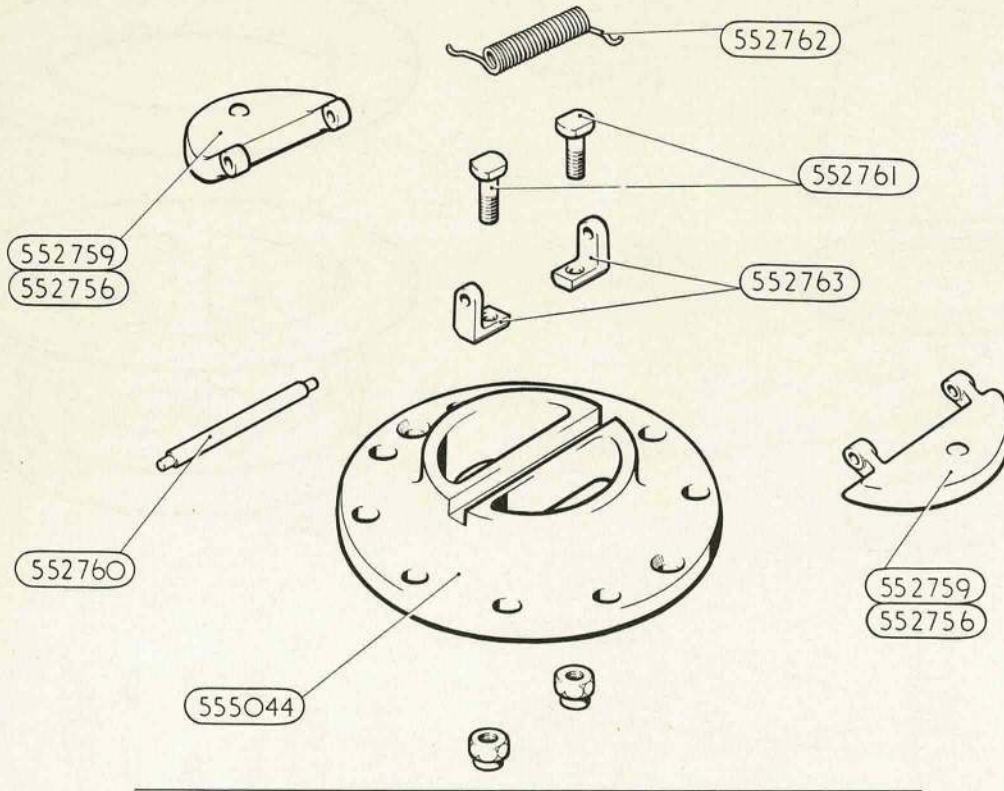

ASSEMBLIES, VARIOUS.

W9

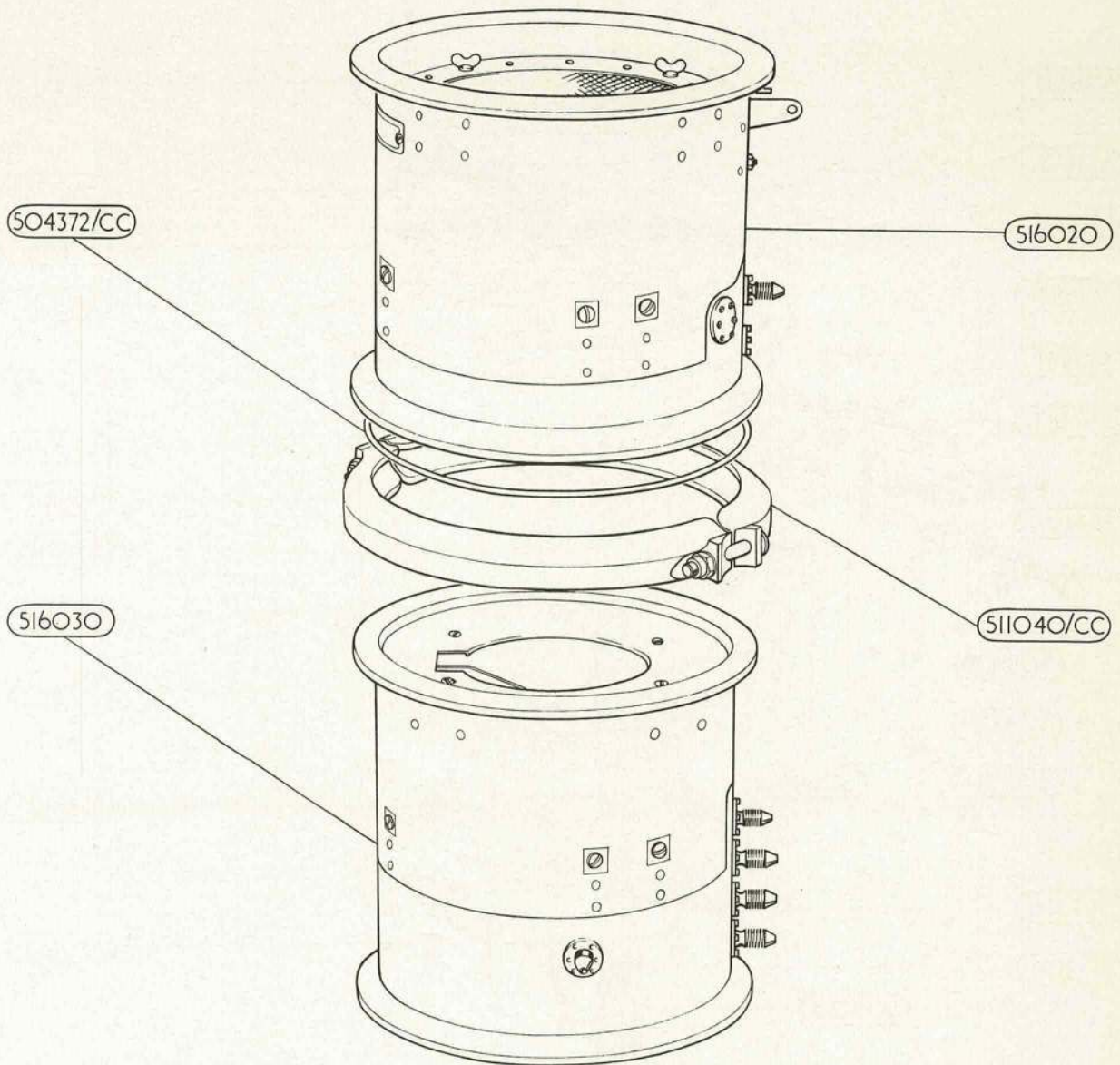

VALVE , DISCHARGE

W 10

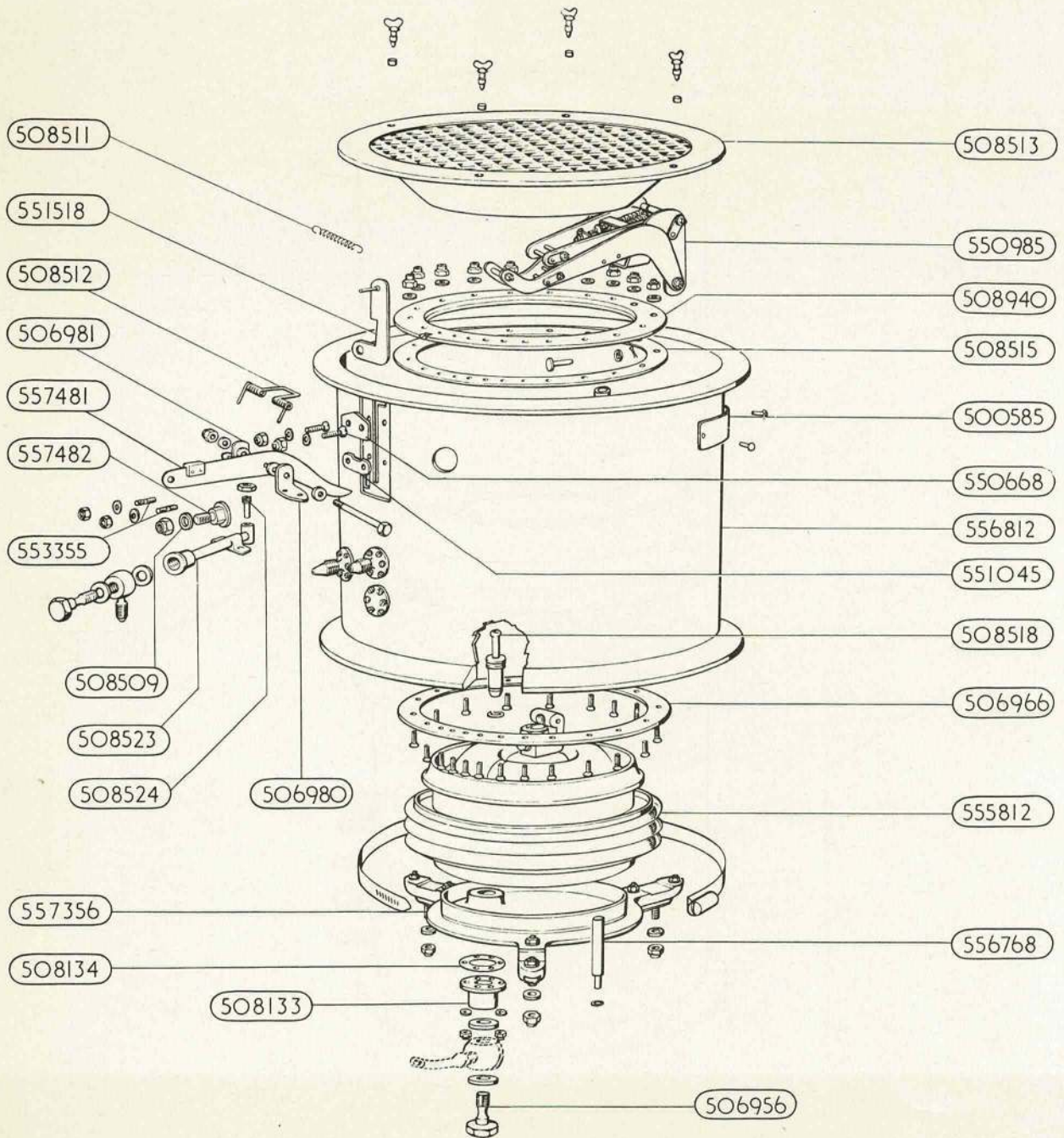

UNIT, No. I. ASSEMBLY.

W11

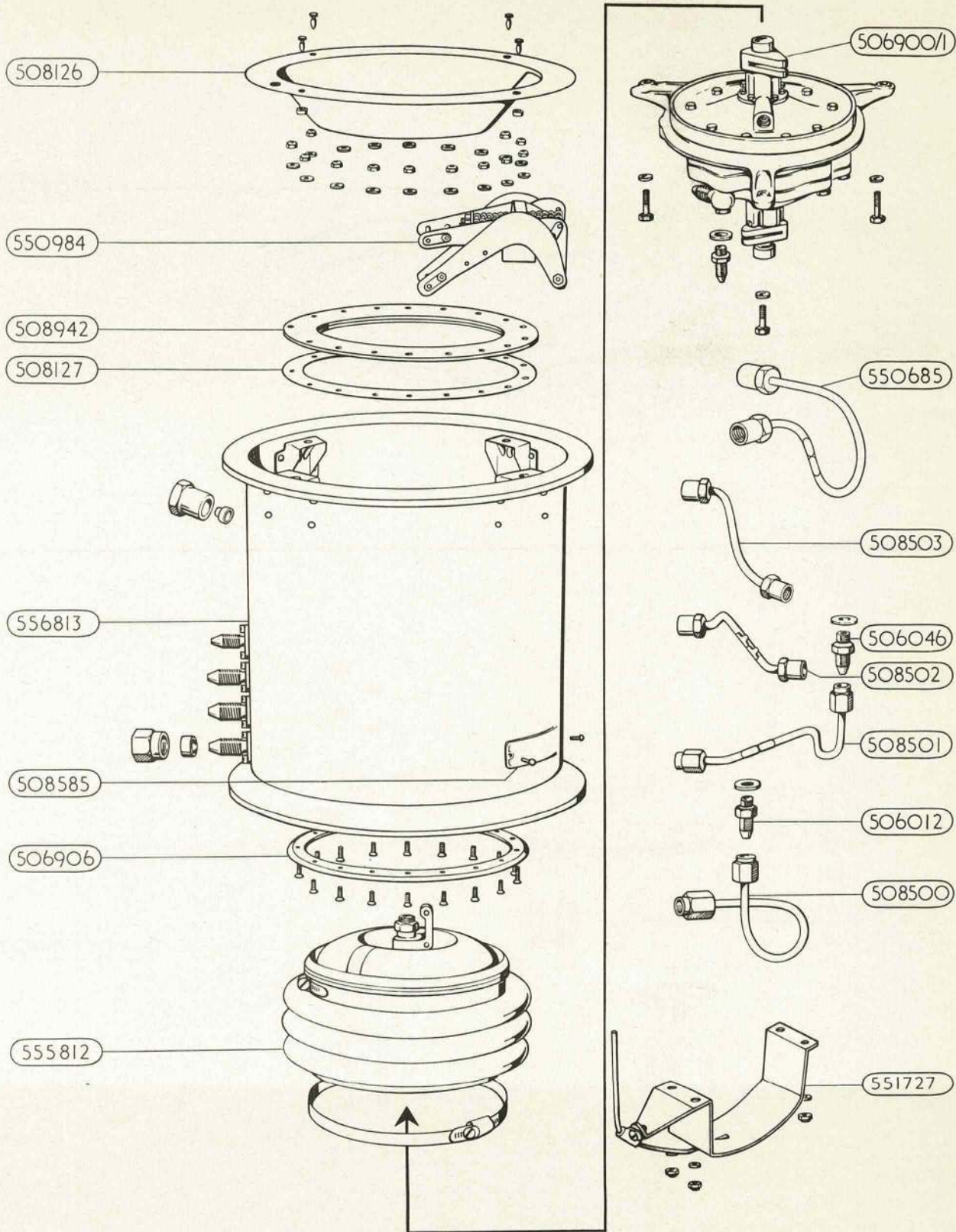

UNIT, No.2. ASSEMBLY.

WI2

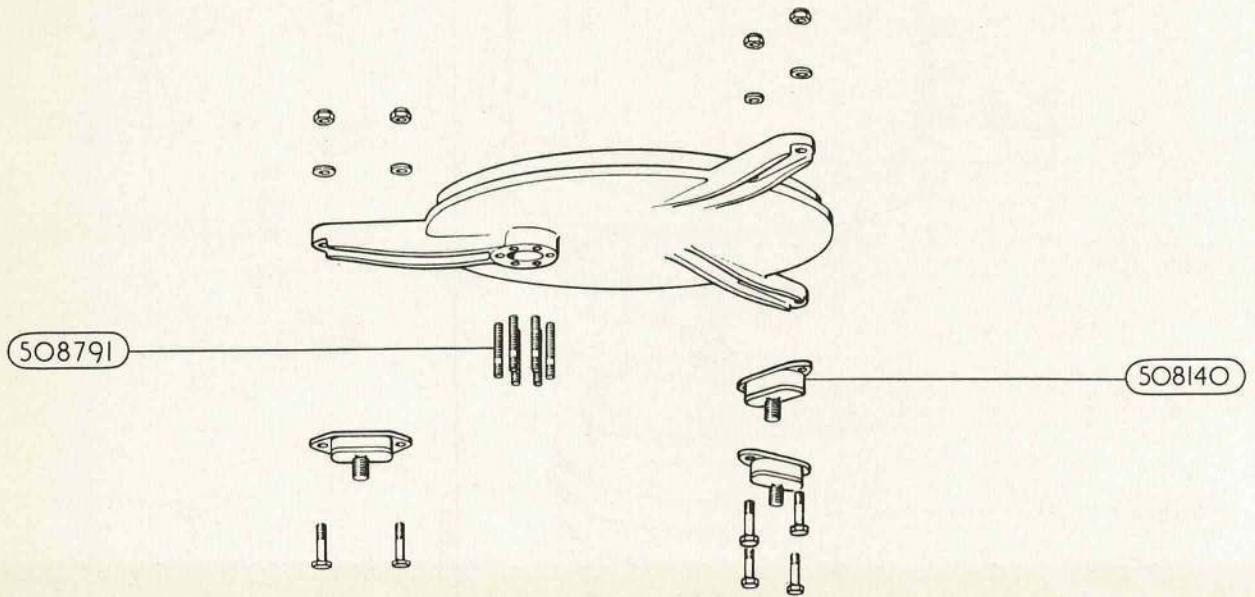
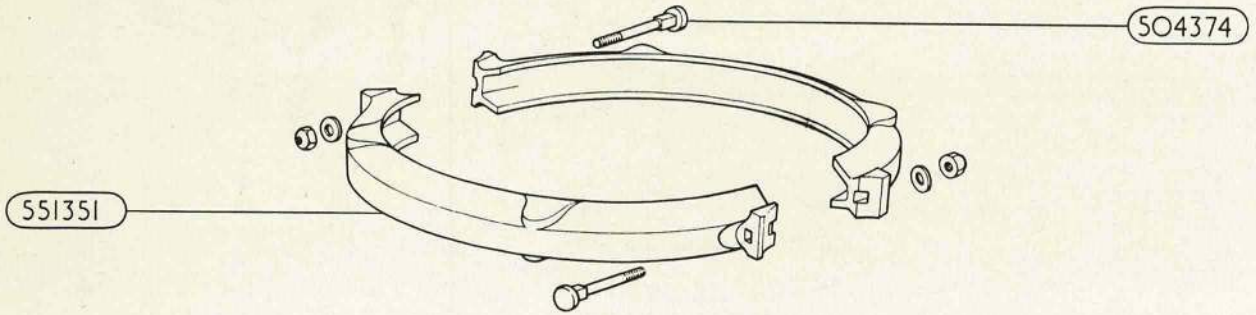

ASSEMBLIES, VARIOUS.

W13

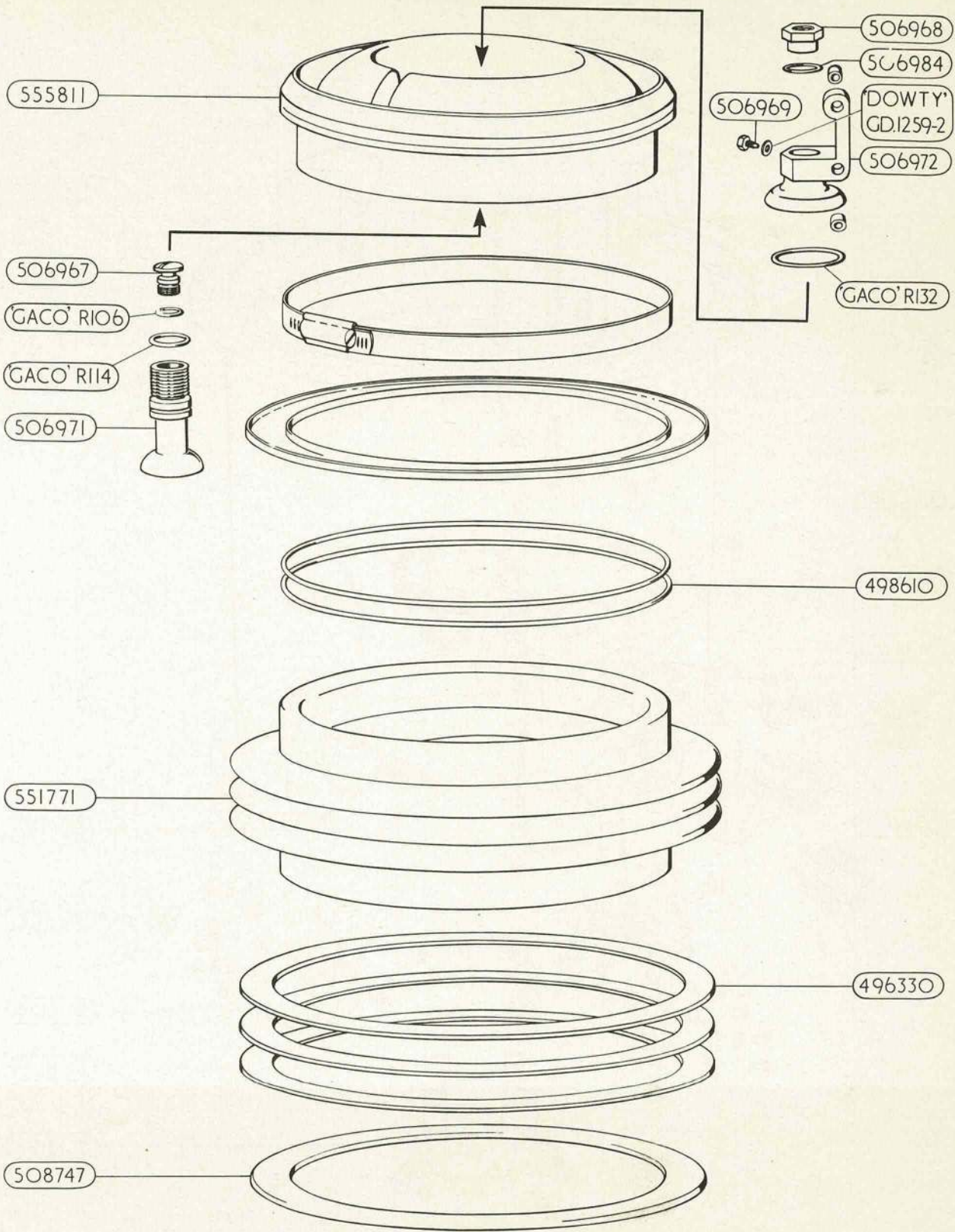

BELLOWS ASSEMBLY

WI4

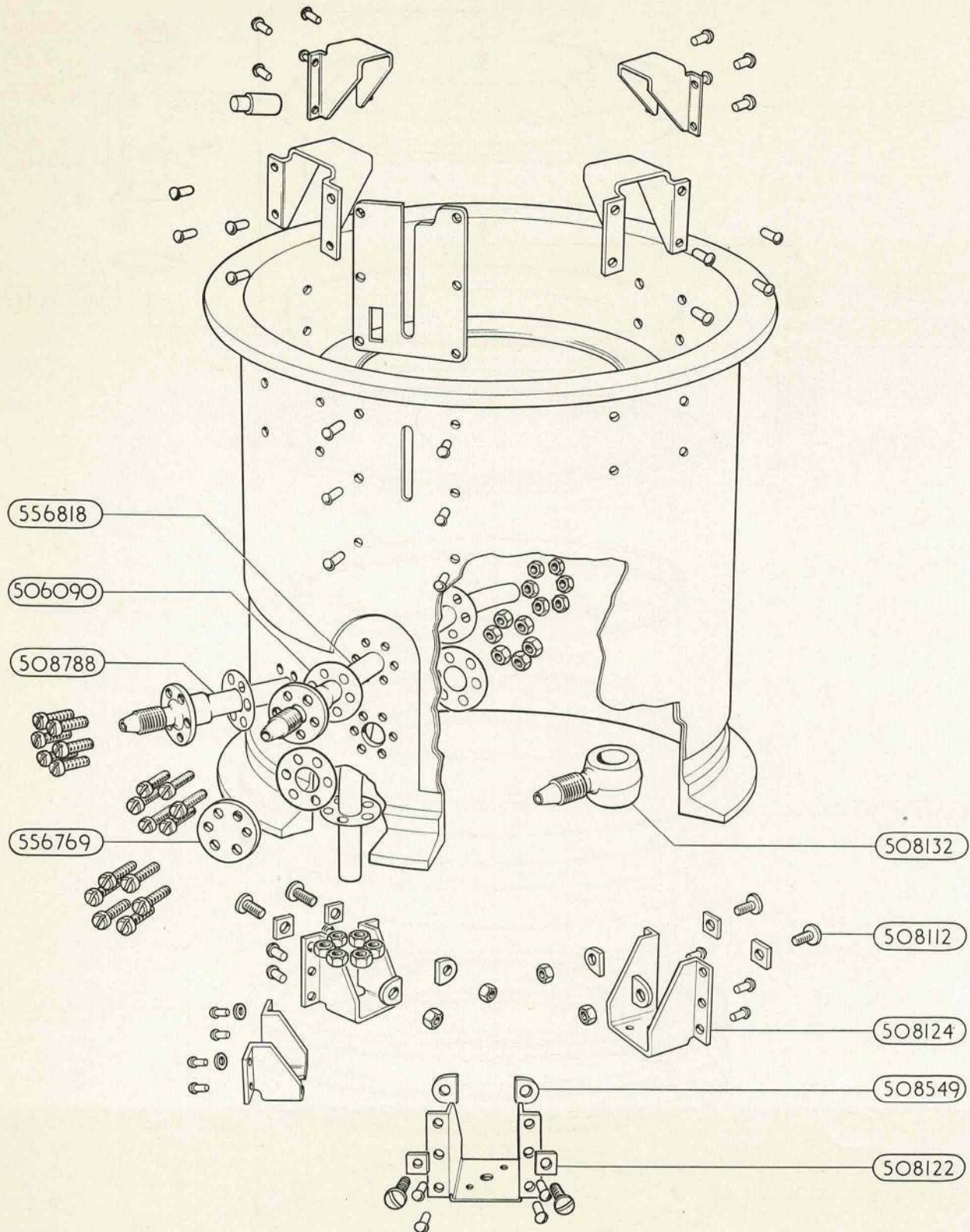

CASING ASSEMBLY.

W15

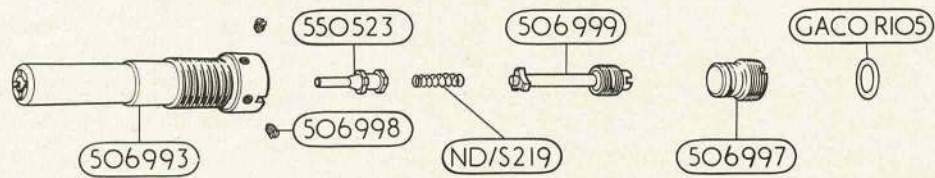
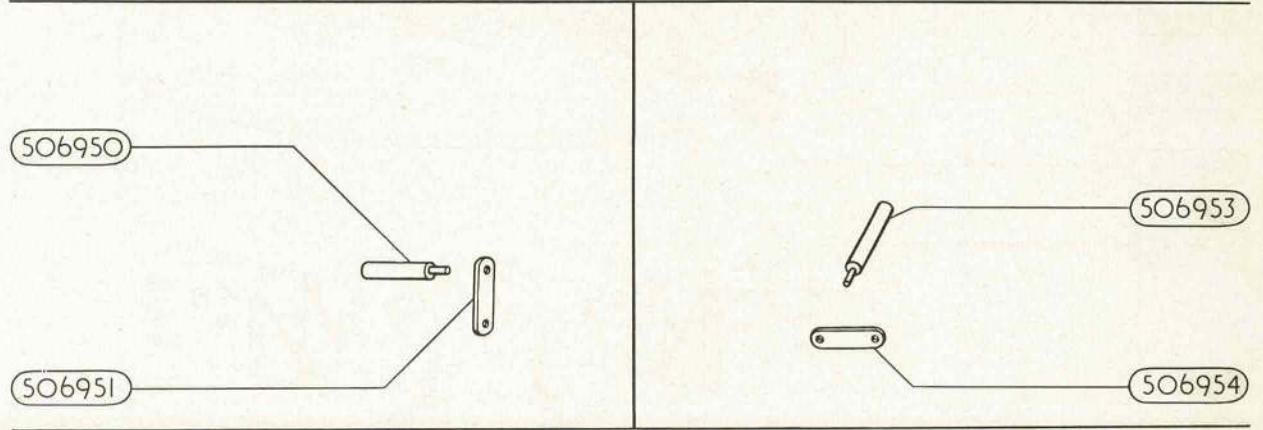
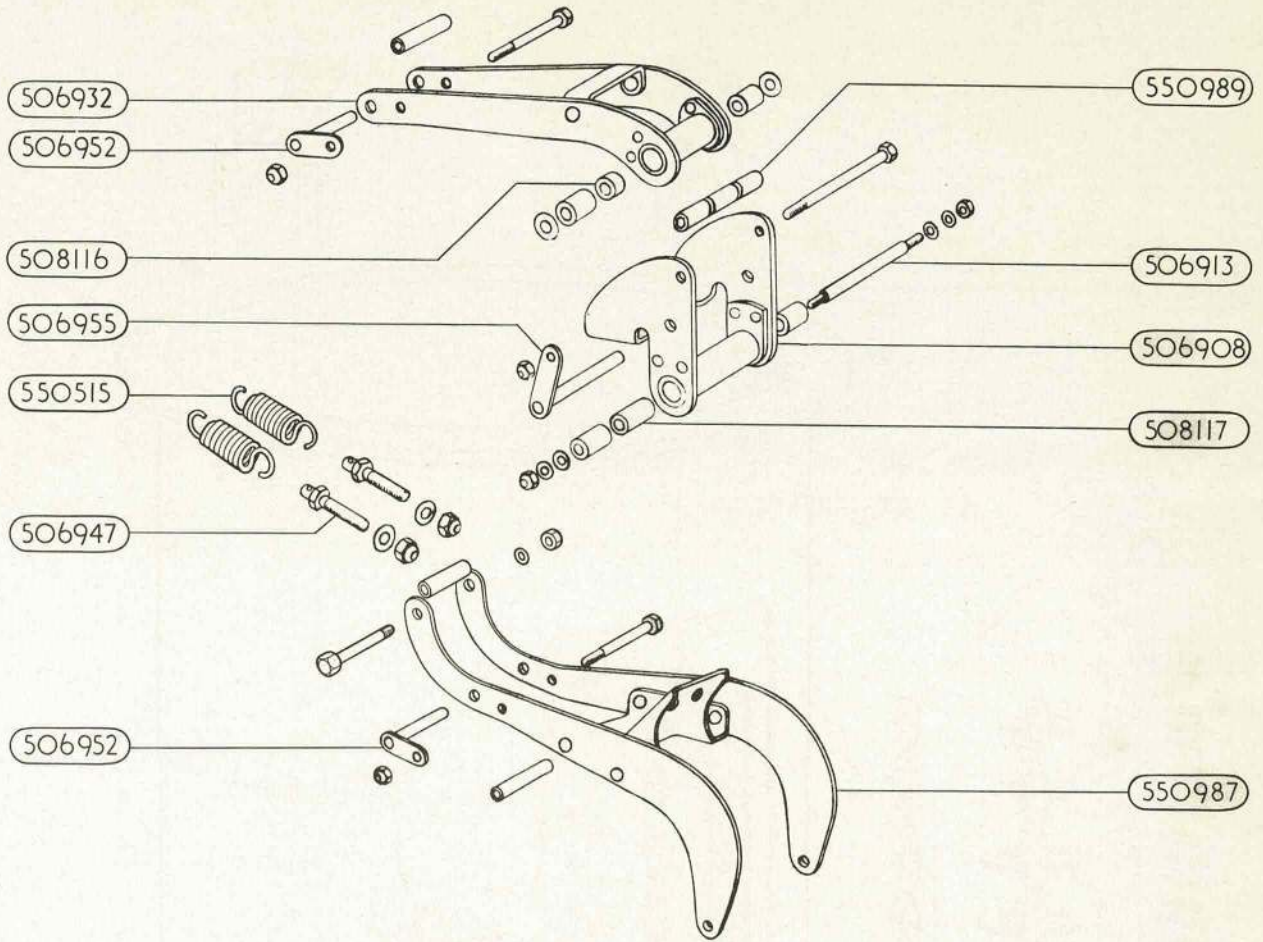

ASSEMBLIES, VARIOUS.

W16

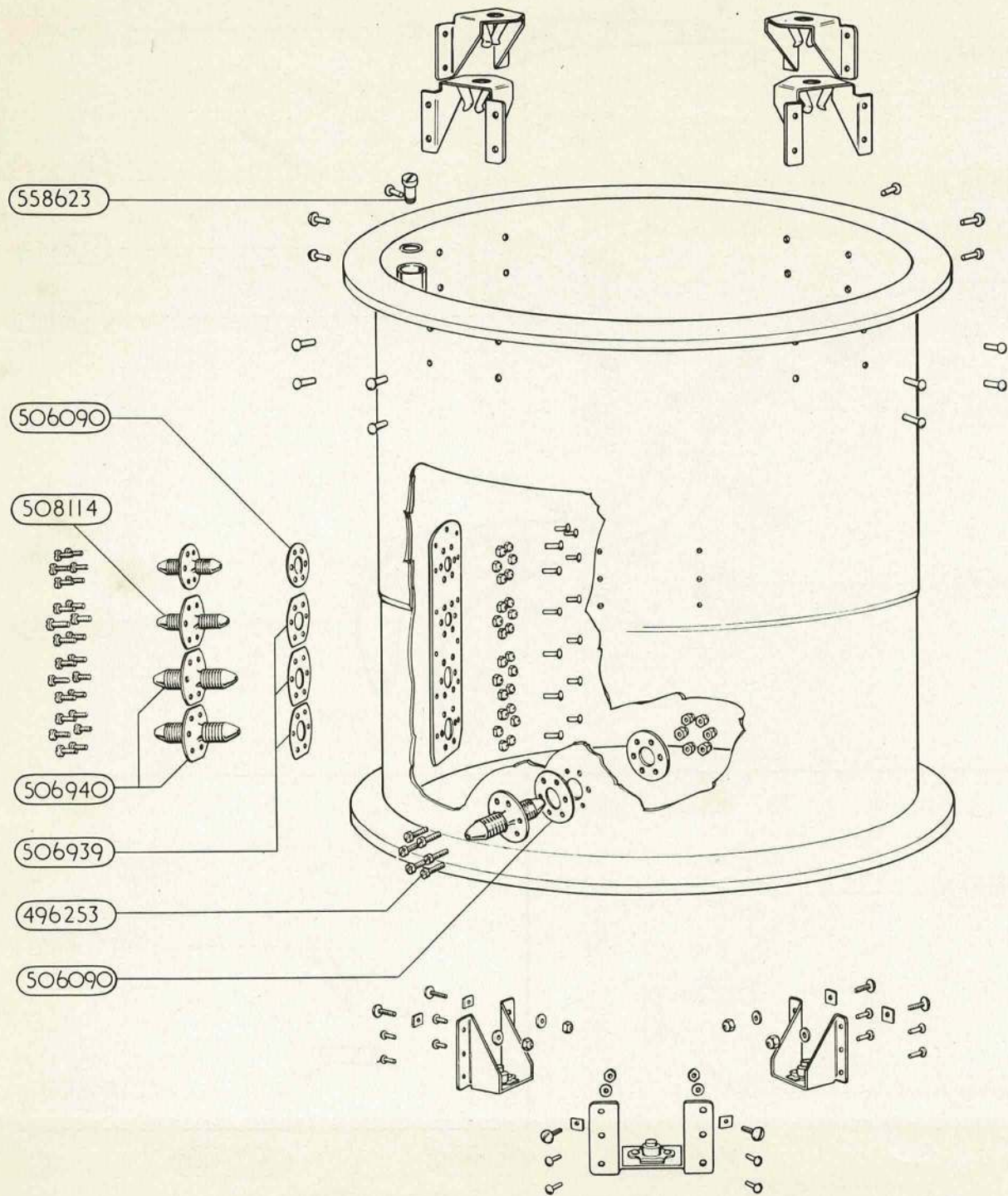

CASING ASSEMBLY.

W17

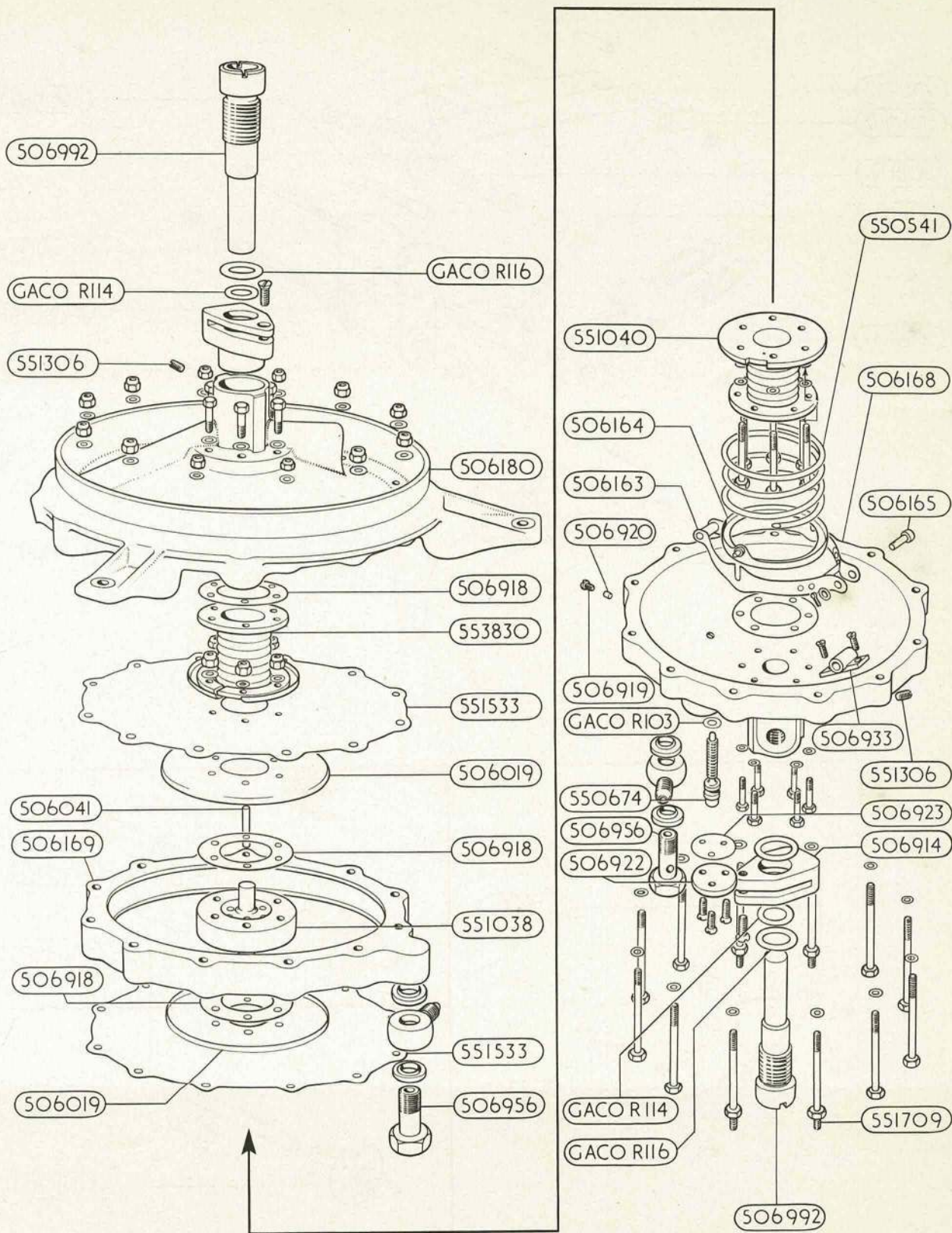

CONTROLLER, SURGE, ASSEMBLY

W18

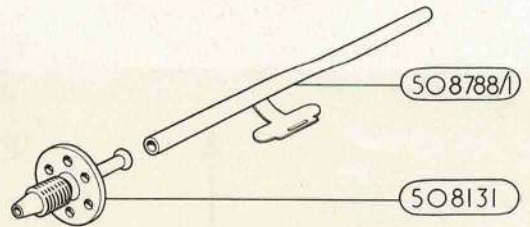
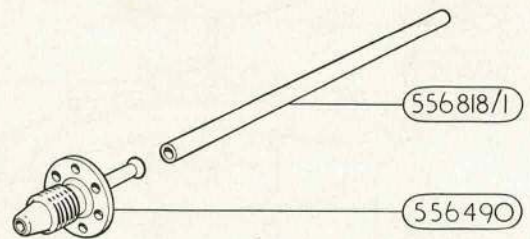
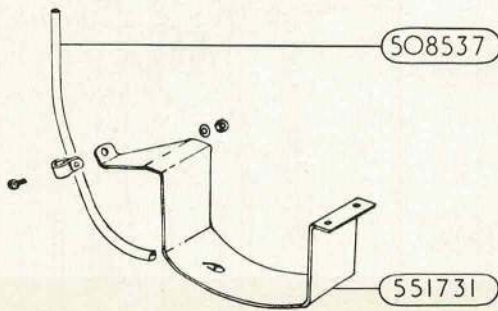
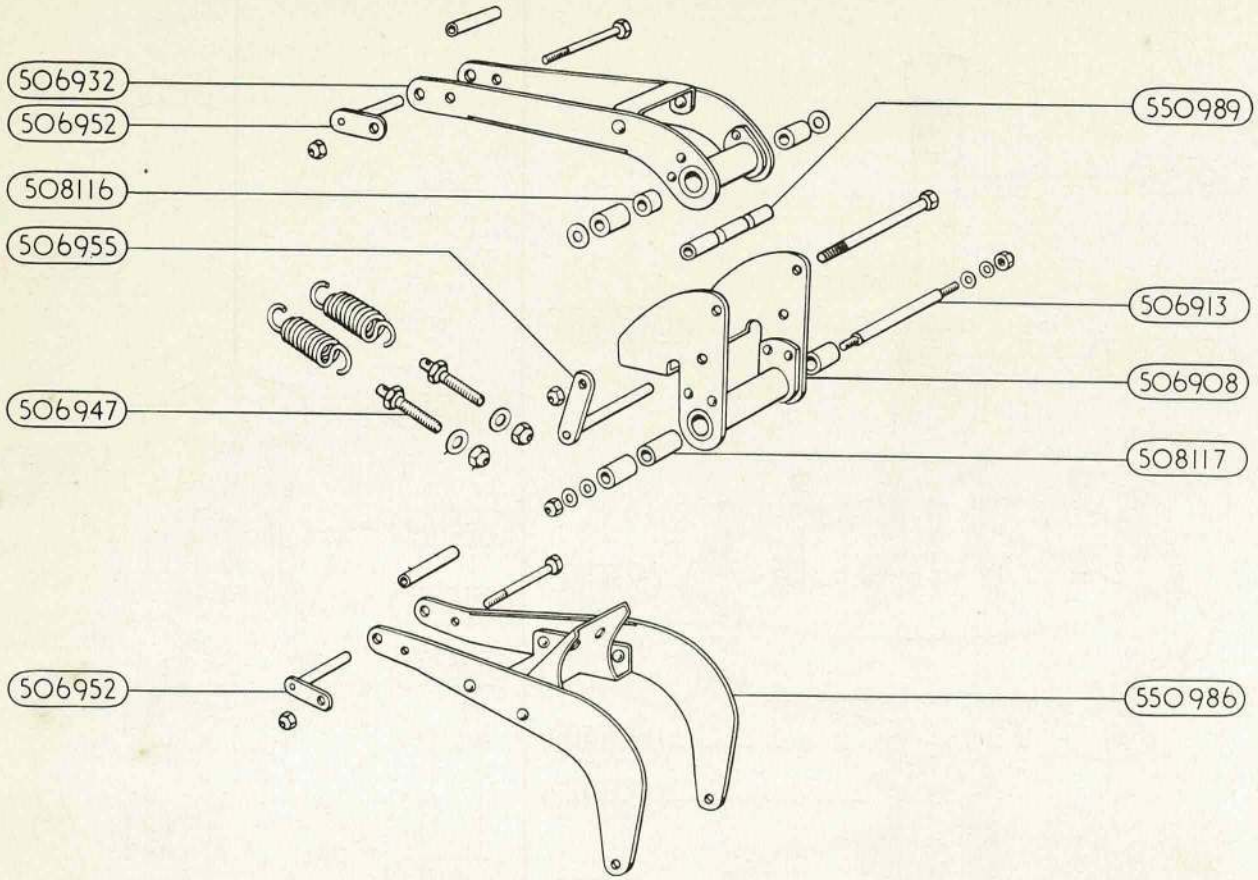

ASSEMBLIES, VARIOUS

This file was downloaded  
from the RTFM Library.  
Link: [www.scottbouch.com/rtfm](http://www.scottbouch.com/rtfm)

Please see site for usage terms,  
and more aircraft documents.

