

**AUGMENTORS, FLOW**

**N**





AUGMENTOR FLOW

Ref. No.	Part No.	Description	1 2 3 4 5					No. Off	Matl. Spec.	CL. OF	Plate No.
			ST.	M.R.	L.M.						
988	515950	AUGMENTOR, FLOW ... ..					1	—	A	Z 1	
		Spares for:—									
	557076	BOLT, attachment of end flanges to case ... ..					20	S.80		Z 1	
	557745	WASHER, tab (PRE. AMDT. 18AG) ... ..					2	—		Z 1	
	558049	WASHER, tab (AMDT. 18AG) (TYPE X' AMT 31AG)					10	—		Z 1	
	558079	CASE (AMDT. 19AG) ... ..					1	S.S.			
	554695	CASE (PRE. AMDT. 19AG) ... ..					1	S.S.		Z 1	
	554693	FLANGE ... ..					1	BS.1630		Z 1	
	554694	FLANGE ... ..					1	BS.1630		Z 1	
	554107	GASKET, sealing, at end flanges, end housing and orifice.					4	HALLITE		Z 1	
	554692	HOUSING, end ... ..					1	S.110		Z 1	
28S/16239	A37/B14	Screw, csk. 4 B.A. (PRE. AMDT. 19AG) ... ..					8	—	C	Z 1	
1251	507533	LABEL (R.N.) ... ..					1	—	C	Z 1	
567	503327	NAMEPLATE (R.N.) ... ..					1	L.17	C	Z 1	
	A49/B	Nut, end housing and flange attachment to case (PRE. AMDT. 19AG).					28	S.110			
	554740	ORIFICE, complete ... ..					1	—		Z 1	
	558078	SCREW, csk. 4 B.A. (AMDT. 19AG) ... ..					8	—		Z 1	
	554553	SCREW, spring adjusting ... ..					3	S.80		Z 1	
28M/	A24/CT	Nut, lock, 2 B.A. ... ..					3	—	C	Z 1	
	554338	SPINDLE ... ..					1	S.80		Z 1	
	554095	SPRING, assembly ... ..					1	—		Z 1	
		Spares for:—									
	554094	ADJUSTER, rate ... ..					1	L.42		Z 1	
	554093	SPRING ... ..					1	DTD.3209		Z 1	
	554743	VALVE, control, assembly ... ..					1	—		Z 1	
		Spares for:—									
1032	503605	BEARING — <del>XXXXXXXXXX</del> (R.N.) (PRE. AMDT. 28AG).					2	—	C	Z 1	
	558539	BEARING (AMDT. 28AG) ... ..					2	—			
	554103	BUSH ... ..					1	L.42		Z 1	
	554744	SCREW, grub ... ..					2	S.80		Z 1	
	554102	SPACER ... ..					1	L.42		Z 1	
	554689	VALVE, control ... ..					1	L.65		Z 1	
	554319	WASHER, spring, seating at control valve ... ..					1	DTD.171A		Z 1	
	554105	WASHER, spring, seating at orifice ... ..					1	DTD.571		Z 1	
1213	554301	WASHER, spindle, seating at end housing (R.N.)					1	S.110	C	Z 1	

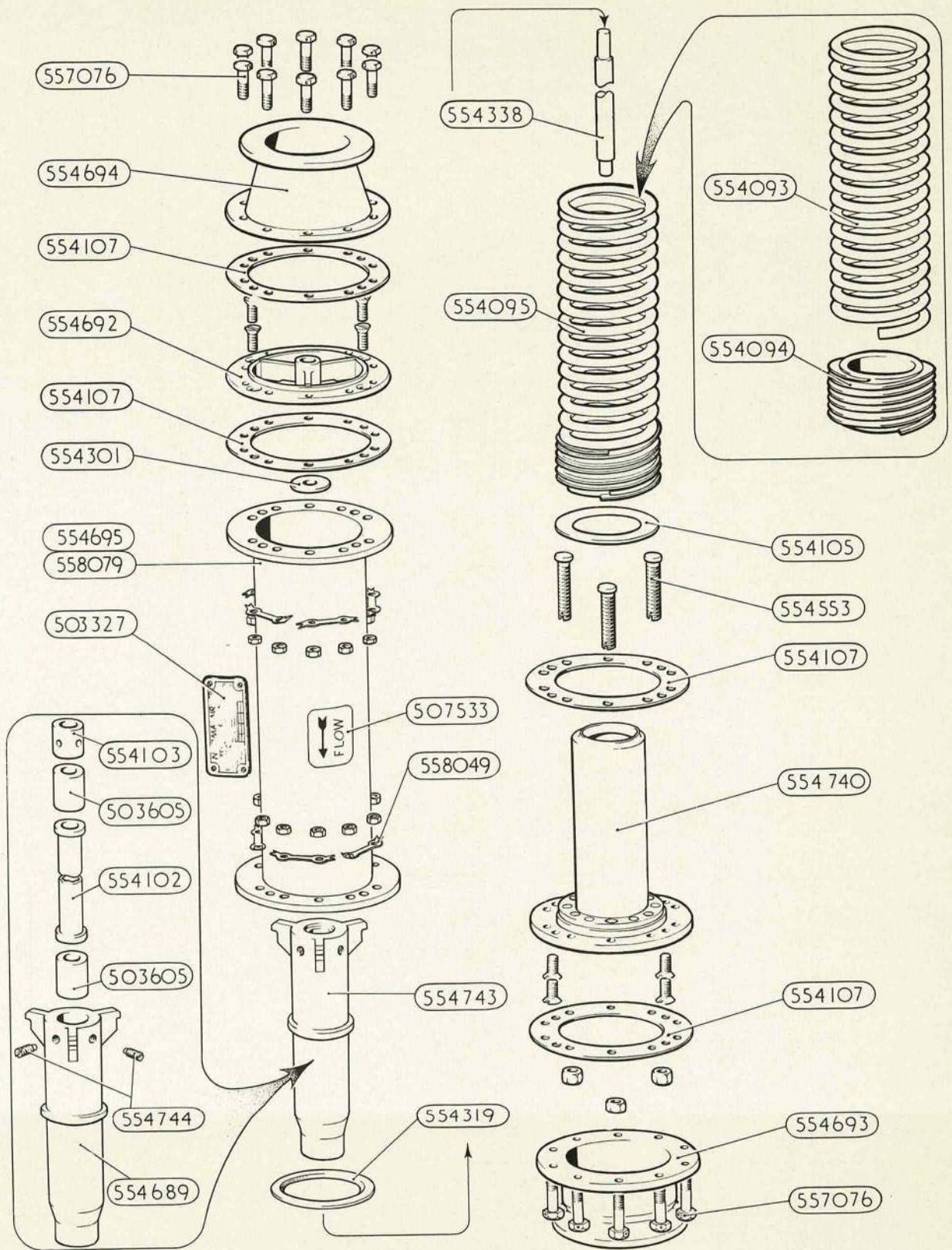

AUGMENTOR, FLOW



This file was downloaded from the RTFM Library.

Link: [www.scottbouch.com/rtfm](http://www.scottbouch.com/rtfm)

Please see site for usage terms, and more aircraft documents.

