

CONTROLS

FLYING CONTROLS IN WING CENTRE SECTION

Ref. No.	Part No.	Description	No. off	Material Specification	Class of Store or LM	Plate No.
		FLYING CONTROLS IN WING CENTRE SECTION, GROUP (Drg. Nos. 10-20 CF 9005, 10-20 CF 9007 and 10-20 WF 17)	1	—	—	
	10-20 WF 967	BLOCK , spacing, flap lock micro-switch	2	LFS.21	—	CE7
28D/9015170	A25/16B	Attachments for 10-20 WF 967, Block :—				
28W/9419465	SP.13/B	Bolt, 4 BA	2	—	C	
		Washer	2	—	C	
		BRACKET , pulley, aileron control, front skin inboard, Port, group (10-20 CF 8481)	1	—	—	CE1
	10-20 CF 9151A/ND	PULLEY AND BRACKET , at centre line of aircraft, at stn. 180"-45, Port inboard, assembly	1	—	—	CE1
	10-20 FS 13443A	BRACKET , angle, assembly	1	—	—	CE1
	10-20 FS 13441ND	BRACKET , bare, 18 SWG	1	L.72	LM	CE1
28M/9434252	AGS.2018/B/1	NUT , anchor, 4 BA	2	—	C	
10754	10-20 CF 8483	BRACKET , pulley, bare	1	—	P	CE1
9705	10-20 CF 8477	GUARD , threaded, 2 BA	1	—	C	CE1
		Attachments for 10-20 CF 8477, Guard :—				
28M/10288	AGS.2001/C/1	Nut, 2 BA	1	—	C	
28W/9419402	SP.13/C	Washer	1	—	C	
	1787	PULLEY , assembly	1	—	P	CE1
		Spares for :—				
2A/9501380	SKEFKO 042266	BEARING , ball (3110-99-950-1380)	1	—	C	CE1
2965	DHS.800	PLATE , retaining	1	—	C	CE1
		Attachments for DHS.800, Plate :—				
28D/1007973	AS.1242/2B	Bolt, 4 BA	3	—	C	
28M/100650	A27/BT	Nut, 4 BA	3	—	C	
		Attachments for DHS.797/20, Pulley :—				
28M/14833	A58/J5	Nut, 3" BSF	1	—	C	
28P/9527619	SP.90/C7	Pin, split (SP.9/C8)	1	—	C	
28W/9419466	SP.13/J	Washer	1	—	C	
	10-20 CF 8479	STUD	1	S.96	—	CE1
		Attachments for 10-20 CF 8479, Stud :—				
28M/14440	A58/JT	Nut, 3" BSF	1	—	C	
28W/9419466	SP.13/J	Washer	1	—	C	
		Attachments for 10-20 CF 9151A/ND, Pulley and Bracket :—				
28M/14537	A58/GS	Nut, 3/8" BSF	4	—	C	
28P/9527619	SP.90/C7	Pin, split (SP.9/C8)	4	—	C	
26FN/3263	DHS.69/EE	Shim	QR	—	C	CE1
28W/9419403	SP.13/C	Washer	4	—	C	
	10-20 CF 9153A/ND	PULLEY AND BRACKET , at centre line of aircraft, at stn. 177"-90, Port out-board, assembly	1	—	—	CE1
9703	10-20 CF 8485	BRACKET , bare	1	—	C	CE1
9704	10-20 CF 8475	GUARD , cable	1	—	C	CE1
		Attachments for 10-20 CF 8475, Guard :—				
28M/10288	AGS.2001/C/1	Nut, 2 BA	1	—	C	
28W/9419402	SP.13/C	Washer	1	—	C	

CONTROLS

FLYING CONTROLS IN WING CENTRE SECTION

Ref. No.	Part No.	Description	No. off	Material Specification	Class of Store or L.M.	Plate No.
1787	DHS.797/20	PULLEY , assembly	1	—	P	CE1
		Spares for :—				
2A/9501380	SKEFKO 402266	BEARING , ball (3110-99-950-1380) ...	1	—	C	CE1
2965	DHS.800	PLATE , retaining	1	—	C	CE1
		Attachments for DHS.800, Plate :—				
28D/1007973	AS.1242/2B	Bolt, 4 BA	3	—	C	
28M/1006504	A27/BT	Nut, 4 BA	3	—	C	
		Attachments for DHS.797/20, Pulley :—				
28M/14833	A58/JS	Nut, 3/8" BSF	1	—	C	
28P/9527619	SP.90/C7	Pin, split (SP.9/C8)	1	—	C	
28W/9419466	SP.13/J	Washer	1	—	C	
	10-20 CF 8479	STUD	1	S.96	—	CE1
		Attachments for 10-20 CF 8479, Stud :—				
28M/14440	A58/JT	Nut, 3/8" BSF	1	—	C	
28W/9419466	SP.13/J	Washer	1	—	C	
		Attachments for 10-20 CF 9153A/ND, Pulley and Bracket :—				
28M/13935	A58/ES	Nut, 1/2" BSF	2	—	C	
28M/14537	A58/GS	Nut, 3/8" BSF	1	—	C	
28P/9527619	SP.90/C7	Pin, split (SP.9/C8)	3	—	C	
26FN/3275	DHS.69/DD	Shim	QR	—	C	CE1
28W/9418921	SP.13/E	Washer	2	—	C	
28W/9419403	SP.13/G	Washer	1	—	C	
	—	BRACKET , pulley, aileron control, front spar inboard, Starboard, group (Drg. No. 10-20 CF 8489)	1	—	—	CE2
	10-20 CF 9155A/ND	PULLEY AND BRACKET , at centre line of aircraft, Starboard, assembly	1	—	—	CE2
10755	10-20 CF 8491	BRACKET , bare	1	—	P	CE2
9706	10-20 CF 8487	GUARD , cable	2	—	C	CE2
		Attachments for 10-20 CF 8487, Guard :—				
28M/10288	AGS.2001/C/1	Nut, 2 BA	1	—	C	
28W/9419402	SP.13/C	Washer	1	—	C	
	10-20 FS 13481	PLATE , washer, 18 SWG	1	S.510	—	CE2
1787	DHS.797/20	PULLEY , assembly	2	—	P	CE2
		Spares for :—				
2A/9501380	SKEFKO 402266	BEARING , ball (3110-99-950-1380) ...	1	—	C	CE2
2965	DHS.800	PLATE , retaining	1	—	C	CE2
		Attachments for DHS.800, Plate :—				
28D/1007973	AS.1242/2B	Bolt, 4 BA	3	—	C	
28M/1006504	A27/BT	Nut, 4 BA	3	—	C	
		Attachments for DHS.797/20, Pulley :—				
28M/14833	A58/JS	Nut, 3/8" BSF	1	—	C	
28P/9527619	SP.90/C7	Pin, split (SP.9/C8)	1	—	C	
28W/9419466	SP.13/J	Washer	1	—	C	
	10-20 CF 8479	STUD , pulley spindle	2	S.96	—	CE2
		Attachments for 10-20 CF 8479, Stud :—				
28M/14440	A58/JT	Nut, 3/8" BSF	1	—	C	
28W/9419466	SP.13/J	Washer	1	—	C	

CONTROLS

FLYING CONTROLS IN WING CENTRE SECTION

Ref. No.	Part No.	Description	No. off	Material Specification	Class of Store or L/M	Place No.
	AS.2808/5/150	TUBE , distance, $\frac{5}{16}$ " o/d \times 17 SWG \times 1"-50 long	1	T.35 or T.45	LM	CE2
28D/1011026	A25/26C	Attachments for AS.2808/5/150, Tube :— Bolt, 2 BA	1	—	C	
28M/9403520	A27/CP	Nut, 2 BA	1	—	C	
28W/9419402	SP.13/C	Washer	2	—	C	
		Attachments for 10-20 CF 9155A/ND, Pulley and Bracket :—				
28M/1011467	A27/ES	Nut, $\frac{1}{4}$ " BSF	3	—	C	
28M/5808571	A27/GS	Nut, $\frac{5}{16}$ " BSF	1	—	C	
28P/9527619	SP.90/C7	Pin, split (SP. 9/C8)	3	—	C	
26FN/3275	DHS.69/DD	Shim	QR	—	C	CE2
26FN/3263	DHS.69/EE	Shim	QR	—	C	CE2
28W/9418920	SP.10/E	Washer	3	—	C	
28W/9419453	SP.10/G	Washer	1	—	C	
	—	BRACKET , pulley, at front spar and rib No. 2 (aileron controls) Port and Starboard, group (Drg. No. 10-20 CF 3993)	1	—	—	CE2
	10-20 CF 3989A	PULLEY AND BRACKET , on front spar, Port, assembly	1	—	—	CE2
	10-20 CF 3990A	PULLEY AND BRACKET , on front spar, Starboard, assembly	1	—	—	CE2
10800	10-20 CF 7815	BOLT , guard	1	—	C	CE2
		Attachments for 10-20 CF 7815, Bolt :—				
28M/10328	AGS.2002/C/1	Nut, 2 BA	1	—	C	
10801	DHS.783/B/18	Washer, 18 SWG	1	—	C	CE2
2890	10-20 CF 3973A	BRACKET , Port, assembly	1	—	C	CE2
2891	10-20 CF 3974A	BRACKET , Starboard, assembly	1	—	C	CE2
	10-20 CF 3975ND	BRACKET , bare, Port	1	L.122	—	CE2
	10-20 CF 3976ND	BRACKET , bare, Starboard	1	L.122	—	CE2
1787	DHS.797/20	PULLEY , 3"-0 dia.	2	—	P	CE2
		Spares for :—				
2A/9501380	SKEFKO 402266	BEARING , ball (3110-99-950-1380)	1	—	C	CE2
2965	DHS.800	PLATE , retaining, 16 SWG	1	—	C	CE2
		Attachments for DHS.800, Plate :—				
28D/9131782	AS.1242/2B	Bolt, 4 BA	3	—	C	
28M/1006504	A27/BT	Nut, 4 BA	3	—	C	
		Attachments for DHS.797/20, Pulley :—				
2967	DHS.901/15JJ	Bolt, $\frac{3}{8}$ " BSF	1	—	C	CE2
28M/13451	A29/JS	Nut, $\frac{3}{8}$ " BSF	1	—	C	
28P/9527619	SP.90/C7	Pin, split (SP.9/C8)	1	—	C	
28W/9419477	SP.15/J	Washer	1	—	C	
		Attachments for 10-20 CF 3989A or 10-20 CF 3990A, Pulley and Bracket :—				
28M/1011467	A27/ES	Nut, $\frac{1}{4}$ " BSF	4	—	C	
28M/7002430	AGS.2002/E/1	Nut, $\frac{1}{4}$ " BSF	2	—	C	
28P/9527619	SP.90/C7	Pin, split (SP.9/C8)	4	—	C	
28W/9418921	SP.13/E	Washer	2	—	C	
28W/9419405	SP.15/E	Washer	4	—	C	

CONTROLS

FLYING CONTROLS IN WING CENTRE SECTION

Ref. No.	Part No.	Description	No. off						Material Specification	Class of Store or LM	Plate No.
			1	2	3	4	5	6			
	—	BRACKET , pulley, at main spar and rib No. 2, Port, group (Drg. No. 10-20 CF 4395)	1						—	CE3	
	10-20 CF 4393A	BRACKET , pulley, on main spar, assembly ...	1						—	CE3	
	10-20 CF 4391	BRACKET , bare ...	1					L.122	—	CE3	
		(For Spares use 10-20 CF 8639ND)									
2919	10-20 CF 8639ND	BRACKET , bare (Spares condition) ...	1						C	CE3	
2918	10-20 CF 4445A	GUARD , assembly ...	1						C	CE3	
		Attachments for 10-20 CF 4445A, Guard :—									
4171	A25/3C/DHS.514/D	Bolt, 2 BA (Alternative S21/A25/3C) ...	2						C	CE3	
28W/9419402	SP.13/C	Washer ...	2						C		
1787	DHS.797/20	PULLEY , 3"-0 dia. ...	2						P	CE3	
		Spares for :—									
2A/9501380	SKEFKO 402266	BEARING , ball (3110-99-950-1380) ...	1						C	CE3	
2965	DHS.800	PLATE , retaining, 16 SWG ...	1						C	CE3	
		Attachments for DHS.800, Plate :—									
28D/9131782	AS.1242/2B	Bolt, 4 BA ...	3						C		
28M/1006504	A27/BT	Nut, 4 BA ...	3						C		
2971	DHS.790	PULLEY , 4"-0 dia. ...	1						P	CE3	
		Spares for :—									
2A/9509471	SKEFKO 401458	BEARING , ball (3110-99-950-1471) ...	1						C	CE3	
2969	DHS.793	PLATE , retaining, 16 SWG ...	1						C	CE3	
		Attachments for DHS.793, Plate :—									
28D/9709461	AS.1242/3C	Bolt, 2 BA ...	3						C		
28M/1006473	A27/CT	Nut, 2 BA ...	3						C		
		Attachments for DHS.797/20 or DHS.790, Pulley :—									
28D/17026	A59/23J	Bolt, 3/8" BSF ...	1						C		
28M/13412	A24/JS	Nut, 3/8" BSF ...	1						C		
28P/9527619	SP.90/C7	Pin, split (SP.9/C8) ...	1						C		
2972	DHS.329/62	Tube, distance ...	1						C	CE3	
28W/9419466	SP.13/J	Washer ...	2						C		
		Attachments for 10-20 CF 4393A, Bracket :—									
28D/1213607	A59/6G	Bolt, 3/8" BSF ...	2						C		
28D/1213608	A59/8G	Bolt, 3/8" BSF ...	2						C		
28M/13267	A24/GS	Nut, 3/8" BSF ...	4						C		
28P/9527619	SP.90/C7	Pin, split (SP.9/C8) ...	4						C		
28W/9419488	SP.16/G	Washer ...	4						C		
	—	BRACKET , pulley, at main spar and rib No. 2, Starboard, group (Drg. No. 10-20 CF 4723)	1						—	CE4	
	10-20 CF 4725A	BRACKET , pulley, Starboard, assembly ...	1						—	CE4	
	10-20 CF 4641	BRACKET , bare ...	1					L.122	—	CE4	
		(For Spares use 10-20 CF 8641ND)									
2929	10-20 CF 8641ND	BRACKET , bare (Spares condition) ...	1						C	CE4	
2930	10-20 CF 4731A	GUARD , assembly ...	1						C	CE4	
		Attachments for 10-20 CF 4731A, Guard :—									
4186	A25/2C/DHS.514/D	Bolt, 2 BA (Alternative S21/A25/2C) ...	2						C	CE4	
28W/9419402	SP.13/C	Washer ...	2						C		

CONTROLS

FLYING CONTROLS IN WING CENTRE SECTION

Ref. No.	Part No.	Description	No. off	Material Specification	Class of Store or L.M	Plate No.
2971	DHS.790	PULLEY , 4" dia.	1	—	P	CE4
		Spares for:—				
2A/9501471	SKEFKO 401458	BEARING , ball (3110-99-950-1471)	1	—	C	CE4
2969	DHS.793	PLATE , retaining	1	—	C	CE4
		Attachments for DHS.793, Plate:—				
28D/9709461	AS.1242/3C	Bolt , 2 BA	3	—	—	C
28M/1006473	A27/CT	Nut , 2 BA	3	—	C	
		Attachments for DHS.790, Pulley:—				
28D/13477	A30/13J	Bolt , 3/8" BSF	1	—	C	
28M/13412	A24/JS	Nut , 3/8" BSF	1	—	C	
28P/9527619	SP.90/C7	Pin , split (SP.9/C8)	1	—	C	
2972	DHS.329/".62	Tube , distance	1	—	C	CE4
		Attachments for 10-20 CF 4725A, Bracket:—				
28D/16614	A59/4G	Bolt , 1/8" BSF	2	—	C	
28D/16974	A59/8G	Bolt , 1/8" BSF	2	—	C	
28M/13267	A24/GS	Nut , 1/8" BSF	4	—	C	
28P/9527619	SP.90/C7	Pin , split (SP.9/C8)	4	—	C	
28W/9419403	SP.13/G	Washer	4	—	C	
	—	BRACKET , pulley, at main spar and rib No. 3, Port, group (Drg. No. 10-20 CF 4397)	1	—	—	CE4
	10-20 CF 9937ND	BLOCK , packing (Fit to maintain clearance between pulleys and guard)	1	LFS	LM	CE4
	10-20 CF 4371A	BRACKET , pulley, Port, assembly	1	—	—	CE4
2920	10-20 CF 4373	BRACKET , bare	1	—	C	CE4
1787	DHS.797/20	PULLEY , 3" dia.	3	—	P	CE4
		Spares for:—				
2A/9501380	SKEFKO 402266	BEARING , ball (3110-99-950-1380)	1	—	C	CE4
2965	DHS.800	PLATE , retaining	1	—	C	CE4
		Attachments for DHS.800, Plate:—				
28D/9131782	AS.1242/2B	Bolt , 4 BA	3	—	C	
28M/1006504	A27/BT	Nut , 4 BA	3	—	C	
		Attachments for DHS.797/20, Pulley:—				
10333	DHS.365/20J	Bolt , 3/8" BSF	1	—	C	CE4
28M/1011476	A27/JS	Nut , 3/8" BSF	1	—	C	
28W/9419466	SP.13/J	Washer	1	—	C	
285/—	A55/B7	SCREW , grub, 4 BA	1	—	C	
		Attachments for 10-20 CF 4371, Bracket:—				
28M/1011467	A27/ES	Nut , 1/2" BSF	4	—	C	
28P/9527619	SP.90/C7	Pin , split (SP.9/C8)	4	—	C	
28W/9418921	SP.13/E	Washer	4	—	C	
	10-20 CF 4381	GUARD , cable	1	LFS.23	—	CE4
		Attachments for 10-20 CF 4381, Guard:—				
	10-20 CF 7909ND	Channel , locking, 22 SWG	1	L.72	LM	CE4
28M/10288	AGS.2001/C1	Nut , 2 BA	2	—	C	
28W/9419402	SP.13/C	Washer	2	—	C	
2921	10-20 CF 4383	STUD , mounting, pulley bracket (rear studs)	2	—	C	CE4
		Attachments for 10-20 CF 4383, Stud:—				
28M/1011475	A27/EP	Nut , 1/2" BSF	1	—	C	
28W/9418921	SP.13/E	Washer	1	—	C	

CONTROLS

FLYING CONTROLS IN WING CENTRE SECTION

Ref. No.	Part No.	Description	No. off	Material Specification	Class of Store or L.M	Plate No.
	—	BRACKET , pulley, at main spar and rib No. 3, Starboard, group (Drg. No. 10-20 CF 4717)	1	—	—	CE4
	10-20 CF 9937ND	BLOCK , packing (Fit if required to maintain 0"·05 maximum clearance between pulley and guard)	1	LFS	LM	CE4
	10-20 CF 4719A	BRACKET , pulley, assembly	1	—	—	CE4
2931	10-20 CF 4721	BRACKET , bare	1	—	C	CE4
1787	DHS.797/20	PULLEY , 3"·0 dia.	1	—	—	CE4
		Spares for :—				
2A/9501380	SKEFKO 402266	BEARING , ball (3110-99-950-1380)	1	—	C	CE4
2965	DHS.800	PLATE , retaining	1	—	C	CE4
		Attachments for DHS.800, Plate :—				
28D/9131782	AS.1242/2B	Bolt, 4 BA	3	—	C	
28M/1006504	A27/BT	Nut, 4 BA	3	—	C	
		Attachments for DHS.797/20, Pulley :—				
28D/13445	A30/11J	Bolt, 3/8" BSF	1	—	C	
28M/1011476	A27/JS	Nut, 3/8" BSF	1	—	C	
28VV/9419466	SP.13/J	Washer	2	—	C	
28S/15438	A55/B6	SCREW , grub, 4 BA	1	—	C	
		Attachments for 10-20 CF 4719A, Bracket :—				
28M/1011467	A27/ES	Nut, 1/2" BSF	4	—	C	
28P/9527619	SP.90/C7	Pin, split (SP.9/C8)	4	—	C	
28VV/9418921	SP.13/E	Washer	4	—	C	
	10-20 CF 4382	GUARD , cable	1	LFS.23	—	CE4
		Attachments for 10-20 CF 4382, Guard :—				
28M/10288	10-20 CF 7909ND	Channel, locking, 22 SWG	1	L.72	LM	CE4
28VV/9419402	AGS.2001/C/1	Nut, 2 BA	2	—	C	
	SP.13/C	Washer	2	—	C	
2921	10-20 CF 4383	STUD , mounting, pulley bracket	2	—	C	CE4
		Attachments for 10-20 CF 4383, Stud :—				
28M/1011475	A27/EP	Nut, 1/2" BSF	1	—	C	
28W/9418921	SP.13/E	Washer	1	—	C	
	DHS.725/E16	Washer, support, 16 SWG	1	DTD.746	LM	CE4
	—	BRACKET , pulley assemblies at stns. 226"·41, 227"·04 and 228"·18, Port only, group (Drg. No. 10-20 CF 1355A)	1	—	—	CE5
	10-20 CF 1469A/ND	BRACKET , pulley, for tailplane and rudder cables on main spar between rib "O" and "OA," assembly	1	—	—	CE5
2917	10-20 CF 1361	BOLT , 2 BA, cable guard at stn. 228"·18 (in-board pulleys)	1	—	C	CE5
		Attachments for 10-20 CF 1361, Bolt :—				
28M/10288	AGS.2001/C/1	Nut, 2 BA	1	—	C	
28VV/9419402	SP.13/C	Washer	1	—	C	
28D/1011025	A25/24C	BOLT , 2 BA, cable guard, at stn. 228"·18 (out-board pulleys)	1	—	C	
		Attachments for A25/24C, Bolt :—				
28M/10288	AGS.2001/C/1	Nut, 2 BA	1	—	C	
28W/9419402	AS.2809/4/200	Tube, distance, 1/2" o/d x 22 SWG x 2"·0 long	1	L.63	LM	
	SP.13/C	Washer	1	—	C	

CONTROLS

FLYING CONTROLS IN WING CENTRE SECTION

Ref. No.	Part No.	Description	No. off	Material Specification	Class of Store or L.M.	Plate No.
	10-20 CF 1829A	BRACKET , "Firestreak" heater pipe attachment, female, assembly	1	—	—	CE5
	10-20 CF 1831ND	BRACKET , bare, 22 SWG	1	S.511	LM	CE5
	10-20 CF 1833ND	TUBE , guide, $\frac{3}{8}$ " o'd \times 20 SWG \times 1'-1 long	2	T.26	LM	CE5
		Attachments for 10-20 CF 1829A, Bracket:—				
28D/9131782	AS.1242/2B	Bolt, 4 BA	4	—	C	
28M/10327	AGS.2002/B1	Nut, 4 BA	4	—	C	
8489	10-20 V 2439A	BRACKET , "Firestreak" heater pipe attachment, male, assembly	1	—	C	CE5
8487	10-20 CF 1605A	BRACKET , pulley, assembly	1	—	C	CE5
	10-20 CF 1611	EYE-BOLT , 2 BA, hinged pulley bracket	1	S.96	—	CE5
		Attachments for 10-20 CF 1611, Eye-bolt:—				
28P/1013002	SP.4Y/B9	Pin, shackle	1	—	C	
28P/9527619	SP.90/C7	Pin, split (SP.9/C8)	1	—	C	
28W/9419402	SP.13/C	Washer	1	—	C	
	10-20 CF 1379	LABEL , 22 SWG	1	L.16	—	CE5
	PARKER KALON	Attachments for 10-20 CF 1379, Label:—				
28S/9019735	Type Z	Screw, No. 4	3	—	C	
28R/13514	AS.103	PULLEY	4	—	C	CE5
		Attachments for AS.103, Pulley —				
28D/1212754	A25/17J	Bolt, $\frac{3}{8}$ " BSF (at station 226"-41)	1	—	C	
28D/1212757	A25/21J	Bolt, $\frac{3}{8}$ " BSF (at station 228"-18)	1	—	C	
28M/14833	A58/JS	Nut, $\frac{3}{8}$ " BSF	2	—	C	
28P/9527619	SP.90/C7	Pin, split (SP.9/C8)	2	—	C	
2916	10-20 CF 1467	Plate, locking	1	—	C	CE5
28W/9419466	SP.13/J	Washer	2	—	C	
28W/9419489	SP.16/J	Washer (at station 226"-41)	1	—	C	
1787	DHS.797/20	PULLEY , 3"-0 dia.	3	—	P	CE5
		Spares for:—				
2A/9501380	SKEFKO 402266	BEARING , ball (3110-99-950-1380)	1	—	C	CE5
2965	DHS.800	PLATE , retaining	1	—	C	CE5
		Attachments for DHS.800, Plate:—				
28D/9131782	AS.1242/2B	Bolt, 4 BA	3	—	C	
28M/1006504	A27/BT	Nut, 4 BA	3	—	C	
		Attachments for DHS.797/20, Pulley (per set of 3):—				
28D/1212759	A25/24J	Bolt, $\frac{3}{8}$ " BSF	1	—	C	
28M/14833	A58/JS	Nut, $\frac{3}{8}$ " BSF	1	—	C	
28P/9527619	SP.90/C7	Pin, split (SP.9/C8)	1	—	C	
2970	DHS.329"-55	Tube, distance	1	—	C	CE5
28W/9419466	SP.13/J	Washer	1	—	C	
28W/1007698	SP.14/J	Washer	1	—	C	
	AS.2809/4/103	TUBE , distance, cable guard, at station 226"-41, $\frac{1}{2}$ " o'd \times 22 SWG \times 1'-03 long	1	L.62	LM	
		Attachments for AS.2809/4/103, Tube:—				
28D/9435710	A25/11C	Bolt, 2 BA	1	—	C	
28W/9419402	SP.13/C	Washer	1	—	C	
8488	10-20 CF 1613A	WING-NUT , 2 BA, clamping hinged pulley bracket	2	—	C	CE5
		Attachments for 10-20 CF 1469A/ND, Bracket:—				
26DL/15008	A59/11E/DHS.514/D	Bolt, $\frac{1}{2}$ " BSF (Alternative S21/A59/11E)	1	—	C	
28D/1213595	A59/15E	Bolt, $\frac{1}{2}$ " BSF	1	—	C	
28D/9434873	A59/17E	Bolt, $\frac{1}{2}$ " BSF	1	—	C	
28M/1011467	A27/ES	Nut, $\frac{1}{2}$ " BSF	2	—	C	
28P/9527619	SP.90/C7	Pin, split (SP.9/C8)	2	—	C	
26FN/3275	DHS.69/DD	Shim	QR	—	C	CE5
28W/9418921	SP.13/E	Washer	2	—	C	

CONTROLS

FLYING CONTROLS IN WING CENTRE SECTION

Ref. No.	Part No.	Description	No. off	Material Specification	Class of Store or LM	Plate No.
	—	BRACKET , pulley, at outboard missile casting, aileron controls, Port and Starboard, group (Drg. No. 10-20 CF 3807)	2	—	—	CE2
	10-20 WC 9929A	BRACKET , cable duct, on aileron pulley bracket, on outboard face of outboard "Fire-streak," pylon housing, assembly	1	—	—	CE3
28M/9434251	10 WC 9931ND AGS.2008/B/1 10-20 CF 3805A/1 10-20 CF 3806A/1	BRACKET , bare, 18 SWG ... NUT , 4 BA ... BRACKET , pulley, on rib No. 4, in leading edge, Port, assembly BRACKET , pulley, on rib No. 4, in leading edge, Starboard, assembly	1 1 1 1	L.72 — — —	LM C — —	CE3 — CE2 CE2
2884	10-20 CF 3803	BRACKET , bare, Port ...	1	—	C	CE2
2885	10-20 CF 3804	BRACKET , bare, Starboard ...	1	—	C	CE2
9707	10-20 CF 8571A	GUARD , cable, Port ...	1	—	C	CE2
9708	10-20 CF 8572A	GUARD , cable, Starboard ... Attachments for 10-20 CF 8571A or 10-20 CF 8572A, Guard :—	1	—	C	CE2
4171	A25/3C/DHS.514/D	Bolt , 2 BA (Alternative S21/A25/3C) ...	2	—	C	CE2
28W/9419475	SP.15/C	Washer ...	2	—	C	—
1787	DHS.797/20	PULLEY , 3"0 dia. ... Spares for :—	1	—	P	CE2
2A/9501380	SKEFKO 402266	BEARING , ball (3110-99-950-1380) ...	1	—	C	CE2
2965	DHS.800	PLATE , retaining ... Attachments for DHS.800, Plate :—	1	—	C	CE2
28D/9131782	AS.1242/2B	Bolt , 4 BA ...	3	—	C	—
28M/1006504	A27/BT	Nut , 4 BA ... Attachments for DHS.797/20, Pulley :—	3	—	C	—
2966	DHS.901/10JJ	Bolt , 3/8" BSF ...	1	—	C	CE2
28M/13451	A29/JS	Nut , 3/8" BSF ...	1	—	C	—
28P/9527619	SP.90/C7	Pin , split (SP.9/C8) ...	1	—	C	—
28W/9419477	SP.15/J	Washer ... Attachments for 10-20 CF 3805A/1 or 10-20 CF 3806A/1, Bracket :—	1	—	C	—
28D/1212204	A57/4E	Bolt , 1/2" BSF, forward ...	2	—	C	—
28D/1008151	A25/4E	Bolt , 1/2" BSF, aft ...	2	—	C	—
28M/1011467	A27/ES	Nut , 1/2" BSF ...	4	—	C	—
28P/9527619	SP.90/C7	Pin , split (SP.9/C8) ...	4	—	C	—
28W/9419405	SP.15/E	Washer ...	4	—	C	—
	—	BRACKET , pulley, for undercarriage, wing-fold and rudder controls, Starboard only, group (Drg. No. 10-20 CF 1321)	1	—	—	CE6
	10-20 CF 7079A/ND	BRACKET , pulley, on main spar at rib "OA," assembly	1	—	—	CE6
9576	10-20 CF 7065	BRACKET , bare ...	1	—	C	CE6
2926	10-20 CF 1319	GUARD , cable, 2"75 long ...	1	—	C	CE6
9577	10-20 CF 7519	GUARD , cable, 1"55 long ... Attachments for 10-29 CF 1319 or 10-20 CF 7519, Guard :—	1	—	C	CE6
28M/10281	AGS.2001/C/3	Nut , 2 BA ...	1	—	C	—
28W/9419475	SP.15/C	Washer ...	1	—	C	—

CONTROLS

FLYING CONTROLS IN WING CENTRE SECTION

Ref. No.	Part No.	Description	No. off	Material Specification	Class of Store or L.M	Place No.
28R/13514	10-20 CF 1601	LABEL , 20 SWG	1	L.16	—	CE6
	10-20 CF 1603	LABEL , 20 SWG	1	L.16	—	CE6
	AS.103	PULLEY , 2" dia.	4	—	C	CE6
		Attachments for AS.103, Pulley (per pair) :—				
28M/1011476	A27/JS	Nut, 3/8" BSF	2	—	C	
28P/9527619	SP.90/C7	Pin, split (SP.9/C8)	2	—	C	
2928	10-20 CF 1317	Spindle, undercarriage pulleys	1	—	C	CE6
2927	10-20 CF 1315	Spindle, wing-fold pulleys	1	—	C	CE6
28W/9419477	SP.15/J	Washer	2	—	C	
1787	DHS.797/20	PULLEY , 3" dia.	1	—	P	CE6
		Spares for :—				
2A/9501380	SKEFKO 402266	BEARING , ball (3110-99-950-1380)	1	—	C	CE6
2965	DHS.800	PLATE , retaining	1	—	C	CE6
		Attachments for DHS.800, Plate :—				
28D/9131782	AS.1242/2B	Bolt, 4 BA	3	—	C	
28M/1006504	A27/BT	Nut, 4 BA	3	—	C	
		Attachments for DHS.797/20, Pulley :—				
28D/1213576	A60/18J	Bolt, 3/8" BSF	1	—	—	
28M/1011476	A27/JS	Nut, 3/8" BSF	1	—	C	
28P/9527619	SP.90/C7	Pin, split (SP.9/C8)	1	—	C	
28W/9419466	SP.13/J	Washer	1	—	C	
		Attachments for 10-20 CF 7079A/ND, Bracket :—				
28D/1011242	A25/7E	Bolt, 1/4" BSF	1	—	C	
28D/—	A59/20G	Bolt, 3/16" BSF	1	—	C	
28D/1213443	A59/32G	Bolt, 3/16" BSF	1	—	C	
28M/1011467	A27/ES	Nut, 1/4" BSF	1	—	C	
28M/7002431	AGS.2002/G/1	Nut, 3/16" BSF	1	—	C	
28M/13122	A27/GS	Nut, 3/16" BSF	1	—	C	
28P/9527619	SP.90/C7	Pin, split (SP.9/C8)	2	—	C	
28W/9419405	SP.15/E	Washer	1	—	C	
28W/9419476	SP.15/G	Washer	1	—	C	
	—	BRACKET , pulley, front spar, rib "OA," Port and Starboard, group (Drg. Nos. 10-20 CF 8471, 10-20 CF 8473, 10-20 WC 2821A/1 and 10-20 WC 2822A/1)	1	—	—	CE1
	10-20 CF 9977A	BRACKET , "P" clip, air speed indicator pipe, at aileron control pulley bracket, Port, assembly	1	—	—	CE1
	10-20 CF 9978A	BRACKET , "P" clip, air speed indicator pipe, at aileron control pulley bracket, Starboard, assembly	1	—	—	CE1
	10-20 CF 9975ND	BRACKET , bare, Port, 18 SWG	1	L.72	LM	CE1
	10-20 CF 9976ND	BRACKET , bare, Starboard, 18 SWG	1	L.72	LM	CE1
28M/9144673	AGS.2019/C/1	NUT , 2 BA	1	—	C	
10753	10-20 CF 8467	BRACKET , pulley, aileron control, Port	1	—	C	CE1
		Attachments for 10-20 CF 8467, Bracket :—				
2897	10-20 WC 13525	Bolt, socket	1	—	C	CE1
28M/1011475	A27/EP	Nut, 1/4" BSF	2	—	C	
28M/1007403	A27/ET	Nut, 1/4" BSF	1	—	C	
	10-20 WC 25207	Stud	1	S.96	—	CE1
	10-20 WC 25209	Stud	1	S.96	—	CE1
28W/9419405	SP.15/E	Washer	2	—	C	
28W/9419487	SP.16/E	Washer	1	—	C	

CONTROLS

FLYING CONTROLS IN WING CENTRE SECTION

Ref. No.	Part No.	Description	No. off	Material Specification	Class of Store or L.M.	Plate No.
9701	10-20 CF 8469	BRACKET , aileron control pulley, Starboard ...	1	—	C	CE1
		Attachments for 10-20 CF 8469, Bracket :—				
5146	10-20 WC 10311	Bolt, socket ...	1	—	C	CE1
28M/1011475	A27/EP	Nut, 1/2" BSF ...	2	—	C	
	10-20 WC 25207	Stud ...	2	S.96	—	CE1
28W/9419405	SP.15/E	Washer ...	2	—	C	
9702	10-20 CF 8493	GUARD , cable, pulley bracket on front spar ...	1	—	C	CE1
		Attachment for 10-20 CF 8493, Guard :—				
28M/10288	AGS.2001/C/1	Nut, 2 BA ...	1	—	C	
28W/9419402	SP.13/C	Washer ...	1	—	C	
1787	DHS.797/20	PULLEY , aileron cables on front spar, assembly	2	—	P	CE1
		Spares for :—				
2A/9501380	SKEFKO 402266	BEARING , ball (3110-99-950-1380) ...	1	—	C	CE1
2965	DHS.800	PLATE , retaining ...	1	—	C	CE1
		Attachments for DHS.800, Plate :—				
28D/9131782	AS.1242/2B	Bolt, 4 BA ...	3	—	C	
28M/1006504	A27/BT	Nut, 4 BA ...	3	—	C	
		Attachments for DHS.797/20, Pulley :—				
28M/14833	A58/JS	Nut, 3/8" BSF ...	1	—	C	
28P/9527619	SP.90/C7	Pin, split (SP.9/C8) ...	1	—	C	
28W/9419466	SP.13/J	Washer ...	1	—	C	
2895	10-20 CF 1573	STUD , pulley spindle, on front spar ...	1	—	C	CE1
		Attachments for 10-20 CF 1573, Stud :—				
28M/14833	A58/JS	Nut, 3/8" BSF ...	1	—	C	
28P/9527619	SP.90/C7	Pin, split (SP.9/C8) ...	1	—	C	
28W/9419466	SP.13/J	Washer ...	1	—	C	
	—	BRACKET , pulley, rear stub boom diaphragm, Port,	1	—	—	CE4
		group (Drg. No. 10-20 CF 4399)				
	10-20 CF 4375A	BRACKET , pulley, on aft face of diaphragm, Port,	1	—	—	CE4
		assembly				
2924	10-20 CF 4389	BOLT , special, cable guard ...	1	—	C	CE4
2923	10-20 CF 4387	BOLT , special, pulley spindle ...	1	—	C	CE4
2922	10-20 CF 4377A	BRACKET , pulley, assembly ...	1	—	C	CE4
2971	DHS.790	PULLEY , 4" dia. ...	3	—	P	CE4
		Spares for :—				
2A/9501471	SKEFKO 401458	BEARING , ball (3110-99-950-1471) ...	1	—	C	CE4
2969	DHS.793	PLATE , retaining ...	1	—	C	CE4
		Attachments for DHS.793, Plate :—				
28D/9709461	AS.1242/3C	Bolt, 2 BA ...	3	—	C	
28M/1006473	A27/CT	Nut, 2 BA ...	3	—	C	
		Attachments for 10-20 CF 4375A, Bracket :—				
28D/1215684	A59/SE	Bolt, 1/2" BSF (Lock to DHS.514/D) ...	4	—	C	
28W/9419405	SP.15/E	Washer ...	4	—	C	
	—	BRACKET , pulley, rear stub boom diaphragm, Star-	1	—	—	CE4
		board, group (Drg. No. 10-20 CF 4707)				
	10-20 CF 4709A	BRACKET , pulley, on aft face of diaphragm, Star-	1	—	—	CE4
		board, assembly				
2933	10-20 CF 4715	BOLT , 2 BA, cable guard ...	1	—	C	CE4
	10-20 CF 1837A	BRACKET , pulley, assembly ...	1	—	—	CE4
		(For Spares use 10-20 CF 9517A/ND)				
12601	10-20 CF 9517A/ND	BRACKET , pulley, assembly (Spares condition)	1	—	C	

CONTROLS

FLYING CONTROLS IN WING CENTRE SECTION

Ref. No.	Part No.	Description	No. off	Material Specification	Class of Store or L.M	Plate No.
2971	DHS.790	PULLEY , 4" dia.	1	—	P	CE4
		Spares for :—				
2A/9501471	SKEFKO 401458	BEARING , ball (3110-99-950-1471)	1	—	C	CE4
2969	DHS.793	PLATE , retaining, 16 SWG	1	—	C	CE4
		Attachments for DHS.793, Plate :—				
28D/9709461	AS.1242/3C	Bolt, 2 BA	3	—	C	
28M/1006473	A27/CT	Nut, 2 BA	3	—	C	
		Attachments for DHS.790, Pulley :—				
2932	10-20 CF 4713	Bolt, 3/8" BSF	1	—	C	CE4
		Attachments for 10-20 CF 4709A, Bracket :—				
28D/1215683	A59/4E	Bolt, 1/2" BSF (Lock to DHS.514/D)	2	—	C	
28D/1215684	A59/5E	Bolt, 1/2" BSF (Lock to DHS.514/D)	2	—	C	
28W/9419405	SP.15/E	Washer	4	—	C	
11509	10-20 CF 5219A	CABLE , aileron balance, joint in leading edge to joint under R.H. side of rear cockpit floor, Port, assembly (Pre Mod. 655)	1	—	C	CE7
		Spares for :—				
28X/3514	—	CABLE , bare, 15 cwt.	QR	—	C	
28U/16591	SP.36/C15L	END , tapped, 2 BA, L.H.	2	—	C	
16275	10-20 CF 5281A	CABLE , aileron balance, joint in leading edge to joint under R.H. side of rear cockpit floor, Port, assembly (Mod. 655)	1	—	C	CE7
		Spares for :—				
28X/3514	—	CABLE , bare, 15 cwt.	QR	—	C	
	10-20 CF 8669	END , plain	1	S.93	—	CE7
28U/16591	SP.36/C15L	END , tapped, 2 BA, L.H.	1	—	C	
		Attachments for 10-20 CF 5219A or 10-20 CF 5281A, Cable :—				
28M/1006473	A27/CT	Nut, 2 BA	1	—	C	
28M/13253	A27/CTL	Nut, 2 BA, L.H. thread	1	—	C	
28U/14789	SP.35/C	Rod, tensioner	1	—	C	
12779	10-20 CF 5235A	CABLE , aileron balance, joint in leading edge to joint under R.H. side of rear cockpit floor, Starboard, assembly	1	—	C	CE7
		Spares for :—				
28X/3514	—	CABLE , bare, 15 cwt.	QR	—	C	
28U/16591	SP.36/C15L	END , tapped, 2 BA, L.H.	1	—	C	
28U/16590	SP.36/C15	END , tapped, 2 BA, R.H.	1	—	C	
		Attachments for 10-20 CF 5235A, Cable :—				
28M/1006473	A27/CT	Nut, 2 BA	1	—	C	
28M/13253	A27/CTL	Nut, 2 BA, L.H. thread	1	—	C	
28U/14789	SP.35/C	Rod, tension	1	—	C	
11507	10-20 CF 5223A	CABLE , aileron, in leading edge, rib No. 3 to wing-fold, forward, Starboard, assembly	2	—	C	CE7
		Spares for :—				
28X/3514	—	CABLE , bare, 15 cwt	QR	—	C	
	10-20 CF 8669	END , plain	1	S.93	—	CE7
28U/16590	SP.36/C15	END , tapped, 2 BA, R.H.	1	—	C	
		Attachments for 10-20 CF 5223A, Cable :—				
28M/1006473	A27/CT	Nut, 2 BA	1	—	C	
28M/13253	A27/CTL	Nut, 2 BA, L.H. thread	1	—	C	
28U/14789	SP.35/C	Rod, tension	1	—	C	
11506	10-20 CF 5225A	CABLE , aileron, in leading edge, rib No. 3 to wingfold, rear, assembly (Pre Mod. 655)	2	—	C	CE7

CONTROLS

FLYING CONTROLS IN WING CENTRE SECTION

Ref. No.	Part No.	Description	No. off	Material Specification	Class of Store or LM	Plate No.
16276	10-20 CF 5283A	CABLE , aileron, in leading edge, between ribs No. 1 and 2 to wing fold, rear, assembly (Mod. 655) Spares for :-	2	—	C	CE7
28X/3514	—	CABLE , bare, 15 cwt.	QR	—	C	
28U/16591	10-20 CF 8671 SP.36/C15L	END , plain END , tapped, 2 BA, L.H.	1 1	S.93 —	— C	CE7
28M/1006473	A27/CT	Nut, 2 BA	1	—	C	
28M/13253	A27/CTL	Nut, 2 BA, L.H. thread	1	—	C	
28U/14789	SP.35/C	Rod, tension	1	—	C	
11508	10-20 CF 5217A	CABLE , aileron, joint in leading edge to joint under rear cockpit floor, assembly (Mod. 148, Pre Mod. 655) Spares for :-	1	—	C	CE7
28X/3514	—	CABLE , bare, 15 cwt.	QR	—	C	
28U/16591	SP.36/C15L	END , tapped, 2 BA, L.H.	1	—	C	
28U/16590	SP.36/C15	END , tapped, 2 BA, R.H.	1	—	C	
16277	10-20 CF 5285A	CABLE , aileron, in leading edge to joint under cockpit floor, Port, assembly (Mod. 655) Spares for :-	1	—	C	CE7
28X/3514	—	CABLE , bare, 15 cwt.	QR	—	C	
28U/16590	SP.36/C15	END , tapped, 2 BA	2	—	C	
28M/1006473	A27/CT	Nut, 2 BA	1	—	C	
28M/13253	A27/CTL	Nut, 2 BA, L.H. thread	1	—	C	
28U/14789	SP.35/C	Rod, tension	1	—	C	
13925	10-20 CF 5275A	CABLE , aileron, joint in leading edge to joint under rear cockpit floor, Starboard, assembly	1	—	C	
28X/3514	—	CABLE , bare, 15 cwt.	QR	—	C	
28U/16590	SP.36/C15	END , tapped, 2 BA	1	—	C	
28U/16591	SP.36/C15L	END , tapped, 2 BA, L.H.	1	—	C	
28M/1006473	A27/CT	Nut, 2 BA	1	—	C	
7042	10-20 CF 5161A	CABLE , flap "Down," Port, assembly	1	—	C	
7043	10-20 CF 5163A	CABLE , flap "Down," Starboard, assembly	1	—	C	
28X/3450	—	CABLE , bare, 25 cwt.	QR	—	C	
28U/—	SP.36/E25	END , tapped, 1/4" BSF	1	—	C	
28U/17822	SP.37/E	EYE-END , 1/4" dia.	1	—	C	
7044	10-20 CF 5167A	CABLE , flap "Up," Port, assembly	1	—	C	
7045	10-20 CF 5169A	CABLE , flap "Up," Starboard, assembly	1	—	C	
28X/3452	—	CABLE , bare, 45 cwt.	QR	—	C	
28U/—	SP.36/G45	END , tapped, 5/16" BSF	1	—	C	
28U/—	SP.37/G	EYE-END , 5/16" dia.	1	—	C	
2949	10-20 CF 5127A	CABLE , rudder, beam joint to joint between rib "O" and "OA," Port, assembly	1	—	C	CE13
28X/3514	—	CABLE , bare, 15 cwt.	QR	—	C	
28U/15280	SP.34/C15	END , screwed, 2 BA	1	—	C	
28U/15287	SP.37/C	EYE-END	1	—	C	
28P/829	SP.4Y/B3	Pin, shackle	2	—	C	
28P/9527619	SP.90/C7	Pin, split (SP.9/C8)	2	—	C	
2952	10-20 CF 5125A	CABLE , rudder, beam joint, to joint between rib "O" and "OA," Starboard, assembly	1	—	C	CE13

CONTROLS

FLYING CONTROLS IN WING CENTRE SECTION

Ref. No.	Part No.	Description	No. off	Material Specification	Class of Store or L.M	Place No.
28X/3514	—	CABLE , bare, 15 cwt.	QR	—	C	
28U/15282	SP.34/C15L	END , screwed, 2 BA, L.H.	1	—	C	
28U/15280	SP.34/C15	END , screwed, 2 BA... ..	1	—	C	
28M/1006473	A27/CT	Attachments for 10-20 CF 5125A. Cable :—				
28M/13253	A27/CTL	Nut, 2 BA	1	—	C	
28U/14790	SP.33 C	Nut, 2 BA, L.H. thread	1	—	C	
		Turnbarrel, 2 BA	1	—	C	
2950	10-20 CF 5145A	CABLE , tailplane, boom joint, to joint on rib No. 2 in wheel bay, Port only, assembly	1	—	C	CE13
28X/3514	—	CABLE , bare, 15 cwt.	QR	—	C	
28U/1204116	SP.38/C	FORK-END	1	—	C	
10804	10-20 CF 5213A	CABLE , tailplane, joint on main spar to joint between rib "O" and "OA" (Port only), assembly	1	—	C	CE13
10803	10-20 CF 5211A	CABLE , tailplane, joint on rib No. 2 in wheel bay, to joint between rib "O" and "OA" (Port only), assembly	1	—	C	CE13
28X/3514	—	CABLE , bare, 15 cwt.	QR	—	C	
28U/15287	SP.37/C	EYE-END	1	—	C	
28U/1204116	SP.38/C	FORK-END	1	—	C	
		Attachments for 10-20 CF 5213A or 10-20 CF 5211A, Cables :—				
28P/829	SP.4Y/B3	Pin, shackle	2	—	C	
28P/9527619	SP.90/C7	Pin, split (SP.9-C8)	2	—	C	
2951	10-20 CF 5147A	CABLE , tailplane, joint on rib No. 2 in wheel bay, to boom joint (Port only), assembly	1	—	C	CE13
28X/3514	—	CABLE , bare, 15 cwt.	QR	—	C	
28U/—	SP.36, E15L	END , tapped, L.H.	1	—	C	
28U/15287	SP.37/C	EYE-END	1	—	C	
	10-20 CF 9815A	CHAIN , complete with cables, elevator and flap inter-connecting in Port boom, assembly	1	—	—	CE9
	10-20 CF 9816A	CHAIN , complete with cables, elevator and flap inter-connecting in Starboard boom, assembly	1	—	—	CE9
9570	10-20 CF 5155A	CABLE , assembly	1	—	C	CE9
9571	10-20 CF 5153A	CABLE , assembly	1	—	C	CE9
15030	10-20 CF 9814A	CHAIN , sprocket, Port, assembly... ..	1	—	C	CE9
15029	10-20 CF 9813A	CHAIN , sprocket, Starboard, assembly	1	—	C	CE9
28M/12931	A27/ET	NUT , 1/2 BSF	1	—	C	
28M/13454	A27/ETL	NUT , 1/2 BSF, L.H. thread	1	—	C	
	—	ELECTRICAL COMPONENTS (See sub-section EAM)	—	—	—	
20274	10-20 CF 1291	GUARD , cable, on spectacle beam	4	—	C	CE6
		Attachments for 10-20 CF 1291, Guard :—				
28M/10288	AGS.2001/C/1	Nut, 2 BA	2	—	C	
28W/9419402	SP.13/C	Washer	2	—	C	
	—	MECHANISM , flap operating on rib "O." group (Drg. No. 10-20 CF 1439)	1	—	—	CE8
	10-20 CF 607A	BRACKET , pulley, on spectacle beam, lower, assembly	1	—	—	CE3
		Spares for :—				
	10-20 CF 613	GUARD , conical	1	L.64	—	CE3 CE6
		Attachments for 10-20 CF 613, Guard :—				
28M/10288	AGS.2001/C/1	Nut, 2 BA	1	—	C	
28W/9419402	SP.13/C	Washer	1	—	C	

CONTROLS

FLYING CONTROLS IN WING CENTRE SECTION

Ref. No.	Part No.	Description	No. off	Material Specification	Class of Score or LM	Plate No.
	AS.2811/5/065	GUARD , plain, tube, $\frac{1}{16}$ " o/d \times 17 SWG \times 0"-65 long	2	L.62	LM	CE3
28D/1215666	A59/10C	Attachments for AS.2811/5/065, Guard :—				
28M/10288	AGS.2001/C/1	Bolt, 2 BA	1	—	C	
28W/9419402	SP.13/C	Nut, 2 BA	1	—	C	
		Washer	2	—	C	
7010	10-20 CF 1435A	PULLEY , assembly	2	—	P	CE3
		Spares for :—				
2A/9501471	SKEFKO 401458	BEARING , ball (3110-99-950-1471)	1	—	C	CE3
		Attachments for 10-20 CF 1435A, Pulley :—				
28M/1011476	A27/JS	Nut, $\frac{3}{8}$ " BSF	1	—	C	
28P/9527619	SP.90/C7	Pin, split (SP.9/C8)	1	—	C	
		Spindle	1	S.96	—	CE3
26DL/7341	DHS.34/F	Washer	2	—	C	
		SPINDLE , 2 BA	1	S.1	—	CE3
		Attachments for 10-20 CF 615, Spindle :—				
28M/10288	AGS.2001/C/1	Nut, 2 BA	1	—	C	
28W/9419402	SP.13/C	Washer	1	—	C	
		Attachments for 10-20 CF 607A, Bracket :—				
28D/13046	A25/19E	Bolt, $\frac{1}{8}$ " BSF	1	—	C	
28D/14522	A25/23E	Bolt, $\frac{1}{8}$ " BSF	1	—	C	
28D/—	AS.1244/35G	Bolt, $\frac{3}{16}$ " BSF	1	—	C	
11727	DHS.358/19E	Bolt, $\frac{1}{8}$ " BSF	1	—	C	
28M/1011475	A27/EP	Nut, $\frac{1}{8}$ " BSF	2	—	C	
28M/1006939	A27/GP	Nut, $\frac{3}{16}$ " BSF	1	—	C	
28M/7002430	AGS.2002/E/1	Nut, $\frac{1}{8}$ " BSF	1	—	C	
28W/9418921	SP.13/E	Washer	3	—	C	
28W/9419403	SP.13/G	Washer	1	—	C	
		BRACKET , pulley, on spectacle beam, upper, assembly	1	—	—	CE3 CE8
		Spares for :—				
7009	10-20 CF 603A	BRACKET , pulley, assembly	1	—	P	CE3
	10-20 CF 629	GUARD , cable	1	L.64	LM	CE3
		Attachments for 10-20 CF 629, Guard :—				
28D/1011019	A25/8C	Bolt, 2 BA (Lock to DHS.514/D)	1	—	C	
28W/9419402	SP.13/C	Washer	1	—	C	
10551	DHS.777/C2	Washer, packing	QR	—	C	CE3
5632	DHS.784/45	PULLEY	2	—	C	CE3
		Spares for :—				
2A/9501483	SKEFKO 401458/C1	BEARING , ball (3110-99-950-1483)	1	—	C	CE3
2969	DHS.793	PLATE , retaining	1	—	C	CE3
		Attachments for DHS.793, Plate :—				
28D/9709461	AS.1242/3C	Bolt, 2 BA	3	—	C	
28M/1006473	A27/CT	Nut, 2 BA	3	—	C	
		Attachments for DHS.784/45, Pulley :—				
28M/1011476	A27/JS	Nut, $\frac{3}{8}$ " BSF	1	—	C	
28P/9527619	SP.90/C7	Pin, split (SP.9/C8)	1	—	C	
		Spindle, $\frac{3}{8}$ " BSF	1	S.96	—	CE3
		Attachments for 10-20 CF 609A, Bracket :—				
28D/9133208	A25/20E	Bolt, $\frac{1}{8}$ " BSF	1	—	C	
28D/14522	A25/23E	Bolt, $\frac{1}{8}$ " BSF	1	—	C	
28D/1212594	A25/33E	Bolt, $\frac{1}{8}$ " BSF	1	—	C	
28D/—	AS.1244/35G	Bolt, $\frac{3}{16}$ " BSF	1	—	C	
28M/1011475	A27/EP	Nut, $\frac{1}{8}$ " BSF	3	—	C	
28M/1006939	A27/GP	Nut, $\frac{3}{16}$ " BSF	1	—	C	
28W/9418921	SP.13/E	Washer	1	—	C	
28W/7000392	SP.14/E	Washer	2	—	C	
28W/9419403	SP.13/G	Washer	1	—	C	

CONTROLS

FLYING CONTROLS IN WING CENTRE SECTION

Ref. No.	Part No.	Description	No. off	Material Specification	Class of Store or L.M.	Plate No.
	10-20 CE 4691A	BRACKET , pulley, on spectacle beam, ram air turbine cable, Port lower, assembly (Mod. 216) Spares for :—	1	—	—	CE3
16087	10-20 CE 4673A AS.2809/4/045	BRACKET , pulley GUARD , cable, tube, $\frac{1}{4}$ " o/d x 22 SWG x 0"-45 long Attachments for AS.2809/4/045, Guard :—	1 1	— L.62	C LM	CE3 CE3
28D/9133013	A25/5C	Bolt, 2 BA	1	—	C	
28M/10328	AGS.2002/C/1	Nut, 2 BA	1	—	C	
28W/9419475	SP.15/C	Washer	1	—	C	
28R/13502	AS.111	PULLEY Attachments for AS.111, Pulley :—	1	—	P	CE3
28D/1011242	A25/7E	Bolt, $\frac{1}{4}$ " BSF	1	—	C	
28M/13935	A58/ES	Nut, $\frac{1}{4}$ " BSF	1	—	C	
28P/9527619	SP.90/C7	Pin, split (SP.9/C8)	1	—	C	
28W/9418921	DHS.330/"-20 SP.13/E	Tube, distance, 0"-374 o/d x 0"-25 i/d x 0"-2 long	1	DTD.423	LM	CE3
28W/9418920	SP.10/E	Washer, spacing Washer	1 1	— —	C C	
4157	DHS.365/21E	Attachments for 10-20 CE 4691A, Bracket :—				
28D/1011029	A25/1E	Bolt, $\frac{1}{4}$ " BSF	1	—	C	CE3
28M/1011475	A27/EP	Bolt, $\frac{1}{4}$ " BSF	2	—	C	
28W/7000392	SP.14/E	Nut, $\frac{1}{4}$ " BSF Washer	3 3	— —	C C	

CONTROLS

FLYING CONTROLS IN WING CENTRE SECTION

Ref. No.	Part No.	Description	No. off						Material Specification	Class of Store or L.M.	Plate No.
			1	2	3	4	5	6			
16088	10-20 WC 29949A	COUPLING , swivel, on spectacle beam, assembly (Mod. 216) Attachments for 10-20 WC 29949A, Coupling :—						1	—	C	CE6
28D/12571	A25/21E	Bolt, 1/2" BSF						1	—	C	CE6
4157	DHS.365/21E	Bolt, 1/2" BSF						1	—	C	
28M/1011475	A27/EP	Nut, 1/2" BSF						2	—	C	
28W/7000392	SP.14/E	Washer						2	—	C	
12558	10-20 WC 27065A	COVER , flap pulley, assembly Attachments for 10-20 WC 27065A, Cover :—						1	—	C	CE8
28D/9436920	A25/1C	Bolt, 2 BA						4	—	C	CE8
	10-20 WC 27067ND	Washer, support, 18 SWG						4	S.510	—	
	—	ELECTRICAL COMPONENTS (See sub-section EAM)						—	—	—	
	—	GUARD , cable, flap operating pulley, bottom, group (Drg. No. 10-20 CF 7911)						1	—	—	
11726	10-20 CF 7913ND	GUARD Attachments for 10-20 CF 7913ND, Guard :—						1	—	C	CE6
28D/9453970	A25/15C	Bolt, 2 BA						2	—	C	CE6
28M/10288	AGS.2001/C/1	Nut, 2 BA						2	—	C	
28W/9419402	SP.13/C	Washer						2	—	C	
	—	GUARD , cable, flap operating pulley, top, group (Drg. No. 10-20 CF 993)						1	—	—	
7016	10-20 CF 997ND	GUARD Attachments for 10-20 CF 997ND, Guard :—						1	—	C	CE6
28D/1200119	A25/4C	Bolt, 2 BA						2	—	C	CE6
28M/10288	AGS.2001/C/1	Nut, 2 BA						2	—	C	
	10-20 CF 995ND	Packing 1/2" thick x 1/2" wide x 2"-0 long						1	DTD.363	LM	
28W/9419402	SP.13/C	Washer						2	—	C	
7011	10-20 CF 631	GUARD , cable, between pulleys on spectacle beam (Starboard only) Attachments for 10-20 CF 631, Guard :—						2	—	C	CE6
4406	A25/16C/DHS.514/D	Bolt, 2 BA (Alternative S21/A25/16C)						1	—	C	
	—	HYDRAULIC COMPONENTS (See sub-section QR)						—	—	—	
6A/2134	—	INDICATOR , flap position Attachments for Ref. No. 6A/2134, Indicator :—						1	—	P	
28D/9436920	A25/1C	Bolt, 2 BA						4	—	C	CE8
28M/10288	AGS.2001/C/1	Nut, 2 BA						4	—	C	
7025	10-20 CF 1785A	LEVER , flap servo, inboard, assembly Spares for :—						1	—	P	CE8
2A/9500462	—	BEARING , ball (3110-99-950-0462) Attachments for 10-20 CF 1785A, Lever :—						1	—	C	
28D/9140645	A25/10C	Bolt, 2 BA						1	—	C	CE8
28M/10288	AGS.2001/C/1	Nut, 2 BA						1	—	C	
28W/9419402	SP.13/C	Washer						1	—	C	
7024	10-20 CF 1781A	LEVER , flap servo, outboard, assembly Spares for :—						1	—	P	CE8
28N/13511	HOFFMANN CJ.1	JOINT , self aligning Attachments for 10-20 CF 1781A, Lever :—						1	—	C	
28D/9140644	A25/9C	Bolt, 2 BA						1	—	C	CE8
28M/10288	AGS.2001/C/1	Nut, 2 BA						1	—	C	
28W/9419402	SP.13/C	Washer						1	—	C	
	10 CF 2581	LEVER , flap transmitter, 12 SWG Attachments for 10 CF 2581, Lever :—						1	L.72	—	CE8
28D/9436920	A25/1C	Bolt, 2 BA (Lock to DHS.514/D)						1	—	C	

CONTROLS

FLYING CONTROLS IN WING CENTRE SECTION

Ref. No.	Part No.	Description	No. off	Material Specification	Class of Store or L.M	Plate No.
	10-20 CF 9095A	LINK , intermediate, flap transmitter, assembly ...	1	—	—	
	10-20 CF 9097ND	LINK , bare, 18 SWG ...	1	S.510	LM	CE8
	10-20 CF 3003ND	PIN , $\frac{1}{16}$ " dia. ...	1	S.92	LM	CE8
		Attachments for 10-20 CF 9095A, Link :—				
28P/9527619	SP.90/C7	Pin, split (SP.9/C8) ...	1	—	C	
28W/9419402	SP.13/C	Washer ...	1	—	C	
	10-20 CF 9091A	LINK , intermediate (slotted) flap, transmitter, assembly	1	—	—	
	10-20 CF 9093ND	LINK , bare, 18 SWG ...	1	S.510	LM	CE8
	10-20 CF 3003ND	PIN , $\frac{1}{16}$ " dia. ...	1	S.92	LM	CE8
		Attachments for 10-20 CF 9091A, Link :—				
28D/9436920	A25/1C	Bolt, 2 BA ...	2	—	C	
28M/10288	AGS.2001/C/1	Nut, 2 BA ...	2	—	C	
28P/9527619	SP.90/C7	Pin, split (SP.9/C8) ...	2	—	C	
28W/9419402	SP.13/C	Washer ...	3	—	C	
	10-20 CF 1523A/ND	PULLEY , fly operating, forward of spectacle beam (Port side only)	1	—	—	CE8
7012	10 CF 2291A	PULLEY , assembly ...	1	—	P	CE8
		Spares for :—				
	10 CF 2293	DISC , wheel, 20 SWG ...	1	L.72	—	CE8
		Attachments for 10 CF 2293, Disc :—				
28D/1203083	A25/3J	Bolt, $\frac{3}{8}$ " BSF ...	1	—	C	
28M/1007404	A27/JT	Nut, $\frac{3}{8}$ " BSF ...	1	—	C	
	10-20 CF 1583	FITTING , cable attachment ...	1	L.65	—	CE8
	10 CF 2367A	FITTING , control, assembly ...	1	—	—	CE8
		Spares for :—				
28M/9435069	AGS.2008/G/1	NUT , anchor, $\frac{1}{8}$ " BSF ...	12	—	C	
7013	10 CF 2403	FITTING , rim end ...	1	—	C	CE8
	10 CF 2323	PLATE , joint, bottom, 14 SWG ...	1	L.73	—	CE8
	10 CF 2451	PLATE , joint, bottom, 16 SWG ...	1	L.73	—	CE8
	10 CF 2325	PLATE , joint, top, 14 SWG ...	1	L.73	—	CE8
	10 CF 2453	PLATE , joint, top, 16 SWG ...	1	L.73	—	CE8
7014	10 CF 2993	PLATE , link, bottom ...	1	—	C	CE8
7015	10 CF 2995	PLATE , link, top ...	1	—	C	CE8
		Attachments for 10 CF 2993 and 10 CF 2995, Plates (per pair) :—				
3249	DHS.365/10E	Bolt, $\frac{3}{8}$ " BSF ...	2	—	C	CE8
5175	DHS.365/10G	Bolt, $\frac{1}{4}$ " BSF ...	1	—	C	CE8
28M/1011467	A27/ES	Nut, $\frac{1}{4}$ " BSF ...	2	—	C	
28M/5808571	A27/GS	Nut, $\frac{3}{16}$ " BSF ...	1	—	C	
28P/9527619	SP.90/C7	Pin, split (SP.9/C8) ...	3	—	C	
	10 CF 2371	PLATE , reinforcing, 16 SWG ...	1	DTD.687	—	CE8
	10 CF 2455ND	RIM , half (Make from Standard section J.861)	2	—	—	CE8
17358	10 CF 3383A	SPINDLE , torque, assembly ...	1	—	C	CE8
		Attachments for 10 CF 3383A, Spindle :—				
28D/1011256	A25/5G	Bolt, $\frac{1}{4}$ " BSF ...	12	—	C	
7041	10 WC 4995	RING , sealing, pulley spindle, $\frac{1}{16}$ " thick ...	1	—	C	CE8
	10 CF 2585	RING , spacing, pulley, spindle ...	1	S.1	—	CE8
7026	10-20 CF 941A	ROD , connecting, at flap jack, assembly ...	1	—	P	CE8
	10-20 CF 933A	FORK-END , assembly ...	1	—	—	CE8
		Spares for :—				
4060	10-20 CE 1377	BUSH (See Repair section, PA) ...	1	—	C	CE8
28M/1007403	A27/ET	NUT , $\frac{1}{4}$ " BSF ...	1	—	C	

CONTROLS

FLYING CONTROLS IN WING CENTRE SECTION

Ref. No.	Part No.	Description	No. off	Material Specification	Class of Store or L.M.	Place No.
28D/1008145	A25/6E	Attachments for 10-20 CF 941A, Rod :-				
7027	10-20 CF 939	Bolt, 1/4" BSF	1	—	C	
28M/13121	A27/CS	Bolt, special, 2 BA	1	—	C	CE8
28M/1011467	A27/ES	Nut, 2 BA	1	—	C	
28P/9527619	SP.90/C7	Nut, 1/4" BSF	1	—	C	
	10-20 CF 1509ND	Pin, split (SP.9/C8)	2	—	C	
		Tube, distance, 0"-3123-0"-3119 o/d x 0"-25 i/d x 0"-30 long	1	T.26 or S.96	LM	CE8
28W/9418921	SP.13/E	Washer	1	—	C	
	10-20 CF 9523A	ROD , connecting, complete with crank, flap operating, assembly	1	—	—	CE8
28N/9129579	AGS.2031/6	CIRCLIP	1	—	C	
13156	10-20 CF 9521	CRANK , flap drive	1	—	P	CE8
	10 CF 3223	PIN , crank	1	S.96	—	CE8
7020	10 CF 3209A	ROD , connecting, assembly	1	—	P	CE8
		Spares for :-				
7021	10 CF 3213	BUSH (See Repair section PA)	4	—	C	CE8
28N/9156370	SP.21	NIPPLE , lubrication	1	—	C	CE8
28S/13722	A55/CS	SCREW , grub, 2 BA	2	—	C	
	10 CF 3215	STUD	1	S.1	—	CE8
		Attachments for 10 CF 3215, Stud :-				
28M/1007403	A27/ET	Nut, 1/4" BSF	1	—	C	
7022	10 CF 3225	SPOOL	1	—	C	CE8
7019	10 CF 3219	SPRING	1	—	C	CE8
	10 CF 3221	TUBE , spacing anchorage, 7/16" o/d x 1"-68 long, 17 SWG	1	L.63	—	CE8
		Attachments for 10-20 CF 9523A, Rod :-				
7023	10 CF 2579	Nut, retaining (Lock to DHS.514/D)	1	—	C	CE8
7035	10-20 CF 507A	ROD , radius, assembly	1	—	P	CE8
	10-20 CF 1577A	EYE-END , assembly	1	—	—	CE8
		Spares for :-				
7036	10 CF 3331	BUSH (See Repair section PA)	1	—	C	CE8
	10-20 CF 8539	PLATE , retaining, 10 SWG	1	S.514	—	CE8
		Attachments for 10-20 CF 8539, Plate :-				
28D/1007975	AS.1242/1C	Bolt, 2 BA	1	—	C	
		Attachments for 10-20 CF 507A, Rod :-				
9128	10-20 CF 8541	Bolt, end	1	—	C	CE8
7037	10-20 CF 1519A	Bolt, special, 3/4" BSF, assembly	1	—	C	CE8
		Spares for :-				
28N/9156370	SP.21	Nipple, lubrication	1	—	C	CE8
28M/13590	A27/SS	Nut, 3/4" BSF	1	—	C	
9127	10-20 CF 8537	Pin, knuckle	1	—	C	CE8
28P/20027	SP.9/H12	Pin, split (SP.9/H14)	1	—	C	
7038	10 CF 3381	Sleeve, headed	2	—	C	CE8
28W/9419494	SP.16/S	Washer	1	—	C	
18941	DHS.783/45/20	Washer, special	2	—	C	CE8

CONTROLS

FLYING CONTROLS IN WING CENTRE SECTION

Ref. No.	Part No.	Description	No. off	Material Specification	Class of Score or L/M	Plate No.
	10-20 CF 1429	SHAFT , control, flap servo mechanism ...	1	S.1	—	CE8
		Attachments for 10-20 CF 1429, Shaft :—				
28M/1011476	A27/JS	Nut, 3/8" BSF ...	1	—	C	
28P/9527619	SP.90/C7	Pin, split (SP.9 C8) ...	1	—	C	
28W/9419466	SP.13/J	Washer ...	1	—	C	
7028	10-20 CF 1949A	STRUT , spring, flap control, assembly ...	1	—	P	CE5 CE8
	10-20 CF 1951A	BARREL , assembly ...	1	—	—	CE5
7029	10-20 CF 1969	Attachments for 10-20 CF 1951A, Barrel :— Nut, special ...	1	—	C	CE5
28R/13509	HOFFMANN CM.2B	BEARING , rod end, 1/8" BSF ...	1	—	C	
		Attachments for CM.2B, Bearing :—				
28M/1011470	A27/GT	Nut, 3/8" BSF (Lock to DHS.514/D) ...	1	—	C	
	10-20 CF 1953	FORK-END ...	1	L.65	—	CE5
	10-20 CF 1967	NUT , lock, special ...	1	S.92	—	CE5
7031	10-20 CF 1955	GUIDE , spring ...	1	—	C	CE5
	10-20 CF 1957	SHAFT , control, assembly ...	1	—	—	CE5
	10-20 CF 1069	FITTING , eye-end ...	1	S.93	—	CE5
7030	10-20 CF 1965	GUIDE , spring ...	1	—	C	CE5
	10-20 CF 1961	PLUG , end ...	1	S.92	—	CE5
	10-20 CF 1067	SLEEVE , stop, inner ...	1	S.93	—	CE5
	10-20 CF 1963	SLEEVE , stop, outer ...	1	S.92	—	CE5
	10-20 CF 1959	TUBE , 1/8" o d x 17 SWG ...	1	T.35	—	CE5
		Attachments for 10-20 CF 1957, Shaft :—				
28M/13121	A27/CS	Nut, 2 BA ...	1	—	C	
28P/9527619	SP.90/C7	Pin, split (SP.9 C8) ...	1	—	C	
	DHS781:8 18	Washer, special ...	1	S.510	—	CE5
7032	10-20 CF 1499	SPRING , 13 SWG ...	1	—	C	CE5
		Attachments for 10-20 CF 1949A, Strut :—				
7033	10-20 CF 1089	Bolt, special, 2 BA ...	1	—	C	CE8
28M/13121	A27/CS	Nut, 2 BA ...	2	—	C	
28P/9527619	SP.90/C7	Pin, split (SP.9 C8) ...	2	—	C	
7034	10-20 CF 1087	Tube, distance ...	1	—	C	CE8
2971	DHS.790	PULLEY , cable, at intersection of rib No. 1 and spectacle beam, lower, assembly	2	—	P	CE9
5632	DHS.784/45	PULLEY , cable, at intersection of rib No. 1 and spectacle beam, upper, assembly Spares for :—	2	—	C	CE9
2A/9501471	—	BEARING , ball (Required for DHS.790, Pulley) ... (3110-99-950-1471)	1	—	C	CE9
2A/9501483	—	BEARING , ball (Required for DHS.784 45 Pulley) ... (3110-99-950-1483)	1	—	C	CE9
2969	DHS.793	PLATE , retaining, 16 SWG ...	1	—	C	CE9
		Attachments for DHS.793, Plate :—				
28D/9709461	AS.1242/3C	Bolt, 2 BA ...	3	—	C	
28M/1006473	A27/CT	Nut, 2 BA ...	3	—	C	
		Attachments for DHS.790 and DHS.784/45, Pulleys (per pair) :—				
	10-20 CF 1907	Bolt, 3/8" BSF ...	1	S.96	—	CE9
28M/13825	A24 GC	Nut, 3/8" BSF ...	1	—	C	
28P/9527619	SP.90/C7	Pin, split (SP.9 C8) ...	1	—	C	
28W/9419403	SP.13 G	Washer ...	1	—	C	

CONTROLS

FLYING CONTROLS IN WING, CENTRE SECTION

Ref. No.	Part No.	Description	No. off	Material Specification	Class of Store or L.M	Plate No.
14031	10-20 CF 9647A	PULLEY , cable, on spectacle beam, assembly ...	4	—	P	CE9
2A/9500417	—	Spares for :— BEARING , ball (3110-99-950-0417) ...	1	—	C	
	10-20 CF 9607	PLATE , retaining, 16 SWG ...	1	L.72	LM	
28S/1200060	A33/A16	Attachments for 10-20 CF 9607, Plate :— Screw, 6 BA ...	3	—	C	
	10-20 CF 1217	Attachments for 10-20 CF 967A, Pulley :—				
28M/1011476	A27/JS	Bolt, special, 3/8" BSF ...	1	S.96	—	CE9
28P/9527619	SP.90/C7	Nut, 3/8" BSF ...	1	—	C	
	10 CF 2419	Pin, split (SP.9/C8) ...	1	—	C	
28W/9419466	SP.13/J	Tube, distance ...	1	L.64	LM	CE9
	—	Washer ...	1	—	C	
	10-20 CF 1325A	PULLEY , rudder, at station 199"-38, Port only, group (Drg. No. 10-20 CF 1403)	1	—	—	
	10798	BRACKET , rudder pulley, between rib "O" and "OA," assembly	1	—	—	CE6
	10-20 CF 1327	BRACKET , bare ...	1	—	C	CE6
	10-20 CE 2365	GUARD ...	1	S.1	—	CE6
	28M/5808573	Attachments for 10-20 CE 2365, Guard :—				
	28P/9527619	Nut, 2 BA ...	1	—	C	
	28W/9419402	Pin, split (SP.9/C8) ...	1	—	C	
	1787	Washer ...	1	—	C	
	DHS.797/20	PULLEY , 3"-0 dia. ...	1	—	P	CE6
	28M/1011467	Attachments for DHS.797/20, Pulley :—				
	28P/9527619	Nut, 1" BSF ...	1	—	C	
	28W/9418921	Pin, split (SP.9/C8) ...	1	—	C	
	10799	Washer ...	1	—	C	
	10-20 CF 1329	SPIGOT ...	1	—	C	CE6
	28M/1011475	Attachments for 10-20 CF 1329, Spigot :— Nut, 1" BSF ...	1	—	C	
	28D/9133012	Attachments for 10-20 CF 1325A, Bracket :—				
	28M/5808573	Bolt, 2 BA ...	4	—	C	
	28P/9527619	Nut, 2 BA ...	4	—	C	
	28W/9419402	Pin, split (SP.9/C8) ...	4	—	C	
	—	Washer ...	4	—	C	
	27K/—	REGULATOR , cable tension, at rib No. 4, aileron controls, Port and Starboard, group (Drg. No. 10-20 CF 9217)	1	—	—	
	27K/—	BRACKET , mounting, Port, assembly ... (Mod. 512) (Pre Mod. 603)	1	—	—	CE7
	27K/1617	BRACKET , mounting, Starboard, assembly ... (Mod. 512) (Pre Mod. 603)	1	—	—	CE7
	27K/1618	BRACKET , mounting, Port, assembly ... (Mod. 603) (Pre Mod. 882)	1	—	P	CE7
	27K/1876	BRACKET , mounting, Starboard, assembly ... (Mod. 603) (Pre Mod. 882)	1	—	P	CE7
	27K/1875	BRACKET , mounting, Port, assembly (Mod. 882) ...	1	—	P	CE7
	27K/1875	BRACKET , mounting, Starboard, assembly ... (Mod. 882)	1	—	P	CE7
	2873	GUARD , cable, at regulator on rib No. 4, Port ...	1	—	C	CE7
	2874	GUARD , cable, at regulator on rib No. 4, Starboard ...	1	—	C	CE7
	1216977	Attachments for 10-20 CF 3585 or 10-20 CF 3586, Guard :—				
	28W/9419402	Bolt, 2 BA (Alternative S21/A25/3C) ...	2	—	C	
		Washer ...	2	—	C	

CONTROLS

FLYING CONTROLS IN WING CENTRE SECTION

Ref. No.	Part No.	Description	No. off	Material Specification	Class of Score or L.M	Plate No.
28P/9527619	SP.90/C7	PIN , split, aileron cable stop, on tension regulator (SP.9/C8)	2	—	C	
27K/—	TELEFLEX E.72399	REGULATOR , cable tension, Port (Pre Mod. 512)	1	—	—	CE7
27K/1615	TELEFLEX E.72979	REGULATOR , cable tension, Port (Mod. 512)...	1	—	P	CE7
27K/—	TELEFLEX E.72400	REGULATOR , cable tension, Starboard... (Pre Mod. 512)	1	—	—	CE7
27K/1616	TELEFLEX E.72980	REGULATOR , cable tension, Starboard... (Mod. 512)	1	—	P	CE7
		Attachments for E.72399, E.72400, E.72979 or E.72980, Regulator :—				
28D/1011240	A25/5E	Bolt, 1/4" BSF	2	—	C	
28D/1008145	A25/6E	Bolt, 1/4" BSF	2	—	C	
28M/1011467	A27/ES	Nut, 1/4" BSF	2	—	C	
28P/9527619	SP.90/C7	Pin, split (SP.9/C8)	2	—	C	
26FC/6726	DHS.69/D	Shim	4	—	C	CE7
	10-20 CF 9837	Washer, special, 12 SWG (Mod. 751) (Pre Mod. 839) (Required if flange is less than 0".25 thick)	3	S.511	LM	CE7
	10-20 CF 9839	Washer, special, 12 SWG (Mod. 751) (Pre Mod. 839) (Required if flange is less than 0".25 thick)	1	S.511	LM	CE7
	10-20 CF 10101	Washer, special, 12 SWG (Mod. 839) (Pre Mod. 882) (Required if flange is less than 0".25 thick)	4	S.511	LM	CE7
16659	10-20 CF 3447A	SHAFT , torque, between track No. 3 and rib No. 4, assembly	2	—	C	CE9
	10-20 CF 9549A	SHAFT , torque, inner, between gear box No. 1 and 2, assembly	2	—	—	CE9
		Attachments for 10-20 CF 9549A, Shaft :—				
28D/1011244	A25/9E	Bolt, 1/4" BSF	1	—	C	
28M/1011467	A27/ES	Nut, 1/4" BSF	1	—	C	
28P/9527619	SP.90/C7	Pin, split (SP.9/C8)	1	—	C	
	10-20 CF 3435A	SHAFT , torque, lower inboard, between gear box No. 2 and track No. 3, assembly (For spares use 10-20 CF 10223A/ND)	2	—	—	CE9
18869	10-20 CF 10223A/ND	SHAFT , torque, lower inboard, between gear box No. 2 and track No. 3, assembly (Spares condition) Spares for :—	2	—	P	
2A/9500423	—	BEARING , ball (3110-99-950-0423)	1	—	C	
		Attachments for Ref. No. 2A/9500423, Bearing :—				
7007	10-20 CF 3439	Nut, retaining	1	—	C	CE9
28P/19399	SP.90/G18	Pin, split (SP.9/G20)	1	—	C	
26DL/7078	DHS.94/6/165	PIN , ground steel, 3/16" dia.	2	S.96	C	CE9
	10-20 CF 3441A	SLEEVE , assembly	1	—	—	CE9
	10-20 CF 3437	SPROCKET	1	L.65	—	CE9
		Attachments for 10-20 CF 3437, Sprocket :—				
28D/1011248	A59/16E	Bolt, 1/4" BSF	2	—	—	
28M/1011467	A27/ES	Nut, 1/4" BSF	2	—	—	
28P/9527619	SP.90/C7	Pin, split (SP.9/C8)	2	—	C	
28W/14183	AS.1903/E12	Washer, saddle	2	—	C	
		Attachments for 10-20 CF 3435A, Shaft :—				
28D/9434872	A59/18E	Bolt, 1/4" BSF	2	—	C	
28M/1011467	A27/ES	Nut, 1/4" BSF	2	—	C	
28P/9527619	SP.90/C7	Pin, split (SP.9/C8)	2	—	C	
28W/14184	AS.1903/E14	Washer, saddle	2	—	C	

FLYING CONTROLS IN WING CENTRE SECTION

Ref. No.	Part No.	Description	No. off	Material Specification	Class of Score or LM	Plate No.
19383	10-20 CF 3567A	SHAFT , torque, upper outboard, between gear box No. 2 and rib No. 4, assembly Spares for :—	2	—	P	CE9
7005	10-20 CF 3571A	SPROCKET , assembly	1	—	P	CE9
	—	SHROUD , cable, in wheel well. Port, group (Drg. No. 10-20 CF 5303)	1	—	—	CE10
	10-20 CF 5353	BRACKET , attachment, at intersection of arch rib No. 2 and main spar Attachments for 10-20 CF 5353, Bracket :—	1	L.72	LM	CE10
28D/9133011	A25/2C	Bolt, 2 BA	2	—	C	
28M/5808573	A27/CS	Nut, 2 BA	2	—	C	
	10-20 CF 5375	Packing, 12 SWG	1	L.72	LM	CE10
28P/9527619	SP.90/C7	Pin, split (SP.9/C8)	2	—	C	
28W/9419402	SP.13/C	Washer	2	—	C	
2939	10-20 CF 5337A	SHROUD , for cables along main spar, between rib No. 3 and arch rib No. 2, assembly Spares for :—	1	—	P	CE10
2938	10-20 CF 5369	HINGE , half	1	—	C	CE10
2940	10-20 CF 5425	HINGE , half, at arch rib No. 2 Attachments for 10-20 CF 5425, Hinge :—	1	—	C	CE10
28D/15988	AS.4565-4C	Bolt, 2 BA	2	—	C	
28M/13324	A29/CP	Nut, 2 BA	2	—	C	
28W/9419402	SP.13/C	Washer	2	—	C	
	10-20 CF 5367	PACKING , piece, 10 SWG	1	L.72	LM	CE10
	10-20 CF 5341ND	PACKING , piece, 0"3 thick	1	L.64	—	CE10
		Attachments for 10-20 CF 5337A, Shroud :—				
28D/7002428	A25/6C	Bolt, 2 BA	1	—	C	
28D/9140647	A25/14C	Bolt, 2 BA	1	—	C	
28M/5808573	A27/CS	Nut, 2 BA	2	—	C	
28P/9527619	SP.90/C7	Pin, split (SP.9/C8)	2	—	C	
16393	10-20 CF 10121A	SHROUD , for cables along rib No. 3, centre portion, forward, assembly (Mod. 868) Spares for :—	1	—	P	CE10
2936	10-20 CF 5325ND	HINGE , half	1	—	C	CE10
	10-20 CF 5321ND	PACKING , under hinge, 14 SWG	1	L.72	LM	CE10
	10-20 CF 5323ND	STIFFENER , hinge, 18 SWG	1	L.72	LM	CE10
		Attachments for 10-20 CF 10121A, Shroud :—				
28D/9140647	A25/14C	Bolt, 2 BA, hinge pivot at pulley shroud	1	—	C	
28M/10288	AGS.2001/C/1	Nut, 2 BA	3	—	C	
28W/9419402	SP.13/C	Washer	2	—	C	
	10-20 CF 10131A	SHROUD , for cables along rib No. 3, centre portion, rear, assembly (Mod. 868) (For Spares use 10-20 CF 10207A/ND)	1	—	—	CE10
16394	10-20 CF 10207A/ND	SHROUD , for cables along rib No. 3, centre portion, rear, assembly (Mod. 868) (Spares condition) Attachments for 10-20 CF 10131A, Shroud :—	1	—	C	
28D/9133011	A25/2C	Bolt, 2 BA	2	—	C	
28M/10288	AGS.2001/C/1	Nut, 2 BA	2	—	C	
26FC/2036	DHS.69/CC	Shim	QR	—	C	CE10
9485	10-20 CF 5307A	SHROUD , pulley, at intersection of rib No. 3, centre portion and main spar, assembly Spares for :—	1	—	P	CE10
2937	10-20 CF 5423	HINGE , half	1	—	C	CE10

CONTROLS

FLYING CONTROLS IN WING CENTRE SECTION

Ref. No.	Part No.	Description	No. of						Material Specification	Class of Store or L.M	Plate No.
			1	2	3	4	5	6			
2938	10-20 CF 5369	HINGE , half						1	—	C	CE10
	10-20 CF 5367	PACKING , piece, under hinge, 10 SWG ...						1	L.72	LM	CE10
	10-20 CF 5313ND	PACKING , under hinge, 10 SWG ...						1	L.72	LM	CE10
		Attachments for 10-20 CF 5307A, Shroud :—									
28D/1011024	A25/21C	Bolt, 2 BA						1	—	C	
28M/10288	AGS.2001/C/1	Nut, 2 BA						1	—	C	
28P/9527619	SP.90/C7	Pin, split (through pulley bolt) (SP.9/C8) ...						1	—	C	
28W/9419402	SP.13/C	Washer						1	—	C	
	—	SHROUD , cable, in wheel well, Starboard, group ...						1	—	—	CE10
		(Drg. No. 10-20 CF 5305)									
	10-20 CF 5353	BRACKET , attachment at intersection of arch rib						1	L.72	LM	CE10
		No. 2 and main spar, 16 SWG									
		Attachments for 10-20 CF 5353, Bracket :—									
28D/9133011	A25/2C	Bolt, 2 BA						2	—	C	
28M/5808573	A27/CS	Nut, 2 BA						2	—	C	
	10-20 CF 5375	Packing, 12 SWG						1	L.72	LM	CE10
28P/9527619	SP.90/C7	Pin, split (SP.9/C8)						2	—	C	
28W/9419402	SP.13/C	Washer						2	—	C	
2941	10-20 CF 5345A	SHROUD , for cables along main spar, between rib						1	—	P	CE10
		No. 3 and arch rib No. 2, assembly									
		Spares for :—									
2942	10-20 CF 5427	HINGE , half (arch rib No. 2)						1	—	C	CE10
		Attachments for 10-20 CF 5427, Hinge :—									
28D/15903	AS.4565/5C	Bolt, 2 BA						2	—	C	
28M/13324	A29/CP	Nut, 2 BA						2	—	C	
	10-20 CF 5349ND	Packing, 3/8" thick						1	L.64	LM	CE10
28W/9419402	SP.13/C	Washer						2	—	C	
2943	10-20 CF 5373	HINGE , half						1	—	C	CE10
	10-20 CF 5371	PACKING , 10 SWG						1	L.72	LM	CE10
		Attachments for 10-20 CF 5345A, Shroud :—									
28D/7002428	A25/6C	Bolt, 2 BA						2	—	C	
28M/5808573	A27/CS	Nut, 2 BA						2	—	C	
28P/9527619	SP.90/C7	Pin, split (SP.9/C8)						2	—	C	
16395	10-20 CF 10115A	SHROUD , for cables along rib No. 3, centre						1	—	P	CE10
		portion, forward, assembly									
		(Mod. 868)									
2943	10-20 CF 5373	HINGE , half						1	—	C	CE10
	10-20 CF 5371	PACKING , 10 SWG						1	L.72	LM	CE10
		Attachments for 10-20 CF 10115A, Shroud :—									
28D/7002428	A25/6C	Bolt, 2 BA						1	—	C	
28M/10288	AGS.2001/C/1	Nut, 2 BA						3	—	C	
28W/9419402	SP.13/C	Washer						2	—	C	
	10-20 CF 10132A	SHROUD , for cables along rib No. 3, centre						1	—	—	CE10
		portion, rear, assembly (Mod. 868)									
		(For spares use 10-20 CF 10208A/ND)									
16396	10-20 CF 10208A/ND	SHROUD , for cables along rib No. 3, centre						1	—	P	
		portion, rear, assembly (Mod. 868)									
		(Spares condition)									
		Attachments for 10-20 CF 10132A, Shroud :—									
28D/9133011	A25/2C	Bolt, 2 BA						2	—	C	
28M/10288	AGS.2001/C/1	Nut, 2 BA						2	—	C	
26FC/2036	DHS.69/CC	Shim						QR	—	C	CE10

CONTROLS

FLYING CONTROLS IN WING CENTRE SECTION

Ref No.	Part No.	Description	No. off	Material Specification	Class of Store or L.M	Place No.
18528	10-20 CF 10195A	SHROUD , pulley, at intersection of rib No. 3 (Centre portion) and main spar, assembly Spares for :—	1	—	P	CE10
2944	10-20 CF 5365 10-20 CF 5363	HINGE , half PACKING , 10 SWG	2 2	— L.72	C LM	CE10 CE10
28D/9435710	A25/11C	Attachments for 10-20 CF 10195A, Shroud :— Bolt, 2 BA	1	—	C	
28M/10288	AGS.2001/C/1	Nut, 2 BA	1	—	C	
28P/9527619	SP.90/C7	Pin, split (through pulley bolt) (SP.9/C8)	1	—	C	
28W/9419402	SP.13/C	Washer	1	—	C	
—	—	TRACK , flap. No. 1, Port and Starboard, group ... (Drg. No. 10-20 WF 3)	1	—	—	
10-20 WC 16849	10-20 WC 16849	BRACKET , mounting, gear box, forward end, Port, assembly	1	—	—	CE9
10-20 WC 16850	10-20 WC 16850	BRACKET , mounting, gear box, forward end, Starboard, assembly	1	—	—	CE9
10-20 WC 16845	10-20 WC 16845	BRACKET , mounting, Port, 18 SWG ...	1	L.72	LM	CE9
10-20 WC 16846	10-20 WC 16846	BRACKET , mounting, Starboard, 18 SWG ...	1	L.72	LM	CE9
10-20 WC 16847	10-20 WC 16847	BRACKET , support, Port, 18 SWG ...	1	L.72	LM	CE9
10-20 WC 16848	10-20 WC 16848	BRACKET , support, Starboard, 18 SWG ...	1	L.72	LM	CE9
19106	10-20 CF 7537A/2	CHAIN AND BOGIE , Port, assembly ...	1	—	P	CE11
19107	10-20 CF 7538A/2	CHAIN AND BOGIE , Starboard, assembly ...	1	—	P	CE11
2A/9500419	—	BEARING , ball (3110-99-950-0419) ...	2	—	C	
6915	10-20 CF 4519	BOLT , special	1	—	C	CE11
6907	10 CF 2191A/ND	CHAIN , assembly Spares for :— CONNECTOR , L.H. thread	1	S.1	—	
20521	AS.168/2	Attachments for 10 CF 2191A/ND, Chain :— Bolt, nut and split pin, assembly	1	—	C	
6910	10 CF 2193A/ND	CHAIN , assembly Spares for :— CONNECTOR , R.H. thread	1	S.1	—	CE11
20521	AS.168/2	Attachments for 10 CF 2193A/ND, Chain :— Bolt, nut and split pin, assembly	1	—	C	
28FP/1091	DZUS Type A6	CIRCLIP	1	—	C	CE11
16311	10 CF 2107	CONNECTOR Attachments for 10 CF 2107, Connector :— Bolt, special, 2 BA	1	—	C	CE11
6908	10 CF 3123	Nut, special, 2 BA	1	—	C	CE11
6909	10 CF 3139	Nut, special, 2 BA	1	—	C	CE11
28P/9527619	SP.90/C7	Pin, split (SP.9/C8)	1	—	C	
28N/13513	HOFFMANN CJ.5	JOINT , ball	1	—	C	CE11
9505	10-20 WF 1059A	LINK , swinging, Port	1	—	P	CE11
9506	10-20 WF 1060A	LINK , swinging, Starboard Spares for :— BUSH	1	—	P	CE11
6924	10 WF 457	Attachments for 10-20 WF 1059A or 10-20 WF 1060A, Link :— Nut, cap, assembly	2	—	C	CE11
14275	10-20 WF 1399A	Nipple, lubricating	1	—	C	CE11
28N/8156370	SP.21	Nut, cap, bare, $\frac{3}{16}$ " BSF	1	S.92	—	CE11
28P/9527619	SP.90/C7	Pin, split (SP.9/C8)	1	—	C	
6923	10 WF 381	Washer, special	1	—	C	CE11

CONTROLS

FLYING CONTROLS IN WING CENTRE SECTION

Ref. No.	Part No.	Description	1 2 3 4 5 6						No. off	Material Specification	Class of Store or L.M	Place No.
			16272	10-20 WF 37	PILLAR , ball joint							
6919	10 CF 2119	PLATE , cover						1	—	C	CE11	
6917	10 CF 3121	PLATE , side, bogie, inner						1	—	C	CE11	
6918	10 CF 2113	PLATE , side, bogie, outer						1	—	C	CE11	
17781	10 CF 2197	ROD , tension						1	—	C	CE11	
		Attachments for 10 CF 2197, Rod :—										
6908	10 CF 3123	Bolt, special, 2 BA						1	—	C	CE11	
6909	10 CF 3139	Nut, special, 2 BA						1	—	C	CE11	
28P/9527619	SP.90/C7	Pin, split (SP.9/C8)						1	—	C		
28U/14789	SP.35/C	ROD , tie						1	—	C		
		Attachments for SP.35/C, Rod :—										
28M/1006473	A27/CT	Nut, 2 BA						1	—	C		
28M/13253	A27/CTL	Nut, 2 BA, L.H.						1	—	C		
6912	10 CF 2153	ROLLER						1	—	C	CE11	
6916	10 CF 2115A	SEAL , moulded rubber, assembly						1	—	C	CE11	
6913	10 CF 2117	SPACER						1	—	C	CE11	
6914	10-20 WF 39	WASHER , serrated						1	—	C	CE11	
20190	AS.252/81P	CHAIN , driving						2	—	C	CE9	
		Attachments for AS.252/81P, Chain :—										
28M/1007403	A27/ET	Nut, 1/2" BSF						1	—	C		
28M/13454	A27/ETL	Nut, 1/2" BSF, L.H.						2	—	C		
28M/1011470	A27/GT	Nut, 3/8" BSF						1	—	C		
28U/15632	SP.35/E	Rod, tension						1	—	C		
9812	10-20 CF 8853	Rod, tension						1	—	C	CE9	
	10 CF 2345	FAIRLEAD , Port, 1"0 thick						1	LFS.23	—	CE9	
	10 CF 2346	FAIRLEAD , Starboard, 1"0 thick						1	LFS.23	—	CE9	
		Attachments for 10 CF 2345 or 10 CF 2346, Fair-lead :—										
28D/1011466	A26/3C	Bolt, 2 BA						2	—	C		
28M/9403520	A27/CP	Nut, 2 BA						2	—	C		
28W/9419454	SP.10/C	Washer						2	—	C		
6886	10 CF 267A	GEARBOX , Port, assembly (Pre Mod. 1060)						1	—	P	CE12	
6887	10 CF 268A	GEARBOX , Starboard, assembly (Pre Mod. 1060)						1	—	P	CE12	
16781	10-20 CF 10209A	GEARBOX , Port, assembly (Mod. 1060)						1	—	P	CE12	
16782	10-20 CF 10210A	GEARBOX , Starboard, assembly (Mod. 1060)						1	—	P	CE12	
		Spares for :—										
2A/9400419	—	BEARING , ball (3110-99-940-0419)						2	—	C		
2A/9500422	—	BEARING , ball (3110-99-950-0422)						2	—	C		
6888	10 CF 1149	BOLT , special, 2 BA						2	—	C	CE12	
6899	10 CF 261	COVER , universal joint (Pre Mod. 1060)						1	—	C	CE12	
6898	10 CF 3419A	GEAR-WHEEL , assembly						1	—	C	CE12	
6894	10 CF 251	GUARD , chain						2	—	C	CE12	
6895	10 CF 253	GUARD , chain						2	—	C	CE12	
		Attachments for 10 CF 251 or 10 CF 253, Guard :—										
28D/1011029	A25/1E	Bolt, 1/2" BSF						1	—	C		
6891	10 CF 245	HOUSING , bearing						2	—	C	CE12	
		Attachments for 10 CF 245, Housing :—										
6892	10 CF 1151	Bolt, special, 2 BA						2	—	C	CE12	
28M/10328	AGS.2002/C/1	Nut, 2 BA						2	—	C		
28W/9419475	SP.15/C	Washer						2	—	C		
6889	10 CF 1143	Washer, special						2	—	C	CE12	

CONTROLS

FLYING CONTROLS IN WING CENTRE SECTION

Ref. No.	Part No.	Description	No. off						Material Specification	Class of Score or LM	Place No.
			1	2	3	4	5	6			
6900	10 CF 231A	JOINT , universal, assembly Spares for :—						1	—	C	CE12
	10 CF 225	ADAPTER						1	L.65	—	CE12
	10 CF 433A	JOINT , universal Attachments for 10 CF 433A, Joint :—						1	—	—	CE12
	10 CF 233	Rivet, special						2	S.80	—	CE12
6890	10 CF 257	RING , sealing, 0"-125 thick						2	—	C	CE12
6893	10 CF 255	RING , sealing, 0"-125 thick						2	—	C	CE12
	10 CF 5903	VENT , breather, assembly						1	—	—	CE12
6889	10 CF 1143	WASHER , special Attachments for 10 CF 267A, 10 CF 268A, 10-20 CF 10209A or 10-20 CF 10210A, Gear-box :—						2	—	C	CE12
28D/1212313	A25/15E	Bolt, 1/8" BSF						1	—	C	
28D/1011261	A25/15G	Bolt, 1/8" BSF						1	—	C	
28D/1212388	A25/16G	Bolt, 3/16" BSF						1	—	C	
28M/7002430	AGS.2002/E/1	Nut, 1/8" BSF						1	—	C	
28M/7002431	AGS.2002/G/1	Nut, 3/16" BSF						2	—	C	
	10-20 CF 1293	GUARD , chain, bottom, 10 SWG						2	L.72	LM	CE13
	10-20 CF 1135	GUARD , chain, top, 10 SWG Attachments for 10-20 CF 1293 or 10-20 CF 1135, Guard (per pair) :—						2	L.64	LM	CE13
28D/1011022	A25/18C	Bolt, 2 BA						1	—	C	
6901	10 CF 1063	SPROCKET , driving, at gear-box						2	—	C	CE12
6902	10 CF 1067	SPROCKET , operating at gear-box Attachments for 10 CF 1063 or 10 CF 1067, Sprocket (per pair) :—						2	—	C	CE12
6905	A25/29E/DHS.514/D	Bolt, 1/8" BSF (Alternative S21/A25/29E)						1	—	C	CE12
6903	10 CF 1057	Cap, serrated						1	—	C	CE12
6904	10 CF 1053A	Cap, serrated, assembly						1	—	C	CE12
11933	10-20 CF 9327	Shim, .22 SWG						QR	—	C	CE12
6906	10 CF 2241A	SPROCKET , rear, assembly Spares for :—						2	—	—	CE9
2A/9500412	SKEFKO CBS.3	BEARING , ball (3110-99-950-0412) Attachments for 10 CF 2241A, Sprocket :—						1	—	C	
28M/13122	A27/GS	Nut, 3/16" BSF						1	—	C	
28P/9527619	SP.90/C7	Pin, split (SP.9/C8)						1	—	C	
28W/9419455	SP.10/G	Washer						1	—	C	
	—	TRACK , flap No. 2, Port and Starboard, group (Drg. No. 10-20 WF 5)						1	—	—	
19546	10-20 CF 10281A	BOGIE , corque track, assembly (Mod. 1401)						2	—	P	CE14
6944	10 CF 2791A	CARRIAGE , bogie, assembly Spares for :—						1	—	P	CE14
6945	10 CF 2795	SPIGOT						4	—	C	CE14
28N/15373	HOFFMANN CJ.7	JOINT , ball						1	—	C	CE14
16270	10 WF 557	PILLAR , ball joint Attachments for 10 WF 557, Pillar :—						1	—	C	CE14
6947	10 WF 563	Bolt, special, 1/8" BSF						1	—	C	CE14
28M/13267	A24/GS	Nut, 5/16" BSF						1	—	C	
6948	10 WF 565	Washer						1	—	C	CE14

CONTROLS

FLYING CONTROLS IN WING CENTRE SECTION

Ref. No.	Part No.	Description	No. off	Material Specification	Class of Score or L.M	Plate No.
6929	10 CF 2229	PLATE , cover, 16 SWG	1	—	C	CE14
6946	10 CF 3137	Attachments for 10 CF 2229, Plate :— Screw, special, 4 BA	4	—	C	CE14
6932	10 CF 2225	PLUG	1	—	C	CE14
6930	10 CF 2163A	ROLLER , assembly	4	—	C	CE14
2A/9500415	SKEFKO CBS.4	Spares for :— BEARING , ball (3110-99-950-0415)	1	—	C	
19548	10-20 CF 10263	Attachments for 10 CF 2163A, Roller :— Axle (Mod. 1401)	1	—	C	CE14
19547	10-20 CF 10261	Bolt, special, 1/2" BSF (Mod. 1401)	1	—	C	CE14
28P/19231	SP.90/C13	Pin, split (SP.9/C14)	1	—	C	
28W/1011085	SP.11/N	Washer	2	—	C	
6916	10 CF 2115A	SEAL , moulded	1	—	C	CE14
19544	10-20 CF 10275A	CHAIN AND BOGIE , Port, assembly (Mod. 1401)	1	—	P	CE11
19545	10-20 CF 10276A	CHAIN AND BOGIE , Starboard, assembly (Mod. 1401)	1	—	P	CE11
19548	10-20 CF 10263	AXLE , bogie (Mod. 1401)	2	—	C	CE11
19547	10-20 CF 10261	Attachments for 10-20 CF 10263, Axle :— Bolt, special, 1/2" BSF (Mod. 1401)	2	—	C	CE11
28P/19231	SP.90/C13	Pin, split (SP.9 C14)	2	—	C	
6933	10 CF 2227	BOLT , special, 1/2" BSF	1	—	C	CE11
6931	10 CF 3009	CARRIAGE , bogie	1	—	C	CE11
6926	10-20 CF 5665A ND	CHAIN , assembly	1	—	C	CE11
20207	AS.168/4	Attachments for 10-20 CF 5665A ND, Chain :— Nut, bolt and split pin, assembly	1	—	C	
20194	AS.927/91P	CHAIN	1	—	C	
20207	AS.168/4	Attachments for AS.927/91P, Chain :— Nut, bolt and split pin, assembly	1	—	C	
28N/15373	HOFFMANN CJ.7	JOINT , ball	1	—	C	CE11
17388	10-20 WF 4043A	LEVER , adjustable, Port, assembly (Mod. 1191)	1	—	C	CE11
17389	10-20 WF 4044A	LEVER , adjustable, Starboard, assembly (Mod. 1191)	1	—	C	CE11
28N/9156370	SP.21	Spares for :— NIPPLE , grease	1	—	C	CE11
28M/9512070	A27/EC	Attachments for 10-20 WF 4043A or 10-20 WF 4044A, Lever :—				
28P/9527619	SP.90/C7	Nut, 1/2" BSF	1	—	C	
		Pin, split (SP.9 C8)	1	—	C	
6929	10 CF 2229	PLATE , cover, 16 SWG	1	—	C	CE11
	10 CF 2231	Attachments for 10 CF 2229, Plate :— Screw, special, 4 BA (Make from Part No. A31.B32, Ref. No. 28S 1200039-Drill No. 58)	4	S.1	LM	CE11
6932	10 CF 2225	PLUG	1	—	C	CE11
11932	10-20 CF 9307	ROD , tension	1	—	C	CE11
28M/1006473	A27/CT	Attachments for 10-20 CF 9307, Rod :—				
28M/13253	A27/CTL	Nut, 2 BA	1	—	C	
		Nut, 2 BA, L.H. thread	1	—	C	

CONTROLS

FLYING CONTROLS IN WING CENTRE SECTION

Ref. No.	Part No.	Description	No. off	Material Specification	Class of Store or L.M.	Place No.
6930	10 CF 2163A	ROLLER , assembly	4	—	C	CE11
6916	10 CF 2115A	SEAL , moulded rubber, assembly	1	—	C	CE11
6936	10-20 CF 171A	GEAR-BOX , assembly (Pre Mod. 1060)	2	—	C	CE12
16783	10-20 CF 10211A	GEAR-BOX , assembly (Mod. 1060)	2	—	C	CE12
		Spares for :—				
2A/9500422	—	BEARING , ball (3110-99-950-0422)	2	—	C	
2A/9500419	—	BEARING , ball (3110-99-950-0419)	2	—	C	
6899	10 CF 261	COVER , universal joint (Pre Mod. 1060)	2	—	C	CE12
6937	10-20 CF 147A	GEAR-WHEEL , assembly	1	—	C	CE12
6891	10 CF 245	HOUSING , bearing	2	—	C	CE12
		Attachments for 10 CF 245, Housing (per pair) :—				
28D/1214821	A30/18C	Bolt, 2 BA	3	—	C	
28M/10328	AGS.2002/C/1	Nut, 2 BA	3	—	C	
28W/9419404	SP.16/C	Washer	3	—	C	
6889	10 CF 1143	Washer, special	2	—	C	CE12
6938	10-20 CF 167A	JOINT , universal, assembly	1	—	C	CE12
		Spares for :—				
	10 CF 1401	ADAPTER , torque tube	2	L.65	—	CE12
		Attachments for 10 CF 1401, Adapter :—				
	10 CF 233	Rivet, special	1	S.80	—	CE12
	10 CF 433A	JOINT , bare	2	—	—	CE12
		Attachments for 10 CF 433A, Joint :—				
	10 CF 233	Rivet, special	1	S.80	—	CE12
6893	10 CF 255	RING , sealing, ball bearing (0".125 thick)	2	—	C	CE12
6890	10 CF 257	RING , sealing, ball bearing (0".125 thick)	2	—	C	CE12
12642	10-20 CF 9513ND	SHIM	QR	—	C	CE12
	10 CF 5903A	VENT , breather, assembly	1	—	—	CE12
		Attachments for 10-20 CF 171A or 10-20 CF 10211A, Gear-Box :—				
28D/9453970	A25/15C	Bolt, 2 BA	2	—	C	
28M/10328	AGS.2002/C/1	Nut, 2 BA	4	—	C	
26DL/4216	DHS.69/C	Shim	QR	—	C	CE12
9507	10-20 CF 7303	Stud	1	—	C	CE12
9508	10-20 CF 7305	Stud	1	—	C	CE12
28W/9419402	SP.13/C	Washer	4	—	C	
6942	10-20 CF 5655	GUARD , chain, at gear-box	2	—	C	CE12
		Attachments for 10-20 CF 5655, Guard :—				
28M/10328	AGS.2002/C/1	Nut, 2 BA	2	—	C	
26DL/4216	DHS.69/C	Shim	QR	—	C	CE12
28W/9419402	SP.13/C	Washer	2	—	C	
9509	10-20 WC 25251A	GUARD , chain, outboard of gear-box, Port, assembly	1	—	P	CE9
9510	10-20 WC 25252A	GUARD , chain, outboard of gear-box, Starboard, assembly	1	—	P	CE9
		Attachments for 10-20 WC 25251A or 10-20 WC 25252A, Guard :—				
28D/9133011	A25/2C	Bolt, 2 BA	2	—	C	

CONTROLS

FLYING CONTROLS IN WING CENTRE SECTION

Ref. No.	Part No.	Description	No. off	Material Specification	Class of Store or L.M.	Place No.
17381	10-20 WF 4059A	LEVER , Port, assembly (Mod. 1191)	1	—	P	CE14
17382	10-20 WC 4060A	LEVER , Starboard, assembly (Mod. 1191)	1	—	P	CE14
	10-20 WF 471	Spares for :— BUSH , tapped	1	S.1	—	CE14
28D/1007974	AS.1242/1/2 C	Attachments for 10-20 WF 471, Bush :— Bolt, 2 BA	1	—	C	
28N/9156370	SP.21	NIPPLE , lubrication	1	—	C	
17383	10-20 WF 4053	STUD , bottom	1	—	C	CE14
17384	10-20 WF 4055	STUD , top	1	—	C	CE14
		Attachments for 10-20 WF 4053 or 10-20 WF 4055, Stud :—				
28P/19155	SP.90/E12	Pin, splc (SP.9/E14)	1	—	C	
		Attachments for 10-20 WF 4059A or 10-20 WF 4060A, Lever :—				
28M/5808571	A27/GS	Nut, 1/8" BSF	2	—	C	
28P/9527619	SP.90/C7	Pin, splc (SP.9/C8)	3	—	C	
28W/9419455	SP.10/G	Washer	2	—	C	
6955	10 WF 767	Washer, shim	1	—	C	CE14
6954	10 WF 765	Washer, throat	1	—	C	CE14
6953	10 CF 2797	ROLLER , side load, torque track	8	—	C	CE14
6943	10-20 CF 3563	SPROCKET , driving	2	—	C	CE19
		Attachments for 10-20 CF 3563, Sprocket :—				
6941	10 CF 1047	Cap, end	1	—	C	CE12
28M/5808571	A27/GS	Nut, 1/8" BSF	1	—	C	
11933	10-20 CF 9327	Shim	QR	—	C	CE12
	—	TRACK , flap, No. 3, group	2	—	—	
		(Drg. No. 10-20 WF 7)				
19550	10-20 CF 10283A	BOGIE , torque track, assembly (Mod. 1401)	2	—	P	CE14
6944	10 CF 2791A	CARRIAGE , bogie, assembly	1	—	P	CE14
		Spares for :—				
6945	10 CF 2795	SPIGOT	4	—	C	CE14
28N/15373	HOFFMANN CJ.7	JOINT , ball	1	—	C	CE14
16271	10 WF 559	PILLAR , ball joint	1	—	C	CE14
		Attachments for 10-20 WF 559, Pillar :—				
6960	10 WF 561	Bolt, special, 1/8" BSF	1	—	C	CE14
28M/13267	A24/GS	Nut, 1/8" BSF	1	—	C	
6948	10 WF 565	Washer, locking	1	—	C	CE14
6929	10 CF 2229	PLATE , cover	1	—	C	CE14
		Attachments for 10 CF 2229, Plate :—				
6946	10 CF 3137	Screw, special, 4 BA	4	—	C	CE14

CONTROLS

FLYING CONTROLS IN WING CENTRE SECTION

Ref. No.	Part No.	Description	No. off	Material Specification	Class of Score of L.M.	Plate No.
6932	10 CF 2225	PLUG	1	—	C	CE14
6930	10 CF 2163A	ROLLER , assembly	4	—	C	CE14
2A/9500415	—	Spares for :— BEARING , ball (3110-99-950-0415) ...	1	—	C	
		Attachments for 10 CF 2163A, Roller (per pair) :—				
19548	10-20 CF 10263	Axle (Mod. 1401)	1	—	C	CE14
19547	10-20 CF 10261	Bolt, special, 1/2" BSF (Mod. 1401)	1	—	C	CE14
28P/19231	SP.90/C13	Pin, split (SP.9/C14)	1	—	C	
28W/1011085	SP.11/N	Washer	2	—	C	
6916	10 CF 2115A	SEAL , moulded	1	—	C	CE14
19549	10-20 CF 10279A	CHAIN AND BOGIE , assembly (Mod. 1401) ...	2	—	P	CE11
19596	10-20 CF 9541	BOLT	2	—	C	CE11
6957	10-20 CF 5767	CARRIAGE , bogie	1	—	C	CE11
6956	10-20 CF 5765A/ND	CHAIN , assembly	1	—	C	CE11
		Attachments for 10-20 CF 5765A/ND, Chain :—				
	AS.168/6	Bolt, nut and pin, assembly	1	—	—	
20196	AS.947/87P	CHAIN , complete	1	—	C	
		Attachments for AS.947/87P, Chain :—				
	AS.168/6	Bolt, nut and split pin, assembly	1	—	—	
17390	10-20 WF 4047A	HEAD , adjustable, assembly (Mod. 1191) ...	1	—	C	CE11
		Spares for :—				
28N/9156370	SP.21	NIPPLE , lubrication	1	—	C	CE11
		Attachments for 10-20 WE 4047A, Head :—				
6959	10 CF 2273	Bolt, special, 1/2" BSF	1	—	C	CE11
28P/19233	SP.90/E6	Pin, split (SP.9/E8)	1	—	C	
28N/15373	HOFFMANN C1.7	JOINT , ball	1	—	C	
6929	10 CF 2229	PLATE , cover	1	—	C	CE11
		Attachments for 10 CF 2229, Plate :—				
	10 CF 2231	Screw, 4 BA (Make from Ref. No. 28S/2791) ...	4	—	LM	CE11
6932	10 CF 2225	PLUG , adjustable head	1	—	C	CE11
	10-20 CF 10085	ROD , tension (Make from Ref. No. 28U/15632)	1	—	LM	CE11
		Attachments for 10-20 CF 10085, Rod :—				
28M/13454	A27/ETL	Nut, 1/2" BSF, L.H. thread	1	—	C	
28M/1007403	A27/ET	Nut, 1/2" BSF, R.H. thread	1	—	C	
6930	10 CF 2163A	ROLLER	4	—	—	CE11
		Spares for :—				
2A/9500415	—	BEARING , ball (3110-99-950-0415) ...	1	—	—	
		Attachments for 10 CF 2163A, Roller (per pair) :—				
19548	10-20 CF 10263	Axle (Mod. 1401)	1	—	C	CE11
19547	10-20 CF 10261	Bolt, special, 1/2" BSF (Mod. 1401)	1	—	C	CE11
28P/19231	SP.90/C13	Pin, split (SP.9/C14)	1	—	C	
28W/1011085	SP.11/N	Washer	2	—	C	

CONTROLS

FLYING CONTROLS IN WING CENTRE SECTION

Ref. No.	Part No.	Description	No. off	Material Specification	Class of Store or LM	Plate No.
6916	10 CF 2115A	SEAL , moulded rubber	1	—	C	CE11
17385	10-20 WF 4057A	LEVER , flap, Port, assembly (Mod. 1191) ...	1	—	P	CE13
17386	10-20 WF 4058A	LEVER , flap, Starboard, assembly (Mod. 1191) ...	1	—	P	CE13
16943	10-20 WF 291	BUSH , special	1	—	C	CE13
		Attachments for 10-20 WF 291, Bush :—				
28D/1007976	AS.1242/4C	Bolt, 2 BA	1	—	C	
28M/9403520	A27/CP	Nut, 2 BA	1	—	C	
28W/9419475	SP.15/C	Washer	1	—	C	
28N/9156370	SP.21	NIPPLE , lubrication	1	—	C	
17387	10-20 WF 4051	STUD (Mod. 1191)	2	—	C	CE13
		Attachments for 10-20 WF 4057A or 10-20 WF 4058A, Lever :—				
28D/1212809	A25/40J	Bolt, $\frac{3}{16}$ " BSF	1	—	C	
16792	10-20 WF 1525	Bolt, $\frac{3}{16}$ " BSF (Mod. 939)	1	—	C	CE13
28M/13412	A24/JS	Nut, $\frac{3}{16}$ " BSF	1	—	C	
6965	10 WF 483	Nut, castellated	2	—	C	CE13
28P/9527619	SP.90/C7	Pin, split (SP.9/C8)	3	—	C	
16793	10-20 WF 1527	Washer (Mod. 939)	1	—	C	
28W/9419466	SP.13/J	Washer	1	—	C	
28W/9138816	SP.11/J	Washer	10	—	C	
28P/9527619	SP.90/C7	PIN , split, bogie pillar ball joint (SP.9/C8) ...	2	—	C	
6953	10 CF 2797	ROLLER , side load	8	—	C	CE13
	AS.2809/5/090	TUBE , distance, chain guard, $\frac{3}{16}$ " o/d x 22 SWG x 0°-90 long	4	L.62	LM	
		Attachments for AS.2809/5/090, Tube :—				
28D/1213239	A61/18E	Bolt, $\frac{1}{4}$ " BSF (Lock to DHS.514/D)	1	—	C	
28M/1011467	A27/ES	Nut, $\frac{1}{4}$ " BSF	1	—	C	
6955	10 WF 767	WASHER , shim, bogie pillar, 22 SWG	6	—	C	CE13
6954	10 WF 765	WASHER , throat, bogie pillar	2	—	C	CE13
	—	TRACK , flap, No. 3A, group (Org. No. 10-20 WF 9)	2	—	—	
6993	10-20 CF 5555	ARM , mounting, lever guide sprocket	2	—	C	CE9
6995	10-20 CF 5557	ARM , adjuster, lower sprocket guide	2	—	C	CE9
6975	10-20 WF 63	BARREL , eccentric, rotating link	2	—	C	CE11
	10-20 CF 5573	BARREL , eye-end, sprocket adjuster	2	L.64	LM	CE9
		Attachments for 10-20 CF 5573, Barrel :—				
7004	10-20 CF 5575	Nut, special, $\frac{3}{16}$ " BSF	2	—	C	CE9
2A/9500420	—	BEARING , ball, low speed shaft (3110-99-950-0420)	2	—	C	
2A/9500439	—	BEARING , ball, centre bottom, outer torque shaft (3110-99-950-0439)	2	—	C	
		Attachments for Ref. No. 2A/9500439, Bearing :—				
28M/5808571	A27/GS	Nut, $\frac{3}{16}$ " BSF	1	—	C	
28P/9527619	SP.90/C7	Pin, split (SP.9/C8)	1	—	C	
28W/9419476	SP.15/G	Washer	1	—	C	

CONTROLS

FLYING CONTROLS IN WING CENTRE SECTION

Ref. No.	Part No.	Description	No. off	Material Specification	Class of Store or L.M.	Plate No.
6999	10-20 CF 5567	CAP , domed, centre bottom, outer torque shaft	2	—	C	CE9
28N/2001716	AGS.2030/26	Attachments for 10-20 CF 5567, Cap :— Circlip	1	—	C	
19110	10-20 CF 5851A/1	CHAIN AND BOGIE , Port, assembly	1	—	P	CE11
19111	10-20 CF 5852A/1	CHAIN AND BOGIE , Starboard, assembly	1	—	P	CE11
6972	10-20 WF 79	BOLT , special, 3/8" BSF, rotating link	1	—	C	CE11
6808	10 CF 3123	BOLT , special, connector attachments	2	—	C	CE11
20200	AS.911/93P	CHAIN	1	—	C	
20521	AS.168/2	Attachments for AS.911/93P, Chain :— Bolt, nut and split pin, assembly	1	—	C	
6966	10-20 CF 5527A/ND	CHAIN , assembly	1	—	P	CE11
	AS.168/6	Attachments for 10-20 CF 5527A/ND, Chain :— Bolt, nut and split pin, assembly	1	—	—	
28FP/1091	DZUS Type A6	CIRCLIP	1	—	C	
28N/13513	HOFFMANN C.J.5	JOINT , ball	1	—	C	
17359	10-20 WF 1463A	LINK , rotating, Port, assembly	1	—	C	CE11
17360	10-20 WF 1464A	LINK , rotating, Starboard, assembly	2	—	C	CE11
6973	10-20 WF 67ND	Spares for :— STUD	1	—	C	CE11
14276	10-20 WF 1385A	Attachments for 10-20 WF 1463A or 10-20 WF 1464A, Link :— Nut, cap, assembly	1	—	C	CE11
28N/9156370	SP.21	Spares for :— Nipple, lubricating	1	—	C	
28P/9527619	10-20 WF 1383ND SP.90/C7	Nut, cap (bare), 3/8" BSF Pin, split (SP.9/C8)	1 1	S.92 —	— C	CE11 CE11
6909	10 CF 3139	NUT , special, 2 BA, connector attachments	2	—	C	CE11
28P/9527619	SP.90/C7	PIN , split, connector units (SP.9/C8)	2	—	C	
6919	10 CF 2119	PLATE , cover	1	—	C	CE11
6970	10-20 CF 5847	PLATE , side, inner	1	—	C	CE11
6969	10-20 CF 5845	PLATE , side, outer	1	—	C	CE11
6968	10 CF 2109	ROD , tie	1	—	C	CE11
28M/1006473	A27/CT	Attachments for 10 CF 2109, Rod :— Nut, 2 BA	1	—	C	
28M/13454	A27/ETL	Nut, 1/2" BSF, L.H.	1	—	C	
6971	10-20 CF 5841A	ROLLER , assembly	1	—	C	CE11
2A/9500419	—	Spares for :— BEARING , ball (3110-99-950-0419)	1	—	C	
6919	10 CF 2115A	SEAL , pillar, assembly	1	—	C	CE11
6884	10-20 WF 65	Attachments for 10-20 CF 5851A/1 or 10-20 CF 5852A/1, Chain and Bogie :— Bolt, locking, 1/2" BSF	1	—	C	CE11
28M/5808571	A27/G5	Nut, 3/8" BSF	1	—	C	
28P/9527619	SP.90/C7	Pin, split (SP.9/C8)	1	—	C	
16261	DHS.781/32/18	Washer	1	—	C	CE11
6885	10-20 WF 81	Washer	1	—	C	CE11

CONTROLS

FLYING CONTROLS IN WING CENTRE SECTION

Ref. No.	Part No.	Description	No. off	Material Specification	Class of Store or L.M	Plate No.
20193	AS.924/166P	CHAIN , high speed	2	—	C	CE9
20199	AS.924/184P	CHAIN , low speed	2	—	C	CE9
	10-20 CF 5561	COLLAR , guide sprocket adjuster	2	L.64	LM	CE9
		Attachments for 10-20 CF 5561, Collar :—				
28M/1007403	A27/ET	Nut, 1/2" BSF	1	—	C	
6997	10-20 CF 5559	Nut, barrel	1	—	C	CE9
28W/9419405	SP.15/E	Washer	1	—	C	
	10-20 CF 5565	EYE-BOLT , guide sprocket adjuster	2	S.96	—	CE9
		Attachments for 10-20 CF 5565, Eye-bolt :—				
28D/12571	A25/21E	Bolt, 1/2" BSF	1	—	C	
28M/13935	A58/ES	Nut, 1/2" BSF	1	—	C	
28P/9527619	SP.90/C7	Pin, split (SP.9/C8)	1	—	C	
	10-20 CF 5571	EYE-END , sprocket adjuster	2	S.96	—	CE9
		Attachments for 10-20 CF 5571, Eye-end :—				
	10-20 CF 5613	Bolt, special, 1/2" BSF	1	S.96	—	CE9
	10-20 CF 3617	GUARD , chain, Port	1	L.121	—	CE9
	10-20 CF 3618	GUARD , chain, Starboard	1	L.121	—	CE9
		Attachments for 10-20 CF 3617 or 10-20 CF 3618, Guard :—				
28D/9140645	A25/10C	Bolt, 2 BA	1	—	C	
28D/1214037	AS.1242/15C	Bolt, 2 BA	1	—	C	
28D/1214036	AS.1242/14C	Bolt, 2 BA	1	—	C	
28W/1006940	AGS.2034/C	Washer, shakeproof	1	—	C	
28W/1013428	AGS.2036/C	Washer, shakeproof	2	—	C	
	10-20 CF 5835	HOUSING , bearing, adjustable, high speed shaft	2	S.93	—	CE14
		Attachment for 10-20 CF 5835, Housing :—				
6983	10-20 CF 5839	Nut, ring, slotted, 1"-60 1/d x 20 T.P.I. Whic. ...	1	—	C	CE14
7001	10-20 WC 6029A	LEVER , sprocket adjuster, Port, assembly ...	1	—	P	CE9
7002	10-20 WC 6030A	LEVER , sprocket, adjuster, Starboard, assembly	1	—	P	CE9
		Spare for :—				
	AS.2809/4/050	TUBE , distance, lower, 1/2" o/d x 22 SWG x 0"-50 long	1	L.63	LM	
		Attachments for AS.2809/4/050, Tube :—				
28D/9435710	A25/11C	Bolt, 2 BA	1	—	C	
28M/5808573	A27/CS	Nut, 2 BA	1	—	C	
28P/9527619	SP.90/C7	Pin, split (SP.9/C8)	1	—	C	
28W/9419402	SP.13/C	Washer	1	—	C	
	AS.2809/4/040	TUBE , distance, upper, 1/2" o/d x 22 SWG x 0"-40 long	1	L.63	LM	
		Attachments for AS.2809/4/040, Tube :—				
28D/9133014	A25/13C	Bolt, 2 BA	1	—	C	
28M/5808573	A27/CS	Nut, 2 BA	1	—	C	
28P/9527619	SP.90/C7	Pin, split (SP.9/C8)	1	—	C	
28W/9419402	SP.13/C	Washer	1	—	C	
		Attachments for 10-20 WC 6029A or 10-20 WC 6030A, Lever :—				
7003	10-20 CF 3577	Bolt, special, 1/2" BSF	1	—	C	CE9
28P/19228	SP.90/C8	Pin, split (SP.9/C9)	1	—	C	
9515	10-20 WC 24859	PEDESTAL , at centre bottom, outer torque shaft (Pre Mod. 832)	2	—	C	CE9

CONTROLS

FLYING CONTROLS IN WING CENTRE SECTION

Ref. No.	Part No.	Description	No. off						Material Specification	Class of Store or L.M	Place No.
			1	2	3	4	5	6			
16315	10-20 WC 29825	PEDESTAL , at centre bottom, outer torque shaft (Mod. 832) Attachments for 10-20 WC 24859 or 10-20 WC 29825, Pedestal :—						2	—	C	CE9
28M/1011467	A27/ES	Nut, 1/2" BSF						2	—	C	
28P/9527619	SP.90/C7	Pin, split (SP.9/C8)						2	—	C	
28W/9419405	SP.15/E	Washer						1	—	C	
28W/9418920	SP.10/E	Washer						1	—	C	
16775	10-20 CF 10181	PLATE , locking, high speed shaft (Mod. 943) ... Attachments for 10-20 CF 10181, Plate :—						2	—	C	CE14
28D/9133012	A25/3C	Bolt, 2 BA						1	—	C	
28D/1200119	A25/4C	Bolt, 2 BA						1	—	C	
28M/9403520	A27/CP	Nut, 2 BA						2	—	C	
28W/9419402	SP.13/C	Washer						2	—	C	
16102	10-20 WC 30077	PLATE , packing, high speed shaft L.H. ... (Fit if required)						1	—	C	CE14
16184	10-20 WC 30078	PLATE , packing, high speed shaft R.H. ... (Fit if required)						1	—	C	CE14
19088	10-20 WC 41471	PLATE , retaining, bearing ring, high speed shaft (Mod. 1384)						1	—	C	CE14
6986	10-20 CF 5537A	SHAFT , low speed, assembly ... Spares for :						1	—	P	CE14
2A/9500418	—	BEARING , ball (3110-99-950-0418)						2	—	C	
6988	10-20 CF 5779	FITTING , end ... Attachments for 10-20 CF 5779, Fitting :—						1	—	C	CE14
28D/1214091	AS.1242/2C	Bolt, 2 BA						3	—	C	
28M/9403520	A27/CP	Nut, 2 BA						3	—	C	
	10-20 CF 5791	SCREW , adjustment ... Attachments for 10-20 CF 5791, Screw :—						2	5.96	—	CE14
8495	A27/GT/DHS.514/D	Nut, 1/8" BSF (Alternative S21/A27/GT)						1	—	C	
6987	10-20 CF 5781	SHAFT , complete with sprocket ... Attachments for 10-20 CF 5781, Shaft :—						1	—	C	CE14
28M/14555	A58/NS	Nut, 1/2" BSF						1	—	C	
28P/19228	SP.90/CB	Pin, split (SP.9/C10)						1	—	C	
28P/9419468	SP.13/N	Washer						1	—	C	
	10-20 CF 5783	SLEEVE , serrated... Attachments for 10-20 CF 5783, Sleeve :—						1	5.96	—	CE14
28D/9140647	A25/14C	Bolt, 2 BA						1	—	C	
28M/5808573	A27/CS	Nut, 2 BA						1	—	C	
28P/9527619	SP.90/C7	Pin, split (SP.9/C8)						1	—	C	
	10-20 CF 5789	SPACER ... Attachments for 10-20 CF 5537A, Shaft :—						1	L.65	—	CE14
28M/15199	A58/LS	Nut, 1/8" BSF						1	—	C	
28P/19234	SP.90/EB	Pin, split (SP.9/E10)						1	—	C	
28W/9419478	SP.15/L	Washer						1	—	C	
	—	SHAFT , mounting, lower guide sprocket arm, group						2	—	—	CE9
28M/14537	A58/GS	NUT , 1/8" BSF						1	—	C	
28M/14833	A58/JS	NUT , 3/8" BSF						1	—	C	
28P/9527619	SP.90/C7	PIN , split (SP.9/C8)						2	—	C	
6994	10-20 CF 5553	SHAFT						1	—	C	CE9
28W/9419476	SP.15/G	WASHER						1	—	C	
28W/9419477	SP.15/J	WASHER						1	—	C	

CONTROLS

FLYING CONTROLS IN WING CENTRE SECTION

Ref. No.	Part No.	Description	No. off	Material Specification	Class of Store or LM	Place No.
	10-20 CF 9535A	SHAFT , torque, high speed, upper inboard portion, assembly Spares for :—	2	—	—	CE14
6982	10-20 CF 5837A	BEARING , ball, assembly Spares for :—	1	—	P	CE14
2A/9500419	—	BEARING , ball (3110-99-950-0419)	1	—	C	
6980	10-20 CF 5643	CLUTCH , dog (female)	1	—	C	CE14
26DL/7356	DHS.94/6/115	PIN , ground steel, $\frac{3}{16}$ " dia.	2	—	C	CE14
6981	10-20 CF 5645	RING , bearing	1	—	C	CE14
	10-20 CF 9545A/ND	SHAFT , torque, high speed, upper outboard portion, assembly (For spares use 10-20 CF 9959A/ND)	2	—	—	CE14
14717	10-20 CF 9959A/ND	SHAFT , torque, high speed, upper outboard portion, assembly (Spares condition)	2	—	P	
6985	10-20 CF 5535	NUT , special	1	—	C	CE14
28P 19231	SP.90/C13	PIN , split (SP.9/C14)	1	—	C	
	10-20 CF 9539	SHAFT , bare	1	5.96	—	CE14
6984	10-20 CF 5533	SPROCKET	1	—	C	CE14
	28M/14833	Attachments for 10-20 CF 9545A/ND, Shaft :— Nut, $\frac{3}{8}$ " BSF	1	—	C	
	26DL/7356	Pin, ground steel, $\frac{3}{16}$ " dia.	2	—	C	CE14
	28P/9527619	Pin, split (SP.9/C8)	1	—	C	
	28W/9419477	Washer	1	—	C	
6996	10-20 CF 5563	SPRING , guide sprocket adjuster	2	—	C	CE9
6998	10-20 CF 3457	SPROCKET , centre bottom, outer torque shaft Attachments for 10-20 CF 3457, Sprocket :—	2	—	C	CE9
28D/9434875	A59/20E	Bolt, $\frac{1}{2}$ " BSF	2	—	C	
28M/1011467	A27/ES	Nut, $\frac{1}{2}$ " BSF	2	—	C	
28P/9527619	SP.90/C7	Pin, split (SP.9/C8)	2	—	C	
28W/14185	AS.1903/E16	Washer	4	—	C	
6976	10 CF 4323A	SPROCKET , guide, lower, assembly Spares for :—	2	—	P	CE9
2A/9501380	SKEFKO 402266	BEARING , ball (3110-99-950-1380) Attachments for 10 CF 4323A, Sprocket :—	1	—	C	CE9
6992	10-20 CF 5547	Bolt, special, $\frac{3}{16}$ " BSF	1	—	C	CE9
28M/14537	A58/GS	Nut, $\frac{3}{16}$ " BSF	1	—	C	
28P/9527619	SP.90/C7	Pin, split (SP.9/C8)	1	—	C	
28W/9419477	SP.15/J	Washer	QR	—	C	
6976	10 CF 4323A	SPROCKET , guide, upper, assembly Spares for :—	2	—	P	CE9
2A/9501380	SKEFKO 402266	BEARING , ball (3110-99-950-1380) Attachments for 10 CF 4323A, Sprocket :—	1	—	C	CE9
6991	10-20 CF 5545	Bolt, special, $\frac{3}{16}$ " BSF	1	—	C	CE9
28M/14537	A58/GS	Nut, $\frac{3}{16}$ " BSF	1	—	C	
28P/9527619	SP.90/C7	Pin, split (SP.9/C8)	1	—	C	
28W/9419477	SP.15/J	Washer	QR	—	C	
6989	10-20 CF 5539	SPROCKET , low speed shaft Attachments for 10-20 CF 5539, Sprocket :—	2	—	C	CE14
28M/1011467	A27/ES	Nut, $\frac{1}{2}$ " BSF	1	—	C	
28P/9527619	SP.90/C7	Pin, split (SP.9/C8)	1	—	C	
6990	10-20 CF 5541	Washer, special	1	—	C	CE14

CONTROLS

FLYING CONTROLS IN WING CENTRE SECTION

Ref. No.	Part No.	Description	No. off	Material Specification	Class of Store or L.M.	Plate No.
6976	10 CF 4323A	SPROCKET , rear end, assembly	2	—	P	CE9
		Spares for :—				
2A/9501380	SKEFKO 402266	BEARING , ball (Port sprocket only) ...	1	—	C	CE9
		(3110-99-950-1380)				
		Attachments for 10 CF 4323A, Sprocket :—				
6977	10-20 CF 5543	Bolt, special, $\frac{5}{16}$ " BSF	1	—	C	CE9
6978	10 WC 8673	Nut, special, $\frac{5}{16}$ " BSF	1	—	C	CE9
28P/9527619	SP.90/C7	Pin, split (SP.9/C8)	1	—	C	
	AS.2809/4/075	TUBE , distance, chain guard at guide sprocket, $\frac{1}{4}$ " o/d x 22 SWG x ".75 long	4	L.63	LM	
		Attachments for AS.2809/4/075, Tube :—				
28D/9419397	A25/12C	Bolt, 2 BA	1	—	C	
28M/5808573	A27/CS	Nut, 2 BA	1	—	C	
28P/9527619	SP.90/C7	Pin, split (SP.9/C8)	1	—	C	
	AS.2809/4/050	TUBE , distance, chain guard sprocket, $\frac{1}{4}$ " o/d x 22 SWG x ".50 long	2	L.63	LM	
		Attachments for AS.2809/4/050, Tube :—				
28D/9140644	A25/9C	Bolt, 2 BA	1	—	C	
28M/5808573	A27/CS	Nut, 2 BA	1	—	C	
28P/9527619	SP.90/C7	Pin, split (SP.9/C8)	1	—	C	
	AS.2811/5/160	TUBE , distance, chain guard on sprocket mounting bracket on rib No. 4, $\frac{5}{16}$ " o/d x 17 SWG x 1".60 long	4	L.63	LM	
		Attachments for AS.2811/5/160, Tube :—				
12848	A25/19C/DHS.514/D	Bolt, 2 BA (Alternative S21/A25/19C)	1	—	C	CE9
28U/14790	SP.33/C	TURNBARREL , 2 BA, aileron balance cable connections on front spar at centre line of aircraft	1	—	C	

CONTROLS
FLYING CONTROLS IN WING CENTRE SECTION

Ref. No.	Part No.	Description						No. off	Material Specification	Class of Store or L.M.	Plate No.
		1	2	3	4	5	6				

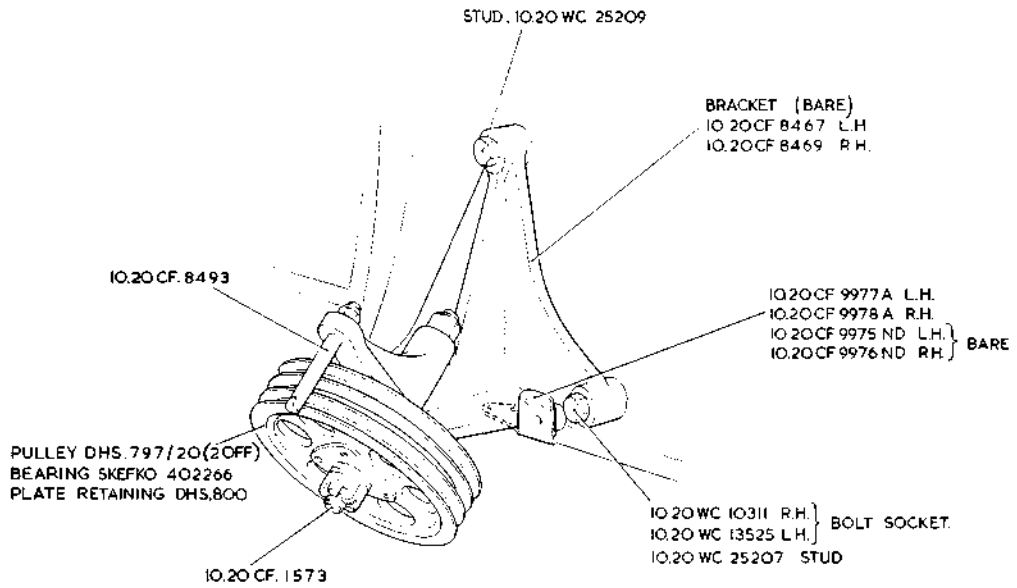
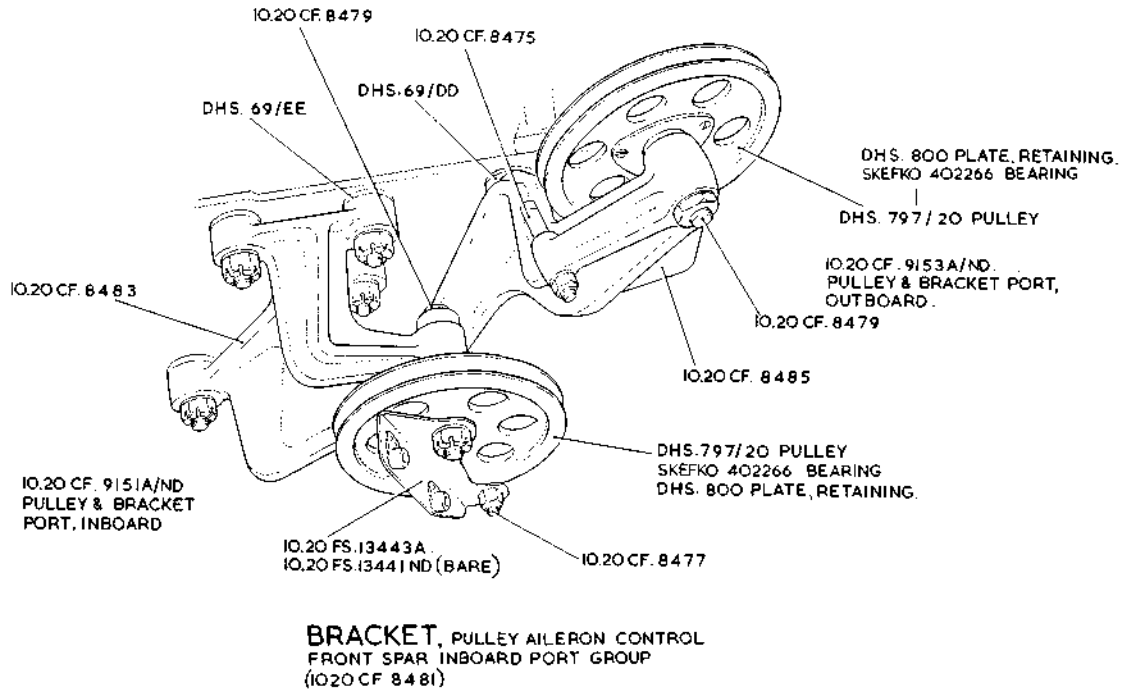

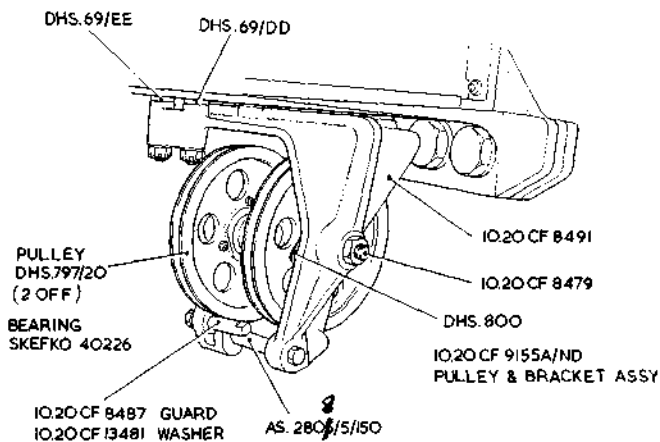

BRACKET, PULLEY AILERON CONTROL
 FRONT SPAR INBOARD STBD. GROUP.
 (DRG. No. IO.20 CF 8489)

AL 2 8

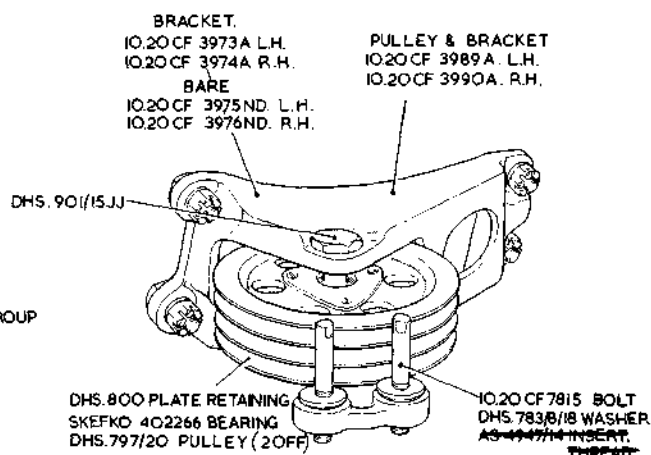

BRACKET, PULLEY
 AT FRONT SPAR & RIB NO.2
 (AILERON CONTROL) PORT & STBD. GROUP
 (DRG. No. IO.20 CF 3993)

AL 62

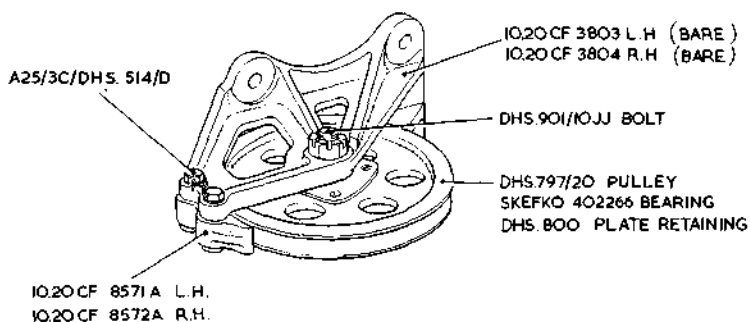

BRACKET, PULLEY, AT OUTBOARD
 MISSILE CASTING, AILERON CONTROLS
 PORT & STBD GROUP
 (DRG. No. IO.20 CF 3807)

BRACKET, PULLEY, ON RIB NO.4
 IN LEADING EDGE.

PORT - IO.20 CF 3805A/1
 STBD. - IO.20 CF 3806A/1

SEE TEXT FOR SPARES CONDITION
OF ITEMS MARKED THUS: *

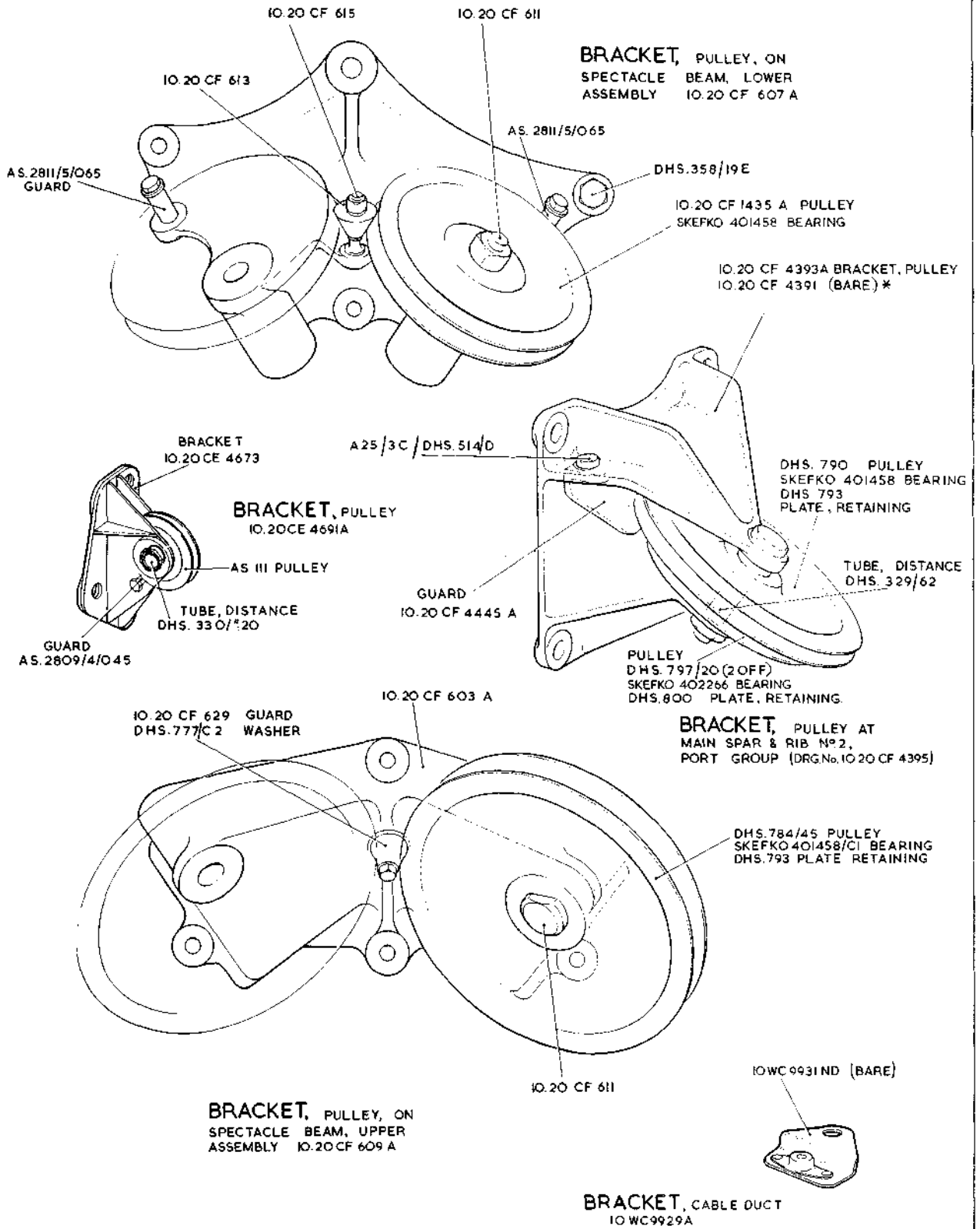

CONTROLS FLYING CONTROLS IN WING CENTRE SECTION

SEE TEXT FOR SPARES CONDITION
OF ITEMS MARKED THUS— *

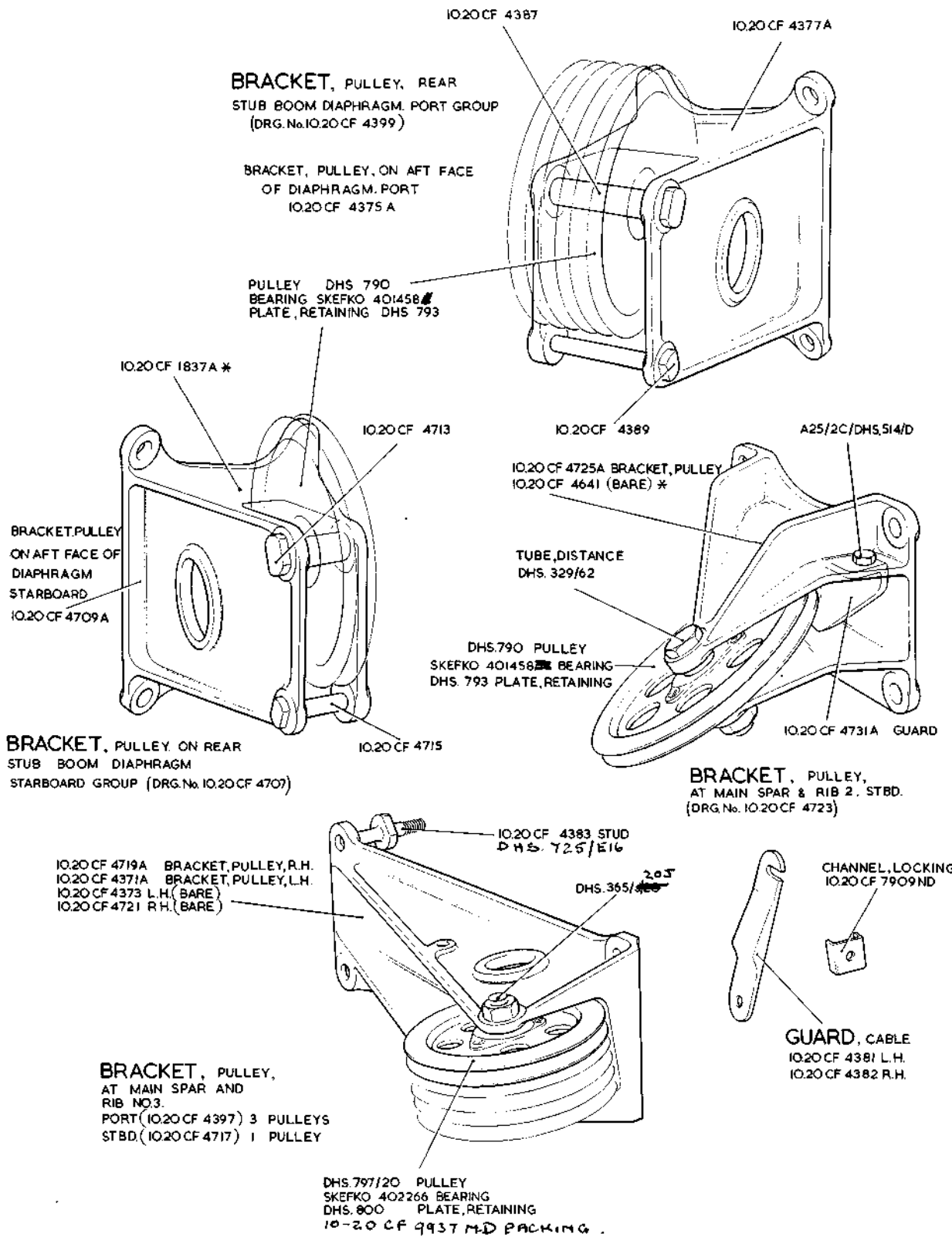

CE.5

CONTROLS
FLYING CONTROLS IN
WING CENTRE SECTION

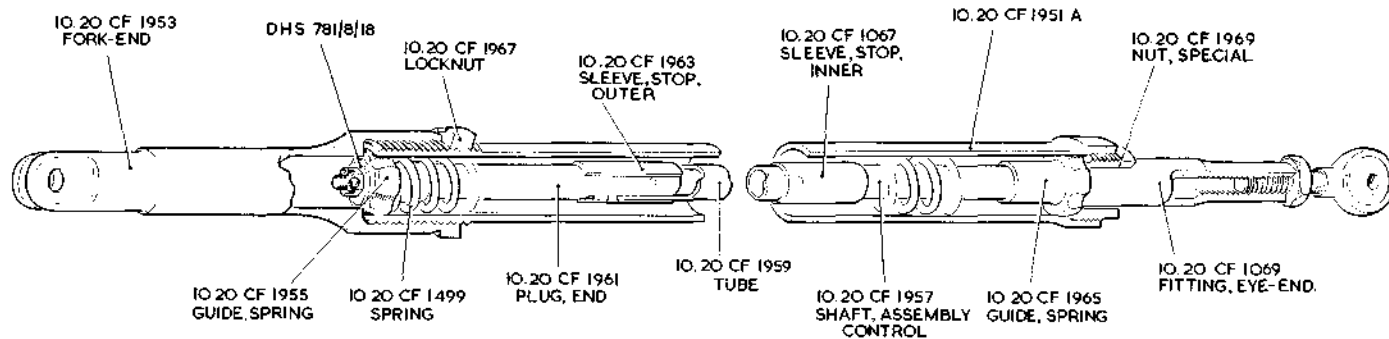
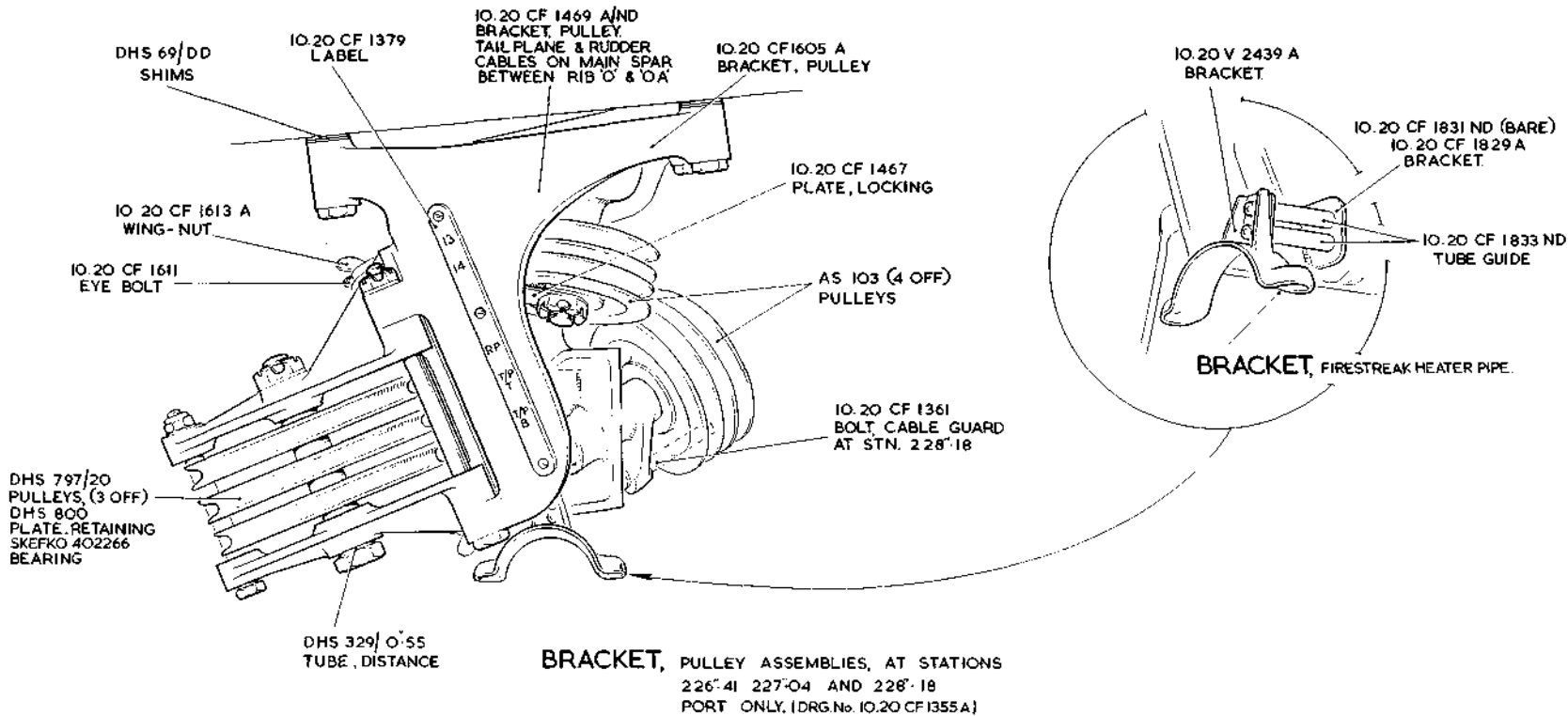

STRUT SPRING, FLAP CONTROL, ASSEMBLY. (DRG.No IO.20 CF 1949A)

CE.5
[A.L.66]

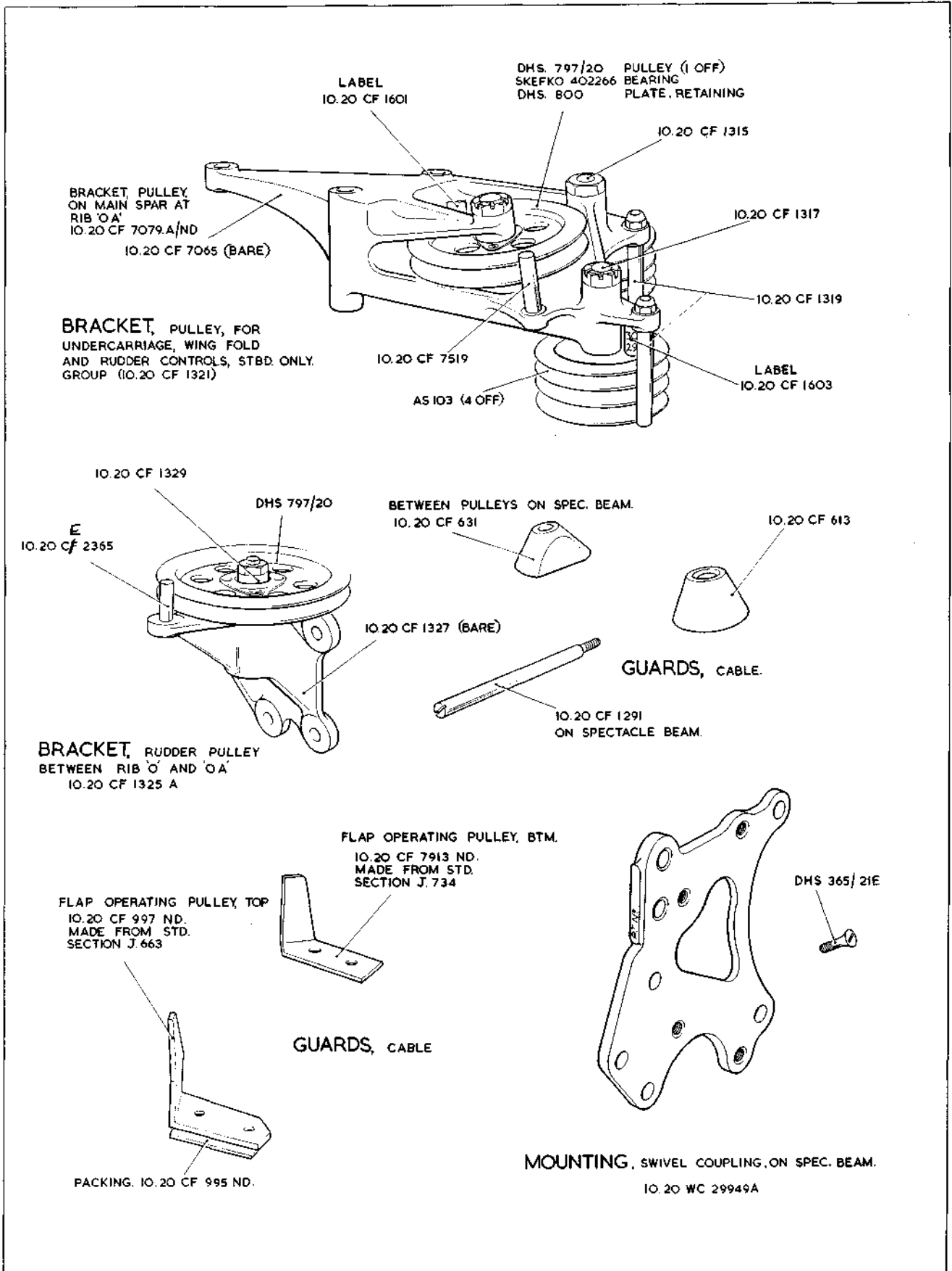

CE.6

CONTROLS FLYING CONTROLS IN WING CENTRE SECTION

CE.6
[A.L. 28]

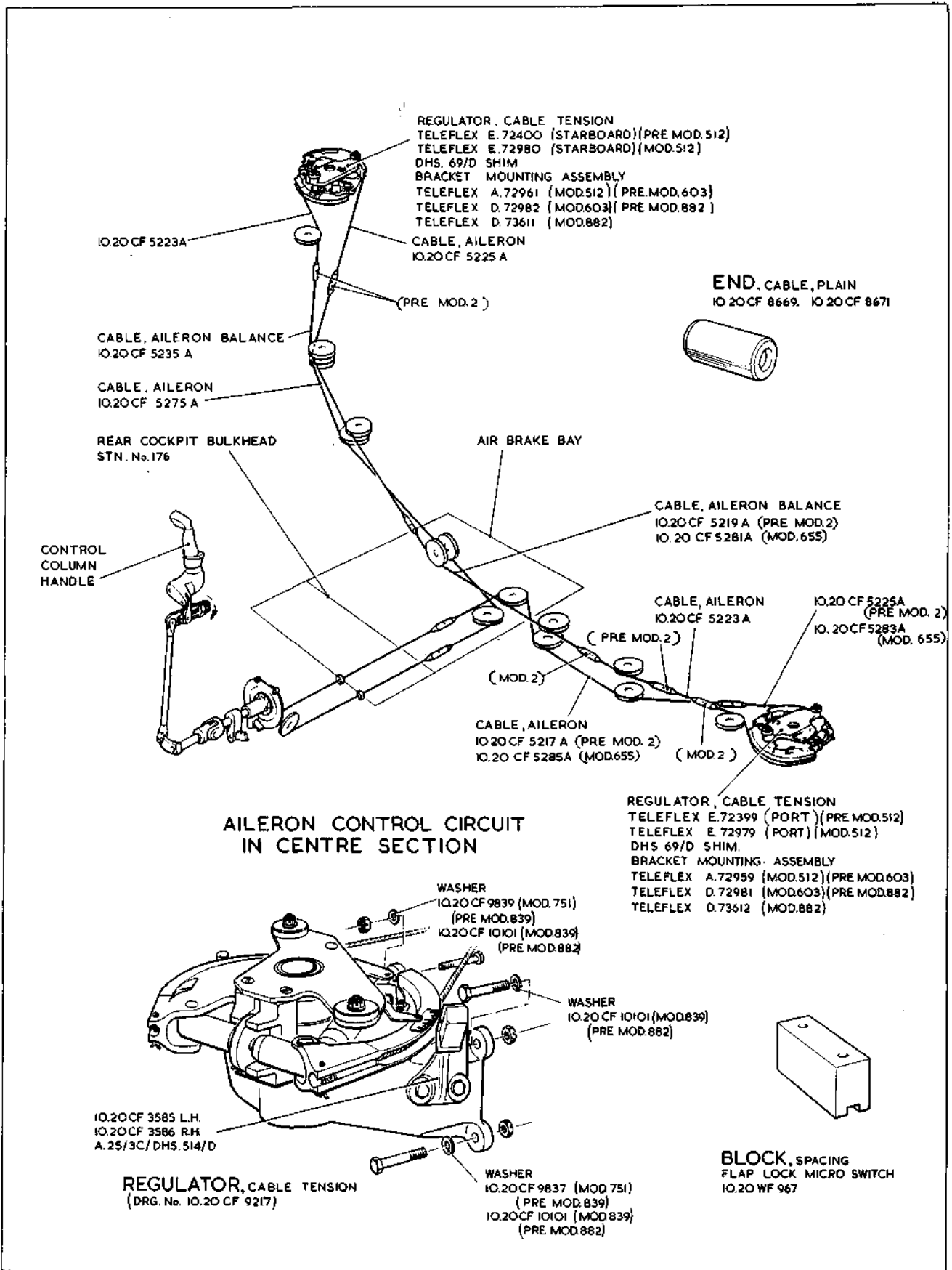

CE.7

CONTROLS FLYING CONTROLS IN WING CENTRE SECTION

CE.7
[AL.41]

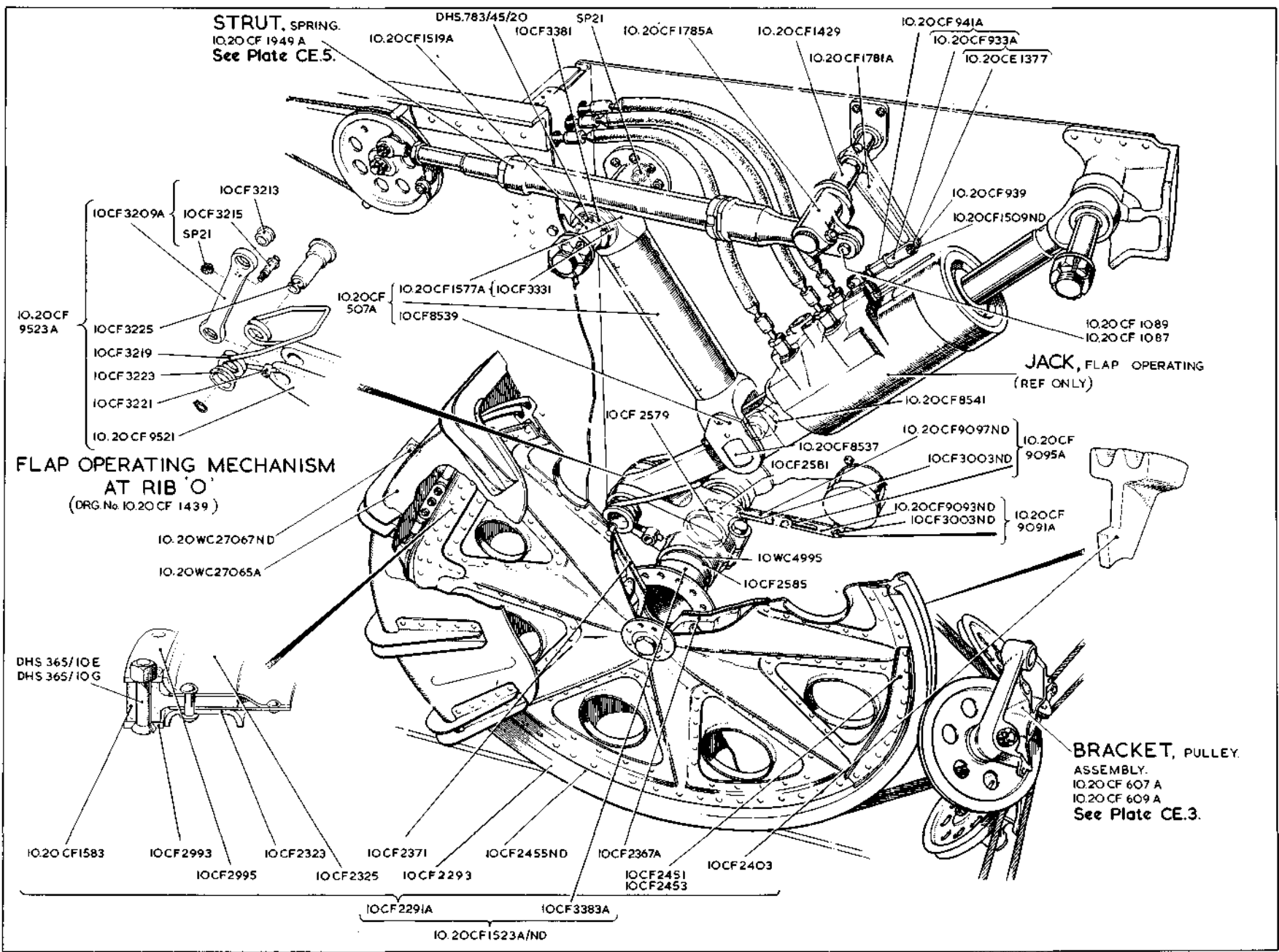

CE.8

**CONTROLS
FLYING CONTROLS IN
WING CENTRE SECTION**

RESTRICTED

CE.8
[A.L.72]

SEE TEXT FOR SPARES CONDITION OF ITEMS MARKED THUS— *

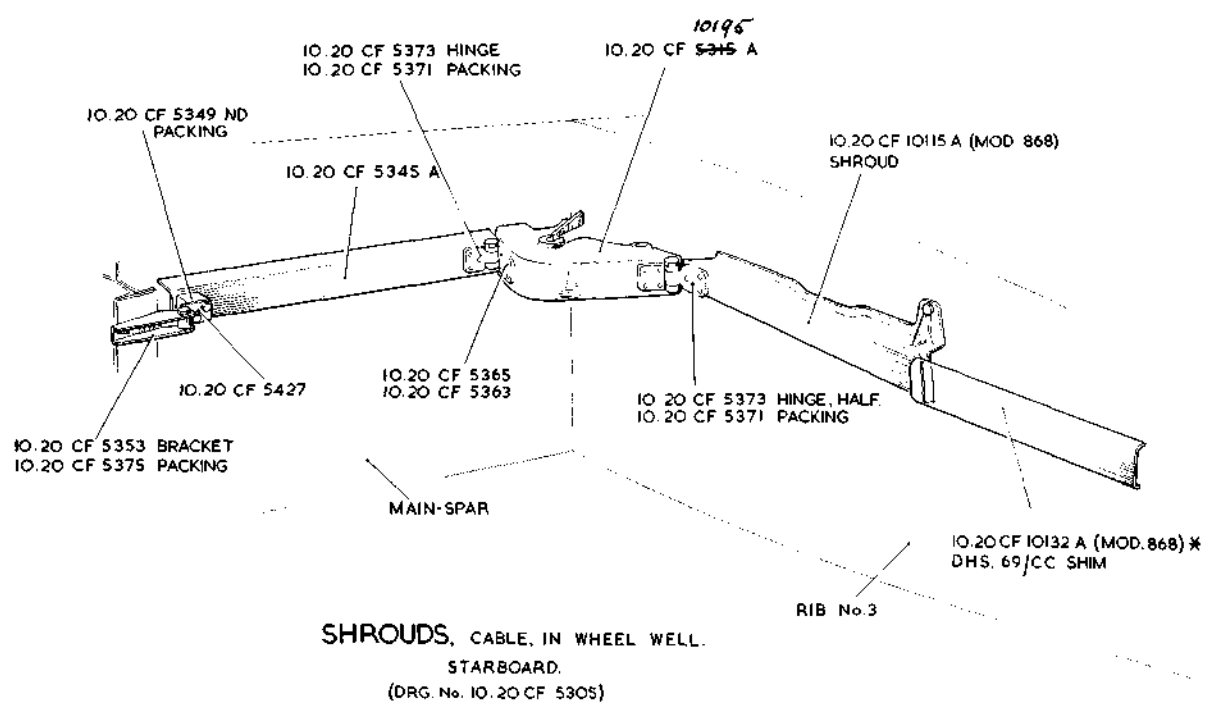
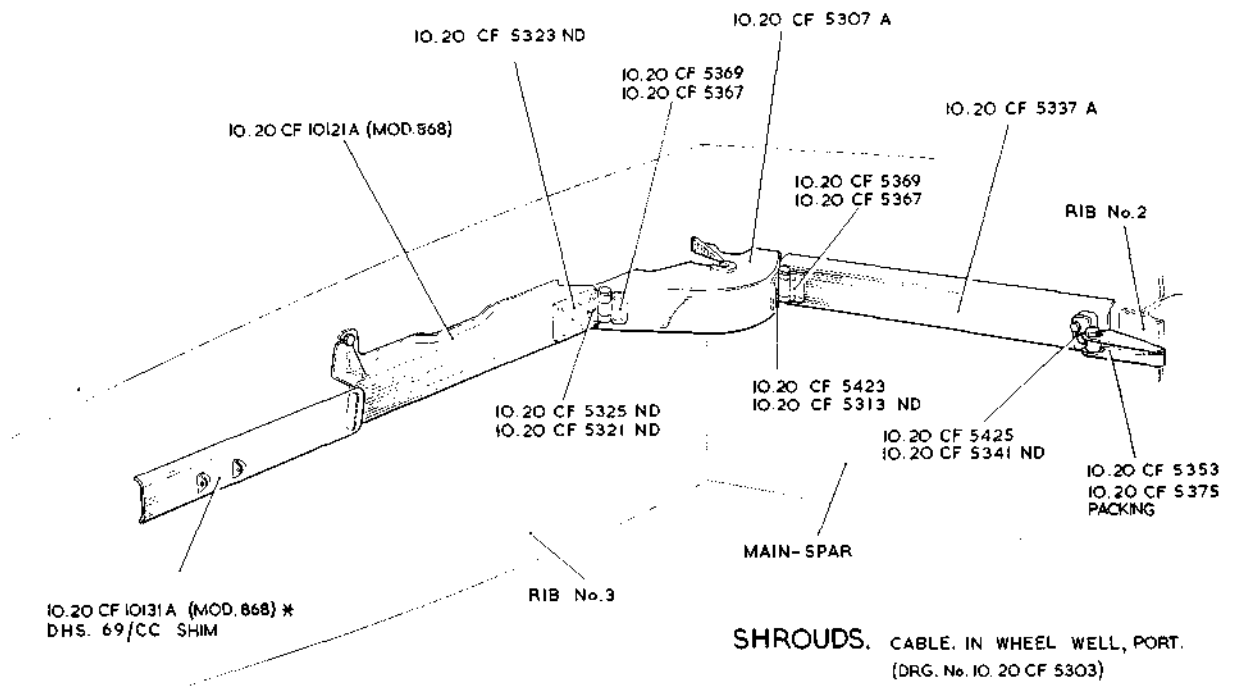

CE.10

CONTROLS FLYING CONTROLS IN WING CENTRE SECTION

CE.10
[A.L.24]

CE.11

**CONTROLS
IN
FLYING CONTROLS
IN
WING CENTRE SECTION**

RESTRICTED

CE.11

[A.L.53]

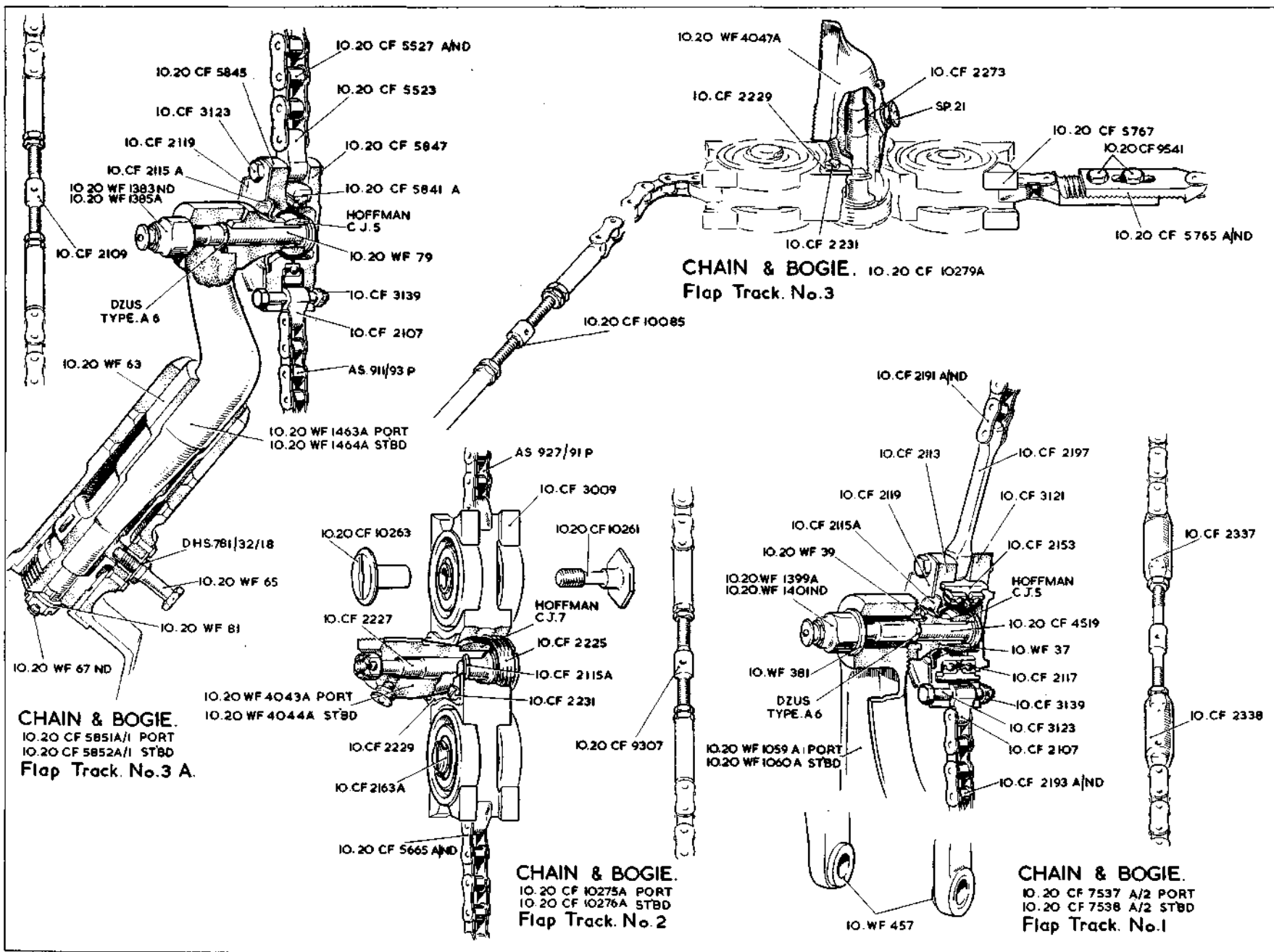

See Vixen Mk. 1

RESTRICTED

Plate CE.11

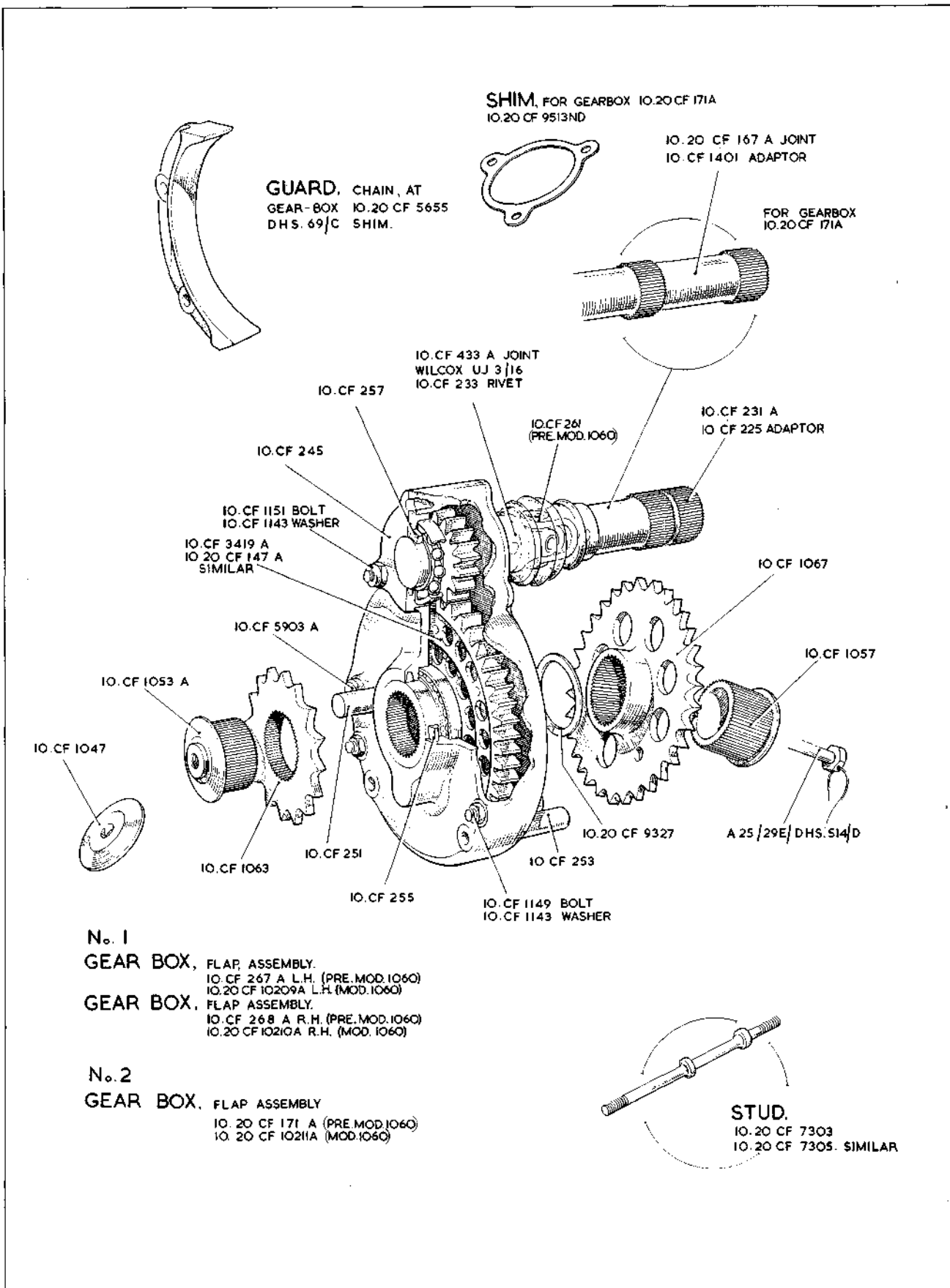

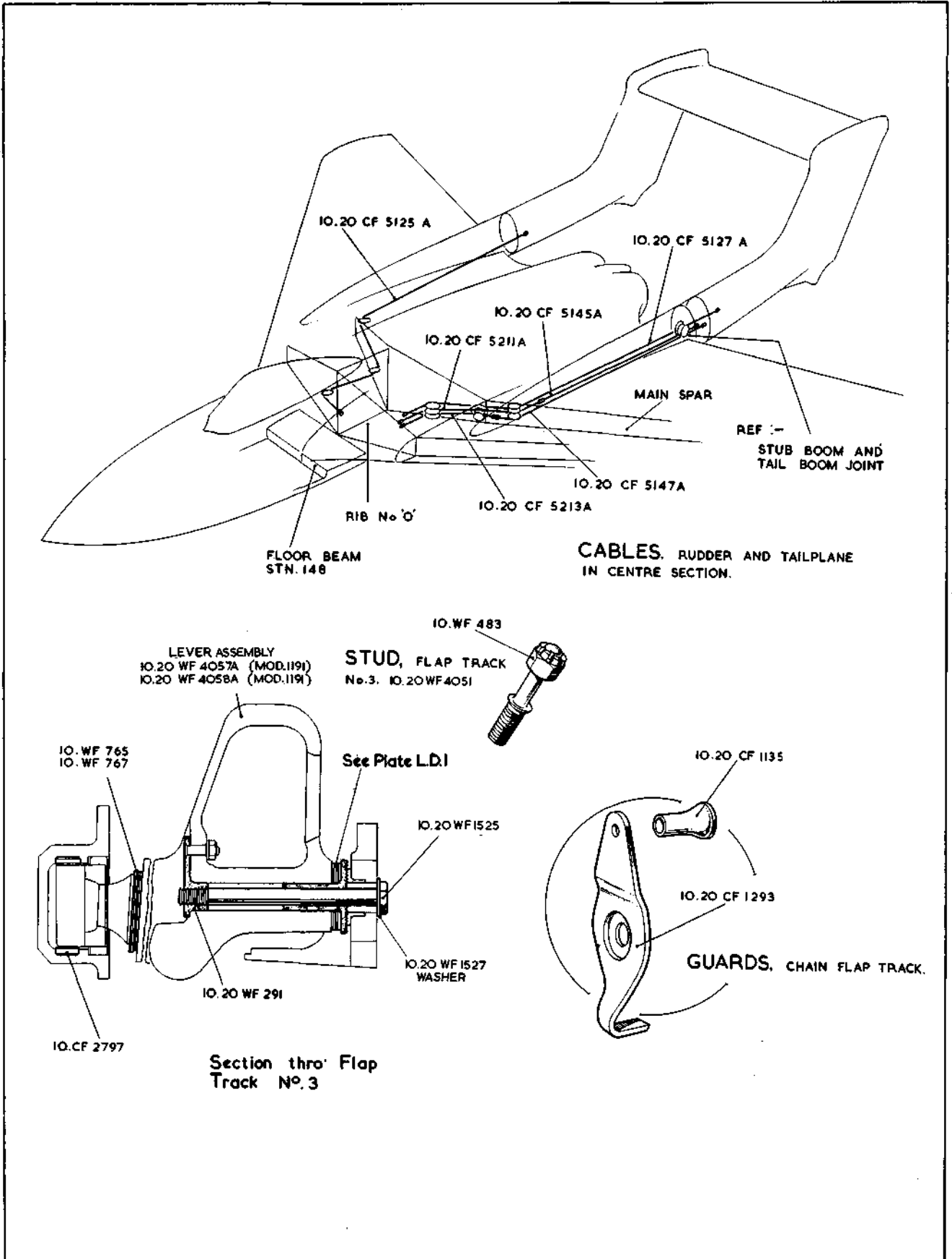

CE.14

CONTROLS
FLYING CONTROLS IN
WING CENTRE SECTION

RESTRICTED

CE.14
CLASS

SEE TEXT FOR SPARES CONDITION
OF ITEMS MARKED THUS: *

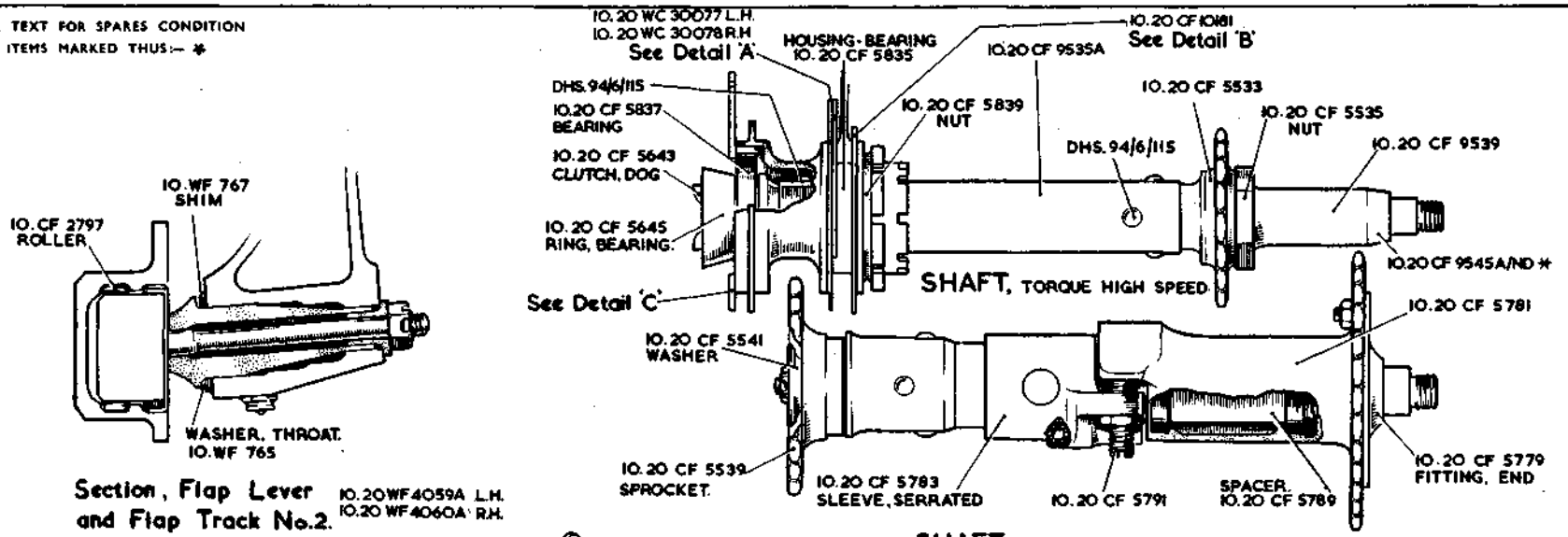

Section, Flap Lever and Flap Track No.2.
10.20 WF 4059A L.H.
10.20 WF 4060A R.H.

High and Low speed Shafts at Track No.3 A.

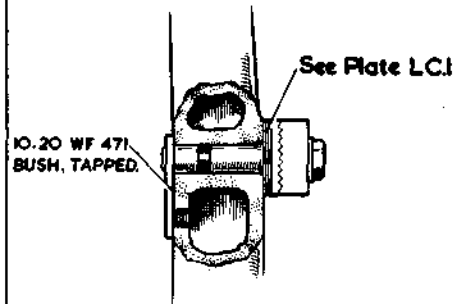

Sections of Flap Lever.
10.20 WF 4059A
10.20 WF 4060A

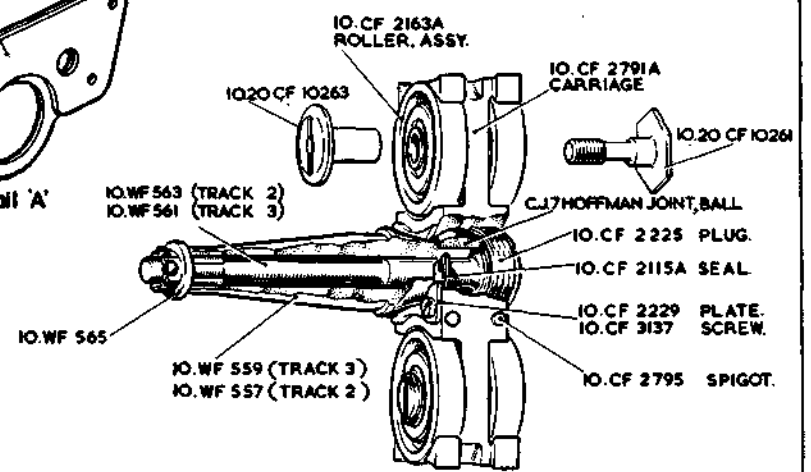
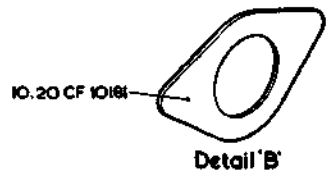
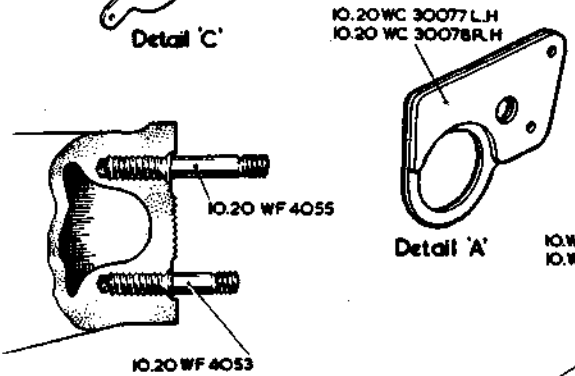
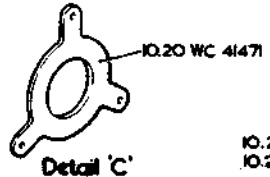

BOGIE, TORQUE TRACK, ASSEMBLY. 10.20 CF 10281A No.2
10.20 CF 10283A No.3

See View No. 1

RESTRICTED

Plate CE.14

This file was downloaded
from the RTFM Library.

Link: www.scottbouch.com/rtfm

Please see site for usage terms,
and more aircraft documents.

