

ELECTRICAL INSTALLATIONS

INSTALLATION OF ICE DETECTOR, CODED "WM"

Ref. No.	Part No.	Description	No. off	Material Specification	Class of Store or L.M.	Place No.
		INSTALLATION OF ICE DETECTOR, CODED "WM"	1	—	—	
		INSTALLATION IN FUSELAGE, FORWARD, PORT (Drg. No. 10-20 N 14459 (Mod. 825))	1	—	—	
28D/8308	AS.1242/3C	BOLT , 2 BA, ice detector head mounting ...	6	—	C	
	—	HEAD , ice detector, coded "AW," group ...	1	—	—	
	10-20 N 14815A	DETECTOR , ice, c/w cable and mounting, assembly (Mod. 825)	1	—	—	ECP1
	10-20 N 14815A/ CABLES	CABLE , assembly ...	1	—	ECC	
6A/5577	SMITHS 16DI-MOD. 01	HEAD , ice detector ...	1	—	P	ECP1
6335	10-20 N 5853	MOUNTING , ice detector head ...	1	—	C	ECP1
	10-20 S 15301ND	PIPE , static ...	1	L.56	PC	ECP1
28S/1200034	A31/B16	SCREW , 4 BA ...	2	—	C	
28W/9419448	AGS.2035/B	WASHER , shakeproof ...	2	—	C	
	10-20 FS 1728S	PLATE , facing, 18 SWG (Mod. 825) ...	1	L.73	LM	ECP1
6336	10-20 N 5849	WASHER , sealing ...	1	—	C	
		INSTALLATION IN COCKPIT FORWARD OF FRAME 96" (Drg. Nos. 10-20 N 11421, 10-20 N 5909, 10-20 N 4925, 10-20 N 13463, 10-20 N 15721, 10-20 N 22903 and 10-20 N 23973)	1	—	—	
		BLOCK , terminal, coded "ACJ," group (Mod. 825, Pre Mod. 1101)	1	—	—	
	10-20 N 15717A	BRACKET , mounting, c/w terminal block, assembly	1	—	—	ECP1
	DHS.456/2	BLOCK , terminal, 2-way, assembly (For breakdown see DHS. Data Sheet)	1	—	—	ECP1
	10-20 N 15713A	BRACKET , mounting, assembly ...	1	—	—	ECP1
	10-20 N 15715ND	BRACKET , bare, 20 SWG ...	1	L.72	LM	ECP1
5X/3272	PLESSEY CZ.26799	COVER , terminal block ...	1	—	C	ECP1
28M/10287	AGS.2001/B/1	NUT , 4 BA ...	2	—	C	
5X/9450403	PLESSEY Z.28426	PILLAR , fixing, 4 BA ...	2	—	C	ECP1
		Attachments for 10-20 N 15717A, Bracket :—				
28D/1010658	A25/1B	Bolt, 4 BA ...	2	—	C	
28W/9419401	SP.10/B	Washer ...	2	—	C	
		BLOCK , terminal and relay group (Mod. 1101) ...	1	—	—	
	DHS.456/2	BLOCK , terminal, 2-way, coded "AJC," assembly (For breakdown see DHS. Data Sheet)	1	—	—	ECP1
		Attachments for DHS.456/2, Block :—				
28M/10287	AGS.2001/B/1	Nut, 4 BA ...	2	—	C	
5X/9450403	PLESSEY Z.28426	Pillar, fixing, 4 BA ...	2	—	C	ECP1
	10-22 N 2025A	BRACKET , mounting, terminal block and relay assembly	1	—	—	ECP1
		Attachments for 10-22 N 2025A, Bracket :—				
28D/1010658	A25/1B	Bolt, 4 BA ...	2	—	C	
28W/9419401	SP.10/B	Washer ...	2	—	C	

ELECTRICAL INSTALLATIONS

INSTALLATION OF ICE DETECTOR, CODED "WM"

Ref. No.	Part No.	Description	No. off						Material Specification	Class of Score or L.M	Plate No.
			1	2	3	4	5	6			
5X/3272	PLESSEY CZ.26799	COVER , terminal block						1	—	C	ECP1
	—	RELAY , magnetic, coded "ACJ-A" (See sub-section ECX)						—	—	—	
	—	BLOCK , terminal, coded "AV," group						1	—	—	
	DHS.456/20	BLOCK , terminal, 20-way, assembly (For breakdown see DHS. Data Sheet)						1	—	—	
5X/9149643	PLESSEY CZ.25111	COVER , terminal block						1	—	C	BA13
5X/9450403	PLESSEY Z.28426	PILLAR , fixing						2	—	C	ECP1
5195	DHS.849	SCREW , 6 BA (Fit at terminal No. 7)						1	BS.259	C	ECP1
	—	BLOCK , terminal, "AX" group						1	—	—	
	DHS.456/2	BLOCK , terminal, 2-way, assembly (For breakdown see DHS. Data Sheet)						1	—	—	ECP1
5X/3272	PLESSEY CZ.26799	COVER , terminal block						1	—	C	ECP1
5X/9450403	PLESSEY Z.28426	PILLAR , fixing						2	—	C	ECP1
	—	BLOCK , terminal, coded "AZ," group						1	—	—	
	DHS.456/20	BLOCK , terminal, 20-way, assembly (For breakdown see DHS. Data Sheet)						1	—	—	
5X/9149643	PLESSEY CZ.25111	COVER , terminal block						1	—	C	BA13
5X/9450403	PLESSEY Z.28426	PILLAR , fixing						2	—	C	ECP1
	10-20 N 14089A	CABLE , bung Q3, coded "FB," assembly (For cables circuit coded "WM")						1	—	ECC	
	10-20 N 14337A	CABLE , bung Q6, coded "FA," assembly (Mod. 728) (For cables circuit coded "WM")						1	—	ECC	
	10-20 N 5633A	CABLE , coded "AB.1," assembly						1	—	ECC	
	10-20 N 5635A	CABLE , coded "AB.2," assembly						1	—	ECC	
	10-20 N 15677A	CABLE , "AW-ACJ," assembly (Mod. 825)						1	—	ECC	
	10-20 N 9/123 Mk. 1	CABLE , coded "10.AV.WMA-WMA.H.CV.20," assembly						1	—	ECC	
	10-20 N 9/123 Mk. 2	CABLE , coded "7.AV.WMA★-WMA★.★1.C.7," assembly						1	—	ECC	
	10-20 N 9/123 Mk. 23	CABLE , coded "1.AX.WMA-WMA.AV.5," assembly						1	—	ECC	
	10-20 N 9/123 Mk. 24	CABLE , coded "1.AX.WM-WM.ACJ.1," assembly (Mod. 825)						1	—	ECC	
	10-20 N 9/123 Mk. 25	CABLE , coded "2.AX.WM-WM.ACJ.2," assembly (Mod. 825)						1	—	ECC	
	10-20 N 22903/CABLES	CABLES , link, assembly (Mod. 1000) (For cables circuit coded "WM")						QR	—	ECC	
	—	RELAY , ice detector, c/w mountings, coded "AB," group						1	—	—	
11935	10-20 S 12601	ADAPTER						1	L.65	C	ECP1
17495	10-20 N 9821A/ND	MOUNTING , anti-vibration and tray, assembly						1	—	C	ECP1
28D/9294	AS.1242/5B	BOLT , 4 BA, anti-vibration mounting						4	—	C	
5K/3335	AS.3360/B4B	LEAD , bonding						2	—	C	
		Attachments for Ref. No. 5K/3355, Lead :—									
28D/8300	AS.1242/1B	Bolt, 4 BA						1	—	C	
28M/10287	AGS.2001/B/1	Nut, 4 BA						1	—	C	
28W/9419465	SP.13/B	Washer						1	—	C	
10AJ/155	—	MOUNTING , anti-vibration pedestal type						4	—	P	
	10-20 N 9157A	MOUNTING , tray, assembly						1	—	—	ECP1

ELECTRICAL INSTALLATIONS

INSTALLATION OF ICE DETECTOR, CODED "WM"

Ref. No.	Part No.	Description	No. off	Material Specification	Class of Store or L.M	Plate No.
7334	10-20 N 5051	NUT , 4 BA, anti-vibration mounting ... Attachments for 10-20 N 9821A/ND, Mounting :-	4	—	C	ECP1
28D/1008149	A25/2B	Bolt, 4 BA	16	—	C	
28M/10287	AGS.2001/B/1	Nut, 4 BA	16	—	C	
28W/9419401	SP.10/B	Washer	16	—	C	
12675	10-20 N 7643	NIPPLE	1	—	C	ECP1
17494	10-20 N 9137A	PLATE , mounting, ice detector relay, assembly Spares for :-	1	—	C	ECP1
	10-20 N 10111A/ND	PIN , pip, assembly	2	—	—	ECP1
	—	CORD , waxed, 6"-0 long	QR	—	—	
28FP/1	AVDEL LTD. 3201-403	PIN , "Pip," Type A	1	—	C	
6A/7676	SMITHS 25D1	RELAY , unit, ice detector (Mod. 1161) Attachments for 25D1, Relay :-	1	—	—	ECP1
28D/1007976	AS.1242/4C	Bolt, 2 BA	4	—	C	
28M/10288	AGS.2001/C/1	Nut, 2 BA	4	—	C	
28W/9419475	SP.15/C	Washer	4	—	C	
	—	INSTALLATION AT P.A.S. PANEL CODED "AU" (Drg. No. 10-20 F 3887)	1	—	—	
5CZ/6256	DOWTY C.5165Y.P.14	INDICATOR , electro magnetic, coded "D" ... (Mod. 810, Pre Mod. 1050)	1	—	P	
	DOWTY					
5CZ/6696	DN.1245Z.Mk. 53	INDICATOR , electro magnetic, coded "D" ... (Mod. 1050)	1	—	P	
5CZ/6257	DOWTY C.6156Y.P.44	INDICATOR , electro magnetic, coded "E" ... (Mod. 810, Pre Mod. 1050)	1	—	P	
	DOWTY					
5CZ/6697	DN.1245Z.Mk. 62	INDICATOR , electro magnetic, coded "E" ... (Mod. 1050)	1	—	P	
5CZ/6024	THORN 80/10/0287	PLATE , pressure, at indicator	2	—	C	EBG1A
5D/1975	THORN 80/10/0292	RECEPTACLE , at indicator	2	—	C	EBH1A
	HONEYWELL					
	2TL1-1A	SWITCH , coded "C"	1	—	P	
	—	INSTALLATION AT LOWER PANEL, CODED "H" (Drg. Nos. 10-20 N 15833A Pre Mod. 803 and 10-20 N 15709A Mod. 803)	1	—	—	
	—	BLOCK , fuse, coded "CV," group	1	—	—	
	—	BLOCK , fuse, 12-way (See sub-section EBV)	—	—	—	
10H/23862	—	FUSE , 10 amp.	1	—	C	

ELECTRICAL INSTALLATIONS

INSTALLATION OF ICE DETECTOR, CODED "WM"

Ref. No.	Part No.	Description	No. off	Material Specification	Class of Score or L.M.	Plate No.
	—	INSTALLATION AT FRAME 96" (Drg. No. 10-20 N 13463)	1	—	—	
26DV/7529	DHS.438/C	TERMINAL , earth, stn. 1, coded "C," group	1	—	—	
26DV/4969	DHS.437/C	TAG , corrosion	1	—	C	
		TERMINAL , earth, assembly (For breakdown see DHS. Data Sheet)	1	—	C	
		Attachments for DHS.437/C, Terminal:—				
28D/9137409	AS.1246/2C	Bolt, 2 BA	2	—	C	
28M/10298	AGS.2001/C/1	Nut, 2 BA	2	—	C	
28W/9419404	SP.16/C	Washer	2	—	C	
	—	INSTALLATION AT STARBOARD WING DECK PANEL, CODED "FB" (Drg. Nos. 10-20 N 14863A, 10-20 N 11143 and 10-20 N 14899A)	1	—	—	
	—	BLOCK , fuse, coded "T," group	1	—	—	
10H/23862	—	BLOCK , fuse, 12-way (See sub-section EBV)	—	—	—	
	—	FUSE , 10 amp.	4	—	C	
	DHS.456/20	BLOCK , terminal, coded "D," group	1	—	—	
		BLOCK , terminal, 20-way, assembly (For breakdown see DHS. Data Sheet)	1	—	—	
14987	10-20 N 8231	PILLAR , fixing, 4 BA	2	—	C	EBG1A
28W/9419474	SP.15/B	WASHER	2	—	C	
	DHS.456/20	BLOCK , terminal, coded "F," group	1	—	—	
		BLOCK , terminal, 20-way, assembly (For breakdown see DHS. Data Sheet)	1	—	—	
14987	10-20 N 8231	PILLAR , fixing, 4 BA	2	—	C	EBG1A
28W/9419474	SP.15/B	WASHER	2	—	C	
	10-20 N 9/123 Mk. 21	CABLE coded "7.D.FB.WMB-WMB.FE.B.4," assembly	1	—	ECC	
	10-20 N 9/123 Mk. 22	CABLE , coded "8.D.FB.WMC-WMC.FE.B.3," assembly	1	—	ECC	
	10-20 N 9/123 Mk. 20	CABLE , coded "9.D.FB.WME-WME.FF.A.14," assembly	1	—	ECC	
	10-20 N 9/123 Mk. 19	CABLE , coded "10.D.FB.WMD-WMD.FF.A.11," assembly	1	—	ECC	
	10-20 N 9/123 Mk. 13	CABLE , coded "19.F.FB.WMA-WMA.HD.2," assembly	1	—	ECC	
	10-20 N 9/123 Mk. 14	CABLE , coded "20.F.FB.WMA-WMA.HD.1," assembly	1	—	ECC	
	10-20 N 9/123 Mk. 15	CABLE , coded "20.F.FB.WMA-WMA.FA.E.3," assembly	1	—	ECC	
	10-20 N 9/123 Mk. 11	CABLE , coded "1a.M.FB.WMB-WMB.FE.A.19," assembly	1	—	ECC	
	10-20 N 9/123 Mk. 10	CABLE , coded "2a.M.FB.WMB-WMB.FE.A.16," assembly	1	—	ECC	
	10-20 N 9/123 Mk. 9	CABLE , coded "3a.M.FB.WMC-WMC.FE.A.8," assembly	1	—	ECC	
	10-20 N 9/123 Mk. 8	CABLE , coded "4a.M.FB.WMC-WMC.FE.A.7," assembly	1	—	ECC	
	10-20 N 9/123 Mk. 7	CABLE , coded "5a.M.FB.WMD-WMD.FF.A.12," assembly	1	—	ECC	
	10-20 N 9/123 Mk. 6	CABLE , coded "6a.M.FB.WMD-WMD.FF.A.15," assembly	1	—	ECC	

INSTALLATION OF ICE DETECTOR, CODED "WM"

Ref. No.	Part No.	Description	No. off	Material Specification	Class of Store or L.M.	Plate No.
	10-20 N 9/123 Mk. 5	CABLE , coded "7a.M.FB.WME-WME.FF.A.4," assembly	1	—	ECC	
	10-20 N 9/123 Mk. 4	CABLE , coded "8a.M.FB.WME-WME.FF.A.3," assembly	1	—	ECC	
	10-20 N 9/123 Mk. 12	CABLE , coded "Ca.M.FB.WMA-WMA★.★8.C.6," assembly	1	—	ECC	
	10-20 N 14899A/ CABLES	CABLES , link, assembly (Mods 372 and 482) ... (For cables circuit coded "WM")	QR	—	ECC	
	10-20 N 9201A	RELAYS , coded "AS," "AT" and "AU," complete with bracket, assembly	1	—	—	
9774	10-20 N 8905	BRACKET , mounting ...	1	—	C	ECP1
	10-20 N 9201A/ CABLES	CABLE , assembly ...	1	—	ECC	
10F/Z.530453	—	RELAY ...	3	—	P	
	28M/10286	Attachments for Ref. No. 10F/Z.530453, Relay :—				
28W/9419464	AGS.2001/A/1 SP.13/A	Nut, 6 BA ...	2	—	C	
	28D/11937	Washer ...	2	—	C	
28W/9419465	AS.1246/1B SP.13/B	Attachments for 10-20 N 9201A, Relays :—				
	5CW/6853	Bolt, 4 BA ...	2	—	C	
	28S/1200080	Washer ...	2	—	C	
	28S/13887	SWITCH , magnetic, Type 10B, No. 15, coded "M"	1	—	P	
28W/1200328	A32/B8 A32/B10 AGS.2037/B	Attachments for Ref. No. 5CW/6853, Switch :—				
	—	Screw, 4 BA ...	1	—	C	
	—	Washer, shakeproof ...	2	—	C	
	—	INSTALLATION AT RIB "O," CENTRE SECTION (Drg. No. 10-20 N 11143)	1	—	—	
	—	TERMINAL , earth, station 8, coded "C" and "D" group	1	—	—	
26DV/7529	DHS.438/C	TAG , corrosion ...	2	L.16	C	
26DV/4969	DHS.437/C	TERMINAL , earth, assembly ... (For breakdown see DHS. Data Sheet)	2	—	C	
	28M/10328	Attachments for DHS.437/C, Terminal :—				
28S/15552	AGS.2002/C/1 A32/C18	Nut, 2 BA ...	2	—	C	
28W/9419402	SP.13/C	Screw, 2 BA ...	2	—	C	
	—	Washer ...	2	—	C	
	—	INSTALLATION AT PORT WING DECK PANEL, CODED "FA" (Drg. Nos. 10-20 N 11143 and 10-20 N 13301A)	1	—	—	
	DHS.456/20	BLOCK , terminal, coded "E," group ...	1	—	—	
	14987	BLOCK , terminal, 20-way, assembly ... (For breakdown see DHS. Data Sheet)	1	—	—	
28W/9419474	10-20 N 8231 SP.15/B	PILLAR , fixing ...	2	S.92	C	EBG1A
	10-20 N 9/123 Mk. 17	WASHER ...	2	—	C	
	10-20 N 9/123 Mk. 16	CABLE , coded "2.E.FA.WMA-WMA.HC.1," assembly	1	—	ECC	
		CABLE , coded "3.E.FA.WMA-WMA.HC.2," assembly	1	—	ECC	

ELECTRICAL INSTALLATIONS
INSTALLATION OF ICE DETECTOR, CODED "WM"

Ref. No.	Part No.	Description	No. off	Material Specification	Class of Store or L.M.	Plate No.
	—	INSTALLATION AT PORT AND STARBOARD ENGINE AIR INTAKES (Drg. Nos. 10-20 WC 12903-4 Pre Mod. 846 and 10-20 WC 31705-6 Mod. 846)	1	—	—	
	—	FLAMESTAT , coded "HC" and "HD," group	1	—	—	
	10-20 WC 13229	BRACKET , flamestat attachment, 20 SWG ...	2	L.72	LM	ECP1
28D/9436920	A25/1C	Attachments for 10-20 WC 13229, Bracket :—	2	—	C	
28W/9419402	SP.13/C	Bolt, 2 BA	2	—	C	
		Washer	2	—	C	
5CW/6647	TEDDINGTON CONTROLS FHO/A/529	FLAMESTAT , Type 500 series (Pre Mod. 846)	2	—	P	
5CW/—	TEDDINGTON CONTROLS FHO/A/596	FLAMESTAT , Type 500 series (Mod. 846) ...	1	—	—	
	10-20 WC 13253ND	PACKING , for flamestat, 0"-25 thick	2	Asbestos	LM	
	—	INSTALLATION AT FORWARD PORT ENGINE BAY (Drg. No. 10-20 N 5123)	1	—	—	
	DHS.456/20L	BLOCKS , terminal, 20-way, coded "FEA" and "FEB" assembly (For breakdown see DHS. Data Sheet)	2	—	—	
28D/12182	AS.1246/6B	Attachments for DHS.456/20L, Block :—	2	—	C	
28W/9419465	SP.13/B	Bolt, 4 BA	2	—	C	
		Washer	2	—	C	
	10-20 N 5071A	CABLE , coded "FV," assembly (For cables circuit coded "WM")	1	—	ECC	
26DV/4969	DHS.437/C	TERMINAL , earth, station 9, coded "A," group	1	—	—	
		TERMINAL , earth, assembly (For breakdown see DHS. Data Sheet)	1	—	C	
28M/10288	AGS.2001/C/1	Attachments for DHS.437/C, Terminal :—	2	—	C	
28S/15552	A32/C18	Nut, 2 BA	2	—	C	
28W/9419402	SP.13/C	Screw, 2 BA	2	—	C	
2034	DHS.776/C/1	Washer	4	DTD.171	C	
		Washer, between terminal back plate and web	1	—	C	
	—	INSTALLATION AT FORWARD STARBOARD ENGINE BAY (Drg. No. 10-20 N 5125)	1	—	—	
	DHS.456/20L	BLOCK , terminal, 20-way, coded "FFA," assembly (For breakdown see DHS. Data Sheet)	1	—	—	
28D/12182	AS.1246/6B	Attachments for DHS.456/20L, Block :—	2	—	C	
28W/9419465	SP.13/B	Bolt, 4 BA	2	—	C	
		Washer	2	—	C	
	10-20 N 5057A	CABLE , coded "FX," assembly (For cables circuit coded "WM")	1	—	ECC	
32B/	—	TAPE , identification, numbers and letters, use from Ref. Nos. 32B/1087 to 32B/1120 inclusive, as required	QR	—	C	

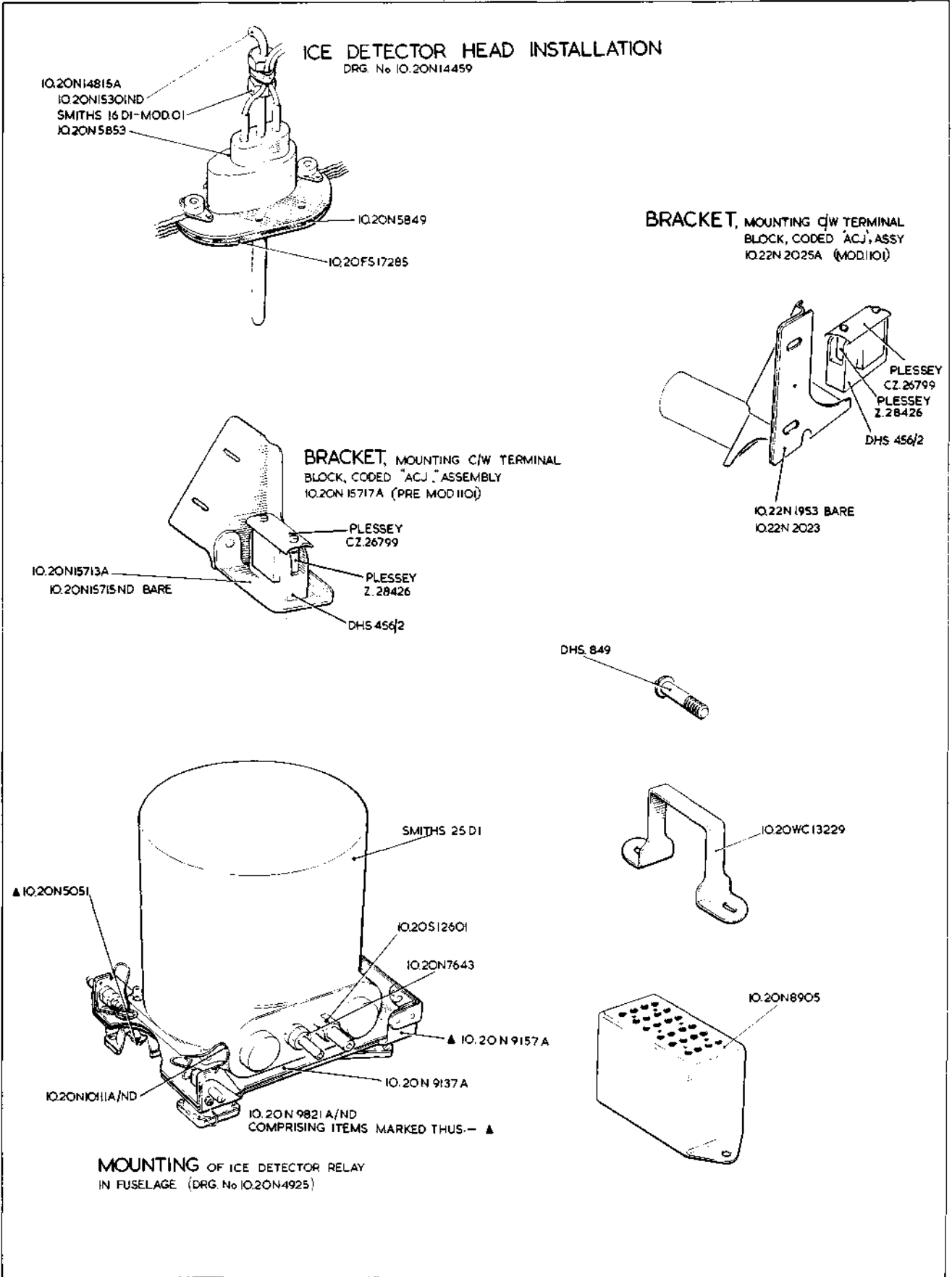

This file was downloaded
from the RTFM Library.

Link: www.scottbouch.com/rtfm

Please see site for usage terms,
and more aircraft documents.

