

**EQUIPMENT, GROUND
SPECIAL TOOLS
(SPECIAL ORDER ONLY)**

Ref. No.	Part No.	Description	No. off	Material Specification	Class of Store or L.M	Plate No.
	—	TOOLS, SPECIAL (Drg. No. 10-20 Y 3) (SPECIAL ORDER ONLY)	1	—	—	
	—	TOOLS, ARMAMENT SERVICING , group ...	1	—	—	
95380	10-20 Y 5505A	ADAPTER , hoisting, " Bull Pup " and heavy stores pylon, assembly (Mod. 8098)	1	—	P	HB8
11A/4678	10-20 Y 2715	ADAPTER , spanner, for use with " Acratork " spanner Model B/6, when fitting light stores pylon to wing	2	S.96	C	HB1
11A/4680	10-20 Y 2355	ADAPTER , spanner, for use with " Acratork " spanner Model B/6, when fitting heavy stores pylon to wing	2	S.96	C	HB1
11A/4677	10-20 Y 1781	ADAPTER , spanner, for use with " Acratork " spanner Model B/6, when fitting stores to heavy stores pylon	2	S.96	C	HB1
95337	10-20 Y 4963	ADAPTER , for use with " Acratork " spanners Model B/3 when fitting 1000 lb. bomb ; or Model A/1 when fitting 25 lb. practice bombs carrier to heavy stores pylons (Mod. 8044)	1	—	P	HB8
	ML. AVIATION					
75R/8	HT.1604/1700/A	ADAPTER , winching, for " Firestreak " shoe ...	1	—	P	
95382	10-20 Y 8813A	BEAM , hoisting, pylon, " Bull Pup," assembly (Mod. 8084) Spares for :—	1	—	P	HB8
96380	10-20 Y 8835A	BOLT , wing, assembly	1	—	C	HB8
96379	10-20 Y 8833	TRUNNION , inner	2	S.96	C	HB8
96378	10-20 Y 8831	TRUNNION , outer Attachments for 10-20 Y 8833 and 10-20 Y 8831, Trunnion (per set) :—	2	S.96	C	HB8
28D/12776	A25/41J	Bolt, 3/8" BSF	1	—	C	
28M/1007404	A27/JT	Nut, 3/8" BSF	1	—	C	
11A/4402	10-20 Y 2085A 6 Y 37ND	BRACE , for heavy stores pylon screw-jack, assembly HANDLE Attachments for 6 Y 37ND, Handle :—	1	—	P	HB1
			1	Hardwood	LM	HB1
28M/12928	A27/EP	Nut, 1/2" BSF	1	—	C	
28W/9418921	SP.13/E	Washer	2	—	C	
95405	10-20 Y 9023A	BUNG , rain shedding duct (Mod. 8086) ...	1	—	C	HB8
95166	10-20 Y 2855A	CLAMP , line of sight, gyro alignment, assembly... (Mod. 8006) Spares for :—	2	—	P	HB1
96126	10-20 Y 1777	BOLT , special	1	S.96	C	HB1
96127	10-20 Y 1779	NUT , special, knurled	1	S.96	C	HB1
28M/803	AGS.120/A	NUT , wing	1	—	C	
	10-20 Y 2863	PLATE , 6 SWG	1	L.72 or L.65	LM	HB1
95379	10-20 Y 8891A	COLUMN , hoisting, " Bull Pup " and heavy stores pylon, assembly (Mod. 8098) Spares for :—	1	—	P	HB8
	10-20 Y 5515	APRON , rubber, 9'-0" x 8'-0" x 1/8" thick (bond to base to process DHA.437)	1	Neoprene DHA.65	LM	HB8

**EQUIPMENT, GROUND
SPECIAL TOOLS
(SPECIAL ORDER ONLY)**

Ref. No.	Part No.	Description	No. off	Material Specification	Class of Store or L.M	Place No.
96369	10-20 Y 8931	TRUNNION	1	S.96	C	HB8
28D/15082	A25/45J	Attachments for 10-20 Y 8931, Trunnion :—	1	—	C	
28M/1007404	A27/JT	Bolt, 3/8" BSF	1	—	C	
95312	10-20 Y 4915A	CONNECTOR , "Firestreak" ground cooling from Mk. 2A Radar cooling trolley (Mod. 8035)	1	—	P	HB8
11A/5023	M.L. AVIATION FX.1095-390B	HANDLE , crutching, c/w adapter, assembly ...	2	—	C	
95327	10-20 Y 5031A	INSTRUMENTS AND CASE , sight alignment, complete (Mod. 8043, Pre Mod. 8088) (For use on Pre Mod. 1068 A/c) Spares for :—	1	—	P	HB1
96347	12-20 Y 601A	ADAPTER , plumb bob, assembly	2	DTD.423	C	HB1
	10-20 Y 5033A	PILLAR , front, assembly	2	—	—	HB1
	10-20 Y 3121A	PILLAR , rear, assembly	2	—	—	HB1
		Spares for :—				
96126	10-20 Y 1777	BOLT , 2 BA, eye-piece clamping	1	S.96	C	HB1
	4 Y 479A	FLAG , assembly	1	Red Calico	LM	HB1
96127	12-20 Y 1779	NUT , knurled, 2 BA, eye-piece clamping	1	S.96	C	HB1
95378	10-20 Y 9129A	INSTRUMENT AND CASE , 20 m/m sight alignment, complete (Mod. 8088) (For use on A/c embodying Mod. 1068) Spares for :—	1	—	P	HB1
96347	12-20 Y 601A	ADAPTER , plumb bob, assembly	2	DTD.423	C	HB1
	10-20 Y 8129A	INSTRUMENT , 20 m/m sight alignment, assembly Spares for :—	1	—	—	HB1
7R/292	CHAS. BAKER	HEAD , optical	1	—	P	HB1
7G/1445	—	INSTRUMENT , weapon alignment (For A/c and "Firestreak" alignment—for use with 10-20 Y 5031A)	2	—	P	
11A/4968	—	KIT , tool, for Ejector release unit No. 2 Mk. 1, heavy stores pylons (For spares see AP.1086, Book 5, Sect. 11A)	1	—	P	
95122	10-20 Y 2919	NUT , hoist crunnion, mounting spider for alignment projector (Mod. 8007) (First 9 A/c only)	4	S.92	C	HB1
	10-20 Y 8723A	POST , support, for use with adapter and "Acratork" spanner Model B/6, when fitting heavy stores to pylons (Mod. 8073)	1	—	—	HB7
NAVAL PATT.		PROJECTOR , alignment	1	—	P	
F6A/9195	—	RIG , test, for setting and testing torque spanners	1	—	P	
6A/2239	—	SPANNER , "Acratork" Model A/1, 5-50 lbs./ft., for use when fitting 1000 lb. bomb and practice carrier to heavy stores pylon (Mod. 8044)	1	—	P	
11A/4757	—	SPANNER , "Acratork" Model B/6 (For use when fitting pylons and heavy stores to wing)	1	—	P	
1L/171	—	SPANNER , "Acratork" Model B/3, 20-100 lbs./ft.	1	—	P	
11A/4946	10-20 Y 2971A	SPANNER , for retaining ring, fuel tank pylon, assembly (First 14 Aircraft only)	1	—	P	HB1
	10 Y 257	TOMMY-BAR , 3/8" dia. x 7"0 long	1	S.93	LM	HB1

**EQUIPMENT, GROUND
SPECIAL TOOLS
(SPECIAL ORDER ONLY)**

Ref. No.	Part No.	Description	No. off	Material Specification	Class of Store or L.M.	Plate No.
95109	10-20 Y 3221A	SPANNER , special, for use with spigot nut, light stores pylon, assembly (Part No. 10-20 WC 26213), assembly	1	—	C	HB1
	ROSS LTD.					
95125	1-136.C.22	SPIDER , mounting, for alignment projector ...	1	—	P	
95124	10-20 Y 2395A	SWITCH-KEY , armament ground test, assembly	1	—	C	HB2
	4 Y 479A	Spares for :— FLAG , red, assembly	1	Calico	LM	HB2
28E/15825	TERRY Type 169	Attachment for 4 Y 479A, Flag :— Ring, split, 1/2" dia.	1	—	C	
95139	10-20 Y 3593A	TOOL-BOX , L.A.B.S. gyro levelling, assembly (Mod. 8012) Spares for :—	1	—	P	HB3
95144	10-20 Y 3475A	ADAPTER , levelling, assembly Spares for :—	1	—	P	HB3
96152	10-20 Y 3477	SCREW , knurled, 1/4" x 28 UNF	1	S.96	C	HB3
95392	10-20 Y 5527	BOLT , knurled head, No. 8, 32 UNC, levelling platform (Mod. 8113)	4	S.96	C	HB3
95140	10-20 Y 3591	HEAD , optical	1	—	P	HB3
95141	10-20 Y 3445A	HEAD , sight, assembly Spares for :—	1	—	P	HB3
96150	10-20 Y 3453	BOLT , special, 2 BA	1	S.96	C	HB3
96127	10-20 Y 1779	NUT , special, knurled, 2 BA	1	S.96	C	HB3
26FC/6751	DHS.94/5/90	PIN , 3/8" dia., ground steel, securing spigot	1	S.96	C	HB3
	10-20 Y 3449	SPIGOT , flanged	1	S.110	—	HB3
95393	10-20 Y 9593A	PLATFORM , levelling, assembly (Mod. 8113)	1	—	P	HB3
96149	10-20 Y 3671	SPRING , optical head securing	1	Spr. Stl.	C	HB3
95121	10-20 Y 2917	TRUNNION , hoist, mounting spider for alignment projector (Mod. 8007) (First 9 A/C only)	4	S.92	C	HB2
	M.L. AVIATION LTD.					
11A/5025	FX1095-494C	WRENCH , for lock-ring	2	—	C	
	—	WRENCH , "Springtork," group	1	—	—	
NAVAL PATT.						
B11/	BRITTOOL D.30	HOLDER , bit	1	—	C	
NAVAL PATT.						
B11/	BRITTOOL M.24	BIT , screwdriver	1	—	C	
NAVAL PATT.						
B11/	BRITTOOL Type MT52 OR DT.52	WRENCH , "Springtork"	1	—	P	

**EQUIPMENT, GROUND
SPECIAL TOOLS
(SPECIAL ORDER ONLY)**

Ref. No.	Part No.	Description	No. of	Material Specification	Class of Store or L.M.	Plate No.
	—	TOOLS, FLYING CONTROLS SERVICING, group	1	—	—	
27KH/2792	HOBSON CH.105194	ADAPTER , for use with "Northbar" spanner No. 2 (Elevator)	1	—	P	
27KH/2781	HOBSON CH.105747	ADAPTER , "C" Type, for "Northbar" torque spanner (Aileron)	1	—	P	
27KH/2448	HOBSON CHA.96792	ADAPTER , socket, for retaining ring ... (Hobson Part No. CH.78286) (Elevator)	1	—	P	
27KH/2493	HOBSON CHA.105702	FIXTURE , for centralising rudder lever in aircraft (Hobson Part No. CH.82951)	1	—	P	
95081	10-20 Y 2257A	GAUGE , neutral setting for aileron booster, assembly Spares for :—	2	—	C	HB2
—	10-20 Y 2483ND	CABLE , 5 cwt., securing flag (Make from Ref. No. 28X/3495)	1	W9/4P	LM	HB2
	4 Y 479A	FLAG , red, assembly ...	1	Calico	LM	HB2
28Y/3004	SP.66/A	THIMBLE ...	1	—	C	
95078	10-20 Y 429A	GAUGE , neutral setting for tail-plane booster, assembly Spares for :—	2	—	C	HB2
	10-20 Y 3105ND	CABLE , 5 cwt., securing identification label ... (Make from Ref. No. 28X/3495)	1	W9/4P	LM	
27KH/2477	HOBSON CH.91416	PLATE , lever locking, for lever (Hobson Part No. CH.83196) (Aileron)	1	—	P	
64TT/10	D.H. ENGINE CO. T.72170	SPANNER , adjustable "C" Type ...	1	—	C	
27KH/2461	HOBSON CH.96759	SPANNER , "C" Type, for locknut (Hobson Part No. CH.79356) (Aileron)	1	—	P	
27KH/2443	HOBSON CH.96776	SPANNER , "C" Type, for locknut (Hobson Part No. CH.85916) (Elevator)	1	—	C	
95089	10-20 Y 1809	SPANNER , double-ended, for retaining ring, tail-plane inboard bearing (Part No. 10 CF 5845) and retaining cap nut tailplane inner bearing, elevator track (Part No. 10-20 CF 2283)	1	—	C	HB2
95309	10-20 Y 4699	SPANNER , for retaining nut, flap mechanism at Rib "O" (Part No. 10 CF 2579) (Mod. 8039)	1	S.514	C	HB2
27KH/2488	HOBSON CH.96782	SPANNER , open-ended (Rudder) ...	2	—	P	
27KH/—	HOBSON CH.105712/4	SPANNER , torque, "Northbar," No. 4 ...	1	—	—	
	STURGESS T5-5003/106/00	TENSIOMETER , cable, with Type "2C" and "3A" risers	1	—	—	
	OR					
NAVAL PATT. B10G/12947	—	TENSIOMETER , cable, complete with Nos. 1 to 4 risers	1	—	P	
1C/6134	R.A.E. SME. Mk. 3. No. 2226	TENSIOMETER , cable, 5 cwt. to 10 cwt. ...	1	—	P	
1C/6135	R.A.E. SME. Mk. 4. No. 1241	TENSIOMETER , cable, 15 cwt. ...	1	—	P	

**EQUIPMENT, GROUND
SPECIAL TOOLS
(SPECIAL ORDER ONLY)**

Ref. No.	Part No.	Description	No. off	Material Specification	Class of Score or L.M.	Plate No.
	—	TOOLS, FUEL SYSTEM SERVICING, group ...	1	—	—	
27F/2729	AVERY-HARDOLL Type FC-104	COUPLING-UNIT, pressure fuelling ...	2	—	P	
95403	10-20 Y 9693A	DRAINER, universal, for fuel tank water drains, assembly (Mod. 8068)	1	—	P	HB2
95003	10 Y 1053A	SPANNER, for fuel tank drain valves and water drains	1	—	C	HB2
95313	10-20 Y 4721A	SPANNER, for Northbar torque spanner No. 4, used on threaded ring, refuelling in flight probe, assembly (Mod. 8022)	1	—	P	HB7
		Spares for :—				
96165	10-20 Y 4723	PIN, clevis, "90 long ...	1	S.96	C	HB7
96166	10-20 Y 4725	PIN, clevis, 1"-20 long ...	1	S.96	C	HB7
28P/1007741	SP.9/C8	PIN, split ...	2	—	C	
95208	10-20 Y 3953A	TOOL, for operation of tank isolation valve, assembly (Mod. 8024)	2	—	P	HB2
96072	10-20 Y 2681	NUT, cap ...	1	S.93	C	HB2
28P/1011036	SP.9/G8	PIN, split, securing slip-ring ...	1	—	C	
	10-20 Y 3951A/ND	SLIP-RING AND FLAG, assembly ...	1	—	—	HB2
	10-20 Y 3975ND	CABLE, 3 cwt. (Make from Ref. No.28X/5450)	1	W9/1P	LM	
	4 Y 479A	FLAG, red, assembly ...	1	Calico	LM	HB2
	10-20 Y 3919	LABEL, " Ensure Valve assembled," 20 SWG	1	L.72	LM	
	10-20 Y 2825	SLIP-RING, 16 SWG ...	1	S.510	—	HB2
	10-20 Y 3921	SPINDLE ...	1	S.93	—	HB2
28Y/3004	SP.66/A	THIMBLE, flag and cable attachment ...	1	—	C	
	10-20 Y 3777A	TOOL, fuel pipe connection alignment at wing-fold assembly	1	—	—	HB2
95404	10-20 Y 9619A	TOOL, fuel tank water drain at rib 4A, assembly (Mod. 8068)	1	—	P	HB2
95002	10 Y 1045A	TOOL, release for fuel drain valves, assembly ...	1	—	P	HB2
		Spares for :—				
96109	10 Y 1561A	ADAPTER, release, assembly ...	1	—	C	HB2
28E/9128961	AGS.605 Mk. 1	CLIP, hose, adjustable ...	1	—	C	
	AS.2584	CONNECTION, tank drainage, 1 1/4" drain valve	1	—	—	
NAVAL PATT. B8/4K/2477	AS.2587	ADAPTER, hose ...	1	—	P	
NAVAL PATT. B8/4K/2478	AS.2585	NUT, union ...	1	—	C	
	10 Y 1047ND	HOSE, kerosene resistant, 1 1/4" i/d ...	1	—	—	HB2

**EQUIPMENT, GROUND
SPECIAL TOOLS
(SPECIAL ORDER ONLY)**

Ref. No.	Part No.	Description	No. off	Material Specification	Class of Store or L.M.	Place No.
	—	TOOLS, MAIN AND NOSE UNDERCARRIAGE AND WING-FOLD, group	1	—	—	
95028	10-20 Y 205A	BAR , manual unlocking for wing-fold latch, assembly	1	—	P	HB3
95027	10-20 Y 203A	BAR , manual withdrawal for wing-fold latch, assembly	1	—	P	HB3
2A/9500569	—	Spares for :— BALL , steel, $\frac{1}{4}$ " dia. spring-loaded at tip of bar	2	—	C	HB3
95116	10-20 Y 2977	BULLET , locating, for wing hinge pin ...	1	—	C	HB3
95308	10-20 Y 4219A	EXTRACTOR AND ASSEMBLER , for removal and replacement of wing-fold bushes (complete in container), assembly (Mod. 8028)	1	—	P	HB3
		Spares for :—				
	10-20 Y 2173	BLOCK , assembler ...	1	S.96	—	HB3
	10-20 Y 2169	BLOCK , extractor or assembler ...	1	S.96	—	HB3
	10-20 Y 2165	BOLT , extractor or assembler, $\frac{1}{4}$ " BSF ...	1	S.82	—	HB3
	10-20 Y 2175	GUIDE , assembler ...	1	S.96	—	HB3
	10-20 Y 4213	GUIDE , assembler ...	1	S.96	—	HB3
	10-20 Y 2177	NUT , assembler ...	1	S.96	—	HB3
	10-20 Y 4211	NUT , assembler ...	1	S.96	—	HB3
	10-20 Y 2167	NUT , extractor ...	1	S.96	—	HB3
26DL/95067	6 Y 377A	EXTRACTOR , dowel nosewheel steering head and oleo leg, assembly (Part Nos. 10-20 UN 113 and 10-20 UN 157)	1	—	C	HB3
		Spares for :—				
	6 Y 379	BOLT , extractor, threaded 2 BA $\times \frac{1}{4}$ " BSF $\times \frac{3}{8}$ " BSF	1	S.11	LM	HB3
28M/1011473	A27/JP	NUT , $\frac{3}{8}$ " BSF ...	1	—	C	
95326	10-20 Y 5043A/ND	FIXTURE , boring, for reaming bush front top latch fitting, wing-fold, Port (Drg. JXT.9666) (Mod. 8032)	1	—	P	HB7
95354	10-20 Y 5044A/ND	FIXTURE , boring, for reaming bush front top latch fitting, wing-fold, Starboard (Drg. JXT.9667) (Mod. 8032)	1	—	P	HB7
95074	10-20 Y 451A	GAUGE , offset alignment, for nose leg radius rod, assembly	1	—	C	HB4
96168	10-20 Y 5045ND	REAMER , for bush, front top latch fitting, wing-fold (Drg. JXT.9673) (Mod. 8032)	1	—	P	HB7
95018	10 Y 223A	SPANNER , for air head plug, main u/c shock absorber, assembly (Part No. 10-20 U 67)	1	—	C	HB4
95075	10 Y 235A	SPANNER , for alignment of axle, nosewheel u/c, assembly (Part No. 10-20 UN 331)	1	—	C	HB4
		Spares for :—				
	10 Y 257	TOMMY-BAR , $\frac{3}{8}$ " dia. \times 7"-0 long ...	1	S.93	LM	HB4
95086	10-20 Y 2179A	SPANNER , for bush alignment, wing-fold, assembly	1	—	C	HB4
95070	10-20 Y 365A	SPANNER , for eccentric bush alignment, main u/c leg side stay, assembly (Part Nos. 10-20 U 1333-4) also used on Lock-head orifice control valve, main u/c leg (Part No. AIR. 67168)	2	—	C	HB4
		Spares for :—				
	10 Y 257	TOMMY-BAR , $\frac{3}{8}$ " dia. \times 7"-0 long ...	1	S.93	LM	HB4

**EQUIPMENT, GROUND
SPECIAL TOOLS
(SPECIAL ORDER ONLY)**

Ref. No.	Part No.	Description	No. of	Material Specification	Class of Store or L/M	Plate No.
95016	10-20 Y 367A	SPANNER , for end plugs, main u/c cross tube, assembly (Part Nos. 10-20 U 179 and 10-20 U 219) Spares for :—	1	S.15	C	HB4
95015	10 Y 257 10-20 Y 363A	TOMMY-BAR , 3/8" dia. x 7"-0 long ... SPANNER , for fluid head retaining nut, main u/c shock absorber, assembly (Part No. 10-20 U 121) Spares for :—	1 1	S.93 —	LM C	HB4 HB3
95001	10 Y 247ND 10 Y 432A	TOMMY-BAR , 3/8" dia. x 12"-0 long ... SPANNER , for gland nut, nosewheel u/c oleo leg, assembly (Part No. 10-20 UN 597) Spares for :—	1 1	Stubbs Silver Steel —	LM C	HB4 HB4
95014	10-20 Y 361A	SPANNER , for gland retaining nut, main u/c shock absorber, assembly ... (Part No. 10-20 U 111)	1	—	C	HB5
96449	10-20 Y 9823	SPANNER , for inner casing sleeve bearing, nose-wheel u/c oleo leg (Mod. 8143) (Part No. 10-20 UN 1191)	1	Tufcor Tool Steel	C	HB4
95068	10-20 Y 447	SPANNER , for nosewheel u/c oleo leg, orifice plate (Part No. 10-20 UN 783)	1	Tufcor Tool Steel	C	HB5
95072	10 Y 229A	SPANNER , for plug, nosewheel u/c axle, assembly (Part No. 10-20 UN 335)	2	—	C	HB4
95069	10 Y 233A	SPANNER , for retaining nut, air chamber main u/c shock absorber and nosewheel u/c axle sleeves, assembly (Part Nos. 10 U 171, 10-20 U 441 and 10-20 U 413) Spares for :—	1	—	C	HB5
95017	10 Y 257 10-20 Y 353A	TOMMY-BAR , 3/8" dia. x 7"-0 long ... SPANNER , for torque link plugs, main u/c shock absorber, assembly (Part Nos. 10-20 U 83 and 10-20 U 85)	1 2	S.93 —	LM C	HB5 HB4
95071	10-20 Y 2309A	SPANNER , for wheel nut main u/c shock absorber, assembly (Part No. 10-20 U 961)	1	—	C	HB5
95076	10-20 Y 445	SPANNER , for wheel nut, nosewheel u/c axle (Part No. 10-20 UN 339)	1	—	C	HB5
95323	10-20 Y 5041A/ND	TOOL , honing, wing-fold bushes (Drg. No. JXT.10453, Mod. 8056) (For breakdown see AP.4647A, Vol. 6)	1	—	P	HB7
4G/5615	—	TOOLS , tyre removal and servicing, group ...	1	—	—	—
4G/6109	DUNLOP A.10351 OR	KIT , tyre inflation ... MACHINE , tubeless tyre removal ...	1 1	— —	P P	— —
4G/6269	DUNLOP A.10444	RIG , tubeless tyre removal ...	1	—	P	—
27A/3991	DUNLOP AM.20734	RING , tyre removal (main wheel) ...	2	—	C	—
27A/4201	DUNLOP AM.20750	RING , tyre removal (nosewheel) ...	2	—	C	—
	—	TOOLS , nosewheel and main wheel tyre removal (See AP.4515C, Vol. 3, Part 1, Sect. 2, Chap. 61)	—	—	—	—

RESTRICTED

**EQUIPMENT, GROUND
SPECIAL TOOLS
(SPECIAL ORDER ONLY)**

Ref. No.	Part No.	Description	No. off	Material Specification	Class of Store or L.M.	Place No.
95408	10-20 Y 9737A	TOOLS, MISCELLANEOUS SERVICING, group	1	—	—	
		BALANCE , spring, auto-throttle checking, assembly (Mod. 8134) Spares for:—	1	—	C	HB9
96418	10-20 Y 9739	BARREL	1	—	C	HB9
96419	10-20 Y 9741	CAP , screw	1	—	C	HB9
	10-20 Y 9755	CRUTCH , 12 SWG	1	L.72	LM	HB9
28S/13314	AS.2993/6E	Attachments for 10-20 Y 9755, Crutch:— Screw, 1/4" BSF	1	—	C	
	10-20 Y 9743	HOOK , 1/2" dia.	1	S.93	LM	HB9
	10-20 Y 9753	POINTER , 20 SWG	1	S.510	LM	HB9
28S/14005	A32/B14	Attachment for 10-20 Y 9753, Pointer:— Screw, round head, 4 BA	1	—	C	
96421	10-20 Y 9747A	SPINDLE , assembly	1	—	C	HB9
96420	10-20 Y 9745	SPRING	1	—	C	HB9
	AS.2807/4/026	TUBE , distance, 1/2" o/d x 20 SWG x 26 long	1	T.35	LM	
95006	10-20 Y 965A	BRACE , engine gear-box mounting, assembly ... Spares for:—	1	—	C	HB5
	6 Y 37ND	HANDLE	1	Hardwood	LM	HB5
		Attachments for 6 Y 37ND, Handle:— Nut, 1/4" BSF	1	—	C	
28M/12928	A27/EP	Washer	1	—	C	
28W/9418921	SP13/E		1	—	C	
95005	10 Y 135A	BRACE , engine trunnion mounting, assembly ... Spares for:—	1	—	C	HB5
	6 Y 37ND	HANDLE	1	Hardwood	LM	HB5
		Attachments for 6 Y 37ND, Handle:— Nut, 1/4" BSF	1	—	C	
28M/12928	A27/EP	Washer	1	—	C	
28W/9418921	SP.13/E		1	—	C	
27VA/3303	DUNLOP ACO.5928	CLAMP , detachable for bleeding hydraulic pressure relays	1	—	C	
95330	10-20 Y 4965A	CLEANER , windscreen, sandwich, assembly ... (Mod. 8045) Spares for:—	1	—	C	HB5
32B/9427267	—	FLANLETTE (4" wide cut to 2" wide x 12"-0 long)	QR	—	C	
95363	10-20 Y 8371A	CLAMP , special, windscreen replacement, Port, assembly (Mod. 8017)	1	—	P	HB7
95364	10-20 Y 8373A	CLAMP , special, windscreen replacement, Starboard, assembly (Mod. 8017) Spares for:—	1	—	P	HB7
	10-20 Y 8389ND	PAD , thumbscrew, 1"-25 x 1"-25 x 1/8" thick, Port	8	Sorbo rubber	LM	HB7
		Starboard	6	Sorbo rubber	LM	HB7
		(Attach with Bostik "C")				
96332	10-20 Y 8375	SCREW , thumb, Port	8	—	C	HB7
		Starboard	6	—	C	HB7
95370	10-20 Y 8481	COMPUTER , weight and C.G., c/w case, assembly (Mod. 8055)	1	—	P	HB8
95369	10-20 Y 8665A	DEVICE , testing, navigator's blow-in window, assembly (Mod. 8071) Spares for:—	1	—	P	HB7
	10-20 Y 8613A	BAR , pressure, assembly	1	—	—	HB7
		Spares for:—				
96359	10-20 Y 8617ND	PACKING , Spruce	1	V.37	C	HB7
		Attachments for 10-20 Y 8617ND, Packing:— Bolt, 4 BA	2	—	C	
28D/1007468	AS.1242/3B	Nut, 4 BA	2	—	C	
28M/10287	AGS.2001/B/1	Washer	2	—	C	
28W/9419465	SP.13'B		2	—	C	

**EQUIPMENT, GROUND
SPECIAL TOOLS
(SPECIAL ORDER ONLY)**

Ref. No.	Part No.	Description	No. of	Material Specification	Class of Store or L.M.	Plate No.
28P/1015709	SP.4Y/D11	Attachments for 10-20 Y 8613A, Bar :-				
28P/9527619	SP.90/C7	Pin, shackle	1	—	C	
		Pin, split (SP.9/C8)	1	—	C	
	10-20 Y 8591A	BARREL , assembly	1	—	—	HB7
		Spares for :-				
96363	10-20 Y 8593ND	PACKING , Spruce ply	1	—	C	HB7
96362	10-20 Y 8607ND	PACKING , Spruce ply (Attach with impact adhesive)	1	—	C	HB7
96360	10-20 Y 8661A	BOLT , wing	2	—	C	HB7
96361	10-20 Y 8587A	SCREW , compression, handle, assembly ...	1	—	C	HB7
96358	10-20 Y 8521	SPRING	1	—	C	HB7
	10-20 Y 8655	STRIP , calibration, 18 SWG	1	S.514	LM	HB7
95340	10-20 Y 3955A	GAUGE , ball, gap indicator, for windscreen panels replacement, assembly (Mod. 8017)	1	—	P	HB7
		Spares for :-				
96276	10-20 Y 8039	BOBBIN	3	—	C	HB7
	—	GUN , grease, group	1	—	—	
NAVAL PATT. B11/6334	TECALEMIT HF.4000	CONNECTOR , miniature, "TAT"	1	—	C	
NAVAL PATT. B8/6330	TECALEMIT J.10	GUN , grease	1	—	P	
95079	10-20 Y 1149A	PIPE , draining, hydraulic system, assembly ...	1	—	C	HB7
95311	10-20 Y 4225A	PLUG , blanking, A.S.I. detector, assembly (Mod. 8036) (For use when testing A.S.I. system)	1	—	P	HB7
		Spares for :-				
	4 Y 479A	FLAG , red, assembly	1	Calico	LM	HB7
	—	RING , split, 1" dia.	1	—	—	
95310	10-20 Y 4221A	PLUG , test, A.S.I. test/drain, assembly (Mod. 8036)	1	—	P	HB7
	—	SCREW-DRIVERS , round-end, for use on slotted head bolts (Plunge-milled), group	1	—	—	
26DL/95100	J.51731	SCREW-DRIVER , for $\frac{7}{16}$ " dia. (DHS.981) and $\frac{3}{4}$ " dia. (DHS.958 and DHS.981)	1	—	C	
26DL/95101	J.51733	SCREW-DRIVER , for $\frac{5}{16}$ " dia. (DHS.958) and $\frac{1}{2}$ " dia. (DHS.965, DHS.995, DHS.988 and DHS.998)	1	—	C	
26DL/95102	J.51734	SCREW-DRIVER , for $\frac{1}{4}$ " dia. (DHS. 958) ...	1	—	C	
95093	J.51736	SCREW-DRIVER , for 2 BA (DHS.958) ...	1	—	C	
95376	10-20 Y 8929	SPANNER , adapter arrester hook nut, assembly (Mod. 8087) (For use with "Acra-tork" spanner Model B/S, Ref. No. 1L/199)	1	—	C	HB6
95395	10-20 Y 9297A	SPANNER , adapter set c/w stowage box for fire-wire gland nut (Mod. 8103)	1	—	P	HB9
		Spares for :-				
	10-20 Y 9643A/ND	BOX , assembly	1	—	—	HB9
96405	TIPCO W47	EXTENSION arm, 6"-0 long	1	—	P	HB9
96404	10-20 Y 9299	EXTENSION arm, 5"-0 long	1	—	P	HB9
96403	10-20 Y 9323	EXTENSION arm (Make from Tipco Part No. W47) 4"-0 long	1	—	P	HB9
	10-20 Y 9817	LABEL , instructions, 26 SWG (Mod. 8142) ...	1	Alumn.	—	HB9
96401	10-20 Y 9307	LINK , spanner	1	—	P	HB9
96398	10-20 Y 9301	SPANNER , open end	1	—	P	HB9
96454	10-20 Y 9799	SPANNER , socket, medium (Mod. 8142) ...	1	—	P	HB9
96456	10-20 Y 9803	SPANNER , socket, short (Mod. 8142) ...	1	—	P	HB9
96455	10-20 Y 9801	SPANNER , socket, tall (Mod. 8142) ...	1	—	P	HB9

**EQUIPMENT, GROUND
SPECIAL TOOLS
(SPECIAL ORDER ONLY)**

Ref. No.	Part No.	Description						No. off	Material Specification	Class of Store or L.M.	Place No.
		1	2	3	4	5	6				
NAVAL PATT. B11/H.5314	—	SPANNER , engine to gear-box shaft drive ...						1	—	C	
37L/10157	ROTOL TL.3243	SPANNER , engine to gear-drive shaft drive ...						1	—	C	
95010	10-20 Y 1101A	SPANNER , engine mounting trunnion, assembly (Part No. 10-20 EM 617)						1	—	C	HB6
95013	10-20 Y 1195A	SPANNER , $\frac{3}{8}$ " Lockheed nut, hydraulic coupling, assembly (Pre Mod. 8038)						1	—	C	HB6
95322	10-20 Y 4689A	SPANNER , $\frac{3}{8}$ " Lockheed nut, hydraulic coupling, assembly (Mod. 8038)						1	—	C	HB6
95012	10-20 Y 1189A	SPANNER , $\frac{1}{2}$ " Lockheed nut, hydraulic coupling, assembly (Pre Mod. 8038)						1	—	C	HB6
95321	10-20 Y 4695A	SPANNER , $\frac{1}{2}$ " Lockheed nut, hydraulic coupling, assembly (Mod. 8038)						1	—	C	HB6
95011	10-20 Y 1177A	SPANNER , $\frac{3}{4}$ " Lockheed nut, hydraulic coupling, assembly (Pre Mod. 8038)						1	—	C	HB6
95320	10-20 Y 4697A	SPANNER , $\frac{3}{4}$ " Lockheed nut, hydraulic coupling, assembly (Mod. 8038)						1	—	C	HB6
95080	10-20 Y 1427A	SPANNER , trunnion bolt, air intake duct, assembly (Part No. 10-20 EC 85)						1	—	C	HB6
95009	10-20 Y 977A	SPANNER , trunnion pin, arrester hook, assembly Part No. 10-20 D 611)						1	—	C	HB6
	—	TOOLS , miscellaneous repair (See AP.4647, Vol. 6, Part 1, Chap. 1, Table 2)						—	—	—	
95388	10-20 Y 9567A	TOOL , shutter reset, photographic reconnaissance pod (Mod. 8116)						1	—	C	HB9

ADAPTERS, ACRATORK SPANNER MODEL B/6

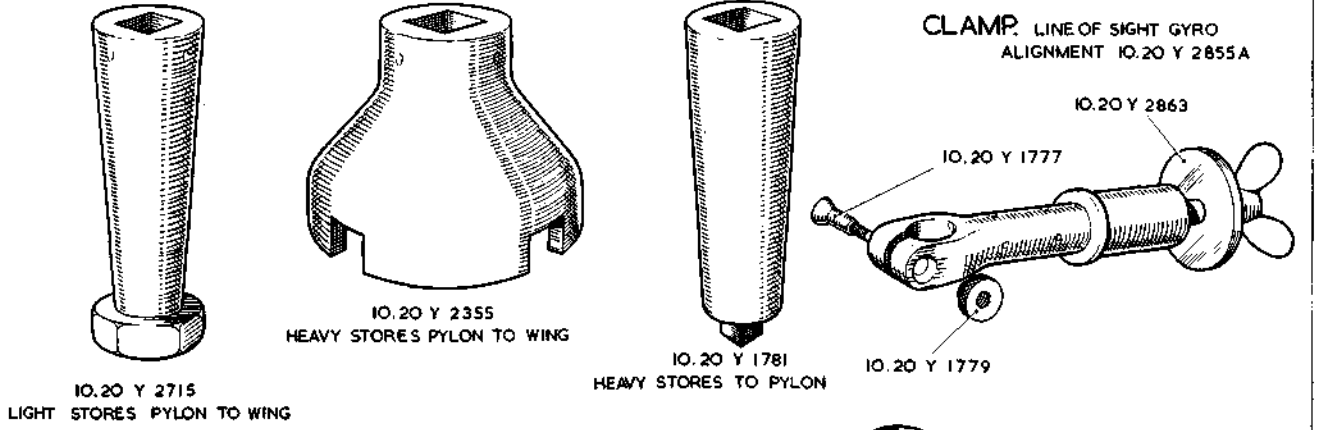

BRACE,

HEAVY STORES PYLON, SCREW JACK
IO.20 Y 2085A

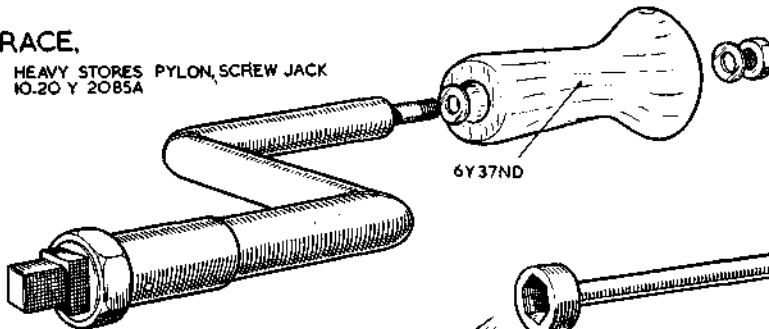

SPANNER LIGHT STORES PYLON
IO.20Y3221A

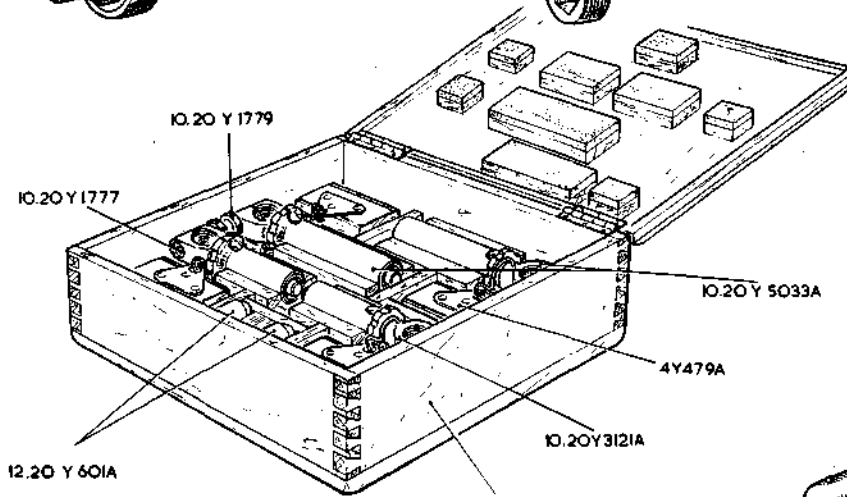

INSTRUMENTS AND CASE, ALIGNMENT SIGHT
IO.20 Y 5031A MOD.8043 (PRE MOD.8088)

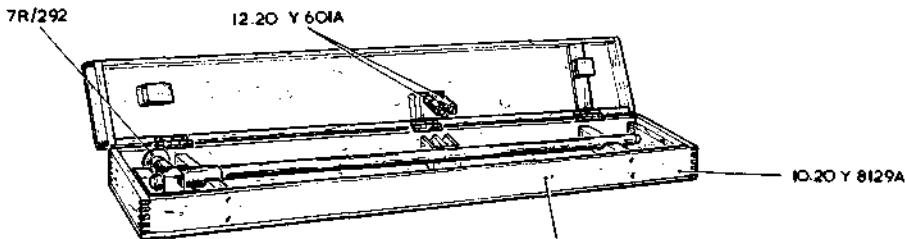
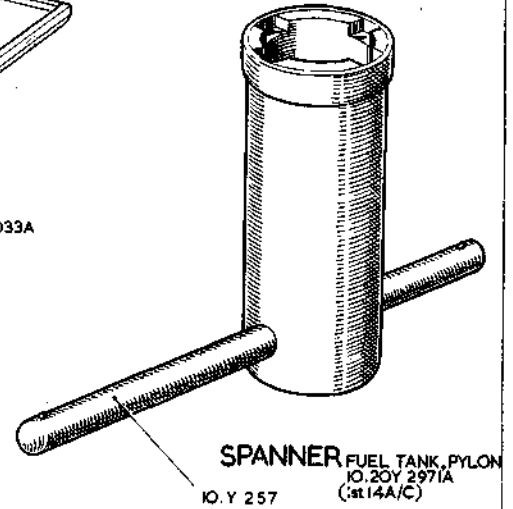

INSTRUMENTS AND CASE, ALIGNMENT SIGHT IO.20 Y 9129A (MOD.8088)

HB.1

EQUIPMENT, GROUND

HB.1

SPECIAL TOOLS

[A.L.40]

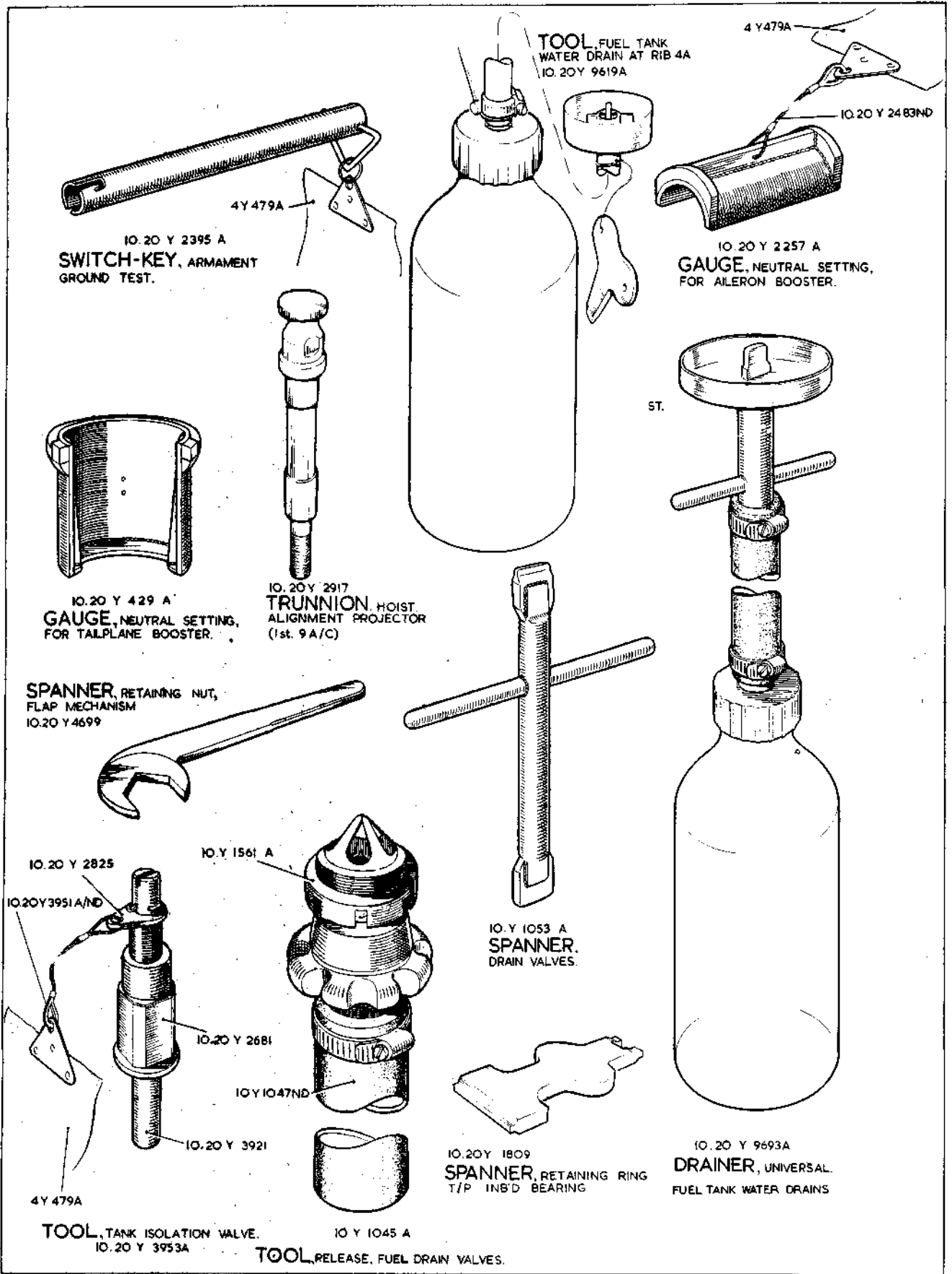

HB.2

EQUIPMENT, GROUND

HB.2

SPECIAL TOOLS

[A.L.62]

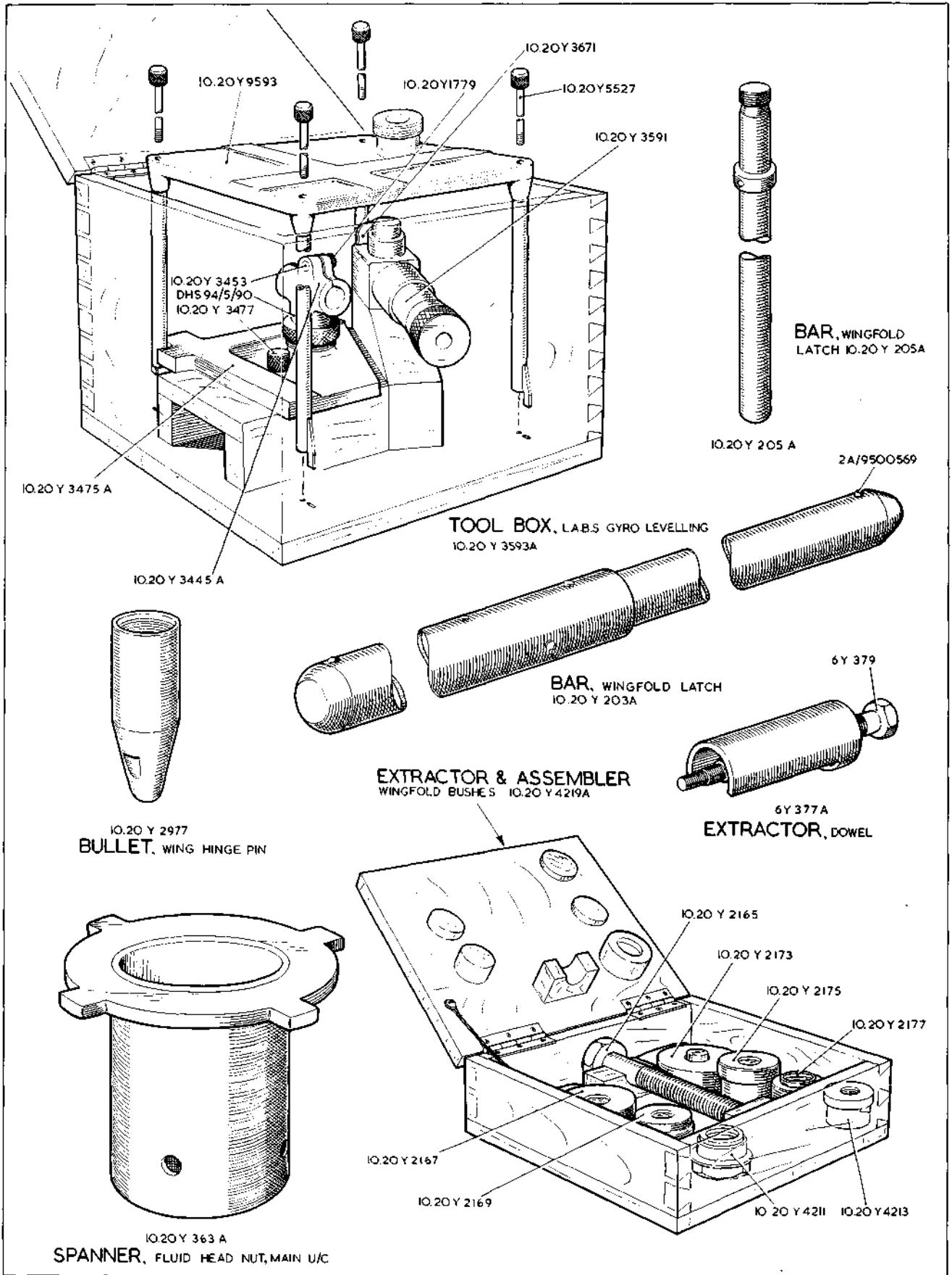

HB.3

EQUIPMENT, GROUND

HB.3
[AL. 52]

SPECIAL TOOLS

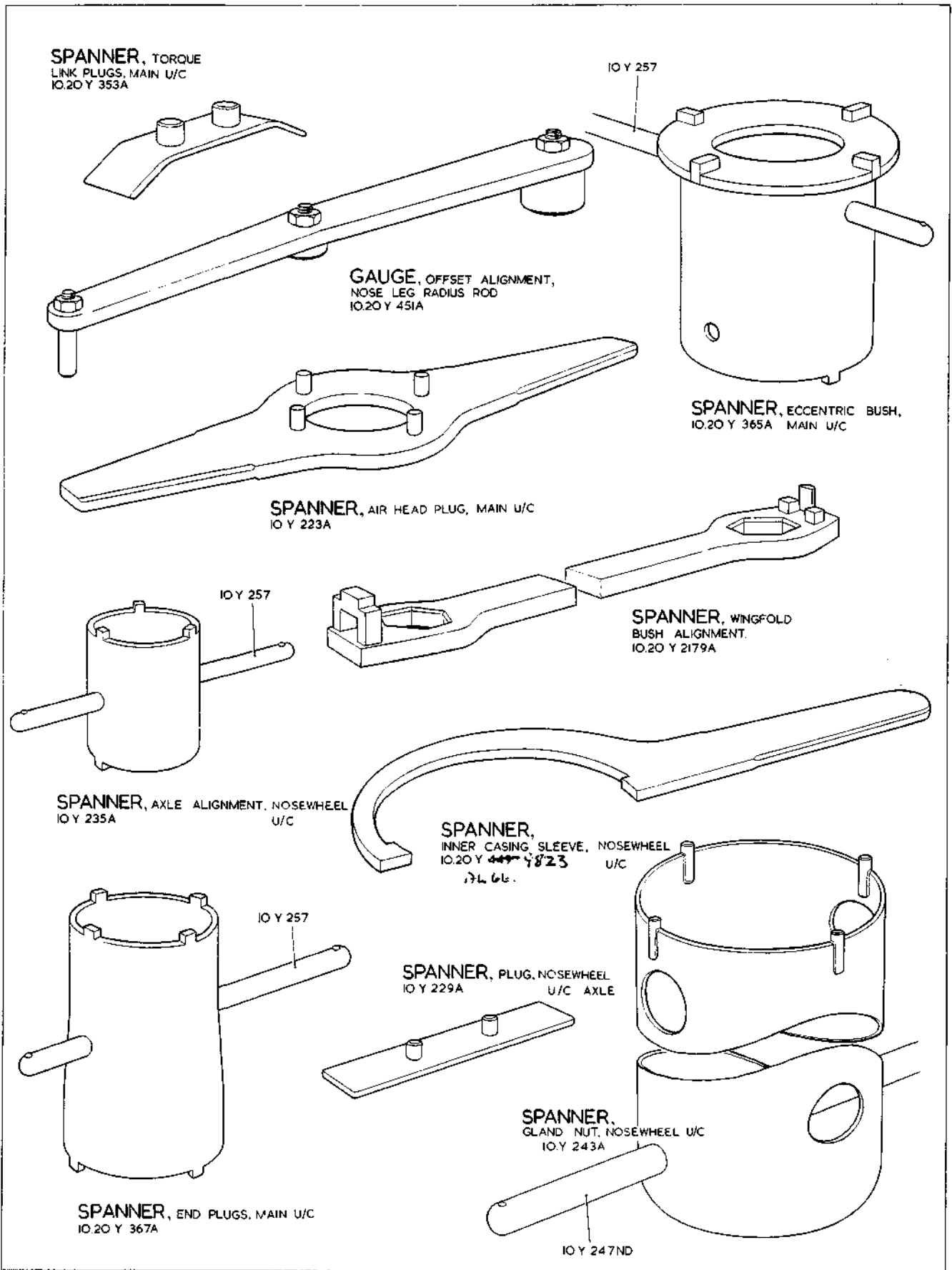

HB.4

EQUIPMENT, GROUND

HB.4

(AL40)

SPECIAL TOOLS

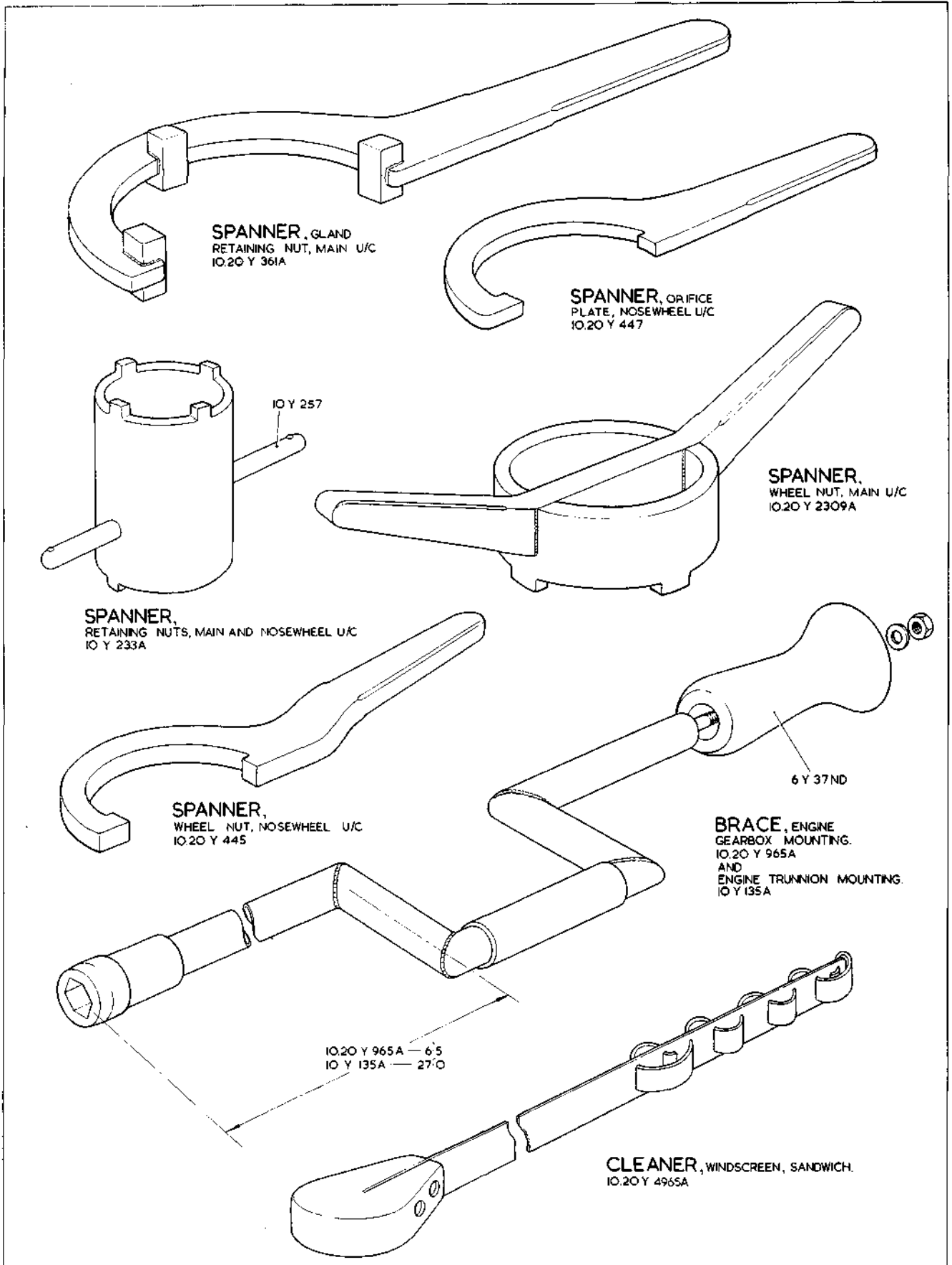

HB.5

EQUIPMENT, GROUND

HB.5
(A.L.40)

SPECIAL TOOLS

SPANNER
TRUNNION PIN, ARRESTER HOOK
IO.20Y 977A

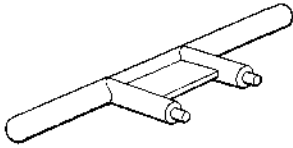

SPANNER
ENGINE MOUNTING TRUNNION
IO.20Y 1101A

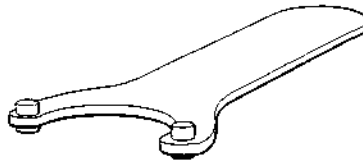

SPANNER
FOR 3/4" LOCKHEED NUT
IO.20Y 4697A (MOD.8038)

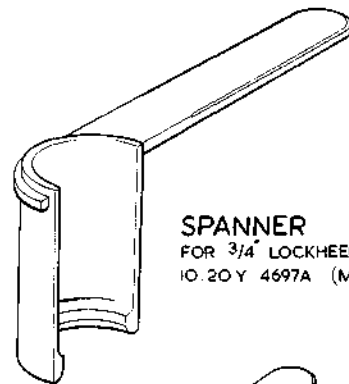

SPANNER
FOR 3/4" LOCKHEED NUT
IO.20Y 1177A (PRE MOD.
8038)

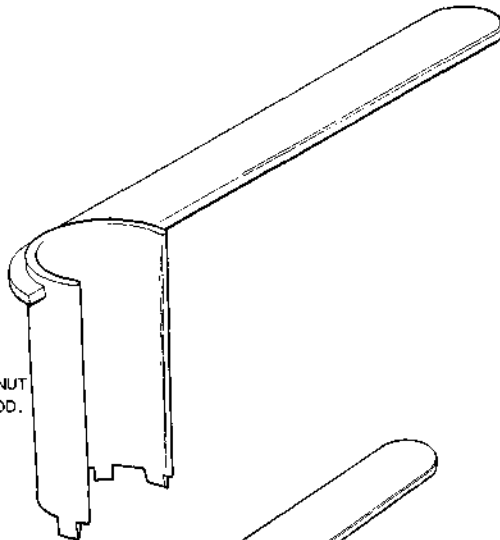

SPANNER
FOR 1/2" LOCKHEED NUT
IO.20Y 4695A (MOD.8038)

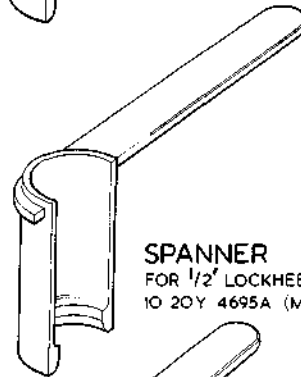

SPANNER
FOR 1/2" LOCKHEED NUT
IO.20Y 1189A (PRE MOD.8038)

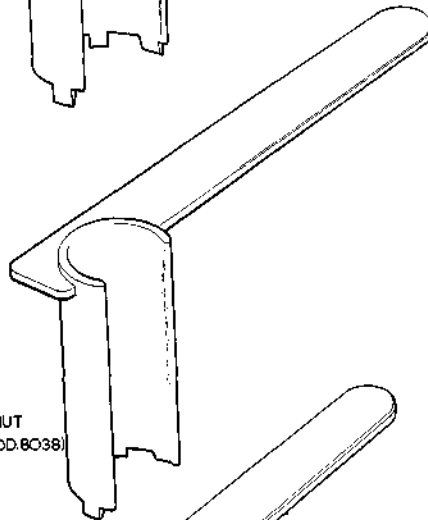

SPANNER
FOR 3/8" LOCKHEED NUT
IO.20Y 4689A (MOD.8038)

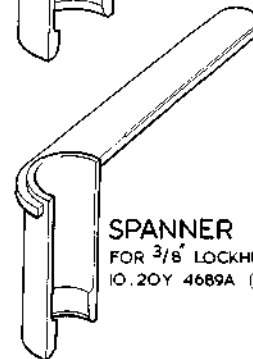

SPANNER
FOR 3/8" LOCKHEED NUT
IO.20Y 1195A (PRE MOD.8038)

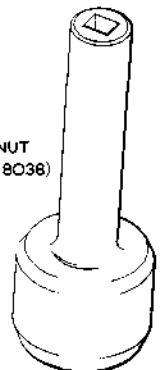
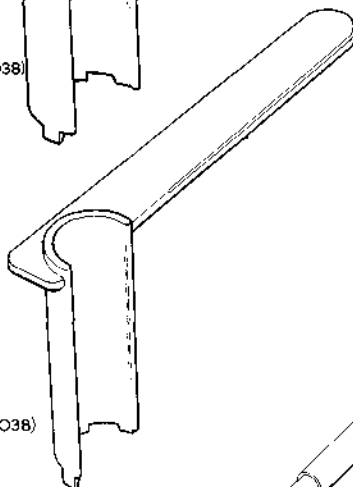

SPANNER
ARRESTER HOOK NUT
IO.20Y 8929

SPANNER
TRUNNION BOLT, AIR INTAKE DUCT
(IO.20Y 1427A)

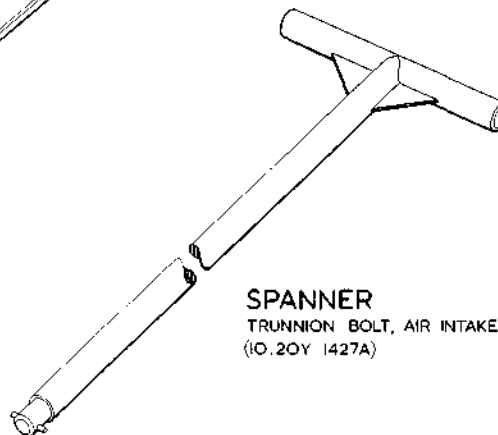

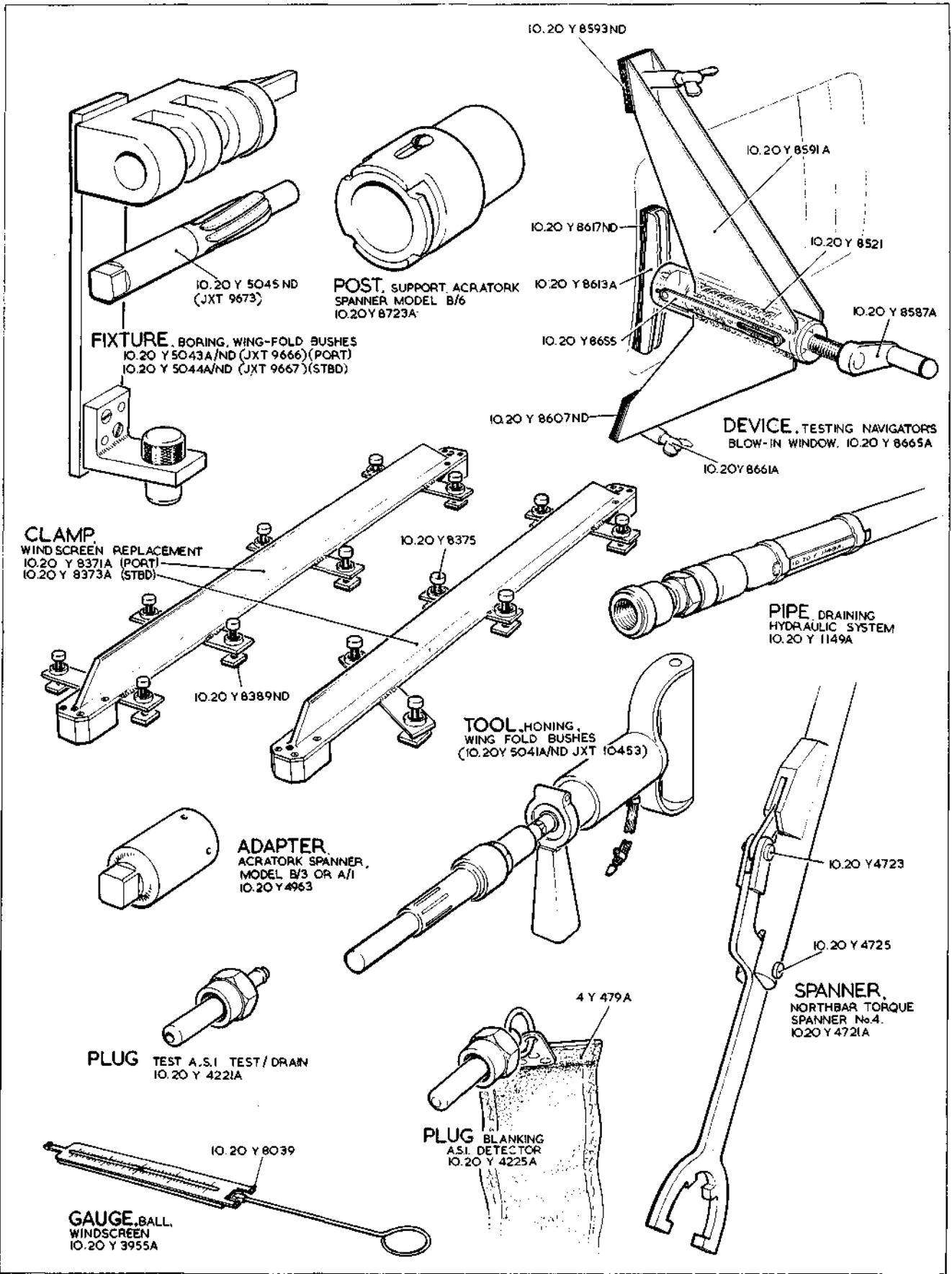

HB.7

EQUIPMENT, GROUND

HB7
[AL.40]

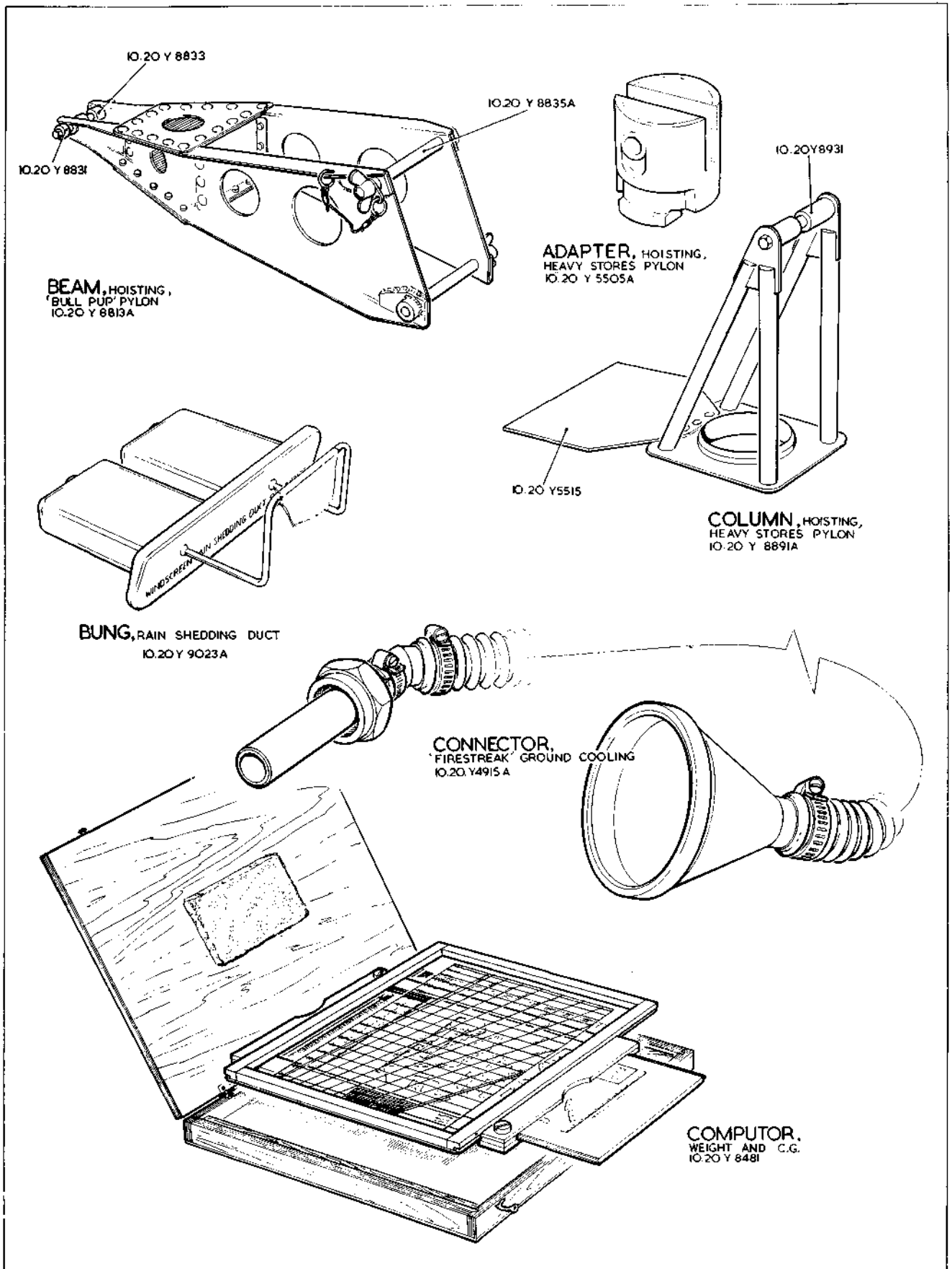

HB.8

EQUIPMENT, GROUND SPECIAL TOOLS

HB.8
[AL 62]

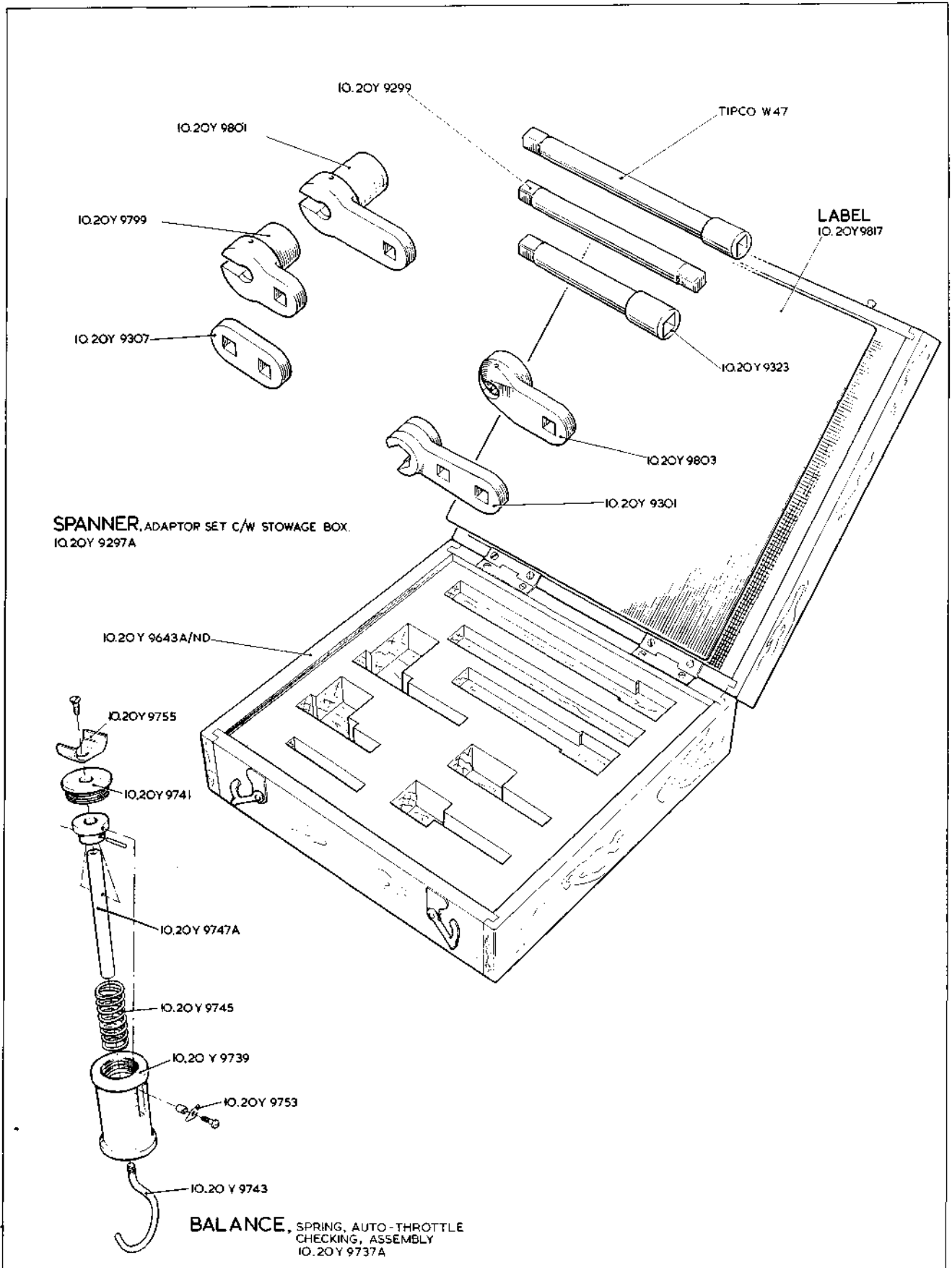

HB.9

EQUIPMENT, GROUND

HB.9

SPECIAL TOOLS

[A.L.66]

This file was downloaded
from the RTFM Library.

Link: www.scottbouch.com/rtfm

Please see site for usage terms,
and more aircraft documents.

