

**FUSELAGE**  
**CANOPY INSTALLATION**

Ref. No.	Part No.	Description	No. off						Material Specification	Class of Score or L.M	Plate No.
			1	2	3	4	5	6			
		<b>G.A. OF CANOPY</b> (Drg. No. 10-20 FC 1311) ...	1								
		Spares for :—									
	10-20 FS 5385A	<b>ANGLE</b> , canopy seal support, Port, assembly (For spares use 10-20 FS 16859A/ND)	1							KB2	
14679	10-20 FS 16859A/ND	<b>ANGLE</b> , canopy seal support, Port, assembly (Spares condition)	1						C		
	10-20 FS 841	<b>ANGLE</b> , canopy seal support, Starboard, assembly (For spares use 10-20 FS 16223ND)	1							KB2	
12978	10-20 FS 16223ND	<b>ANGLE</b> , canopy seal support, Starboard, assembly (Spares condition)	1						C		
	10-20 FS 4201	<b>BRACKET</b> , canopy seal support angle, L.H. (For spares use 10-20 FS 14207ND)	1					RZ.5		KB1	
1941	10-20 FS 14207ND	<b>BRACKET</b> , canopy seal support angle, L.H. (Spares condition)	1						C		
1940	10-20 FS 4203	<b>BRACKET</b> , canopy seal support angle, R.H. Attachments for 10-20 FS 4201 or 10-20 FS 4203, Bracket :—	1						C	KB1	
28D/9419452	A25/3B	Bolt, 4 BA	2						C		
28M/10327	AGS.2002/B 1	Nut, 4 BA	2						C		
	PARKER-KALON										
	28S/6775	Screw, No. 4 x 1/2", countersunk head	1						C		
28W/9419401	SP.10/B	Washer	2						C		
	—	<b>BRACKETS</b> , probe spotlight, group (Drg. No. 10-20 FS 20589A) (Mod. 1091)	1							KB1	
	10-20 FS 20591	<b>BRACKET</b> , support, 18 SWG	1					L.72	LM	KB1	
17509	10-20 FS 20593	<b>BRACKET</b> , support Attachments for 10-20 FS 20593, Bracket :—	1						C	KB1	
28D/9133011	A25/2C	Bolt, 2 BA	2						C		
28M/10328	AGS.2002/C/1	Nut, 2 BA	2						C		
28W/9419402	SP.13/C	Washer	2						C		
	10-20 FS 3709A	<b>BULKHEAD</b> , pressure, assembly (Pre Mod. 96)	1							KB1	
	10-20 FS 14655A	<b>BULKHEAD</b> , pressure, assembly (Mod. 96) Spares for :—	1							KB1	
	10-20 FS 16489A	<b>BRACKET</b> , support, L.A.B.S. test box, assembly (Mod. 491)	1							KB1	
	10-20 FS 16487ND	<b>BRACKET</b> , bare, 20 SWG	1					L.72	LM	KB1	
28M/9434251	AGS.2008/B/1	<b>NUT</b> , 4 BA, anchor	4						C		
28M/13774	AGS.2019/B/1	<b>NUT</b> , 4 BA, anchor	2						C		
	10-20 FS 6561A	<b>DUCT</b> hot air, assembly (For spares use 10-20 FS 14273A/ND)	1							KB1	
10198	10-20 FS 14273A/ND	<b>DUCT</b> , hot air, assembly (Spares condition)	1						C		
	10-20 FS 3711	<b>HOUSING</b> , pivot, optimum angle (For spares use 10-20 FS 14211ND)	1					L.122		KB1	
1942	10-20 FS 14211ND	<b>HOUSING</b> , pivot, optimum angle (Spares condition)	1						C		
	—	<b>PAD</b> , group (Mod. 96)	1								
28M/9435067	AGS.2008/C/1	<b>NUT</b> , anchor, 2 BA	4						C		
	10-20 FS 14751	<b>PAD</b>	3					DTD.298		KB1	
	10-20 FS 14753	<b>PAD</b>	1					DTD.298		KB1	
	10-20 FS 4563	<b>PLATE</b> , cover, optimum angle release tube	1							KB1	
1943	10-20 FS 5511A/ND	<b>SEAL</b> , hot air duct	1						C	KB1	
	—	<b>COMPASS</b> , check steering, windscreen (See sub-section FA)	—								

**FUSELAGE**  
**CANOPY INSTALLATION**

Ref. No.	Part No.	Description	No. off						Material Specification	Class of Store or L.M	Plate No.
			1	2	3	4	5	6			
	10-20 FS 5181	<b>DIAPHRAGM</b> , bulkhead support, Port ... ..	1						—	—	KB1
	10-20 FS 5179	<b>DIAPHRAGM</b> , bulkhead support, Starboard ... ..	1						—	—	KB1
		Attachments for 10-20 FS 5181 or 10-20 FS 5179, Diaphragm :—									
28D/9436920	A25/1C	Bolt, 2 BA ... ..	1						—	C	
28D/9133011	A25/2C	Bolt, 2 BA ... ..	1						—	C	
28M/10328	AGS.2002/C/1	Nut, 2 BA ... ..	2						—	C	
28W/9419454	SP.10/C	Washer ... ..	2						—	C	
	—	<b>HANDLE</b> , canopy winding (See sub-section KD) ...	—						—	—	
	—	<b>HOOD</b> , canopy, sliding, assembly (See sub-section KE)	—						—	—	
	—	<b>LAMP</b> , probe spotlight (See sub-section EAZ) ...	—						—	—	
1931	10-20 FC 1305A	<b>LATCH</b> , canopy, Port, assembly ... ..	1						—	C	KB2
21070	10-20 FC 2447A	<b>LATCH</b> , canopy, Starboard, assembly (Mod. 1592)	1						—	C	KB2
		Spares for :—									
	10-20 FC 1453ND	<b>BLOCK</b> , reinforcing, Port ... ..	1					S.96	—	—	KB2
	10-20 FC 2445ND	<b>BLOCK</b> , reinforcing, Starboard ... ..	1					S.96	—	—	KB2
	10 FC 131	<b>PLATE</b> , reinforcing ... ..	1					DTD.165	—	—	KB2
		Attachments for 10 FC 131, Plate :—									
28D/1007285	AS.1242/1B	Bolt, 4 BA ... ..	2						—	C	
	3 FC 479	<b>STUD</b> ... ..	4					S.96	—	—	KB2
	—	<b>MECHANISM</b> , canopy jettison (See sub-section KC)	—						—	—	
	—	<b>MECHANISM</b> , canopy winding gear (See sub-section KD)	—						—	—	
	—	<b>MOUNTING</b> , micro-switch, hood opening, group (Drg. No. 10-20 FC 1439)	1						—	—	
2030	10-20 FC 1441	<b>BRACKET</b> , stop, mounting ... ..	1						—	C	
	—	<b>ELECTRICAL COMPONENTS</b> ... ..	—						—	—	
	—	(See sub-section EBR)									
	—	<b>MOUNTING</b> , relay box, group (Mod. 96) (Drg. No. 10-20 FS 14723)	1						—	—	KB1
	10-20 FS 20859A/ND	<b>BRACKET</b> , assembly (Mod. 1247) ... ..	2						—	—	KB1
28M/9434251	10-20 FS 20857ND	<b>BRACKET</b> , 20 SWG ... ..	1					L.72	—	LM	KB1
	AGS.2008/B/1	<b>NUT</b> , anchor, 4 BA ... ..	1						—	C	
	10-20 FS 15297A/ND	<b>CAP</b> , assembly ... ..	1						—	—	KB1
	10-20 FS 14731ND	<b>CAP</b> ... ..	1						—	LM	KB1
1790	DHS.726/C/16	<b>WASHER</b> , support ... ..	8						—	C	KB1
1945	10 FC 729	<b>NUT</b> , retaining canopy seal valve in distance tube	1						—	C	KB2
	10-20 FC 909	<b>PLATE</b> , packing, at junction of canopy rail to wind-screen front arch, L.H.	1					DTD.424	—	—	KB1
	10-20 FC 911	<b>PLATE</b> , packing, at junction of canopy rail to wind-screen front arch, R.H.	1					DTD.424	—	—	KB1
1932	10-20 FC 1257A	<b>RAIL</b> , canopy, Port, assembly ... ..	1						—	P	KB2
		Spares for :—									
	10-20 FS 11213	<b>PLATE</b> , rubbing ... ..	1					S.510	—	LM	KB2
		Attachments for 10-20 FC 1257A, Rail :—									
28D/1213877	AS.3294/3B	Bolt, 4 BA ... ..	9						—	C	
1092	DHS.365/2C	Bolt, 2 BA ... ..	1						—	C	
1792	DHS.365/3C	Bolt, 2 BA ... ..	2						—	C	
2742	DHS.365/4C	Bolt, 2 BA ... ..	3						—	C	
4341	DHS.365/5C	Bolt, 2 BA ... ..	3						—	C	
5161	DHS.365/9C	Bolt, 2 BA ... ..	2						—	C	
28M/10327	AGS.2002/B/1	Nut, 4 BA ... ..	9						—	C	
28M/10328	AGS.2002/C/1	Nut, 2 BA ... ..	11						—	C	
28W/9419401	SP.10/B	Washer ... ..	9						—	C	
28W/9419454	SP.10/C	Washer ... ..	11						—	C	

**FUSELAGE  
CANOPY INSTALLATION**

Ref. No.	Part No.	Description	No. of	Material Specification	Class of Store or L.M	Place No.
1933	10-20 FC 1181A	<b>RAIL</b> , canopy, Starboard, assembly ... ..	1	—	P	KB2
	10-20 FC 1547A	<b>PLATE</b> , rubbing, assembly ... ..	1	—	—	KB2
	10-20 FC 1565ND	<b>PLATE</b> , packing, 24 SWG ... ..	2	S.510	LM	KB2
	10-20 FC 1549ND	<b>PLATE</b> , rubbing, 24 SWG ... ..	1	S.510	LM	KB2
		Attachments for 10-20 FC 1181A, Rail :—				
28D/9128773	AS.3294/1B	Bolt, 4 BA ... ..	3	—	C	
28D/1213877	AS.3294/3B	Bolt, 4 BA ... ..	1	—	C	
28D/1213878	AS.3294/4B	Bolt, 4 BA ... ..	2	—	C	
28D/1213879	AS.3294/5B	Bolt, 4 BA ... ..	1	—	C	
1092	DHS.365/2C	Bolt, 2 BA ... ..	1	—	C	
1792	DHS.365/3C	Bolt, 2 BA ... ..	2	—	C	
2742	DHS.365/4C	Bolt, 2 BA ... ..	6	—	C	
4341	DHS.365/5C	Bolt, 2 BA ... ..	7	—	C	
28M/10327	AGS.2002/B/1	Nut, 4 BA ... ..	7	—	C	
28M/10328	AGS.2002/C/1	Nut, 2 BA ... ..	16	—	C	
28W/9419401	SP.10/B	Washer ... ..	7	—	C	
28W/9419454	SP.10/C	Washer ... ..	16	—	C	
1934	10-20 FC 1373A	<b>SEAL</b> , pressure, inflatable, complete with valve ...	1	—	C	KB2
		Attachments for 10-20 FC 1373A, Seal :—				
28S/1213814	PARKER-KALON TYPE " Z "	Screw, No. 4 x 1/2" round head ... ..	24	—	C	
	10-20 FC 905	<b>STOP</b> , canopy rail, L.H. side (For spares use 10-20 FC 1591ND)	1	L.65	—	KB2
1929	10-20 FC 1591ND	<b>STOP</b> , canopy rail, L.H. side (Spares condition) ...	1	—	C	
		Attachments for 10-20 FC 905, Stop :—				
28D/9140645	A25/10C	Bolt, 2 BA ... ..	1	—	C	
28D/1007975	AS.1242/1C	Bolt, 2 BA ... ..	1	—	C	
28D/1213878	AS.3294/4B	Bolt, 4 BA ... ..	1	—	C	
28M/10328	AGS.2002/C/1	Nut, 2 BA ... ..	1	—	C	
28W/9419454	SP.10/C	Washer ... ..	1	—	C	
	10-20 FC 907	<b>STOP</b> , canopy rail, R.H. side (For spares use 10-20 FC 1589ND)	1	L.65	—	KB2
1928	10-20 FC 1589ND	<b>STOP</b> , canopy rail, R.H. side (Spares condition) ...	1	—	C	
		Attachments for 10-20 FC 907, Stop :—				
28D/9435710	A25/11C	Bolt, 2 BA ... ..	1	—	C	
28D/1212404	A25/35C	Bolt, 2 BA ... ..	1	—	C	
28M/10328	AGS.2002/C/1	Nut, 2 BA ... ..	2	—	C	
28W/9419454	SP.10/C	Washer ... ..	2	—	C	
1938	10-20 FS 5381	<b>STRIP</b> , seal clamping, Port ... ..	1	—	C	KB2
1939	10-20 FS 5383	<b>STRIP</b> , seal clamping, Starboard ... ..	1	—	C	KB2
		Attachments for 10-20 FS 5381 or 10-20 FS 5383, Strip :—				
28D/9128773	AS.3294/1B	Bolt, 4 BA ... ..	17	—	C	
28M/10327	AGS.2002/B/1	Nut, 4 BA ... ..	17	—	C	
1935	10-20 FC 1031ND	<b>STRIP</b> , seal retaining ... ..	1	—	C	KB2
1944	10-20 FC 1419A	<b>TUBE</b> , distance, canopy seal valve ... ..	1	—	C	KB2

**FUSELAGE  
CANOPY INSTALLATION**

Ref. No.	Part No.	Description	No. off						Material Specification	Class of Store or L.M	Plate No.	
			1	2	3	4	5	6				
	—	<b>TUBE</b> , sliding hood optimum angle release, group (Drg. No. 10-20 FC 991)							1	—		
1926	10 FS 3987	<b>BRACKET</b> , guide ... ..							1	—	C	KB1
		Attachments for 10 FS 3987, Bracket :—										
28D/9133011	A25/2C	Bolt, 2 BA ... ..							4	—	C	
28M/10328	AGS.2002/C/1	Nut, 2 BA ... ..							4	—	C	
1927	10 FS 2121	Packing ... ..							4	—	C	KB1
	10-20 FC 1561ND	Packing ... ..							QR	L.72	LM	KB1
28W/9419404	SP.16/C	Washer (Use at rear inboard position) ... ..							1	—	C	
1924	10 FC 325	<b>SCREW</b> , pivot ... ..							2	—	C	KB1
1925	10 FC 327	<b>SEAL</b> , pivot ... ..							2	—	C	KB1
1920	10-20 FC 1353A/ND	<b>TUBE</b> , assembly ... ..							1	—	P	KB1
	10 FC 339ND	<b>DOWEL</b> , $\frac{1}{16}$ " dia. x 0".25 long ... ..							1	S.1	LM	KB1
1923	10 FC 329	<b>PLUG</b> , stop ... ..							1	—	C	KB1
	10 FC 303A	<b>TUBE</b> , inner, assembly ... ..							1	—	—	KB1
		Spares for :—										
1922	10 FC 311	<b>PLUG</b> , end, latch ... ..							1	—	C	KB1
	10-20 FC 1355A	<b>TUBE</b> , outer, assembly ... ..							1	—	—	KB1
		Spares for :—										
	10-20 FC 1359	<b>COLLAR</b> , stop ... ..							1	L.122	—	KB1
	10-20 FC 1517	<b>SOCKET</b> , anchoring, forward ... ..							1	L.122	—	KB1
1921	10 FC 307	<b>SOCKET</b> , stop and guide, aft ... ..							1	—	C	KB1
	—	<b>WINDSCREEN</b> , installation (See sub-section KF) ...							—	—	—	

SEE TEXT FOR SPARES CONDITION OF ITEMS MARKED THUS: \*

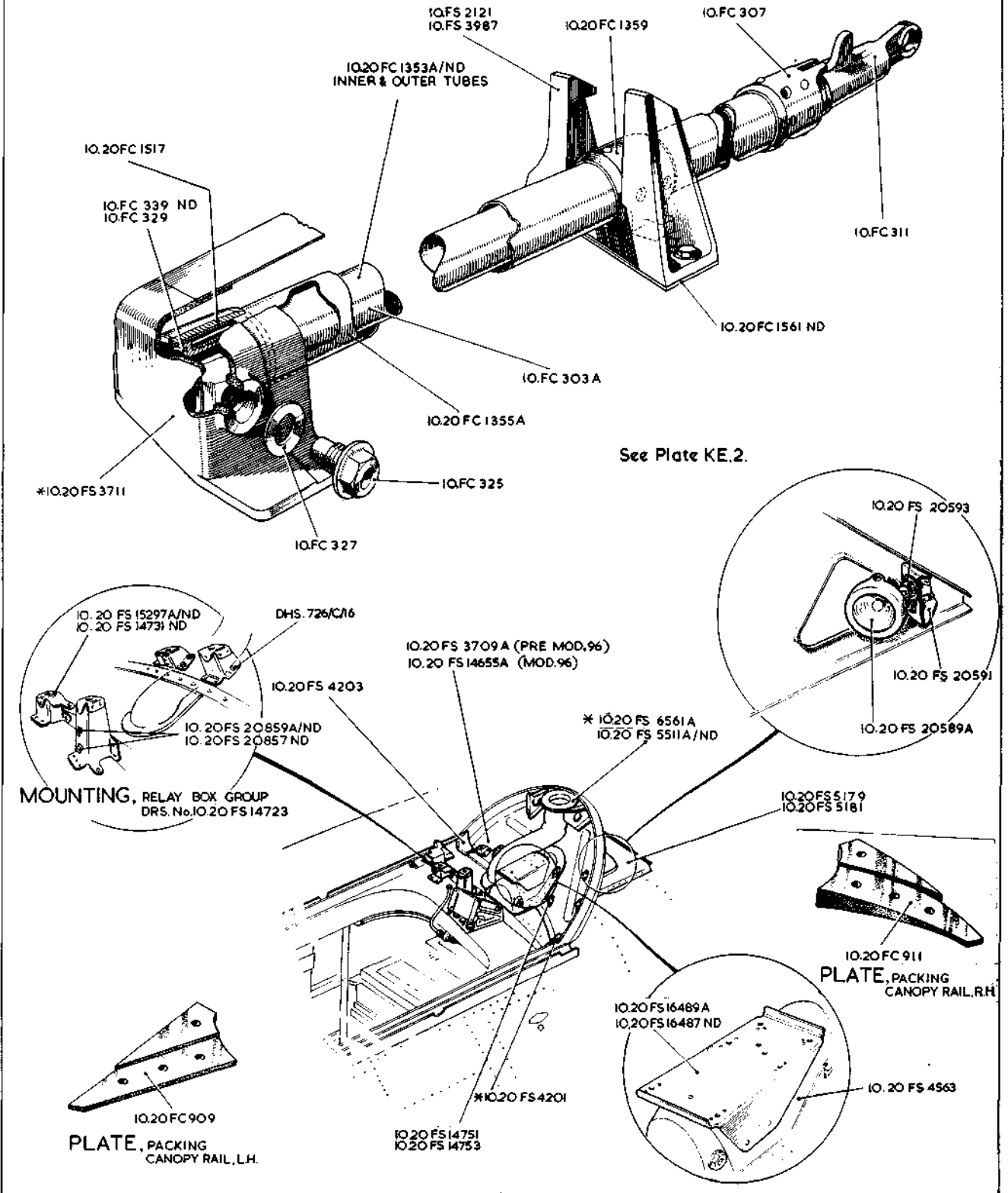

KB. I

# FUSELAGE

KB. I  
[AL.56]

## CANOPY INSTALLATION

RESTRICTED

SEE TEXT FOR SPARES CONDITION OF ITEMS MARKED THUS \*

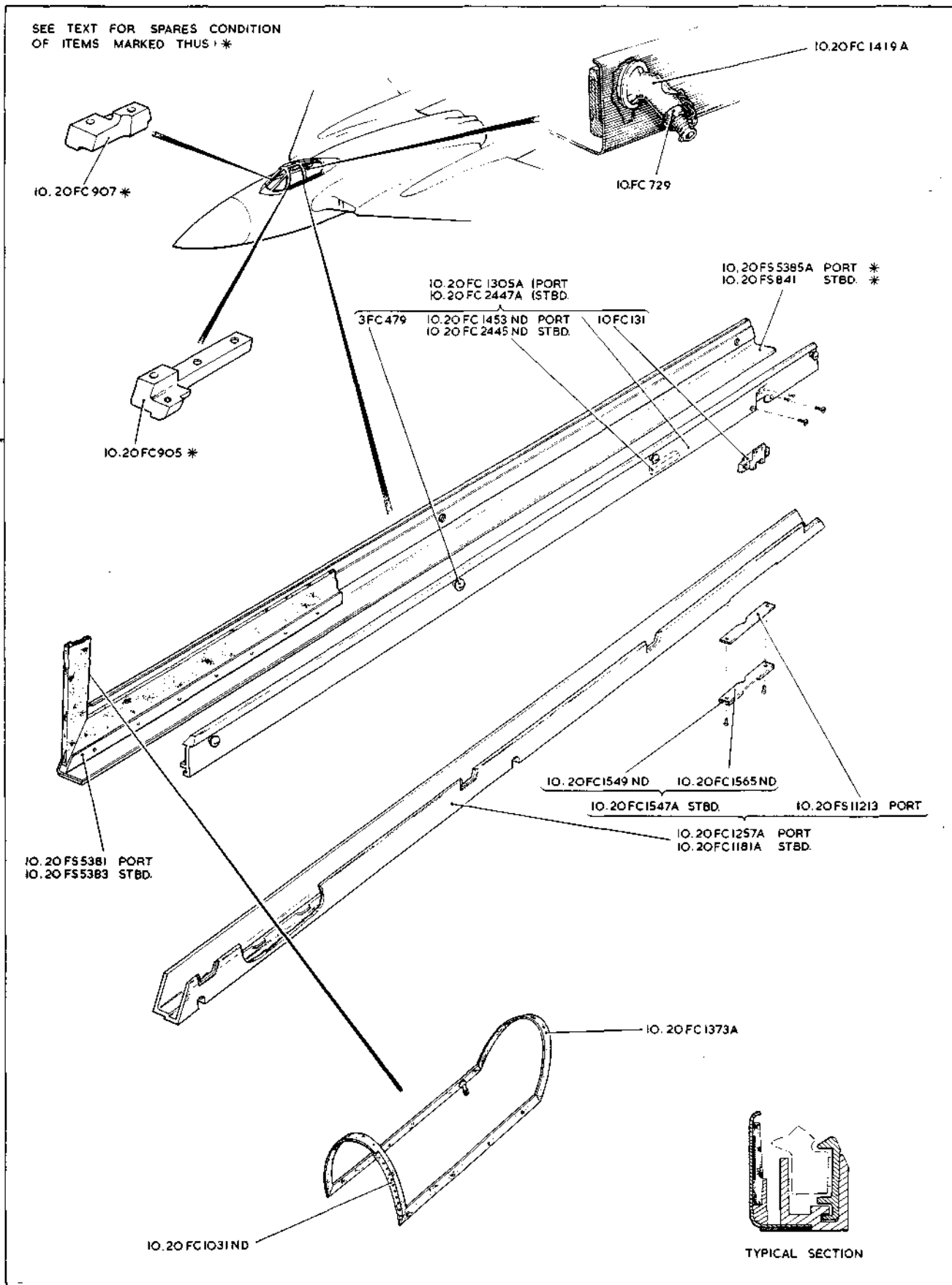

KB.2

# FUSELAGE CANOPY INSTALLATION

KB.2

[A.L. 79]



This file was downloaded  
from the RTFM Library.

Link: [www.scottbouch.com/rtfm](http://www.scottbouch.com/rtfm)

Please see site for usage terms,  
and more aircraft documents.

ENGINE  
INHIBITED  
DO NOT  
TURN  
PROP