

MAIN PLANES

AILERON

Ref. No.	Part No.	Description	No. off	Material Specification	Class of Score or L.M	Plate No.
114	510-20 WA 103	AILERON, PORT (Special spares assembly, c/w attachments (Mod. 233)	1	—	P	LJ1
115	510-20 WA 104	AILERON, STARBOARD (Special spares assembly, c/w attachments (Mod. 233)	1	—	P	LJ1
	10-20 WA 1315A	AILERON, Port, assembly	1	—	—	LJ1
	10-20 WA 1317A	AILERON, Starboard, assembly	1	—	—	LJ1
13309	10-20 WA 1769	BLOCK, joint, trailing edge, between ribs Nos. 9 and 10	1	L.64	C	LJ1
8342	10-20 WA 1121A	BRACKET, hinge, centre, assembly Spares for :—	1	—	P	LJ3
1523	10 WA 19	BUSH Attachments for 10-20 WA 1121A, Bracket :—	2	DTD.197	C	LJ2
28D/9133011	A25/2C	Bolt, 2 BA	16	—	C	
1532	10 WA 337	Bolt, 1/2" BSF	1	S.96	C	LJ3
1533	10-20 WA 951	Bolt, 1/2" BSF	1	S.97	C	LJ3
8726	DHS.782/6/21	Washer, tab	1	DTD.171	C	LJ3
8727	DHS.782/24/20	Washer, tab	1	DTD.171	C	LJ3
	10-20 WA 1125A	BRACKET, hinge, inner, Port, assembly (For spares use 10-20 WA 1297A/ND)	1	—	—	LJ4
8345	10-20 WA 1297A/ND	BRACKET, hinge, inner, Port, assembly (Spares condition)	1	—	P	
	10-20 WA 1129A	BRACKET, hinge inner, Starboard, assembly (For spares use 10-20 WA 1301A/ND)	1	—	—	LJ4
8344	10-20 WA 1301A/ND	BRACKET, hinge, inner, Starboard, assembly (Spares condition) Spares for :—	1	—	P	
1542	10-20 WA 207	BUSH, aileron hinge	1	DTD.197	C	LJ4
1543	10-20 WA 209	BUSH, aileron hinge	1	DTD.197	C	LJ4
1544	10-20 WA 203	BUSH, jack pick-up	1	DTD.197	C	LJ4
1545	10-20 WA 205	BUSH, jack pick-up	1	DTD.197	C	LJ4
	10 WA 609	TRACK, roller (For spares use 10-20 WA 1295ND)	1	S.510	—	LJ4
1546	10-20 WA 1295ND	TRACK, roller (Spares condition) Attachments for 10-20 WA 1125A, Bracket :—	1	S.510	C	
28D/9131782	AS.1242/2B	Bolt, 4 BA	14	—	C	
28D/9133011	A25/2C	Bolt, 2 BA	10	—	C	
1655	DHS.358/3C	Bolt, 2 BA	16	—	C	LJ4
28D/1011030	A25/2E	Bolt, 1/2" BSF	10	—	C	
1147	DHS.358/3E	Bolt, 1/2" BSF	14	—	C	LJ4
28M/1006504	A27/BT	Nut, 4 BA	14	—	C	
28M/12931	A27/ET	Nut, 1/2" BSF	10	—	C	
28M/10288	AGS.2001/C/1	Nut, 2 BA	10	—	C	
28M/10328	AGS.2002/C/1	Nut, 2 BA	16	—	C	
28M/10290	AGS.2001/E/1	Nut, 1/2" BSF	12	—	C	
28M/7002430	AGS.2002/E/1	Nut, 1/2" BSF	2	—	C	
28VV/9419402	SP.13/C	Washer	16	—	C	
28VV/9418921	SP.13/E	Washer	14	—	C	
3412	DHS.770/B	Washer, cup	14	DTD.571	C	LJ4
1468	DHS.770/C	Washer, cup	16	DTD.571	C	LJ4
1649	DHS.770/E	Washer, cup	14	DTD.571	C	LJ4
		Attachments for 10-20 WA 1129A, Bracket :—				
28D/9131782	AS.1242/2B	Bolt, 4 BA	14	—	C	
1655	DHS.358/3C	Bolt, 2 BA	16	—	C	LJ4
28D/1011030	A25/2E	Bolt, 1/2" BSF	14	—	C	
1147	DHS.358/3E	Bolt, 1/2" BSF	12	—	C	LJ4

MAIN PLANES
AILERON

Ref. No.	Part No.	Description	No. off						Material Specification	Class of Store or L.M.	Place No.
			1	2	3	4	5	6			
28M/1006504	A27/BT	Nut, 4 BA	14	—	C	
28M/12931	A27/ET	Nut, 1/2" BSF	14	—	C	
28M/10328	AGS.2002/C/1	Nut, 2 BA	16	—	C	
28M/10290	AGS.2001/E/1	Nut, 1/2" BSF	10	—	C	
28M/7002430	AGS.2002/E/1	Nut, 1/2" BSF	2	—	C	
28W/9419402	SP.13/C	Washer	16	—	C	
28W/9418921	SP.13/E	Washer	12	—	C	
3412	DHS.770/B	Washer, cup	14	DTD.571	C	LJ4
1648	DHS.770/C	Washer, cup	16	DTD.571	C	LJ4
1649	DHS.770/E	Washer, cup	12	DTD.571	C	LJ4
8343	10-20 WA 1117A	BRACKET , hinge, outer, assembly	1	—	P	LJ4
		Spares for :—									
1523	10 WA 19	BUSH	2	DTD.197	C	LJ4
		Attachments for 10-20 WA 1117A, Bracket :—									
1533	10-20 WA 951	Bolt, 1/2" BSF	2	S.97	C	LJ4
28D/9133011	A25/2C	Bolt, 2 BA	12	—	C	
8726	DHS.782/6/21	Washer	2	DTD.171	C	LJ4
8723	10-20 WA 857A	COVER , formation lamp, assembly	1	—	P	LJ2
		Spares for :—									
8725	10-20 WA 1101ND	PLATE , retaining	1	L.72	C	LJ2
8724	10-20 WA 863ND	WINDOW , 'Perspex'	1	DTD.339	C	LJ2
		Attachments for 10-20 WA 857A, Cover :—									
7198	DHS.964/1C	Bolt, 2 BA	14	—	C	LJ2
12155	10-20 N 10825A/ND	LAMP , formation keeping, coded "TG" Port, assembly (Drg. No. 10-20 N 2393) (Pre Mod. 1048)	1	—	C	LJ2
12156	10-20 N 10827A/ND	LAMP , formation keeping, coded "YG" Starboard, assembly (Drg. No. 10-20 N 2393) (Pre Mod. 1048)	1	—	C	LJ2
28D/17777	AS.4565/4E	BOLT , 1/2" BSF	1	—	C	
	10-20 WA 879A	BRACKET , lamp mounting, assembly...	1	—	—	LJ2
	10-20 WA 881ND	ANGLE , L.H., 20 SWG	1	S.510	LM	LJ2
	10-20 WA 882ND	ANGLE , R.H., 20 SWG	1	S.510	LM	LJ2
28M/9403519	A27/BP	NUT , 4 BA	1	—	C	
	10-20 WA 883ND	PLATE , centre, 20 SWG	1	S.510	LM	LJ2
4205	10-20 N 2391	CLAMP , cable	2	LFS.21	C	LJ2
	—	ELECTRICAL COMPONENTS (See sub-section EBM)	—	—	—	
28M/9403519	A27/BP	NUT , 4 BA	1	—	C	
28M/10320	AGS.2002/E/3	NUT , 1/2" BSF	1	—	C	
28S/15902	A55/B8	SCREW , grub	1	—	C	
		Attachments for 10-20 N 10825A/ND or 10-20 N 10827A/ND, Lamp :—									
28S/9992525	A32/B12	Screw, 4 BA	4	—	C	

MAIN PLANES

AILERON

Ref. No.	Part No.	Description	No. off	Material Specification	Class of Store or L.M.	Plate No.
	—	LAMP , formation, keeping, coded "TG." group Port and "YG" Starboard (Drg. Nos. 10-20 N 2471 and 10-20 N 24743, Mod. 1048) (SPECIAL ORDER ONLY)	1	—	—	
19658	10-20 N 23837	CLAMP , cable, half	1	—	C	LJ2
19659	10-20 N 23839	CLAMP , cable, half Attachments for 10-20 N 23837 or 10-20 N 23939, Clamp :—	1	—	C	LJ2
28S/1016732	A32/B18	Screw, 4 BA	2	—	C	
28W/9419465	SP.13/B	Washer	2	—	C	
	10-20 WA 2277A	LAMP , formation c/w mounting, assembly ...	1	—	—	LJ2
	—	ELECTRICAL COMPONENTS ... (See sub-section EBM)	—	—	—	
	10-20 N 24179A/ND	MOUNTING , assembly	1	—	—	LJ2
19657	10-20 WA 2297	MOULDING Attachments for 10-200 WA 2297, Moulding :—	1	—	C	LJ2
28M/10288	AGS.2001/C/1	Nut, 2 BA	1	—	C	
28S/2892	A32/C40	Screw, 2 BA	1	—	C	
	AS.2806/4/079	Tube, distance, 1/4" o/d x 22 SWG x ".79 long	1	T.35 or T.45	LM	
	DHS.725/C/16	Washer (Make from standard section J.2037)	2	—	LM	
19951	10-20 WA 2295A	MOUNTING , assembly Attachments for 10-20 WA 2277A, Lamp :—	1	—	C	LJ2
28S/9992533	A32/C20	Screw, 2 BA	3	—	C	
28W/9419402	SP.13/C	Washer	3	—	C	
5K/3422	AS.3360/C8C	LEAD , bonding, flexible Attachments for AS.3360/C8C, Lead :—	1	—	C	LJ4
28D/9436920	A25/1C	Bolt, 2 BA	2	—	C	
28M/10288	AGS.2001/C/1	Nut, 2 BA	1	—	C	
28W/9419402	SP.13/C	Washer	2	—	C	

MAIN PLANES

AILERON

Ref. No.	Part No.	Description						No. off	Material Specification	Class of Store or L.M	Plate No.
		1	2	3	4	5	6				

MAIN PLANES

AILERON

Ref. No.	Part No.	Description	No. off	Material Specification	Class of Store or L.M.	Place No.
17626	10-20 WE 10083A	LINK , hinge, centre, assembly (Mod. 1225) ... (Drg. No. 10-20 WA 1783) Spares for :—	1	—	P	LJ3
2A/9500467	HOFFMANN CA.3	BEARING , ball	1	—	C	
1530	10-20 WE 2745	BUSH	1	—	C	LJ3
3398	10-20 WE 4519	BUSH	1	—	C	LJ3
28D/15797	A57/16J	Attachments for 10-20 WE 10083A, Link :—				
28M/1011476	A27/JS	Bolt, 3/8" BSF	1	—	C	
28P/9527619	SP.90/C7	Nut, 3/8" BSF	1	—	C	
28VV/9419466	SP.13/J	Pin, split (SP.9/C8)	1	—	C	
		Washer	1	—	C	
17628	10-20 WE 10081A	LINK , hinge, outer, assembly (Mod. 1225) ... (Drg. No. 10-20 WA 1319) Spares for :—	1	—	P	LJ4
2A/9500467	HOFFMANN CA.3	BEARING , ball	1	—	C	
3396	10-20 WE 4517	BUSH	2	—	C	LJ4
28D/1213773	A30/15J	Attachments for 10-20 WE 10081A, Link :—				
28M/1011476	A27/JS	Bolt, 3/8" BSF	1	—	C	
28P/9527619	SP.90/C7	Nut, 3/8" BSF	1	—	C	
28VV/9419466	SP.13/J	Pin, split (SP.9/C8)	1	—	C	
		Washer	1	—	C	
	10-20 WA 27ND	MEMBER , trailing edge, inboard (Make from standard section X83, Ref. No. 26FY/1650)	1	—	LM	LJ1
	10-20 WA 29ND	MEMBER , trailing edge, outboard (Make from standard section X83, Ref. No. 26FY/1650)	1	—	LM	LJ1
	10-20 WA 223	PLATE , nose skin, adjacent to inner hinge, Port, 22 SWG	1	L.72	LM	LJ1
	10-20 WA 224	PLATE , nose skin, adjacent to inner hinge, Starboard, 22 SWG	1	L.72	LM	LJ1
	10-20 WA 1801	PLATE , nose skin, adjacent to outer hinge, Port, 18 SWG	1	L.72	LM	LJ1
	10-20 WA 1802	PLATE , nose skin, adjacent to outer hinge, Starboard, 18 SWG	1	L.72	LM	LJ1
	10-20 WA 1933	PLATE , nose skin, between centre and inner hinges, Port, 22 SWG	1	L.72	LM	LJ1
	10-20 WA 1934	PLATE , nose skin, between centre and inner hinges, Starboard, 22 SWG	1	L.72	LM	LJ1
	10-20 WA 239	PLATE , nose skin, between outer and centre hinges, Port, 22 SWG	1	L.72	LM	LJ1
	10-20 WA 240	PLATE , nose skin, between outer and centre hinges, Starboard, 22 SWG	1	L.72	LM	LJ1
28M/11957	10-20 WA 2271A/ND	PLATE , nut, outboard of outer hinge, assembly	1	—	—	LJ1
	AGS.2007/C/1	NUT , anchor, 2 BA	6	—	C	
	10-20 WA 2269ND	PLATE , bare, 1"60 x 4"50, 18 SWG ...	1	L.72	LM	LJ1
28D/9436920	A25/1C	Attachments for 10-20 WC 2271A/ND Plate :—				
		Bolt, 2 BA	6	—	C	
	10-20 WA 269ND	PLATE , radiused, bottom, at outer hinge, Port (For spares use 10-20 WA 1977ND)	1	L.73	—	LJ4
14543	10-20 WA 1977ND	PLATE , radiused, bottom, at outer hinge, Port (Spares condition)	1	—	C	
	10-20 WA 270ND	PLATE , radiused, bottom, at outer hinge, Starboard (For spares use 10-20 WA 1978ND)	1	L.73	—	LJ4
14544	10-20 WA 1978ND	PLATE , radiused, bottom, at outer hinge, Starboard (Spares condition)	1	—	C	

MAIN PLANES

AILERON

Ref. No.	Part No.	Description	No. off	Material Specification	Class of Store or L.M	Plate No.
		Attachments for 10-29 WA 269ND or 10-20 WA 270ND, Plate :-				
28D/13485	AS.3294/3C	Bolt, 2 BA	2	—	C	
28M/1006473	A27/CT	Nut, 2 BA	2	—	C	
28W/9419475	SP.15/C	Washer	2	—	C	
	10-20 WA 767ND	Washer, cup (Make from Part No. DHS.770/C, Ref. No. 26FY/1648)	2	DTD.571	LM	LJ3 LJ4
	10-20 WA 237ND	PLATE, radiused, top, between centre and inner hinges, Port (For spares use 10-20 WA 1979ND)	1	L.73	—	LJ3
14539	10-20 WA 1979ND	PLATE, radiused, top, between centre and inner hinges, Port (Spares condition)	1	—	C	
	10-20 WA 238ND	PLATE, radiused, top, between centre and inner hinges, Starboard (For spares use 10-20 WA 1980ND)	1	L.73	—	LJ3
14540	10-20 WA 1980ND	PLATE, radiused, top, between centre and inner hinges, Starboard (Spares condition)	1	—	C	
	10-20 WA 235ND	PLATE, radiused, top, between centre and outer hinges, Port (For spares use 10-20 WA 1981ND)	1	L.73	—	LJ3
14541	10-20 WA 1981ND	PLATE, radiused, top, between centre and outer hinges, Port (Spares condition)	1	—	C	
	10-20 WA 236ND	PLATE, radiused, top, between centre and outer hinges, Starboard (For spares use 10-20 WA 1982ND)	1	L.73	—	LJ3
14542	10-20 WA 1982ND	PLATE, radiused, top, between centre and outer hinges, Starboard (Spares condition)	1	—	C	
		Attachments for 10-20 WA 235ND or 10-20 WA 236ND, Plate :-				
28D/13485	AS.3294/3C	Bolt, 2 BA	2	—	C	
28M/1006473	A27/CT	Nut, 2 BA	2	—	C	
28W/9419475	SP.15/C	Washer	2	—	C	
	10-20 WA 767ND	Washer, cup (Make from Part No. DHS.770/C, Ref. No. 26FY/1648)	2	—	LM	LJ3
	10-20 WA 221ND	PLATE, radiused, top, inboard portion, Port (For spares use 10-20 WA 1973ND)	1	L.73	—	LJ4
14537	10-20 WA 1973ND	PLATE, radiused, top, inboard portion, Port (Spares condition) ...	1	—	C	
	10-20 WA 309ND	PLATE, radiused, top, inboard portion, Starboard (For spares use 10-20 WA 1975ND)	1	L.73	—	LJ4
14538	10-20 WA 1975ND	PLATE, radiused, top, inboard portion, Starboard (Spares condition)	1	—	C	
	10-20 WA 1825	PLATE, reinforcing, at centre and outer hinges, (For spares use 10-20 WA 2045ND)	2	L.72	—	LJ4
14736	10-20 WA 2045ND	PLATE, reinforcing, at centre and outer hinges, (Spares condition)	2	—	C	
	10-20 WA 1323	PLATE, reinforcing, bottom skin, at outer hinges Port (For spares use 10-20 WA 2265ND)	1	L.73	—	LJ1
15247	10-20 WA 2265ND	PLATE, reinforcing, bottom skin, at outer hinges, Port (Spares condition)	1	—	C	
	10-20 WA 1324	PLATE, reinforcing, bottom skin, at outer hinges, Starboard (For spares use 10-20 WA 2266ND)	1	L.73	—	LJ1
15284	10-20 WA 2266ND	PLATE, reinforcing, bottom skin, at outer hinges, Starboard (Spares condition)	1	—	C	
	10-20 WA 1325A	PLATE, reinforcing, top skin, at outer hinge, Port, assembly (For spares use 10-20 WA 2037A/ND)	1	—	—	LJ1
14747	10-20 WA 2037A/ND	PLATE, reinforcing, top skin, at outer hinge, Port, assembly (Spares condition)	1	—	C	

MAIN PLANES

AILERON

Ref. No.	Part No.	Description	No. off	Material Specification	Class of Store or L.M	Plate No.
	10-20 WA 1326A	PLATE, reinforcing, top skin, at outer hinge, Starboard, assembly (For spares use 10-20 WA 2038A/ND)	1	—	—	LJ1
14748	10-20 WA 2038A/ND	PLATE, reinforcing, top skin, at outer hinge, Starboard, assembly (Spares condition)	1	—	C	
	10-20 WA 1913A	RIB, No. 1, Port, assembly (For spares use 10-20 WA 2155A/ND)	1	—	—	LJ1
15144	10-20 WA 2155A/ND	RIB, No. 1, Port, assembly (Spares condition) ... Spares for :—	1	—	C	
	10-20 WA 1131ND	STRIP, 8"25 x 0"60 x 0"10 ...	1	LFS.21	LM	LJ1
	10-20 WA 1914A	RIB, No. 1, Starboard, assembly (For spares use 10-20 WA 2156A/ND)	1	—	—	LJ1
15145	10-20 WA 2156A/ND	RIB, No. 1, Starboard, assembly (Spares condition) Spares for :—	1	—	C	
	10-20 WA 1131ND	STRIP, 8"25 x 0"60 x 0"10 ...	1	LFS.21	LM	LJ1
	10-20 WA 1529A	RIB, No. 1A, assembly (For spares use 10-20 WA 2223A/ND)	1	—	—	LJ1
14799	10-20 WA 2223A/ND	RIB, No. 1A, assembly (Spares condition) ...	1	—	C	
	10-20 WA 1531A	RIB, No. 2, assembly (For spares use 10-20 WA 2211A/ND)	1	—	—	LJ1
14791	10-20 WA 2211A/ND	RIB, No. 2, assembly (Spares condition) ...	1	—	C	
	10-20 WA 1533A	RIB, No. 2A, assembly (For spares use 10-20 WA 2247A/ND)	1	—	—	LJ1
14792	10-20 WA 2247A/ND	RIB, No. 2A, assembly (Spares condition) ...	1	—	C	
	10-20 WA 1535A	RIB, No. 3, assembly (For spares use 10-20 WA 2205A/ND)	1	—	—	LJ1
14793	10-20 WA 2205A/ND	RIB, No. 3, assembly (Spares condition) ...	1	—	C	
	10-20 WA 1907A	RIB, No. 6, Port, assembly (For spares use 10-20 WA 2195A/ND)	1	—	—	LJ1
14806	10-20 WA 2195A/ND	RIB, No. 6, Port, assembly (Spares condition) ...	1	—	C	
	10-20 WA 1908A	RIB, No. 6, Starboard, assembly (For spares use 10-20 WA 2196A/ND)	1	—	—	LJ1
14807	10-20 WA 2196A/ND	RIB, No. 6, Starboard, assembly (Spares condition)	1	—	C	
	10-20 WA 1789	RIB, No. 6A, Port (For spares use 10-20 WA 2019A/ND)	1	L.73	—	LJ1
14733	10-20 WA 2019A/ND	RIB, No. 6A, Port (Spares condition) ...	1	L.73	C	
	10-20 WA 1790	RIB, No. 6A, Starboard (For spares use 10-20 WA 2020A/ND)	1	L.73	—	LJ1
14734	10-20 WA 2020A/ND	RIB, No. 6A, Starboard (Spares condition) ...	1	L.73	C	
	10-20 WA 1539A	RIB, No. 6B, Port, assembly (For spares use 10-20 WA 2075A/ND)	1	—	—	LJ1
14800	10-20 WA 2075A/ND	RIB, No. 6B, Port, assembly (Spares condition)	1	—	C	
	10-20 WA 1540A	RIB, No. 6B, Starboard, assembly (For spares use 10-20 WA 2076A/ND)	1	—	—	LJ1
14801	10-20 WA 2076A/ND	RIB, No. 6B, Starboard, assembly (Spares condition)	1	—	C	
	10-20 WA 1541A	RIB, No. 7, assembly (For spares use 10-20 WA 2183A/ND)	1	—	—	LJ1
14784	10-20 WA 2183A/ND	RIB, No. 7, assembly (Spares condition) ...	1	—	C	
	10-20 WA 1543A	RIB, No. 7A, assembly (For spares use 10-20 WA 2081A/ND)	1	—	—	LJ1
14802	10-20 WA 2081A/ND	RIB, No. 7A, assembly (Spares condition) ...	1	—	C	
	10-20 WA 1545A	RIB, No. 8, assembly (For spares use 10-20 WA 2171A/ND)	1	—	—	LJ1
14785	10-20 WA 2171A/ND	RIB, No. 8, assembly (Spares condition) ...	1	—	C	

MAIN PLANES

AILERON

Ref. No.	Part No.	Description	No. off	Material Specification	Class of Store or L.M.	Plate No.
	10-20 WA 1547A	RIB, No. 8A, assembly (For spares use 10-20 WA 2177A/ND)	1	—	—	LJ1
14767	10-20 WA 2177A/ND	RIB, No. 8A, assembly (Spares condition) ...	1	—	C	
	10-20 WA 1549A	RIB, No. 9, assembly (For spares use 10-20 WA 2165A/ND)	1	—	—	LJ1
14768	10-20 WA 2165A/ND	RIB, No. 9, assembly (Spares condition) ...	1	—	C	
	10-20 WA 1551A	RIB, No. 9A, assembly (For spares use 10-20 WA 2189A/ND)	1	—	—	LJ1
14794	10-20 WA 2189A/ND	RIB, No. 9A, assembly (Spares condition) ...	1	—	C	
	10-20 WA 1553A	RIB, No. 10, assembly (For spares use 10-20 WA 2149A/ND)	1	—	—	LJ1
14786	10-20 WA 2149A/ND	RIB, No. 10, assembly (Spares condition) ...	1	—	C	
	10-20 WA 1555A	RIB, No. 10A, assembly (For spares use 10-20 WA 2199A/ND)	1	—	—	LJ1
14795	10-20 WA 2199A/ND	RIB, No. 10A, assembly (Spares condition) ...	1	—	C	
	10-20 WA 1557A	RIB, No. 11, assembly (For spares use 10-20 WA 2143A/ND)	1	—	—	LJ1
14787	10-20 WA 2143A/ND	RIB, No. 11, assembly (Spares condition) ...	1	—	C	
	10-20 WA 1559A	RIB, No. 11A, assembly (For spares use 10-20 WA 2127A/ND)	1	—	—	LJ1
14788	10-20 WA 2217A/ND	RIB, No. 11A, assembly (Spares condition) ...	1	—	C	
	10-20 WA 1561A	RIB, No. 12, assembly (For spares use 10-20 WA 2129A/ND)	1	—	—	LJ1
14789	10-20 WA 2129A/ND	RIB, No. 12, assembly (Spares condition) ...	1	—	C	
	10-20 WA 1563A	RIB, No. 12A, assembly (For spares use 10-20 WA 2229A/ND)	1	—	—	LJ1
14790	10-20 WA 2229A/ND	RIB, No. 12A, assembly (Spares condition) ...	1	—	C	
	10-20 WA 1565A	RIB, No. 13, assembly (For spares use 10-20 WA 2137A/ND)	1	—	—	LJ1
14797	10-20 WA 2137A/ND	RIB, No. 13, assembly (Spares condition) ...	1	—	C	
	10-20 WA 1567A	RIB, No. 13A, assembly (For spares use 10-20 WA 2235A/ND)	1	—	—	LJ1
14798	10-20 WA 2235A/ND	RIB, No. 13A, assembly (Spares condition) ...	1	—	C	
	10-20 WA 1569A	RIB, No. 14, assembly (For spares use 10-20 WA 2123A/ND)	1	—	—	LJ1
14766	10-20 WA 2123A/ND	RIB, No. 14, assembly (Spares condition) ...	1	—	C	
	10-20 WA 1571A	RIB, No. 14A, assembly (For spares use 10-20 WA 2241A/ND)	1	—	—	LJ1
14796	10-20 WA 2241A/ND	RIB, No. 14A, assembly (Spares condition) ...	1	—	C	
	10-20 WA 1573A	RIB, No. 15, assembly (For spares use 10-20 WA 2117A/ND)	1	—	—	LJ1
14769	10-20 WA 2117A/ND	RIB, No. 15, assembly (Spares condition) ...	1	—	C	
	10-20 WA 1575A	RIB, No. 15A, assembly (For spares use 10-20 WA 2087A/ND)	1	—	—	LJ1
14803	10-20 WA 2087A/ND	RIB, No. 15A, assembly (Spares condition) ...	1	—	C	
	10-20 WA 1577A	RIB, No. 16, assembly (For spares use 10-20 WA 2111A/ND)	1	—	—	LJ1
14770	10-20 WA 2111A/ND	RIB, No. 16, assembly (Spares condition) ...	1	—	C	
	10-20 WA 1579A	RIB, No. 16A, assembly (For spares use 10-20 WA 2093A/ND)	1	—	—	LJ1
14804	10-20 WA 2093A/ND	RIB, No. 16A, assembly (Spares condition) ...	1	—	C	
	10-20 WA 1581A	RIB, No. 17, assembly (For spares use 10-20 WA 2105A/ND)	1	—	—	LJ1
14771	10-20 WA 2105A/ND	RIB, No. 17, assembly (Spares condition) ...	1	—	C	

MAIN PLANES

AILERON

Ref. No.	Part No.	Description	No. off	Material Specification	Class of Score or L.M	Plate No.
	10-20 WA 1583A	RIB , No. 17A, assembly (For spares use 10-20 WA 2099A/ND)	1	—	—	LJ1
14805	10-20 WA 2099A/ND	RIB , No. 17A, assembly (Spares condition) ...	1	—	C	
	10-20 WA 1405A	RIB , No. 18, outer hinge, assembly (For spares use 10-20 WA 2067A/ND)	1	—	—	LJ1
14765	10-20 WA 2067A/ND	RIB , No. 18, outer hinge, assembly (Spares condition)	1	—	C	
	10-20 WA 1855A	RIB , nose, No. 1, Port, assembly (For spares use 10-20 WA 2011A/ND)	1	—	—	LJ1
14738	10-20 WA 2011A/ND	RIB , nose, No. 1, Port, assembly (Spares condition)	1	—	C	
	10-20 WA 1856A	RIB , nose, No. 1, Starboard, assembly (For spares use 10-20 WA 2012A/ND)	1	—	—	LJ1
14739	10-20 WA 2012A/ND	RIB , nose, No. 1, Starboard, assembly (Spares condition)	1	—	C	
	10-20 WA 1859A	RIB , nose, No. 2, assembly (For spares use 10-20 WA 2015A/ND)	1	—	—	LJ1
14737	10-20 WA 2015A/ND	RIB , nose, No. 2, assembly (Spares condition) ...	1	—	C	
	10-20 WA 95A	RIB , nose, No. 3, assembly (For spares use 10-20 WA 1351A/ND)	1	—	—	LJ1
1500	10-20 WA 1351A/ND	RIB , nose, No. 3, assembly (Spares condition) ...	1	—	C	
	10-20 WA 1863A	RIB , nose, No. 8, assembly (For spares use 10-20 WA 1983A/ND)	1	—	—	LJ1
14740	10-20 WA 1983A/ND	RIB , nose, No. 8, assembly (Spares condition) ...	1	—	C	
	10-20 WA 101A	RIB , nose, No. 9, assembly (For spares use 10-20 WA 1355A/ND)	1	—	—	LJ1
1496	10-20 WA 1355A/ND	RIB , nose, No. 9, assembly (Spares condition) ...	1	—	C	
	10-20 WA 103A	RIB , nose, No. 10, assembly (For spares use 10-20 WA 1357A/ND)	1	—	—	LJ1
1495	10-20 WA 1357A/ND	RIB , nose, No. 10, assembly (Spares condition)...	1	—	C	
	10-20 WA 1867A	RIB , nose, No. 11, assembly (For spares use 10-20 WA 1987A/ND)	1	—	—	LJ1
14741	10-20 WA 1987A/ND	RIB , nose, No. 11, assembly (Spares condition) ...	1	—	C	
	10-20 WA 1767A	RIB , nose, No. 12A, Port, assembly (For spares use 10-20 WA 2021A/ND)	1	—	—	LJ1
14759	10-20 WA 2021A/ND	RIB , nose, No. 12A, Port, assembly (Spares condition)	1	—	C	
	10-20 WA 1768A	RIB , nose, No. 12A, Starboard, assembly (For spares use 10-20 WA 2022A/ND)	1	—	—	LJ1
14760	10-20 WA 2022A/ND	RIB , nose, No. 12A, Starboard, assembly (Spares condition)	1	—	C	
	10-20 WA 1765A	RIB , nose, No. 12B, Port, assembly (For spares use 10-20 WA 2025A/ND)	1	—	—	LJ1
14757	10-20 WA 2025A/ND	RIB , nose, No. 12B, Port, assembly (Spares condition)	1	—	C	
	10-20 WA 1766A	RIB , nose, No. 12B, Starboard, assembly (For spares use 10-20 WA 2026A/ND)	1	—	—	LJ1
14758	10-20 WA 2026A/ND	RIB , nose, No. 12B, Starboard, assembly (Spares condition)	1	—	C	
	10-20 WA 1871A	RIB , nose, No. 13, assembly (For spares use 10-20 WA 2003A/ND)	1	—	—	LJ1
14742	10-20 WA 2003A/ND	RIB , nose, No. 13, assembly (Spares condition)...	1	—	C	
	10-20 WA 1875A	RIB , nose, No. 14, assembly (For spares use 10-20 WA 2007A/ND)	1	—	—	LJ1
14743	10-20 WA 2007A/ND	RIB , nose, No. 14, assembly (Spares condition)	1	—	C	
	10-20 WA 1879A	RIB , nose, No. 15, assembly (For spares use 10-20 WA 1991A/ND)	1	—	—	LJ1

MAIN PLANES

AILERON

Ref. No.	Part No.	Description	No. off	Material Specification	Class of Store or L.M.	Plate No.
14744	10-20 WA 1991A/ND	RIB, nose, No. 15, assembly (Spares condition)	1	—	C	
	10-20 WA 1883A	RIB, nose, No. 16, assembly (For spares use 10-20 WA 1995A/ND)	1	—	—	LJ1
14745	10-20 WA 1995A/ND	RIB, nose, No. 16, assembly (Spares condition)	1	—	C	
	10-20 WA 1887A	RIB, nose, No. 17, assembly (For spares use 10-20 WA 1999A/ND)	1	—	—	LJ1
14732	10-20 WA 1999A/ND	RIB, nose, No. 17, assembly (Spares condition)	1	—	C	
	10-20 WA 1763A	RIB, nose, No. 18A, Port, assembly (For spares use 10-20 WA 2033A/ND)	1	—	—	LJ1
14755	10-20 WA 2033A/ND	RIB, nose, No. 18A, Port, assembly (Spares condition)	1	—	C	
	10-20 WA 1764A	RIB, nose, No. 18A, Starboard, assembly (For spares use 10-20 WA 2034A/ND)	1	—	—	LJ1
14756	10-20 WA 2034A/ND	RIB, nose, No. 18A, Starboard, assembly (Spares condition)	1	—	C	
	10-20 WA 1761A	RIB, nose, No. 18B, Port, assembly (For spares use 10-20 WA 2029A/ND)	1	—	—	LJ1
14753	10-20 WA 2029A/ND	RIB, nose, No. 18B, Port, assembly (Spares condition)	1	—	C	
	10-20 WA 1762A	RIB, nose, No. 18B, Starboard, assembly (For spares use 10-20 WA 2030A/ND)	1	—	—	LJ1
14754	10-20 WA 2030A/ND	RIB, nose, No. 18B, Starboard, assembly (Spares condition)	1	—	C	
	10-20 WA 1843A	SKIN, inboard, bottom, Port, assembly (For spares use 10-20 WA 2261A/ND)	1	—	—	LJ1
15105	10-20 WA 2261A/ND	SKIN, inboard, bottom, Port, assembly (Spares condition)	1	—	C	
	10-20 WA 1845A	SKIN, inboard, bottom, Starboard, assembly (For spares use 10-20 WA 2263A/ND)	1	—	—	LJ1
15106	10-20 WA 2263A/ND	SKIN, inboard, bottom, Starboard, assembly (Spares condition)	1	—	C	
	10-20 WA 1839A	SKIN, inboard, top, Port, assembly (For spares use 10-20 WA 2257A/ND)	1	—	—	LJ1
15103	10-20 WA 2257A/ND	SKIN, inboard, top, Port, assembly (Spares condition)	1	—	C	
	10-20 WA 1841A	SKIN, inboard, top, Starboard, assembly (For spares use 10-20 WA 2259A/ND)	1	—	—	LJ1
15104	10-20 WA 2259A/ND	SKIN, inboard, top, Starboard, assembly (Spares condition)	1	—	C	
	10-20 WA 1699A	SKIN, outboard, bottom, Port, assembly (For spares use 10-20 WA 2255A/ND)	1	—	—	LJ1
15116	10-20 WA 2255A/ND	SKIN, outboard, bottom, Port, assembly (Spares condition)	1	—	C	
	10-20 WA 1700A	SKIN, outboard, bottom, Starboard, assembly (For spares use 10-20 WA 2256A/ND)	1	—	—	LJ1
15117	10-20 WA 2256A/ND	SKIN, outboard, bottom, Starboard, assembly (Spares condition)	1	—	C	
	10-20 WA 1697A	SKIN, outboard, top, Port, assembly (For spares use 10-20 WA 2253A/ND)	1	—	—	LJ1
15114	10-20 WA 2253A/ND	SKIN, outboard, top, Port, assembly (Spares condition)	1	—	C	
	10-20 WA 1698A	SKIN, outboard, top, Starboard, assembly (For spares use 10-20 WA 2254A/ND)	1	—	—	LJ1
15115	10-20 WA 2254A/ND	SKIN, outboard, top, Starboard, assembly (Spares condition)	1	—	C	

MAIN PLANES

AILERON

Ref. No.	Part No.	Description	No. off	Material Specification	Class of Store or L.M.	Plate No.
	10-20 WA 1263ND	STIFFENER , L.E. skin, between rib No. 6A and nose rib No. 8, Port (Make from standard section J.604, Ref. No. 26AE/166)	1	—	LM	LJ1
	10-20 WA 1264ND	STIFFENER , L.E. skin, between rib No. 6A and nose rib No. 8, Starboard (Make from standard section J.604, Ref. No. 26AE/166)	1	—	LM	LJ1
	10-20 WA 251ND	STIFFENER , L.E. skin, between nose ribs Nos. 8 and 9 (Make from standard section J.604, Ref. No. 26AE/166)	1	—	LM	LJ1
	10-20 WA 253ND	STIFFENER , L.E. skin, between nose ribs Nos. 9 and 11 (Make from standard section J.604, Ref. No. 26AE/166)	1	—	LM	LJ1
	10-20 WA 255ND	STIFFENER , L.E. skin, between nose ribs Nos. 11 and 12A (Make from standard section J.604, Ref. No. 26AE/166)	1	—	LM	LJ1
	10-20 WA 1793	STIFFENER , skin, between rib No. 18 and outer rib (For spares use 10-20 WA 2063ND)	1	—	—	LJ1
14772	10-20 WA 2063ND	STIFFENER , skin, between rib No. 18 and outer rib (Spares condition)	1	—	C	
	10-20 WA 1795	STIFFENER , skin, between rib No. 18 and outer rib (For spares use 10-20 WA 2065ND)	1	—	—	LJ1
14773	10-20 WA 2065ND	STIFFENER , skin, between rib No. 18 and outer rib (Spares condition)	1	—	C	
	10-20 WA 1333A	TIP , aileron, Port, assembly (For spares use 10-20 WA 2307A/ND)	1	—	—	LJ2
20254	10-20 WA 2307A/ND	TIP , aileron, Port, assembly (Pre Mod. 1048) ... (Spares condition)	1	—	C	
	10-20 WA 1333A	TIP , aileron, Port, assembly (For spares use 10-20 WA 2309A/ND)	1	—	—	LJ2
20485	10-20 WA 2309A/ND	TIP , aileron, Port, assembly (Mod. 1048) (Spares condition)	1	—	C	
	10-20 WA 1334A	TIP , aileron, Starboard, assembly (For spares use 10-20 WA 2308A/ND)	1	—	—	LJ2
20255	10-20 WA 2308A/ND	TIP , aileron, Starboard, assembly (Pre Mod. 1048) Spares condition)	1	—	C	
	10-20 WA 1334A	TIP , aileron, Starboard, assembly (For spares use 10-20 WA 2310A/ND)	1	—	—	LJ2
20486	10-20 WA 2310A/ND	TIP , aileron, Starboard, assembly (Mod. 1048) (Spares condition) Spares for :—	1	—	C	
13275	10-20 WA 1241A/1	BRACKET , mounting, mass balance, assembly	1	—	C	LJ2
	10-20 WA 1929A/ND	CONDUIT , formation lamp cables, aft, Port, assembly	1	—	—	LJ2
	10-20 WA 1930A/ND	CONDUIT , formation lamp cables, aft, Starboard, assembly	1	—	—	LJ2
	10-20 WA 1927A/ND	CONDUIT , formation lamp cables, forward, Port, assembly	1	—	—	LJ2
	10-20 WA 1928A/ND	CONDUIT , formation lamp cables, forward, Starboard, assembly	1	—	—	LJ2
	10-20 WA 1345	DIAPHRAGM , front (For spares use 10-20 WA 2061A/ND)	1	—	—	LJ2
14767	10-20 WA 2061ND	DIAPHRAGM , front (Spares condition) ...	1	—	C	
	10-20 WA 1803A	RIB , aft, assembly (For spares use 10-20 WA 2057A/ND)	1	—	—	LJ1

LJ1

MAIN PLANE

AILERON

RESTRICTED

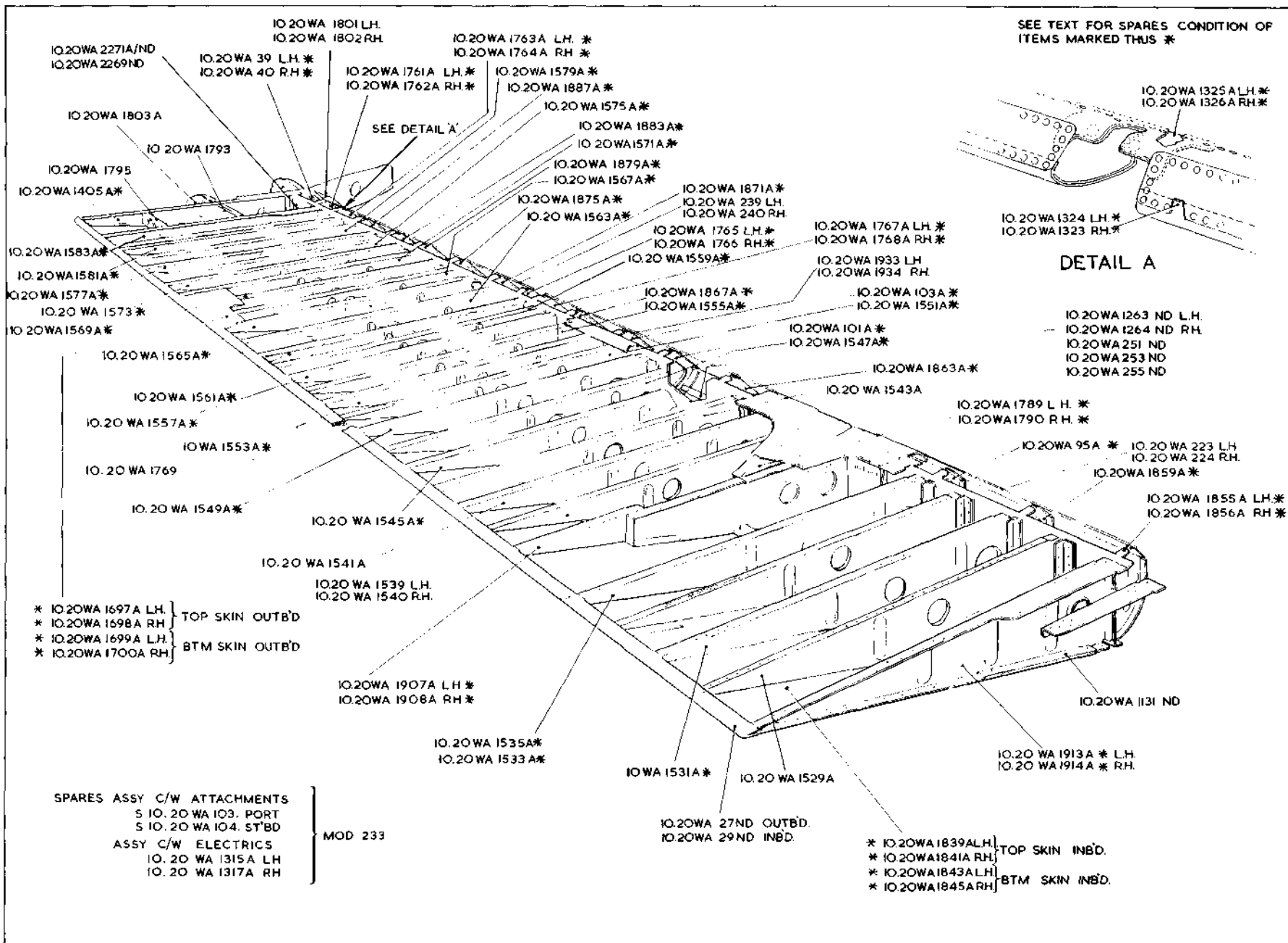

Sec Vixen Mk I

RESTRICTED

Plate LJ1

LJ1
[Es Ty]

Lj.2

SEE TEXT FOR SPARES CONDITION
OF ITEMS MARKED THUS: *

MAIN PLANE

AILERON

RESTRICTED

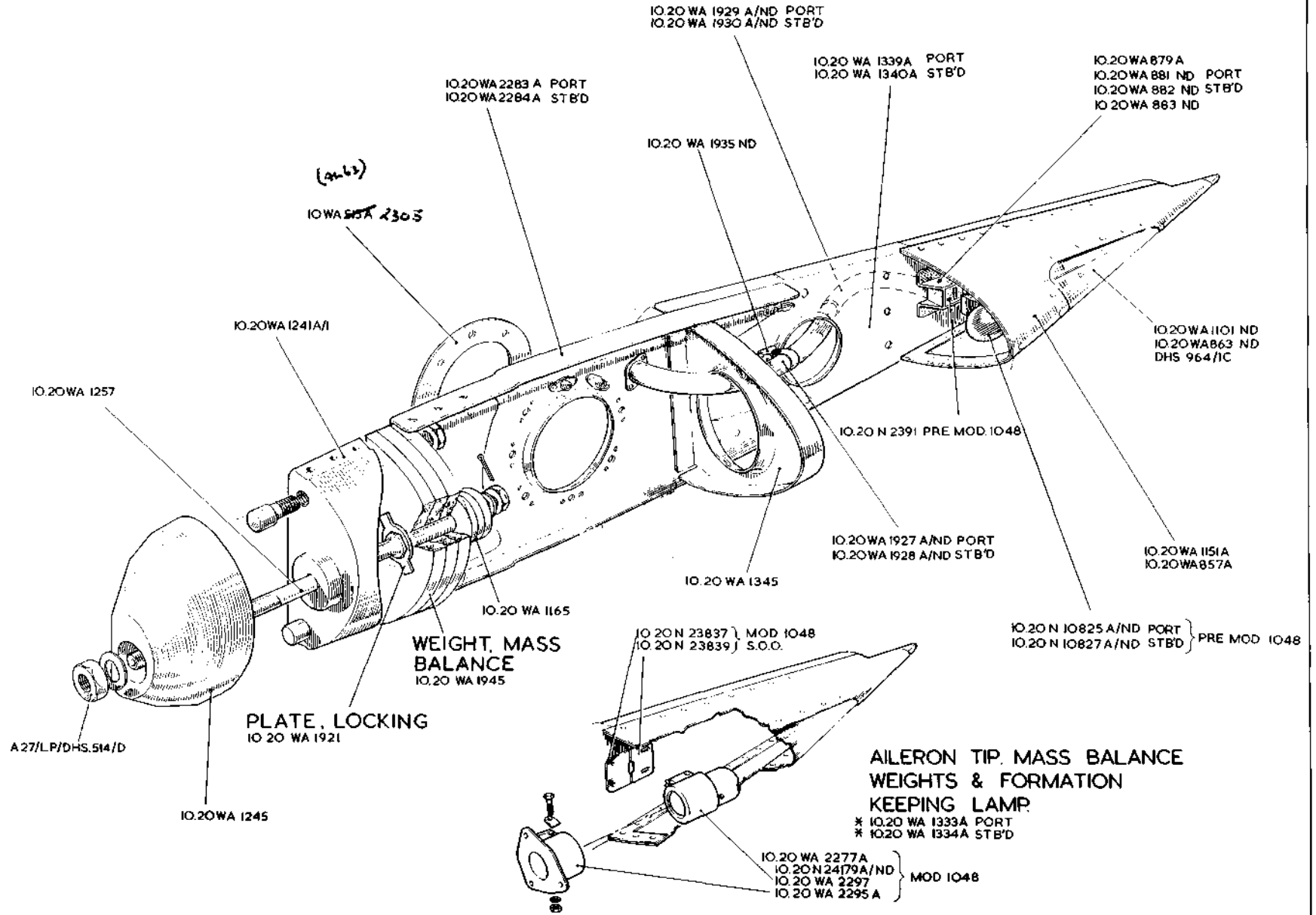

See Vixen Mk. I

RESTRICTED

Plate Lj.2

Lj.2
[All 60]

SEE TEXT FOR SPARES CONDITION OF ITEMS MARKED THUS *

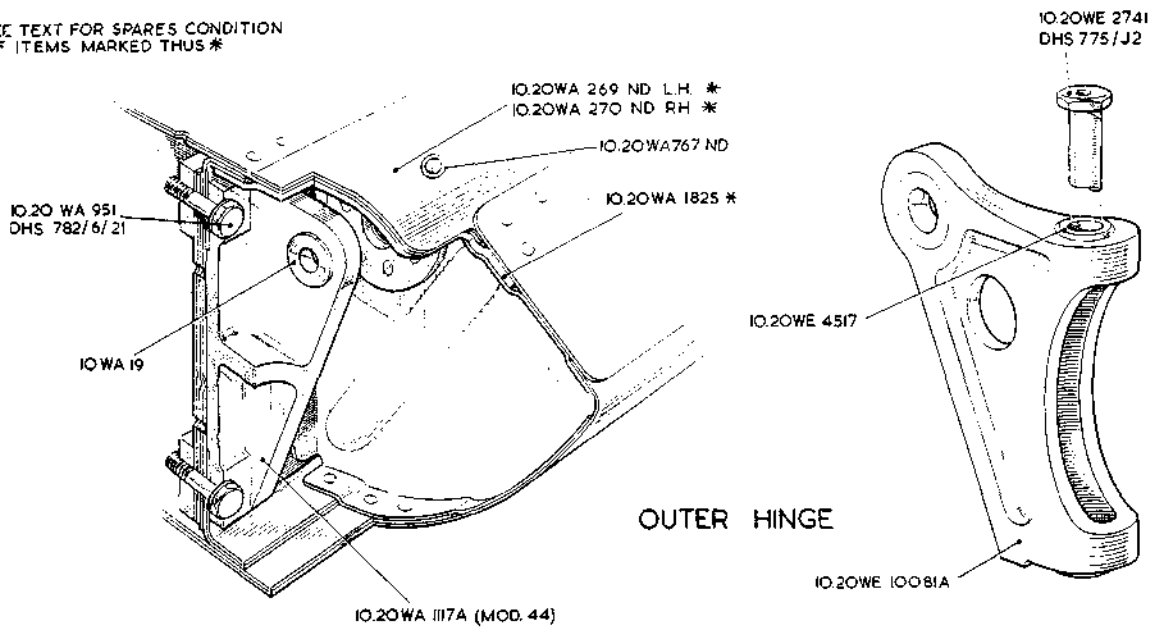

SERVODYNE ATTACHMENTS
IO.20WE 10019

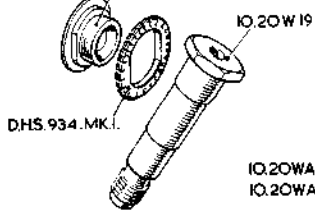

ATTACHMENTS FOR BRACKETS
 DHS 358/3C
 DHS 358/3E
 DHS 770/C L.H. & R.H.
 DHS 770/E
 DHS 770/B

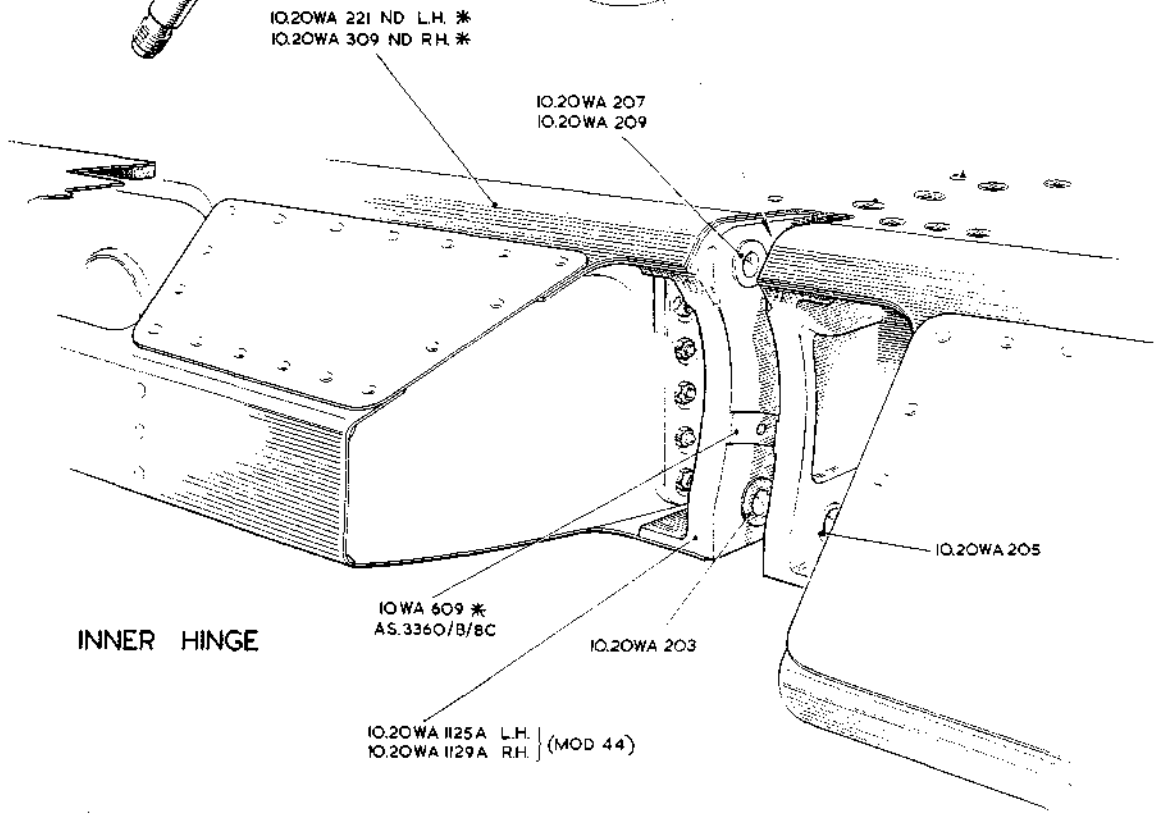
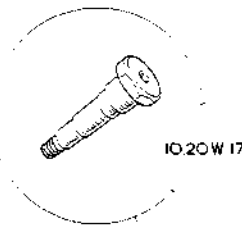

LJ.4

MAIN PLANE

LJ.4

AILERON

[A.L.4]

SEE TEXT FOR SPARES CONDITION
OF ITEMS MARKED THUS *

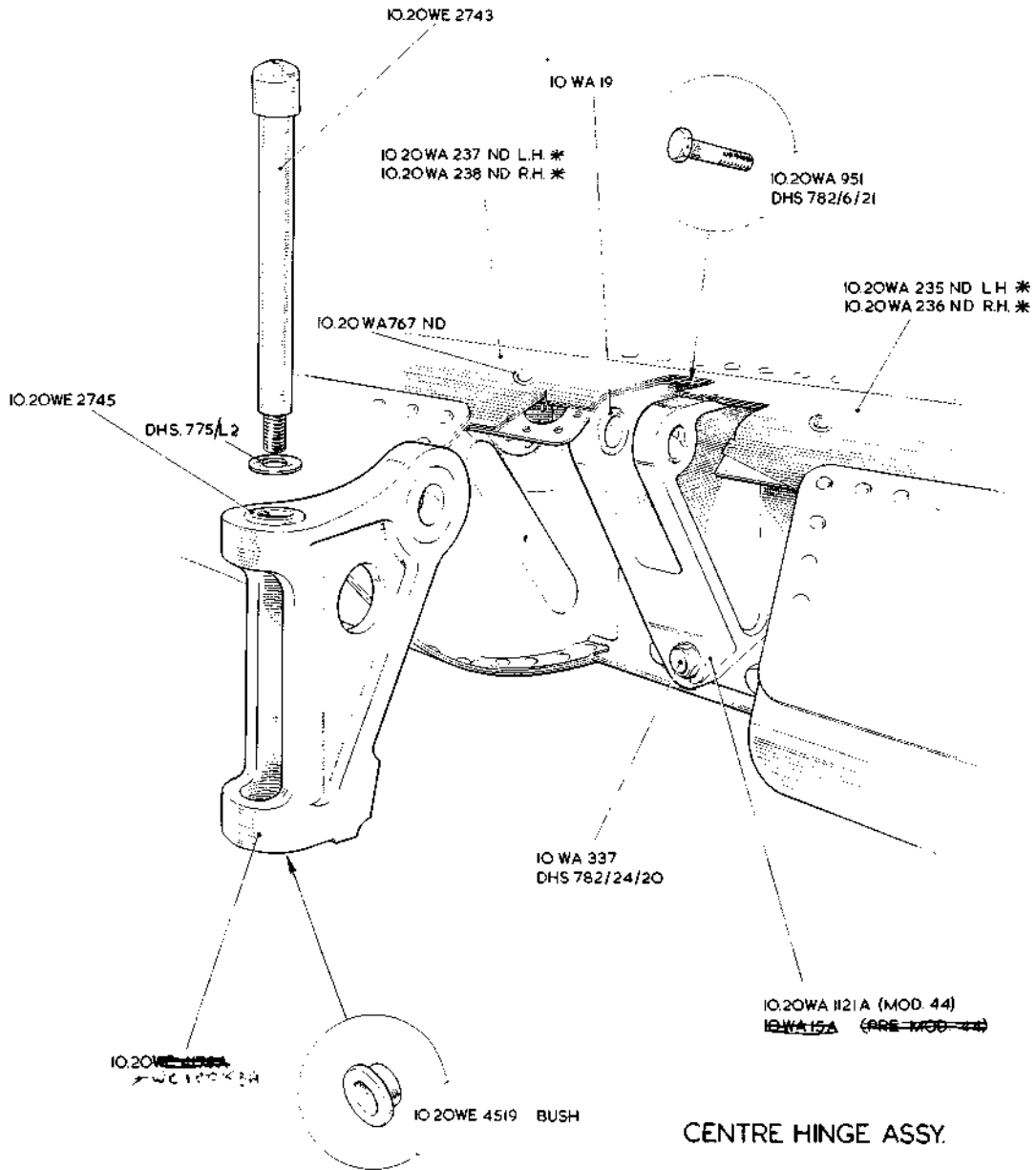

LJ.3

MAIN PLANE

LJ.3

AILERON

[A.L.21]

This file was downloaded
from the RTFM Library.

Link: www.scottbouch.com/rtfm

Please see site for usage terms,
and more aircraft documents.

