

**POWER INSTALLATION  
ENGINE CHANGE UNIT**

Ref. No.	Part No.	Description	No. off	Material Specification	Class of Store or L.M	Place No.
	—	<b>ENGINE CHANGE UNIT</b> (Drg. Nos. 10-20 E 23 and 10-20 E 8273) Spares for :—	2	—	—	MB1 MB2
13496	10-20 E 4915	<b>ADAPTER</b> , connection, hydraulic header tank pressurising (Mod. 164)	1	—	C	MB2
17319	10-20 E 8019	<b>ADAPTER</b> , connection, for 8th stage tapping (Mod. 1108)	1	—	C	MB1
13493	10-20 V 2475	<b>ADAPTER</b> , connection, for 15th stage tapping (gaskets not required)	1	—	C	MB1
18795	10-20 E 5769	<b>BRACKET</b> , support, pipe, combined drain, frame 338"10, 20 SWG (Mod. 1187)	1	—	C	MB2
14461	10-20 E 5177	<b>BRACKET</b> , support, pipe, combined drain, frame 319"75, 18 SWG	1	—	C	MB2
13508	10-20 E 5173	<b>BUSH</b> , half, pipe protector, at support clip, frame 319"75	2	—	C	MB2
14456	10-20 E 5105	<b>BUSH</b> , half, pipe protector, at support clip at compressor duct outlet	2	—	C	MB2
14455	10-20 E 5141	<b>CLIP</b> , pipe, at compressor duct outlet	1	—	C	
		Attachments for 10-20 E 5141, Clip :—				
10099	10-20 E 5035ND	Nut, 2 BA	1	—	C	
28W/9419402	SP.13/C	Washer	1	—	C	
28W/9419404	SP.16/C	Washer	1	—	C	
13509	10-20 E 5175	<b>CLIP</b> , pipe drain, support, at frame 319"75	1	—	C	MB2
		Attachments for 10-20 E 5175, Clip :—				
28D/9436920	A25/1C	Bolt, 2 BA	1	—	C	
10099	10-20 E 5035ND	Nut, 2 BA	1	—	C	MB2
28W/9419402	SP.13/C	Washer	1	—	C	
18799	10-20 E 8277A	<b>DUCT</b> , outlet, compressor seal vent, assembly (Mod. 1187) Spares for :—	1	—	P	MB1
13490	10-20 E 3193A	<b>ELBOW</b> , wheelcase breather outlet, assembly	1	—	C	MB1
	—	<b>ELECTRICAL COMPONENTS</b> (See sub-section ECL)	—	—	—	
	—	<b>GASKETS</b> (For items fitted to engine where required —supplied by Rolls Royce Ltd.—See AP.4481H, Vol. 3, Pt. 1)	—	—	—	
17357	10-20 E 8021	<b>GASKET</b> , for 8th stage tapping adapter (Mod. 1108)	1	—	C	MB1
6A/4802	—	<b>GENERATOR</b> , Mk. 12, tachometer	1	—	P	
14452	10-20 E 4587A	<b>HOSE</b> , combined drain, rear fireproof bulkhead, assembly	1	—	C	MB2
14458	10-20 E 4669	<b>HOSE</b> , combined drain, bulkhead to frame 338"10	1	—	C	MB2
14465	10-20 E 4655	<b>HOSE</b> , drain, combustion chamber to support bracket, frame 338"10	1	—	C	MB2
20612	10-20 E 8295A	<b>RING</b> , sealing, engine, rear fireproof bulkhead, assembly (Mod. 1423) Spares for :—	1	—	C	MB1
	ROLLS ROYCE KJ4006	<b>NUT</b>	2	—	—	MB1
	ROLLS ROYCE BR56821	<b>PIECE</b> , distance	2	—	—	MB1
20614	10-20 E 8285	<b>PLATE</b> , sole (Mod. 1423) Attachments for 10-20 E 8285, Plate :—	1	—	C	MB1
		Bolt, 2 BA	1	—	C	
28D/9436920	A25/1C	Nut, 2 BA	1	—	C	
10099	10-20 E 5035ND	Washer	1	—	C	
28W/9419402	SP.13/C	Washer	1	—	C	

**POWER INSTALLATION  
ENGINE CHANGE UNIT**

Ref. No.	Part No.	Description	No. off	Material Specification	Class of Store or L.M.	Plate No.
20616	10-20 E 8343	PLATE, sole (Mod. 1423) ... ..	1	—	C	MB1
	ROLLS ROYCE KM156					
20618	10-20 E 8349A/ND	SCREW, set ... .. SEGMENT, lower, L.H., assembly (Mod. 1423) ... Spares for :—	2 1	— —	— P	MB1 MB1
13486	10-20 E 2439A	JOINT, angle, assembly, L.H. ... ..	2	—	C	MB1
13487	10-20 E 2440A	JOINT, angle, assembly, R.H. ... ..	2	—	C	MB1
13497	10-20 E 2431ND	PACKING, 22 SWG ... ..	1	—	C	MB1
	10-20 E 2419ND	TONGUE, 22 SWG ... ..	1	DHA.70	—	MB1
20613	10-20 E 8347A/ND	SEGMENT, lower, R.H., assembly (Mod. 1423) ... Spares for :—	1	—	C	MB1
13486	10-20 E 2439A	JOINT, angle, assembly, L.H. ... ..	2	—	C	MB1
13487	10-20 E 2440A	JOINT, angle, assembly, R.H. ... ..	2	—	C	MB1
13497	10-20 E 2431ND	PACKING, 22 SWG ... ..	1	—	C	MB1
13483	10-20 E 2411A/ND	SEGMENT, top, assembly ... .. Spares for :—	1	—	C	MB1
13486	10-20 E 2439A	JOINT, angle, assembly, L.H. ... ..	2	—	C	MB1
13487	10-20 E 2440A	JOINT, angle, assembly, R.H. ... ..	2	—	C	MB1
	10-20 E 2419ND	TONGUE, 22 SWG ... ..	2	DHA.70	—	MB1
		Attachments for 10-20 E 8349A/ND, 10-20 E 8347A/ND or 10-20 E 2411A/ND, Segment :—				
28D/1010030	A25/7C	Bolt, 2 BA ... ..	2	—	C	
10099	10-20 E 5035ND	Nut, 2 BA ... ..	2	—	C	MB1
28W/9419402	SP.13/C	Washer ... ..	2	—	C	
12026	DHS.180 Mk. 1/Z	TAG, locking wire ... ..	4	—	C	MB1
	ROLLS ROYCE K11703	WASHER ... ..	2	—	—	MB1
	ROLLS ROYCE K11403	WASHER, spring ... ..	2	—	—	MB1
13488	10-20 E 2447	RING, sealing, rear firewall, rubber ... ..	2	—	C	MB1
16257	10-20 S 20453A	TUBE, guide, at 15th stage outlet, assembly (Mod. 992)	2	—	C	MB2
14453	10-20 E 4601A	UNION, connector, at bulkhead, assembly Spares for :—	1	—	C	MB2
27QA/423	DOWTY SP.910A/8	RING, sealing ... ..	1	—	C	MB2
		Attachments for 10-20 E 4601A, Union :—				
28D/1011466	A26/3C	Bolt, 2 BA ... ..	2	—	C	
28M/9436836	AGS.2001/C/2	Nut, 2 BA ... ..	2	—	C	
28W/9128924	SP.14/C	Washer ... ..	2	—	C	
14459	10-20 E 4485	UNION, connector, combined drain pipe, at support bracket, frame 338"10	1	—	C	MB2
		Attachments for 10-20 E 4485, Union :—				
14460	10-20 E 4503	Nut, 1" BSP ... ..	1	—	C	MB2
28W/16134	SP.14/U	Washer ... ..	1	—	C	
14466	10-20 E 4667	UNION, connector, for combustion chamber drain pipe, at support bracket, frame 338"10	1	—	C	MB2
		Attachments for 10-20 E 4667, Union :—				
14468	10-20 E 4799	Nut, 1" BSP ... ..	1	—	C	MB2
14467	10-20 E 4801	Washer, 18 SWG ... ..	1	—	C	MB2
	—	UNIT, power (For spares see AP.4481, Vol. 3, Pt. 1)	—	—	—	

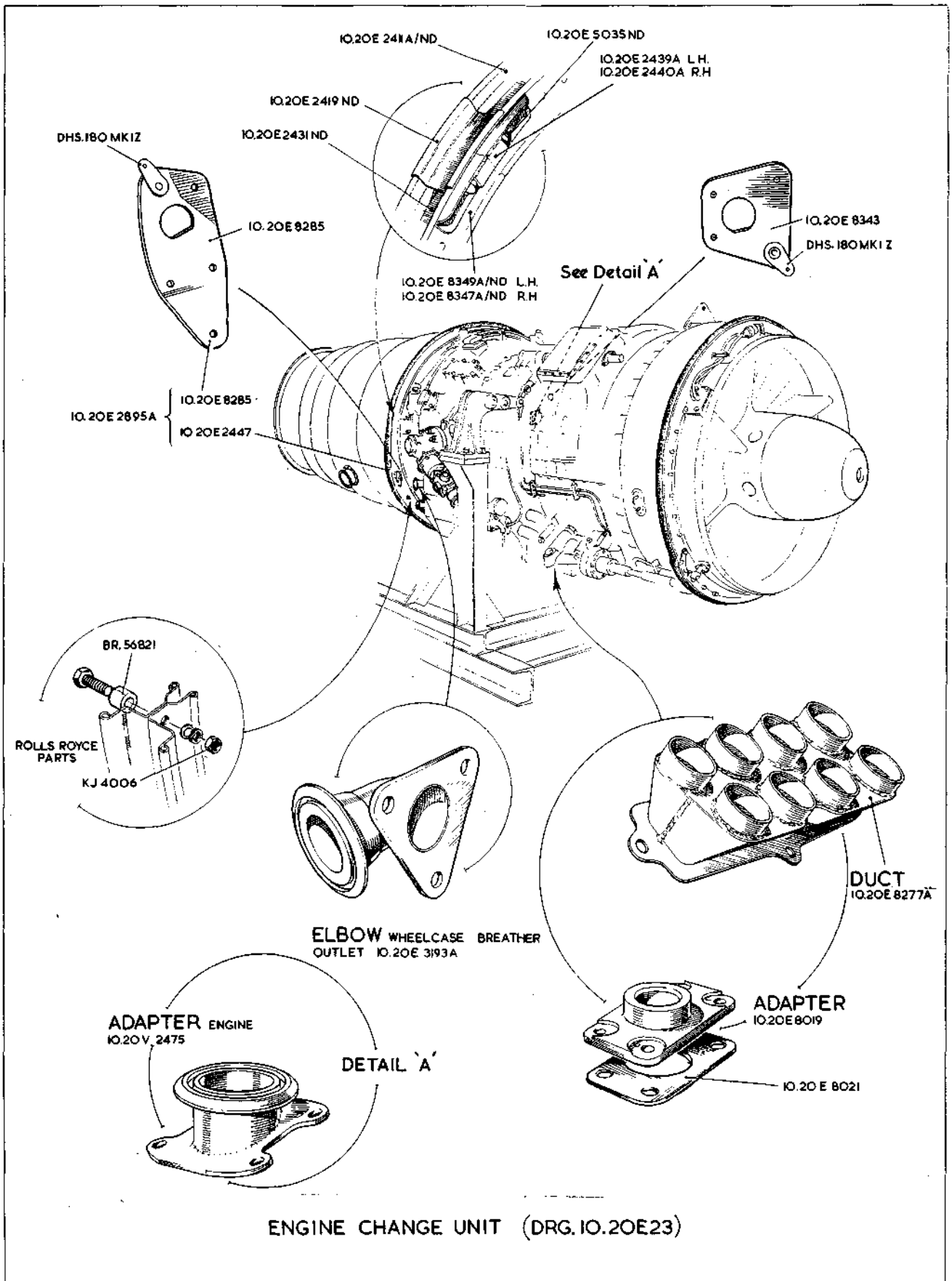

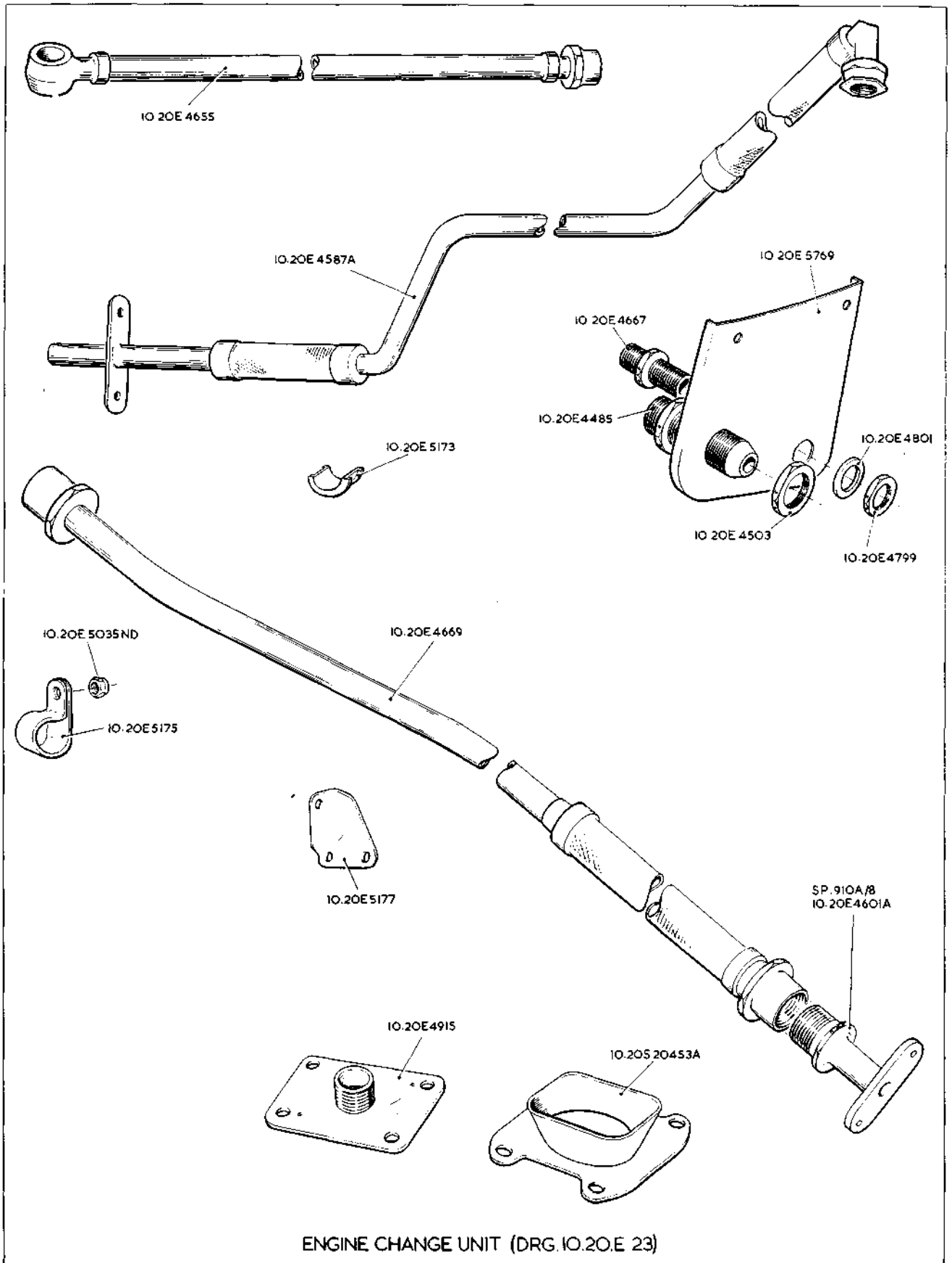

MB2

# POWER INSTALLATION

## ENGINE CHANGE UNIT

MB.2  
[AL. 54]