

**FIRE EXTINGUISHER SYSTEM**

| Ref. No.              | Part No.         | Description  | No. of | Material Specification | Class of Store or LM | Plate No.  |
|-----------------------|------------------|--|--------|------------------------|----------------------|------------|
|                       |                  |  |        |                        |                      |            |
|                       |                  | <b>FIRE EXTINGUISHER SYSTEM</b> (Drg. Nos. 10-20 M671, 10-20 S 4425 and 10-20 S 14423)<br>Spares for :—  | 1      | —                      | —                    | MK1        |
| 27N/258               | GRAVINER 31B/377 | <b>BRACKET</b> , light alloy, at Type 39A fire extinguisher (Mod. 906)                                   | 1      | —                      | P                    | MK1        |
| Naval Ref. No. KJ/833 | —                | <b>CARTRIDGE</b> , electric, operating Types 14A and 39A extinguishers (Mod. 1195)                       | 3      | —                      | P                    |            |
| Naval Ref. No. KJ/846 | —                | <b>CARTRIDGE</b> , electric, operating Type 14A extinguishers (Mod. 1195)                                | 2      | —                      | P                    |            |
| 5095                  | 10-20 M 113      | <b>CLAMP</b> , half, neck attachment of Type 14A fire extinguishers (Pre Mod. 655) ...<br>(Mod. 655) ... | 4<br>2 | L.72<br>L.72           | C<br>C               | MK1<br>MK1 |
| 28D/1011030           | A25/2E           | Attachments for 10-20 M 113, Clamp :—  |        |                        |                      |            |
| 28M/10290             | AGS.2001/E/1     | Bolt, 3/8" BSF   | 1      | —                      | C                    |            |
|                       | AVDEL LTD.       | Nut, 3/8" BSF  | 1      | —                      | C                    |            |
| 28FP/4                | A.407            | Pin, "Pip," quick release  | 1      | —                      | C                    |            |
| 28W/9419405           | SP.15/E          | Washer   | 1      | —                      | C                    |            |
| 14927                 | 10-20 M 817      | <b>CLAMP</b> , quarter, neck attachment of Type 14A fire extinguisher (Mod. 655)                         | 4      | —                      | C                    | MK1        |
| 28D/1011030           | A25/2E           | Attachments for 10-20 M 817, Clamp :—  |        |                        |                      |            |
| 28M/10290             | AGS.2001/E/1     | Bolt, 3/8" BSF   | 1      | —                      | C                    |            |
| 28W/9419405           | SP.15/E          | Nut, 3/8" BSF  | 1      | —                      | C                    |            |
|                       |                  | Washer   | 1      | —                      | C                    |            |
| 28E/14083             | AS.3181/12C      | <b>CLIP</b> , "P," supporting pipe from Type 39A fire extinguisher                                       | 1      | —                      | C                    |            |
| 28D/9133012           | A25/3C           | Attachments for AS.3181/12C, Clip :—   |        |                        |                      |            |
|                       | 10-20 M 591ND    | Bolt, 2 BA   | 1      | —                      | C                    |            |
|                       |                  | Washer, distance (3/8" o/d x No. 11 i/d x 0"20 thick)  | 1      | L.65                   | LM                   | MK1        |
|                       |                  | <b>CLIP</b> , supporting pipe from Type 39A fire extinguisher, group                                     | 1      | —                      | —                    |            |
|                       |                  | Spares for :—  |        |                        |                      |            |
| 28D/9436920           | A25/1C           | <b>BOLT</b> , 2 BA   | 1      | —                      | C                    |            |
| 28D/1011019           | A25/8C           | <b>BOLT</b> , 2 BA   | 1      | —                      | C                    |            |
| 5091                  | 10-20 M 779      | <b>BUSH</b> , half   | 2      | —                      | C                    | MK1        |
| 5090                  | 10-20 M 771A     | <b>CLIP</b> , pipe, assembly...  | 1      | —                      | C                    | MK1        |
| 28M/10288             | AGS.2001/C/1     | <b>NUT</b> , 2 BA  | 2      | —                      | C                    |            |
|                       |                  | <b>CLIP</b> , strap support, on undercarriage door mechanism support beam strut, group                   | 2      | —                      | —                    |            |
| 28D/1011240           | A25/5E           | <b>BOLT</b> , 3/8" BSF   | 2      | —                      | C                    |            |
|                       | 10-20 M 123A     | <b>CLIP</b> , flanged, Port, assembly  | 1      | —                      | LM                   | MK1        |
|                       | 10-20 M 124A     | <b>CLIP</b> , flanged, Starboard, assembly   | 1      | —                      | LM                   | MK1        |
| 28E/14600             | AS.1158/8        | <b>CLIP</b> , saddle, half   | 1      | —                      | C                    |            |
|                       | 10-20 M 125ND    | <b>FLANGE</b> , 16 SWG   | 1      | S.3                    | LM                   | MK1        |
| 28E/14600             | AS.1158/8        | <b>CLIP</b> , saddle, half   | 2      | —                      | C                    |            |
| 28M/10330             | AGS.2002/E/1     | <b>NUT</b> , 3/8" BSF  | 2      | —                      | C                    |            |

**POWER INSTALLATION  
FIRE EXTINGUISHER SYSTEM**

| Ref. No.    | Part No.             | Description   | No. off | Material Specification | Class of Store or L.M | Place No. |
|-------------|----------------------|---|---------|------------------------|-----------------------|-----------|
|             |                      |   |         |                        |                       |           |
|             |                      | <b>ELECTRICAL COMPONENTS</b> (See sub-section "ECM")  | -       | -                      | -                     |           |
| 27N/145     | GRAVINER<br>Type 39A | <b>EXTINGUISHER</b> , fire, methyl bromide, automatic, 6 lb., 3/4" bore discharge, on strut between front and rear portions of rib "O," coded "HG" (Mod. 906) | 1       | -                      | P                     | MK1       |
| 27N/102     | GRAVINER<br>Type 14A | <b>EXTINGUISHER</b> , fire, methyl bromide, automatic, 12 lb., 3/4" bore discharge, at rib No. 1, Port and Starboard, coded "PR" and "VR"                     | 2       | -                      | P                     | MK1       |
| 5074        | 10-20 M 755A         | <b>NOZZLE</b> , at rib No. 1, Port, assembly  | 1       | -                      | P                     | MK1       |
| 5075        | 10-20 M 756A         | <b>NOZZLE</b> , at rib No. 1, Starboard, assembly   | 1       | -                      | P                     | MK1       |
|             |                      | Attachments for 10-20 M 755A or 10-20 M 756A, Nozzle :-   |         |                        |                       |           |
| 28D/9133011 | A25/2C               | Bolt, 2 BA  | 4       | -                      | C                     |           |
| 28M/10288   | AGS.2001/C/1         | Nut, 2 BA   | 4       | -                      | C                     |           |
| 26FN/3285   | DHS.180 Mk. 3/X      | Tag, locking  | 2       | -                      | C                     |           |
| 508         | 10-20 M 761A         | <b>NOZZLE</b> , at rib No. 1, aft of rear firewall, Port, group   | 1       | -                      | -                     |           |
|             |                      | <b>ADAPTER</b> , assembly   | 1       | -                      | C                     | MK1       |
|             |                      | Attachments for 10-20 M 761A, Adapter :-  |         |                        |                       |           |
| 28D/9133011 | A25/2C               | Bolt, 2 BA  | 4       | -                      | C                     |           |
| 28M/10288   | AGS.2001/C/1         | Nut, 2 BA   | 4       | -                      | C                     |           |
| 26FN/3285   | DHS.180 Mk. 3/X      | Tag, locking  | 2       | -                      | C                     |           |
| 5092        | 10-20 M 759A/ND      | <b>NOZZLE</b> , assembly  | 1       | -                      | C                     | MK1       |
|             |                      | <b>NOZZLE</b> , at rib No. 1, aft of rear firewall, Starboard, group  | 1       | -                      | -                     |           |
| 5087        | 10-20 M 79A          | <b>ADAPTER</b> , assembly   | 1       | -                      | C                     | MK1       |
|             |                      | Attachments for 10-20 M 79A, Adapter :-   |         |                        |                       |           |
| 28D/9133911 | A25/2C               | Bolt, 2 BA  | 4       | -                      | C                     |           |
| 28M/10288   | AGS.2001/C/1         | Nut, 2 BA   | 4       | -                      | C                     |           |
| 26FN/3285   | DHS.180 Mk. 3/X      | Tag, locking  | 2       | -                      | C                     |           |
| 5092        | 10-20 M 759A/ND      | <b>NOZZLE</b> , assembly  | 1       | -                      | C                     | MK1       |
| 9615        | 10-20 M 819A/ND      | <b>PIPE</b> , between nozzle at rib No. 1 and pipe on rear face of front firewall, Port, assembly   | 1       | -                      | C                     | MK1       |
| 9616        | 10-20 M 821A/ND      | <b>PIPE</b> , between nozzle at rib No. 1 and pipe on rear face of front firewall, Starboard, assembly  | 1       | -                      | C                     | MK1       |
| 5093        | 10-20 M 767ND        | <b>PIPE</b> , between Port fire extinguisher and nozzle   | 1       | -                      | C                     | MK1       |
| 5094        | 10-20 M 768ND        | <b>PIPE</b> , between Starboard fire extinguisher and nozzle  | 1       | -                      | C                     | MK1       |
| 4560        | 10-20 S 8259ND       | <b>PIPE</b> , between Port fire extinguisher and rear wheel well wall   | 1       | -                      | C                     | MK1       |
| 11513       | 10-20 M 863ND        | <b>PIPE</b> , between Starboard fire extinguisher and rear wheel well wall  | 1       | -                      | C                     | MK1       |
| 5085        | 10-20 M 121ND        | <b>PIPE</b> , between rear wheel well wall and nozzle at rib No. 1, behind rear firewall, Port  | 1       | -                      | C                     | MK1       |
| 5086        | 10-20 M 122ND        | <b>PIPE</b> , between rear wheel well wall and nozzle at rib No. 1, behind rear firewall, Starboard   | 1       | -                      | C                     | MK1       |
| 5089        | 10-20 M 685A/ND      | <b>PIPE</b> , from central fire extinguisher, with nozzle, assembly   | 1       | -                      | C                     | MK1       |

**POWER INSTALLATION**

**FIRE EXTINGUISHER SYSTEM**

| Ref. No.    | Part No.              | Description   | No. off | Material Specification | Class of Store or LM | Place No. |
|-------------|-----------------------|---|---------|------------------------|----------------------|-----------|
|             |                       |   |         |                        |                      |           |
| 5079        | 10-20 M 689A/ND       | <b>PIPE</b> , on rear face of front firewall, with nozzle, Port. assembly                           | 1       | —                      | P                    | MK1       |
| 5078        | 10-20 M 687A/ND       | <b>PIPE</b> , on rear face of front firewall, with nozzle, Star-board, assembly                     | 1       | —                      | P                    | MK1       |
|             |                       | Attachments for 10-20 M 689A/ND or 10-20 M 687A/ND.<br>Pipe :—                                      |         |                        |                      |           |
| 28D/1010030 | 10-20 M 829<br>A25/7C | Block, packing, 2"0 × "63 × "50 ... ..  | 1       | LFS.21                 | LM                   | MK1       |
|             | 10-20 M 827A          | Bolt, 2 BA ... ..   | 2       | —                      | C                    |           |
| 28M/10288   | AGS.2001/C/1          | Clip, pipe, assembly ... ..   | 1       | L.72                   | LM                   | MK1       |
|             |                       | Nut, 2 BA ... ..  | 2       | —                      | C                    |           |
| 5096        | 10-20 M 91A           | <b>STRAP</b> , for Type 14A fire extinguisher, assembly ...   | 2       | —                      | P                    | MK1       |
| 26DL/3293   | 6 WC 9593A            | <b>BOLT</b> , wing, 2 BA, assembly ... ..   | 1       | —                      | C                    | MK1       |
|             | 10-20 M 97A           | <b>BRACKET</b> , assembly ... ..  | 1       | S.510                  | LM                   | MK1       |
|             | 10-20 M 105A          | <b>BRACKET</b> , assembly ... ..  | 1       | S.510                  | LM                   | MK1       |
|             | 10-20 M 95ND          | <b>PAD</b> , neoprene rubber, $\frac{1}{16}$ " thick, Shore hardness 40-60 (Secure with Bostik "C") | 1       | Neoprene Rubber        | LM                   | MK1       |
|             | 10-20 M 93ND          | <b>STRAP</b> , bare, 20 SWG ... ..  | 1       | L.72                   | —                    | MK1       |
| 26DL/3249   | 6 WC 9589             | <b>TRUNNION</b> (threaded 2 BA) ... ..  | 1       | —                      | C                    | MK1       |
| 26DL/3294   | 6 WC 9591             | <b>TRUNNION</b> (plain hole) ... ..   | 1       | —                      | C                    | MK1       |
|             |                       | Attachments for 10-20 M 91A, Strap :—   |         |                        |                      |           |
| 28D/9436920 | A25/1C                | Bolt, 2 BA ... ..   | 2       | —                      | C                    |           |
| 28M/10288   | AGS.2001/C/1          | Nut, 2 BA ... ..  | 2       | —                      | C                    |           |
|             | 10-20 M 723A          | <b>STRAP</b> , bottom, lower half, for Type 39A fire extinguisher, assembly                         | 1       | —                      | —                    | MK1       |
|             | 10-20 M 721A          | <b>STRAP</b> , top, lower half, for Type 39A fire extinguisher.                                     | 1       | —                      | —                    | MK1       |
| 5084        | 10-20 M 741           | <b>BOLT</b> , special, 2 BA for bottom, lower half strap  | 1       | —                      | C                    | MK        |
| 5083        | 10-20 M 739           | <b>BOLT</b> , special, 2 BA, with spigot, for top, lower half strap                                 | 1       | —                      | C                    | MK1       |
|             |                       | Attachments for 10-20 M 741 or 10-20 M 739.<br>Bolt :—  |         |                        |                      |           |
| 28M/10288   | AGS.2001/C/1          | Nut, 2 BA ... ..  | 1       | —                      | C                    |           |
| 28W/9419402 | SP.13/C               | Washer ... ..   | 1       | —                      | C                    |           |
| 5082        | 10-20 M 775           | <b>BUSH</b> , half ... ..   | 4       | —                      | C                    | MK1       |
| 5081        | 10-20 M 749           | <b>CLEAT</b> , bottom half ... ..   | 1       | —                      | C                    | MK1       |
| 5080        | 10-20 M 747           | <b>CLEAT</b> , top half ... ..  | 1       | —                      | C                    | MK1       |
|             | 10-20 M 743A          | <b>STRAP</b> , half, bare ... ..  | 1       | —                      | —                    | MK1       |
|             | 10-20 M 725A          | <b>STRAP</b> , top and bottom, upper half, for Type 39A fire extinguisher, assembly                 | 2       | —                      | —                    | MK1       |
|             | 10-20 M 615           | <b>BOLT</b> , special, shouldered, 2 BA & $\frac{1}{4}$ " BSF ...                                   | 1       | S.96                   | —                    | MK1       |
|             |                       | Attachments for 10-20 M 615, Bolt :—  |         |                        |                      |           |
| 28M/1007403 | A27/ET                | Nut, $\frac{1}{4}$ " BSF ... ..   | 1       | —                      | C                    |           |
| 28W/11071   | AGS.2035/E            | Washer, shakeproof ... ..   | 1       | —                      | C                    |           |
|             | AS.2809/5/160         | Tube, distance, $\frac{5}{8}$ " o/d × 22 SWG × 1"60 long  | 1       | L.62                   | LM                   |           |
|             | 10-20 M 727A/ND       | <b>STRAP</b> , half, bare ... ..  | 1       | —                      | —                    | MK1       |
|             |                       | Attachments for 10-20 M 723A or 10-20 M 721A to 10-20 M 725A, Straps (per pair) :—                  |         |                        |                      |           |
| 28D/9140644 | A25/9C                | Bolt, 2 BA ... ..   | 2       | —                      | C                    |           |
| 28M/10288   | AGS.2001/C/1          | Nut, 2 BA ... ..  | 2       | —                      | C                    |           |

POWER INSTALLATION  
FIRE EXTINGUISHER SYSTEM

| Ref. No. | Part No. | Description |   |   |   |   |   | No. off | Material Specification | Class of Store or L.M. | Plate No. |
|----------|----------|-------------|---|---|---|---|---|---------|------------------------|------------------------|-----------|
|          |          | 1           | 2 | 3 | 4 | 5 | 6 |         |                        |                        |           |
|          |          |             |   |   |   |   |   |         |                        |                        |           |

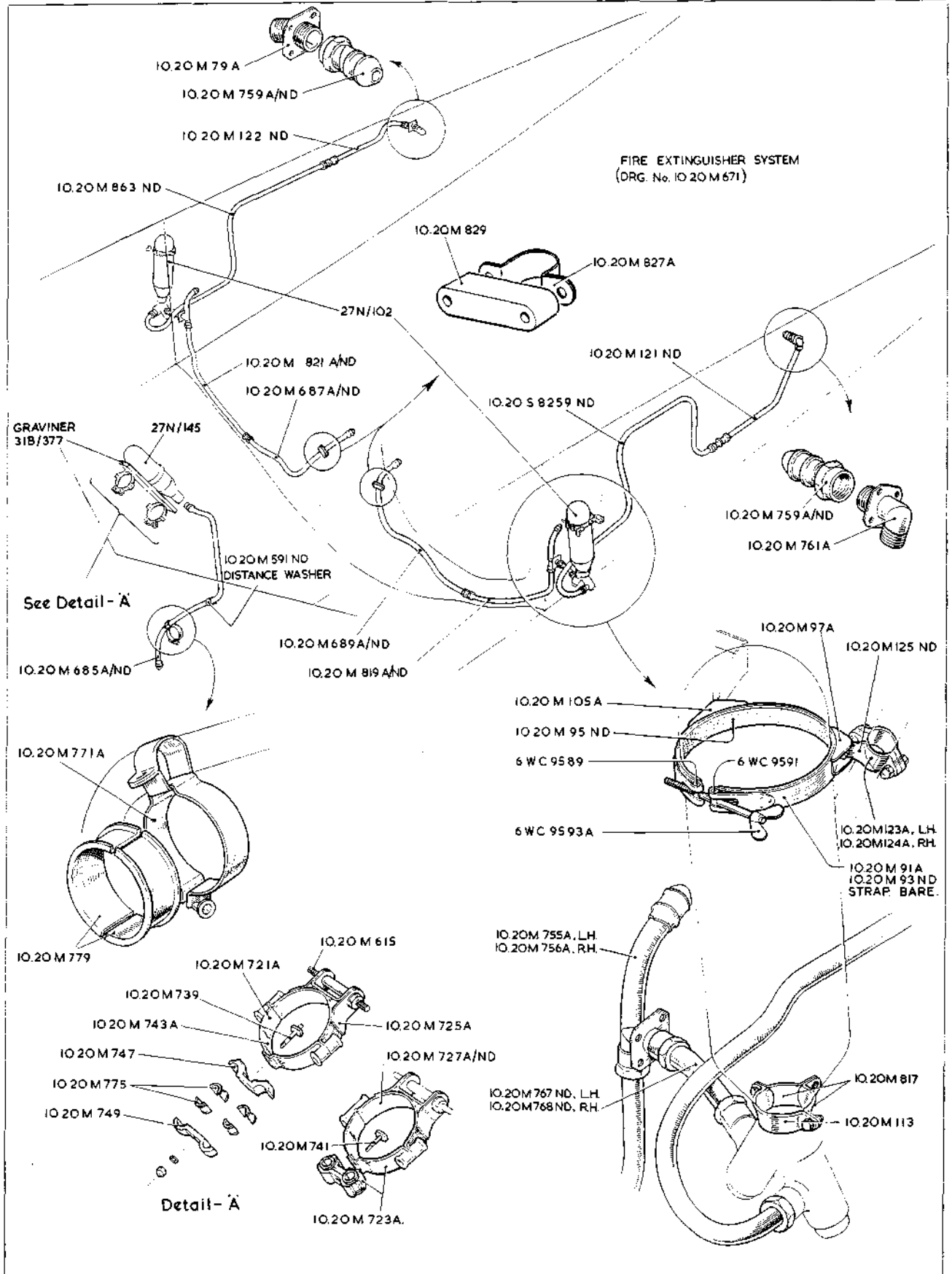

MK. I

# POWER INSTALLATION FIRE EXTINGUISHER SYSTEM

MK. I

[A.L.26]