

SERVICES

WINDSCREEN RAIN SHEDDING PIPES

Ref. No.	Part No.	Description	No. off	Material Specification	Class of Store or L.M	Plate No.
—	—	PIPES, WINDSCREEN RAIN SHEDDING INSTALLATION (Drg. Nos. 10-20 S 20255 and 10-20 S 20391) (Mod. 913)	1	—	—	—
16891	10-20 F 8003	BRACKET , nozzle, at windscreen	1	S.510	C	QK1
28D/13419	AS.3294/8C	Attachments for 10-20 F 8003, Bracket :—				
28M/10288	AGS.2001/C/1	Bolt, 2 BA	3	—	C	
16890	10-20 FC 5001	Nut, 2 BA	3	—	C	
28W/9419475	SP.15/C	Strip, masking	1	L.71	C	QK1
		Washer	3	—	C	
16893	10-20 FS 20069	BRACKET , pipe retaining, at joint of forward and aft fairings	1	DHE.245/1 or S.92	C	QK1
28D/9419397	A25/12C	Attachments for 10-20 FS 20069, Bracket :—				
28M/10288	AGS.2001/C/1	Bolt, 2 BA	2	—	C	
28W/9419402	SP.13/C	Nut, 2 BA	2	—	C	
		Washer	2	—	C	
	10-20 S 20331A	FAIRING and pipes, aft portion, assembly (For spares use 10-20 S 15587A/ND)	1	—	—	QK1
16971	10-20 S 15587A/ND	FAIRING and pipes, aft portion, assembly (Spares condition)	1	—	C	
		Spares for :—				
16869	10-20 S 20303A	PLATE , cover, assembly	1	L.72	C	QK1
28D/1007975	AS.1242/1C	Attachments for 10-20 S 20303A, Plate :—				
		Bolt, 2 BA	2	—	C	
16504	10-20 S 20357	Attachments for 10-20 S 20331A, Fairing and pipes :—				
		Bolt, special, shouldered, 1/2" BSF	1	S.110	C	QK1
		Spares for :—				
27QA/1025	DOWTY GD.2001/B5	Ring, "O," sealing	1	—	C	QK1
28D/14522	A25/23E	Bolt, 1/2" BSF	1	—	C	
28M/10327	AGS.2002/B/1	Nut, 4 BA	56	—	C	
28S/11907	AS.2993/4B	Screw, 4 BA	56	—	C	
26FN/3275	DHS.781/9/16	Washer, 0"-253 i/d x 1"-125 o/d x 16 SWG	1	S.510	LM	QK1
		Washer, shim	2	LB.2	C	QK1
	10-20 S 20281A	FAIRING and pipes, forward portion, assembly (For spares use 10-20 S 15585A/ND)	1	—	—	QK1
16970	10-20 S 15585A/ND	FAIRING and pipes, forward portion, assembly (Spares condition)	1	—	C	
		Spares for :—				
16869	10-20 S 20303A	PLATE , cover, assembly	1	L.72	C	QK1
28D/1007975	AS.1242/1C	Attachments for 10-20 S 20303A, Plate :—				
		Bolt, 2 BA	2	—	C	
28M/10327	AGS.2002/B/1	Attachments for 10-20 S 20281A, Fairing and pipes :—				
28S/11907	AS.2993/4B	Fairing to fuselage :—				
		Nut, 4 BA	36	—	C	
		Screw, 4 BA	36	—	C	

SERVICES
WINDSCREEN RAIN SHEDDING PIPES

Ref. No.	Part No.	Description	No. off						Material Specification	Class of Store or L.M	Plate No.
			1	2	3	4	5	6			
		Pipes to fuselage :-									
28D/1011030	A25/2E	Bolt, 1/2" BSF	1	—	C	
28D/1011238	A25/3E	Bolt, 1/2" BSF	2	—	C	
28D/12571	A25/21E	Bolt, 1/2" BSF	1	—	C	
28D/8308	AS.1242/3C	Bolt, 2 BA	2	—	C	
28M/10288	AGS.2001/C/1	Nut, 2 BA	2	—	C	
28M/10290	AGS.2001/E/1	Nut, 1/2" BSF	3	—	C	
28VV/9419402	SP.13/C	Washer	2	—	C	
28VV/9418921	SP.13/E	Washer	2	—	C	
16889	10-20 S 20483ND	Washer, "Bestobell" J.71 (Fit 2 each side of nozzle and bracket)	4	DTD.378A	C	QK1
16887	10-20 S 20479ND	Washer, "Bestobell" J.71 } Fit between nozzle	3	DTD.378A	C	QK1
16888	10-20 S 20481ND	Washer } feet and fuselage skin	3	LA.3	C	QK1
	DHS.781/9/16	Washer, 0"-253 i/d x 1"-125 o/d x 16 SWG	1	S.510	LM	QK1
26FN/3275	DHS.69/DD	Washer, shim	2	LB.2	C	QK1
	—	FAIRING , forward, rain shedding, windscreen, group (Drg. Nos. 10-20 FS 20079 and 10-20 FS 20115)	1	—	—	QK1
	10-20 FS 17823A/ND	FAIRING , forward, assembly (For spares use 10-20 FS 17963A/ND)	1	—	—	QK1
16969	10-20 FS 17963A/ND	FAIRING , forward, assembly (Spares condition) Spares for :-	1	—	C	
1141	DHS.365/1C	BOLT , 2 BA	1	—	C	
28D/1007975	AS.1242/1C	BOLT , 2 BA	34	—	C	
28D/8308	AS.1242/3C	BOLT , 2 BA	1	—	C	
28D/8310	AS.1242/6C	BOLT , 2 BA	1	—	C	
28M/10328	AGS.2002/C/1	NUT , 2 BA	1	—	C	
28VV/9419454	SP.10/C	WASHER	1	—	C	
		Attachments for 10-20 FS 17823A/ND, Fairing :-				
28D/1007982	AS.1248/1C	Bolt, 2 BA	12	—	C	
28D/9131782	AS.1242/2B	Bolt, 4 BA	1	—	C	
28D/12137	AS.1246/4B	Bolt, 4 BA	1	—	C	
28M/10288	AGS.2001/C/1	Nut, 2 BA	12	—	C	
28M/10287	AGS.2001/B/1	Nut, 4 BA	1	—	C	
28VV/9419465	SP.13/B	Washer	2	—	C	
28VV/9419402	SP.13/C	Washer	12	—	C	
16892	10-20 F 8013	GASKET (Attach to windscreen casting with Araldite adhesive)	1	Bestobell J.12	C	QK1
	—	HANDLE , external, manual, canopy jettison (See sub-section "KC")	—	—	—	
	—	PIPES , rain shedding, in engine bay, group (Drg. No. 10-20 S 20415)	1	—	—	QK2
16878	10-20 S 20413	CHOKE , in pipes forward of butterfly valve	2	—	C	QK2
16948	KING AIRCRAFT CORPORATION C.4205/1 1/2-1 3/4 B Mk. 3	CLAMP , at pipe joints at engine	2	—	C	QK2
16949	KING AIRCRAFT CORPORATION C.4205/1 3/4-2 B Mk. 3	CLAMP , at pipe joints in engine bay and front firewall	6	—	C	QK2

SERVICES

WINDSCREEN RAIN SHEDDING PIPES

Ref. No.	Part No.	Description	No. off	Material Specification	Class of Store or L.M.	Plate No.
16882	10-20 S 20401A	CLAMP , fitted on pipes, aft of front firewall, between ribs Nos. 0 and 7, Port and Starboard, assembly Spares for:—	4	—	C	QK2
	10-20 S 15219ND	CABLE , 3 cwt. (Make from Ref. No. 28X/5450)	1	W9/1P	LM	QK2
	10-20 S 15221ND	FASTENER , wing type (Make from Ref. No. 28FP/ , Part No. ADW5/40)	1	—	LM	QK2
28FP/— 29H/4/46	DZUS SS/200/D12 TALURIT SS J-S	SPRING THIMBLE , 0"15 long	1 1	— —	C C	QK2 QK2
28D/15663	A26/11C	Attachments for 10-20 S 20401A, Clamp:— Bolt, 2 BA	1	—	C	
28M/10288	AGS.2001/C/1	Nut, 2 BA	1	—	C	
16876	10-20 S 15271A	CLIP , pipe, on rib No. 1, aft of front firewall, Port, assembly	1	—	C	QK2
16877	10-20 S 20257A	CLIP , pipe, on rib No. 1, aft of front firewall, Starboard, assembly Attachments for 10-20 S 15271A or 10-20 S 20257A, Clip:—	1	—	C	QK2
28D/15663	A26/11C	Bolt, 2 BA	2	—	C	
	10-20 S 15343ND	Cable, 3 cwt. (Make from Ref. No. 28X/5450	1	W9/1P	LM	QK2
28M/10288	AGS.2001/C/1	Nut, 2 BA	2	—	C	
16875	10-20 S 15311ND	Pin, "Pip," quick release	1	—	C	QK2
29H/4099	—	Ring, split, 3" dia.	2	—	C	
29H/4/46	TALURIT SS J-S	Thimble, 0"15 long	2	—	C	QK2
28W/12685 4/12/82	SP.14/C	Washer	2	—	C	
16879	10-20 S 20249	HOSE , flexible, between engine and butterfly valve, Port	1	—	C	QK2
16884	10-20 S 20247	HOSE , flexible, between engine and butterfly valve, Starboard	1	—	C	QK2
16880	10-20 S 20431A/ND	PIPE , between front firewall and joint at butterfly valve, Port, assembly	1	—	C	QK2
16883	10-20 S 20429A/ND	PIPE , between front firewall and joint at butterfly valve, Starboard, assembly	1	—	C	QK2
28F/18039	AS.5304	RING , sealing, at front firewall and joint at butterfly valve	4	—	C	
28F/17675	AS.5402	RING , sealing, at engine	2	—	C	
	—	VALVE , pneumatic, butterfly, on rib No. 1, at first joint from engine, coded "ABY and ABZ," group (Drg. No. 10-20 S 20215)	2	—	—	
	10-20 S 15309ND	CLIP , hose (Make from Ref. No. 28E/9129562, Part No. AGS.605/3)	1	—	LM	QK2
27V/5694	TEDDINGTON FMP-A-211	VALVE , pneumatic, butterfly	1	—	P	QK2
	—	PIPES , rain shedding, in "Zone A", group (Drg. No. 10-20 S 20365)	1	—	—	QK2
16947	KING AIRCRAFT CORPORATION C.3991/13-2E	CLAMP , at front firewall	3	—	C	QK2
16871	10-20 S 20379A/ND	PIPE , lagged, between joint at aft fairing and joint at front face of front firewall, assembly	1	—	C	QK2

SERVICES

WINDSCREEN RAIN SHEDDING PIPES

Ref. No.	Part No.	Description	No. off	Material Specification	Class of Store or LM	Plate No.
16872	10-20 S 20381A/ND	PIPE , lagged, between joint at front face of front firewall and joint at front firewall, assembly	1	—	C	QK2
16873	10-20 S 20383A/ND	PIPE , lagged, between joint at aft fairing and front firewall, assembly	1	—	C	QK2
28F/18039	AS.5403	RING , sealing, at firewall and pipe along front face of firewall	3	—	C	
27QA/938	DOWTY GD.2004/B14	RING , "O," sealing, at pipe joint at forward and aft fairing	2	—	C	QK1
16866	10-20 S 20455	STRAP , butt, at joint of forward and aft fairings	1	L.72	C	QK1
	—	SWITCH , hood, extension, external, group... (Drg. No. 10-20 FS 20041)	1	—	—	
	10-20 FS 17647ND	PACKING , 0".75 dia., thickness to suit (Make from natural rubber, shore hardness 40°) (Attach with Bostik 1410)	QR	—	LM	QK1
16885	10-20 FS 20043A	SWITCH , assembly ... Spares for :—	1	—	C	QK1
16886	10-20 FS 17815	SPRING ...	1	—	C	QK1
		Attachments for 10-20 FS 20043A, Switch :—				
28D/9131782	AS.1242/2B	Boit, 4 BA	6	—	C	
28M/10287	AGS.2001/B/1	Nut, 4 BA	6	—	C	
28W/9419465	SP.13/B	Washer	6	—	C	

QK.I

WINDSCREEN RAIN SHEDDING PIPES

SERVICES

QK.I
[AL45]

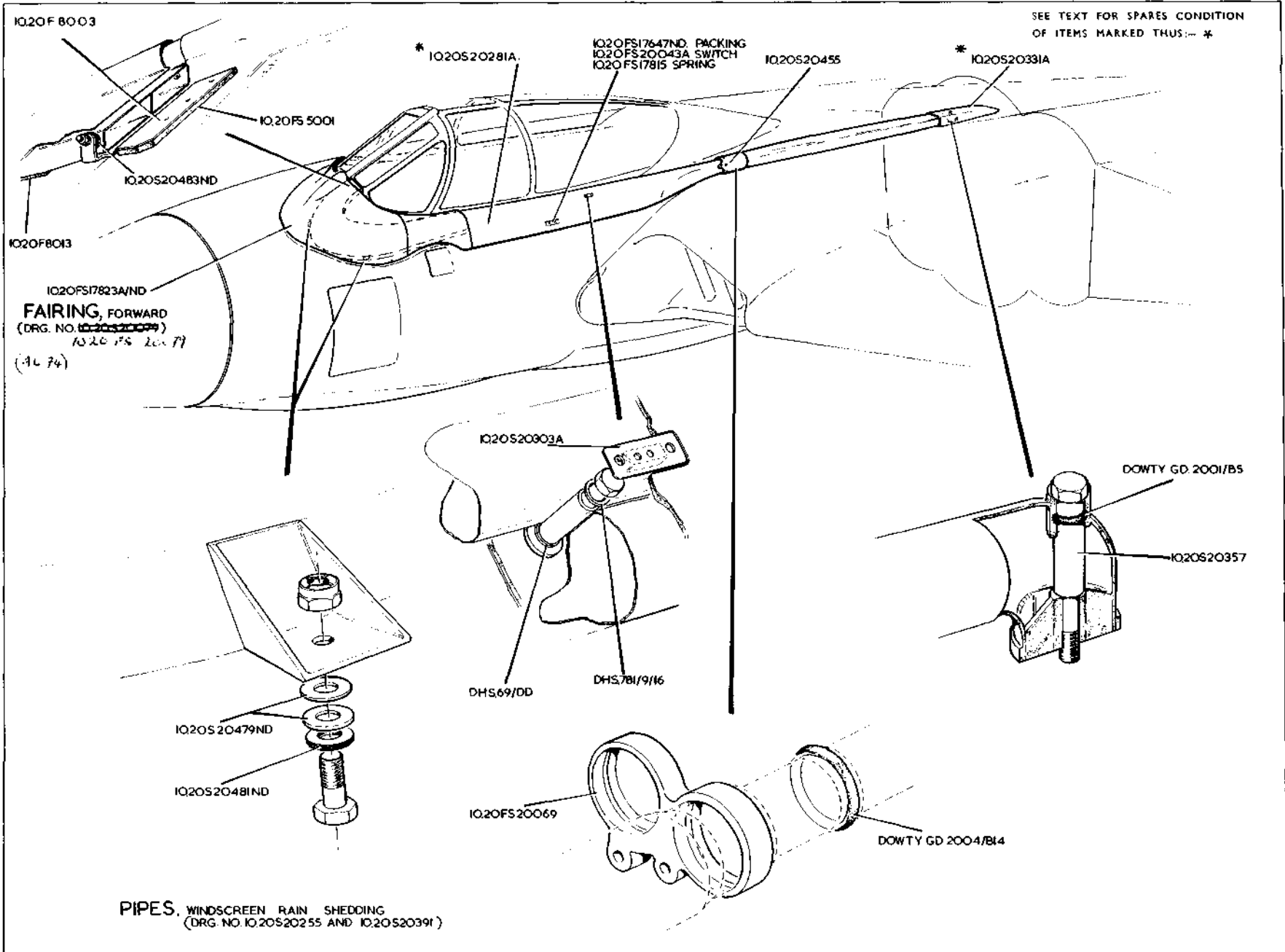

See Vixen M.I.

RESTRICTED

Plate QK.I

RESTRICTED

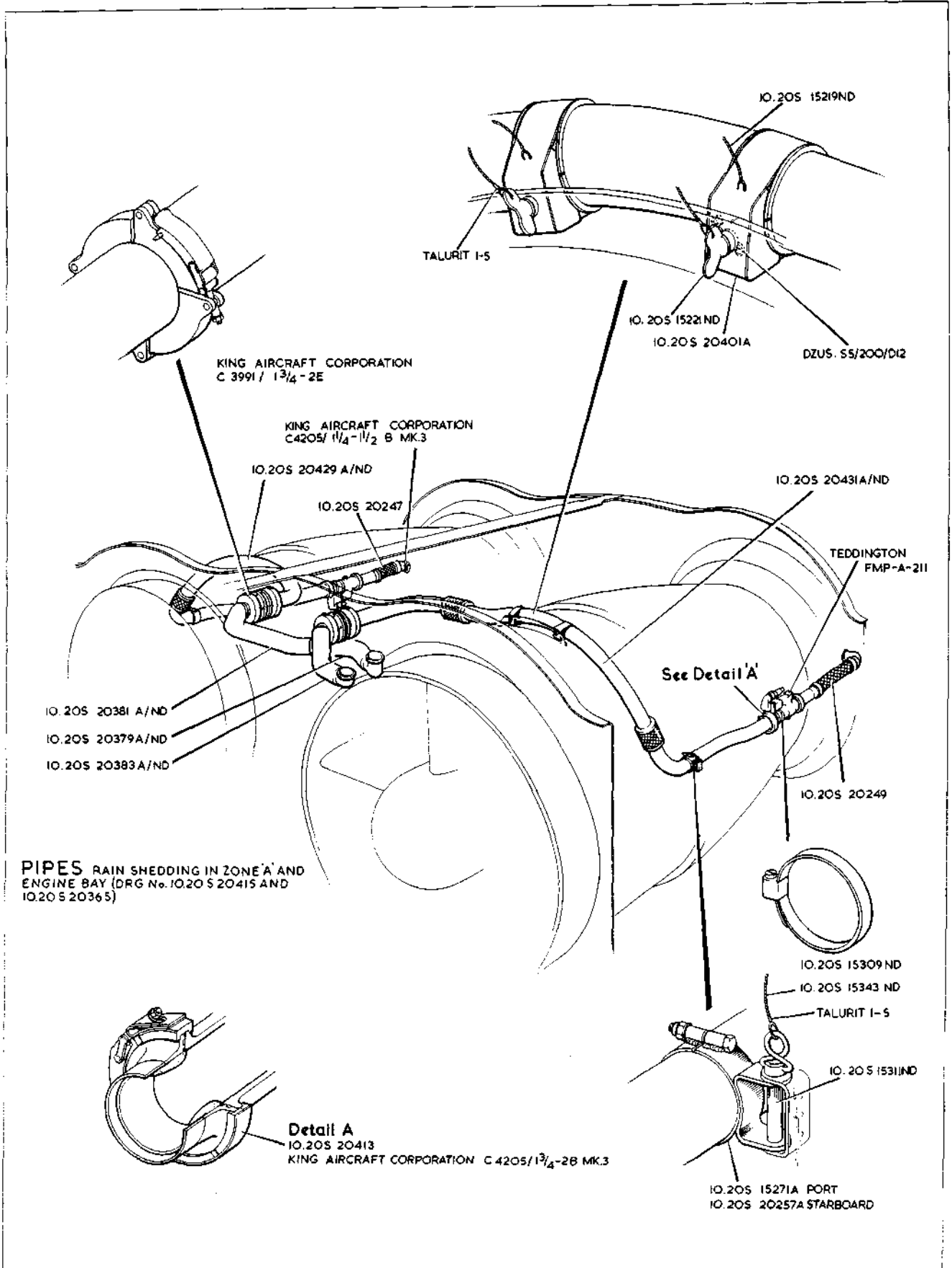

QK.2

SERVICES

QK.2
[AL 45]

WINDSCREEN RAIN SHEDDING PIPES

This file was downloaded
from the RTFM Library.

Link: www.scottbouch.com/rtfm

Please see site for usage terms,
and more aircraft documents.

