

SERVICES—FUEL SYSTEM IN WINGS

Ref. No.	Part No.	Description					No. Off	Material Specification	M.R. Class of Store	Plate No.
		1	2	3	4	5				
	E.206680-1	FUEL SYSTEM IN WINGS, ASSEMBLY ...					—	—		
	—	Cables , electrical (See cable chart) ...					—	—		
1136	A.186450	Clamp , pipe connection, group ...					4	—	C.	NC.1
2723	F.184931	Bolt , eye ...					1	S.94.B	C.	
6526	F.213079	Nut , special ...					1	S.95	C.	
2724	F.185592	Washer , ...					1	DTD.364	C.	
4992	F.200275	Clamp , pipe connection, group ...					2	—	C.	NC.1
2723	F.184931	Bolt , eye ...					1	S.94	C.	
6526	F.213079	Nut , special ...					1	S.95	C.	
2724	F.185592	Washer ...					1	DTD.364	C.	
421	A.185593	Clamp , pipe connection, group ...					4	—	C.	
2723	F.184931	Bolt , eye ...					1	S.94.B	C.	
2724	F.185592	Washer ...					1	DTD.364	C.	
5059	A.186451	Clamp , pipe connection, group ...					4	—	C.	
2723	F.184931	Bolt , eye ...					1	S.94.B	C.	
2724	F.185592	Washer ...					1	DTD.364	C.	
5414	Std.851/68	Clip , support, for vent pipe at rib "G" ...					2	DTD.610	C.	4
	Std.851/30	Clip , support, for vent pipe at rib No. 2 ...					2	DTD.610	C.	
4165	Std.850/35	Clip , support, for earthing connector ...					2	DTD.610	C.	4
27F/2352	Flight Refuelling FRS.132.F.	Connector ...					2	—	B.	
4105	Std.1285.8.C.C.	Connector , earth, at rib "A" ...					2	—	C.	4
4993	F.205032	Packing , for vent pipe clip "G" <i>A.T. Rib</i> ...					2	LFS.21	C.	
4994	Std.1939/1	Packing , for vent pipe clip at rib No. 2 ...					2	LFS.21	C.	
6987	A.207209/4	Pipe , air, inboard tank to connection ...					2	DTD.253	C.	NC.1
4996	B.198928/2	Pipe , connection to connection, port ...					1	DTD.253	C.	NC.1
4997	B.198928/3	Pipe , air, connection to connection, starboard ...					1	DTD.253	C.	NC.1
5000	B.198928/6	Pipe , fuel, transfer, connection to tank, port ...					1	DTD.253	C.	NC.1
5001	B.198928/7	Pipe , fuel, transfer, connection to tank, starboard ...					1	DTD.253	C.	NC.1
7902	A.206783	Pipe , fuel, inboard to outboard pylon, port ...					1	BSS.265	C.	NC.1
7903	A.206784	Pipe , fuel, inboard to outboard pylon, starboard ...					1	BSS.265	C.	NC.1
7898	C.206676	Pipe , fuel, by-pass valve to connection, port ...					1	DTD.253	C.	NC.1
7899	C.206677	Pipe , fuel, by-pass valve to connection, starboard ...					1	DTD.253	C.	NC.1
7900	C.206678	Pipe , air, Flight Refuelling coupling to connection, part ...					1	DTD.253	C.	NC.1
7901	C.206679	Pipe , air, Flight Refuelling coupling to connection, starboard ...					1	DTD.253	C.	NC.1
7892	B.206682	Pipe , fuel, between pylons ...					2	DTD.253	C.	NC.1
7893	B.206683	Pipe , air, between pylons ...					2	DTD.253	C.	NC.1
7894	C.206684	Pipe , fuel, outboard by-pass valve to connection, port ...					1	DTD.253	C.	NC.1
7895	C.206685	Pipe , fuel, outboard by-pass valve to connection, starboard ...					1	DTD.953	C.	NC.1
7896	C.206686	Pipe , air, outboard, by-pass valve to connection, port ...					1	DTD.253	C.	NC.1
7897	C.206687	Pipe , air, outboard by-pass valve to connection, starboard ...					1	DTD.253	C.	NC.1
5004	Dowty	Ring , sealing, at suction relief valve ...					2	—	C.	
270A/376	GD.1309/16									
3940	Dowty	Ring , sealing, at transfer pipe couplings ...					4	—	C.	
270A/371	GD.1309/25									

RESTRICTED

Hunter T. Mk. 7
Issued with A/L No. 3

SERVICES—FUEL SYSTEM IN WINGS

Ref. No.	Part No.	Description					No. Off	Material Specification	M.R. Class of Store	Plate No.
		1	2	3	4	5				
27QA/361	3945 Dowty GD.1308/2						10	—	C.	NC.1
27QA/380	8040 Dowty GD.1309/23						2	—	C.	
27QA/379	5180 Dowty GD.1309/21						4	—	C.	
	5006 Std.1703/7C						4	S.95.B	C.	5
	7906 A.206273						4	LFS.21	C.	NC.1
	7907 A.206274						4	LFS.21	C.	NC.1
	7908 A.206275						4	LFS.21	C.	NC.1
	E.206941-2						—	—		
5023	F.202080						2	L.56	C.	NC.1
6777	F.210001						12	S.95.B	C.	NC.1
7066	F.211844						36	S.95.B	C.	NC.1
6A/4315	Smiths JM.14						2	—	B.	
6A/4316	Smiths JU.6						8	—	B.	
	Std.843/38						2	—		4
5025	C.198341						1	S.54 & L.59	C.	NC.1
5026	C.198342						1	L.54 & L.59	C.	NC.1
5027	C.198530						1	L.54 & L.59	C.	NC.1
5028	C.198531						1	L.54 & L.59	C.	NC.1
5029	C.198343						1	L.54 & L.59	C.	NC.1
5030	C.198344						1	L.54 & L.59	C.	NC.1
6991	C.209795						1	L.54 & L.59	C.	NC.1
6992	C.209796						1	L.54 & L.59	C.	NC.1
5033	C.198345						1	L.54 & L.59	C.	NC.1
5034	C.198346						1	L.54 & L.59	C.	NC.1
5035	C.198526						1	L.54 & L.59	C.	NC.1
5036	C.198527						1	L.54 & L.59	C.	NC.1
6095	B.208097						1	—	B.	NC.1
6096	B.208098						1	—	B.	NC.1
	A.199074						2	DTD.610		
5038	Dowty						2	—	C.	NC.1
27QA/362	GD.1308/4						2	—	C.	NC.1
5CW/5255	Flight Refuelling D.3504100/2						2	—	A.	NC.1
9655	A.226375						8	—	C.	NC.1
2144	Std.1231/3						2	S.3	C.	4
	A.232202						2	L.72	—	
6988	B.207013						2	DTD.610	C.	NC.1
6990	B.207014						4	DTD.610	C.	NC.1
6989	B.207015						2	DTD.610	C.	NC.1
5042	B.202091						2	—	C.	NC.1
5043	B.202075						1	DTD.253	C.	NC.1
5044	B.202076						1	DTD.253	C.	NC.1
5045	C.198514						1	L.54 & L.59	C.	NC.1
5046	C.198515						1	L.54 & L.59	C.	NC.1
5047	A.199113						12	DTD.364	C.	NC.1
27QA/361	3945 Dowty GD.1308/2						12	—	C.	NC.1

RESTRICTED

Hunter T. Mk. 7
Issued with A/L No. 7

SERVICES—FUEL SYSTEM IN WINGS

Ref. No.	Part No.	Description					No. Off	Material Specification	M.R. Class of Store	Plate No.
		1	2	3	4	5				
6208	F.210208					Ring , sealing, at bulkhead connection on front spar	2	—	C.	
	Dowty					Seal , bonded	64	—	C.	NC.1
27QA/139	GD.1307/3									
	Dowty					Seal , bonded, at transfer duct connections ...	24	—	C.	NC.1
27QA/140	GD.1307/4									
	Dowty					Seal , bonded, at bulkhead connection on leading edge spar	2	—	C.	NC.1
27QA/149	GD.1307/G					Tanks (See section "Q")	—	—	—	
9654	F.226373					Washer , sealing, at No. 4 tank transfer pipe flange ...	2	DTD.1177 and L.72	C.	NC.1
9653	F.226372					Washer , sealing, at float switch in No. 1 tank ...	2	DTD.1177 and L.72	C.	NC.1
9652	F.226371					Washer , sealing, at No. 1 tank air pipe flange ...	2	DTD.1177 and L.72	C.	NC.1
9659	A.226379					Washer , sealing, at outlet duct in No. 1 tank ...	2	DTD.1177 and L.72	C.	
9648	F.226367					Washer , sealing	10	DTD.1177 and L.72	C.	
5053	F.199096					Seal , "U," at float switch in No. 4 tank ...	2	Rubber	C.	NC.1
4042	Std.1509/23/030					Tube , distance, at fuel pipe support, $\frac{3}{16}$ " o/d \times 17 S.W.G. \times 0-30" long (Make from 30B/556) ...	4	T.4	MR/C	4
8190	A.218022					Valve , suction relief, port, group	1	—	B.	NC.1
8191	A.218023					Valve , suction relief, starboard, group	1	—	B.	NC.1
6200	F.209640					Collar	1	—	C.	NC.1
	A.210450					Pipe , port	1	—		
	A.210451					Pipe , starboard	1	—		
6199	F.209155					Spring	1	Steel	C.	NC.1
7050	F.215727					Valve	1	—	C.	NC.1

RESTRICTED

Hunter T. Mk. 7
Issued with A/L No. 7

SERVICES—FUEL SYSTEM IN WINGS

Ref. No.	Part No.	Description					No. Off	Material Specification	M.R. Class of Store	Plate No.
		1	2	3	4	5				
	A.233327/8	FUEL SYSTEM IN WINGS ASSEMBLY (Conversion Wing Only) To Wing Serial Numbers :— 41H/670099 HABL/001208 41H/670148 HABL/001249 41H/670163 HABL/002018 41H/670462 HABL/002053 41H/670514 41H/670529 Identical to system fuel assemblyE. 206680-1 except for the following deletions and additions DELETE:—					—	—		
7902	A.206783	Pipe , fuel, inboard to outboard pylon, port ...					1	—	C.	
7903	A.206784	Pipe , fuel, inboard to outboard pylon, starboard ...					1	—	C.	
7892	B.206682	Pipe , fuel, between pylons ...					2	—	C.	
7893	B.206683	Pipe , air, between pylons...					2	—	C.	
7906	A.206273	Support , at rib "J" for fuel and air pipes, between pylons					4	—	C.	
7907	A.206274	Support , at rib "M" for fuel and air pipes, between pylons					4	—	C.	
		ADD:—								
421	A.185593	Clamp , fuel pipe connection at rib "M" group ...					2	—	C.	
2723	F.184931	Bolt , eye ...					1	S.94.B	C.	
2724	F.185592	Washer ...					1	DTD.364	C.	
5059	A.186451	Clamp , air pipe connection between ribs "M-N" group					2	—	C.	
2723	F.184931	Bolt , eye ...					1	S.94.B	C.	
2724	F.185592	Washer ...					1	DTD.364	C.	
	B.210509	Pipe , air, inboard pylon to coupling between ribs "M-N," port					1	DTD.253		
	B.210510	Pipe , air, inboard pylon to coupling between ribs "M-N," starboard					1	DTD.253		
	B.210511	Pipe , air, coupling between ribs "M-N" to outboard pylon, port					1	DTD.253		
	B.210512	Pipe , air, coupling between ribs "M-N" to outboard pylon, starboard					1	DTD.253		
	B.207362	Pipe , fuel, between inboard and outboard pylons ...					4	DTD.253		
	A.234181	Pipe , fuel, at inboard pylon, port ...					1	BSS.265		
	A.234182	Pipe , fuel, at inboard pylon, starboard...					1	BSS.265		
27QA/361	Dowty Seals GD.1308/2	Ring , sealing, at fuel pipe connection rib "M" ...					2	—	C.	
27QA/379	Dowty Seals GD.1309/21	Ring , sealing, at air pipe connection between ribs "M-N"					2	—	C.	
	A.207331	Support , at rib "M" for fuel and air pipes between pylons					4	LFS.21		
	A.234202	Support , at rib "J" for fuel and air pipes between pylons					4	LFS.21		
4042	Std.1509/23/030	Tube , distance, at fuel pipe support rib "M" (Make from 30B/556) (Starboard only)					2	T.4	MR/C	

RESTRICTED

SERVICES—FUEL SYSTEM IN WINGS

Ref. No.	Part No.	Description										No. Off	Material Specification	M.R. Class of Store	Plate No.
		1	2	3	4	5									
		SUMMARY OF STOCK ITEMS													
28D/1010658	A25.1.B	Bolt, 4 B.A.	—	—	—	
28D/9436920	A25.1.C	Bolt, 2 B.A.	—	—	—	
28D/9133011	A25.2.C	Bolt, 2 B.A.	—	—	—	
28D/9133012	A15.3.C	Bolt, 2 B.A.	—	—	—	
28D/1200119	A25.4.C	Bolt, 2 B.A.	—	—	—	
28D/7002428	A25.6.C	Bolt, 2 B.A.	—	—	—	
28D/1011019	A25.8.C	Bolt, 2 B.A.	—	—	—	
28D/12517	A25.17.C	Bolt, 2 B.A.	—	—	—	
28D/12635	A25.24.E	Bolt, 1/4" B.S.F.	—	—	—	
5K/3405	AS.3360 B.3.C	Connector, earthing	—	—	—	
5K/3408	AS.3360 B.6.C	Connector, earthing	—	—	—	
28F/8280	AGS.1142.H	Nipple	—	—	—	
28F/19143	AGS.2120.H	Nipple	—	—	—	
28M/13121	A.27.CS	Nut, 2 B.A.	—	—	—	
28M/10327	AGS.2002.B1	Nut, 4 B.A.	—	—	—	
28M/10328	AGS.2002.C1	Nut, 2 B.A.	—	—	—	
28M/13264	AGS.2021.C1	Nut, 2 B.A.	—	—	—	
28M/13721	AGS.2021.E1	Nut, 1/4" B.S.F.	—	—	—	
28P/19225	SP.90 C.3	Pin	—	—	—	
28P/19154	SP.90 C.7	Pin	—	—	—	
28R/6341	AGS.566.B	Plug	—	—	—	
28S/14301	A33.C14	Screw, 2 B.A.	—	—	—	
28S/6611	A37.C20	Screw, 2 B.A.	—	—	—	
28S/1200066	A33.B20	Screw, 4 B.A.	—	—	—	
28F/9438453	AGS.1186.B	Seal, 1/4"	—	—	—	
28S/1011903	AGS.1186.G	Seal	—	—	—	
28S/9429636	AGS.1186.3	Seal, 2 B.A.	—	—	—	
28W/9419474	SP.15.B	Washer, 4 B.A.	—	—	—	
28W/9419475	SP.15.C	Washer, 2 B.A.	—	—	—	
28W/9419404	SP.16.C	Washer, 2 B.A.	—	—	—	
28F/9652	AGS.1138.E	Washer, 1/4" dia.	—	—	—	

RESTRICTED

[illegible]

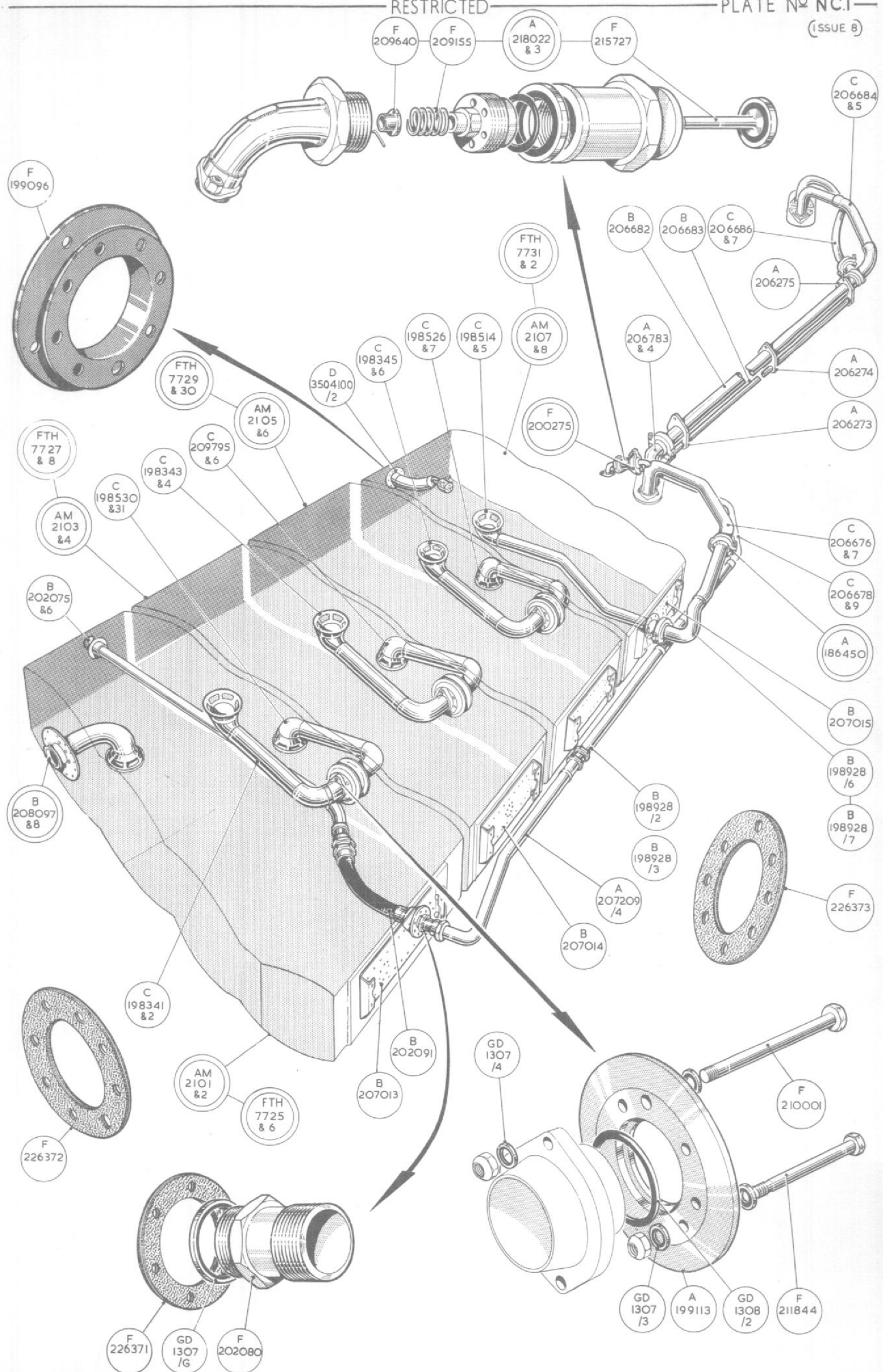

This file was downloaded
from the RTFM Library.

Link: www.scottbouch.com/rtfm

Please see site for usage terms,
and more aircraft documents.

