

COUPLINGS,
AIR VENT SUIT

HH

Issued with A.L. 7.

INDEX OF MAJOR UNITS

RESTRICTED

[illegible]

RESTRICTED

Section HH — COUPLINGS, AIR VENTILATED SUIT

COUPLING, AIR VENTILATED SUIT, A/C UNIT

512070

[illegible]

COUPLING, AIR VENTILATED SUIT, GROUND UNIT

512080

[illegible][illegible][illegible]

RESTRICTED

TYPE / APPLICABILITY

ACCESSORY :-

AIRCRAFT	MK	No. OFF	MK	No. OFF	MK	No. OFF	MK	No. OFF	MK	No. OFF	MK	No. OFF	MK	No. OFF	MK	No. OFF

RESTRICTED

COUPLINGS, AIR VENTILATED SUIT

Ref. No.	Part No.	Description	No. Off	Matl. Spec.	CL. OF	Plate No.
					ST. M.R. L.M.	
969	512070	COUPLING, AIR VENTILATED SUIT A/C UNIT ...	1	—	A	HH 1
		Spares for:—				
	553331	BODY	1	DTD.727		HH 1
1356	553333	COUPLING, pipe (R.N.)	1	L.65	C	HH 1
28F/12084	AGS.1186/G	Washer, sealing	1	—	C	
971	553335	GASKET	1	DTD.560	C	HH 1
1401	555220	GASKET	1	HALLITE	C	HH 1
	553334	HEAD, valve	1	S.80		HH 1
	N.D.	INSERT, wire .375" long 2 B.A. 'CROSS'	8	—		HH 1
534	500500	NAMEPLATE (R.N.)	1	L.4	C	HH 1
28S/6634	2R 1/8"	Screw	4	—	C	
1358	504085	SCREW, grub (R.N.)	1	S.1	C	HH 1
970	556606	SEAT, valve, complete	1	—	C	HH 1
28D/8306	AS.1242/1C	Bolt, 2 B.A.	4	—	C	
1355	553347	SPRING, compression	1	DTD.215	C	HH 1
28D/8307	AS.1242/2C	Bolt, 2 B.A. (for attachment to A/C)	4	—	C	

Page HH 2

COUPLINGS, AIR VENTILATED SUIT

Ref. No.	Part No.	Description							No. Off	Matl. Spec.	CL. OF	Plate No.
		1	2	3	4	5					ST. M.R. L.M.	
1121	512080	COUPLING, AIR VENTILATED SUIT — GROUND UNIT.							1	—	A	HH 2
		Spares for :—										
	555798	NAMEPLATE	1	BS.265		HH 2
1171	553339	SPRING, complete	3	—	C	HH 2
28Q/1919	AS.455/303	Rivet	3	—	C	
1172	553340	SEAL	1	RUBBER	C	HH 2

RESTRICTED

PLATEHHI

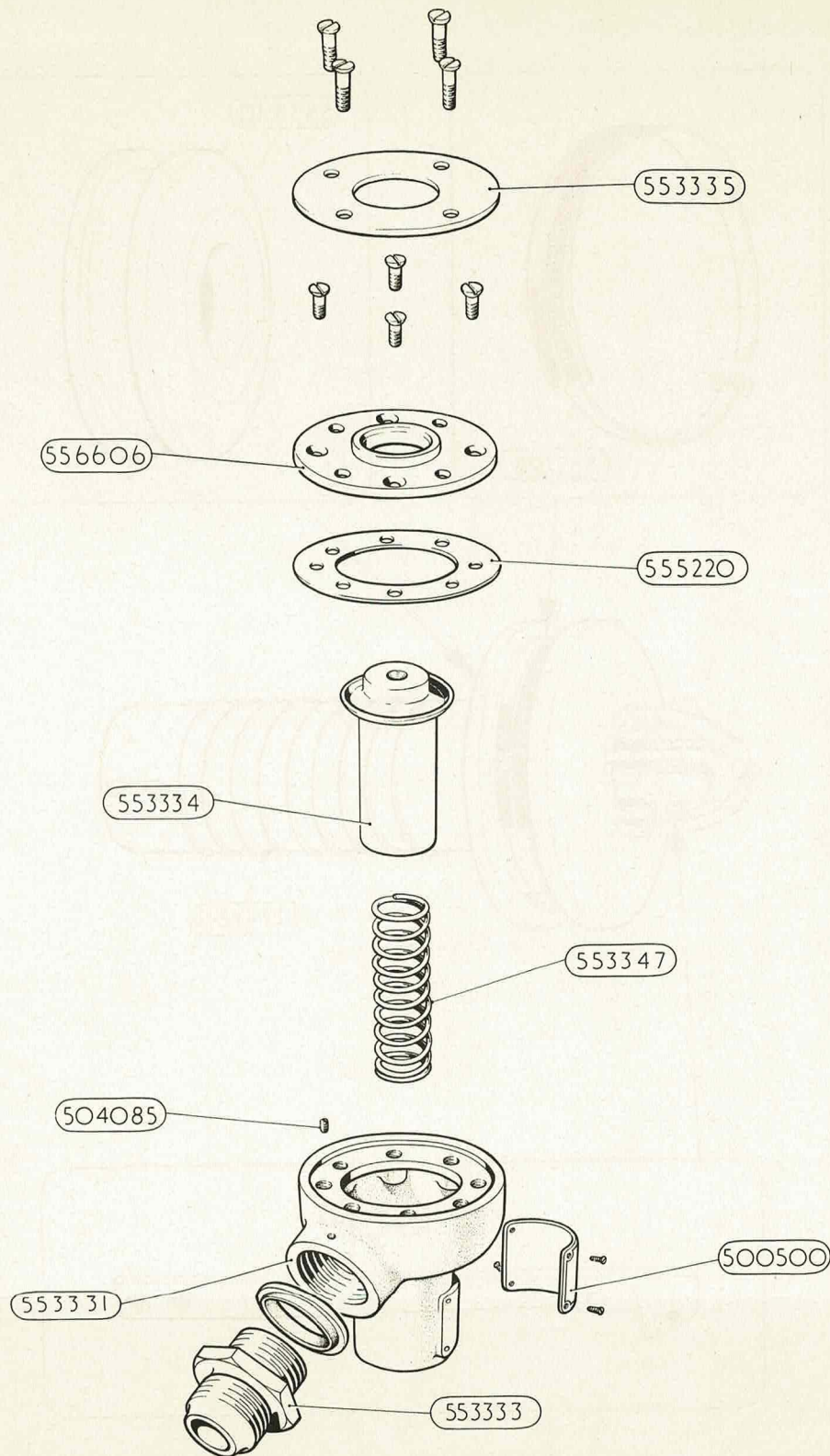

COUPLING, AIR VENTILATED SUIT A/C UNIT

RESTRICTED

PLATE HH2

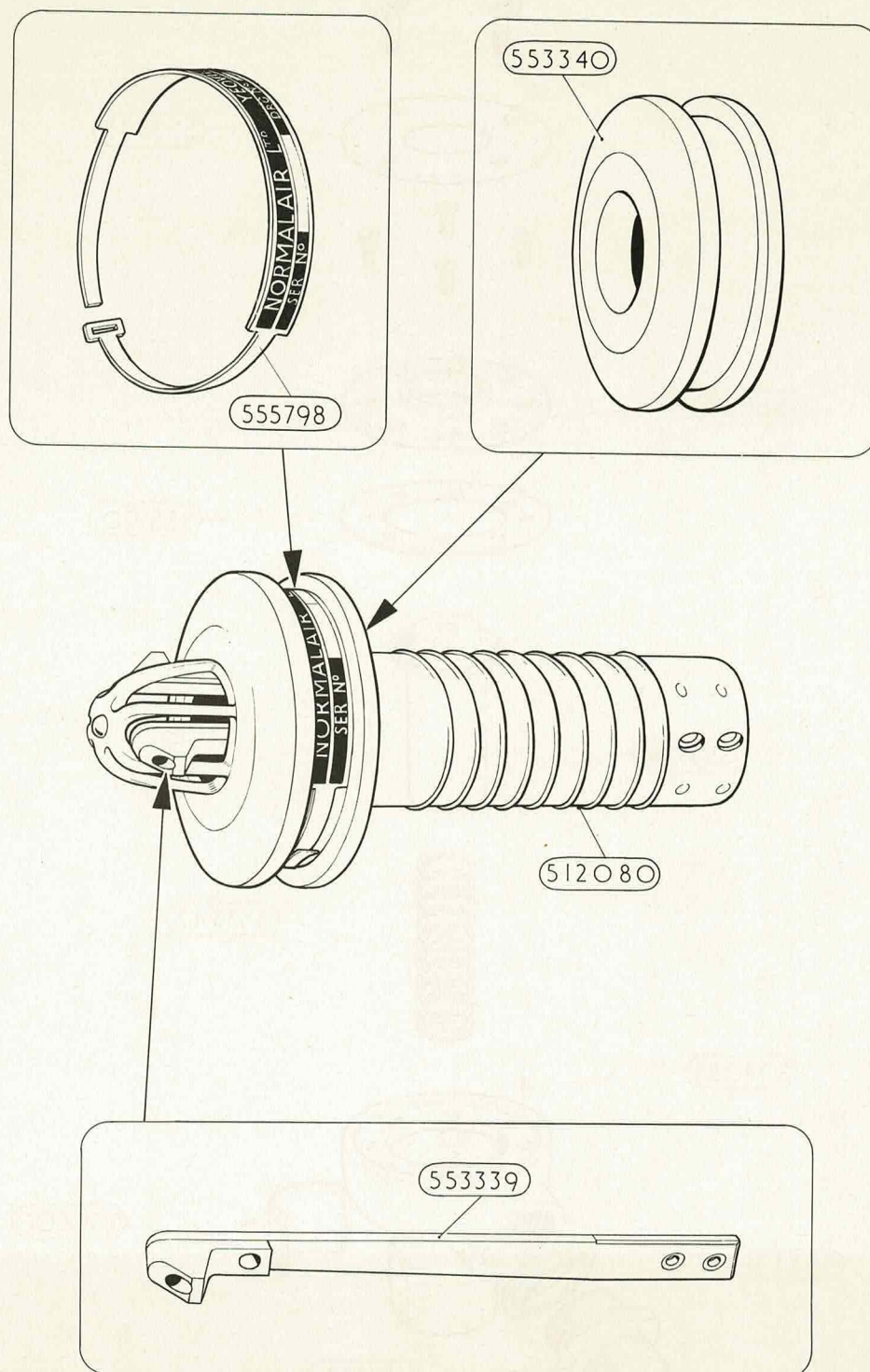

COUPLING, AIR VENTILATED SUIT, GROUND UNIT

This file was downloaded
from the RTFM Library.

Link: www.scottbouch.com/rtfm

Please see site for usage terms,
and more aircraft documents.

